

# Digital Wireless Audio/Video Baby Monitor



The pictures, diagrams and certain functions described in this manual may differ from the actual product due to different models.

**ZOpid**<sup>®</sup>

Visit [www.hittusa.com](http://www.hittusa.com) to check if new firmware or user manual is available for download.

## **SAFETY AND GENERAL INFORMATION**

### **IMPORTANT INFORMATION ON SAFE AND EFFICIENT OPERATION OF THIS PRODUCT READ THIS INFORMATION BEFORE USING THIS BABY MONITOR**

Before operating your Wireless Baby Monitor, please read all these safety and operating instructions completely and then retain for future reference.

1. Your Baby Monitor is designed to be an aid and should not be used as a substitute for responsible and proper adult supervision.
2. Do not place the camera on any surface or mount it on any wall where the camera or the AC adapter cord are within baby's reach.
3. Never place the camera inside your baby's cot, bed or playpen.
4. Never cover the camera and monitor (e. g. with clothes, towels or blankets).
5. Position the camera, monitor and AC adapters to allow adequate ventilation.
6. Never use or place your camera and monitor in moist places or near water. For example, do not use near a bathtub, washbowl, laundry tub, kitchen sink, in a wet basement. etc.
7. To prevent overheating, keep the camera, monitor and AC adapters away from heat sources such as radiators, heat registers, stoves or other appliances (including amplifiers) which produce heat.
8. Keep the camera out of direct sunlight.
9. Disconnect the AC adapter from wall outlets during long periods of non-use.
10. Use only the AC adapters provided. Use of any others may damage the camera and/or monitor.
11. If traveling abroad, make sure that the voltage shown on the power adapters correspond to the local power, before plugging in the AC adapters into the electric outlets.

## **NOTE REGARDING FCC COMPLIANCE**

Users are not permitted to make changes or modify the device in any way. Changes or modifications not authorized by the party responsible for compliance could void the user's authority to operate the equipment.

This device complies with part 15 of the FCC Rules. Operation is subject to the following two conditions: (1) This device may not cause harmful interference, and (2) This device must accept any interference received, including interference that may cause undesired operation.

### **FCC Notice to Users**

This equipment has been tested and found to comply with the limits for a Class B digital device, pursuant to part 15 of the FCC Rules. These limits are designed to provide reasonable protection against harmful interference in a residential installation. This equipment generates, uses and can radiate radio frequency energy and, if not installed and used in accordance with the instructions, may cause harmful interference to radio communications. However, there is no guarantee that interference will not occur in a particular installation. If this equipment does cause harmful interference to radio or television reception, which can be determined by turning the equipment off and on, the user is encouraged to try to correct the interference by one or more of the following measures:

- Reorient or relocate the receiving antenna.
- Increase the separation between the equipment and the receiver.
- Connect equipment to an outlet on a circuit different from that to which the receiver is connected.
- Consult the dealer or an experienced radio/TV technician for help.

## CARE AND MAINTENANCE

1. Keep all parts and accessories out of young children's reach.
2. Fingerprints or dirt on the lens surface can adversely affect camera performances. Avoid touching the lens with your fingers.
3. Should the lens become dirty, use a blower to blow off dirt and dust, or a soft dry cloth to wipe the lens.
4. Keep the camera dry. Precipitation, humidity and other liquids contain minerals that will corrode electronic circuits.
5. Do not use or store in dusty, dirty areas.
6. Do not store in hot areas. High temperatures can shorten the life of electronic devices and warp or melt certain plastics.
7. Do not store in very cold areas. When the system warms up, the moisture can form inside the case, which may damage electronic circuit boards.
8. Do not attempt to open the case. Non-expert handling of the device may damage the system.
9. Avoid dropping or strong shocks.
10. Operate the product using only the power supply include or provided as an accessory.
11. Do not overload electrical outlets or extension cords. This can result in fire or an electric shocks.

## CONTENTS

<b>Features</b>	<b>2</b>
<b>Monitor Diagram</b>	<b>3</b>
<b>Camera Diagram</b>	<b>4</b>
<b>Child Unit (Camera)</b>	<b>5</b>
<b>Parent Unit (Monitor)</b>	<b>7</b>
<b>LCD Display</b>	<b>9</b>
<b>Register Additional Cameras</b>	<b>17</b>
<b>Explanation of Audio &amp; Video Sensitivity Levels</b>	<b>24</b>

## **MAIN FEATURES**

- \*100% Digital Technology
- \*Digital signal for crystal clear clarity
- \*Digital security for complete privacy, no neighbors can hear and see
- \*Digital zoom with selectable regions
- \*Adjustable volume level, auto camera exposure and video timeout to save energy
- \*Signal strength indicator
- \*Wifi interference free
- \*Dynamic audio strength indicators
- \*Intelligent voice activity detector to lower noise and save battery
- \*Two transmission mode selection: Video & Audio or Audio Only
- \*Sleep mode with voice activation(VOX)
- \*Support Multi-Language( 5 Languages)
- \*Supports up to 8 cameras; with Auto and Manual Scan

## MONITOR

- ① Up(Vol+ or Select Previous camera/Menu Option)\*
- ② Down(Vol- or Select Next camera/Menu Option)\*
- ③ OK/Menu
- ④ Voice Level Indicator LEDs
- ⑤ USB Port for charging or firmware update
- ⑥ DC Socket
- ⑦ Reset
- ⑧ On/Off/Esc
- ⑨ Power indicator LED
- ⑩ Signal LED

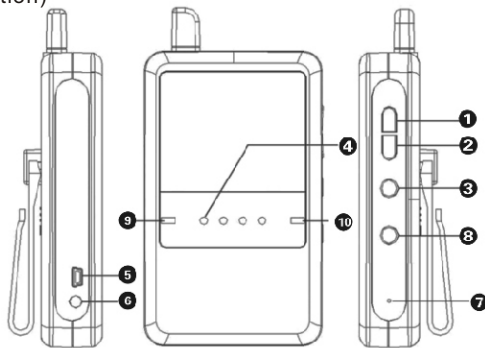

\* Buttons assignment for Volume Control or Camera Selection is a user selectable option- see "Up & Down Buttons Function" under Settings in Main Menu (see section 5.12 for details).

## CAMERA

- ❶ Used during firmware upgrade ONLY
- ❷ Lens
- ❸ Reset
- ❹ DC Socket
- ❺ USB Port for charging or firmware upgrade
- ❻ On/Off/ESC
- ❼ Power and charging status indicator LED

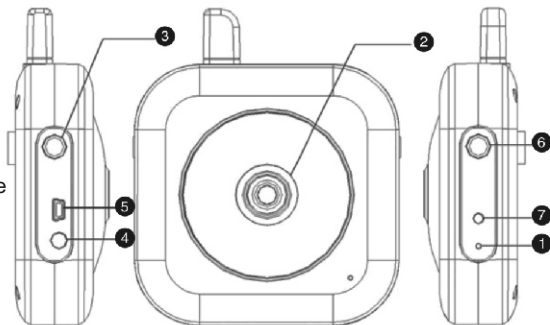



## **CHILD UNIT(CAMERA):**

### **a. POWER ON:**

Connect Camera to an A/C outlet using the included A/C adapter.

**NOTE:** Camera also works with a built-in rechargeable battery, or by connecting it to a computer's USB port using a USB cable.

In Power Off Mode, press and hold ON/OFF button for 3 seconds. Power-indicator LED lights-up indicating the camera is ON.

### **b. POWER OFF**

To turn off the Camera press and hold ON/OFF button for 3 seconds, the Power-indicator LED turns OFF, indicating the Camera is OFF.

### **c. BATTERY STATUS**

When the Camera is not connected to an A/C adapter or computer's USB port, it automatically operates on built-in rechargeable battery. When the battery voltage falls below 3.6V the Power Indicator LED turns RED from GREEN, indicating the battery needs to be charged.

**IMPORTANT NOTE:** When camera battery is extremely low a red flashing "Low battery" message is displayed on the monitor screen.

**d. NIGHT-VISION (IR) OPERATION :**

The camera is equipped with eight(8) Infrared LEDS for night-vision operation. In low light situation the Infrared LEDS turn-on automatically, to activate night-vision.

**NOTE :** The night-vision picture is always black & white and not that sharp. This camera has up to 10 feet night-vision range.

**e. CAMERA STAND/MOUNTING BRACKET :**

Screw the stand to the camera screw hole.

Use a coin to tighten the screw on the back.

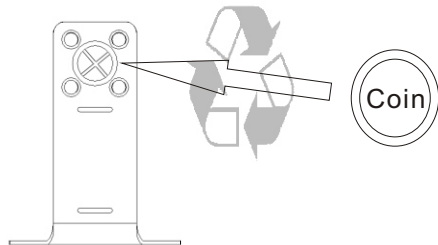
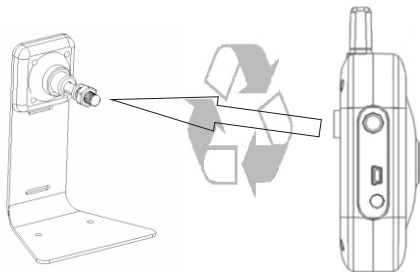

## PARENT UNIT(MOINTOR)

### 1. 1 POWER ON

Connect Monitor to A/C outlet using the included A/C adaper.

**Note** : Monitor also works with a rechargeable battery(see next section for instructions to install rechargeable battery), or by connecting it to a computer' s USB port using a USB cable.

In Power Off Mode, press and hold ON/OFF button for 3 seconds. Power indicator LED will light up and monitor will display"system starting up. . . ". If the camera is powered on then video will be displayed on the screen else the monitor will display "connecting Camera 1".

**Note** :if the camera is powered ON but the monitor displays "Connecting Camera 1" or"Camera 1 unregistered", please see section 5. 7 to first register/pair the camera. This message is also displayed when camera is out of range.

### 1. 2 POWER OFF

To turn off the monitor press and hold ON/OFF button for 3 seconds, the Power LED and display will turn OFF.

## 2. 1 Installing Rechargeable Battery :

Rechargeable battery is included with the system, but not installed, Please install the battery as shown below, make sure to align metal contacts on the battery with the metal contacts in the battery compartment:

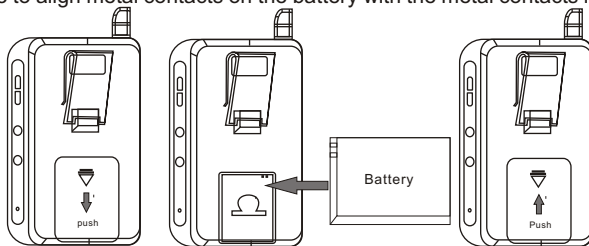

## 2. 2 Battery Operation :

When the battery voltage is above 3.6V, the Power LED is GREEN. When the voltage falls below 3.6V the Power LED turns RED, indicating the battery needs to be charged.

## 2. 3 Charging in Power Off Mode :

When power adapter is connect to the monitor the LCD screen display indicating battery is getting charged until the battery is fully charged.



## LCD DISPLAY:



📶 Thu 07/10 09:59AM 🔒 🔋



### 3.1 Signal Icon

The signal icon 📶 works similar to mobile phone signal strength indicator, the signal bars change indicating camera signal strength.

### 3. 2 Battery Icon

The battery icon  displays 4 different battery levels. Solid icon  indicates full battery strength. Blank blinking icon  indicates very low battery strength and monitor must be connected to the A/C adapter to charge the battery and to continue using the monitor.

### 3. 3 Alarm Icon :

The alarm icon  is displayed once an alarm is setup.

### 4. Voice Level Indicator :

4 LEDs below the Screen show the sound level. This feature is very helpful, when the Volume Level is very low or set to zero, for visual notification of sound detection by the camera and the sound level.

## 5. Main Menu Operations :

### 5.1 Main Menu



Press &Hold ON/OFF button for three(3)seconds to turn ON the monitor.

- Press "OK/MENU" button to display Main Menu.
- Use "UP" or "DOWN" button to highlight a Menu Option and press "OK/MENU" button to complete the selection.
- Press "ESC" button to exit from the Main Menu.

## 5.2 Volume Adjustment:

Use this option to adjust speaker volume

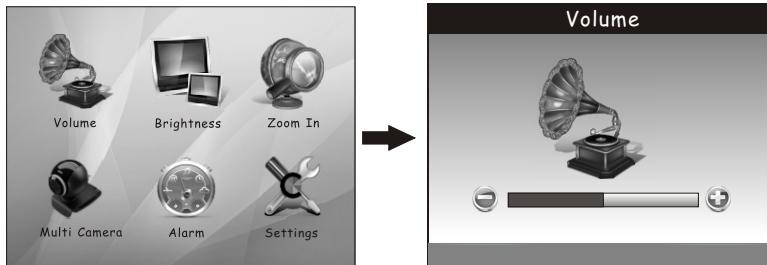

- Press "OK/MENU" button to display Main Menu.
- Use "UP" or "DOWN" button to highlight "Volume" Option and press "OK/MENU" button to complete the selection.
- Use "UP" or "DOWN" button to adjust the "Volume" and press "OK/MENU" button to complete the selection.
- Press "ESC" button to exit from the Menu.

**NOTE: Up and Down Buttons on the Monitor can also be used to adjust volume if "Volume Control" function is assigned to these keys using "Up & Down Buttons Function" under "Settings" in the Main Menu (see section 5.12 for details).**



### 5.3 Brightness Adjustment:

Use this option to adjust picture brightness

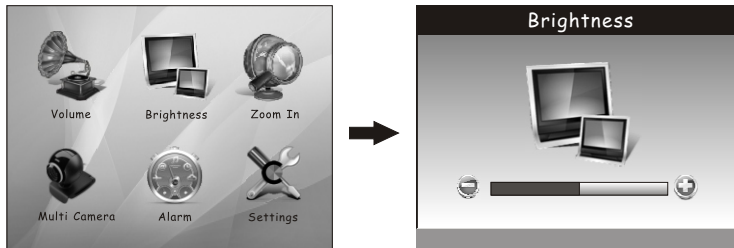

- Press "OK/MENU" button to display Main Menu.
- Use "UP" or "DOWN" button to highlight "Brightness" Option and press "OK/MENU" button to complete the selection.
- Use "UP" or "DOWN" button to adjust the "Brightness" and press "OK/MENU" button to complete the selection.
- Press "ESC" button to exit from the Menu.

## 5.4 Zoom In Function:

Use this option to zoom in on five pre-defined areas of the monitor screen

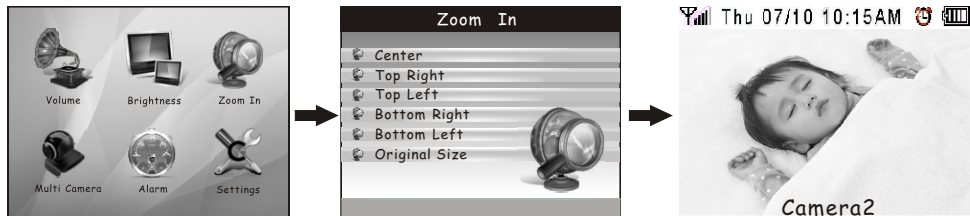

- Press "OK/MENU" button to display Main Menu.
- Use "UP" or "DOWN" button to highlight "Zoom In" Option and press "OK/MENU" button to complete the selection.
- Use "UP" or "DOWN" button to select the area you want to Zoom In on and press "OK/MENU" button to complete the selection.
- The selected position will be displayed magnified 2X.

To display picture in it's original size:

- Press "OK/MENU" button to display Main Menu.
- Use "UP" or "DOWN" button to highlight "Zoom In" Option and press "OK/MENU" button to complete the selection.
- Highlight "Original Size" option and press "OK/MENU" button to complete the selection.
- Press "ESC" button to exit from the Menu.

## 5. 5 Multi Camera(Manual Camera Selection):

If you have more than one camera already registered/paired with the monitor, use this option to setup default camera to view when monitor is turned on. **NOTE: Up and Down Buttons on the Monitor can also be used to manually select a camera to view. "Camera Selection" function is assigned to these keys using "Up & Down Buttons Function" under "Settings" in the Main Menu (see section 5.12 for details).**

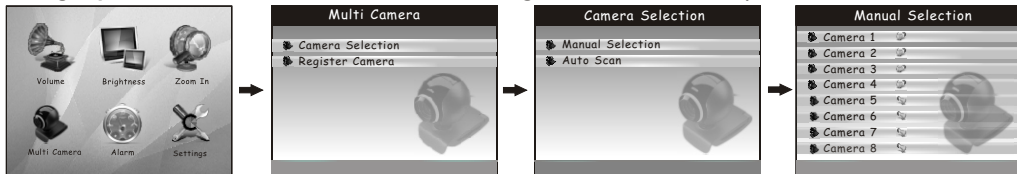

- Press "OK/MENU" button to display Main Menu.
- Use "UP" or "DOWN" button to highlight "Multi Camera" Option and press "OK/MENU" button to complete the selection.
- From "Multi Camera" Menu highlight "Camera Selection" using "UP" or "DOWN" button and press "OK/MENU" button to complete the selection
- From "Camera Selection" Menu highlight "Manual Selection" using "UP" or "DOWN" button and press "OK/MENU" button to complete the selection.
- From "Manual Selection" Menu highlight the camera you want to view and press "OK/MENU" button to complete the selection.

**NOTE:** You can only view cameras that are already registered - Registered cameras have "Thumbs up" sign next to the camera number.

- Press "ESC" button twice to exit from the Menus and view the selected camera.

## 5. 6 Multi Camera(Auto Scan):

If you have more than one camera already registered/paired with the monitor, use this option to setup auto scan mode.

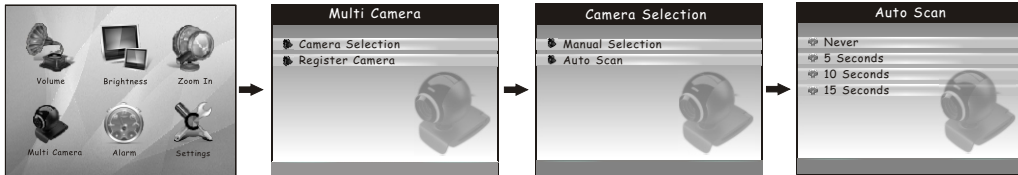

- Press "OK/MENU" button to display Main Menu.
- Use "UP" or "DOWN" button to highlight "Multi Camera" Option and press "OK/MENU" button to complete the selection.
- From "Multi Camera" Menu highlight "Camera Selection" Using "UP" or "DOWN" button and press "OK/MENU" button to complete the selection
- From "Camera Selection" Menu highlight "Auto Scan" using "UP" or "DOWN" button and press "OK/MENU" button to complete the selection.
- From Auto Scan Menu highlight the Duration you will like to view each registered/ Paired camera and press "OK/MENU" button to complete the selection.

**NOTE:** Select "Never" to disable Auto Scan.

- Press "ESC" button twice to exit from the Menus and view the cameras.

## 5.7 Multi Camera(Register/Pair a Camera):

Use this option to register/pair an existing or an additional camera.

**IMPORTANT:** Make sure the camera you are trying to register is powered ON and all other cameras are powered OFF during pairing process.

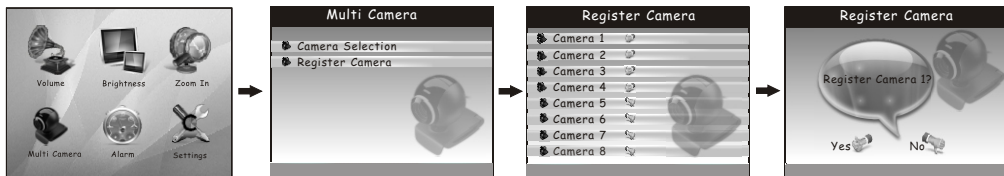

- Press "OK/MENU" button to display Main Menu.
- Use "UP" or "DOWN" button to highlight "Multi Camera" Option and press "OK/MENU" button to complete the selection.
- From "Multi Camera" Menu highlight "Register Camera" using "UP" or "DOWN" button and press "OK/MENU" button to complete the selection.
- From "Register Camera" Menu highlight the camera number you want to use to register this camera and press "OK/MENU" button to complete the selection.

**NOTE:** Camera numbers already allocated (used to register existing cameras) have "thumbs up" sign next to the camera number. To assign this number to another camera, you must first unregister the old camera.

- Use "UP" or "DOWN" button to select "Yes" and press "OK/MENU" button to complete the selection; the screen will display "register camera #" where # is the camera number you selected.
- **Press and quickly release** the ON/OFF button on the **CAMERA** to complete pairing process - *IMPORTANT: Camera must be powered ON and this step must be completed while the monitor screen displays "register camera #"*.
- If pairing is successful, the screen will display "Camera #Registered", where # is the camera number you selected in previous step. "Thumbs up" sign will appear next to the camera #.

**NOTE:** If the pairing/registration process is not successful, repeat this process again.

- Press "ESC" button twice to exit from the Menus and view the camera.

**NOTE:** Follow the same process to remove/unregister a camera - When a registered camera is selected from "Register Camera" Menu list the screen will prompt you to select "Yes" to complete unregister camera or "NO" to cancel operation.

## 5. 8 Alarm Function :

Use this option to setup feeding or other reminder alarms(5 different alarms can be set).

**NOTE:** If an alarm is not disabled it will repeat every 24 hours. See next section to setup date and time.

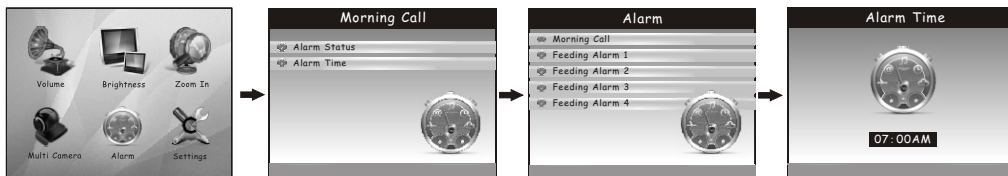

- Press "OK/MENU" button to display Main Menu.
- Use "UP" or "DOWN" button to highlight "Alarm" Option and press "OK/MENU" button to complete the selection.
- From "Alarm" Menu select any one of the five (5) alarms using "UP" or "DOWN" button and press "OK/MENU" button to complete the selection if, for example, you picked "Morning Call" from the Alarm menu the "Morning Call" sub-menu will be displayed.
- From "Morning Call" Menu highlight:
  1. "Alarm Status" to turn this alarm ON or OFF. Use "UP" or "DOWN" button to select "Alarm on" or "Alarm off" and press "OK/MENU" button to confirm the selection.
  2. "Alarm Time" to setup alarm time. Use "UP" or "DOWN" button to change hours and minutes and confirm each entry by pressing "OK/MENU" button.

**Note** : time is entered in either 24-hour or 12-hour time format, depending on the time format selected using "Setting" option from the Main Menu(see section 5. 9 for details).

- Press "ESC" button to exit to the previous menu.
- Other alarms are setup by repeating these steps.



## 5. 9 Settings(Date and Time):

Use this option to setup Date and Time and the Time Format.

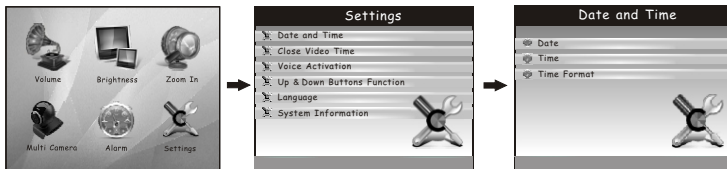

- Press "OK/MENU" button to display Main Menu.
- Use "UP" or "DOWN" button to highlight "Settings" Option and press "OK/MENU" button to complete the selection.
- From "Settings" Menu select "Date and Time" option using "UP" or "DOWN" button and press "OK/MENU" button to complete the selection. Pick one of the following option from "Settings" Menu:
  1. **Date:** Use "UP" or "DOWN" button to change Year, Month and day and confirm each entry by press "OK/MENU" button .
  2. **Time:** Use "UP" or "DOWN" button to change Hour and Minute and confirm each entry by pressing "OK/MENU" button. **NOTE:** Time is entered in either 24-hour or 12-hour time format, depending on the time format selected in the next step.
  3. **Time Format:** to setup time format use "UP" or "DOWN" button to select "12 hours" or "24 hours" and press "OK/MENU" button to confirm the selection.
- Press "ESC" button to exit to the previous menu.

## 5. 10 Settings (Close Video Time):

Use this option to setup Power Save or Audio Only mode.

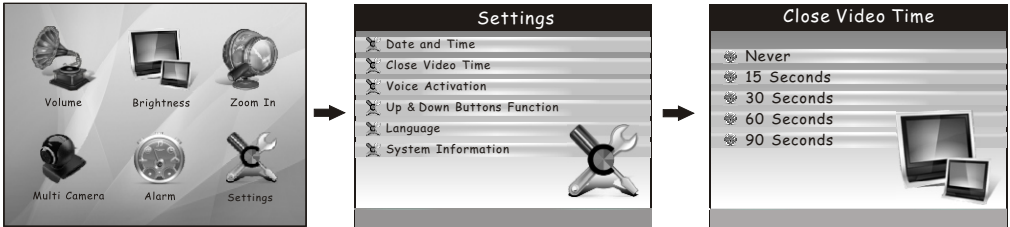

- Press "OK/MENU" button to display Main Menu.
- Use "UP" or "DOWN" button to highlight "Settings" Option and press "OK/MENU" button to complete the selection.
- From "Settings" Menu select "Close Video Time" option using "UP" or "DOWN" button and press "OK/MENU" button to complete the selection
- From "Close Video Time" Menu select sleep time of 15, 30, 60 or 90 seconds (time after which monitor will turn-off and go into power-save mode, if there is no sound detected).

**IMPORTANT NOTE:** Select "Never" to disable power-save mode.

- Press ESC" button to exit to the previous menu.

Also see next section to setup Audio & Video Sensitivity Levels to have the monitor switch between Audio Only and Audio & Video Modes.

## 5. 11 Settings(Voice Activation):

Use this option to setup voice activation sensitivity settings that determine when monitor switches from Audio Only to Audio & Video mode.

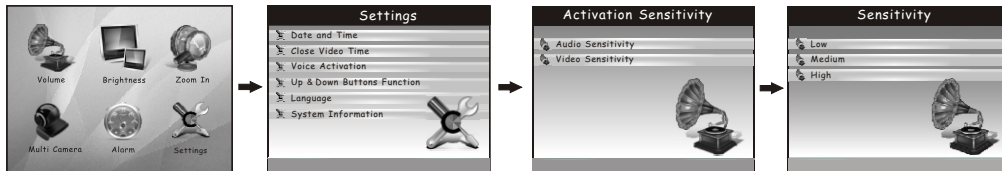

- Press "OK/MENU" button to display Main Menu.
- Use "UP" or "DOWN" button to highlight "Settings" option and press "OK/MENU" button to complete the selection.
- From "Settings" Menu Select "Activation Sensitivity" option using "UP" or "DOWN" button, and press "OK/MENU" button to complete the selection.
- From "Activation Sensitivity" Menu select one of the following:
  - Audio Sensitivity: Select Low, Medium or High sensitivity level using "UP" or "DOWN" button and confirming the selection by pressing "OK/MENU" button.
  - Video Sensitivity: Select Low, Medium or High sensitivity level using "UP" or "DOWN" button and confirming the selection by pressing "OK/MENU" button.

**NOTE:** In order for the Audio Only function to work, make sure that one of the time-interval is selected using "Close Video Time" option in section 5. 10.

## **AUDIO ONLY MODE & EXPLANATION OF AUDIO & VIDEO SENSITIVITY LEVELS:**

To enable Audio Only mode set “Close Video Time” to time interval other than “Never” (see Section 5.10). Switching of monitor from Audio Only to Audio and Video mode depends on the Audio & Video Sensitivity settings.

- **Audio Sensitivity level** determines at what sound level camera sends sound alert to the monitor i.e. Notifying monitor that sound is detected (the low pop sound from the monitor speaker means monitor received the sound alert that sound was detected by the active camera) - High audio sensitivity level means even slightest sound will cause camera to send the alert and Low audio sensitivity level means camera will ignore low level sounds and won't send sound alerts to the monitor.
- **Video sensitivity level** determines at what sound level should the monitor switch from Audio Only (Power Save) mode to Audio/Video mode (display picture) - High Video sensitivity means any sound alert signal received from the camera will cause the monitor to switch to Audio & Video mode (display picture) and Low video sensitivity setting will make monitor to ignore any low sound level alerts and stay in Audio Only mode.

## 5. 12 Settings(Up & Down Buttons Function):

Use this option to assign Volume Control or Camera Selection function to the Up & Down buttons on the monitor

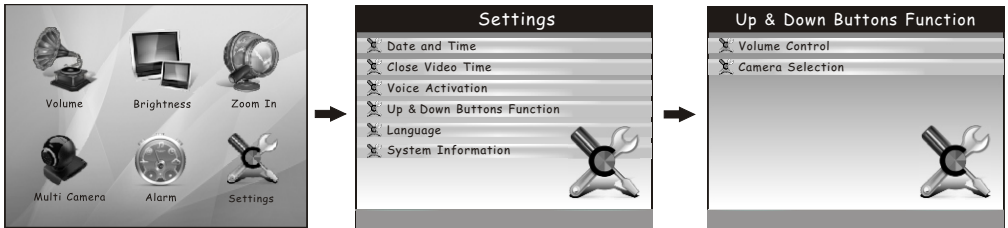

- Press "OK/MENU" button to display Main Menu.
- Use "UP" or "DOWN" button to highlight "Settings" option and press "OK/MENU" button to complete the selection.
- From "Settings" Menu select "Up & Down Buttons Function" option using "UP" or "DOWN" button, and press "OK/MENU" button to complete the selection.
- From "Up & Down Buttons Function" Menu select "Volume Control" or "Camera Selection" using "UP" or "DOWN" button and complete selection using "OK/MENU" button.
- Press "ESC" button to exit to the previous menu.

## 5. 13 Settings(Language):

Use this option to setup ON Screen Menu Display (OSD) Language.

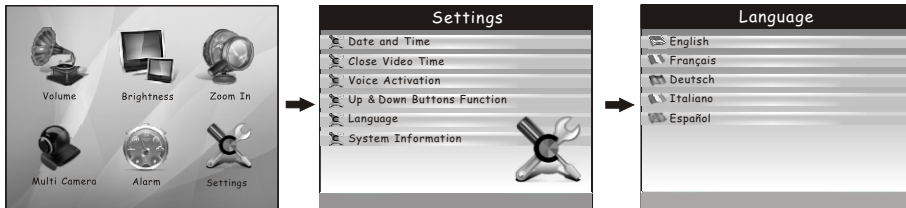

- Press "OK/MENU" button to display Main Menu.
- Use "UP" or "DOWN" button to highlight "Settings" option and press "OK/MENU" button to complete the selection.
- From "Settings" Menu select "Language" option using "UP" or "DOWN" button, and press "OK/MENU" button to complete the selection.
- From "Language" Menu select English, French, Deutsch, Italian or Spanish using "UP" or "DOWN" button and complete selection using "OK/MENU" button.
- Press "ESC" button to exit to the previous menu.

## 5. 14 Settings(System Information):

Use this option to view the firmware version of your baby monitor

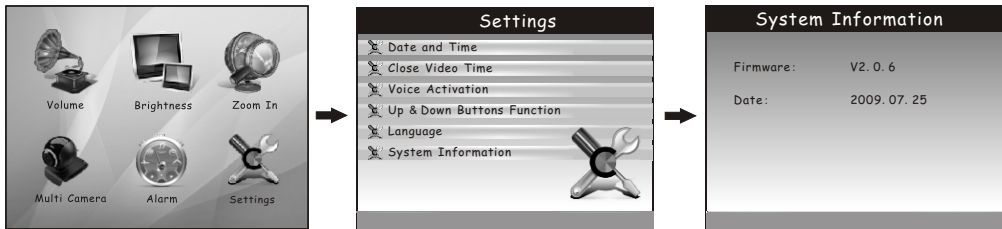

- Press "OK/MENU" button to display Main Menu.
- Use "UP" or "DOWN" button to highlight "Settings" option and press "OK/MENU" button to complete the selection.
- From "Settings" Menu select "System Information" option using "UP" or "DOWN" button, and press "OK/MENU" button to complete the selection.
- Press "ESC" button to exit to the previous menu.

## Limited 1 Year Warranty

**Coverage:** Hi-Tech Trading (USA), Inc. ("HiTT") warrants this product ("Product") against defects in materials and workmanship under normal consumer use for 1 year from the date of purchase. HiTT, at its option, will at no charge repair, replace or refund the purchase price of this Product should it not conform to this warranty. This limited warranty is a consumer's exclusive remedy, extends only to the first consumer purchaser, is not transferable and is valid only on Products purchased by consumers in the United States or Canada.

### **Exclusions:**

**Normal Wear and Tear:** Periodic maintenance, repair and replacement of parts due to normal wear and tear are excluded from coverage.

**Batteries:** Only batteries whose fully charged capacity falls below 80% of their rated capacity and batteries that leak are covered by this limited warranty.

**Miscellaneous:** This warranty does NOT cover defects or damage that result from: (a) improper operation, storage, misuse or abuse, accident or neglect, such as physical damage (cracks, scratches, etc.) To the surface of the Product resulting from misuse; (b) contact with liquid, water, rain, extreme humidity or heavy perspiration, sand, dirt or the bike, extreme heat, or food; (c) use of the Product for commercial purposes or subjecting the Product to abnormal usage or conditions; (d) service, installation, alteration, or modification in any way by someone other than HiTT and, (e) other acts which are not the fault of HiTT.

**Obtaining Service:** To obtain service or information, please send email to [help@hittusa.com](mailto:help@hittusa.com). You will receive instructions on how to ship the Product, at your expense, to a HiTT Service Center. To obtain service, you must include a copy of your receipt. Copy of receipt is not required if you registered this product on our website [www.hittusa.com](http://www.hittusa.com) within 30 days of purchase date.



ZOpid and the stylized logo are registered in the US Patent & Trademark Office. All other product or service names are the property of their respective owners.

**©2009 Hi-Tech Trading(USA),Inc.**

The information contained in this User Manual is believed to be correct at the time of printing. HiTT reserves the right to change or modify any information or specifications without notice. The contents of this User Manual are provided "as is." Except as required by applicable law, no warranties of any kind, either express or implied, including, but not limited to, the implied warranties of merchantability and fitness for a particular purpose, are made in relation to the accuracy, reliability, or contents of this guide.

**Hi-Tech Trading (USA),Inc.**

**P. O. Box 179**

**Woodbury, New York 11797**

**Email: [help@hittusa.com](mailto:help@hittusa.com)**

**Web: [www.hittusa.com](http://www.hittusa.com)**