



HEARTH PRODUCTS

HEARTH PRODUCTS
KITS AND ACCESSORIES

P/N 506033-33
Rev. NC, 03/2010

FACEPLATE KITS

INSTALLATION INSTRUCTIONS FOR INSTALLING FACEPLATE KITS FOR USE WITH MODELS S160, SS210, ST210, S260, ST310, C160, C210, C260, E260 AND C310 WOOD STOVES AND WOOD FIREPLACE INSERTS



KIT CONTENTS

- 1 ea. Arch or Traditional Faceplate (item #4)
- 1 ea. Spring Handle (item #5)
- 1 ea. Tube Of Anti-seize (item #6)
- 2 ea. #6 x 1" Carriage Bolt (item #1)
- 2 ea. #6 Nut (item #2)
- 1 ea. Lennox Nameplate - Gold (item #3)
- 1 ea. Country Nameplate - Gold (item #3)
- 1 ea. Instruction Sheet

TOOLS NEEDED

- 5/32" Allen Wrench or T-Handle Wrench
- Open End Wrench - 5/16"

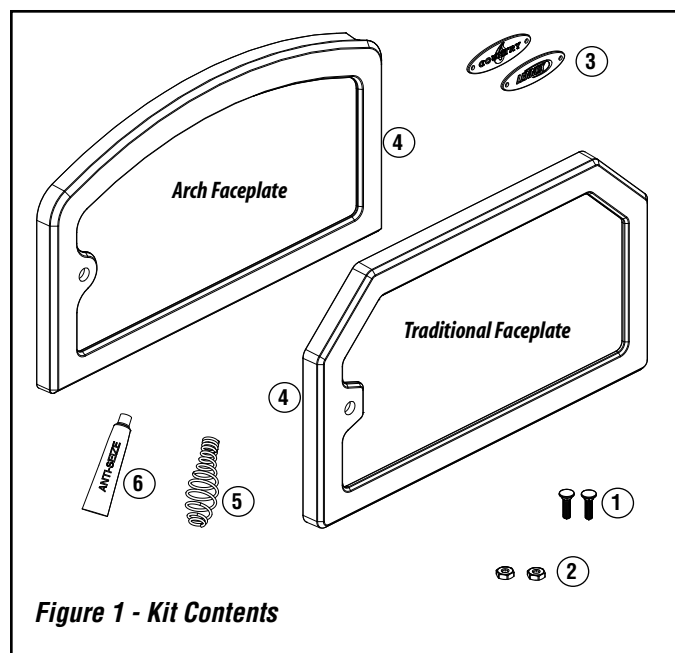

Faceplate Kit (Includes Faceplate, Handle and Nameplate) For Models: C260, E260, C310, S260 and ST310

Cat. No.	Model	Description
H7903	TRAD-FPK-BG-LG	Traditional Faceplate Kit, Brushed Gold
H7906	TRAD-FPK-G-LG	Traditional Faceplate Kit, Gold

GENERAL INFORMATION

These decorative faceplate kits are offered in various attractive finishes to accentuate the look of your wood stove or wood fireplace insert.

Take great care when handling the faceplates to prevent scratching.

If you encounter any problems, need clarification of these instructions or are not qualified to properly install this kit, contact your local distributor or dealer.

Read this instruction sheet in its entirety before beginning the installation.

ALL WARNINGS AND PRECAUTIONS IN THE INSTALLATION AND OPERATION MANUAL PROVIDED WITH THE APPLIANCE APPLY TO THESE INSTRUCTIONS.

ALLOW THE STOVE OR INSERT TO COMPLETELY COOL BEFORE PROCEEDING.



IMPORTANT

Be sure to clean plated surfaces with a soft cloth and household glass cleaner prior to burning the stove or insert. Fingerprints left on the plated surfaces while burning may remain on the finish permanently.

Faceplate Kits (Includes Faceplate, Handle and Nameplate) For Models: C160, C210, S160, ST210 and SS210

Cat. No.	Model	Description
H7901	ARCH-FPK-BG	Arch Faceplate/Brushed Gold
H7902	TRAD-FPK-BG-SM	Traditional Faceplate/Brushed Gold
H7904	ARCH-FPK-G	Arch Faceplate/Gold
H7905	TRAD-FPK-G-SM	Traditional Faceplate/Gold

NOTE: DIAGRAMS AND ILLUSTRATIONS ARE NOT TO SCALE.

INSTALLATION INSTRUCTIONS

Step 1. Remove Spring Handle - Twist spring handle clockwise and pull down at the same time to remove from handle rod (see **Figures 2 and 3**).

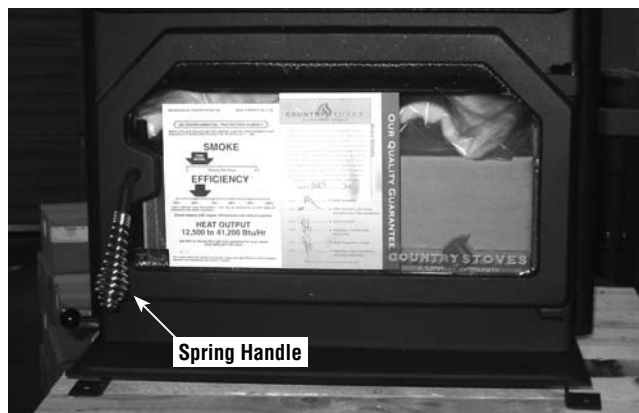

Figure 2



Figure 3

Step 2. Remove Faceplate Screws and Washers - Partially peel back the door gasket, to expose the six screws and washers (see **Figure 4**). **Note:** Peel the gasket back just enough to get your 5/32" allen wrench on the screws (see **Figure 5**). It is very important not to pull the gasket all the way off the door. If the gasket becomes hard to pull, you have gone too far. Fragile care should be taken when working around the door rope junction.

IMPORTANT NOTE: Be sure not to over tighten the screws. If the screws are over tightened the glass may crack when the stove is hot.

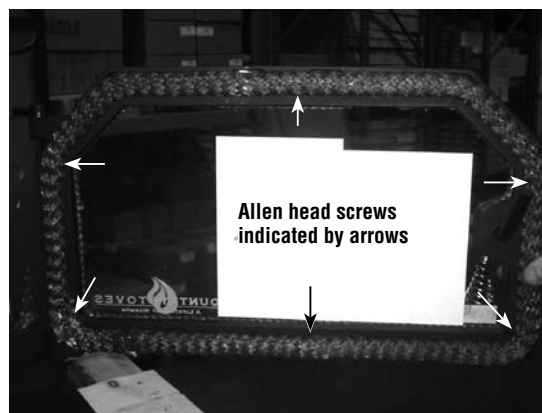

Figure 4

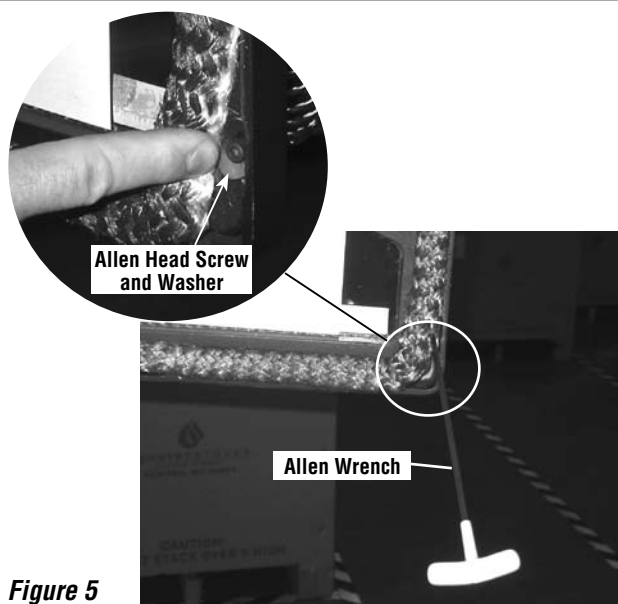

Figure 5

Step 3. Remove Faceplate - Be advised that the faceplate also functions as a glass retainer (see **Figure 6**). **Make sure to apply inward pressure on the glass while removing the faceplate. IMPORTANT, PRESS THE GLASS INWARD TO ENSURE THE GLASS STAYS IN THE GROOVE AND DOES NOT FALL OUT AND BREAK.**



Figure 6

Step 4. Install New Faceplate - Slide the faceplate over the handle rod while the handle rod is at a 90° position (see **Figures 7 and 8**). Move the handle rod up and down and slightly in and out when sliding the faceplate onto the handle rod.
IMPORTANT, ALWAYS PRESS INWARD ON THE GLASS WHILE THE FACEPLATE IS NOT RETAINING THE GLASS, OTHERWISE THE GLASS MAY FALL OUT AND BREAK.



Figure 7



Figure 8

Step 5. Reinstall The Six Screws and Washers - Apply the anti-seize provided before reinstalling the screws. The anti-seize is applied to the screws for ease of the removal of the screws if removal is needed in the future. Ensure that the widest side of the washers is in the direction of the glass as shown in **Figure 9**. Do not tighten screws completely at this time. The door will have up and down play. Place a level on top of the door to level the faceplate. Once the faceplate is level, tighten the six screws. The washers should have a slight bow once they are tightened.

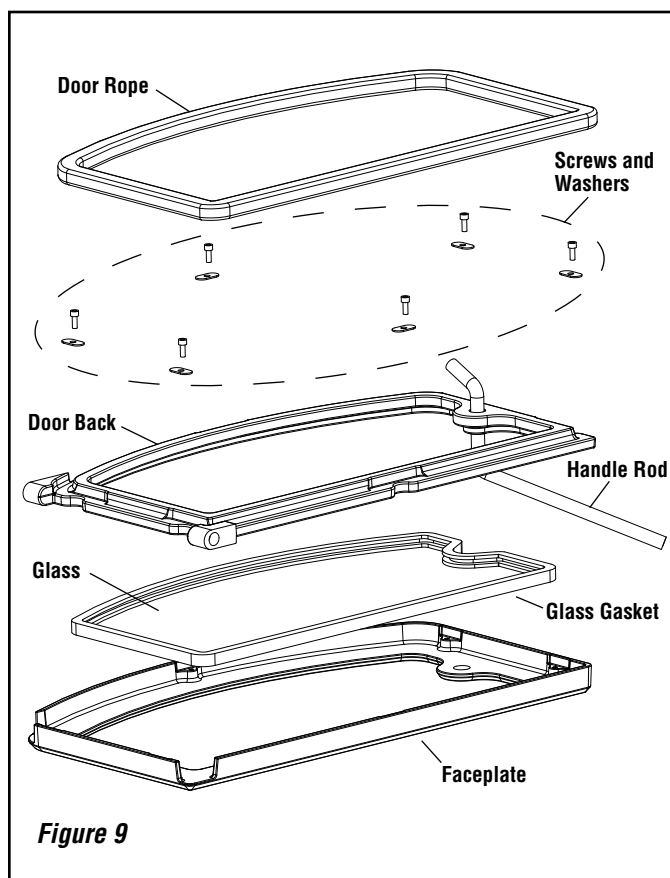

Figure 9

Step 6. Reinstall Spring Handle - Slide the spring handle over the handle rod by pushing up and turning the spring handle clockwise (see **Figure 10**). Make sure to leave a 1/2 inch gap between the end of the handle rod and the bottom of the spring handle. This will also allow for a 1/2 inch of play side to side. **Installing the spring handle too far, where there is no side to side play, will result in the spring handle becoming VERY HOT to the touch.**

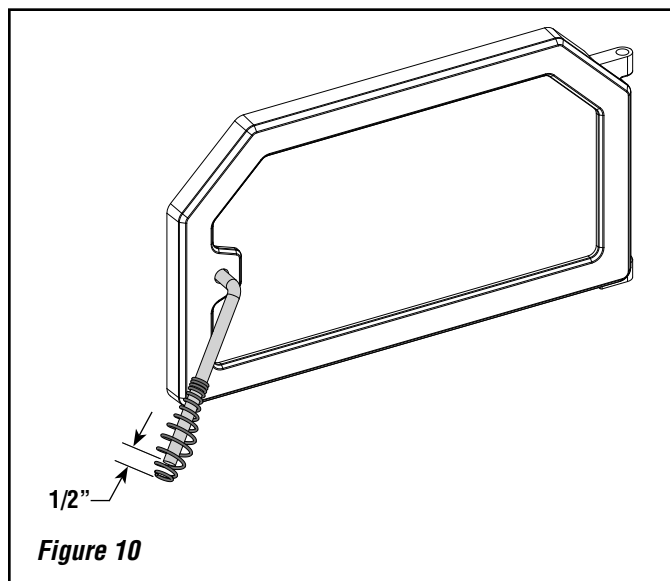

Figure 10

NAMEPLATE OPTIONS

This instruction sheet explains how to install a nameplate onto a wood-burning stove or insert. Your new Country Collection™ wood-burning appliance includes a nickel Country nameplate in the manual packet and a nickel Lennox™ nameplate installed on the appliance.

REPLACEMENT KIT CONTENTS (See Figure 12)

The contents below ship separately with Cat. # H8079 and H8080

- 1 ea. Instruction Sheet
- 2 ea. #6 x 1" Carriage Bolt (item #1)
- 2 ea. #6 Nut (item #2)
- 1 ea. Nameplate - Lennox (Gold or Nickel, item #3)
- 1 ea. Nameplate - Country (Gold or Nickel, item #3)

Cat. #	Description
H8079	Nameplate Kit with Hardware - Nickel
H8080	Nameplate Kit with Hardware - Gold

TOOLS NEEDED

Open End Wrench - 5/16"

INSTALLATION INSTRUCTIONS

Step 7. Align nameplate on the center of the smoke hood.

Step 8. Insert carriage bolts through nameplate and smoke hood.

Step 9. Open the firebox door to allow access to the underside of the smoke hood and secure the carriage bolts using the #6 nuts.

REMOVAL INSTRUCTIONS

Remove the nameplate in the reverse order of installation.

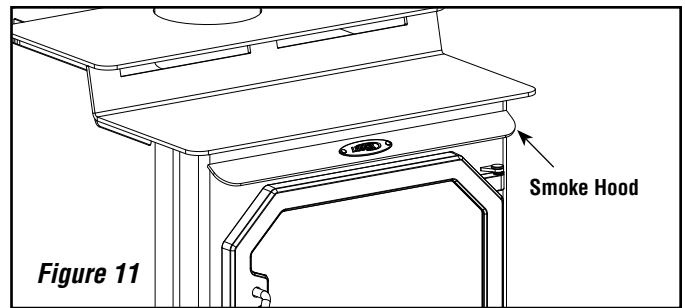

Figure 11

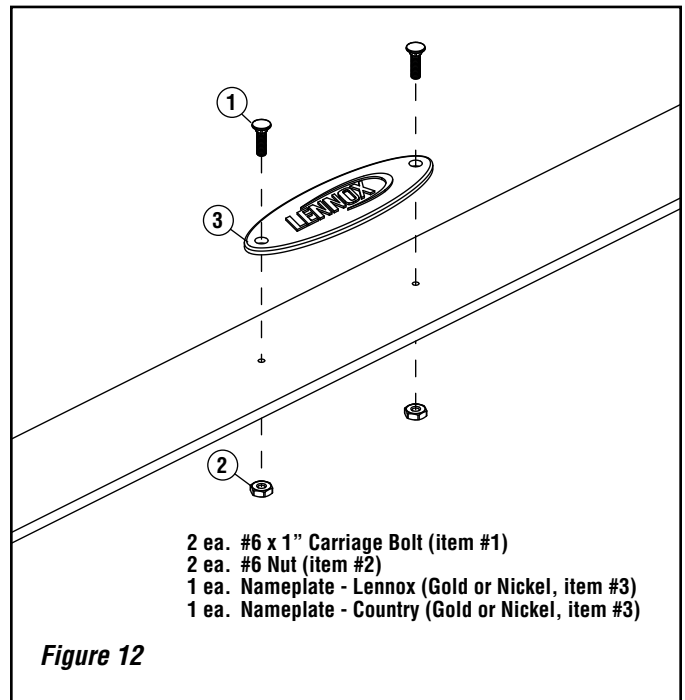

Figure 12

NOTE: DIAGRAMS & ILLUSTRATIONS ARE NOT TO SCALE.

Lennox Hearth Products reserves the right to make changes at any time, without notice, in design, materials, specifications, prices and also to discontinue colors, styles and products. Consult your local distributor for fireplace code information.

LENNOX
HEARTH PRODUCTS