



MHTL-MAGNT8 INSTALLATION INSTRUCTION

Rev. Date 9/1/2013

WARNING – Risk of fire or electric shock. When drilling, check for enclosed wiring and other pre-existing components.

Drilling to install the LED retrofit kit may damage wiring and other electrical components.

WARNING – Risk of fire or electric shock. Installation of the LED Retrofit Kit requires knowledge of electrical systems.

If not qualified, do not attempt installation and contact a qualified electrician.

WARNING – Risk of fire or electric shock. Install this kit only in luminaires that have the construction features and dimensions shown in the photographs and/or drawings.

WARNING – Risk of fire or electric shock. To prevent wiring damage or abrasion, do not expose wiring to the edges of sheet metal or sharp objects.

Only those holes indicated in the photographs and/or drawings may be made or altered as a result of kit installation. Do not leave any other open holes in an enclosure of wiring or electrical components.

MHTL-MAGNT8-2FT - Suitable for field installation in any recessed linear fluorescent luminaire with nominal overall dimensions of 22-3/4 in (577 mm) long by 22-1/4 in (565 mm) wide tapering to 16-1/4 in (414 mm) wide by 2-7/8 in (73 mm) deep; or with a minimum equivalent volume

MHTL-MAGNT8-4FT - Suitable for field installation in any recessed linear fluorescent luminaire with nominal overall dimensions of 47-1/2 in (1207 mm) long by 10-1/4 in (27 mm) wide tapering to 5 in (127 mm) wide by 4-1/4 in (108 mm) deep; or with a minimum equivalent volume.



MHTL-MAGNT8 INSTALLATION INSTRUCTION

Rev. Date 9/1/2013

1. Main Data:

Model	Input Voltage (Vac)	Input Power (W)	Max. Input Current (A)	LED Driver Model	Power Factor	Driver Output Current (A)
MHTL-MAGNT8-2FT	120~277Vac 50/60Hz	2x12W	0.46	LUC-042D056DSM(SSM)	≥0.95	560mA
MHTL-MAGNT8-2FT		3x12W	0.80	LUC-066T056DSM(SSM)		560mA
MHTL-MAGNT8-2FT		2x17W	0.46	LUC-042D070DSM(SSM)		700mA
MHTL-MAGNT8-2FT		3x17W	0.80	LUC-066T070DSM(SSM)		700mA
MHTL-MAGNT8-4FT		2x18W	0.46	LUC-042D070DSM(SSM)		700mA
MHTL-MAGNT8-4FT		3x18W	0.80	LUC-066T070DSM(SSM)		700mA
MHTL-MAGNT8-4FT		2x21W	0.46	LUC-042D070DSM(SSM)		700mA

2. Wiring Diagrams:

MHT-MAGNT8 Series Wiring Diagram

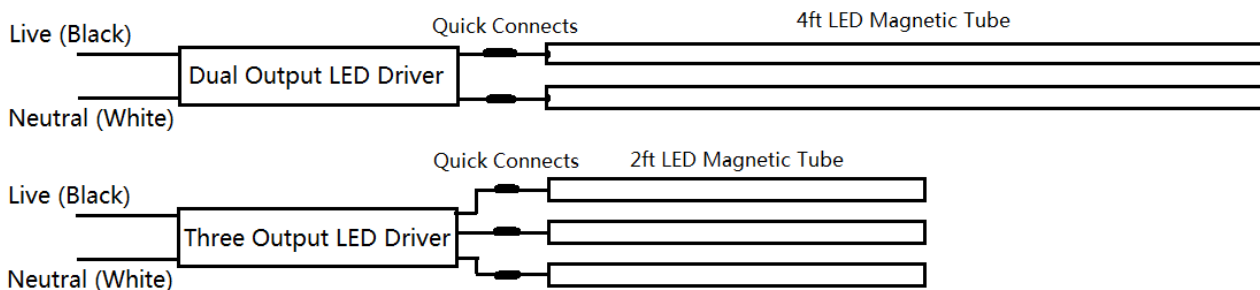

3. Installation and Maintenance Instruction:

- 3.1. This product is to be installed and serviced by a certified electrician.
- 3.2. The Luminaire should be installed in an area with good ventilation, clear of any corrosive or combustible gases and explosive objects.
- 3.3. A supply voltage tolerance of +/- 10% is allowable. An improper installation outside of this range or with the incorrect input voltage will influence the normal operation of this luminaire and result in damage to the lamp and electronic ballast.
- 3.4. The luminaire must be properly grounded to prevent accidental electrical shocks, and to prevent interference from the electrical ballast affecting the normal operation of the luminaire.
- 3.5. Do not open the housing with the luminaire powered on.

4. Replacement Kit Parts List:

For 4ft Replacement Kit:

- (2x/3x) 4ft Magnetic LED Tubes
- (1x) Dual/Three Output LED Driver
- (4x) Self Drilling Screws

For 2ft Replacement Kit:

- (2x/3x) 2ft Magnetic LED Tubes
- (1x) Dual/Three Output LED Driver
- (4x) Self Drilling Screws

4. Required Tools:

- Electric Drill with #2 Phillips Bit
- Wire Cutter
- Wire Stripper



5. Installation Procedures:



1
Unhook the lens latch and open the lens. Remove the existing T5/T8/T12 fluorescent



Shut OFF the
Circuit Breaker
before starting.



3
Remove the mid panel of the fixture by
pinching it toward the center.

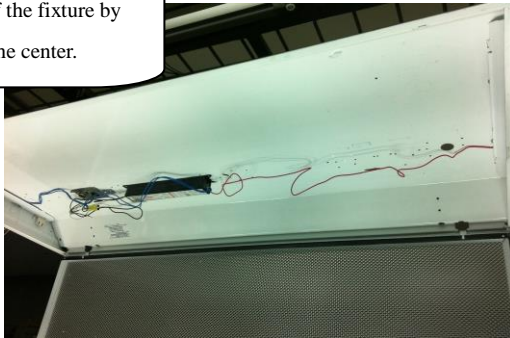

4
Disconnect the input quick connectors and cut all wiring not being used.

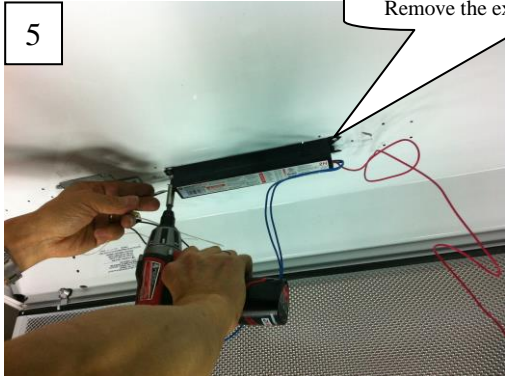
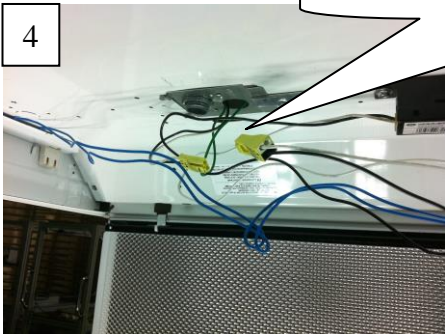

5
Remove the existing fluorescent ballast.





MHTL-MAGNT8 INSTALLATION INSTRUCTION

Rev. Date 9/1/2013

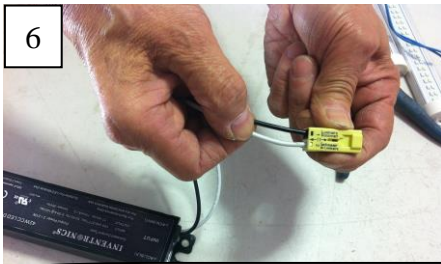

6 Attach quick connectors to the inputs from the new LED Driver and secure it to the fixture with the original screws.

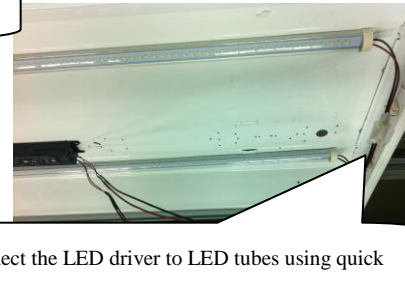
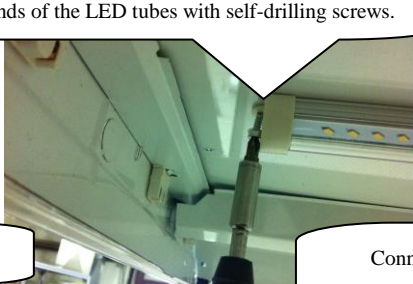
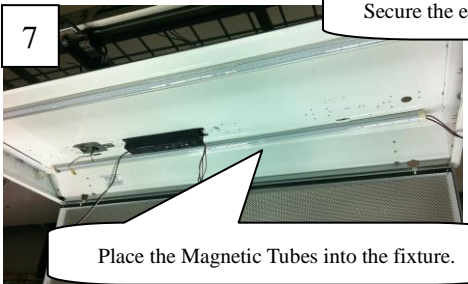

7 Secure the ends of the LED tubes with self-drilling screws.
Place the Magnetic Tubes into the fixture.
Connect the LED driver to LED tubes using quick connectors.

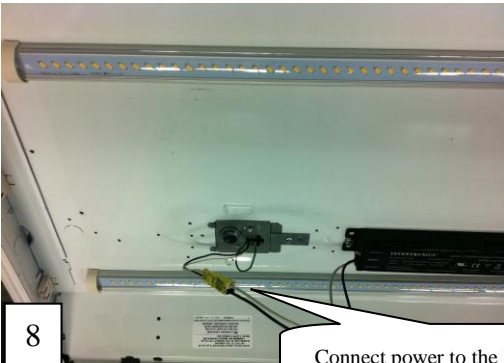

8 Connect power to the LED driver.

Replace the mid panel back.

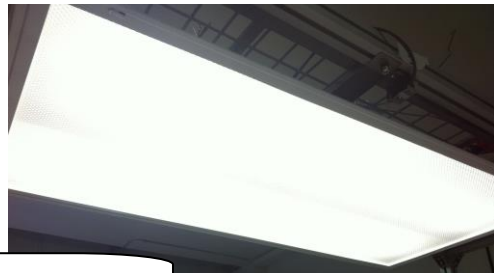

9 Close lens, turn on circuit breaker and energize the fixture.