

# KidsGuard<sup>®</sup> 2



Alarm for  
above  
ground pools



▶ N° Indigo 0 820 366 150

0,118 € TTC / MN

- Automatic surveillance restart 15 minutes after bathing
- Ongoing information on monitoring status



**INSTALLATION INSTRUCTIONS - USER MANUAL**



## IMPORTANT

Dear Sir, Madam,

You have just purchased an immersion detector designed and manufactured to provide warning of a child of 8 kg or more falling into an above ground swimming pool placed on the ground.

The KidsGuard 2® alarm does not comply with standard NFP 90 307/A1.

If you wish to secure an in-ground or on-ground swimming pool in accordance with legal requirements, ACIS can offer other alarms in its range (VisoPool®, KidsGuard 2®, SSM 1.0 and RPT 1.0 alarm transfer) which comply with standard NFP 90 307/A1. Contact your local retailer or call: 0 820 366 150 (€0.118, incl. VAT/min) for more information on these products.

The KidsGuard 2® system cannot replace common sense and individual responsibility.

The safety of your children depends entirely on you!

Risk is highest for children aged under 5.

Accidents do not only happen to someone else! Be prepared!

Under no circumstances may ACIS be held liable for the fall or drowning of any person or animal.

Use of the KidsGuard 2® alarm cannot replace your attention and active supervision of the swimming pool and nearby areas.

Warranty: To benefit from the full KidsGuard 2® warranty, you must complete and sign the warranty form supplied and return this form to ACIS, ZA de la Fénicrière, 85300 SALLERTAINE (France) within 8 days, via registered post (registered letter with acknowledgement of receipt, recorded delivery).

The KidsGuard 2® alarm warranty will only take effect from receipt of the duly filled out warranty certificate.

No warranty will apply until these documents are received.

Read all alarm documents carefully and keep for future reference.

# Table of contents

Important .....	2
<b>Initial checks</b> .....	5
Check the packaging and components .....	5
Pre-commissioning check .....	6
Selecting a location .....	8
Installing .....	8
<b>Operating test in the pool</b> .....	7
Fuel cell blister pack .....	10
<b>Use</b> .....	11
Complete stop .....	12
Warnings .....	12
Additional information .....	13
Information on the KidsGuard 2® alarm .....	13
<b>Safety advice</b> .....	14
<b>Monthly tests</b> .....	16
Warranty.....	17
Warranty exclusions .....	17
After-sales service & returns .....	18
Limits of liability .....	18
Compliance statement .....	19
Practical information .....	19

# Presentation

Detection system for a body falling into or immersed in an above ground swimming pool placed on the ground; maximum pool dimensions 12 x 5 m (scope: 7 metres).

We recommend you equip larger pools with additional protection. KidsGuard 2<sup>®</sup> analyses water movements in your swimming pool and can differentiate between insignificant waves (waterfall, filtration, rain, wind) and those emitted by a falling body. The trigger time depends on the distance between the detection control unit and the point of immersion.

Important! The installation and use of the alarm system cannot replace your attention. The KidsGuard 2<sup>®</sup> alarm complements human supervision for the surveillance of swimming pools.

The unit cannot replace supervision by adults.

Keep a close eye on your children!

# Limits of use

- You can use the KidsGuard 2<sup>®</sup> alarm if the distance between the swimming pool and the house or accommodation allows for emergency intervention (including rescue from the pool) in less than 3 minutes.

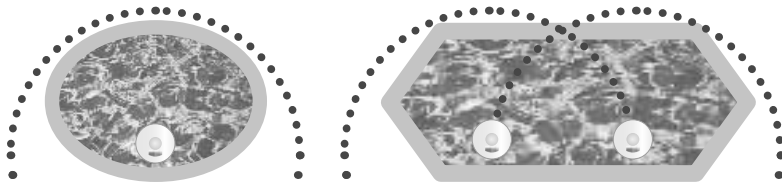

For information, standard NFP 90-307/A1 on alarms for in-ground or on-ground swimming pools requires the detection of any fall within 12 seconds.

We recommend that you place the KidsGuard 2<sup>®</sup> alarm less than 7 metres from any location associated with a risk of falls.

For larger swimming pools, you may need to install one or several additional KidsGuard 2<sup>®</sup> alarms.

- Safety, warning and failure signals must be heard from the house or accommodation. This must be checked during the installation.

- Pool shape and equipment: Only on-site testing can determine whether or not the KidsGuard 2® alarm is compatible with your equipment for large swimming pools (close to 12 x 5 metres).

Important: Some swimming pool equipment may not be compatible with the correct operation of the KidsGuard 2® alarm (cover, tarpaulin, cleaning rover, etc.).

- The KidsGuard 2® alarm does not comply with standard NFP 90 307/A1 and does not enable compliance with legal requirements for in-ground and on-ground swimming pools.

- The KidsGuard 2® alarm is not compatible with mirror swimming pools, pools with sloped access or pools equipped with a high flow filter system (similar to counter-flow swimming systems). The use of a bubble cover can prevent the operation of the KidsGuard 2® alarm.

- In surveillance mode, the KidsGuard 2® alarm adapts sensitivity to the level of movement in the pool. In case of strong wind, storms or bad weather, sensitivity may be reduced. Be particularly attentive in case of strong wind, gusts or bad weather, which could modify the sensitivity of your KidsGuard 2® alarm.

## Check the packaging and components

Despite the great care which we take to ensure the quality of our products and their packaging, please check the content and condition of your KidsGuard 2® alarm.

The pack contains:

A - One ready-to-use KidsGuard 2® alarm

B - Two control magnets

R - Installation instructions and a user manual,

S - A warranty form to be returned to our services.

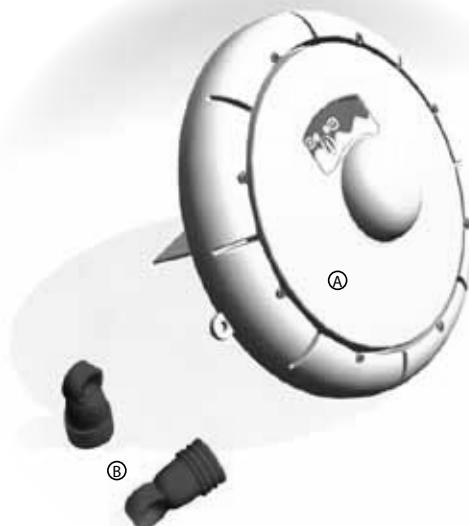

# Pre-commissioning check

KidsGuard 2® alarm systems have been tested at all stages of manufacture. However, if, despite our attention, a unit has been damaged during transport, storage or any other handling operation, only the commissioning test can determine the existence of damage to components and correct operation. Place your detector on a table or other flat surface.



Power up using the magnet:

1 - Place a magnet at the location indicated on the control panel for approximately 3 seconds.

2 - The 2 diodes will light up simultaneously.

3 - Remove the magnet.

4 - KIDSGUARD 2® will emit a beep.

5 - The green and red diodes will flash alternately: KIDSGUARD 2® is now calibrating.

+/- 3 seconds

The process

6 - KidsGuard 2® will emit a series of beeps after 3 seconds: KidsGuard 2® will automatically switch to swimming mode.

7 - The green diode will flash, indicating that KidsGuard 2® is in swimming mode.

+/- 3 minutes

8 - KidsGuard 2® will emit a series of beeps after approximately 3 minutes: KidsGuard 2® has automatically switched to surveillance mode.

9 - The red diode will flash, indicating that KidsGuard 2® is in surveillance mode.

**You will now artificially trigger the warning.** *Warn anyone nearby as the siren is powerful (100 dB)!*

1 - Place the end of the tube in a bucket filled with water, and register an alternating up-down movement with the alarm (approx. 4 back and forth movements).

2 - The siren will trip; stop the alarm by placing a magnet on the indicated location.

**If this test is successful, your immersion detector is ready to be installed.**

**Should this test fail, leave your alarm for approximately 5 minutes and then restart this test. If the problem persists, contact your retailer or call: 0 820 366 150 (€0.118 incl. VAT/min).**

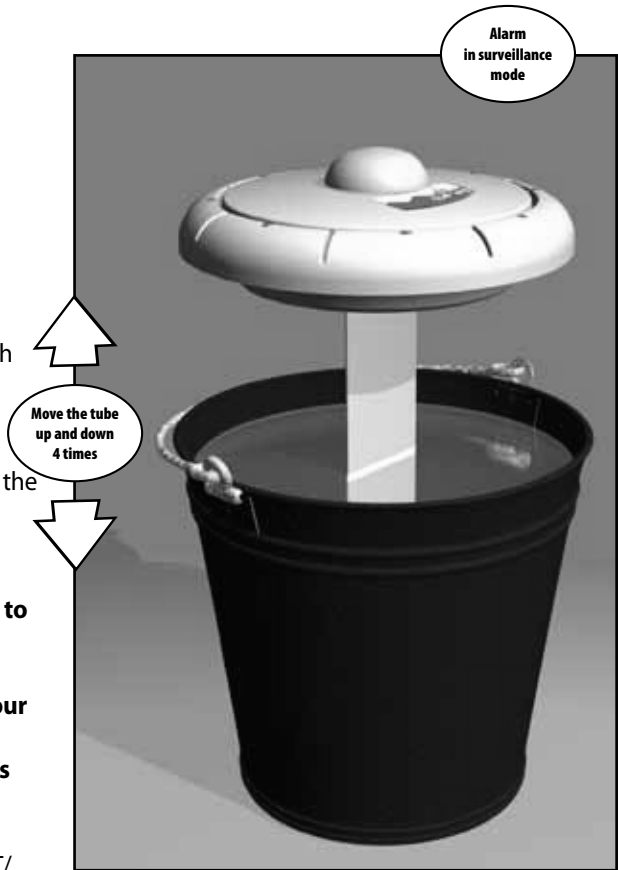

## Selecting a location

To reduce the trigger time for the alarm in case of a fall, the KidsGuard 2® alarm must be fitted in the middle of the longest side of your swimming pool, and no obstacle must be placed between the alarm and a view of the entire pool.

- The alarm floats on the surface of your swimming pool and is attached using the rope and the poolside ring provided.

Safety, warning and failure signals must be heard from the house or accommodation. This must be checked during the installation.

- Provide permanent indication that the pool and surrounding area are under electronic surveillance.

- Install your KidsGuard 2® alarm more than one metre from delivery nozzles, skimmers, suction devices or any other equipment generating noise in the pool.

- Ensure that access to the controlled area (magnetised zone) of your KidsGuard 2® alarm is free of obstacles.

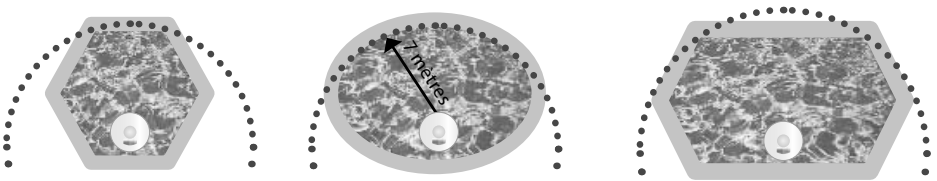

## Installing

- Place your KidsGuard 2® alarm on the surface of the water; the sensor tube must be vertical and submerged.

- You may need to attach your alarm using the rope and the poolside ring provided, to ensure the alarm remains in position at the pool surface (see Installation).

Important: The rope must not be taut and the alarm must float on the surface and not be pulled up by the rope.



# Operating test in the pool :

Essential conditions for testing:

- **alarm attached to the poolside ring with the rope**
- **calm pool water**
- **wait for several dozen minutes after the last swimmer has left the pool**
- **no wind**

1. Start your pool filter.

2. Power up the alarm by placing the magnet in the indicated location for +/- 3 seconds.

3. The green and red diodes will flash alternately: KidsGuard 2° is now calibrating.

4. KidsGuard 2° will emit a series of beeps after 3 seconds: KidsGuard 2° will automatically switch to swimming mode.

5. The green diode will flash, indicating that KidsGuard 2° is in swimming mode.

6. KidsGuard 2° will emit a series of beeps after less than 15 minutes: KidsGuard 2° has automatically switched to surveillance mode.

7. The red diode will flash, indicating that KidsGuard 2° is in surveillance mode.

8. Throw a mass of approximately 8+ kg into the pool.

9. The siren will trip; stop the alarm by placing a magnet on the indicated location.



+/- 3 seconds

**BEEP BEEP BEEP**



< 15 minutes

**BEEP BEEP BEEP**

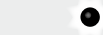

8 Kg

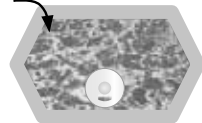

**WAAAAAA!**

Note: If your alarm is unable to detect the fall in less than 12 seconds, allow the pool water to return to calm (a dozen minutes) and restart the test after checking that the alarm has automatically switched to surveillance mode.

Test results	Validity	Action
The fall is detected in 12 seconds or less.	Yes	Stop the siren.
The fall is detected in more than 12 seconds.	No	Repeat the test or contact your retailer or, preferably, call: 0 820 366 150 (€0.118, incl. VAT/min).
The fall is not detected.	No	

After testing, the KidsGuard 2® alarm will automatically switch to surveillance mode after pool water has returned to calm conditions. This may take up to 12 minutes.

The alarm emits a series of rapid beeps and the red LED will flash when the alarm switches to surveillance mode.



## Fuel cell blister pack

Despite the care taken when selecting fuel cells, storage factors may have downgraded their performance: with defective fuel cells, 3 rapid beeps will be emitted approximately every 40 seconds to indicate that they must be changed.

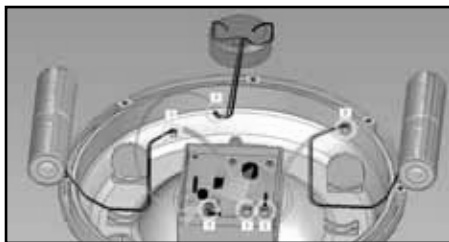

Our fuel cell blister packs are designed with an autonomy of at least one year.

We recommend that you change the fuel cell blister pack either immediately when the low fuel cell signal is emitted, or on an annual basis.

You can purchase fuel cell blister packs for your alarm by calling 0 820 366 150 (€0.118, incl. VAT/min) or your retailer.

When replacing fuel cells, always use fuel cells with the same characteristics and the same power. Return your used fuel cell blister packs to an authorised reprocessing centre (tip, recycling centre) to protect the environment.

**Do not forget to fit the seal beforehand. The buzzer wires will prevent the fitting of the seal otherwise.**

# Use

(Refer to the control diagram on the final page of this document.)

The KidsGuard 2® alarm must be set to swimming mode (flashing green diode) prior to bathing.

If the red diode is flashing, switch the alarm to swimming mode by placing the magnet in the indicated location.

A beep will indicate the change of mode.

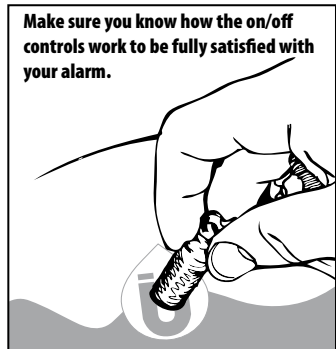

**Make sure you know how the on/off controls work to be fully satisfied with your alarm.**

After bathing, the KidsGuard 2® alarm switches to surveillance mode automatically if the water is calm for at least 2 minutes.

Automatic switching to surveillance mode is indicated with several series of beeps. Important, the two minutes of calm water must be consecutive.

Automatic switching to surveillance mode may actually take up to 15 minutes.

During this period, increased human supervision is important.

It is possible to request a rapid switch to surveillance mode by placing the magnet in the indicated location for a few seconds.

If the pool water is too agitated, the alarm may refuse this forced switch to surveillance mode.

Some counter-flow swimming systems prevent the automatic re-activation of the immersion detection system.

If the siren is tripped, deal with the accident directly.

You can stop the audio signal of the siren by placing the magnet in the magnetised area, or by stopping the alarm using the key.

In all other cases, the siren will sound continuously for 2 minutes, and subsequently intermittently for 3 minutes; the alarm will then automatically switch to swimming mode.

## Complete stop\*

If, despite the risks of interrupting surveillance, you wish to stop your KidsGuard 2® alarm, hold the magnet in the intended location for approx. 10 seconds: the alarm will emit a series of 2-tone beeps before turning off.

In case of an extended period without use, we recommend you store the alarm in a dry and warm location.

To restart your KidsGuard 2® alarm, refer to point I of these instructions. After a complete stop, install and test the alarm as indicated in these instructions.

If a problem arises, immediately contact your retailer or, preferably, call 0 820 366 150 (€0.118 incl. VAT/min).

## Warnings:

*FREEZING - Important:* Your KidsGuard 2® system is inoperative if water freezes inside the sensor, or if the surface of the water in the swimming pool is frozen. If you are uncertain if the water in the tube is solid or liquid, test the alarm.

*AUTHORISED INTERVENTIONS* - In terms of alarm service and maintenance, the only intervention authorised by the user is the replacement of the fuel cells. For all other interventions, contact your retailer or, preferably, call 0 820 366 150 (€0.118, incl. VAT/min).

*CHECKS* - Check the operation of your KidsGuard 2® alarm on a regular basis by performing the alarm tests described in the instructions.

Note the results of these tests in the space assigned for this purpose in the instructions.

In case of a malfunction, protect access to your swimming pool, and contact your retailer or, preferably, call 0 820 366 150 (0.118 EUR incl. VAT/min) immediately and launch the reset procedure.

A test report is included on page 16 of these instructions.

# Additional information

## ***Information on the KidsGuard 2® alarm***

The KidsGuard 2® alarm system cannot replace common sense and individual responsibility.

The alarm is not intended to replace supervision by parents and/or responsible adults, which will remain the key factor in the protection of children (particularly children aged under 5).

The KidsGuard 2® alarm system is designed for above ground swimming pools placed on the ground, and will indicate a danger (or risk of danger).

Rapid action (less than 3 minutes) by a responsible adult is mandatory if the alarm is tripped.

The alarm can be installed in swimming pools smaller than 12 x 5 m and has a maximum scope of 7 metres. If users decide to turn the alarm off, they must be aware that human supervision must replace the alarm.

It is essential to take immediate action if the alarm is tripped.

Parents or responsible adults must pay great attention between the end of bathing and the re-activation of the system in surveillance mode.

Surveillance mode can also be force set using the magnet to reduce this «in-between» time.

Turn off the counter-flow swimming system after bathing to re-activate the switching process to surveillance mode.

Under no circumstances may your retailer or the manufacturer of the KidsGuard 2® alarm be held liable for the fall or drowning of a child, a dependent person or any adult or animal.

Use of an alarm system cannot replace your attention and active supervision of the swimming pool and nearby areas under any circumstances.

This alarm system, just like any safety device or equipment, is a complementary tool and may be useful for a temporary lapse in supervision.

# Safety advice :

## **1 - Monitor and take action!**

- Children should be supervised at all times and from nearby.
- Appoint one person in charge of safety.
- Pay extra attention if several people use the swimming pool at the same time.
- Teach your children to swim as early as possible.
- Wet your neck, arms and legs before getting into the pool.
- Learn basic first aid and rescue skills, especially those required for children.
- Prohibit diving or jumping in the presence of young children.
- Prohibit running and lively games near to the swimming pool.
- Prohibit access to the swimming pool without a life jacket or armbands for all unaccompanied children unable to swim or with weak swimming skills.
- Never leave toys near to the pool or in the pool without supervision.
- Ensure that the pool water is clean and transparent at all times.
- Store water treatment products out of the reach of children.
- Some counter-flow swimming systems prevent the automatic re-activation of the immersion detection system.
- Some cleaning robots such as pool rovers are not compatible with immersion detection systems.
- Take all action necessary to prevent children aged under 5 from accessing the pool if the failure signal trips and until repair.

## **2 - Ensure that:**

A telephone is available near to the pool to avoid leaving your children unsupervised when making a phone call.

A rod and buoy are available near to the pool.

### **3 - In case of an accident:**

Remove the victim from the water as rapidly as possible.

Avoid the domino effect: Ask all swimmers to leave the pool without panicking and ensure they stay a safe distance from the pool.

Contact: Call or ensure someone calls the emergency services immediately.

Assistance: Follow the instructions issued.

Replace wet clothing with hot blankets.

Display emergency numbers near to the swimming pool and remember them.

Numbers available from a landline:

Fire service: 18 (in France)

Ambulance service: 15 (in France)

Numbers available from all phones:

European emergency number: 112

Regional poison control centres:

Administrative region::	Referral poison control centre::	Tel.
Centre	Angers	02 41 48 21 21
Pays de la Loire	Angers	02 41 48 21 21
Aquitaine	Bordeaux	05 56 96 40 80
Poitou Charentes	Bordeaux	05 56 96 40 80
Haute Normandie	Lille	N° Indigo : 0 825 81 28 22
Nord Pas de Calais	Lille	N° Indigo : 0 825 81 28 22
Picardie	Lille	N° Indigo : 0 825 81 28 22
Auvergne	Lyon	04 72 11 69 11
Rhône Alpes	Lyon	04 72 11 69 11
Corse	Marseille	04 91 75 25 25
Languedoc Roussillon	Marseille	04 91 75 25 25
Provence Alpes Côte d'Azur	Marseille	04 91 75 25 25
Réunion	Marseille	04 91 75 25 25
Bourgogne	Nancy	03 83 32 36 36
Champagne-Ardennes	Nancy	03 83 32 36 36
Lorraine	Nancy	03 83 32 36 36
Ile de France	Paris	01 40 05 48 48
Antilles	Paris	01 40 05 48 48
Guyane	Paris	01 40 05 48 48
Basse Normandie	Rennes	02 99 59 22 22
Bretagne	Rennes	02 99 59 22 22
Alsace	Strasbourg	03 88 37 37 37
Franche Comté	Strasbourg	03 88 37 37 37
Limousin	Toulouse	05 61 49 33 33
Midi-Pyrénées	Toulouse	05 61 49 33 33

## Monthly tests

You must test your KidsGuard 2® alarm on a monthly basis to ensure correct operation. Record the results of testing in the table below. In case of a malfunction, contact your retailer or, preferably, call 0 820 366 150 (€0.118 EUR incl. VAT/min) immediately. This table (filled out) may be required if you wish to return the alarm during the warranty period.

N°	Test date	OK	Not OK	Comments
1				
2				
3				
4				
5				
6				
7				
8				
9				
10				
11				
12				
13				
14				
15				
16				
17				
18				
19				
20				
21				
22				
23				
24				



# Warranty

In the context of this warranty, ACIS, which is responsible for the marketing of the KidsGuard 2® alarm, certifies that this product has been designed and manufactured with great care and is free of material and manufacturing defects. The warranty will cover a period of 2 (two) years from the date of purchase.

This warranty covers parts, labour and return to the workshop, if the intervention required is within the scope of the warranty. If, during the period covered by the warranty, the product is found to be defective due to a material or manufacturing defect, ACIS will repair or replace (as deemed appropriate by ACIS) the product or defective parts free of charge. ACIS reserves the right to replace defective spare parts or products with new or factory revised parts or products.

## Warranty exclusions:

- You must complete the warranty form within 8 days of purchase and return this form to ACIS (signed with a copy of your invoice) via registered post with acknowledgement of receipt or recorded delivery.

ACIS reserves the right to refuse the warranty free of charge if the test records, warranty form or invoice cannot be produced, or if the information shown on these documents is found to be modified, unreadable or impossible to understand.

- You must test the alarm on a monthly basis throughout the period of warranty. We recommend that you continue to test the alarm on a monthly basis after the warranty has expired.

- The warranty will only apply if the installation is strictly compliant with all points dictated in these instructions.

- The sale of a previously installed alarm system will cancel the warranty. This exclusion must be notified to the new owner, and will be considered as accepted in case of an incident.

- The warranty will not apply if the serial numbers and other elements used to trace the alarm indicated on the cover are damaged, erased or unreadable.

- The warranty will not cover the following items:

- Routine maintenance and the repair or replacement of consumables in the context of normal use,

- Any adaptation or modification aiming to improve the initial performance of the product, as described in this manual, without the prior written agreement of ACIS,

- Transport costs, transport cost to the home address and all transport risks with a direct or indirect link to the warranty for the KidsGuard 2® alarm,

- Damage caused by:

- Incorrect use, including (but not exclusively), the inappropriate use of the alarm, or non-compliance with these installation instructions,

- The use and maintenance of the product,
- Repairs performed by unauthorized actors or the user,
- Accident, lightning, flooding, fire or any other cause which is beyond the liability of ACIS.

No clause of this warranty will affect the statutory rights of the user.

## **After-sales service & returns**

• All product returns in application of this warranty must be approved by ACIS prior to return.

The customer must contact the retailer of the immersion detector or, preferably, ACIS. If the product is found to be defective, a product return reference will be issued to the customer.

• The product must be returned with adequate protection, in its original packaging, to the address indicated, accompanied with the original sales invoice (the buyer must keep a copy of this invoice).

The assigned return reference must be clearly indicated on the packaging, next to the address of the recipient.

All products without a return reference will be refused. Costs and risks incurred in returning the product must be met by the customer.

• We will perform the necessary tests to check the defect upon receipt of the immersion detector. If the defect is confirmed, we will exchange or repair the product as rapidly as possible.

Neither ACIS nor your retailer are systematically required to replace your system during the time required to repair/replace it. You must pay particular attention to your swimming pool during this period.

## **Limits of liability**

Pursuant to this warranty, the liability of ACIS is limited to the repair or replacement of the KidsGuard 2® alarm.

ACIS will not be required to replace or repair the product if the contractual warranty does not apply, according to the above paragraphs. The liability of ACIS for any defective product may not exceed the purchase price paid for the defective product in any circumstances.

This limitation applies even if ACIS cannot or will not repair or replace a defective product, and if compensation is not the main purpose of the return. ACIS may under no circumstances be held liable for any general, indirect, secondary or special damage.

ACIS is only subject to an obligation to provide resources: provision of an operational alarm, free of any material or manufacturing defect. Under no circumstances may ACIS or its retailers be held liable for the fall or drowning of a child, adult or animal.

You will remain solely liable for the safety of your swimming pool.

The sirens integrated in the immersion detector meet the requirements of standard NFP 90-307/A1.

Under no circumstances may ACIS or its retailers be held liable for problems relating to the emitting of sirens.

## Compliance statement

The KidsGuard 2® immersion detector has been tested according to the provisions of standard NFP 90 - 307/A1 applicable to alarm systems for swimming pools.

Immersion detector	Power supply
KidsGuard 2®	(2 x 3 V) 6 Volts - DC

## Practical information

- For information, immersion time reduces the alarm lifecycle exponentially (data provided by government services, and used for all official safety training exercises).

- Zero risk levels are not possible:

Only your active supervision combined with the passive surveillance of the KidsGuard 2® alarm can ensure a satisfactory level of safety. The installation of this alarm system must not have any effect on your level of supervision or replace active and visual monitoring of the swimming pool and nearby areas under any circumstances.

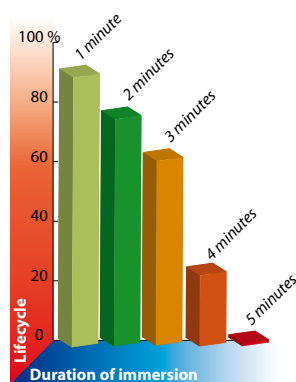

Rapid action will be decisive in the outcome of any accident.

NEVER stray far from the pool if one or several children are playing nearby.

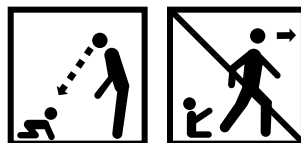

## CONTROL PANEL

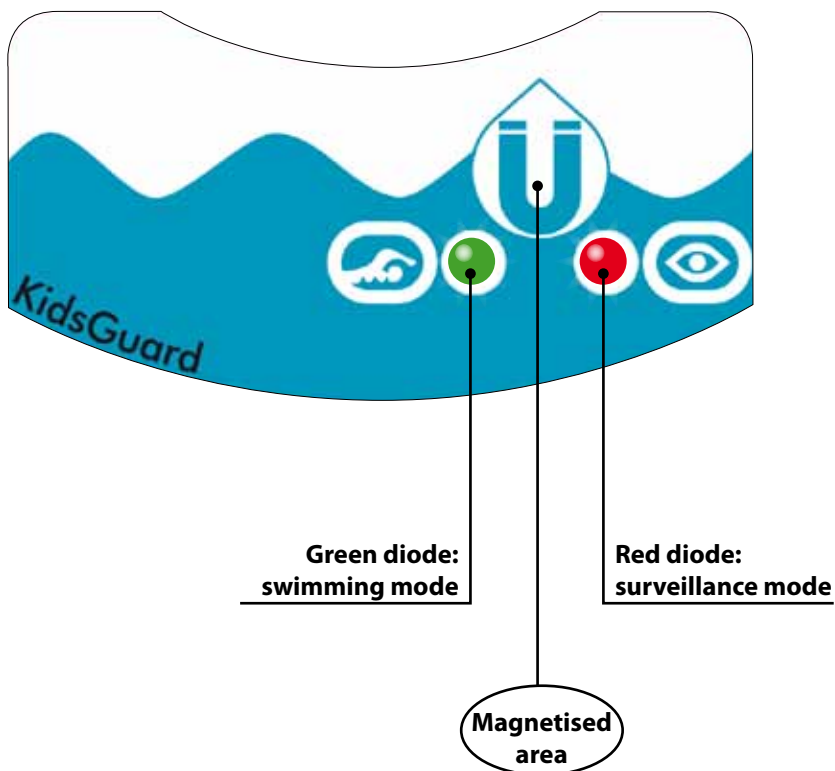

**ACIS**

*Aqua Consult Industrie Service*

Z.A. de la Fénicière - 85300 SALLERTAINE - FRANCE

**▶ N° Indigo 0 820 366 150**

0,118 € TTC / MN