

AL-USB - User's manual



This symbol is intended to alert the user of important operating and maintenance (servicing) instructions in the literature provided with the equipment.



This symbol is intended to alert the user of the presence of uninsulated dangerous voltage within the product's enclosure that may present a risk of electric shock.

1 Caution

Read Instruction: Read and understand all of the safety and operating instructions before using this equipment.

Retain Instructions: The safety instructions should be kept for future reference.

Follow Warnings: Follow all warnings and instructions marked on the equipment or in the user manual.

Avoid Attachments: Do not use tools or attachments that are not recommended by **Alyseum** because they may be hazardous.



Installation:

- Choose the installation location of your unit carefully.
- Avoid placing it in direct sunlight or close to a source of heat.
- Also avoid locations subject to vibrations and excessive dust, cold or moisture.



Power Source:

- This equipment should only be operated from the power source indicated on the product.
- When removing the power plug from the wall outlet, always pull directly on the plug, never yank the cord.



Servicing:

- Refer all servicing to qualified service personnel.
- There are no user-serviceable parts inside.
- To prevent the risk of shock, do not attempt to service this equipment yourself because opening or removing covers may expose you to dangerous voltage or other hazards.



WARNING: TO PREVENT FIRE OR ELECTRIC SHOCK HAZARD, DO NOT EXPOSE THIS APPLIANCE TO RAIN OR MOISTURE.

2 Contents

1	Caution.....	1
2	Contents.....	2
3	What's the AL-USB.....	3
3.1	Features	3
4	Hardware AL-USB	3
4.1	Package content	3
4.2	Options	3
4.3	Panels descriptions	4
4.4	Connecting	4
4.4.1	Connect an AL-USB to a single computer	4
4.4.2	Connect an AL-USB to a network via a switch	4
4.5	Power	5
4.6	Specifications	5
5	Software AL-USB.....	5
5.1	Merging function.....	5
5.2	Establish connections	5
5.3	Settings	5
5.4	Firmware Upgrade software.....	6
6	About.....	6
6.1	Ethernet.....	6
6.1.1	Note about Wi-Fi use	6
6.1.2	Tips for a efficient Ethernet Network	6
6.2	CopperLan	7
7	Miscellaneous	7
7.1	Disclaimer.....	7
7.2	Maintenance.....	7
7.3	Static Electricity, ESD	7
7.3.1	Standard symbols for ESD advertising.....	7
7.3.2	Some tips and precautions for ESD sensitive environment	7
7.4	How to wiring the Ethernet cable ?	8
7.5	Statement and Agency Compliance.....	8
7.5.1	WEEE (for EU countries).....	8
7.5.2	RoHS Compliance (for EU countries).....	8
7.5.3	CE (for EU countries).....	9
7.6	Warranty and repair	9
7.7	Revision history	9
7.8	MIDI Chart.....	10

3 What's the AL-USB

The **Alyseum** AL-USB is an embedded networked computer Box. It uses the Ethernet network to transport MIDI flows between any CopperLan compliant hardware or software applications in computers.

A AL-USB allows you to connect 2 MIDI In and 2 MIDI Out ports (up to 4 MIDI cables)

Of course, the AL-USB can exchange MIDI flows with any other AL-22, AL-88, ALeX and MS-4 (Peer to peer functionality) or any other product supporting CopperLan.

AL-USB are supplied ready to use, the actual linking is managed via the CopperLan Manager software. This freeware tool is also used to monitor the status of all Copperlan computers and equipment. The box can be controlled from any computer anywhere in the network.

DC input allows the interface to work with tablets that do not provide the minimum current required by the USB standard.



AL-USB will only work with USB tablets devices which are MIDI Class Compliant.

If you attach a non class compliant device, it just won't be recognised. No damage will be caused.



Some tablets are not equipped with a standard USB connector. you must acquire a specific adaptor.

3.1 Features

- Self-contained interface, 2 MIDI-USB In/Out pairs to CopperLan interface.
- Works on USB 1.1 & USB 2.0 ports.
- Class-compliant operation – no driver needed for WIN, MAC or Linux.
- Compatible with all tablets supporting MIDI Class Compliant
- 100 Ethernet port.
- Auto-MDIX allows the use of straight-through or cross-over UTP cable.
- peer to peer MIDI transport, on a channel basis, remapping and merging.
- peer to peer MIDI transport without mandating a computer.

4 Hardware AL-USB

4.1 Package content

- 1 AL-USB device
- 1 wall-plug power module – 5 VDC @ 700 mA
- 1 USB cable (type A/B)
- User's manual access card

4.2 Options

Check on <http://www.alyseum.com/accessories>

4.3 Panels descriptions

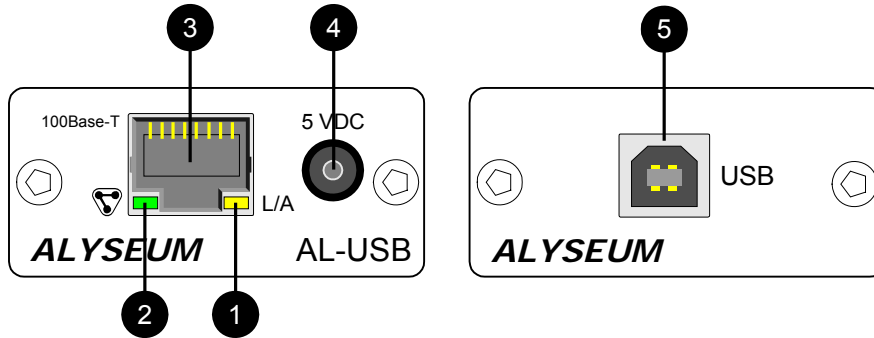

1. Yellow LED – Link/Activity on the Ethernet network

LK/ACT Mode	LED Pattern
No connection	OFF
LINK established	ON
Network activity	ON with OFF pulses

2. Green LED – CP activity

CP activity Mode	LED Pattern
Firmware Upgrade ready	Slow blinking
Firmware Upgrade activity	Fast blinking
CP establishing connection	OFF with ON pulses
CP Activity	ON with OFF pulses

3. RJ45 – Ethernet connector – 100 Base-T
 4. DC plug 2.1mm – 5 VDC (positive in center)
 5. USB type B connector

4.4 Connecting

4.4.1 Connect an AL-USB to a single computer

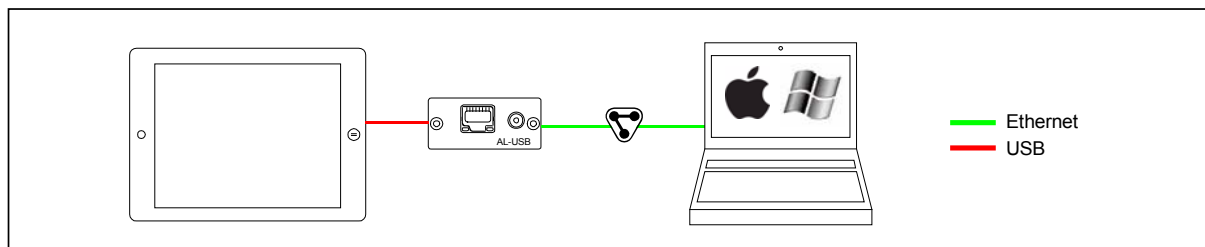

4.4.2 Connect an AL-USB to a network via a switch

More as 2 devices connected to the network, need a switch.

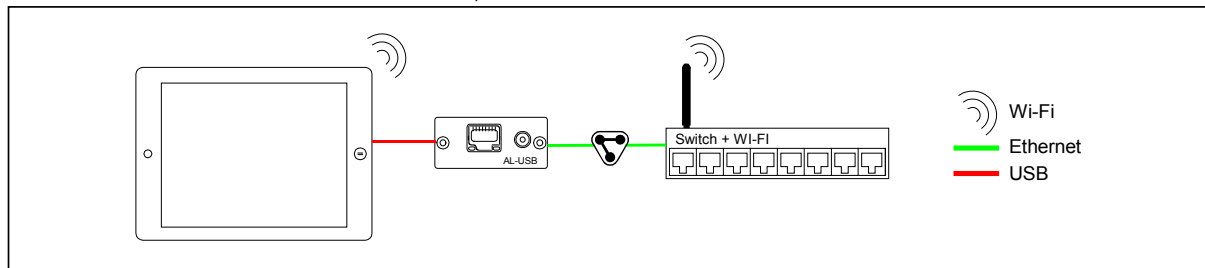

4.5 Power

Normally, the AL-USB takes energy via the USB port

DC input allows the interface to work with tablets that not provide the minimum current required by the USB standard.

4.6 Specifications

- Dimensions (W x H x D): 55 x 25 x 63 mm
- Weight: 0,12 Kg
- Rugged aluminum case with laser engraving
- Power requirements: 5 Volts DC @ 0.3 A

5 Software AL-USB

5.1 Merging function

Connecting two or more sources to the same destination, realizes a merging functions.

Beware that MIDI does not allow merging every type of message at any time. Merging two sysex messages may lead to unpredictable results.

More informations on our application note: <http://www.alyseum.com/download>.

5.2 Establish connections

It is possible to connect any source to any destination, as a whole virtual cable or according to message type.

Establishing connections is done from the connection tab of the CopperLan Manager software application.

To connect a whole virtual cable, select the appropriate source device and click on the MIDI connector icon. You complete the operation by selecting a destination. All messages appearing at the source will be transferred to the destination without any filtering or remapping.

Instead of connecting a whole cable content, it is allowed to connect individually one or more message types according to the following split:

1. Note and Controller messages on a channel basis – these are channel messages
Any of the 16 MIDI channels content can be linked separately
2. Clock messages (incl. clock control and song position messages)
Any clock from any source can be connected to any destination. Note that MIDI destinations can only accept a single clock whereas CopperLan destinations can accept many.
3. Other messages (Sys)
This selection covers all messages to the exception of messages in categories 1 and 2 hereabove. This linking is essentially used for Sysex and MTC messages.

It is meaningful to only connect sources and destinations of adequate messages type (e.g. Sys to Sys). However, it is allowed to connect any source channel to any destination channel, effectively realizing a channel remapping.

More informations on our application note: <http://www.alyseum.com/downloads>

5.3 Settings

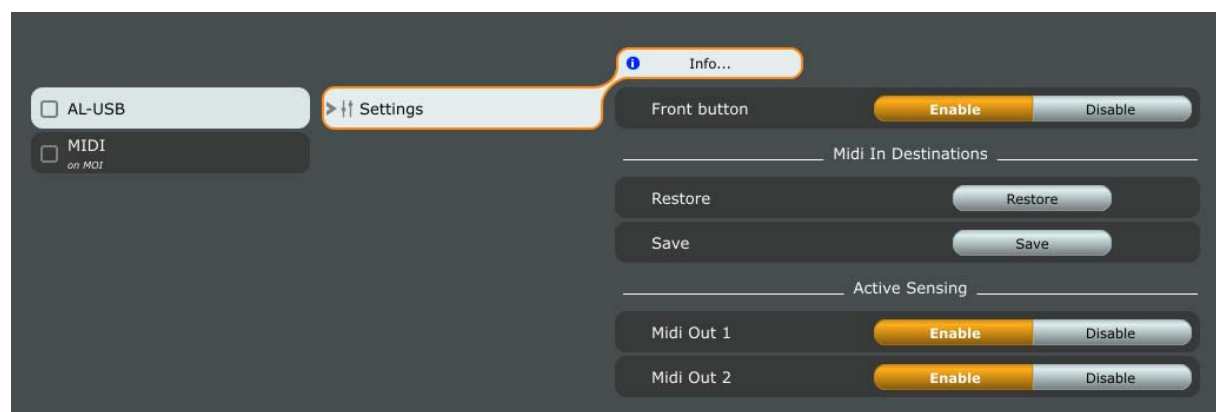

Four settings are done via the CopperLan Manager (Editor tabs)

1. Front button (not available in this product)
2. Restore originals MIDI In connections.
3. Save MIDI In destinations.
4. Enable or disable the active sensing on MIDI Out 1.
5. Enable or disable the active sensing on MIDI Out 2.

5.4 Firmware Upgrade software

Upgrading the firmware is done via the network.

This is done automatically through the CopperLan Manager via an internet connection or via the Firmware updater program.

6 About

6.1 Ethernet

Alyseum products rely on Ethernet to transport data; compared to other solutions (USB, IEEE1394, ...) Ethernet offers many advantages:

- Available on all computer platforms
- No real limit in cable length and node connections.
- Full Duplex.
- Very high bandwidth.
- Very low Latency.
- Frees the computer of the MIDI flow handling of USB/Firewire interfaces
- Embedded devices can work without any computer in the network
- Peer to peer capability.
- Full electrical isolation between machines, preventing audio hum due to ground loops.
- Low cost, ubiquitous and reliable infrastructure.

6.1.1 Note about Wi-Fi use



Using these products via Wi-Fi is possible but not guaranteed. Wireless transmissions are subject to perturbations that require data resending which implies unavoidable delays which are inconvenient for real-time musical purposes. This is why Alyseum only guarantees good performance when using wired network.

6.1.2 Tips for a efficient Ethernet Network



The performance of an Ethernet network is always related to the weakest link.

- Use the WI-FI only for the web, Email, ... and the wired network of your computer for the CopperLan and audio streaming
- For large installations, use an additional network card in your computer to create a network dedicated only for CopperLan and audio streaming
- For large installations , preferably use Gbit Ethernet switches to guarantee a better data exchange
- Avoid Ethernet HUBs as these create collisions in messages that could hamper the overall network performance

6.2 CopperLan

CopperLan offers many advantages:

- Connectivity guaranteed with any hardware/Software supporting CopperLan.
- No IP addresses, thanks to an address abstraction layer.
- Protocol and networking system for command & control + streaming management.
- Self configuring & Plug and Play.
- Decentralized work distribution and storage – every CopperLan equipment incorporates its own server.

CopperLan manages MIDI in a more powerful and flexible than any other technology available. The benefit of having its own dedicated protocol surpasses the afterthought solutions relying on TCP/UDP-IP in terms of speed and user-friendliness.

7 Miscellaneous

7.1 Disclaimer

All rights reserved. Reproduction in whole or part of this document is prohibited without the express permission of **Alyseum**.

© 2011 - 2013 **Alyseum**.

The information and specifications described in this manual are subject to change without notice.

Other products or brandnames mentioned herein are trademarks or registered trademarks of their respective holders.

7.2 Maintenance



Switch Off the power before maintenance.

Do not attempt to clean the unit with chemical solvents (thinner, benzine or alcohol) as this might damage the finish. Use only a clean, dry cloth.

7.3 Static Electricity, ESD



Electrostatic discharge (ESD) can cause malfunction and/or damage to electronic devices if discharged into the device.

Despite the built-in ESD protections in every **Alyseum** product, ESD might build up at levels that could harm your equipment.

7.3.1 Standard symbols for ESD advertising



7.3.2 Some tips and precautions for ESD sensitive environment

- Make sure to discharge any built-up static electricity from yourself and your device before touching or connecting one device to another
- Ground yourself by touching an earth grounded metal surface before handling your device and other equipments.
- For fixed installations, put the device in a grounded metallic rack.
- Ensure air relative humidity is minimum 60%.
- Install ESD specific prevention items, such as grounding mats.

- Reduce movement speed on handling or (dis)connecting devices
- Avoid carpet or other synthetic flooring

7.4 How to wiring the Ethernet cable ?

If you want to build your own Ethernet cable, don't worry, use CAT5 cable, RJ45 connectors and a crimping clamp.

The maximum length for a single cable is 120 meters

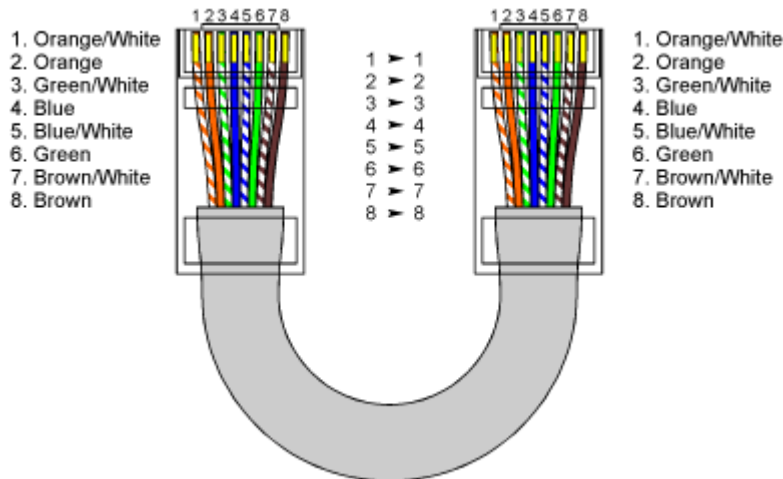

Pin	Function
1	TX+
2	TX-
3	RX-
6	RX+

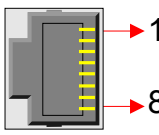

7.5 Statement and Agency Compliance

7.5.1 WEEE (for EU countries)

Waste Electrical and Electronic Equipment (Directive 2002/96/EC)

(applicable for E.U. Customers or others countries with separate collection systems)

1. This marking shown on the product or its literature, indicates that it should not be disposed with other household wastes at the end of its working life.
2. To prevent possible harm to the environment or human health from uncontrolled waste disposal, please separate this from other types of wastes and recycle it responsibly to promote the sustainable reuse of material resources.
3. Household users should contact either the retailer where they purchased this product, or their local government office, for details of where and how they can take this item for environmentally safe recycling.



7.5.2 RoHS Compliance (for EU countries)

Allyseum products complies with the European Union restriction of the use of certain hazardous substances in electronics equipment, (RoHS directive 2002/95/EC)

The RoHS directive prohibits the sale of certain electronic equipment containing some hazardous substances such as Mercury, Lead, Cadmium, Hexavalent chromium and certain Flame-retardants (PBB & PBDE) in the European Union.

<http://eur-lex.europa.eu/LexUriServ/LexUriServ.do?uri=CELEX:32002L0095:EN:HTML>



7.5.3 CE (for EU countries)

Alyseum products complies with the requirements of European Directive 89/336/EC.

7.6 Warranty and repair

Alyseum warrants to you, the original purchaser, that each of its products will be free from defects in materials and workmanship for a period of two years from the date of purchase.

This warranty does not apply to any products which have been repaired or altered by other than repair personnel authorized by **Alyseum**, or which have been subject to ESD, moisture, abuse, accident or improper installation and using.

Alyseum assumes no liability as a consequence of such events under the terms of this Warranty.

Please consult your dealer for more details.

7.7 Revision history

Issue	Date	Comments
1.0	15 December 2013	First release

7.8 MIDI Chart

AL-USB MIDI IMPLEMENTATION CHART ver.1.0. 2013-12-15

Function		Transmitted	Recognized	Remarks
Basic Channel	Default	1-16	1-16	pass-through
	Changed	--	--	via network mapping
Mode	Default	--	--	not applicable
	Messages	X	X	pass-through
	Altered	--	--	not applicable
Note Number		0-127	0-127	pass-through
Velocity		X	X	pass-through
After Touch	Keys	X	X	pass-through
	Channels	X	X	pass-through
Ptch Bend		X	X	pass-through
Control Change		X	X	pass-through
Prog. Change True#		X	X	pass-through
System exclusive		X	X	pass-through
System Common	Song Position	X	X	pass-through
	Song Select	X	X	pass-through
	Tune Request	X	X	pass-through
System Realtime	Clock	X	X	pass-through
	Commands	X	X	pass-through
Aux Messages	Local On/Off	X	X	pass-through
	All Notes Off	X	X	pass-through
	Active Sensing	X	O	Via CopperLan
	System Reset	O	O	
Notes				