

Digital Photo Printer

Operating Instructions

UP-DR200

Owner's Record

The model and serial numbers are located at the rear. Record these number in the space provided below. Refer to these numbers whenever you call upon your Sony dealer regarding this product.

Model No. _____
Serial No. _____

WARNING

To reduce the risk of fire or electric shock, do not expose this apparatus to rain or moisture.

To avoid electrical shock, do not open the cabinet. Refer servicing to qualified personnel only.

THIS APPARATUS MUST BE EARTHED.

To disconnect the main power, unplug the AC IN connector.



This symbol is intended to alert the user to the presence of important operating and maintenance (servicing) instructions in the literature accompanying the appliance.



Risk of injury
Do not touch the inside.



Hot surface
Thermal Print Head becomes a high temperature.

For the customers in the U.S.A.

This equipment has been tested and found to comply with the limits for a Class A digital device, pursuant to Part 15 of the FCC Rules. These limits are designed to provide reasonable protection against harmful interference when the equipment is operated in a commercial environment. This equipment generates, uses, and can radiate radio frequency energy and, if not installed and used in accordance with the instruction manual, may cause harmful interference to radio communications. Operation of this equipment in a residential area is likely to cause harmful interference in which case the user will be required to correct the interference at his own expense.

You are cautioned that any changes or modifications not expressly approved in this manual could void your authority to operate this equipment.

All interface cables used to connect peripherals must be shielded in order to comply with the limits for a digital device pursuant to Subpart B of Part 15 of FCC Rules.

Warning on power connection

Use a proper power cord for your local power supply.

1. Use the approved Power Cord (3-core mains lead) / Appliance Connector / Plug with earthing-contacts that conforms to the safety regulations of each country if applicable.
2. Use the Power Cord (3-core mains lead) / Appliance Connector / Plug conforming to the proper ratings (Voltage, Ampere).

If you have questions on the use of the above Power Cord/Appliance Connector/Plug, please consult a qualified service personnel.

For the customers in Europe

The manufacturer of this product is Sony Corporation, 1-7-1 Konan, Minato-ku, Tokyo, Japan. The Authorized Representative for EMC and product safety is Sony Deutschland GmbH, Hedelfinger Strasse 61, 70327 Stuttgart, Germany. For any service or guarantee matters please refer to the addresses given in separate service or guarantee documents.

Table of Contents

Introduction

Features	4
Basic Application Example	4
Location and Function of Parts and Controls	4

Preparation

Supplied Accessories	7
Connections	8
USB Port Connection	8
Installing the Printer Driver	8

Operation

Loading the Paper Roll and Ink Ribbon	9
Loading the Paper Roll and Ink Ribbon	9
Attaching the Scrap Receptacle	13
Attaching the Output Tray	13
If the Ink Ribbon Breaks during Use	15
Removing the Ink Ribbon and Paper	16
Printing from the Computer	18
Menu Operations	19
Preparation for Menu Operation	19
Adjusting the Gray Balance	19
Displaying the Quantity of Pages Printed	21
Displaying the Firmware Version of the Printer	21
Adjusting the Position of the Printout Image ...	22

Miscellaneous

Precautions	23
Safety	23
Installation	23
On Transporting the Printer	23
Cleaning	23
Cleaning the Interior	24
Ink Ribbon and Paper	27
Specifications	27
List of Messages	28
Troubleshooting	29
Index	30

Introduction

Features

The UP-DR200 Digital Photo Printer is a dye sublimation thermal transfer printer providing high quality, high resolution (330 dpi), and high speed printing of computer image data on four sizes of paper in full color (256 gradations process and 16.7 million colors).

Basic Application Example

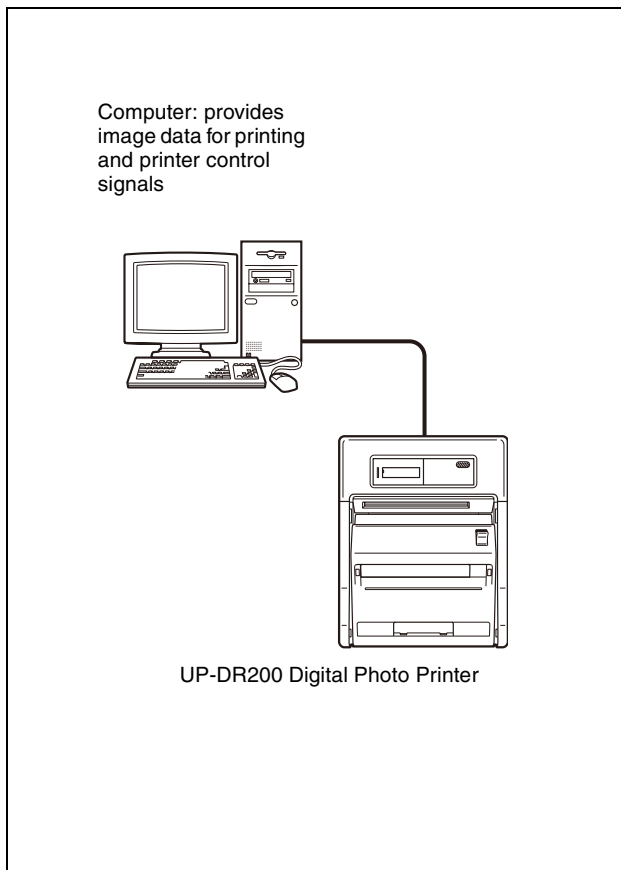

Location and Function of Parts and Controls

For more details, see the reference page numbers enclosed in parentheses.

Front

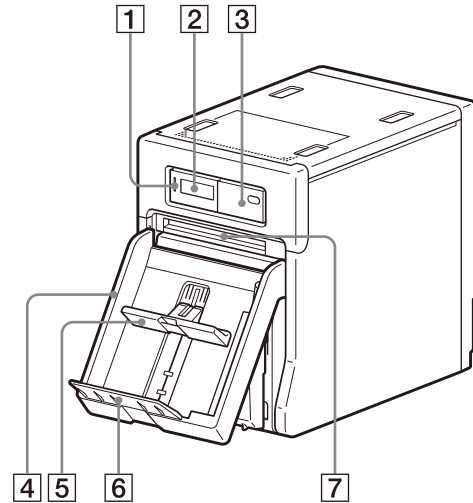

Output tray removed

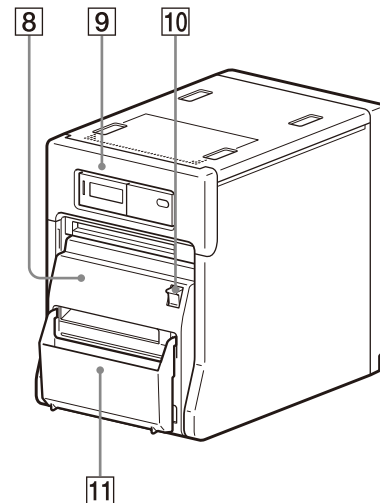

- 1 ALARM indicator (page 28)**
Lights in red when the system is initialized, or when an error occurs.
- 2 LCD (liquid crystal display) (page 18, 21, 28)**
Displays the number of pages printed, or the amount of ink ribbon remaining. Messages are displayed when an error or warning condition occurs.

3 Operation button door (page 19)

Buttons to be used for menu operation are located under this door.

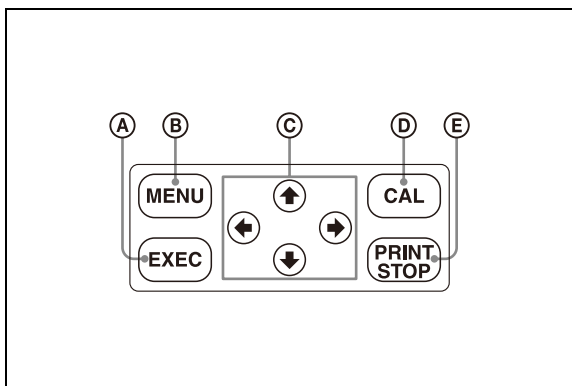
Key panel section**(A) EXEC button (page 20)**

Press this button to print the gray scale adjustment pattern.

(B) MENU button (page 21)

Press this button to carry out menu operations. Pressing the MENU button changes the printer to the off-line mode.

(C) Cursor buttons (page 21)

Press these buttons to select the item to be displayed on the LCD.

(D) CAL (calibration) button (page 19)

Press this button to adjust the gray balance.

(E) PRINT STOP button (page 19)

Pressing the PRINT STOP button for more than one second during printing results in cancelling the number of printings set and clearing the images stored in the memory. The printer stops printing when the page currently printing is completed and ejected.

4 Output tray (page 13)

Collects printouts that are ejected.

5 Output stopper (page 13)

Adjust the position according to the printing pack in use. There are four positions to which to adjust.

6 Output tray adapter (page 14)

Attach this to the output tray to prevent printouts from falling out.

7 Output slot (page 18)

Printouts are ejected from here.

8 Paper door (page 10)

Open and close this when replacing paper rolls. This does not open while printing is in progress.

9 Ribbon door (page 12)

Open and close this when replacing the ink ribbon. This does not open while printing is in progress.

10 Paper door lever

Use this to open the paper door.

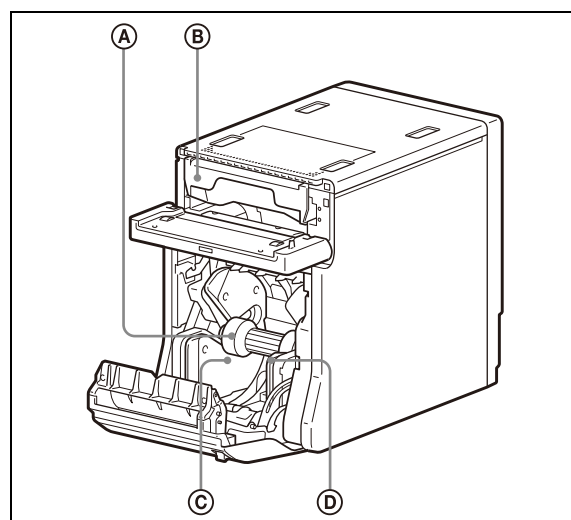
When the paper and ribbon doors are open**(A) Paper core**

Insert this into the paper roll.

(B) Ribbon tray

Place the ink ribbon here.

(C) Paper adapter (blue)**(D) Paper adapter (pink)**

Attach the paper adapters to the printer when using the 2UPC-R203/R205 series printing pack.

11 Scrap receptacle (page 13)

Margins of empty space are crated between each printout. These margins are cut off during printing and dropped into this receptacle.

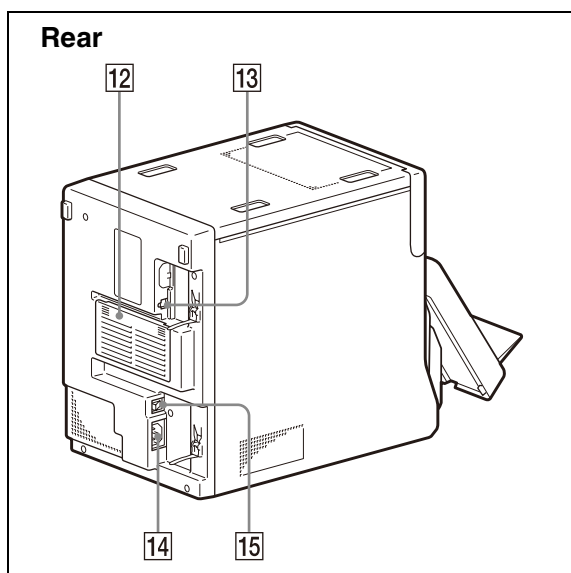
**12 Filter cover (page 26)**

The filter for the printer's cooling fan is attached to this cover.

13 Ψ USB connector (page 8)

Connects to a computer equipped with USB interface (conforming to USB 2.0) via the supplied USB cable.

14 ① POWER switch (page 18)

Press this to turn the printer on and off.

15 ~ AC IN connector (page 8)

Connect the power cord here.

Supplied Accessories

Make certain you have received the following accessories:

Output tray (1)

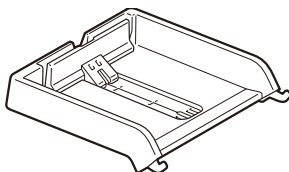

Output tray adapter (1)

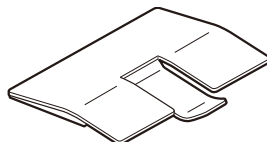

Scrap receptacle (1)

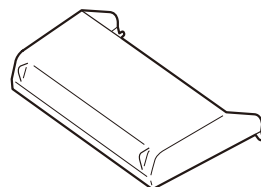

Cleaning ribbon (1)

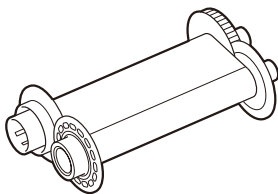

Ribbon tray* (1)

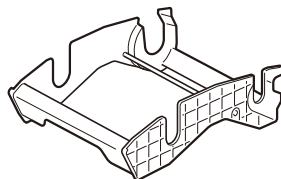

Paper core* (1)

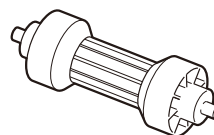

Paper adapter (blue)* (1)

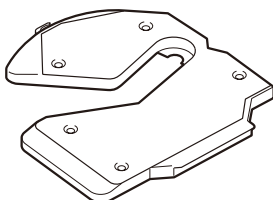

Paper adapter (pink)* (1)

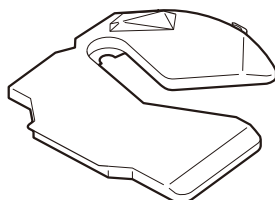

CD-ROM (1)
USB cable (1)
Before Using This Printer (1)
Software License Agreement (1)
Warranty Card (1)
Service and Customer Support
Information (1)

* The paper core is located inside the printer and must be removed when loading or removing paper.
For details on removing the core, see "Loading the Paper Roll and Ink Ribbon" on page 9.

Notes

- When taking the printer out of the carton box, be careful not to hurt your back.
- The packaging materials are needed when transporting the printer, so we suggest you keep them.
- Do not transport the printer with the ink ribbon and paper roll attached.

Connections

After connecting a USB connecting cable (supplied) to the printer and the computer, connect the power cord. For details about the printer connection, refer to the manuals for the computer or other peripheral devices.

USB Port Connection

Notes

- Follow the connection procedures described in the computer manual.
- Make sure that the interface cable is connected securely at both ends.
- The printer drive software provided with the printer is not suitable for using the printer connected to a network.
- Operation of the printer is not guaranteed for connection to a USB hub.

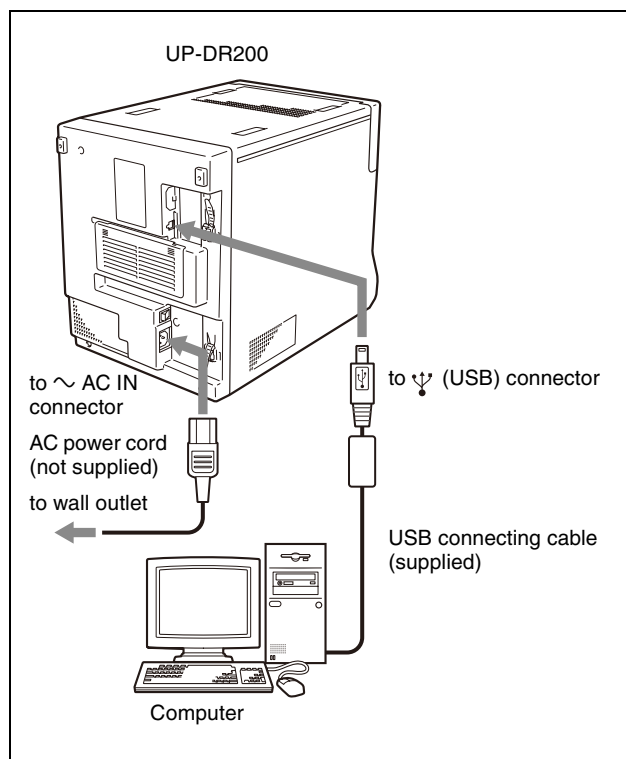

Securing the USB cable and power cord

To prevent disconnection of the USB cable and power cord from accidental pulling, be sure to secure the cables with the cable clamps when connecting them to the printer.

To secure the USB cable

Wrap the cable clamp around the USB cable, and fasten it securely as shown.

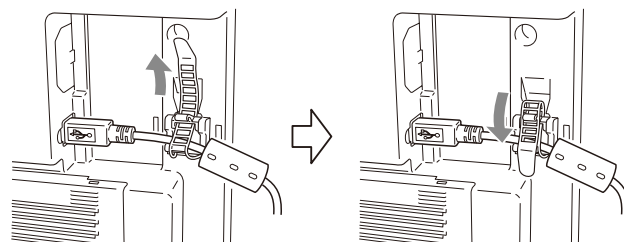

To secure the power cord

Wrap the cable clamp around the power cord, and fasten it securely as shown.

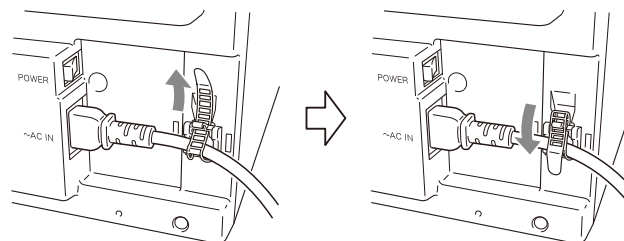

Installing the Printer Driver

To install the printer driver, follow the instructions in the ReadMe.txt file and the install guide on the supplied CD-ROM.

Loading the Paper Roll and Ink Ribbon

This section describes how to load the paper roll and ink ribbon in the preparation to start printing, after connecting the printer as described on page 8.

Handling the Paper Roll and Ink Ribbon

Notes

- Each printing pack contains two sets of the ink ribbon and paper roll combination. Use the ink ribbon and the paper roll in the carton as a set. Do not mix with other varieties of ribbon or paper roll. (See “Ink Ribbon and Paper” on page 27.)
- The number of sheets that can be printed differs depending on the printing pack. One set of the ink ribbon and paper roll allows you to print the following number of sheets.

Printing pack	2UPC-R203 series	2UPC-R204 series	2UPC-R205 series	2UPC-R206 series
Print capacity	770 sheets	700 sheets	400 sheets	350 sheets
Print size	89×127 mm 3.5×5 inches	102×152 mm 4×6 inches	127×178 mm 5×7 inches	152×203 mm 6×8 inches

- Do not replace the printing pack if it has only been partially used. If the paper roll or ink ribbon is replaced after only partial use, the above print capacities are not guaranteed.
- When setting the paper roll down, place it vertically as shown. If you place the paper roll horizontally, the paper may roll around and fall. This may cause an injury.

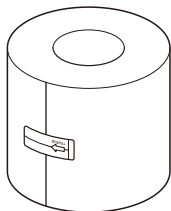

- Hold the paper roll with both hands so that you do not drop it, because it is heavy. Dropping may result in an injury.

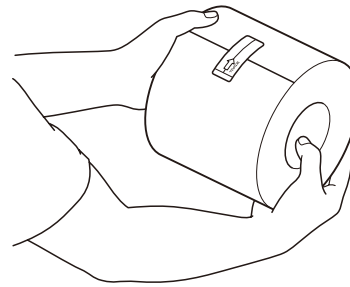

Hold the paper roll with both hands.

- Do not detach the black and white spools of the ink ribbon until you start loading the ink ribbon.
- An IC chip is embedded in the black spool. **Do not touch the terminals on the IC chip with your hands or metal objects, and do not dent, drop, or otherwise apply shock to the IC chip.** Doing so may cause the ink ribbon to become unusable.

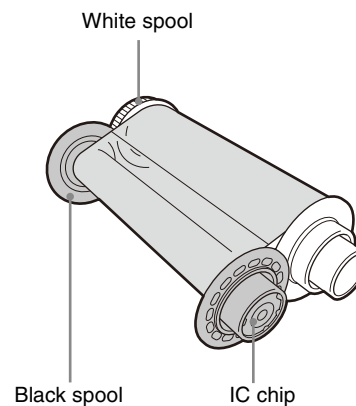

Loading the Paper Roll and Ink Ribbon

When you use the printer for the first time, load the paper roll and ink ribbon.

For detailed information on how to remove the paper and ink ribbon, see “Removing the Ink Ribbon and Paper” on page 16.

Before loading the paper roll and ink ribbon

Confirm that the printer is powered on. If not, turn the printer power on.

Otherwise, the automatic paper feeding may not be done correctly after loading of the paper roll and ink ribbon is completed.

Also, after you have used up one paper roll, clean the thermal head and rollers before loading a new paper roll and ink ribbon.

For detailed information on cleaning, see “Cleaning the Interior” on page 24.

Note

If you use the 2UPC-R204 series or 2UPC-R206 series Printing Pack with the 152-mm (6-inch) paper width after using the 2UPC-R203 series or 2UPC-R205 series Printing Pack with the 127-mm (5-inch) paper width, white stripes may appear on either side of printouts. Be sure to clean the inside of the printer before printing (page 24).

To load the paper roll**Notes**

- Be sure to remove the output tray and the scrap receptacle before loading the paper roll.
- Be careful that your fingers and clothing are not caught in the paper door or on the protuberance in the opening of the door.

- 1 Press and lower the paper door lever, hold the paper door at the center portion, and pull the door forward until it locks into the open position.

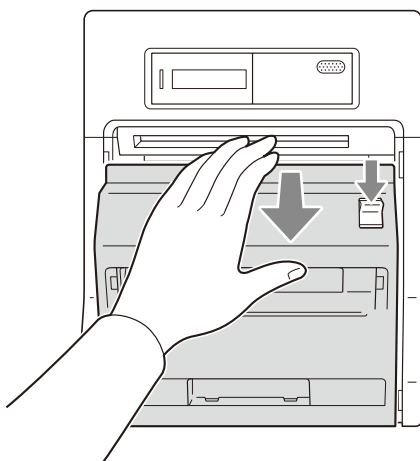

- 2 Remove the paper core from the printer.

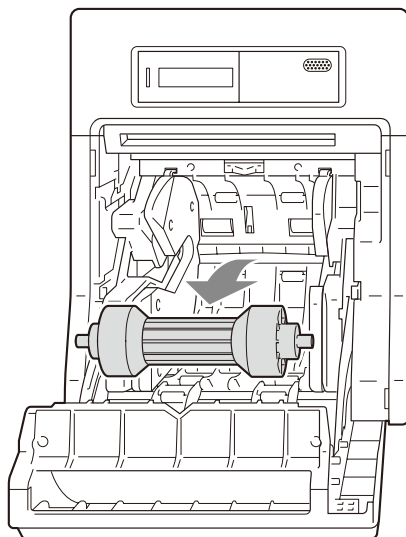

- 3 Insert the paper core into the paper roll. The two sides of the paper core are the same shape. You can insert either side.

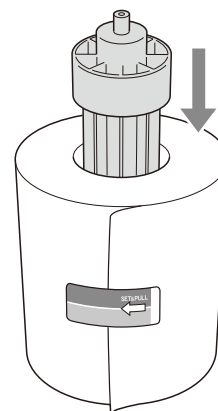
**Notes**

- If the edges of the paper on the roll are not aligned before inserting the paper core, be sure to align them while being careful not to bend or damage them. Not doing so may result in malfunction.

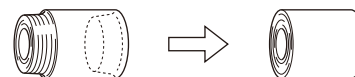

- If the leading edge of the paper is bent or damaged as a result of a paper jam, for example, be sure to use scissors to cut off the damaged portion, as shown, before inserting the paper.

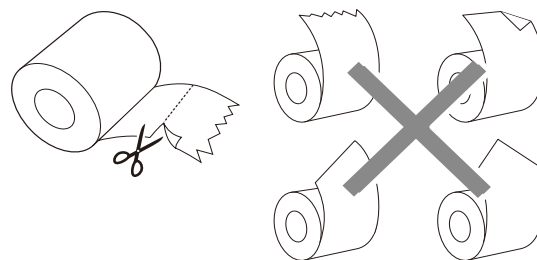

- Do not bump the paper roll against hard objects or squeeze it tightly. Doing so may bend or crease the paper and affect print quality.

- 4 Depending on the width of your paper roll, attach or remove the paper adapters.

Paper with 127-mm (5-inch) width: 2UPC-R203 series and 2UPC-R205 series Printing Pack

Attach the blue paper adapter to the left side of the printer, and the pink paper adapter to the right side.

(When the factory is shipped, the paper adapter is attached.)

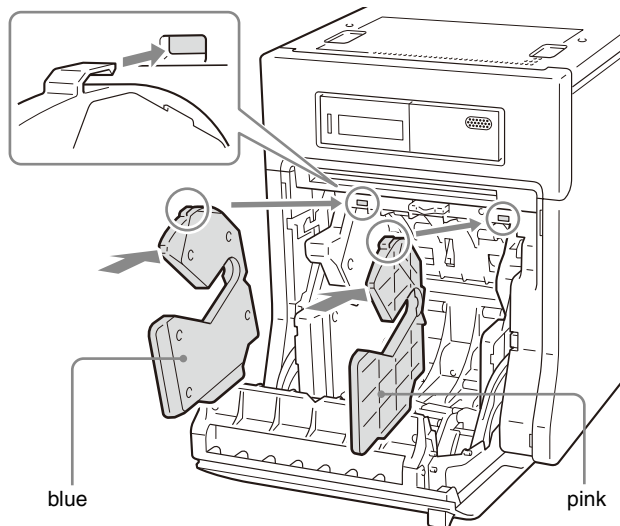

Press the portions indicated by the arrows until the tabs at the top lock into place.

Paper with 152-mm (6-inch) width: 2UPC-R204 series and 2UPC-R206 series Printing Pack

Remove the blue and pink paper adapters from the printer.

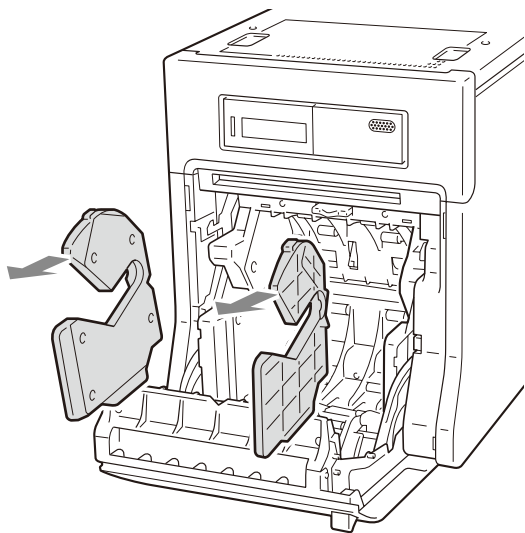

Note

Store removed paper adapters in a safe place.

- 5** Load the paper roll into the printer.
Be sure to load the paper roll with the arrow on the seal pointing inside the printer.

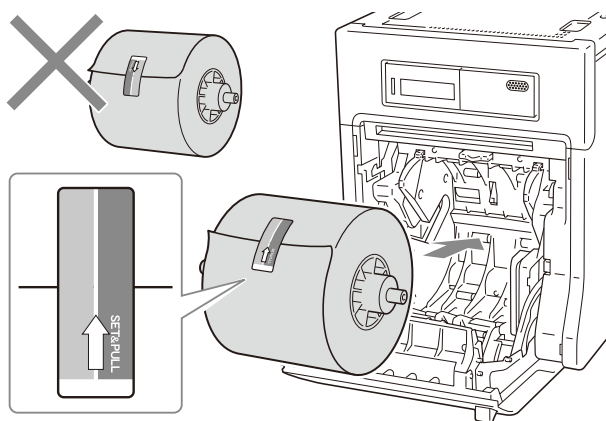

Notes

- To prevent the paper roll from sliding off, hold both sides of the paper core when loading it into the printer.
- Do not touch the print surface (inner surface of the paper) after the paper is loaded. Fingerprints, sweat, and creases in the paper may affect print quality.
- Be sure to insert the paper roll fully into the printer.

- 6** Remove the seal affixed to the paper roll.

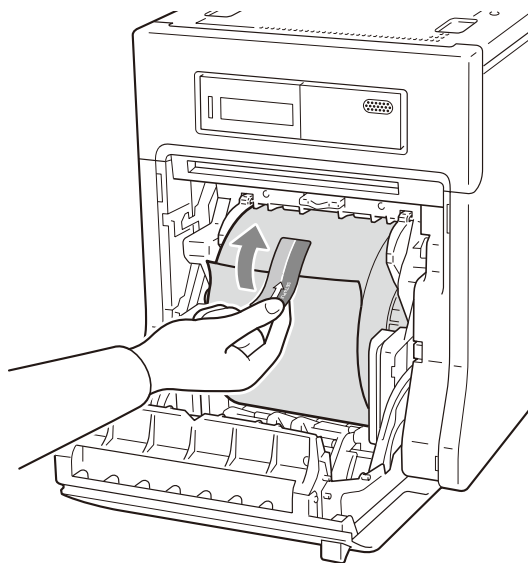

Note

Be sure to remove the seal completely. In addition, remove the seal slowly to avoid leaving parts of the adhesive on the paper. If any part of the seal is left inside the printer, malfunctions may occur.

- 7** Close the paper door, and press the center of the door until it clicks into place.

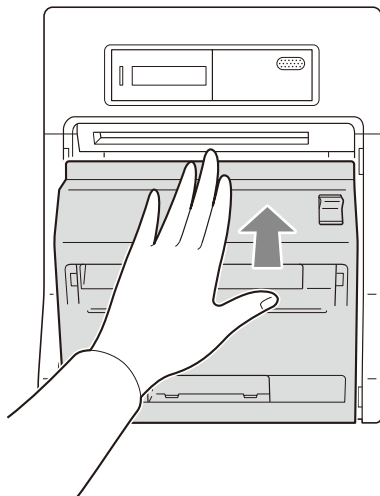

Notes

- If you close the door by pressing only its sides, the door may not lock into place properly.
- When closing the paper door, be sure that the front edge of the paper is not caught in the door.

To load the ink ribbon

- 1** Pull the ribbon door toward you to open it.

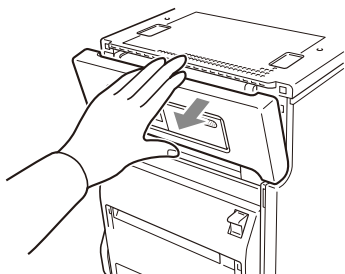

- 2** Remove the ribbon tray.

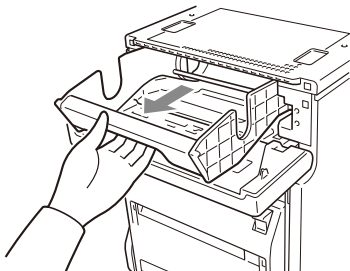

Note

After removing the ribbon tray, do not insert your hand into the opening in the printer. Touching the protrusions or movable parts inside the printer may result in bodily injury or malfunction of the printer. In particular, touching the thermal head when it is hot immediately after printing may result in burns.

- 3** Detach the white spool of the ink ribbon from the black spool.

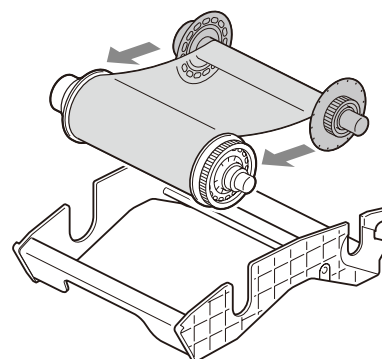

- 4** Gently unravel the ribbon without loosening it, and place it in the ribbon tray.

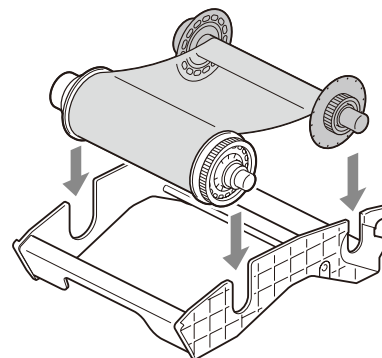

Place the white spool in the front holder and the black spool in the rear holder as shown.

Note

If the ink ribbon is loosely raveled around the spools or there is any slack or creases in the ink ribbon, wind the spools to tighten the slack and smooth out the creases.

- 5** Hold the center of the ribbon tray, and load it into the printer.

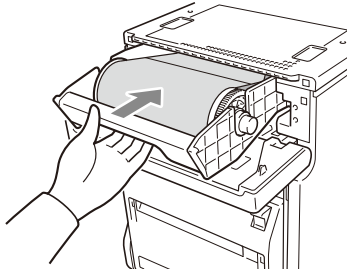

Notes

- Always hold the center of the ribbon tray when loading it into the printer. If you hold the tray by any other part, your fingers may get caught while inserting the tray and injuries may result.
- Be sure to insert the ribbon tray fully into the printer.

- 6** Close the ribbon door.

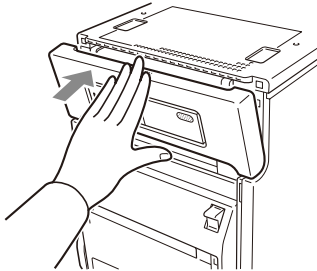

Notes on storage

- Avoid placing the printer where it will be subject to:
 - high temperatures,
 - high humidity or dust,
 - direct sunlight.
- After opening the bag, use the ribbon and the paper as soon as possible.
- When transporting or storing the paper roll and ink ribbon after partial use, we recommend putting them back into their respective bags.

Attaching the Scrap Receptacle

When printing, a margin of empty space is left between each printout. These excess portions are cut off and dropped into the scrap receptacle. Remove scraps from the receptacle as soon as possible.

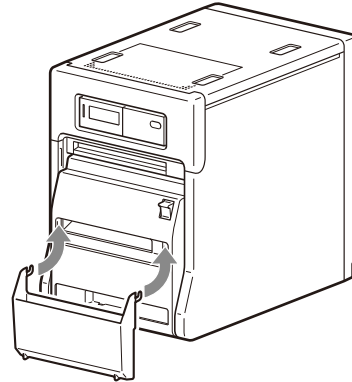

Note

If the scrap receptacle becomes too full, scraps that are cut off may be unable to eject. This may result in malfunction. Remove scraps from the receptacle as soon as possible, and be sure to empty the receptacle whenever you replace a paper roll.

Attaching the Output Tray

When printing, printouts are ejected from the printer and collect in the output tray.

- 1** Attach the output tray to the printer.

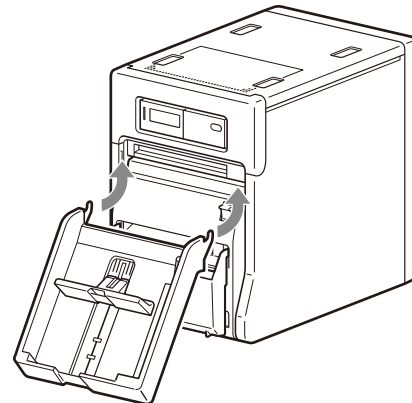

Attaching the Output Tray Adapter

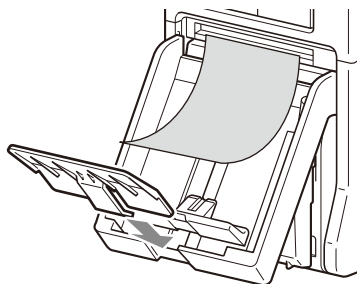

The output tray adapter prevents printouts from sticking out of the output tray.
Use the adapter when printouts curl as shown.

Note

About 20 printout sheets can be stored in the output tray in most cases. However, this number can vary greatly depending on the amount of curling in printouts. In general, you should remove ejected printouts as soon as possible.

Adjust the position of the output stopper according to the printing pack in use and the amount of curling in printouts. There are four positions to which to adjust.

Note

If the output stoppers are not positioned correctly, paper jams may occur.

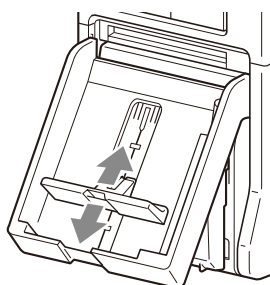

When using the 2UPC-R203 series or 2UPC-R204 series printing pack

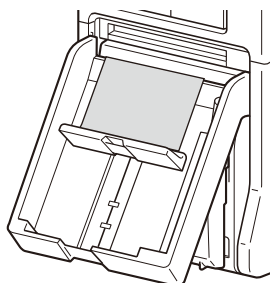

Set the output stopper to the top position.

When using the 2UPC-R205 series printing pack

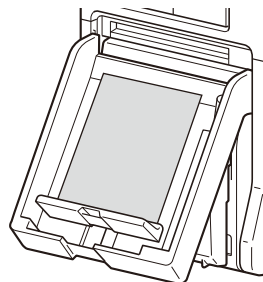

Set the output stopper to the third position from the top.
If there is a large amount of curling in the printouts, set the stopper to second position from the top.

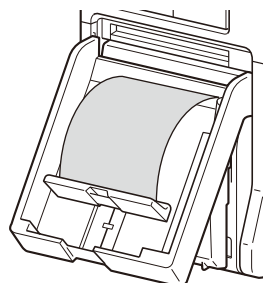

When using the 2UPC-R206 series printing pack

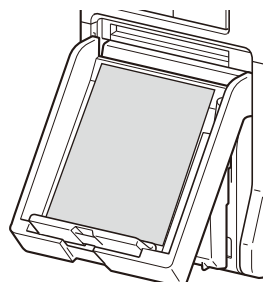

Set the output stopper to the bottom position.
If there is a large amount of curling in the printouts, set the stopper to second position from the bottom.

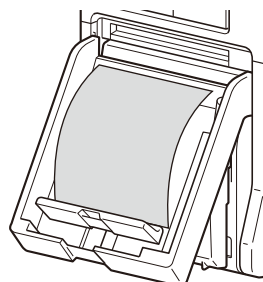

To remove the output tray

Hold the output tray on both sides, and ① raise the tray while ② pulling it toward you.

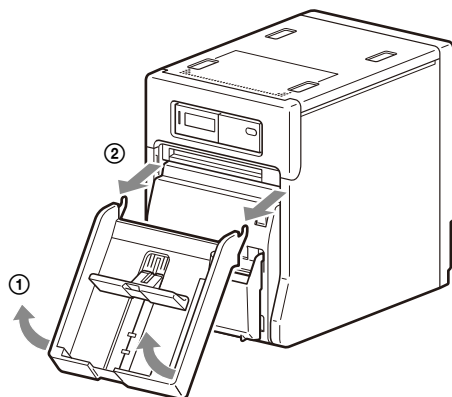

If the Ink Ribbon Breaks during Use

The remaining ribbon can be used after repairing it with adhesive tape.

- 1 Open the ribbon door, and remove the ribbon tray.
- 2 Pull the ribbon on the white spool, attach one edge of a strip of adhesive tape along the entire length of the ribbon's end, and then attach the other edge of the tape to the ribbon on the black spool.

- ① Wind the spool to feed the ribbon out.
- ② Attach the adhesive tape along the entire length of the white spool's ribbon end, and attach it to the ribbon on the black spool.

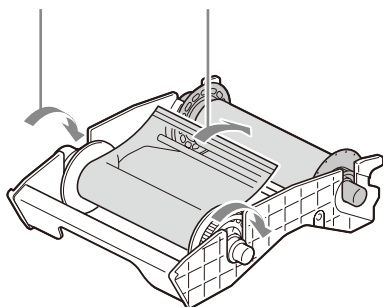

- 3 Remove any slack from the ribbon.

Wind the black spool to remove any slack.

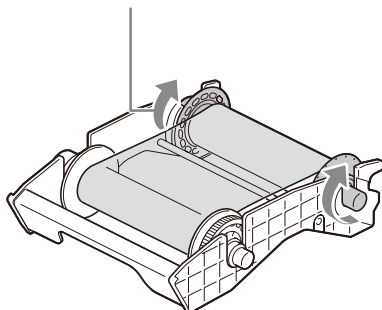

Note

Be sure to wind the taped portion completely onto the black spool so that the tape is not exposed.

- 4 Hold the center of the ribbon tray, and load it into the printer.

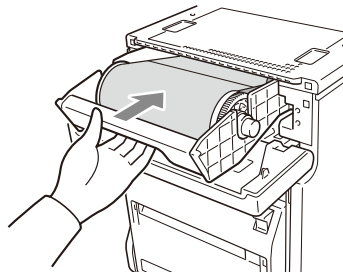

Note

Always hold the center of the ribbon tray when loading it into the printer. If you hold the tray by any other part, your fingers may get caught while inserting the tray and injuries may result.

- 5 Close the ribbon door.

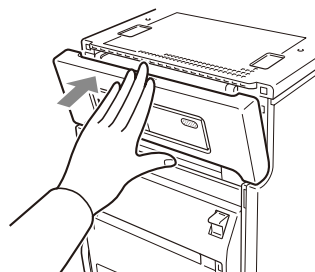

Depending on the position of the ribbon break, a single printout's worth of ribbon may be lost.

Removing the Ink Ribbon and Paper

When the following message appears on the LCD, the paper or ink ribbon corresponding to the designated number of sheets has been used up.

Proceed as follows to remove the ink ribbon and paper roll, and then load a new ink ribbon and paper roll.

LOAD NEW PAPER & RIBBON

Note

The above message is set to appear before the ink ribbon and paper roll are completely used up. Even if there is some ink ribbon and paper remaining, be sure to load a new ink ribbon and paper roll.

- 1 Remove the output tray.

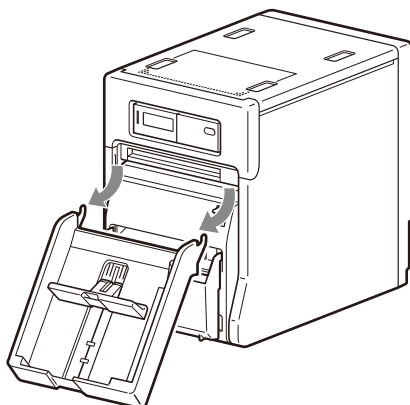

- 2 Remove and empty the scrap receptacle.

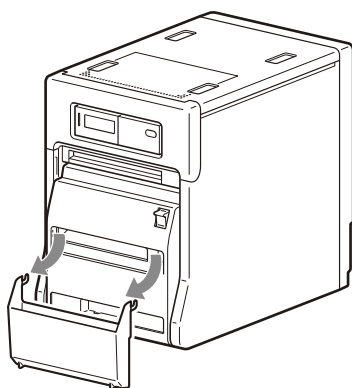

Note

If the scrap receptacle becomes too full, scraps that are cut off may be unable to eject. This may result in malfunction. Be sure to empty the scrap receptacle each time you replace the paper roll.

- 3 Press and lower the paper door lever, hold the paper door at the center portion, and pull the door forward until it locks into the open position.

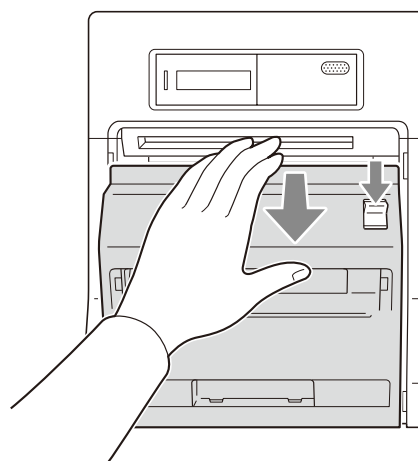

- 4 Remove the paper roll.

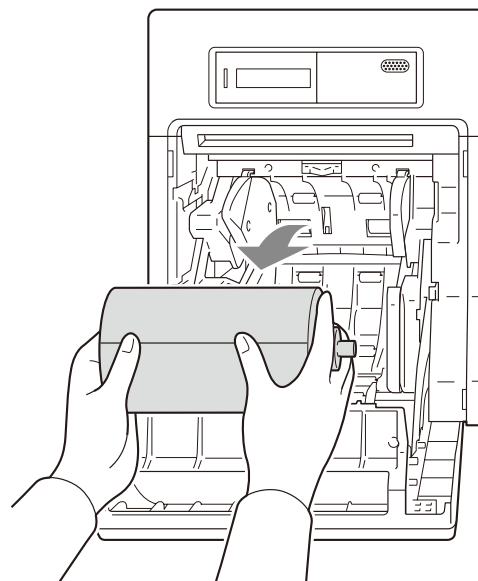

- 5 Remove the paper core from the paper roll.

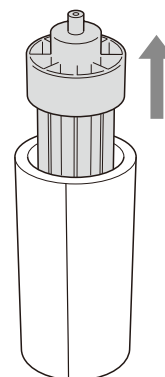

Note

The paper core is reusable. Do not throw it away.

- 6** Pull the ribbon door toward you to open it.

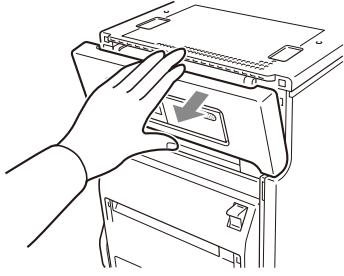

- 7** Remove the ribbon tray.

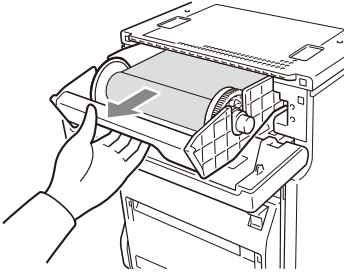

- 8** Remove the ink ribbon.
After removing the ink ribbon, attach the black spool to the white spool.

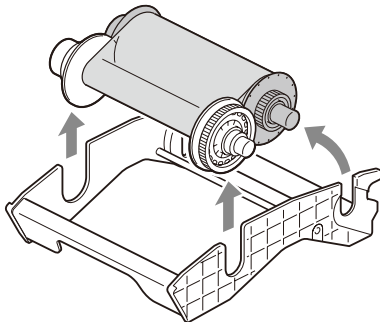

Do not reuse ink ribbons that have reached their prescribed print capacities and have been removed.

Note

The ribbon tray is reusable. Do not throw it away.

If you have to replace a partially used printing pack

We recommend replacing ink ribbons and paper rolls with new printing packs only when the predetermined number of sheets is used up.

If you have to replace a partially used ink ribbon and paper roll, proceed as follows to replace the partially used ink ribbon and paper with new ones.

Note

If you replace a partially used ink ribbon and paper, the remaining amount of ink ribbon displayed may not be correct.

- 1** Press and lower the paper door lever, and pull the paper door toward you until it locks into the open position.
- 2** Remove the paper roll.
- 3** Wind the paper roll tightly, and attach a piece of adhesive tape to prevent loosening.
- 4** Open the ribbon door.
- 5** Remove the ribbon tray, and replace the ink ribbon.
- 6** Load the ribbon tray into the printer, and close the ribbon door.
- 7** Load the paper roll supplied with the ink ribbon loaded in step 5, and close the paper door.

Be sure to retain the removed paper roll and ink ribbon as a pair.

Note

If you replace ink ribbon and paper roll which have been partially used, paper equal to several sheets are wasted and you may not be able to print the number of sheets specified.

For detailed information on the number of sheets that can be printed, see “Printing capacity” on page 27.

Printing from the Computer

Before starting to print

- Confirm that the printer and computer are connected (page 8).
- Confirm that the paper roll and the ink ribbon are correctly installed (page 9).
- Confirm that the output tray is adjusted to suit the paper to be used (page 14).
- Confirm that compatible ink ribbon and printing paper are installed (page 27).

Note

Do not look into the paper output slot during printing. The sharp edge of the printout may poke your eye or face. This may cause loss of sight. Also, do not insert a foreign object in the paper output slot. The cutter may be damaged or broken and a piece of the cutter can cut you.

Printing

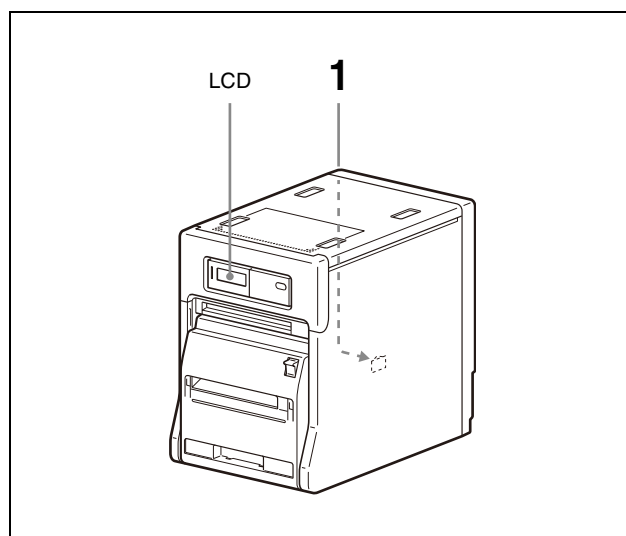

- 1 Turn on the printer and computer. After a few seconds, the following message should appear on the LCD. While READY is being displayed on the LCD, the printer is ready to print.

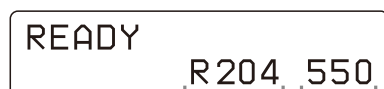

Printing pack currently used

Displays the remaining amount of ink ribbon, whichever is less.

Identification of the printing pack currently being used on the LCD

Display on the LCD	Printing pack
R203	2UPC-R203 series
R204	2UPC-R204 series
R205	2UPC-R205 series
R206	2UPC-R206 series

Notes

- Don't turn the printer on again within 5 seconds after turning it off.
- Do not turn the computer off and on again while it is accessing a hard or another disk.

- 2 Send the image data from the computer to be printed. The printer starts printing. For details, refer to the instructions for the printer driver included on the CD-ROM disc supplied.

- ① While the printer is receiving the image data, the following message should appear.

TRANSFER USB
R204 550

- ② The printer starts printing the transferred image data as soon as the print command is sent from the computer. The following message should appear.

Number of pages to be printed

PRINTING 2
[MAGENTA] 204 450

The color indication changes as the color printing proceeds:
Start→YELLOW→MAGENTA→CYAN→LAMI→Finsih.

- ③ After printing is finished, the printed paper is ejected from the output slot. The printing time depends on the image size, ink ribbon and the paper. Once printing has been completed, READY appears on the LCD again.

READY
R204 548

Notes

- About 20 printout sheets can be stored in the output tray in most cases. However, this number can vary greatly depending on the amount of curling in printouts. In general, you should remove ejected printouts as soon as possible. Additionally, you must adjust the position of the output stopper according to the printing pack you will use.
For details, see “Attaching the Output Tray” on page 13.
- Do not touch a printout until it is completely ejected from the printer. If you touch the printout while it is being ejected, it may not be printed properly.

To stop printing midway

Press and hold the PRINT STOP button for more than one second. The page currently being printed is completed and ejected. After the printout is ejected, the information display returns to READY. The image data stored in the memory and the number of printings set in the queue are cancelled.

PLEASE WAIT
R204 459

Memory capacity

Image data transferred from the computer is stored in the memory of the printer. Data for one more image can be stored in addition to that of the one being printed.

If the printer does not print

When an error message is displayed on the LCD, you cannot operate the printer. Take remedies according to the advice given in “List of Messages” on page 28.

Notes on storing your printouts

- Avoid exposure to direct sunlight, or conditions of high temperature and high humidity, which could cause the colors to fade.
- Avoid applying tape to a printout, and avoid contact with plastic objects such as erasers and desk mats.
- Do not allow alcohol or other volatile organic solvents to come into contact with the printouts.

Menu Operations

You can adjust or confirm the following items using the menu.

- Adjustment of the gray balance
- Display of the total quantity of pages printed
- Display of the firmware version of the printer

Preparation for Menu Operation

Use the MENU button to perform menu operations. The MENU button is located under the operation button door.

- 1 Press the top right of the operation button door.

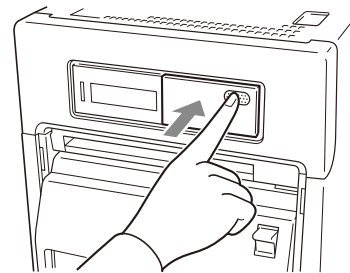

The door opens, revealing the operation buttons.

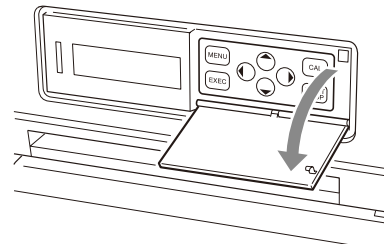

- 2 Carry out the operation using these buttons including the MENU button.

Adjusting the Gray Balance

Use the ink ribbon with the paper that is supplied as a set in the same package. The gray balance of the printer is set to No. 0, which is designated as the achromatic color, as the factory setting. If you want to change the gray balance, proceed as follows. This setting is retained even when the printer is turned off.

There may be differences among packages where the ink ribbon and paper rolls are contained as a set due to handling during transportation and storage.

Note

The gray balance of images cannot be adjusted during printing.

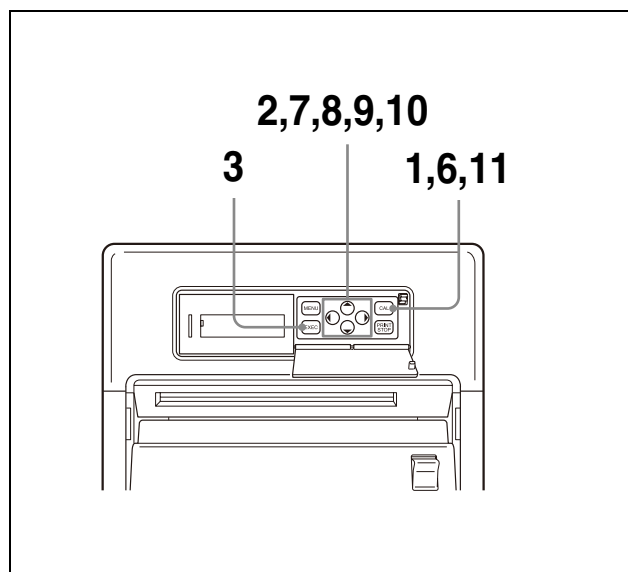

- 1 Press the CAL button.
The printer is switched to off-line.
- 2 Press the \uparrow and \downarrow buttons to select GRAY PATCH PRINT.

Press \uparrow and \downarrow to display GRAY PATCH PRINT.

```
GRAY PATCH PRINT
[A+B]          [EXEC]
```

- 3 Press the EXEC button.
The printer returns to the on-line mode and starts printing.
When using the 2UPC-R203 series or 2UPC-R204 series, gray adjustment patterns Group A and Group B are printed on two sheets separately.
When using the 2UPC-R205 series or 2UPC-R206 series, gray patterns Group A and Group B are printed on one sheet.
- 4 Look at the printout of Group A, and determine the best gray balance from pattern numbers 0 to 88.
- 5 Look at the printout of Group B, and determine the best gray balance from pattern numbers 0 to 88.
- 6 Press the CAL button.
The printer is switched to off-line.

- 7 Press the \uparrow and \downarrow buttons to select GRAY ADJUST [A].
The printer enters the gray balance adjustment mode.

Press \uparrow and \downarrow to display GRAY ADJUST [A].

```
GRAY ADJUST[A]
< 0 >          [0-88]
```

- 8 Press the \leftarrow and \rightarrow buttons to display the pattern number determined in step 4.
For example, select 18 if you determined that pattern No. 18 in the sample provides the best color tone of the gray balance.

```
GRAY ADJUST[A]
<18>          [0-88]
```

Press \leftarrow and \rightarrow to display 18.

- 9 Press the \uparrow and \downarrow buttons to select GRAY ADJUST [B].
The printer enters the gray balance adjustment mode.

Press \uparrow and \downarrow to display GRAY ADJUST [B].

```
GRAY ADJUST[B]
< 0 >          [0-88]
```

- 10 Press the \leftarrow and \rightarrow buttons to display the pattern number determined in step 5.
For example, select 39 if you determined that pattern No. 39 in the sample provides the best gray balance.

```
GRAY ADJUST[B]
<39>          [0-88]
```

Press \leftarrow and \rightarrow to display 39.

- 11 Press the CAL button.
The printer returns to the on-line mode.

Displaying the Quantity of Pages Printed

The total number of printings done since turning on the printer can be displayed. If no printings have been done since the printer was turned on, "0" is displayed on the information display. Also, the total number of printings made so far since you started to use the printer can be displayed.

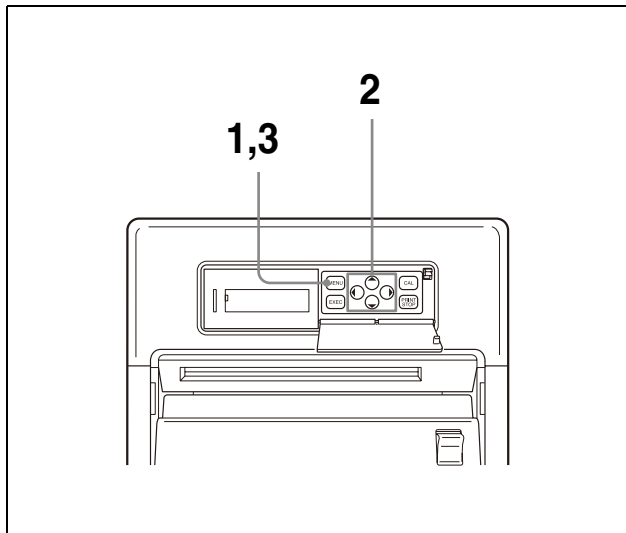

- 1 Press the MENU button.
The printer is switched to off-line.
- 2 Press the \uparrow and \downarrow buttons to select the item you want to be displayed.

To display the total number of printings since turning on the printer:

Select CURRENT PRINTS.

Press \uparrow and \downarrow to display CURRENT PRINTS.



Total number of printings

To display the total number of printings made so far since you started to use the printer:

Select TOTAL PRINTS.

Press \uparrow and \downarrow to display TOTAL PRINTS.

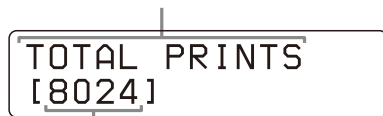

Total number of printings

- 3 Press the MENU button after confirming.
The printer returns to the on-line mode.

Displaying the Firmware Version of the Printer

The version of the firmware of the printer can be displayed.

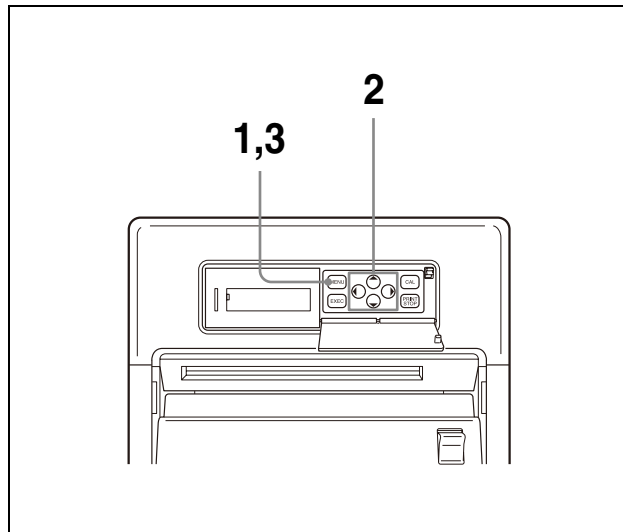

- 1 Press the MENU button.
The printer is switched to off-line.
- 2 Press the \uparrow and \downarrow buttons to display VERSION.

Press \uparrow and \downarrow to display VERSION.



Version of the firmware of the printer

- 3 Press the MENU button after confirming.
The printer returns to the on-line mode.

Adjusting the Position of the Printout Image

You can adjust the position of the printout image as shown in the illustration in step 3, below, for the 2UPC-R203 series and the 2UPC-R205 series. Adjust the image position, as required, or when the blank portion appears on the edge of the printout.

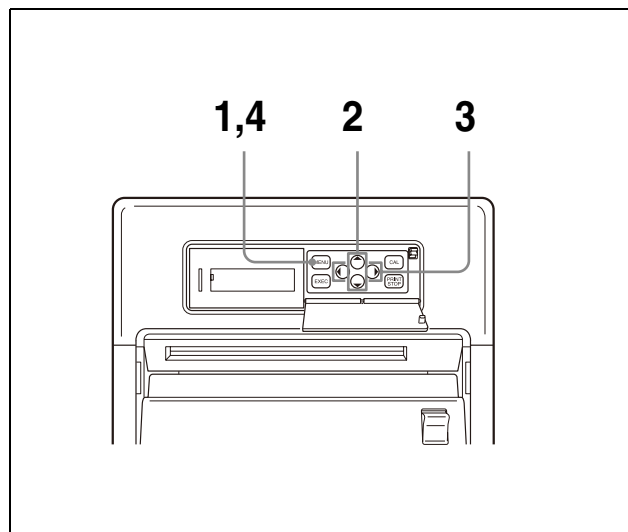

- 1** Press the MENU button.
The printer is switched to the off-line mode.

- 2** Press the \updownarrow and $\leftarrow\rightarrow$ buttons to display PRINT OFFSET.

Press \updownarrow and $\leftarrow\rightarrow$ until PRINT OFFSET appears.



The offset amount for the current position

- 3** Press the $\leftarrow\rightarrow$ and \updownarrow buttons to shift the printout image to the desired position, while looking at the printout.
L1: Moves to the left by 0.6 mm from the default position.
L2: Moves to the left by 1.2 mm from the default position.
R1: Moves to the right by 0.6 mm from the default position.

R2: Moves to the right by 1.2 mm from the default position.

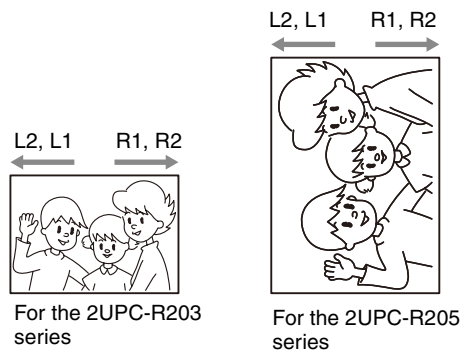

To return to the default position
Display 0.

- 4** Press the MENU button after completing the adjustment.
The printer returns to the on-line mode.

Access the following site to get the latest information on the printer.
<http://www.sony.net/Products/DP-driver/>

Precautions

Safety

- Operate the printer using the power source specified in “Specifications” (page 27).
- Be careful not to damage the power cord by placing or dropping heavy objects on it; it is dangerous to use the unit with a damaged power cord.
- If you do not intend to use the unit for a long time, disconnect the power cord.
- Unplug the power cord by grasping the plug, not the cable itself.
- Do not disassemble the unit. There is a danger of electric shock from the internal parts.
- Be careful not to spill water or other liquids on the unit, or to allow combustible or metallic material to enter the cabinet. If used with foreign matter in the cabinet, the unit is liable to fail, or present a risk of fire or electric shock.
- If the unit malfunctions or if a foreign body falls into the cabinet, disconnect the power immediately and consult your Sony service facility or your Sony dealer.

On condensation

- If the printer is subjected to wide and sudden changes in temperature, such as when it is moved from a cold room to a warm room or when it is left in a room with a heater that tends to produce quantities of moisture, condensation may form inside the printer. In such cases the printer will probably not work properly, and may even develop a fault if you persist in using it. If moisture condensation forms, turn off the power and leave the printer standing for at least one hour.
- If the printing pack is subjected to wide and sudden changes in temperature, condensation may form on the ink ribbon or paper inside. This will cause the printer to malfunction. Also if the printing pack is used in this state, spots are likely to appear on the printout.
- To store a half-used printing pack, replace it in its original packing and reseal the package. If possible, keep the sealed printing pack in a cool, dark location. To subsequently use the printing pack, place it, in its sealed package, in a warm room for several hours. Doing so prevents condensation from forming when the printing pack is removed from its package.

Installation

- Avoid placing the unit in a location subject to:
 - mechanical vibration
 - high humidity
 - excessive dust
 - direct or excessive sunlight
 - extremely high or low temperatures
- Ventilation holes are provided to prevent the unit from overheating. Be careful not to obstruct them with other objects or by covering the unit with a cloth etc.

Ventilation holes

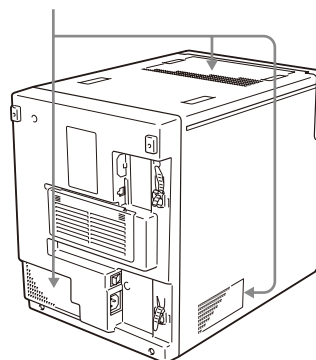

Note

If you obstruct ventilation holes, the unit may not offer full performance.

On Transporting the Printer

Do not transport the printer with the supplied accessories, ink ribbon and paper roll attached. Doing so may cause a malfunction. **It is recommended that you store the ink ribbon and paper roll in the package they came in after you remove them.**

Cleaning

Note

Be sure to turn off the printer and unplug the power cord before cleaning.

When the cabinet becomes dirty

If the cabinet is dirty, wipe it using a cloth that has been soaked in water or mild detergent diluted in water, and thoroughly wrung out. Wipe the cabinet dry using a dry cloth.

Do not use any type of solvent, such as alcohol or benzene or chemical cloth, which may damage the finish.

Cleaning the Interior

If defects such as white stripes and speckled scratches begin to appear in printouts, you may need to clean the thermal head and rollers. To prevent such occurrences, we recommend regular cleaning of the thermal head and rollers using the printing pack replacement cycle (when one printing pack runs out) as a reference.

Cleaning the thermal head is effective in removing white stripes, while cleaning the rollers is effective in removing speckled scratches. When cleaning the interior, always clean the thermal head before cleaning the rollers. You can also end the cleaning process after cleaning only the thermal head.

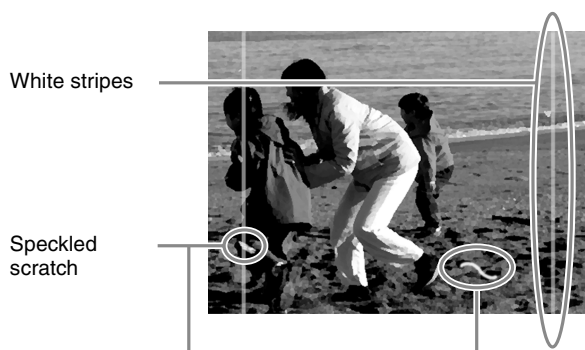

The following items are necessary to perform interior cleaning.

- The cleaning ribbon supplied with the printer (used for cleaning the thermal head and rollers)
- The cleaning sheet (Cleaning Sheet 200) supplied with the printing pack (used for cleaning the rollers)
- Print paper (used for cleaning the thermal head and rollers)

Notes

- The cleaning ribbon is reusable. Do not throw it away.
- As the cleaning sheet is not reusable, discard it after the first use.
- If there is insufficient print paper remaining, an error may occur. If this occurs, replace the print paper and begin the cleaning process again.

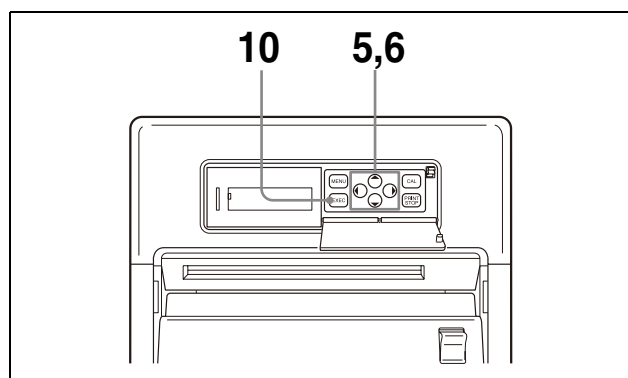

- 1 Remove the output tray and scrap receptacle.
- 2 Check the remaining amount of print paper.
- 3 Open the ribbon door, and remove the ribbon tray.
- 4 Remove the ink ribbon, and replace it with the cleaning ribbon.

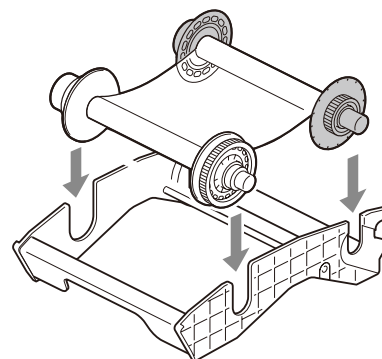

- 5 Load the ribbon tray into the printer, and close the ribbon door.
After the printer initializes, thermal head cleaning starts automatically.

HEAD CLEANING
PLEASE WAIT

When thermal head cleaning finishes, the following message appears.

ROLLER CLEANING?
YES: [<] NO: [>]

To continue with roller cleaning, proceed to step 6. To end the cleaning process here, press the ⇨ button. The print paper used will be cut and ejected. Proceed to step 11.

- 6 Press the ⇨ button.
About 20 cm of paper is ejected automatically, and the following message appears.

CLEANING SHEET
OK? [EXEC]

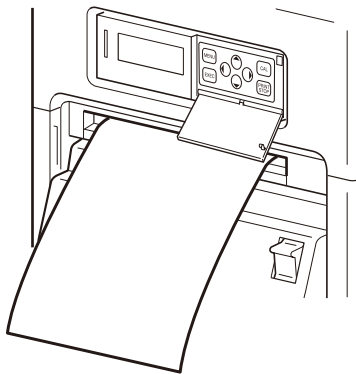

- 7** Remove the paper from the back side of the cleaning sheet (the side without illustrations). Be careful not to remove the paper from the wrong side of the sheet.

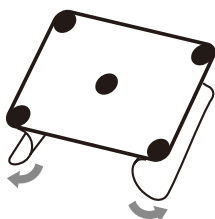

- 8** Refer to the following illustrations according to the width of your paper roll, determine the orientation of the cleaning sheet, and affix the sheet evenly onto the paper 5 cm away from the edge.

When using the 2UPC-R203/R205 series printing pack

Affix the cleaning sheet vertically.

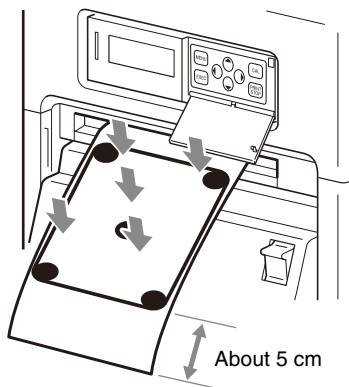

When using the 2UPC-R204/R206 series printing pack

Affix the cleaning sheet horizontally.

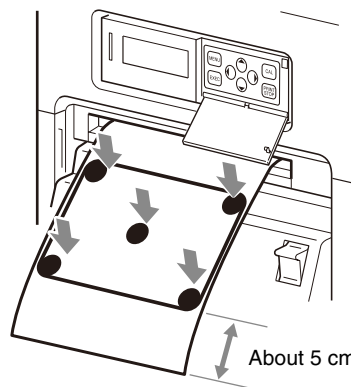

- 9** Remove the paper from the front side of the cleaning sheet. Make sure that the four corners of the cleaning sheet are firmly affixed and not curling up.

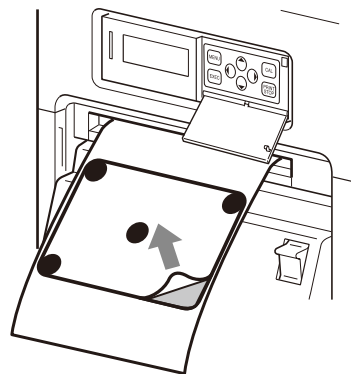

- 10** Press the EXEC button.

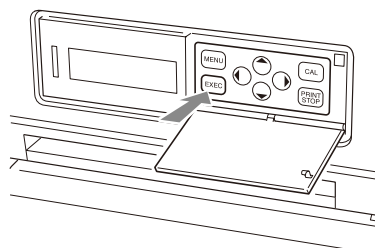

Roller cleaning starts, and dust and particles are removed from the interior. When cleaning is finished, the print paper is cut and the cleaning sheet is ejected.

Note

After cleaning is finished, make sure that the cleaning sheet is completely ejected. If any part of the cleaning sheet remains, cut off all portions of the print paper on which the cleaning sheet is still affixed before further operation.

- 11** Open the ribbon door, and remove the cleaning ribbon.

CLEANING FINISH
REMOVE RIBBON

To clean the paper feed roller

If the paper feed rollers are dirty, gently wipe the rollers with a soft cloth moistened with alcohol while turning the rollers.

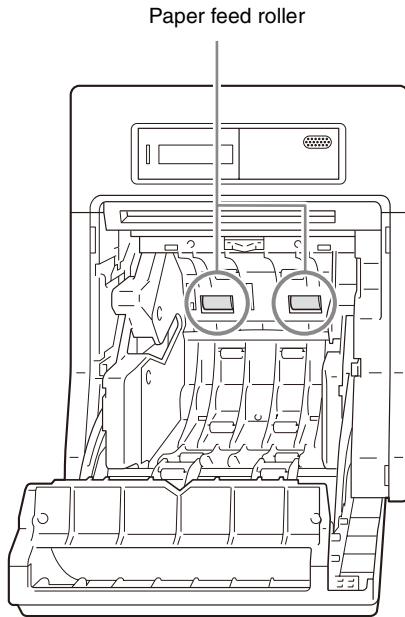

When the following symptoms appear

When the message “HEAD COOLING PLEASE WAIT” begins to appear on the information display frequently:

Ventilation holes are located on the rear and side panels of the printer. Clean the filter on the rear panel of the printer. If the filter is dirty, the time required for cooling the thermal head is lengthened and this causes the printing time to become longer.

- 1** Press upward on the top portion of the filter cover, and remove the filter cover.

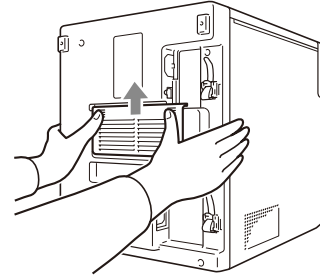

- 2** Remove the filter from the filter cover. The filter is held to the filter cover at four different points.



- 3** Wash the filter with water to remove the dust.

Note

Do not rub the netting of the filter roughly.

- 4** After the filter is completely dry, reattach it to the filter cover.

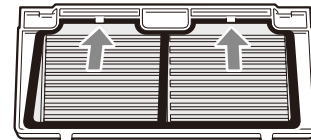

- 5** Reattach the filter cover onto the printer.

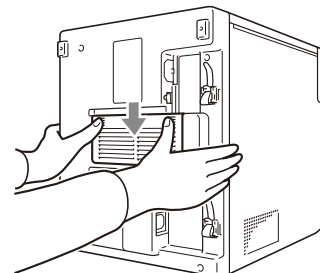

Ink Ribbon and Paper

Each printing pack contains two sets of the ink ribbon and paper roll combination.

Be sure to use the ink ribbon and the paper roll in the carton as a set.

2UPC-R203 series Self-Laminating Color Printing Pack

Contains color ink ribbon and paper.

Ink ribbon for printing: 2 rolls

L-size print paper: 2 rolls

Cleaning sheet: 2 sheets

2UPC-R204 series Self-Laminating Color Printing Pack

Contains color ink ribbon and paper.

Ink ribbon for printing: 2 rolls

King-size print paper: 2 rolls

Cleaning sheet: 2 sheets

2UPC-R205 series Self-Laminating Color Printing Pack

Contains color ink ribbon and paper.

Ink ribbon for printing: 2 rolls

2L-size print paper: 2 rolls

Cleaning sheet: 2 sheets

2UPC-R206 series Self-Laminating Color Printing Pack

Contains color ink ribbon and paper.

Ink ribbon for printing: 2 rolls

2KG-size print paper: 2 rolls

Cleaning sheet: 2 sheets

Printing capacity

The number of sheets that can be printed differs depending on the printing pack. Each printing pack contains two sets of the ink ribbon and paper combination. One set of the ink ribbon and paper allows you to print the following number of sheets.

Printing pack	2UPC-R203 series	2UPC-R204 series	2UPC-R205 series	2UPC-R206 series
Print capacity	770 sheets	700 sheets	400 sheets	350 sheets
Print size	89×127 mm	102×152 mm	127×178 mm	152×203 mm
	3.5×5 inches	4×6 inches	5×7 inches	6×8 inches

Note

However the number of sheets that can be printed may not be guaranteed if you replace the ink ribbon and paper before the ink ribbon and paper run out.

Specifications

Power requirements

100 to 240 V AC, 50/60 Hz

Input current 5 to 2.5 A max. (while printing)

Operating temperature range

10 to 35 °C

Operating humidity range

20 to 80%

External dimensions

Approx. 280 × 356 × 451 mm (WHD)

(11 ¹/₈ × 14 ¹/₈ × 17 ⁷/₈ inches)

(excluding the maximum projecting parts)

Approx. 280 × 356 × 459 mm (WHD)

(11 ¹/₈ × 14 ¹/₈ × 18 ¹/₈ inches)

(including the maximum projecting parts)

Mass Approx. 17 kg (37.48 lb) (printer only)

Printing system Dye sublimation thermal transfer

Thermal head 13.1 dot/mm, 2048 elements (330 dpi)

Gradations 8 bits each for yellow, magenta and cyan

Picture size 2UPC-R203 series: 89 × 127 mm

(3.5 × 5 inches)

2UPC-R204 series: 102 × 152 mm

(4 × 6 inches)

2UPC-R205 series: 127 × 178 mm

(5 × 7 inches)

2UPC-R206 series: 152 × 204 mm

(6 × 8 inches)

Printable pixels 2UPC-R203 series:

1210 × 1728 dots

2UPC-R204 series:

1382 × 2048 dots

2UPC-R205 series:

1728 × 2380 dots

2UPC-R206 series:

2048 × 2724 dots

(The top and bottom and right and left portions will not be printed by about 1.5 mm.)

Printing time 2UPC-R203 series: Approx. 8.0 sec.

2UPC-R204 series: Approx. 8.0 sec.

2UPC-R205 series: Approx. 12.5 sec.

2UPC-R206 series: Approx. 14.5 sec.

(Printing time may vary depending on the conditions of use.)

Input connector AC IN (for power)

Interface Hi-Speed USB (USB2.0)

Accessories supplied

Output tray (1)
Output tray adapter (1)
Scrap receptacle (1)
Cleaning ribbon (1)
Ribbon tray (1)
Paper core (1)
Paper adapter (blue) (1)
Paper adapter (pink) (1)
USB cable (1-790-081-71(Sony)) (1)
CD-ROM (1)
Software License Agreement (1)
Before Using This Printer (1)
Warranty Card (1)
Service and Customer Support Info. (1)

Optional accessories

Self-Laminating Color Printing Pack
2UPC-R203 series
2UPC-R204 series
2UPC-R205 series
2UPC-R206 series

Design and specifications are subject to change without notice.

List of Messages

Messages appear on the LCD under the following conditions. Please take the remedial actions shown next to the message to correct the problem.

Messages and error messages causing the ALARM indicator to turn on

When the ALARM indicator on the front panel lights in red, a message or an error message appears on the LCD. Please take the remedial actions shown next to the message to correct the problem.

Message	Description and Remedy
CHECK PAPER & RETRY	<ul style="list-style-type: none">Paper cannot be fed or ejected correctly. →Load the paper roll correctly. (page 9)The end of the paper may be folded or bent. →Check whether or not the paper is folded or bent. If it is, cut the folded part of the paper off and load the paper roll again. (page 9)A paper jam has occurred. →Clear the paper jam, and try printing again.The paper has run out. →Load a new ink ribbon and paper roll. (page 9)
CHECK RIBBON & RETRY	<ul style="list-style-type: none">The ink ribbon may have broken. →Repair it with adhesive tape. (page 15)Ink ribbon corresponding to the designated number of sheets has been used up. →Load a new ink ribbon and paper roll. (page 9)The ink ribbon is not loaded correctly. →Load it correctly. (page 9)
DOOR OPEN	The paper door or ribbon door is open. →Close the paper door and ribbon door completely. (pages 12 and 13)
XXXX ERROR RESTART PRINTER	Mechanical trouble has occurred in the printer. →Restart the printer, and try printing again. If the problem persists, contact your supplier or the nearest Sony Service Center.
LOAD COMPATIBLE PAPER & RIBBON	An incompatible ink ribbon and paper roll are loaded. →Load the compatible ink ribbon and paper roll taken from the same package. (page 27)
REMOVE PAPER	A paper jam has occurred while cleaning the rollers. →Clear the paper jam.

Message	Description and Remedy
LOAD PAPER	There is no paper roll loaded. →Load a paper roll. (page 9)
UNRECOGNIZED RELOAD RIBBON	The ink ribbon cannot be properly recognized. →Remove the ribbon tray, make sure that the ink ribbon is loaded correctly, and reinsert the ribbon tray into the printer.
LOAD RIBBON	There is no ink ribbon loaded. →Load an ink ribbon. (page 9)
UNSUPPORTED RIBBON	A different ink ribbon for the printer may be loaded. →Confirm whether or not the loaded ink ribbon is for the printer. (page 27)

Other messages

When the following messages appear even though the ALARM indicator does not light, take the remedy next to each message.

Message	Description and remedy
LOAD NEW PAPER & RIBBON	The designated amount of paper or ink ribbon has been used up. →Load a new ink ribbon and paper roll. (page 9)
HEAD COOLING PLEASE WAIT	The thermal head is too hot. →Wait for the message to disappear. Printing will then resume automatically.
PLEASE WAIT	The printer has ejected a printout because it has received a stop command or the printer has stopped printing due to some problem. →Wait for the message to disappear.

Troubleshooting

Before submitting the product for repair, please recheck the following. If the unit still does not operate properly, contact your supplier or the nearest Sony Service Center.

Problem	Cause and Remedy
The printer does not feed the correct amount of paper automatically when you close the front door after loading the paper roll and ink ribbon.	<ul style="list-style-type: none"> The printer is not turned on. →Turn on the printer on. The paper roll has been loaded with its left and right sides reversed. →Load the paper roll in the proper direction. (page 11)
Cannot load the ink ribbon.	You may be trying to load the ink ribbon spools into the wrong holders. →Load each spool into its proper holder on the ribbon tray. (page 12)
LOAD RIBBON is displayed even though an ink ribbon is loaded.	The ink ribbon may not be loaded correctly. →Load the ink ribbon correctly. (page 9)
Paper is left even though LOAD NEW PAPER & RIBBON is displayed.	This is not a malfunction. Extra sheets of paper are provided with each roll of paper. →Remove the current paper roll and load a new ink ribbon and paper roll. (page 9)
Ink ribbon is left even though LOAD NEW PAPER & RIBBON is displayed.	This is not a malfunction. Extra ink ribbon is provided. →Remove the current ink ribbon and load a new ink ribbon and paper roll. (page 9)
HEAD COOLING PLEASE WAIT is displayed frequently.	The filter may be dirty. →Clean the filter. (page 26)
A vertical white stripe appears on the printout.	Dust may have accumulated on the thermal head. →Clean the interior. (page 24)
The blank portion appears on the edge of the printout.	<ul style="list-style-type: none"> The image may be shifted. →Shift the printout image to the desired position. (page 22) You may be using a printing pack with 127-mm (5-inch) width (2UPC-R203/R205 series) without the paper adapters installed. →Install the paper adapters. (page 10)

Index

A

- Accessories supplied
 - confirmation 7
- Adjusting the gray balance 19

B

- Basic Application Example 4

C

- Cleaning
 - cabinet 23
 - Cleaning the Interior 24
 - paper feed roller 26
- Connections 8
 - To secure the power cord 8
 - To secure the USB cable 8

D

- Displaying
 - quantity of printing 21
 - version of the printer 21

F

- Features 4

I

- Ink ribbon
 - if the ribbon breaks 15
- Ink ribbon and paper
 - usable printing pack 27
- Introduction 4

M

- Menu operations
 - adjusting the gray balance 19
 - adjusting the position of the printout image 22
 - displaying the firmware version of the printer 21
 - displaying the quantity of pages printed 21
 - preparation 19
- Messages 28

O

- Operation 9

P

- Paper and ink ribbon
 - loading 9
 - removing 16
- Part Names and Functions
 - Front 4
 - Operation button door 5
 - Rear 6
- Precautions
 - condensation 23
 - Installation 23
 - on transportation 23
 - Safety 23
- Preparation 7
- Printer driver installing 8
- Printing 18
- Printing pack
 - 2UPC-R203 series 27
 - 2UPC-R204 series 27
 - 2UPC-R205 series 27
 - 2UPC-R206 series 27
 - printing capacity 27

S

- Specifications 27

T

- Troubleshooting 29

U

- USB port connection 8

