



Everything in its place.™

OWNER'S MANUAL



41 in / 104 cm STAINLESS STEEL TOOL CHEST COMBO
ITM. / ART. 766685
Model # TLS-0401

SAFETY PRECAUTIONS

Please observe the following safety precautions when using your TRINITY Tool Chest.



CARE AND MAINTENANCE

- Do not use abrasive cleaners or a metal scouring pad as it may damage the stainless steel surface
- Use a stainless steel cleaner to eliminate grease and fingerprints
- Make sure to wipe ALONG the grain (NOT against)

PARTS LIST

Your TRINITY Professional 41 in / 104 cm Stainless Steel Tool Chest Combo should include the following parts. Before assembling, unpack the carton and lay out all of the parts described below. If you are missing any parts, need assistance with assembly or have questions, please contact TRINITY Customer Service at 800.985.5506 or at customerservice@trinityii.com. Parts can also be requested online at our customer center at www.trinityii.com.

Wrench and screwdriver are required for assembly. Not included.

TOP CHEST

A

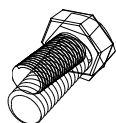

SIDE HANDLE BOLTS (12)

B

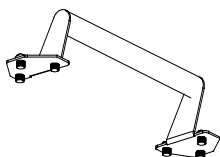

SIDE HANDLES (2)

C

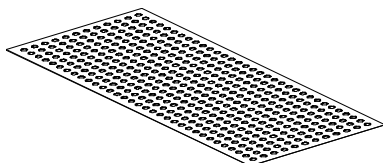

LINERS (7)

D



KEYS (2)

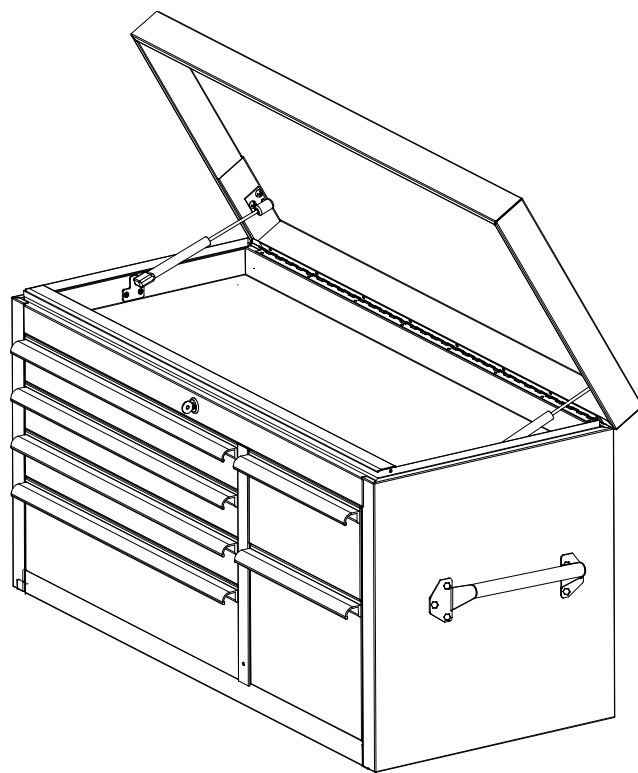

PARTS LIST

BOTTOM CHEST

E

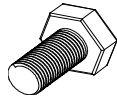

SIDE HANDLE BOLTS (12)

F

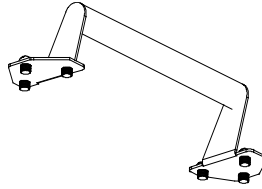

SIDE HANDLES (2)

G

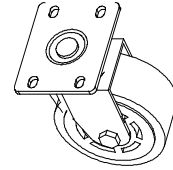

NON-LOCKING
SWIVEL CASTER (2)

H

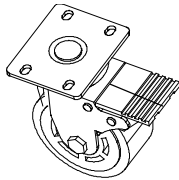

LOCKING SWIVEL CASTER (2)

I



REAR BRACES (2)

J



REAR BRACE SCREWS (8)

K

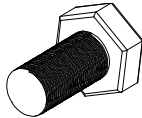

SWIVEL CASTER BOLTS (16)

L



KEYS (2)

M

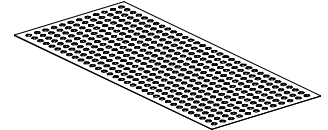

LINERS (5)

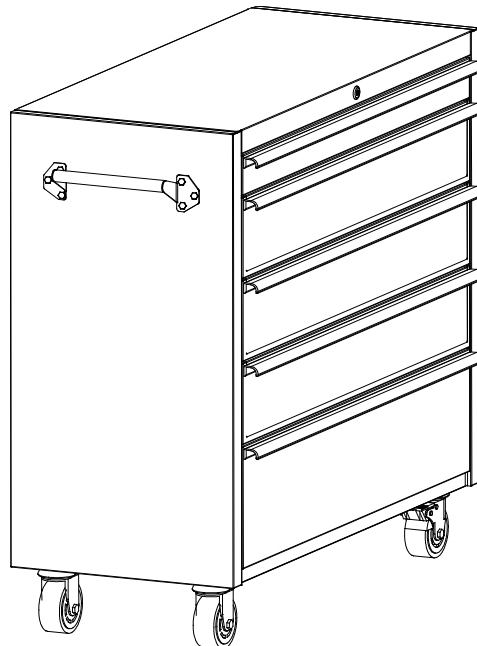

ASSEMBLY INSTRUCTIONS

STEP 1: INSTALLING SIDE HANDLES

Be sure to assemble the **SIDE HANDLES (B,F)** on both the Top and Bottom Chests to make it easier to move your Tool Chest.

Position the **SIDE HANDLES (B,F)** over the precut holes and attach them using the (mid-sized) **SIDE HANDLE BOLTS (A,E)**. Tighten securely.

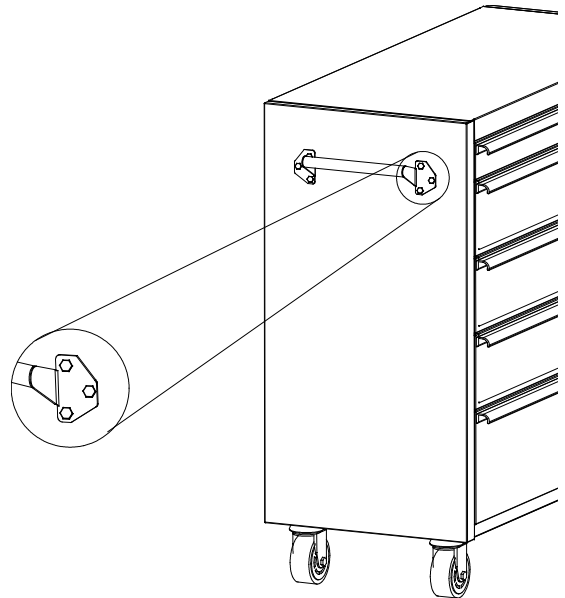

STEP 2: INSTALLING SWIVEL CASTERS

Carefully lay the Bottom Chest on its back. Position the two **NON-LOCKING SWIVEL CASTERS (G)** on the right side. Position the two **LOCKING SWIVEL CASTERS (H)** on the left side. Insert the (large-sized) **SWIVEL CASTER BOLTS (K)** through the **SWIVEL CASTERS (G,H)**, and then into the bottom of the Chest. Tighten securely.

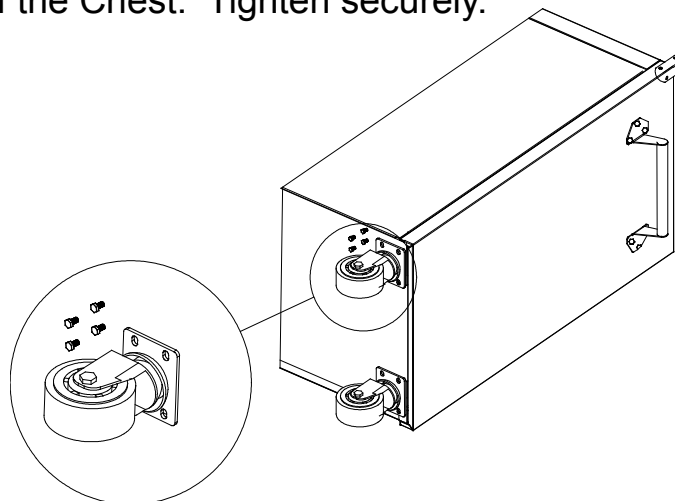

ASSEMBLY INSTRUCTIONS

STEP 3: INSTALLING REAR BRACES

Be sure to assemble the **REAR BRACES (I)** to secure the Top Chest to the Bottom Chest.

Position the **REAR BRACES (I)** over the precut holes at the back edge where the two Chests adjoin. Attach the **REAR BRACES (I)** using the (small-sized) **REAR BRACE SCREWS (J)**. Tighten securely.

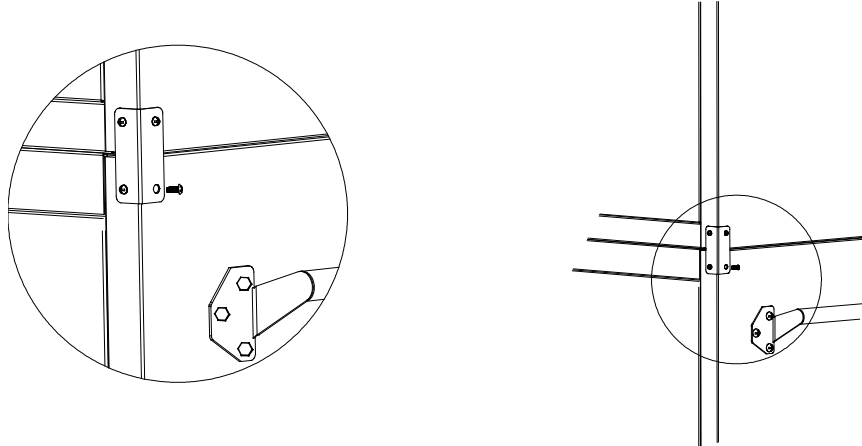

STEP 4: INSTALLING DRAWER LINERS

Simply Place the **LINERS (C,M)** inside the top compartment and inside of each drawer.

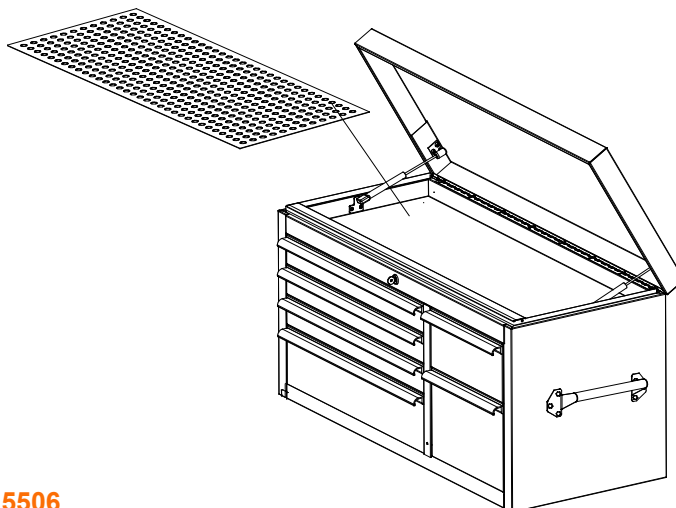

USAGE INSTRUCTIONS

DRAWER REMOVAL

Pull the drawer out so that it is almost fully extended. Push the black release lever DOWN on the RIGHT-hand side. Pull the black release lever UP on the LEFT-hand side. While holding the levers as instructed, pull the drawer forward until released from the slides attached to the Tool Chest (“Tool Chest Slides”). **Note:** The slides attached to the drawer (“Drawer Slides”) are an integral part of the drawer and must be removed along with the drawer itself.

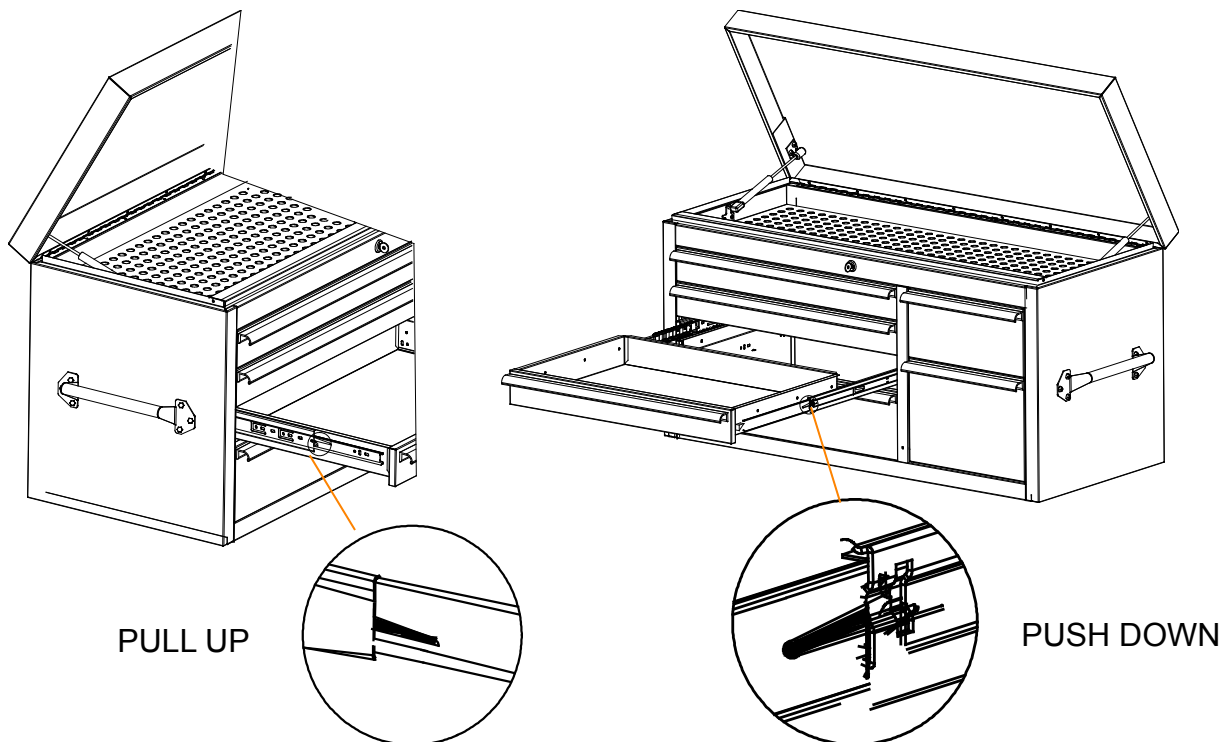

DRAWER REPLACEMENT

Extend the Tool Chest Slides for the drawer to be replaced. Insert the brackets on each side of the Drawer Slides into the corresponding slots on the Tool Chest Slides, making sure they are properly positioned. Once the brackets are inserted into the slots, completely close the drawer to set all slides in their proper positions.

SERVICE PARTS LIST – TOP CHEST

TRINITY Customer Service provides the following replacement parts:

- 1) TLS-TCHNDLE: Side Handle
- 2) TLS-TCLIFT: Gas Lift
- 3) TLS-TCSLIDE: Tool Chest Slide
- 4) TLS-TCSLIDEDR: Drawer Slide
- 5) TLS-TCDHANDLE24: 24.25" Aluminum Drawer Handle
- 6) TLS-TCDHANDLE12: 12.5" Aluminum Drawer Handle
- 7) TLS-TCKEYS: Keys
- 8) TLS-TCLOCK: Lock
- 9) TLS-41TCTOPLINERS: Top Chest Liners

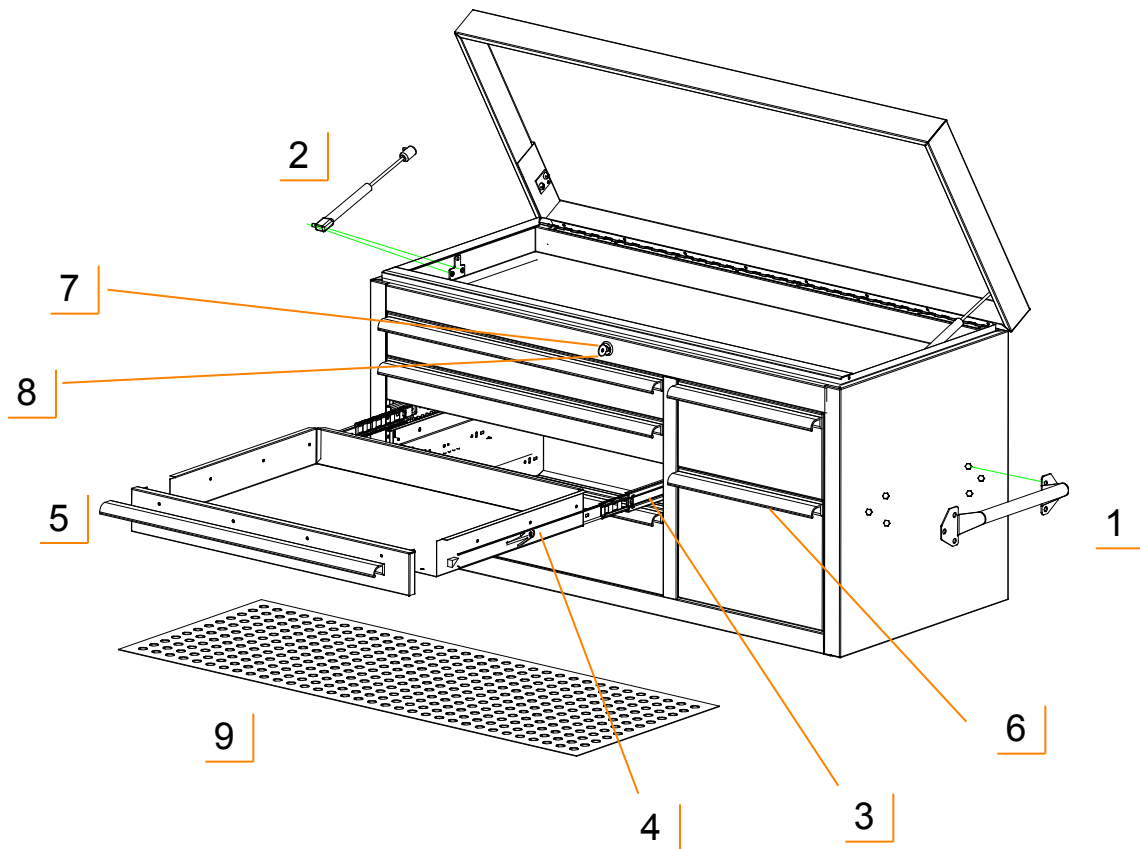

NOTE: Replacement keys may be ordered using the code shown on the face of the lock. The Top and Bottom Chests may have different key codes.

SERVICE PARTS LIST – BOTTOM CHEST

TRINITY Customer Service provides the following replacement parts:

- 1) TLS-TCHANDLE: Side Handle
- 2) TLS-TCREARBRACES: Rear Brace
- 3) TLS-TCLOCK: Lock
- 4) TLS-TCKEYS: Keys
- 5) TLS-TCSLIDE: Tool Chest Slide
- 6) TLS-TCSLIDEDR: Drawer Slide
- 7) TLS-TCDHANDLE38: Full-length Aluminum Drawer Handles
- 8) TLS-TCCASTERLOCK52: 5" x 2" Swivel Locking Caster
- 9) TLS-TCCASTER52: 5" x 2" Swivel Caster
- 10) TLS-41TCBOTLINERS: Bottom Chest Drawer Liners

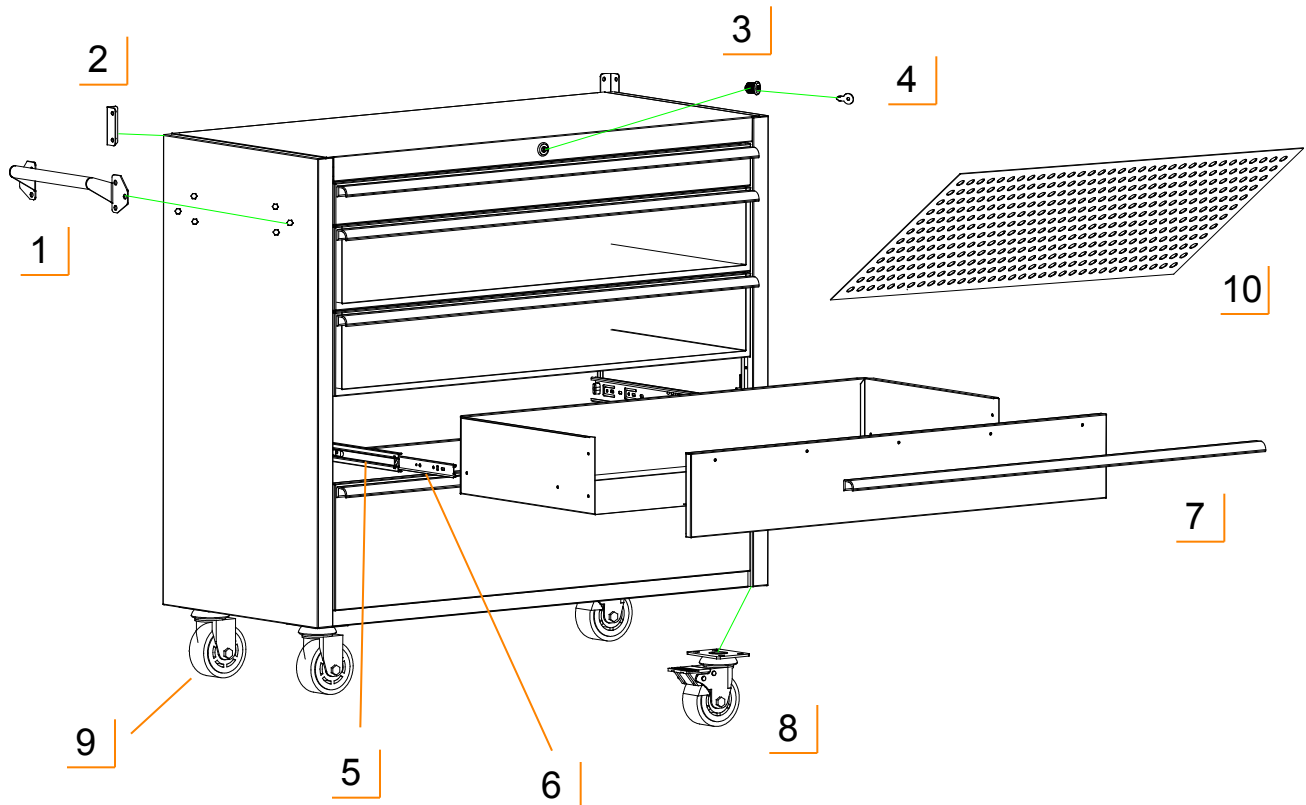

NOTE: If you need replacements for parts not mentioned in this user guide, please call us at 800.985.5506, or send an email to customerservice@trinityii.com, and we will be glad to help with your replacement parts.

1 YEAR LIMITED WARRANTY

TRINITY 41in / 104 cm STAINLESS STEEL TOOL CHEST COMBO Model # TLS-0401

Trinity International Industries (“Trinity”) warrants to the original consumer purchaser (“Purchaser”) of the TRINITY 41 in / 103 cm Stainless Steel Tool Chest Combo (“Product”) that each Product shall be free from defects in workmanship and materials for a period of 1 year from the date of original purchase. Trinity’s obligation under this warranty shall be limited to repair or replacement of, or adequate compensation for the Product which shall not be greater than the amount of the purchase price of the Product, at the option of Trinity, during the warranty period. All replaced parts and Products become the property of Trinity and must be returned to Trinity.

This warranty excludes normal wear and tear of the Product and its parts or components, and damage arising from any of the following: negligent use or misuse of the Product, use contrary to this User’s Manual, or alteration by any one other than Trinity. The warranty period of 1 year shall not be extended or renewed by the repair or replacement of, or compensation for, the Product.

Except as set forth herein, there are no warranties on this Product either express or implied, and Trinity disclaims all warranties including, but not limited to, any implied warranties of merchantability, infringement or fitness for a particular purpose. No warranty or guarantee given by any person, firm, or corporation with respect to this product shall be binding on Trinity.

If your Product is defective or otherwise requires service or parts, please call TRINITY Customer Service toll-free at (800) 985-5506, between 8:00 a.m. and 5:00 p.m., PST. Please tell us which model you purchased, the date of the purchase, and the problem with your Product. A copy of your original purchase receipt must accompany your service request.

LIMITATION OF REMEDIES AND LIABILITY

Trinity shall not be liable for any incidental, consequential, special, or punitive damages for breach of any express or implied warranty on its Product. Except to the extent prohibited by applicable law, any implied warranty of merchantability or fitness for a particular purpose on this Product shall be limited to the duration of the above warranty. Neither Trinity nor anyone else who has been involved in the creation, production, delivery or sale of the Product shall be liable for any damages of any type, including but not limited to any lost profits, lost savings, loss of anticipated benefits, or any other incidental, consequential, special, or punitive damages which arise out of the purchase, use, or inability to use the Product, whether arising out of contract, negligence, strict tort, or any other legal theory on which a claim is based. Recovery of any kind against Trinity shall not be greater in amount than the purchase price of the Product. Without limiting the foregoing, Purchaser assumes all risk and liability for loss, damage or injury to Purchaser and Purchaser’s property and to others and their property arising out of the use, misuse, or inability to use this Product. This limited warranty shall not extend to anyone other than the original purchaser of this product, is nontransferable and states your exclusive remedy.

Some states do not allow the exclusion or limitation of incidental, consequential, special, or punitive damages, so the above limitation or exclusion may not apply to you. The above warranty gives you specific legal rights, and you may have other rights which vary from state to state.



PRODUCT REGISTRATION

Thank you for purchasing a TRINITY 41 in / 104 cm Stainless Steel Tool Chest Combo. In order to register your product and receive streamlined customer service, please fill out the following Product Registration Form and (1) fax the form to FAX 310.347.4134 (2) complete the Product Registration Form online at www.trinityii.com or (3) scan and email the form to customerservice@trinityii.com. Include a copy of your original receipt with your submission.

First Name: _____ Last Name: _____

Address: _____

City: _____ State: _____ Zip Code: _____

Email Address: _____ Phone: _____

Product Model #: _____ Purchase Date: ____/____/____

Location of Purchase: _____

Please rate the importance of each feature (1=least important; 10=most important)

Quality ____ Price ____ Size/Capacity ____ Appearance ____ Other ____

What other brands did you seriously consider before making this purchase?

- Craftsman Snap On Husky
 Kobalt Other Did not consider other brands

How did you hear about our product?

- Magazine Ad Catalog Salesperson Word of Mouth
 Internet Store Display Other

Marital Status: Single Married

Household Income: Below \$50,000 \$50,000-\$150,000 \$150,000+

Education: High School College Graduate School

Primary Residence: Own Rent

Comments/Suggestions:

CONTACT US

**QUESTIONS? NEED PARTS?
WE ARE HERE TO HELP!**

**To receive your replacement part, please fax or email
your receipt and product registration along with your
name, address and a brief description of your problem to:**

TRINITY Customer Service

TEL: 800.985.5506

FAX: 310.347.4134

EMAIL: customerservice@TRINITYii.com

**Monday through Friday
8:00 AM – 5:00 PM (PST)**

www.TRINITYii.com