

supapowa®  
**SupaStart™**

my first  
**SupaPowa®**  
kit

## **User Manual**



**Let's get  
SupaStarted**

# CONTENTS

<b>1. Included in SupaStart™</b>	<b>P 03</b>
<b>2. Correct usage and user safety</b>	<b>P 04</b>
<b>3. Transmitter</b>	<b>P 06</b>
<b>4. Portable Transmitter</b>	<b>P 08</b>
<b>5. Receiver</b>	<b>P 10</b>
<b>6. Specifications</b>	<b>P 13</b>
<b>7. Warranty</b>	<b>P 13</b>
<b>8. Correct Disposal of product</b>	<b>P 13</b>

---

## Included in SupaStart™

1 x Transmitter (B)

1 x Portable Transmitter (C)

1 x Receiver (A)

1 x Micro USB (FEMALE) to 30-pin adapter

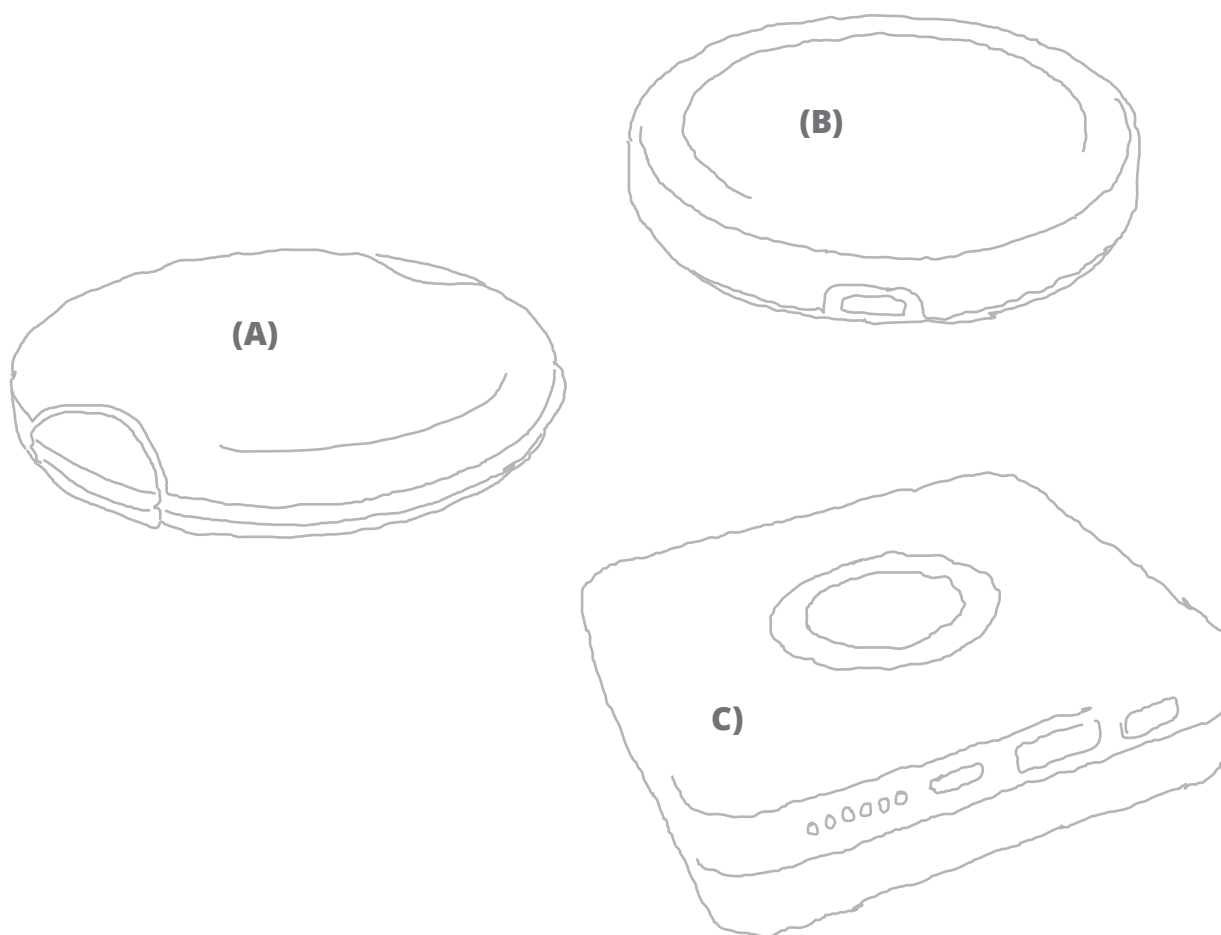
1 x UK standard 3-pin USB 2.0 AC Adapter

1 x "Let's Get SupaStarted" Guide

1 x 1.5m USB 2.0 A (Male) to Micro USB (Male) Cable

1 x 1.2m USB 2.0 A (Male) to Micro USB (Male) Cable

1 x 0.3m USB 2.0 A (Male) to Micro USB (Male) Cable



---

## 2. Correct usage and user safety

---

Thank you for purchasing SupaStart™ product bundle.

### Your first SupaPowa® kit

**Soon you will be ready to charge your device(s) wirelessly at home, at work and on the go using SupaPowa®**

For your own safety ensure that you read this User Manual in full before using these products.

For warranty purposes, ensure that you keep detail of the purchase, including date of purchase and supplier.

For further details about the warranty please refer to Section 7 of this document.

---



These products are compatible with the Qi standard for wireless charging.



---

## 2.2. Dangers associated with incorrect use.

### **Do not attempt to open or dismantle any of the products!**

- Ensure that the products are kept at room temperature at all times.
- Do not use products in direct sunlight as excessive heat may impair the performance and also cause risk of fire.
- Avoid using the products in areas where they may come into contact with liquids and/or excessive dust.
- Always ensure that charging is undertaken on a flat, stable surface to minimise the risk of products falling and being damaged or causing damage.
- Always ensure that you use the products as intended and as outlined in this User Manual.
- Always dispose of any used products via an approved collection / recycling point.

---

## 2.3. Use of products close to an active medical implant.

- It is recommended that any electrical device is kept at least 15cm away from an active medical implant.
- Always follow the manufacturer's recommendations.
- Do not use the wireless charging product if you think there may be a problem caused by interference.(R1)(R2)

---

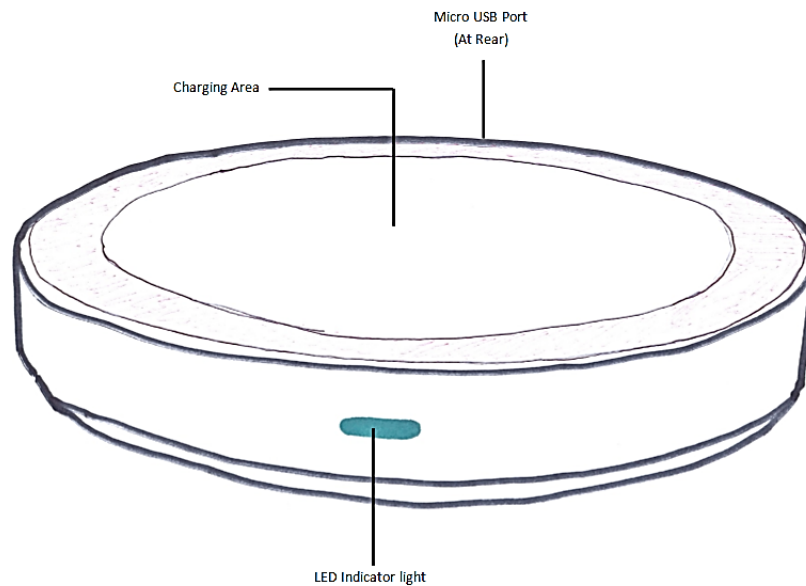
## Congratulations.

You now have the freedom to charge your mobile device(s) wirelessly using SupaPowa®.

---

---

## 3. Transmitter



### 3.1 Connect to Mains Power (Figure 1)

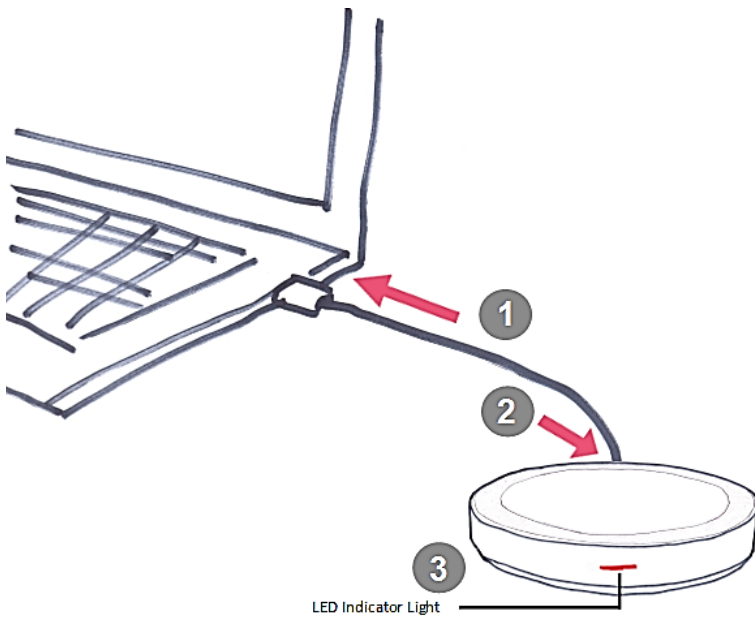
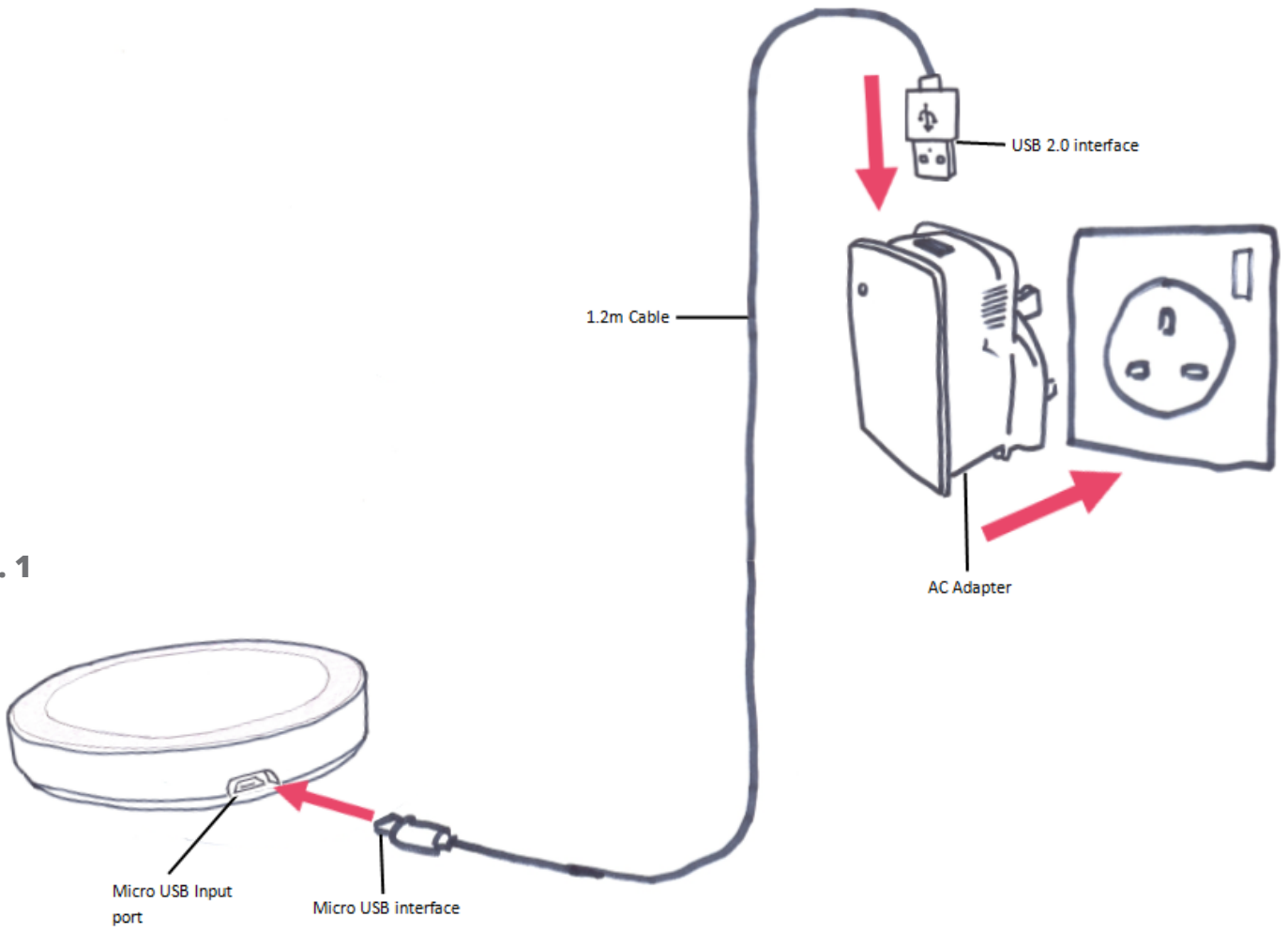
1. Connect the USB 2.0 interface (on the 1.2m cable) to the AC Adapter provided (Fig 1).
  2. Connect the Micro USB interface (on the 1.2m cable) to the Micro USB Input port located at the rear of the Transmitter.
  3. Locate and plug the AC Adapter into a suitable mains socket.
- The LED Indicator light on the Transmitter will illuminate Red when ready for use (Standby mode).

---

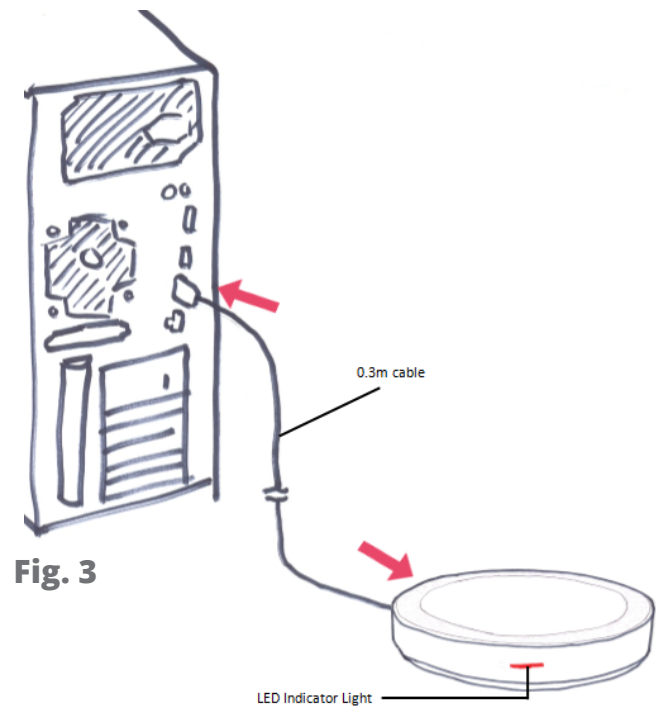
### 3.2. Connect to Laptop/Desktop PC

1. Connect the USB 2.0 interface (on the 0.3m cable) into a USB port on the laptop/desktop (Fig 2, Fig 3).
2. Connect the Micro USB interface (on the 0.3m cable) to the Micro USB Input port located at the rear of the Transmitter.
3. The LED Indicator light on the Transmitter will illuminate Red when ready for use.

**Fig. 1**

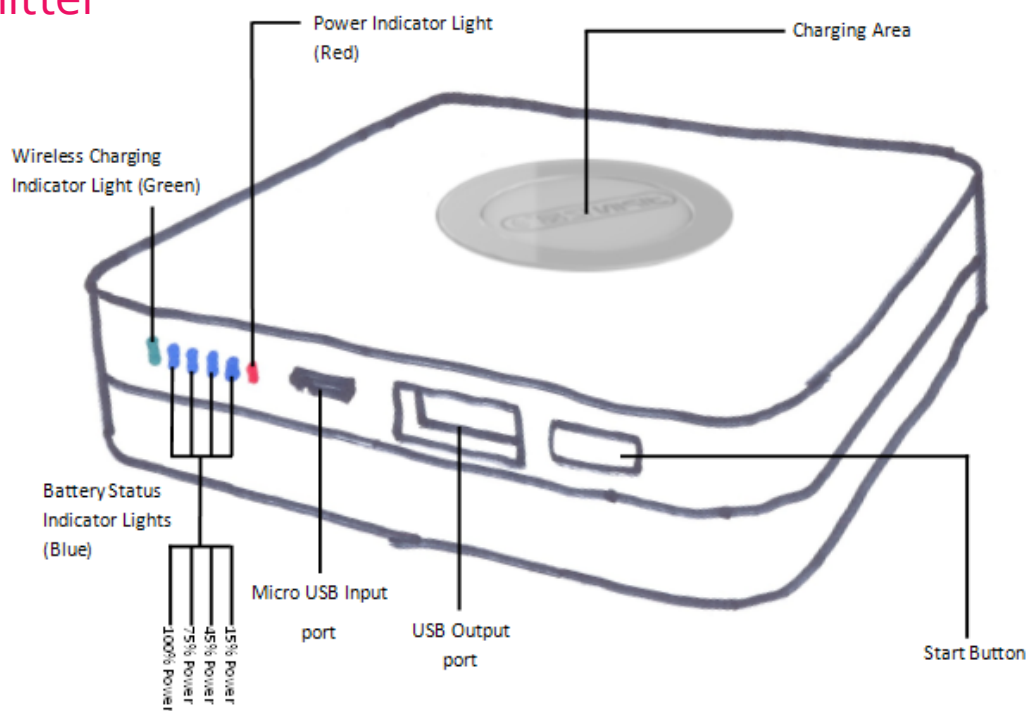


**Fig. 2**



**Fig. 3**

## 4. Portable Transmitter



### 4.1 Charging the Portable Transmitter

Prior to first use, it is recommended that you fully charge the Portable Transmitter by connecting to a suitable mains socket (see Fig 4).

**(NOTE: You can also connect to a laptop or desktop pc's to charge the Portable Transmitter, but the time taken to re-charge the Portable Transmitter's internal battery will increase slightly.)**

1. Connect the USB 2.0 interface (on the 1.5m cable) to the AC Adapter provided.
2. Connect the Micro USB interface (on the 1.5m cable) to the Micro USB Input port on the Portable Transmitter.
3. Locate and plug the AC Adapter into a suitable mains socket.
4. The Red Power Indicator Light will illuminate to indicate that the Portable Transmitter's internal battery is charging.

The Portable Transmitter's internal charge state will be indicated by the battery status indicator lights in four stages:

- \* 1 Blue light = 15% power
- \* 2 Blue lights = 45% power
- \* 3 Blue lights = 75% power
- \* 4 Blue lights = 100% power.

When all four blue battery status indicator lights are constantly lit, this will indicate that the Portable Transmitter's internal battery is fully charged.

5. When connected to a mains power source, you can also use the Portable Transmitter to wirelessly charge a mobile device.

The Portable Transmitter's internal battery will continue to be charged (Battery Status Indicator Lights will continue to flash) whilst offering charge to the mobile device (Green Wireless Charging Indicator Light illuminates when a Receiver is introduced to the charge area).



The charging of the Portable Transmitter's internal battery may take longer when charging a mobile device at the same time (see Fig. 5).

6. You can either choose to wirelessly charge your device by placing the Receiver onto the charge area of the Portable Transmitter or you can connect your device (using the designated USB cable supplied with your mobile device (not included in the SupaStart™) to the USB 2.0 output socket on the Portable Transmitter (Fig. 6)

The Portable Transmitter will identify which charge method has been chosen when the start button is pressed.

**(NOTE: If the Portable Transmitter's Battery Status Indicator is showing a single flashing Blue Light, the remaining internal battery capacity is low (less than 15%). Please re-charge the Portable Transmitter when it is in this state.)**

Fig. 4

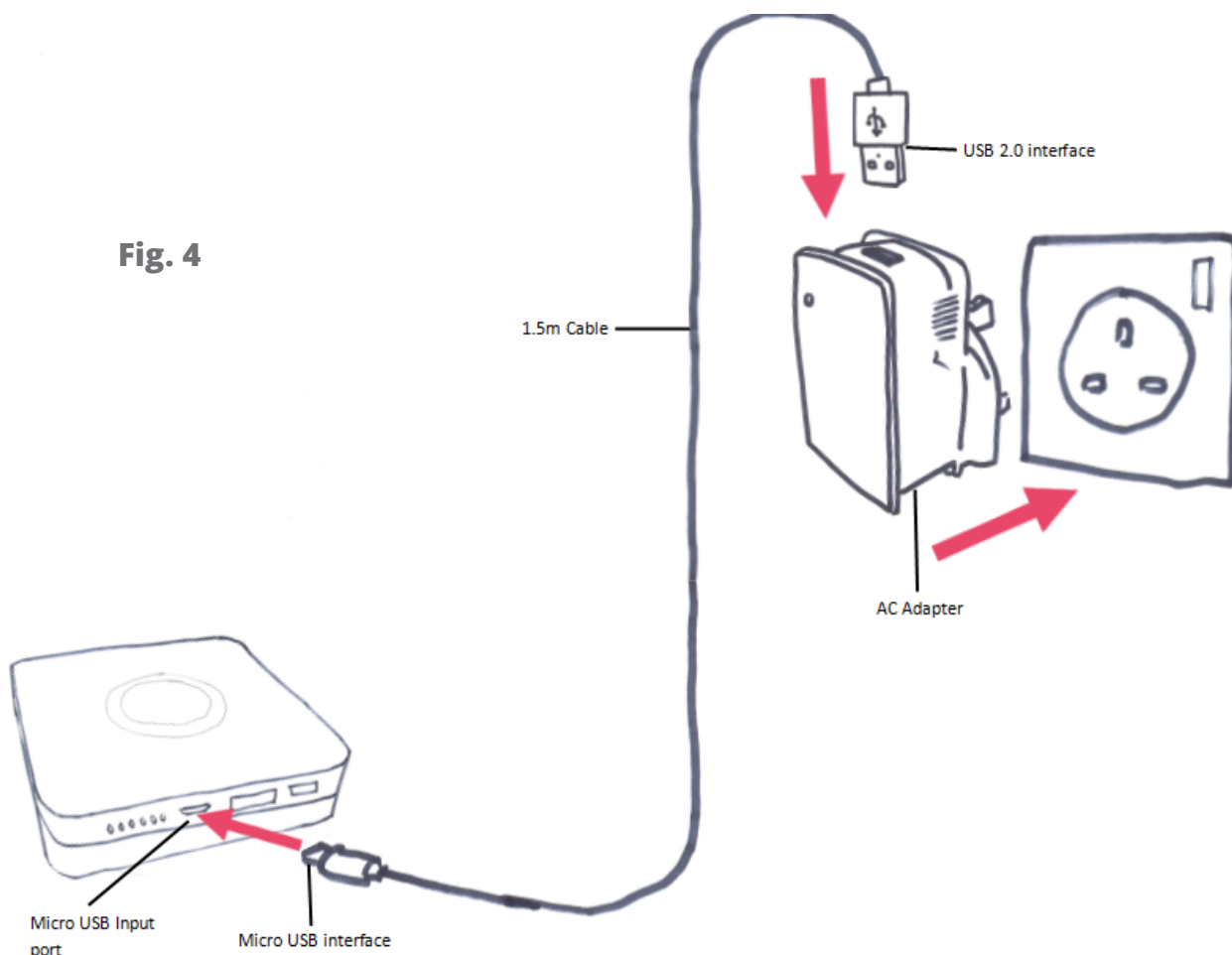


Fig. 5

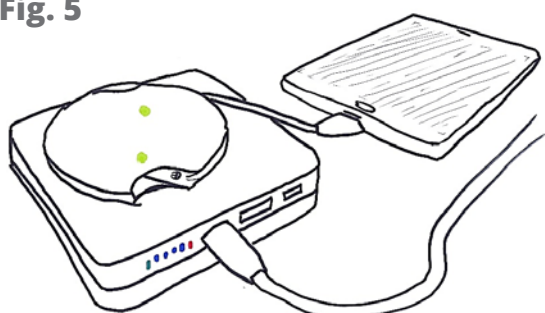
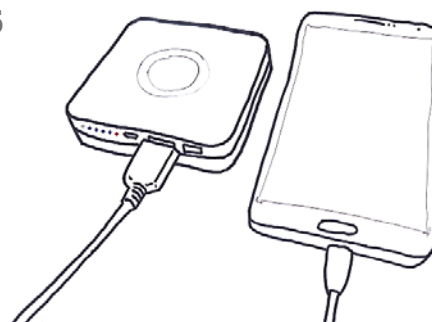


Fig. 6



## 5. Receiver

a. Micro USB connector

Fig. 7

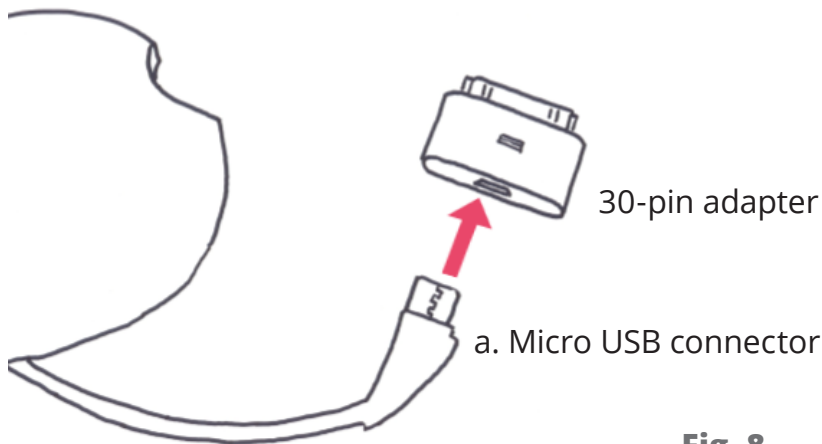
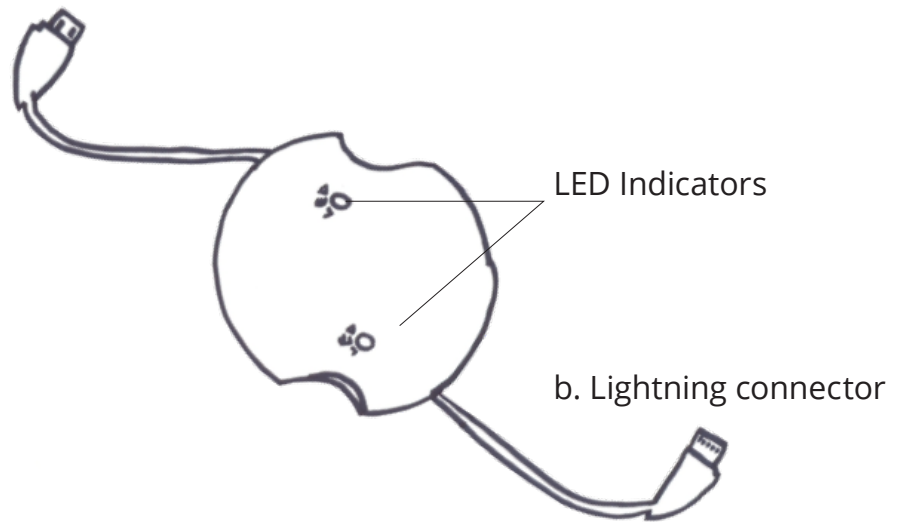


Fig. 8

### 5.1. How to use your Receiver

There are two initial options available to enable your mobile device for wireless charging – (refer to Fig. 7).

Depending on your mobile device's input – you can use either:

- a) the Micro USB connector or;
- b) the Lightning connector.

If your device has a 30-pin input, you will need to attach the supplied Micro USB to 30-pin adapter to the Receiver's Micro USB connector (a) to enable your device to charge. (refer to Fig. 8)

**(NOTE: You cannot plug and charge two devices at the same time with a single Receiver).**

Once your mobile device is connected to the Receiver, simply place the Receiver onto the charge area of the Transmitter or Portable Transmitter. When correctly aligned the two LED indicators on the Receiver will illuminate and your mobile device will start charging.

(NOTE: For best performance always ensure that the Receiver is centrally aligned to the Transmitter)

**Alternative receiver types are available for various mobile devices. For more information visit [www.supapowa.org](http://www.supapowa.org)**

**There are already over 50 SupaPowa®-ready mobile devices on the market. To see if yours is one, visit [www.supapowa.org](http://www.supapowa.org)**



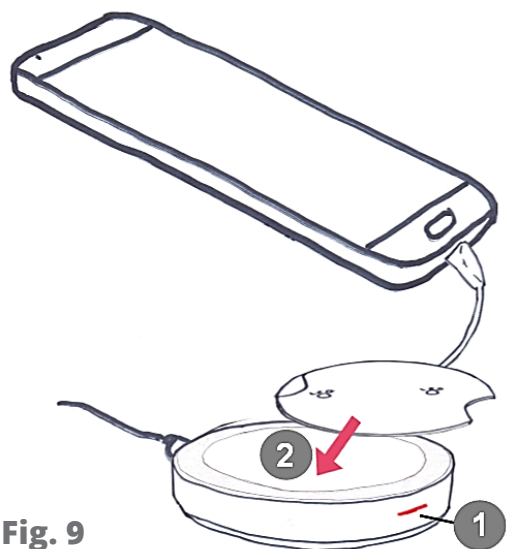


Fig. 9

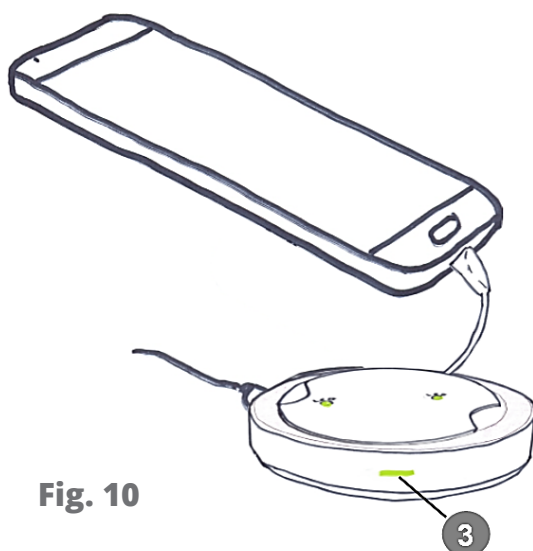


Fig. 10

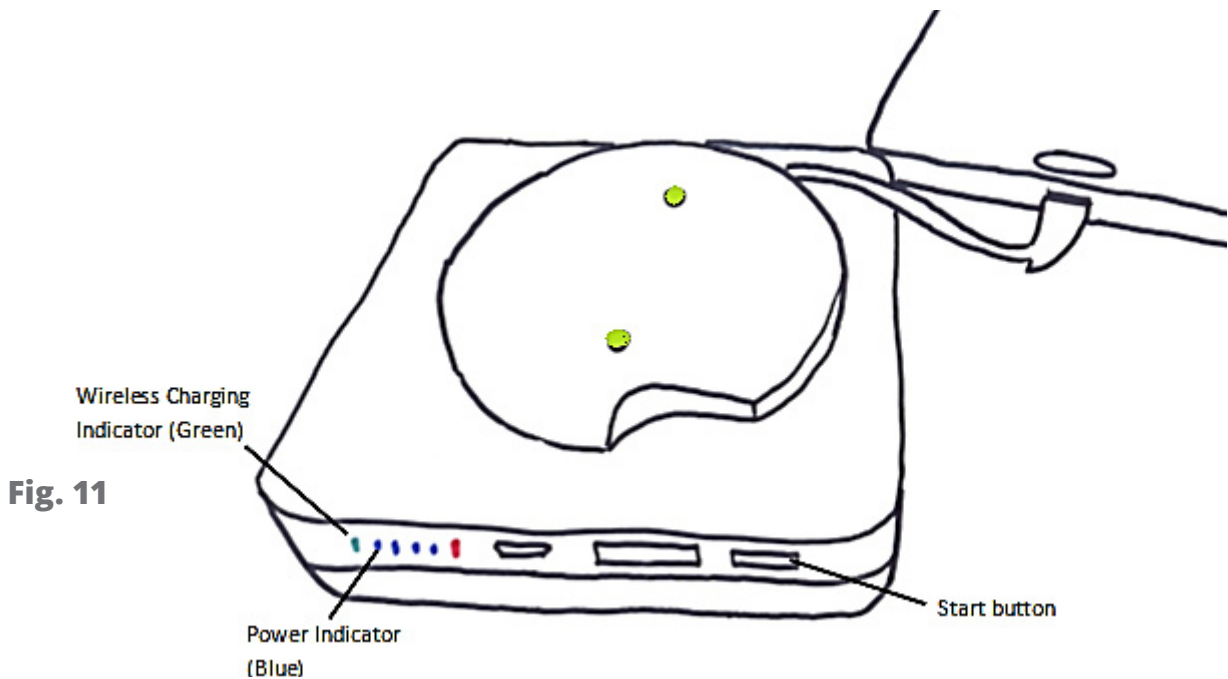
---

## 5.2. Using the Receiver with the Transmitter to charge your mobile device

1. Ensure that the Transmitter is connected and in standby mode by checking that its LED indicator light is red (Fig. 9).
2. Centrally align the Receiver (or a device which is SupaPowa® ready) onto the charge area of the Transmitter (Fig. 9).
3. When correctly aligned, the LED Indicator

light on the Transmitter will flash Green to indicate that charging has commenced (Fig. 10).

**If the Receiver is misaligned, the LED indicator light on the Transmitter will remain Red and your device will not charge.**



**Fig. 11**

### 5.3. Using the Receiver with the Portable Transmitter to charge your mobile device

1. Press the Start button once to turn the Portable Transmitter on.
2. The Power Indicator light(s) will be displayed. This will enable the wireless charging function. (Figure 9).
3. Place the Receiver on the charge area of the Portable Transmitter.
4. When a device is charging wirelessly the

green Wireless Charging Indicator light will illuminate and flash. (Figure 9).

**(NOTE: If the Portable Transmitter is inactive for 50 seconds or longer, i.e. the Receiver is misaligned or removed from the charge area, then the Portable Transmitter will turn itself off. To reactivate the Portable Transmitter press the Start button.)**

---

## 6. Specifications

---

### Transmitter

Input: DC5V, 1.5A

Efficiency: > 72%

Diameter: 69mm

Net Weight: 50g

Output: 5V500-1000mA

Charging distance: Up to 5mm

Thickness: 9mm

---

### Portable Transmitter

Input: DC5V 1.5A

Efficiency: <70%

Product size: 82mm

Net weight: 136g

Output: 5V500-1000mA

Charging distance: Up to 5mm

Thickness: 19mm

Battery Capacity: 4100mAh

---

### Receiver

Micro USB Output: DC5V0.56A

Receiving distance: 3-5mm

Efficiency: >72%

Thickness: 7.5mm

Lightning Output: DC5V0.5A

Working frequency:  
110-250KHz

Diameter: 58mm

Net weight: 24g

---

## 7. Warranty

12 month Return to Base warranty with valid proof of purchase.

Warranty is invalid if the product(s) are not used as specified in this User Manual or with the supplied AC Adapter.

---

## 8. Correct disposal of product

European law requires that these devices must not be discarded as ordinary household waste. To dispose of these devices, take them to a recycling collection point for electrical waste.

The wheellie bin symbol, indicated below, indicates that this product is covered by the European Directive 2002/96/EC.




supapowa.org

#supapowa



Wireless  
**Personal Power**

Made in China

All products are compatible with the Qi standard for wireless charging 

Qi and the Qi logo are the trademarks of WPC

SupaPowa® is a registered trademark of QiConnect Ltd