

**Embrace Network World and Experience
Infinite Connection**

ViewSonic® See the difference™ 

PJD6357



4,000 Lumens XGA /HDMI with Cable Management Hood LightStream Projector

The ViewSonic networkable LightStream™ projector PJD6357 features 4,000 lumens, native XGA 1024x768 resolution, majestic style and thoughtfully intuitive design. Exclusive SuperColor™ 6-Segment Color Wheel maximizes color saturation and brightness for true-to-life image projection in any light, while SonicExpert™, ViewSonic's proprietary sound enhancement technology, powers a 10W speaker to deliver incredibly clear and audible sound. PortAll - a neatly designed enclosed HDMI/MHL connection

compartment, supports streaming media from wireless HDMI dongles or MHL connectors, while a cable management hood connects onto the back of the projector and eliminates unsightly cable clutter. With HV keystone, corner adjustment, 1.3x optical zoom, shorter throw ratio, and easy network management, the PJD6357 provides flexible setup. Designed with smarter features and extensive connectivity, the networkable PJD6357 is ideal for use in education and corporate environments.

SuperColor: Best in Class Color Accuracy

ViewSonic’s proprietary SuperColor Technology offers a wider color range than conventional DLP projectors for true-to-life color performance in any light. SuperColor™ 6-Segment Color Wheel maximizes brightness Increased by 15% or more with the highest color saturation over others in the same class.



SuperColor™ projectors offer color accuracy levels



Conventional projectors offer low-quality images

Bright Images Less lighting limitations

Packed with 4000 lumens and a high contrast ratio, the PJD6357 is guaranteed to produce bright images in any environment – even in rooms with high ambient light.



Balanced Color and Brightness

Our unique ViewMatch picture mode delivers the optimum brightness and color for everyday projector use.

Normal



ViewMatch® Color Mode



Future-proof Connectivity

This projector includes ViewSonic’s exclusive Portal feature—a hidden compartment with an integrated and secure MHL/HDMI port that lets you discretely stream multimedia content from a wireless dongle, or lets you connect to other devices via an HDMI cable.



Extreme Mounting Flexibility

Equipped with a 1.3x optical zoom lens, this projector provides mounting flexibility with a wider throw distance range. With a 1.5 shorter throw ratio, this lens can also project large images from short distances in small rooms. And with a throw ratio ranging from 1.51 to 1.97, this projector can effectively replace typical DLP and 3LCD projectors without having to move or re-install existing projector mounts.

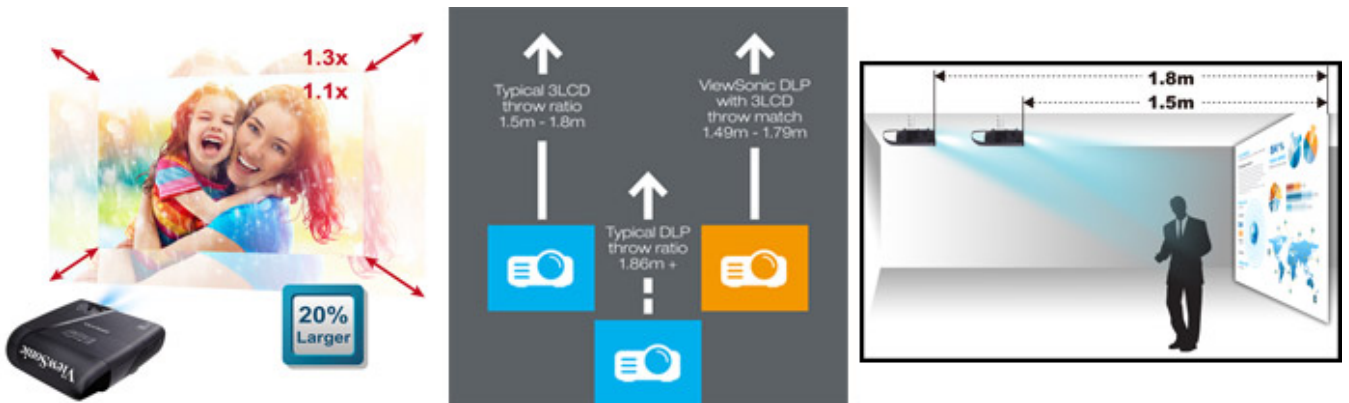

Easy Image Adjustments

Horizontal and vertical keystone correction and a corner adjustment feature eliminate crooked and distorted images for a perfectly proportioned picture every time.

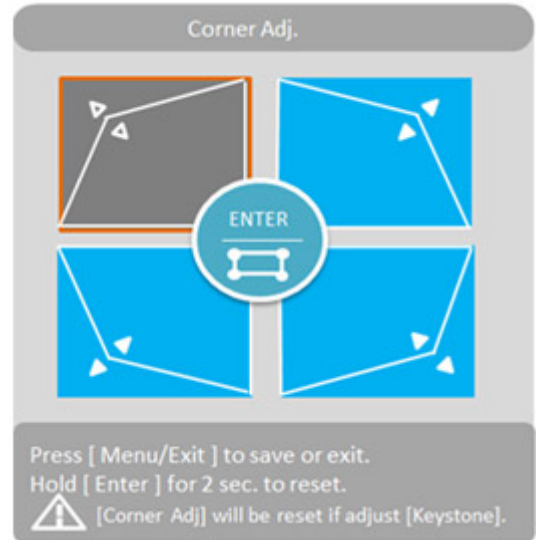
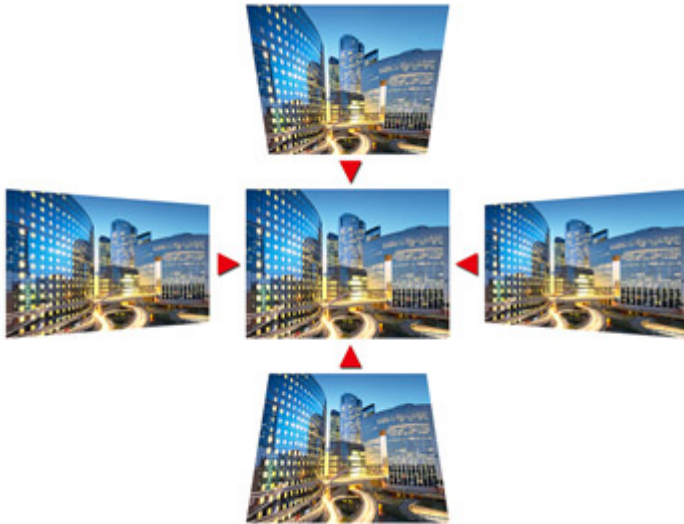

SonicExpert Technology For Best-in-Class Sound

ViewSonic's exclusive SonicExpert technology incorporates a ported speaker chamber and a more powerful amplifier to deliver higher volume and the absolute best-in-class sound.



SonicMode for Enhanced Audio Experience

ViewSonic's SonicMode offers three presets for different applications. Standard: offers the best sound levels for general use. Speech: enhances the sound of spoken words, making it ideal for projecting speeches and lectures, or for sales calls and video conferencing. Entertainment: delivers more bass and richer mid-high frequencies ideal for music and movies.



Remotely Monitor and Control up to 256 Projectors

All LightStream PJD6 projectors come equipped with Crestron RoomView Express, an easy-to-use network management system that lets administrators remotely monitor and control up to 256 LightStream projectors from a single PC.

Dual HDMI with 3D Blu-ray Support

Equipped with two HDMI ports, this projector can display 3D images directly from 3D Blu-ray players—perfect for connecting to any HDMI-enabled devices such as PCs, laptops, tablets, and media players.



Smart Fan and Free Air Flow Design

An integrated thermal sensor intelligently controls fan speed, reduces noise, and saves energy, while air flows freely through the projector for quick and efficient cooling of the lamp.

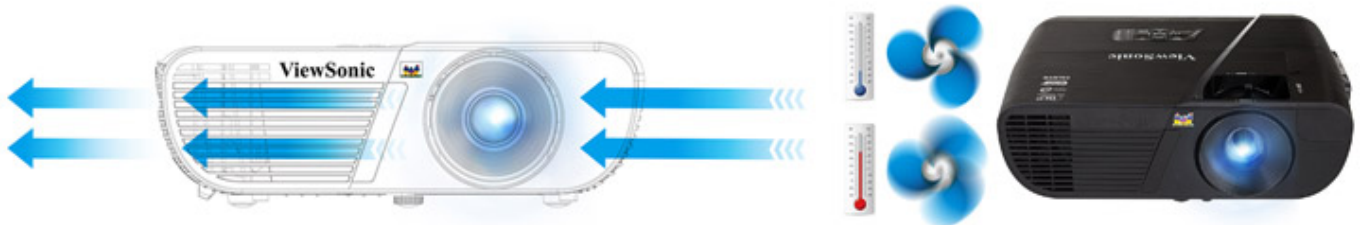

Hide Unsightly Cables

The cable management hood connects onto the back of the projector to hide unsightly cable clutter and exposed ports.



Easy Access Lamp

An easy-access top lamp door enables simple lamp maintenance and replacement.



Do It All with a Single Remote Control

A programmable hotkey “MyButton” can be configured to launch the most commonly used functions. A single remote control can also control up to eight projectors in the same venue. A Free vRemote App also allows users to control a projector via a mobile device.



App- The world’s pioneer ProjectorExpert APP Cover all completed projector applications at once!

ProjectorExpert APP contains all ViewSonic projector product information, projection distance measurement, ViewSync wireless introduction, industrial application case study, news messages, etc.. It integrates all projector related information and can be as general users’ perfect assistant when choosing or installing projectors, providing users’ a platform with convenient and sufficient information as well as to become dealers, distributors, system integrators’ portable tool which can check instantly.



App- ProjectorDistance App for Quick Projector Position Preview

No matter small meeting room, middle classroom, or big hall, ProjectorDistance tells you how far the projector should be placed according to the room ceiling height, projector’s screen size, aspect ratio, etc. Just input several figures, the result will

*App - vRemote App controller with snapshot keystone and lamp life monitor

Never worry about missing a remote control again! Users can download vRemote, the virtual remote control, onto any IR-enabled smartphone. If there is no IR function on smartphone, users

be displayed in the simulation scenarios with measurement. You can use finger to adjust the distance instantly.



can also plug in USB wireless adapter (PJ-WPD-200) into projectors, then users can have their Android™ or iOS devices wirelessly stream content to a projector. In addition, vRemote can instantly help users automatically correct keystone with a simple snapshot of the projected image. Administrators can also remotely view the projectors' lamp working hours and adjust keystone.

*Only available on certain models.



Technical Specifications

| | | |
|-----------------------------|---------------------|---|
| Display | Resolution | 1024x768 |
| | Lens | Optical Zoom: 1.3X; Digital Zoom:0.8X~2.0X |
| | Size | 30 - 300 inch |
| | Throw Distance | 1.0m - 10.0m |
| | Throw Ratio | 1.51~1.97 |
| | Lamp | 210W |
| | Brightness | 4000 ANSI Lumens |
| | Contrast Ratio | 20,000:1 (DynamicEco Mode) |
| | Keystone Correction | Vertical: +40~-40°, (Manual) |
| | Aspect Ratio | 4:3 |
| | Color Depth | 1.07 Billion Colors (30 bits per color) |
| | Optical Offset | 115 % +/-5% |
| | Audio | Speakers |
| Input Signal | Video | NTSC: NTSC M (3.58 MHz), 4.43MHz PAL: PAL (B, D, G, H, I, M, N, 60) SECAM: SECAM (B, D, G, K, K1, L) SD: 480i and 576i ED: 480p and 576p HD: 720p,1080i, 1080p |
| | Frequency | Fh: 15-102KHz; Fv: 23-120Hz |
| Compatibility | PC | 1024x768@60Hz (native) |
| | Mac | 1024x768@60Hz (native) |
| Connector | RGB Input | VGA Input x2 |
| | RGB Output | VGA Output x1 |
| | Composite Video | RCA-1 x1 |
| | S Video | Mini-Din 4 pin x1 |
| | Component Video | Share with VGAX2 |
| | Digital | HDMI 1.4x1 ; HDMI/MHL 2.0 x 1 |
| | Audio | Input: 3.5mm Mini-Mono Jack x2; Output: 3.5mm Mini-Mono Jack (x1); Microphone: Share with Audio in 2 connector |
| | Control | RS232 (DB-9) x1 |
| | USB | Mini USB x1 (For Mouse control & firmware upgrade) |
| | Network | LAN (RJ45) x1 |
| Power | Voltage | 100~240Vac 50/60Hz (Auto Switching) |
| | Consumption | 330W (Max.) |
| Operating Conditions | Temperature | 0°~40°C / 32°~104°F |
| | Humidity | 10~90%, Non-Condensation |
| Dimensions | Physical | 316mm (width) x 103.7mm (height) x 228mm (depth) |
| Weight | Net | 2.3 kg |
| Regulations | | CB, TUV-GS, UL/cUL, FCC (including ICES-003), CE,C-Tick Mexico Energy test/Registration, EAC, UkrSEPRO/EMC DOC, UL COC, TUV-S Mark(Argentina), PSB, KCC, KC, SASO, CCC WEEE, RoHS, REACH, SVHC, ErP |
| Package Contents | | Power Cord (1.8m) VGA Cable(1.8m) Remote Control with Batteries (With Laser) Quick Start Guide (one sheet version) ViewSonic CD Wizard (with User Manual) |