

FreeFit Installation Manual 2014



GLOBAL *Contract*

OHSAS 18001:2007

ISO 9001:2008

ISO 14001:2004

Global Contract Inc. 565 Petrolia Road
North York, Ontario, M3J 2X8

Visit us on the Internet at globalcontract.com • (416) 739-5000

TABLE OF CONTENTS

List of Tools P.02

Assembly P.03

Leg Attachment	3
Feet	4
Crossbars	4
Sidebar	5
Bumpers	5
3-Column 90° Telescopic Crossbars	6
3-Column 90° Fixed Crossbars	6
Electric 2 Column	7
Electric 3 Column	7

FreeFit



Required Tools



Robertson Screwdriver



Allenkeys



Drill with Roberson Bit



Warning leaflet and user manual should be left on the table after completed installation.



Please contact your Global Contract Service Representative at 416-739-5000 for any questions or concerns.

NOTE: Any alterations to listed components will void the manufacturer's warranty. The manufacturer will not be responsible for any damage or bodily harm caused by alterations in accordance with national or local electrical codes and manufac-

turer's specifications. In accordance with the manufacturer's policy of continual product improvement, the product presented in this document is subject to change without notice or obligation.24

INSTALLATION GUIDELINES

Leg attachment to surface

Note that these instructions show generic parts. Parts included in individual tables may differ in appearance and functionality but the assembly principle is the same.

Complete product

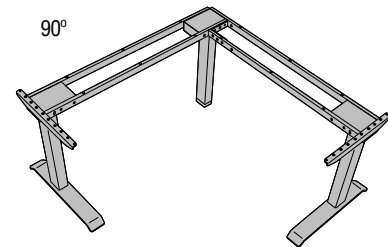
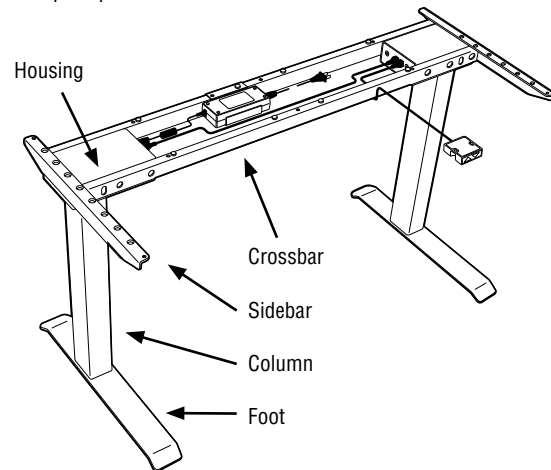

Complete product with worksurface

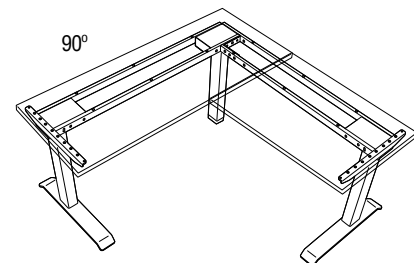
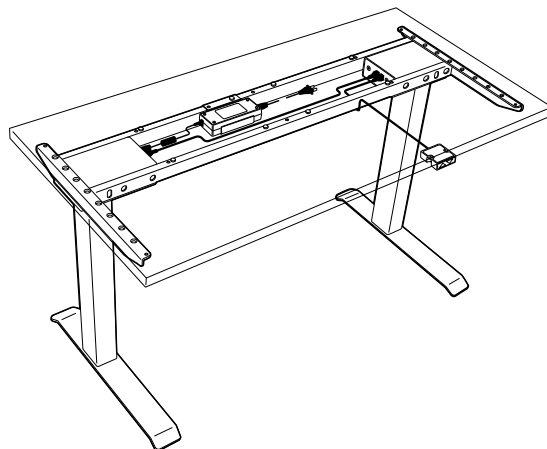

Feet

Assemble the feet on the columns. Tighten screws firmly.
IMPORTANT: Make sure the correct screws are used. Using too long screws may destroy internal parts in the column.

Screw Socket Round UNC 5/16- 18x5/8" Zn

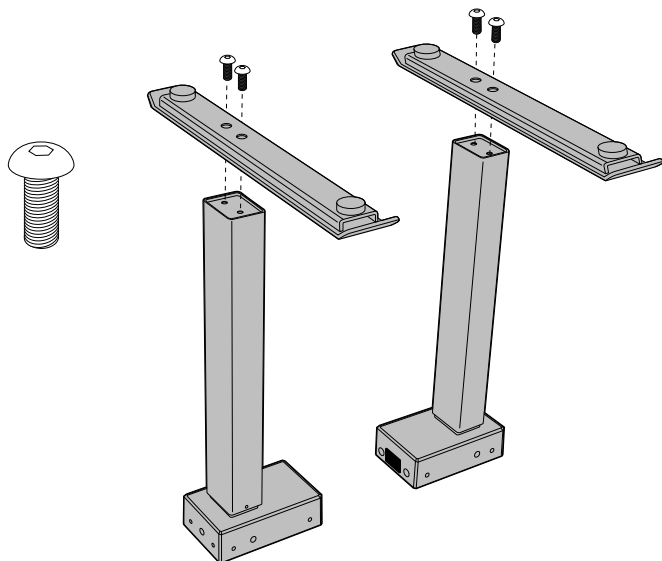

Crossbars

Screw socket CSK UNC
5/16 - 18x1" Zn

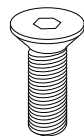

Loosen screws to adjust crossbar length.

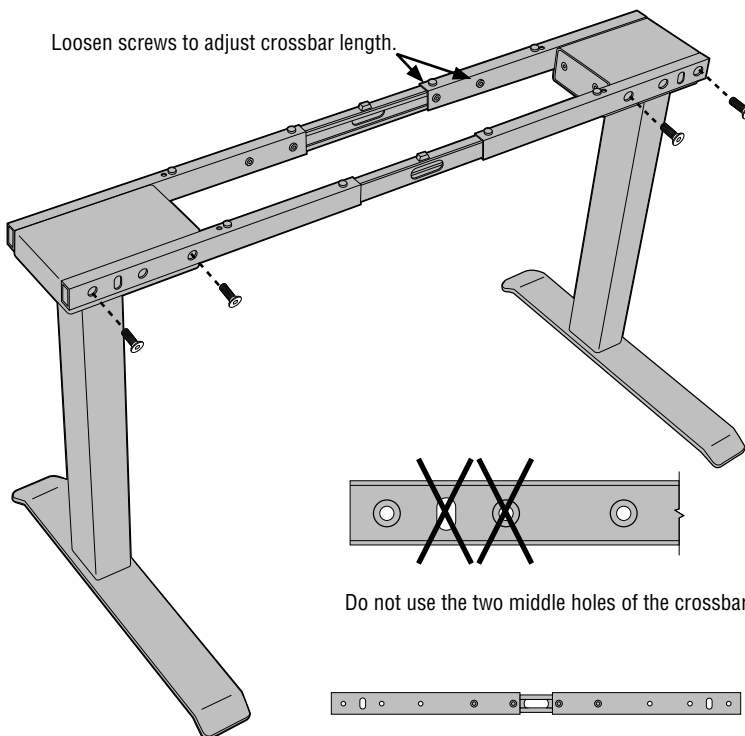

Do not use the two middle holes of the crossbars.



Adjustable crossbar



Fixed crossbar

INSTALLATION GUIDELINES

Sidebars

Fasten sidebars in threaded holes on top of crossbars with countersunk screws. Various types of sidebars exist, some of which can be placed in optional positions. The holes closest to the ends of the sidebar are dedicated for fixing of work top but any available hole can be used for this purpose.

Screw socket CSK UNC
1/4-20x5/8" Zn

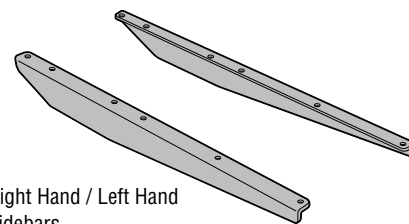
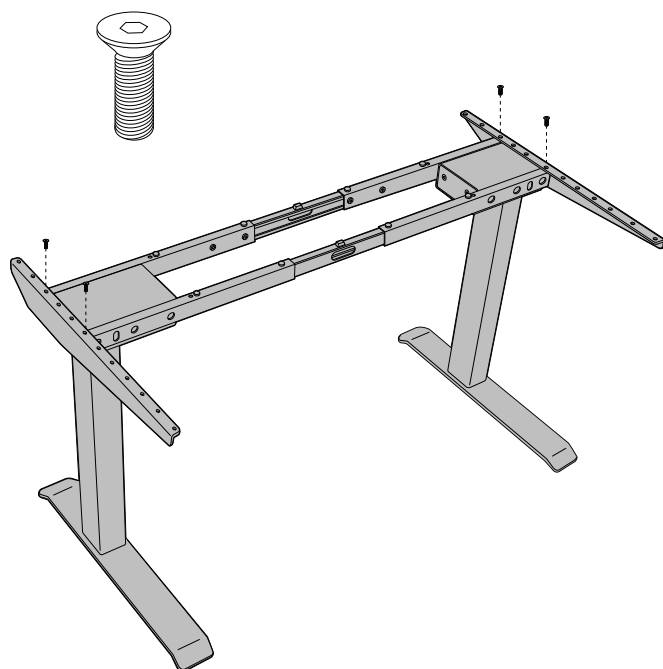

Right Hand / Left Hand
Sidebars

Bumpers

The work top is resting on the sidebars and on self-adhesive rubber bumpers placed on the crossbars. The bumpers should be placed as close to the fixing screws for the work top as possible to keep the work top from bending. The rubber bumpers come in two thicknesses. The thicker ones are used on the C-channel. On fixed crossbars the thick bumpers are not used.

Place the thin bumpers on the tube next to the screw hole and next to the tube edge.

Place the thick bumpers on the C-channel next to the screw hole.

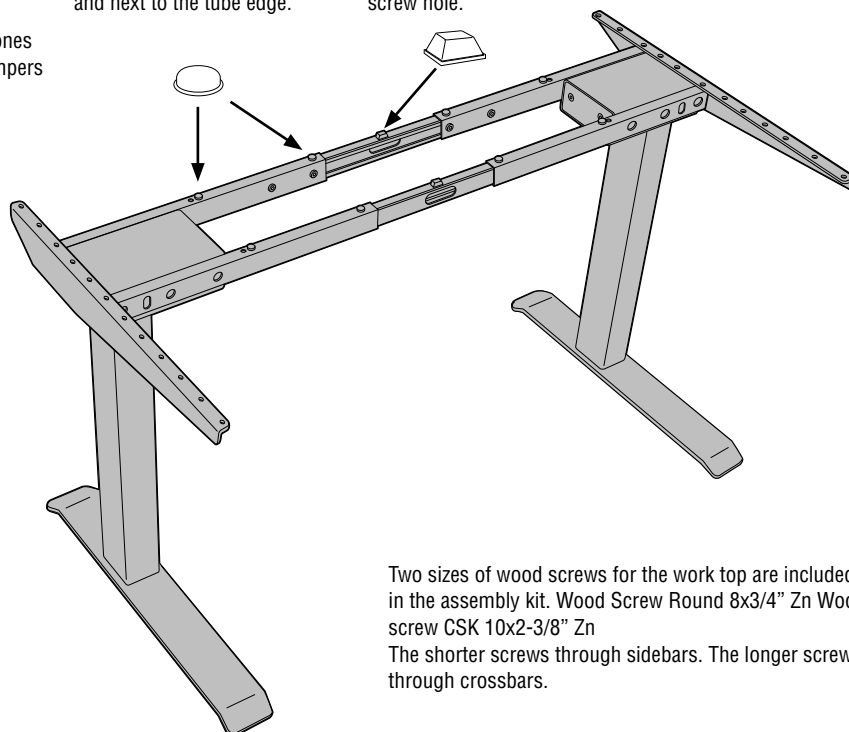

Bumper \varnothing 1/2" x 1/8"
Transparent

Bumper 1/2" x 1/2" x 1/4"
Transparent

Two sizes of wood screws for the work top are included in the assembly kit. Wood Screw Round 8x3/4" Zn Wood screw CSK 10x2-3/8" Zn
The shorter screws through sidebars. The longer screws through crossbars.

3-Column 90° Telescopic Crossbars

Attach the crossbars on the long side of the housings. Tighten screws firmly. **IMPORTANT:** Do not use the two middle holes of the crossbars. Do not insert any object in the two middle holes as this can damage electronic components.

Loosen the round headed screws on the cross-bars and adjust the frame to desired width.

Fasten the screws on the crossbars.

3 regular telescopic crossbars and 1 special telescopic crossbar with an angled C-channel are used.

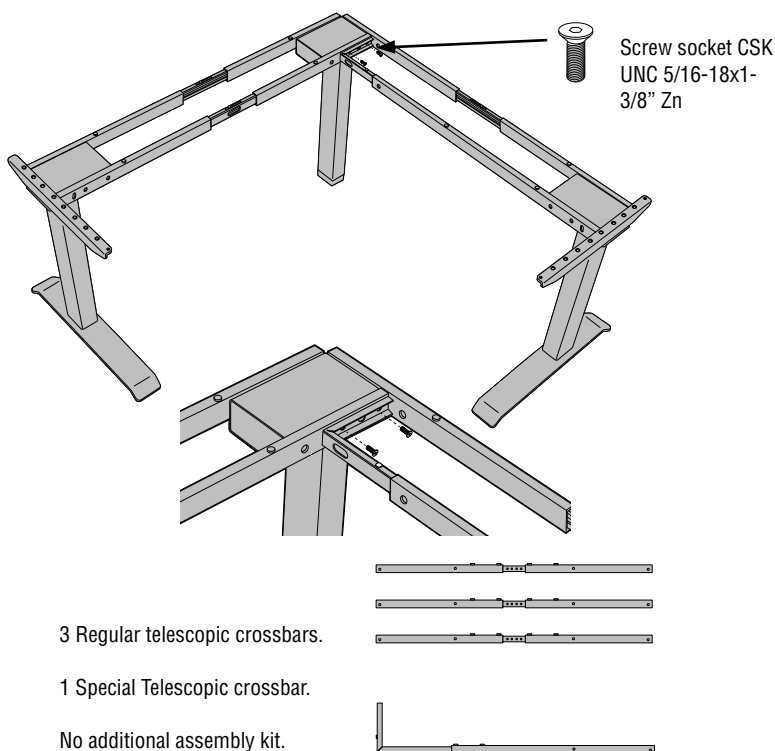

3-Column 90° Fixed Crossbars

3-Column 90° Table, Fixed Crossbars 3 regular fixed crossbars together with 1 regular fixed crossbar 6" shorter than the other three are used.

The assembly procedure is the same as for a 2-column table with the exception that the angled C-channel mounts to the middle house with one extra-long screw 1-3/8".

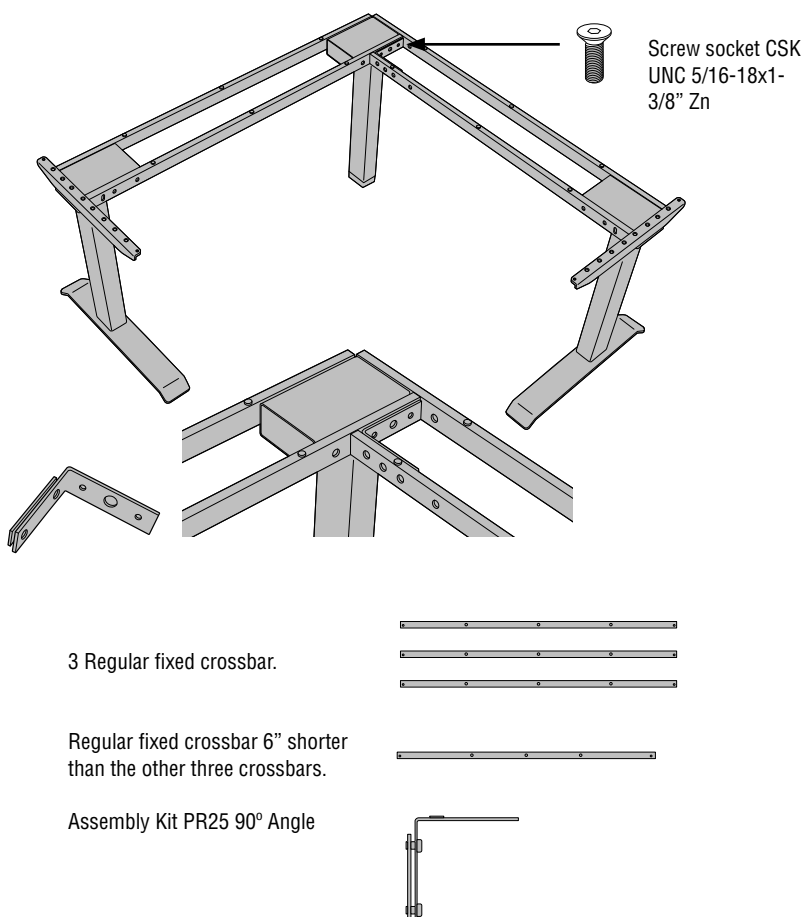

Electrical 2-Column

The handset is mounted at the front edge of the work top, screwed to the underside with screws supplied with the unit.
Connect cables and power supply according to

Power Supply D04 35V/2, 12A AC input 110-240V, 50-60Hz

Cable USA 2-pol IEC C7

Cable LinBus iDrive

ASM Light Handed w/Screws

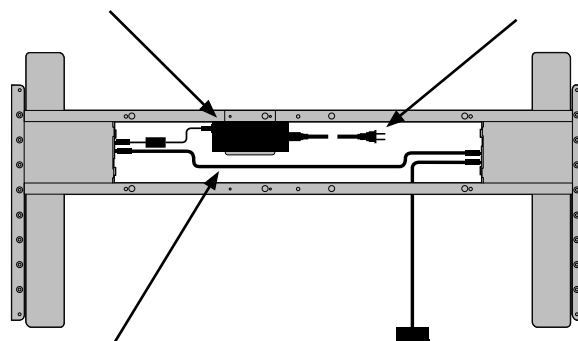

Electrical 3-Column

Power Supply D04 35V/2, 12A AC input 110-240V, 50-60Hz

Cable USA 2-pol IEC C7

Cable LinBus iDrive

ASM Light Handed w/Screws

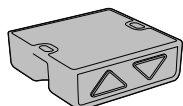
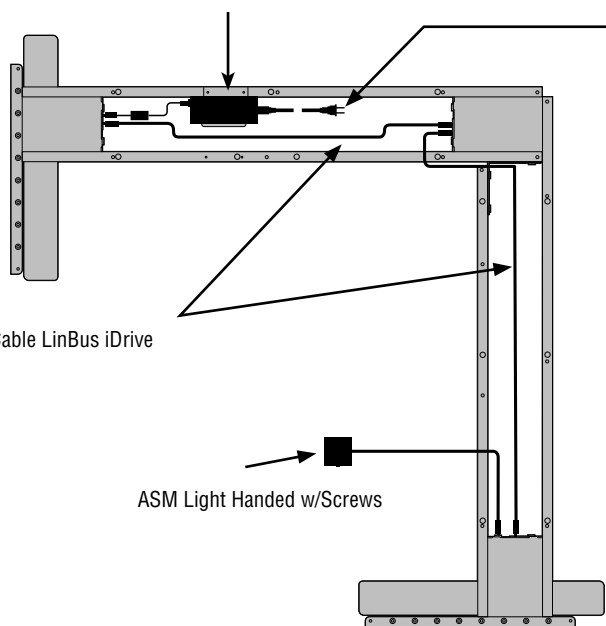

ASM Light Handset

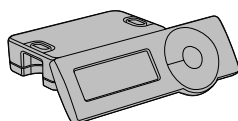

Handset w Display

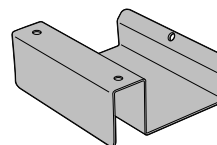

Holder for power supply, hooks over crossbar or screws into worksurface.

THE GLOBAL GROUP SHOWROOM

1350 Flint Road, Toronto, Ontario, M3J 2J7

Sales & Marketing • TEL: 1-877-446-2251 • FAX: 416-667-0338

Customer Service • TEL: 416-739-5000 • FAX: 800-361-3182

VANCOUVER SHOWROOM

3823 Still Creek Avenue, Burnaby, BC, V5C 4E2 • TEL: 604-432-1701

EDMONTON SHOWROOM

17716 107 Avenue, Edmonton, AB, T5S 1G8 • TEL: 780-444-8922

CALGARY SHOWROOM

12-2010 30th Avenue NE, Calgary, AB, T2E 7K9 • TEL: 403-250-7770

WINNIPEG SHOWROOM

1-1080 Waverley Street N, Winnipeg, MB, R3T 5S4 • TEL: 204-925-3350

OTTAWA SHOWROOM

201-150 Isabella Street, Ottawa, ON, K1S 1V7 • TEL: 613-234-2881

MONTREAL SHOWROOM

980 St-Antoine Street Ouest, Montreal, Bureau 200, QC, H3C 1A8 • TEL: 514-866-4331

HALIFAX SHOWROOM

1310 Hollis Street, Suite 150, Halifax, NS, B3J 3P3 • TEL: 902-422-7434

QUEBEC SHOWROOM

Complex Lebourgneuf 2, 815, boul. Lebourgneuf, Suite 502, Quebec, QC, G2JOC1 • TEL: 418-653-6111

GLOBAL *Contract*

Visit us on the Internet at globalcontract.com

OHSAS 18001:2007

ISO 9001:2008

ISO 14001:2004