



USER'S MANUAL
MANUEL DE L'UTILISATEUR
MANUAL DEL USUARIO

WE28UX8310

Contents

BEFORE USING THE PRODUCT	3	Cleaning
	4	Securing the Installation Space
	5	Correct Posture to Use the Product
SAFETY INFORMATION	6	Symbols
	7	Electrical Safety
	8	Installation Safety
PREPARATIONS	11	What's Included
	12	Installation
CONNECTIONS	15	Before Connecting
	15	Connecting PC
INITIAL SETUP	18	Before Using the Monitor
OSD MENU SETTINGS	19	SOURCE
	20	LANGUAGE
	21	PICTURE
	22	COLOR
	23	PIP/PBP
	24	AUDIO
	25	SETUP
	26	OSD SETUP
SPECIFICATIONS	27	General
	28	PowerSaver
	29	Standard Signal Mode Table

Before Using the Product

Cleaning

Exercise care when cleaning as the panel and exterior of advanced LEDs are easily scratched. Take the following steps when cleaning.

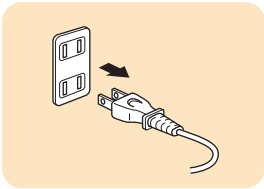

1. Power off the monitor and computer.
2. Disconnect the power cord from the monitor.



Hold the power cable by the plug and do not touch the cable with wet hands. Otherwise, an electric shock may result.

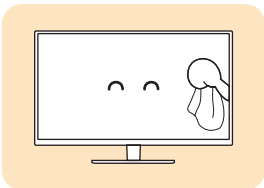

3. Wipe the monitor screen using a clean, soft and dry cloth.



- Do not apply a cleaning agent that contains alcohol, solvent, or surfactant to the monitor.
- Do not spray water or detergent directly on the product.



4. Wet a soft and dry cloth in water and wring thoroughly to clean the exterior of the monitor.

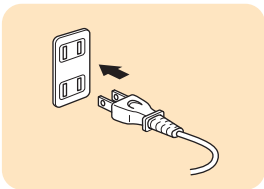

5. Connect the power cord to the product after cleaning.
6. Power on the monitor and computer.

Before Using the Product

Securing the Installation Space

Ensure some space around the product for ventilation. An internal temperature rise may cause fire and damage to the product. Be sure to allow the amount of space as shown below or greater when installing the product.

 The exterior may differ depending on the product.

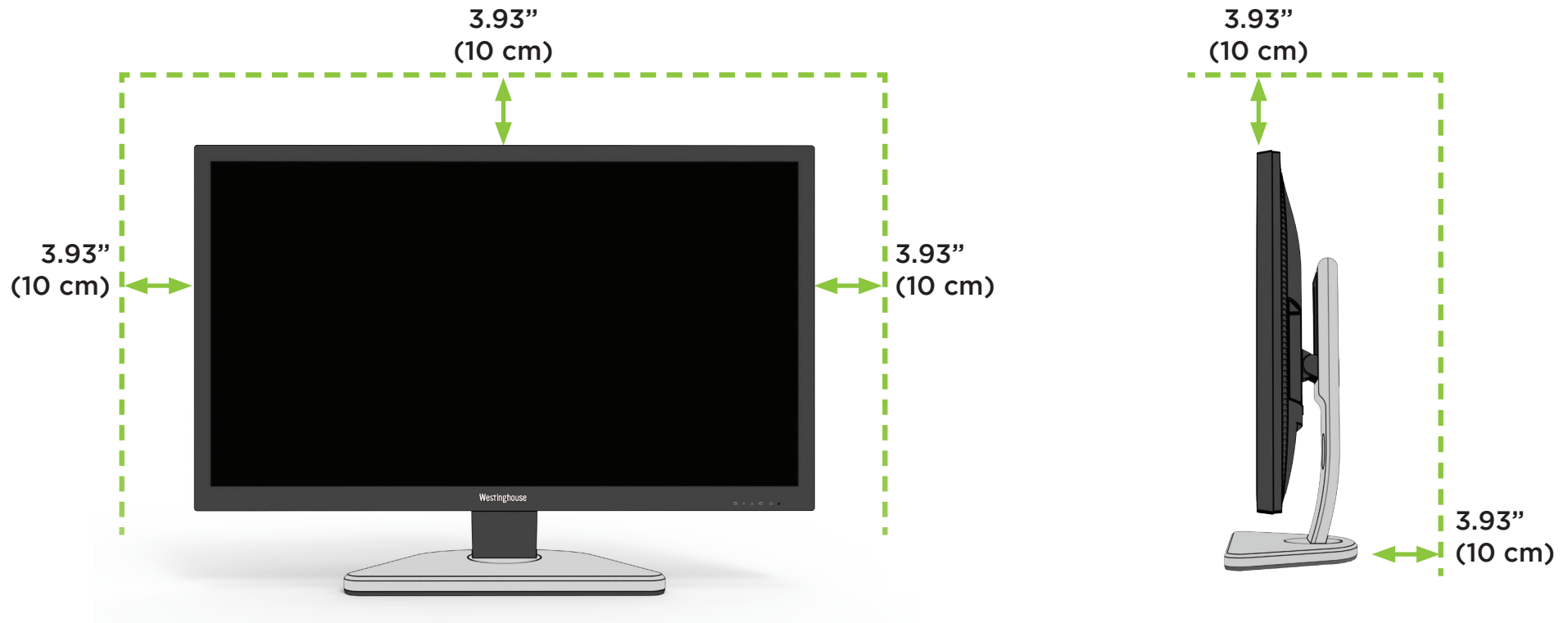

Before Using the Product

Correct Posture to Use the Product

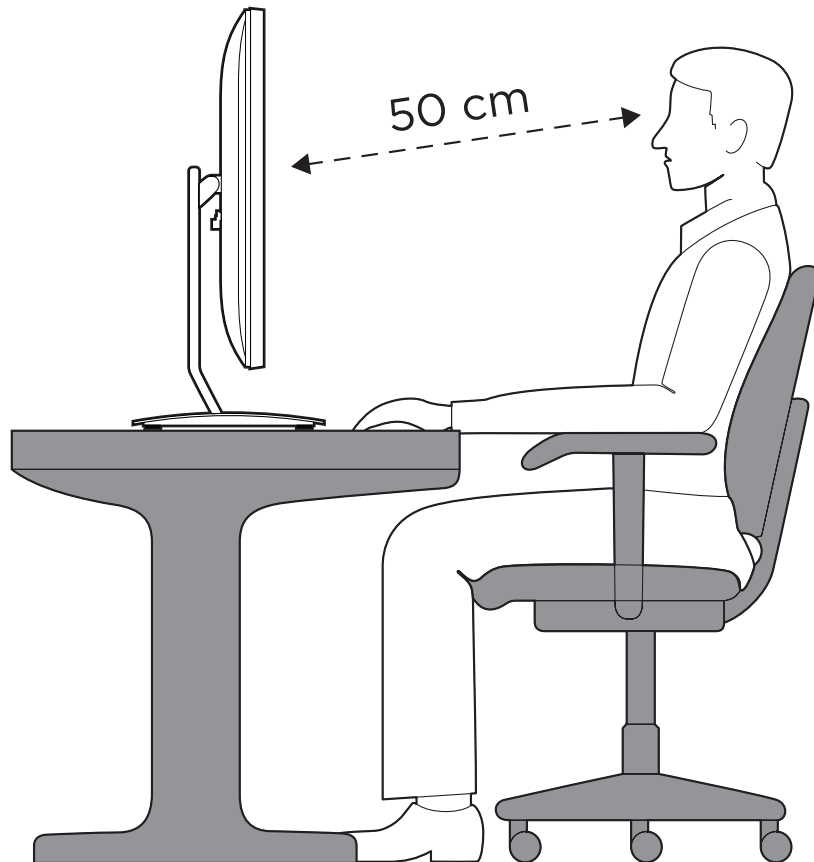







- Straighten your back.
- Allow a distance of 45 to 50 cm between your eyes and the screen, and look slightly downward at the screen.
- Keep your eyes directly in front of the screen.
- Adjust the angle so light does not reflect on the screen.
- Keep your forearms perpendicular to your upper arms and level with the back of your hands.
- Keep your elbows at about a right angle.
- Adjust the height of the product so you can keep your knees bent at 90 degrees or more, your heels attached to the floor, and your arms lower than your heart.

Safety Information

	CAUTION RISK OF ELECTRIC SHOCK DO NOT OPEN !	
Caution: TO REDUCE THE RISK OF ELECTRIC SHOCK, DO NOT REMOVE COVER (OR BACK). THERE ARE NO USER SERVICEABLE PARTS INSIDE. REFER ALL SERVICING TO QUALIFIED PERSONNEL.		

Symbols

	This symbol indicates that high voltage is present inside. It is dangerous to make any kind of contact with any internal part of this product.
	This symbol alerts you that important literature concerning operation and maintenance has been included with this product.

	A serious or fatal injury may result if instructions are not followed.
	Personal injury or damage to properties may result if instructions are not followed.
	Activities marked by this symbol are prohibited.
	Instructions marked by this symbol must be followed.

Safety Information

Electrical Safety



The following images are for reference only. Real-life situations may differ from what is shown in the images.

Warning

Do not use a damaged power cord or plug, or a loose power socket.

- An electric shock or fire may result.

Do not plug many products into the same power socket.

- Otherwise, the socket may overheat and cause a fire.

Do not touch the power plug with wet hands.

- Otherwise, an electric shock may result.

Fully insert the power plug in case it's loose.

- An unstable connection may cause a fire.

Be sure to connect the power plug to a grounded power socket. (type 1 insulated devices only).

- An electric shock or injury may result.

Do not bend or pull the power cord with force. Do not weigh the power cord down with a heavy object.

- A damaged power cord may cause an electric shock or fire.

Do not place the power cord or product near heat sources.

- An electric shock or fire may result.

Remove foreign substances such as dust around the plug pins and power socket with a dry cloth.

- Otherwise, a fire may result.

Caution

Do not unplug the power cord when the product is in use.

- The product may become damaged by an electric shock.

Do not use the power cord for products other than authorized products supplied by Seiki.

- An electric shock or fire may result.

Keep the power socket where the power cord is connected unobstructed.

- If any problem occurs in the product, unplug the power cable to completely cut the power to the product.
- Power to the product cannot be completely cut off with the power button.

Hold the plug when disconnecting the power cord from the power socket.

- An electric shock or fire may result.

The socket-outlet shall be installed near the equipment and shall be easily accessible.



This product meets ENERGY STAR[®] guidelines for energy efficiency. ENERGY STAR and the ENERGY STAR mark are registered U.S. marks. ENERGY STAR is a registered mark owned by the U.S. government.



This Monitor incorporates High-Definition Multimedia Interface (HDMI[™]) technology. HDMI, the HDMI logo and High-Definition Multimedia Interface are trademarks or registered trademarks of HDMI Licensing LLC.

Safety Information

Installation Safety

Warning

DO NOT PLACE CANDLES, INSECT REPELLANTS OR CIGARETTES ON TOP OF THE PRODUCT. DO NOT INSTALL THE PRODUCT NEAR HEAT SOURCES.

- Otherwise, a fire may result.

Avoid installing the product in a narrow space with bad ventilation, such as a bookshelf or wall closet.

- Otherwise, a fire may result due to an increased internal temperature.

Keep the plastic packaging bag for the product in a place that cannot be reached by children.

- Children may suffocate.

Do not install the product on an unstable or vibrating surface (insecure shelf, sloped surface, etc.).

- Otherwise, a fire may result.

Avoid installing the product in a narrow space with bad ventilation, such as a bookshelf or wall closet.

- The product may fall and break or cause a personal injury.
- Using the product in an area with excess vibration may damage the product or cause a fire.

Do not install the product in a vehicle or a place exposed to dust, moisture (water drips, etc.), oil, or smoke.

- An electric shock or fire may result.

Do not install the product within the reach of children.

- The product may fall and injure children.

Do not expose the product to direct sunlight, heat, or a hot object such as a stove.

- Otherwise, the product lifespan may be reduced, or a fire may result.

Do not install the product in a kitchen or near a kitchen counter.

- Edible oil, such as soybean oil, can damage or deform the product.

Caution

Take care not to drop the product when moving it.

- Otherwise, product failure or personal injury may result.

Do not set down the product on its front.

- The screen may become damaged.

When installing the product on a cabinet or shelf, make sure that the bottom edge of the front of the product is not protruding.

- The product may fall and break or cause personal injury.
- Install the product only on cabinets or shelves of the right size.

Put down the product carefully.

- The product may fall and break or cause personal injury.

Installing the product in an unusual place (a place exposed to a lot of fine dust, chemical substances, extreme temperatures or a significant presence of moisture, or a place where the product will operate continuously for an extended period of time) may seriously affect its performance.

- Be sure to consult Seiki Customer Service Center before installation if you want to install the product at such a place.

Safety Information

Installation Safety

Warning

High voltage runs through the product. Do not attempt to disassemble, repair, or modify the product on your own.

- An electric shock or fire may result.
- Contact Seiki Customer Service Center for repair.

Before moving the product, turn off the power switch and disconnect the power cable and all other connected cables.

- Otherwise, the power cord may be damaged and a fire or electric shock may result.

If the product generates a strange noise, a burning smell, or smoke, remove the power cord immediately and contact Seiki Customer Service Center.

- An electric shock or fire may result.

Do not let children hang from the product or climb on top of it.

- The product may fall, and your child may become injured or seriously harmed.

If the product falls or the exterior is damaged, power off the product, remove the power cord, and contact Seiki Customer Service Center.

- Otherwise, an electric shock or fire may result.

Do not put a heavy object, toy, or sweets on top of the product.

- The product or heavy objects may fall as children try to reach for the toy or sweets resulting in a serious injury.

If there is a thunderstorm or lightning strike, turn off the power and disconnect the power cable.

- An electric shock or fire may result.

Do not move the product by pulling the power cord or any cable.

- Otherwise, the cable may be damaged and product failure, an electric shock or fire may result.

If a gas leakage is found, do not touch the product or power plug. Also, ventilate the area immediately.

- Sparks can cause an explosion or fire.

Do not use or keep combustible spray or an inflammable substance near the product.

- An explosion or fire may result.

Ensure the vents are not blocked by tablecloths or curtains.

- Otherwise, a fire may result from an increased internal temperature.

Do not insert a metallic object (a chopstick, coin, hair pin, etc.) or inflammable object (paper, match, etc.) into the vent or ports of the product.

- If water or any foreign substance enters the product, be sure to power off the product, remove the power cord, and contact Seiki Customer Service Center.
- Product failure, an electric shock or fire may result.

Do not place objects containing liquid (vases, pots, bottles, etc) or metallic objects on top of the product.

- If water or any foreign substance enters the product, be sure to power off the product, remove the power cord, and contact Seiki Customer Service Center.
- Product failure, an electric shock or fire may result.

Safety Information

Caution

Leaving the screen fixed on a stationary image for an extended period of time may cause afterimage burn-in or defective pixels.

- If you are not going to use the product for an extended period of time, activate power-saving mode or a moving-picture screen saver.

Disconnect the power cord from the power socket if you do not plan on using the product for an extended period of time (vacation, etc.).

- Otherwise, a fire may result from accumulated dust, overheating, an electric shock, or electric leakage.

Use the product at the recommended resolution and frequency.

- Otherwise, your eyesight may be deteriorated.

Looking at the screen too close for an extended period of time can deteriorate your eyesight.

Do not hold the monitor upside-down or move it by holding the stand.

- The product may fall and break or cause personal injury.

Do not use humidifiers or stoves around the product.

- An electric shock or fire may result.

Rest your eyes for more than 5 minutes for every 1 hour of product use.

- Eye fatigue will be relieved.

Do not touch the screen when the product has been turned on for an extended period of time as it will become hot.

Store the small accessories used with the product out of reach of children.

Exercise caution when adjusting the product angle or stand height.

- Otherwise, children's fingers or hands may become stuck and injured.
- Tilting the product excessively may cause it to fall and result in personal injury.

Do not place heavy objects on the product.

- Product failure or personal injury may result.

When using headphones or earphones, do not turn the volume too high.

- Having the sound too loud may damage your hearing.

Preparations

What's Included



- Contact the dealer from whom you purchased the product if any item is missing.
- The appearance of the components may differ from the image shown.



Display Panel

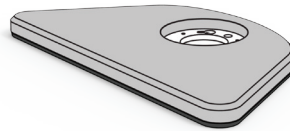

Base



Stand



Power Cord

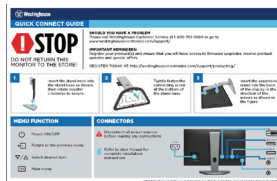

Quick Connect Guide



User Manual Disc



Warranty Card

- Components may vary depending on the country.
- The optimal resolution may not be available when using a non-high speed HDMI or HDMI-DVI cable.



Preparations

Installation

Attaching the Stand



- Before assembling the product, place the product down on a flat and stable surface.

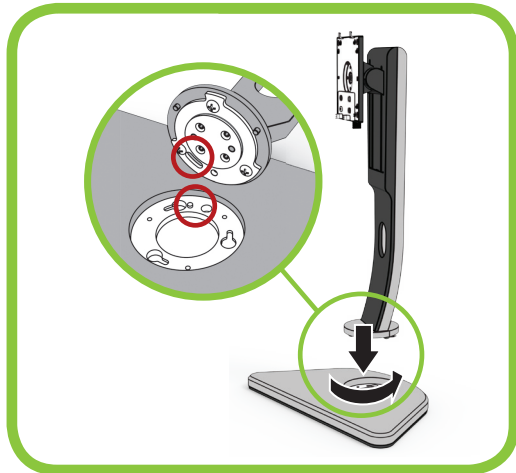

When inserting the stand, aim the groove directly to the convex on the base, then anticlockwise rotate the stand to the end.

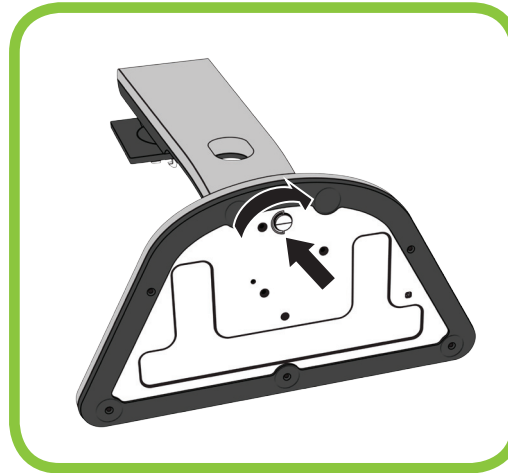

Fasten the connecting screw at the bottom of the stand base.



Push the assembled stand into the main body in the direction of the arrow as shown in the figure.



- For more security fixing the stand to the main body, you can fasten the 2 screws on the back of the mounting plate.

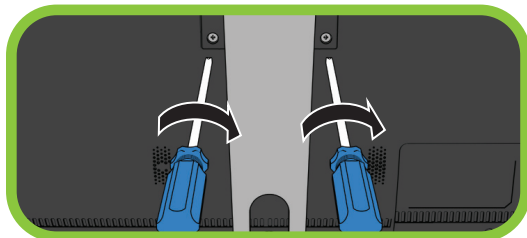

Preparations

Adjusting the Screen



- Adjust the screen to the best height, angle and direction.

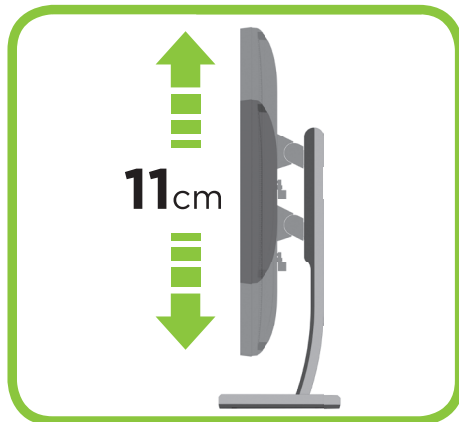

Move the screen up and down 11cm.

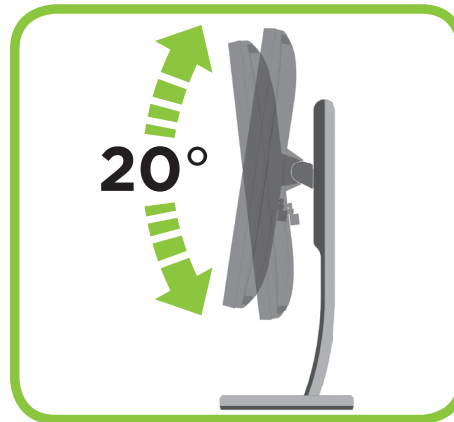

The screen can lean backward 15°, lean forward 5°.

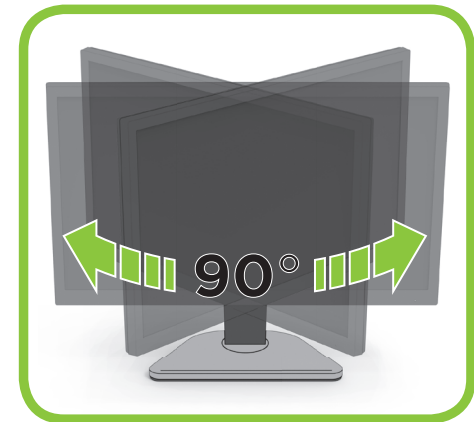

Turn the screen 45° to the left or 45° to the right.

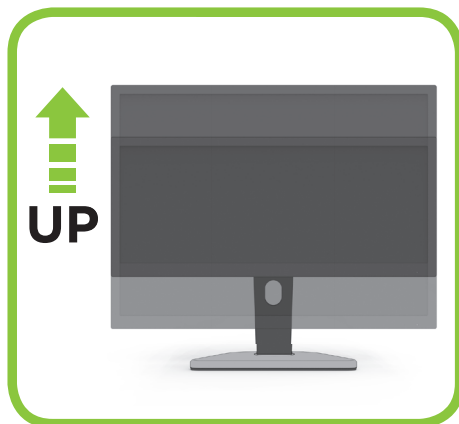

UP

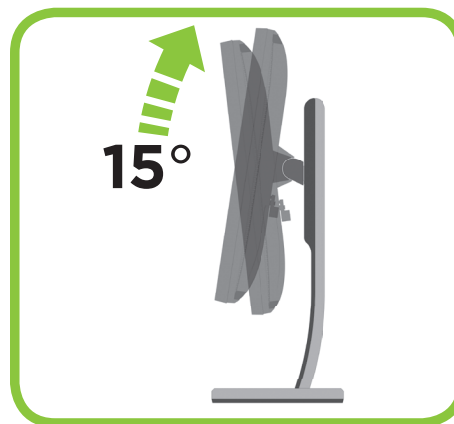

15°

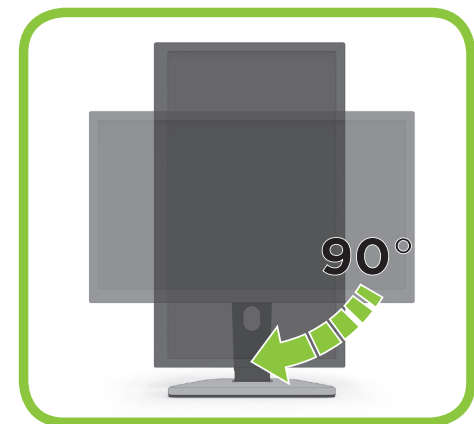

90°

Move the screen up to the top, and lean backward to the maximum angle, then rotate the screen 90° to the right.

Preparations

Removing the Stand



- If you already fasten the 2 screws on the back of the mounting plate, be sure to loosen them first.

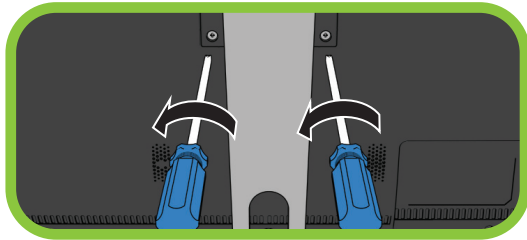

- Before removing the product, place the product down on a flat and stable surface.



Toggle the lever on the stand, then pull the assembled stand out of the main body in the direction of the arrow as shown in the figure.

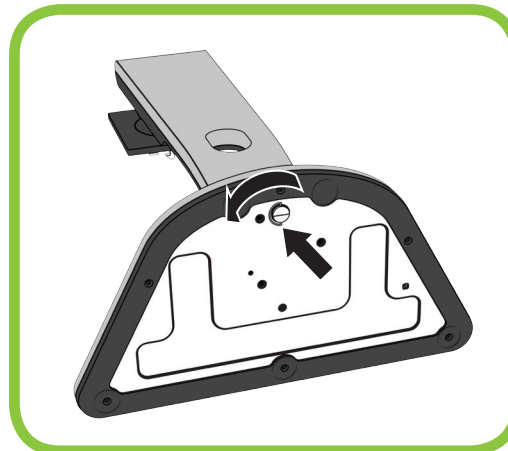

Loosen the connecting screw at the bottom of the base.



Clockwise rotate the stand and pull it out of the base in the direction shown in the figure.

Connections

Before Connecting

- Before connecting a source device, read the user manual provided with it. The number and locations of ports on source devices may differ from device to device.
- Do not connect the power cable until all other connections are completed. Connecting the power cable during connection may damage the product.
- Check the types of ports at the back of the product you want to connect.

Connecting PC

Select a connection method suitable for your PC.



- Do not connect the power cable before connecting all other cables.
- Ensure you connect a source device first before connecting the power cable.
- Connecting parts may differ in different products.

Connection Using the DVI Cable



1. Connect the DVI cable to the **DVI** port on the back of the product and the **DVI** port on the PC.
2. Connect the power cable to the product and a power socket. Next, turn on the power switch on the PC.
3. Change the input source to **DVI** by touching Δ / ∇ , when input source is not set.

Connections

Connection Using the HDMI Cable

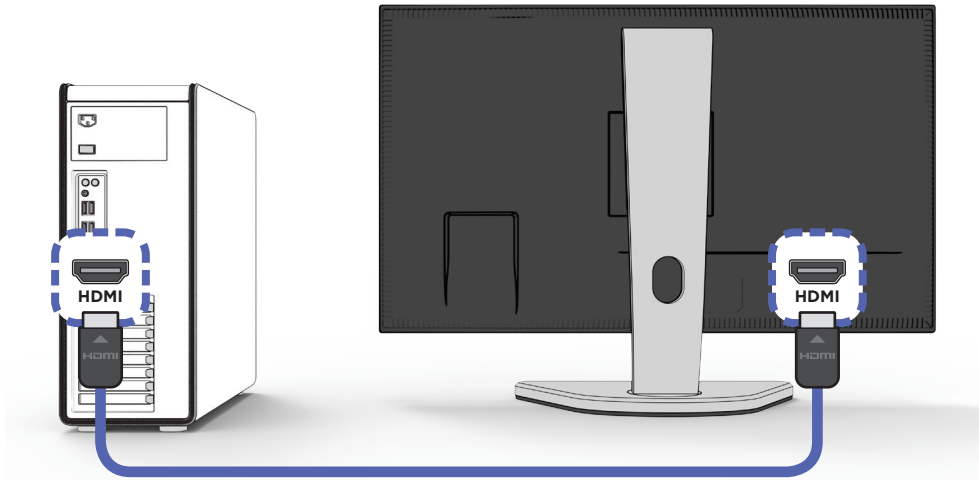

1. Connect the HDMI cable to the **HDMI 1** , **HDMI 2** or **HDMI 3** port on the back of the product to the **HDMI** port on the PC.
2. Connect the power cable to the product and a power socket. Next, turn on the power switch on the PC.
3. Change the input source to **HDMI 1** , **HDMI 2** or **HDMI 3** by touching Δ / ∇ , when input source is not set.

Note:HDMI 1 port version is 2.0 and other HDMI port version is 1.4.

HDMI 2.0 can support the 3840*2160@60Hz max resolution and

HDMI 1.4 only support the max resolution to 3840*2160@30Hz.

Connection Using the DisplayPort (DP) Cable





1. Connect the DP cable to the **DP** port on the back of the product and the **DP** port on the PC.
2. Connect the power cable to the product and a power socket. Next, turn on the power switch on the PC.
3. Change the input source to **DP** by touching Δ / ∇ , when input source is not set.

Connections

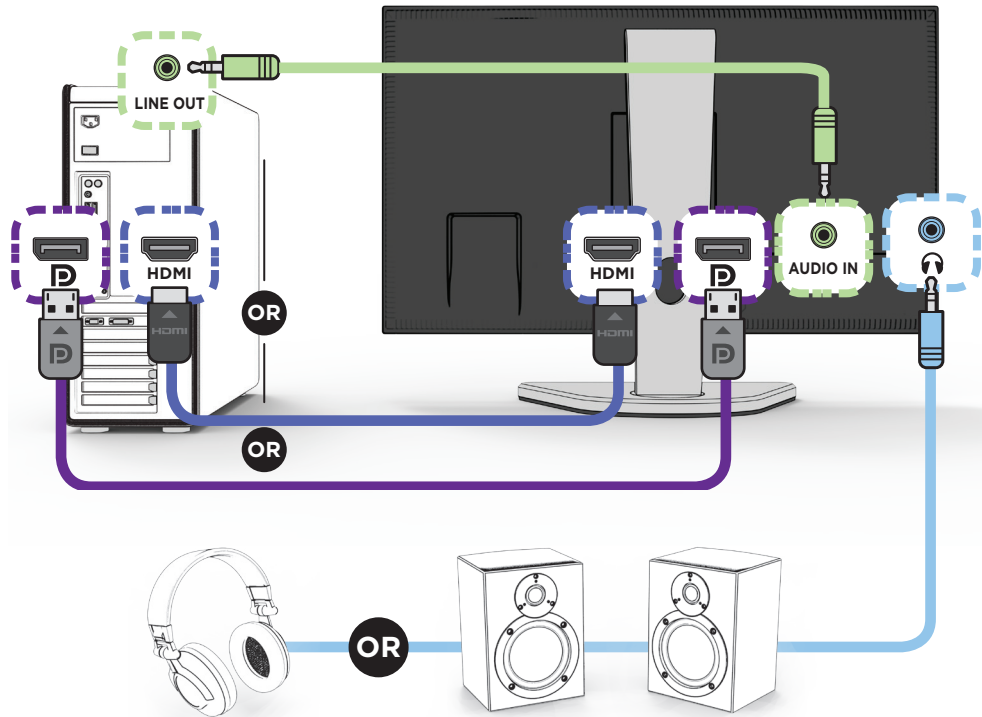
Connecting to Headphones or Audio In



1. Connect the Mini Audio cable to the **PC AUDIO/HDMI/DP** port on the back of the product and the **AUDIO/HDMI/DP** port on the PC.
2. Connect an audio output device such as headphones or speakers to  port on the product.

 • The sound could only be heard when using the **Mini Audio** cable / **HDMI to HDMI** cable / **DP** cable.

Connecting the Power

- Connect the power cable on the rear of the product. Plug in the power cable to the power socket.

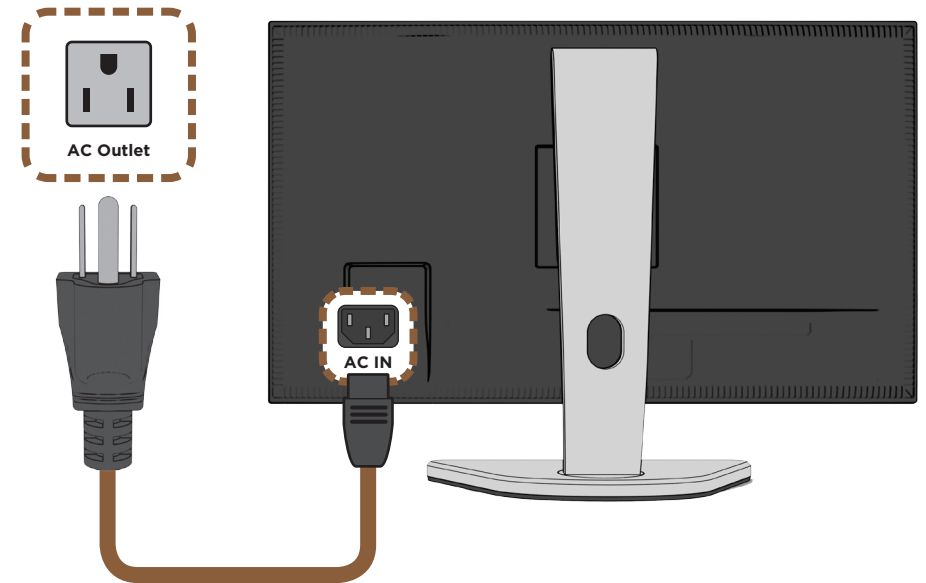

Initial Setup

Before Using the Monitor





Connect external equipments properly.
Insert the power plug, and switch ON the main power switch on the back.

Power On/Off

- Touch the  on the front of the monitor. The power indicator light will turn blue when the Monitor is ON.

Menu Button Function

Adjusting OSD menu settings by controlling menu buttons on the front of the monitor.

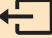
	Enter the main menu; Confirm the selection.
	Touch to select different sources among: DVI, HDMI 1, HDMI 2, HDMI 3, DisplayPort .
	Use the  /  touch sensor to select the desired item.
	Return to the previous menu.

OSD Menu Settings

SOURCE

Touch the  to enter SOURCE mode, then touch the  again to enter and use the Δ/∇ to select among different input signals.

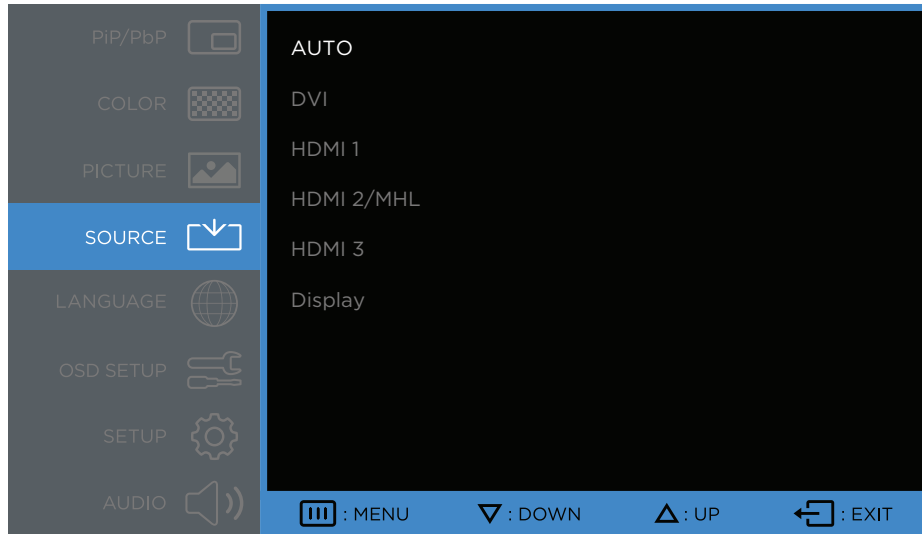

Touch the  to display the On Screen Display menu.

Touch the  again to enter the input source list.

Touch the Δ/∇ to select your desired input source and touch the  to confirm.

Touch the  to exit.

AUTO	To select the source automatically.
DVI	Maximum resolution: 3840x2160 @30Hz (Digital Signal)
HDMI 1	
HDMI 2/MHL	Maximum resolution: 3840x2160 pixels @60Hz(Only HDMI1) (Digital Signal)
HDMI 3	
DisplayPort	Maximum resolution: 3840x2160 pixels @60Hz (Digital Signal)

OSD Menu Settings

LANGUAGE

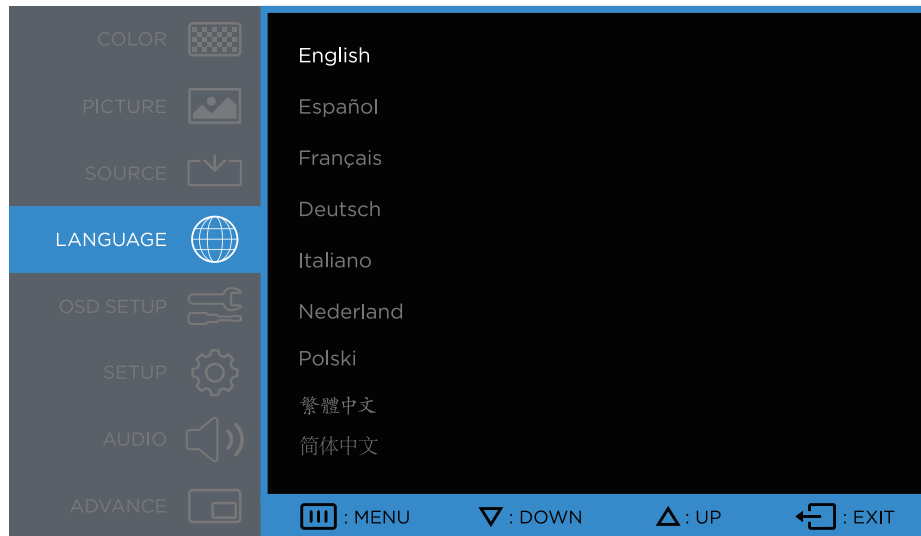

To allow users to choose from available languages.



Touch the  to display the On Screen Display menu.

Touch the  to select LANGUAGE.

Touch the  again to enter the language setting.

Touch the  to select your desired setting and touch the  to confirm.

Touch the  to exit.

OSD Menu Settings

PICTURE

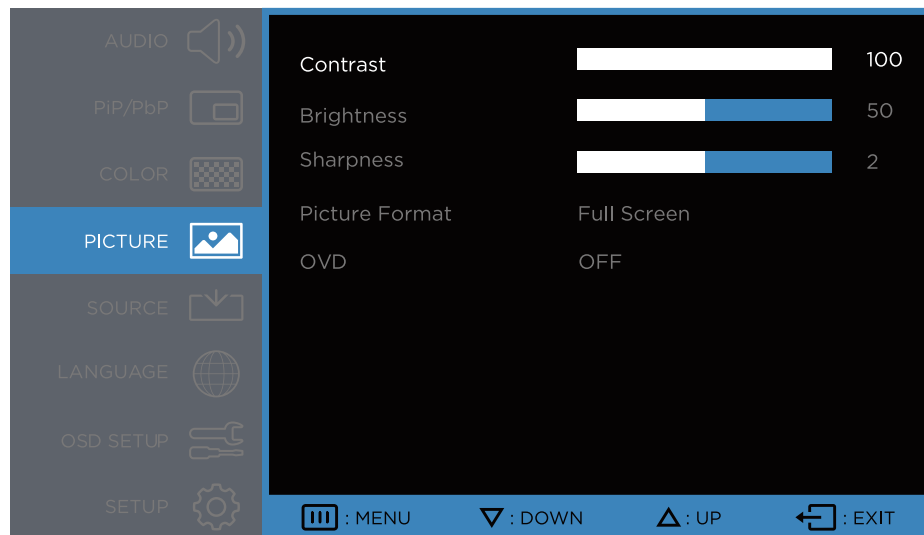

Manually adjust the Brightness, Contrast, Sharpness, Black equalize and Picture Format.



Touch the  to display the On Screen Display menu.

Touch the  to select PICTURE.

Touch the  again to enter the picture setting.

Touch the  to select your desired setting and touch the  to enter. Then use the  to adjust the setting.

Touch the  to exit.

Contrast	To adjust the foreground white level of screen image.
Brightness	To adjust the clarity of a non-UHD Resolution (3840x2160) signal.
Sharpness	To adjust the luminance of the video.
Picture Format	To select the video mode from Full Screen,16:9,4:3,5:4,Origin.
OVD	Allows the user to change the Over Drive strength. Improve the quality of the motion pictures.

OSD Menu Settings

COLOR

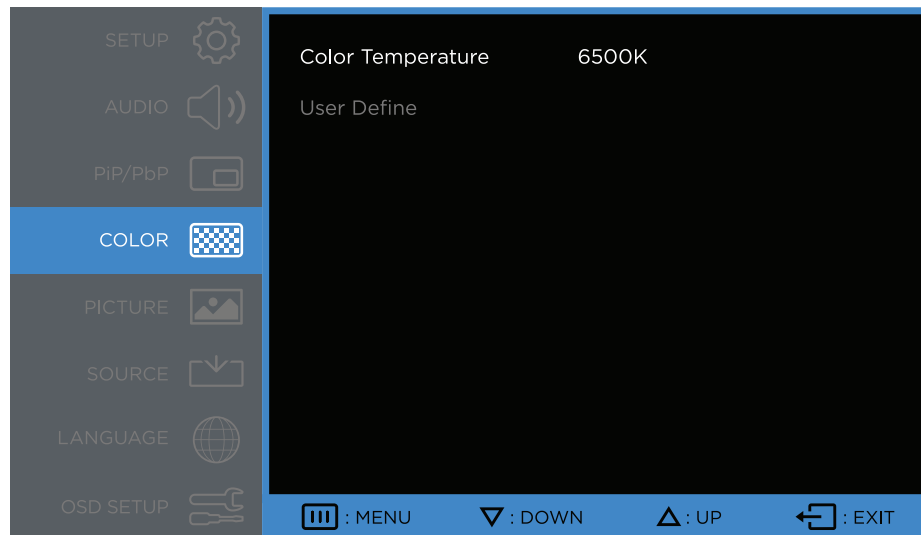

To select the color to adjust Color Temperature and User Define.



Touch the  to display the On Screen Display menu.

Touch the  to select COLOR.

Touch the  again to enter the color setting.

Touch the  to select your desired setting and touch the  to enter. Then use the  to adjust the setting.

Touch the  to exit.

Color Temperature	Cycle among color temperatures: 11000K, 9300K , 6500K or User Define.
User Define	Individual adjustments for red(R), green(G), blue(B).

OSD Menu Settings

PIP/PBP (This model doesn't support PiP/PBP Function.)

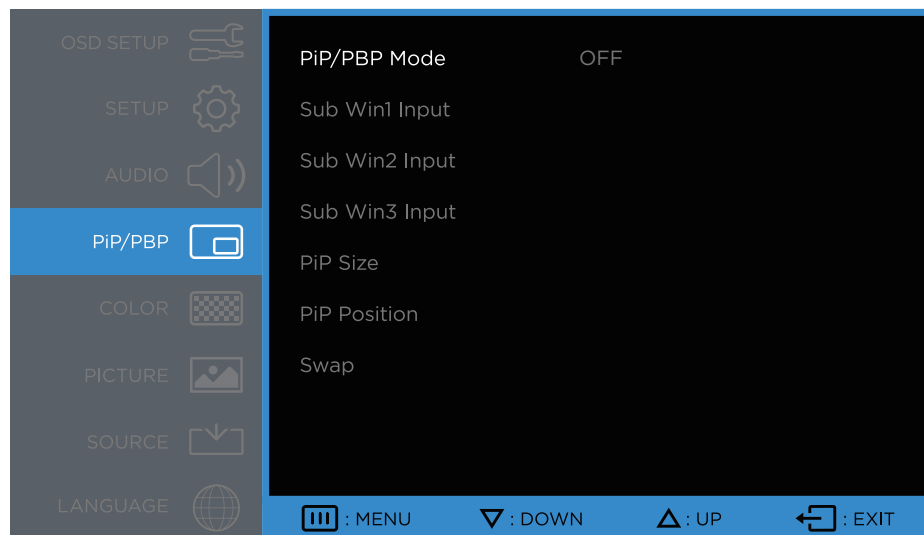

PiP/PBP allows you to watch two screens from different sources at the same time. (PiP is picture in picture; PBP is picture by picture)



Touch the  to display the On Screen Display menu.

Touch the  to select PiP/PBP.

Touch the  again to enter the PiP/PBP setting.

Touch the  to select your desired setting and touch the  to enter. Then use the  to adjust the setting.

Touch the  to exit.

PiP/PBP Mode	Toggle to enable /disable PiP/PBP function.
Sub Win1 Input	To select input source for sub-screen as following.
Sub Win2 Input	To select input source for sub-screen as following.
Sub Win3 Input	To select input source for sub-screen as following.
PiP Size	To adjust sub-screen window size.
PiP Position	To adjust sub-screen window position.
Swap	Switch between main screen and sub-screen.

OSD Menu Settings

AUDIO

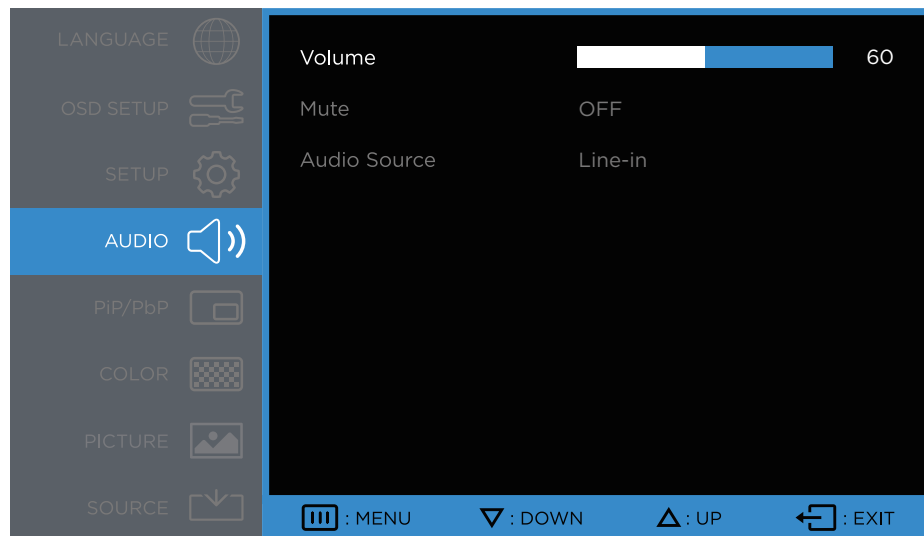

To adjust the audio functions.



Touch the  to display the On Screen Display menu.

Touch the  to select AUDIO.

Touch the  again to enter the audio setting.

Touch the  to select your desired setting and touch the  to enter. Then use the  to adjust the setting.

Touch the  to exit.

Volume	To adjust the volume of speaker output.
Mute	To turn the Mute ON/OFF.
Audio Source	<ul style="list-style-type: none">• When in HDMI 1 ,HDMI 2 or HDMI 3 input, select where the audio source comes from Line-in, HDMI 1,HDMI 2 or HDMI 3.• When in DisplayPort input, select where the audio source comes from Line-in, DisplayPort.

OSD Menu Settings

SETUP

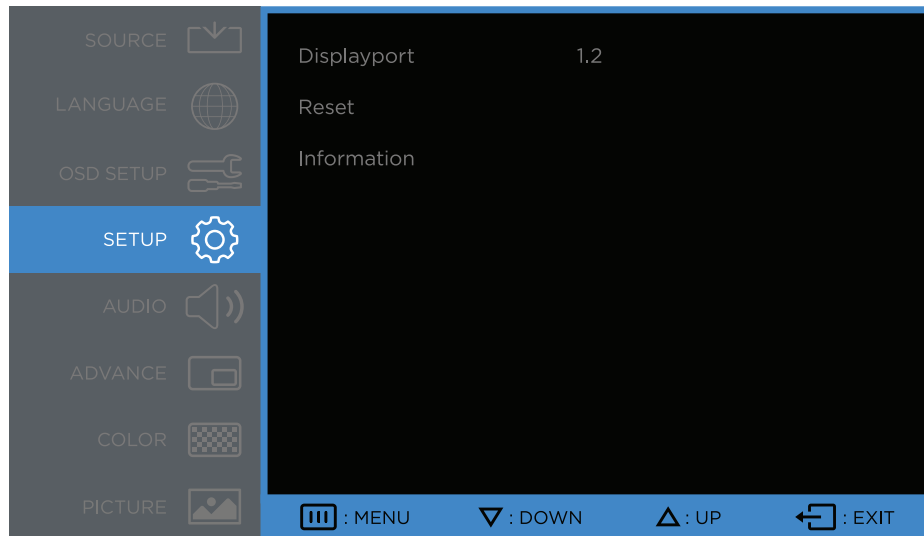

To set up DisplayPort, Reset and Information.



Touch the  to display the On Screen Display menu.

Touch the  to select SETUP.

Touch the  again to enter the setup setting.

Touch  to select your desired setting and touch the  to enter. Then use the  to adjust the setting.

Touch the  to exit.

DisplayPort	To set the Displayport version. (Displayport 1.1 support max resolution 3840x2160@30Hz, Displayport 1.2 support max resolution 3840x2160@60Hz)
Reset	To recall factory settings for Video & Audio controls.
Information	To display the information, regarding the current input signal coming from the graphic card in your computer.

OSD Menu Settings

OSD SETUP

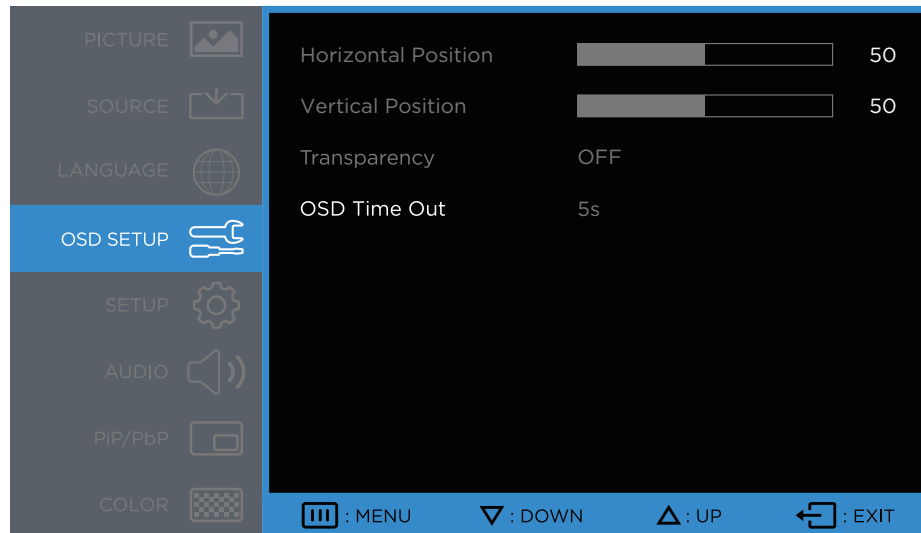

To manually adjust the Horizontal/Vertical OSD position, Transparency and OSD Time Out.



Touch the  to display the On Screen Display menu.

Touch the  to select OSD SETUP.

Touch the  again to enter the OSD setting.

Touch the  to select your desired setting and touch the  to enter. Then use the  to adjust the setting.

Touch the  to exit.

Horizontal Position	To horizontally adjust the OSD position.
Vertical Position	To vertically adjust the OSD position.
Transparency	To change the transparency of OSD window.
OSD Time Out	To automatically turn off On Screen Display(OSD) after a preset period of time.

Specifications

General

Model Name		WE28UX8310
Panel	Size	28 Inches (71 cm)
	Display area	620.93 mm (H) x 341.28 mm (V) 24.44 Inches (H) x 13.34 Inches (V)
	Pixel Pitch	0.16 mm (H) x 0.16 mm (V) 0.0063 Inches (H) x 0.0063 Inches (V)
	Brightness	300 Cd/M ²
Power Supply		AC 100 - 240 V ~, 50/60 Hz
Dimensions (W x D x H) / Weight	Without Stand	663 x 58 x 393 mm / 5.5 kg 26.10 x 2.28 x 15.47 inches / 12.13 lbs
	With Stand	663 x 186 x 475-585 mm / 8 kg 26.10 x 7.32 x 18.70-23.03 inches / 17.63 lbs
Environmental considerations	Operating	Temperature : 32°F ~ 95°F (0°C ~ 35°C) Humidity : 20 % - 80 %, non-condensing
	Storage	Temperature : 32°F ~ 122 °F (0°C ~ 50°C) Humidity : 5 % - 95 %, non-condensing

Panel Dots (Pixels)

Due to the nature of the manufacturing of this product, approximately 1 pixel per million (1ppm) may be brighter or darker on the LCD panel. This does not affect product performance.

Plug-and-Play

This monitor can be installed and used with any Plug-and-Play compatible systems. Two-way data exchange between the monitor and PC system optimizes the monitor settings. Monitor installation takes place automatically. However, you can customize the installation settings if desired.

The above specifications are subject to change without notice to improve quality.

Specifications

PowerSaver

The power-saving function of this product reduces power consumption by switching off the screen and changing the color of the power LED if the product is not used for a specified period of time. The power is not turned off in power-saving mode. To switch the screen back on, press any key on the keyboard or move the mouse. Power-saving mode functions only when the product is connected to a PC that has a power-saving function.

PowerSaver	Energy Star Power Consumption	Power saving mode
Power Consumption	50 watts	<0.5 watts

- The power consumption level can vary in different operating conditions or when settings are changed.
- ENERGY STAR® is a US registered mark of the United States Environmental Protection Agency. Energy Star power is measured with the test method in the current Energy Star® Standard.
- To reduce the power consumption to 0 watts, turn off the power switch on the back of the product or disconnect the power cable. Be sure to disconnect the power cable when you will not be using the product for an extended period of time. To reduce the power consumption to 0 watts when the power switch is not available, disconnect the power cable.

Specifications

Standard Signal Mode Table

- This product can be set to only one resolution for each screen size to obtain the optimum picture quality due to the nature of the panel. Therefore, a resolution other than the specified resolution may degrade the picture quality. To avoid this, it is recommended that you select the optimum resolution specified for the screen size of your product.
- Check the frequency when you exchange a CDT monitor (connected to a PC) for an LED monitor. If the LED monitor does not support 85Hz, change the vertical frequency to 60Hz using the CDT monitor before you exchange it with the LED monitor.

Model Name		WE28UX8310
Synchronization	Horizontal Frequency	30 ~ 134 kHz (DisplayPort) 30 ~ 90 kHz (HDMI)
	Vertical Frequency	56 ~ 75 Hz (DisplayPort) 24 ~ 75 Hz (HDMI)
Resolution	Optimum Resolution	3840 x 2160 @ 60Hz (DisplayPort) 3840 x 2160 @ 60Hz (Only HDMI 1)
	Maximum Resolution	3840 x 2160 @ 60Hz (DisplayPort) 3840 x 2160 @ 60Hz (Only HDMI 1)

If a signal that belongs to the following standard signal modes is transmitted from your PC, the screen will automatically be adjusted. If the signal transmitted from the PC does not belong to the standard signal modes, the screen may be blank even though the power LED turns on. In such a case, change the settings according to the following table by referring to the graphics card user manual.

Horizontal Frequency

The time required to scan a single line from the left to the right side of the screen is called a horizontal cycle. The reciprocal number of a horizontal cycle is called horizontal frequency. Horizontal frequency is measured in kHz.

Vertical Frequency

Repeating the same picture dozens of times per second allows you to view natural pictures. The repeat frequency is called “vertical frequency” or “refresh rate” and is indicated in Hz.

Specifications

HDMI / DisplayPort

Resolution	Horizontal Frequency (kHz)	Vertical Frequency (Hz)	Pixel Clock (MHz)	Sync Polarity (H/V)
VESA, 640 x 480	31.469	59.940	25.175	-/-
MAC, 640 x 480	35.000	66.667	30.240	-/-
VESA, 640 x 480	37.861	72.809	31.500	-/-
VESA, 640 x 480	37.500	75.000	31.500	-/-
VESA, 800 x 600	35.156	56.250	36.000	+/+
VESA, 800 x 600	37.879	60.317	40.000	+/+
VESA, 800 x 600	48.077	72.188	50.000	+/+
VESA, 800 x 600	46.875	75.000	49.500	+/+
VESA, 1024 x 768	48.363	60.004	65.000	-/-
VESA, 1024 x 768	56.476	70.069	75.000	-/-
VESA, 1024 x 768	60.023	75.029	78.750	+/+
VESA, 1152 x 864	67.500	75.000	108.000	+/+
VESA, 1280 x 720	45.000	60.000	74.250	+/+
VESA, 1280 x 800	49.702	59.810	83.500	-/+
VESA, 1280 x 1024	63.981	60.020	108.000	+/+
VESA, 1280 x 1024	79.976	75.025	135.000	+/+
VESA, 1600 x 900RB	60.000	60.000	108.000	+/+
VESA, 1680 x 1050	65.290	59.954	146.250	-/+
VESA, 1920 x 1080	67.500	60.000	148.500	+/+
VESA, 1920 x 1200	74.556	59.885	193.250	-/+
VESA, 2560 x 1440RB	88.787	59.951	241.500	+/-
CEA, 3840 x 2160	67.500	30.000	297.000	+/+

Some resolutions listed in the table above may not be available depending on graphics card specifications.



www.westinghouseelectronics.com