



## Indoor Wireless Remote Light Control

## User's Manual



For technical support, call us at:  
1-800-654-8483, option #4



51135  
02/10

**Enclosed you will find**

- (1) Keychain Remote
- (1) Indoor Plug-in Receiver



Any transmitter in the GE Home Automation product line is capable of controlling every receiver—the ultimate in home convenience. Control any number of light fixtures or appliances from up to 150ft\* away by choosing the transmitter and receiver combination that best suits your needs.

### WARNING

- Risk of electric shock**
- Keep children away
  - Use indoors only
  - Do not use in wet locations
- Risk of fire**
- Do not exceed electrical ratings

## Home Automation Series | product line



Keychain Remote  
51144



Remote Light Switch  
51147



Motion Sensor  
& Plug-in Receiver  
56765



Indoor Plug-in Receiver  
51140



Outdoor Plug-in Receiver  
51141



Socket Adapter  
51142



Wall Switch  
51143

**IMPORTANT!** These devices are NOT compatible with devices from other systems. You must purchase GE remotes and receivers to ensure compatibility.

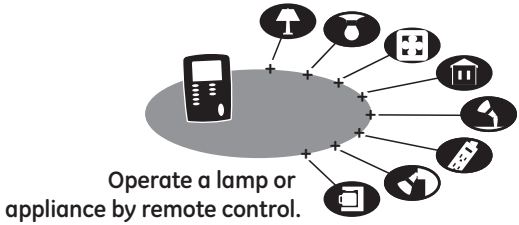

Operate a lamp or appliance by remote control.

### Expanding your system

These devices operate on any of 8 user-settable channels. The channels are easy to set and adjust with the simple turn of a knob. The following table is one example of how you can configure your system:

Area	CH	Remotes	Receivers
Bedroom	1	Bedside - Remote Light Switch Entrance - Keychain Remote	(2) Bedside Lamps - (2) Socket Adapters Corner Torchere - Indoor Plug-in Receiver Overhead Light Fixture - Remote Light Switch Entertainment System - Indoor Plug-in Receiver
Living Room	2	Coffee Table - Remote Light Switch Entrance - Keychain Remote	(2) End Table Lamps - (2) Socket Adapters Overhead Light Fixture - Remote Light Switch Entertainment System - Indoor Plug-in Receiver Christmas Tree - Indoor Plug-in Receiver
	3		Window Santa - Indoor Plug-in Receiver Lighted Poinsettia - Indoor Plug-in Receiver
Basement	4	Entrance - Keychain Remote Remote Light Switch	(4) Overhead Can Fixtures - (4) Socket Adapters (2) Fluorescent Fixtures - (2) Indoor Plug-in Receivers
Garage Receivers	5	Entrance - Keychain Remote Remote Light Switch	(2) Fluorescent Fixtures - (2) Outdoor Indoor Plug-in Overhead Light Fixture - Remote Light Switch
Outdoor	6	Foyer - Remote Light Switch Car Keys - Keychain Remote	Entry Light - Remote Light Switch Couch Lantern - Remote Light Switch
	7		Christmas Lights - Outdoor Indoor Plug-in Receiver Yard Santa - Outdoor Indoor Plug-in Receiver
Kitchen	8	Entrance - Remote Light Switch	Coffee Maker - Indoor Plug-in Receiver

GE is a trademark of the General Electric Company and is used under license to Jasco Products Company LLC, 10 E. Memorial Rd., Oklahoma City, OK 73114 www.jascoproducts.com.

**90 DAY LIMITED WARRANTY:** Jasco Products Company warrants this product to be free from manufacturing defects for a period of 90 days from the original date of consumer purchase. This warranty is limited to the repair or replacement of this product only and does not extend to consequential or incidental damage to other products that may be used with this unit. This warranty is in lieu of all other warranties express or implied. Some states do not allow limitations on how long an implied warranty lasts or permit the exclusion or limitation of incidental or consequential damages, so the above limitations may not apply to you. This warranty gives you specific rights, and you may also have other rights which vary from state to state. If unit should prove defective within the warranty period, return prepaid with dated proof of purchase to: Jasco Products Company 10 E. Memorial Rd. Oklahoma City, OK 73114

### Operating Instructions

FOR INDOOR USE ONLY

1. Remove the small tab on the back of unit labeled HOUSE CODE using a small screwdriver.
2. Set the HOUSE CODE to any one of the following settings:

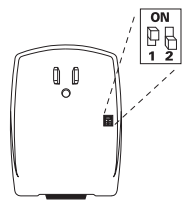
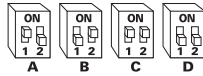

**NOTE:** Make sure ALL your devices have the same HOUSE CODE setting. The remotes WILL NOT control the receivers if they have different HOUSE CODE settings.

**IMPORTANT!** HOUSE CODES help eliminate interference (devices randomly turn on/off). If you experience interference, change the HOUSE CODE on all your remotes and receivers to a different setting.

3. Replace the HOUSE CODE tab.

4. Set the CHANNEL by using knob on front as shown.



**NOTE:** If you set your Indoor Plug-in Receiver to CHANNEL 1, the unit can be controlled using any remote set to CHANNEL 1. If you set your Indoor Plug-in Receiver to CHANNEL 2, the unit can be controlled using any remote set to CHANNEL 2 ... and so on.

**IMPORTANT!** A transmitter will control a receiver ONLY if they have the same HOUSE CODE and CHANNEL settings.

5. Plug Indoor Plug-in Receiver into a powered, grounded 125VAC outlet.

6. Plug the lamp/appliance you wish to control into the Indoor Plug-in Receiver as shown.

**CAUTION: WHEN THE INDICATOR LIGHT IS ON, THE OUTPUT OUTLET IS POWERED. DO NOT CONNECT / DISCONNECT DEVICES TO / FROM THE OUTLET ONCE IT IS POWERED.**

### Operating Instructions - Keychain Remote

1. Remove the battery compartment cover.
2. Set the HOUSE CODE to any one of the following settings:
3. Replace the battery compartment cover.
4. Set the CHANNEL by using the knob on front as shown.

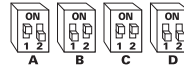

**NOTE:** If you set your Keychain Remote to CHANNEL 1, the unit can control any receiver set to CHANNEL 1. If you set your Keychain Remote to CHANNEL 2, the unit can control any receiver set to CHANNEL 2 ... and so on.

5. Use the toggle button to activate the Keychain Remote (ON/OFF operation). Make sure to press firmly and for a minimum of 1 second for best results. An indicator lights RED when a signal is sent.

6. Using any of the receivers set to the same CHANNEL and HOUSE CODE, test the installation by using the ON and OFF buttons.

### Specifications

#### Keychain Remote

Battery Type ..... Use ONLY A23 (12V) Alkaline

**NOTE:** The functional range will decrease as the battery wears out so make sure to replace the battery every 6 months for best results.

#### Indoor Outlet Adapter

FOR INDOOR USE ONLY

DO NOT EXCEED ELECTRICAL RATINGS

Electrical Rating ..... 120V, 60Hz

Maximum Resistive Load ..... 1200W

Maximum Tungsten Load ..... 600W

Maximum Motor Load ..... 1/3HP

\*Functional range may be adversely affected by one or more of the following factors: weather, radio frequency interference, low transmitter battery and obstructions between the transmitter and receiver.

This device complies with Part 15 of the FCC rules. Operation is subject to the following two conditions:

1. This device may not cause harmful interference, and;
2. This device must accept any interference received, including interference that may cause undesired operation.

**FCC Note:** The manufacturer is not responsible for any radio or TV interference caused by unauthorized modifications to this equipment. Such modifications could void the user's authority to operate the equipment.

**NOTE:** This equipment has been tested and found to comply with the limits for a Class B digital device, pursuant to Part 15 of the FCC Rules. These limits are designed to provide reasonable protection against harmful interference in a residential installation. This equipment generates, uses and can radiate radio frequency energy and, if not installed and used in accordance with the instructions may cause harmful interference to radio communications. However, there is no guarantee that interference will not occur in a particular installation. If this equipment does cause harmful interference to radio or television reception, which can be determined by turning the equipment off and on, the user is encouraged to try to correct the interference by one or more of the following measures:

- Reorient or relocate the receiving antenna.
- Increase the separation between the equipment and receiver.
- Connect the equipment into an outlet on a circuit different from that to which the receiver is connected.
- Consult the dealer or an experienced radio/TV technician for help.

**CAUTION:** Changes or modifications not expressly approved by the party responsible for compliance could void the user's authority to operate the equipment.