



# Electric grill



## USER MANUAL ENGLISH

<b>Model</b>	<b>JA802 T -1A</b>
Mains voltage	220-240V~50Hz
Nominal power	2000 watts
Item number	10000179
<b>Model</b>	<b>JA802 T</b>
Mains voltage	220-240V~50Hz
Nominal power	2000 watts
Item number	10000180

**Basic safety precautions must be taken when using electrical appliances. In order to avoid the risk of burns, electrocution, fire and/or personal injury, please read through this user manual carefully before starting up appliances and follow all directions when you are using them. Keep this user manual carefully for future use. If you give this appliance to third parties, please pass along the user manual also.**

## **IMPORTANT SAFETY INSTRUCTIONS**

- Connect the device only to receptacles which were installed in accordance with the regulations. Don't use any power strips or extension cords.
- The voltage shown on the type plate must match the voltage of your mains supply.
- When using the appliance, make sure that the power cord cannot become a tripping hazard.
- Keep the appliance, the power cord and the power plug away from hot surfaces, naked flames and sharp edges. Ensure that the cord does not get crushed (in doors, for example).
- Never touch the appliance, the power cord or the power plug with moist or wet hands.
- Never immerse the appliance, the power cord or the power plug in water or other liquids. There is a danger of death from electrocution.
- Always grasp the plug and never pull the power cord to disconnect the appliance from the mains.
- The device is for use in living spaces only. Do not use it in moist environments
- Do not use the appliance in the vicinity of naked flames.
- Never leave the grill unattended, if it is in use or connected to the mains.
- Do not point the grill at people or animals. This may cause injury!
- When you are operating the grill, make sure that your hair, loose clothing or parts of your body are not in the vicinity of the coiled element. This may cause burns!
- Please note that, when the grill is in use, grease or meat or vegetable juices can splatter. This may cause burns!
- Dripping grease burns on the appliance's heat elements. This can lead to the development of smoke and flames.
- Do not douse any flames which may arise with water or other liquids. Smother the flames with a fireproof cloth.
- Do not use the grill in an environment where there are flammable gases, liquids or dust. There is a danger that these will ignite and cause burns.
- Do not come into physical contact with or put any objects on the grill surface. Danger of fire and burns!
- Never use the power cable to carry the appliance.
- Always carry the appliance by the plastic handles on both sides. Caution, it may cause burns!
- When carrying, disassembling and cleaning the appliance, hot fat / water can run out of the drip pan. Caution, it may cause burns!
- Always allow the grill to cool down, before carrying it. Caution, it may cause burns!

- Do not operate the grill on uneven surfaces and avoid tipping over the grill when it is in use.
- Switch the appliance off and unplug it before cleaning it.
- Children are not familiar with the risks which can arise when dealing with electrical appliances. Keep children away from the grill. Please be particularly careful, if children are in the vicinity, when you are using the grill.
- Keep packing materials such as plastic bags and styrofoam pieces out of the reach of children. These may constitute a choking hazard!
- Do not use the appliance, if it shows signs of damage, if it has fallen or if it is not functioning perfectly.
- Please examine the appliance, the mains cord and the plug regularly for visible damage. Do not use the device under any circumstances, if you have discovered damage. Do not try to repair the grill yourself.
- Repairs should only be carried out by qualified personnel.
- Use the appliance for its intended purpose, only.
- This appliance is suitable for use in private households only and is not intended for commercial use.

## OVERVIEW OF THE APPLIANCE

1. Small grill rack
2. Wind shield
3. Large grill rack
4. Heating element
5. Temperature regulator
6. Plastic handle
7. Grill stand
8. Metal tubes (only for the grill with a stand)
9. Plastic shelf (only for the grill with a stand)
10. Plastic feet (only for the grill with a stand)

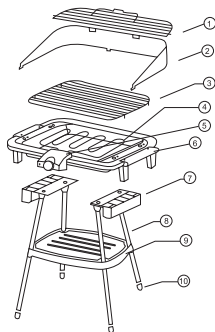

## THE FIRST USE

### DIRECTION:

For the grill with a stand (Model: JA802T), please assemble the legs of the grill first, as described under points A. - J.

1. Take all of the appliance parts out of the packaging and remove all packaging and wadding.
2. Clean the table grill in order to remove any manufacturing residue which may be present.
3. Remove the grill rack from the appliance. The grill rack is connected to the appliance by a plug connection on the lateral plastic handles.

4. Attach the wind shield to the appliance. To do this, bend the shield slightly inwards on the left and the right. Now stick the stamped out slots of the wind shield into the openings on the left and right of the appliance. There is a flat metal peg located in the centre of the shield which must be inserted into the opening intended for that purpose which is also located in a central position on the grill. Make sure that the wind shield is securely positioned and doesn't twist when it is being mounted.
- A) Take all of the appliance parts out of the packaging and remove all packaging and packing filler.
  - B) First of all, place the plastic shelf with the flat level sides on a stable even surface (table, counter top or floor).
  - C) Stick the longer metal tubes which are equipped with plastic feet into the holes of the plastic shelf which are intended for that purpose in such a way that the ends without plastic feet sink into the shelf. Proceed in the same manner for all 4 feet.
  - D) Now turn the plastic shelf with the feet over and put it on the inserted metal legs.
  - E) Now stick the shorter metal tubes into the holes from above. Make sure that you insert the tapering ends of the tubes into the holes. The legs and the tubes can be tightly connected to one another by pressing them lightly and turning them.
  - F) Now stick the plastic frame into the tube openings with the pegs intended for that purpose.
  - G) The plastic shelf and the frame ensure that there is sufficient tension and thus guarantee that the stand will have a secure footing.
  - H) Now, proceed as described under points 2. – 4. of this chapter.
  - I) After you have assembled the grill, put it into the plastic frame. Make sure that the grill doesn't tilt when you are inserting it and that it remains level.
  - J) Before using the grill for the first time, check that it is stable.

## **HANDLING THE GRILL**

1. Place the grill on an even, heat-resistant surface (a table or a counter top for the table grill / the floor for the grill with a stand).
2. Turn the temperature regulator to the lowest level and plug in the grill. The red operating light will come on.
3. You can vary the temperature of the grill at any time when you are using it by turning the temperature regulator (1 = the lowest temperature / Max. = the highest temperature).
4. Depending on what you are grilling, the food can be placed directly on the grill rack which has not been preheated or can be put on the rack after it has warmed up. CAUTION: When you are grilling fatty food, grease or water can splatter out. Caution, it may cause burns!
5. Grease / water which drips down will be collected in the drip pan under the heating elements. DIRECTION: If you put some water into the drip pan before starting up the grill (the bottom of the drip pan should only be barely covered), it will be easier to remove the grease after grilling.
6. To finish, turn the temperature regulator to the lowest temperature and then, unplug the grill.

## CLEANING AND CARE

Caution:

Always unplug the grill before cleaning and always allow it to cool down.

- The grill, the power cord and the power plug must not be immersed in water or other liquids for cleaning. Clean it with a dry cloth.
- If it is really dirty, the outside of the grill can be wiped carefully with a damp cloth and then dried carefully. Use a mild cleaner. Ensure that no moisture penetrates into the inside of the grill.
- Don't use any harsh cleaners, steel brushes, scouring powder or other hard objects which could scratch the surfaces.
- Clean the grill regularly after each use to remove greasy residue completely. The grill rack can also be cleaned in the dishwasher.
- Never use solvent or petrol to clean the grill.

## DISPOSAL

### Old electrical appliances from private households

- If you do not want to use the electrical appliance any more, take it to a collection facility for old electrical appliances, who will take it free of charge.
- Old electrical appliances must not under any circumstances be thrown in household waste (see symbol).



### Further directions for disposal

- Return the electrical appliance in such a condition that its later re-use or recycling is not adversely affected. Batteries must be removed in advance and the destruction of parts which contain fluids must be avoided.
- Batteries of any kind must not go into the household rubbish. Every consumer is legally obliged to submit batteries of all kinds to collection centres in his community or city neighbourhood or to a dealer.
- Electrical appliances can contain harmful substances. Improper handling or damage to the appliance can lead to health problems or water or ground contamination, when the appliance is recycled later.

## Batteries



- Batteries do not belong in the garbage. As a consumer, you are legally obliged to return used batteries. You can return your old batteries free of charge in your local store or at public collection points in your municipality.
- Batteries contain harmful substances, which can contaminate the environment by inappropriate waste handling and can affect human health.

## SERVICE / WARRANTY

The warranty is valid for 3 years and starts from the date of purchase. Please retain the sales receipt to prove date of purchase.

It covers defects and malfunctions that may occur through normal use during the warranty period.

You will not be liable for any repairs made during the warranty period.

The warranty is rendered invalid in the event of damages, modifications to or misuse of the appliance, where these fall outside the warranty issuer's scope of responsibility. This applies to the following cases in particular:

- Non-authorized personnel tampering with the appliance.
- Modifications to the outside and inside of the appliance, removal or disguising of the serial number or changes to the seals.
- Damages that are the result of the appliance being bumped, dropped or subject to external forces.
- Damages that are the result of improper handling or misuse.
- In the event of damages caused by external factors, such as power surges, lightning strikes.
- Professional use of the appliance.

Your statutory rights are not be limited by this warranty in the event of the appliance being taken away (additional delivery, withdrawal, loss, recovery of damages).

Please retain the original packaging in case you need to send the appliance back for repair. Repaired or exchanged components are generally subject to the appliance's remaining warranty period.

If you should have any questions about the product or on these instructions for use or if you observe any problems with the product, please contact our Service Hotline directly for further information.

**Important information:**

Please send your appliance to our address only after you have arranged this with us.  
You must contact our Service Hotline in advance.

**ITEM NO.: 10000179-180**

GS-ZEICHEN-ZERTIFIKATSINHABER: / GS-LICENCE HOLDER:  
NINGBO JIANGBEI CHUANGXIN ELEC. INDUSTRIAL CO., LTD.  
HERGESTELLT FÜR: / PRODUCED FOR:  
AERA RUNDfunk-UND FERNSEH GMBH  
HANNS-MARTIN-SCHLEYER STRASSE 2  
D-77656 OFFENBURG

