

- Install the power supply and drill a hole near the end of T-wire, then treat the wire through hole to protect the wire from chasing.

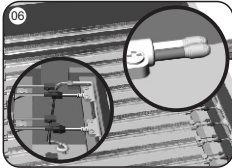

- Connect T-wire to the power supply output correctly and cap both ends of T-wire for good protection.

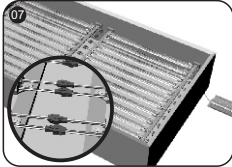

- If the rigid LED light is not long enough, please connect the ends of rigid LED lights together.

⚠ Note: The maximum connectable quantity needs to meet the requirement shown in the table below the connection illustration, forbid exceeding!

NOTES

1. Installation Notes

- (1) Clean the installing surface before installing the products.
- (2) Make sure the polarity of connections made at the rigid LED light and power supply is correct, otherwise the product will not be illuminated.
- (3) Connect the rigid LED light to power supply firmly, it will be fine until the wires cannot be pulled out by hand.
- (4) The maximum quantity in parallel connection for Z2472CA is 6pcs.

2. Notes for Optional Supplies

- (1) Forbid using any acid or alkaline adhesive to secure the product.
- (2) The maximum connectable quantity is shown in the table below the connection illustration. Please choose the safety-certificated switch power supply with DC 12V output voltage (with short-circuit, overvoltage and overcurrent protections; the tolerance range for output voltage of the switch power supply is $\pm 5\%$). If more products are needed, ensure the power supply has more than 20% load allowance.

Malfunction & Solutions Table

Malfunction & Solutions Table		
Symptoms	Possible Causes	Solutions
None LED light works	1. There is no primary power.	Power on.
	2. Short circuit occurs at the input of power supply; No primary power for the power supply; The power supply is auto protected since the short or open circuit occurs at the output of the power supply.	Remove any short or open circuits and other malfunctions, and energize the fixture.
	3. The input wires of the rigid LED lights are connected reversely.	Connect the wires correctly.
Some LED lights don't work	1. No primary power for some switch power supplies.	Check the power supply and remove malfunctions.
	2. Some rigid LED lights are wrongly connected to the power supply.	Connect the wires correctly.
	3. Some rigid LED lights' polarities are connected reversely.	Connect the T-wires correctly.
	4. Some T-wires are connected wrongly.	Use higher or more power supplies.
Brightness of the LED is dim or not even	1. The power supply is over loaded.	Make sure the working voltage of rigid LED light is within 95%-105% of the rated voltage, shorten the supply wire between the power supply and the first rigid LED light or use thicker supply wires.
	2. The wire loss of the power supply is too much.	Adjust the length of LED lights for each branch to meet the maximum connectable length.
	3. Too many rigid LED Lights are connected.	Find the intermittent connections and remove any malfunctions.
LEDs are blinking	1. Intermittent connections exist.	Replace the power supply.
	2. Switch power supply doesn't work.	

⚠ WARNING

- This product is non-waterproof, only used indoors. Forbid exposing it to outdoor or semi-outdoor environment directly.
- Do not disassemble or modify this product.
- Turn power off before installing and serving the products.
- Have a licensed electrician install, maintain and serve the products!
- The space between two rigid LED lights is no less than 50mm(2.0in), otherwise the over-temperature in light box will reduce the expected lifetime of rigid LED light.
- Forbid using acid or alkaline adhesive to secure the product. When use the neutral glass glue to fix the products, do not seal the products until the glue solidified in open environment.
- The supply wire between the power supply and the rigid LED light is no longer than 2m(78.7in), otherwise the line loss will increase, which will cause the brightness difference between the two ends.
- Check the supply voltage and wire connections before power on.

- The maximum load power per T-wire is 180W, forbid overloading. If more products are needed, the additional T-wire must be connected to a separate power supply. If any T-wire is left unused, please cut the unused part and protect the cut end against short circuit.

Declaration

- Warranty: 3 years or 13,000 hours, whichever comes first.
- If the external flexible cord of this luminaire is damaged, it shall be exclusively replaced by the manufacturer or his service agent or a similar qualified person in order to avoid a hazard.
- All the data and pictures in this manual are subject to actual products.
- Information provided is subject to change without notice.

Galaxy Series Double-sided Rigid LED Light Manual Z2436CA Z2472CA



Read this manual carefully before using this product and keep it!

V1.0

Model and Specification

Series Name	Galaxy Series	
Model	Z2436CA	Z2472CA
Color	White	White
Rated Power(W)	13	25

Working Voltage (V) :	DC12
Operating Temperature (°C[°F]) :	-25~60[-13~140]
Storage Temperature(°C[°F]) :	-25~70[-13~158]

Profile Drawings

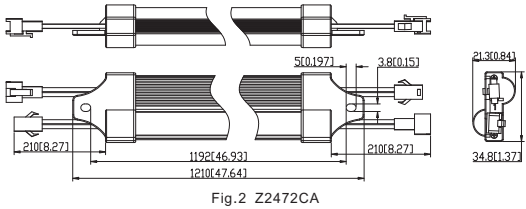
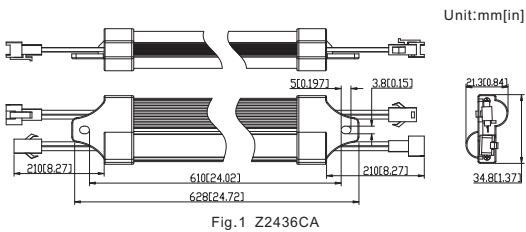

Product Parts and Tools Required

1.Connection Illustration:

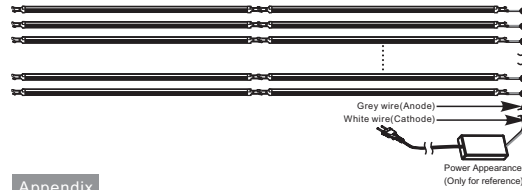
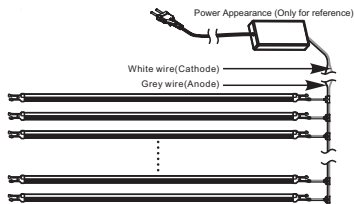

Appendix

Model	Z2436CA	Z2472CA
Maximum Connectable Quantity(pcs)	2	1

The maximum load power per T-wire is 180W, forbid overloading. If more products are needed, the additional T-wire must be connected to a separate power supply. If any T-wire is left unused, please cut the unused parts and protect the cut end against short circuit.

2.Product Parts and Tools Required:

(1)Product Parts

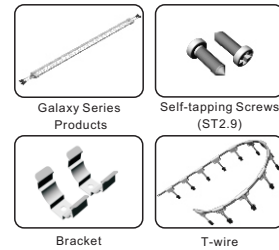

(2)Tools Required



Installation and Application

Layout Guidelines

Depth of Light Box(mm[in])	Layout Spacing (mm[in])	Installing Quantity (pcs)	Illuminance Range of Z2436CA(lux)
dz=200[7.9]	dy=60[2.4]	14	2800-3200
dz=240[9.4]	dy=70[2.8]	12	2300-2500
dz=320[12.6]	dy=120[4.7]	7	1500-1800
dz=360[14.2]	dy=140[5.5]	6	1400-1500
dz=400[15.7]	dy=160[6.3]	5	1200-1300

Notes:

- The above data are tested with Z2436CA rigid LED light;
- Tested in 3mm(0.12in) depth acrylic board with 54.4% luminous transmittance;
- Light box size: 600mm*1000mm(23.6in*39.4in);
- The brightness of SAMSUNG LED is about 30% higher than Rishang LED.
- The layout of Z2472CA light can refer to that of Z2436CA light.
- The above data are for reference only.

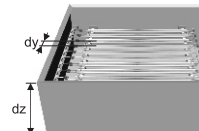

Installation Procedures with Brackets

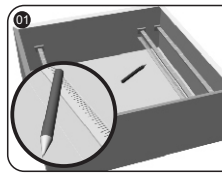

- After cleaning the installing surface, determine the installing position and quantity.

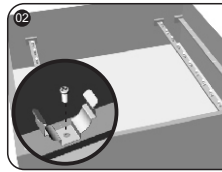

- Fix the brackets on the framework of light box and adjust the bracket spacing according to the depth of light box.

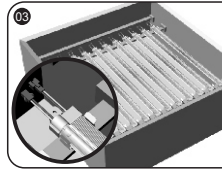

- After fixing the brackets, put the lights into the brackets and fasten them respectively.

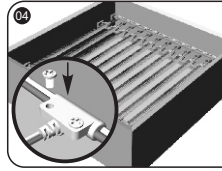

- Connect the T-wire to the wires of rigid LED lights and secure the T-wire well with screws.

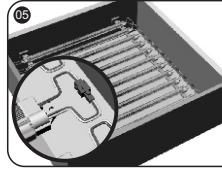

- Connect the rigid LED lights (male socket to female socket) and fix them.

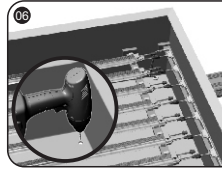

- Install the power supply and drill a hole near the end of T-wire, then treat the wire through hole to protect the wire from chasing.

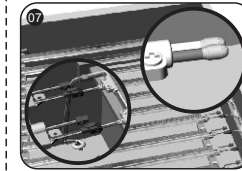

- Connect T-wire to the power supply output correctly and cap both ends of T-wire for good protection.

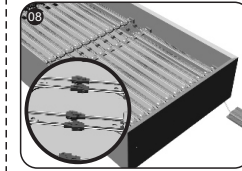

- If the rigid LED light is not long enough, please connect the ends of rigid LED lights together.
- Note: The maximum connectable quantity needs to meet the requirement shown in the table below the connection illustration, forbid exceeding!

Installation Procedures with End caps

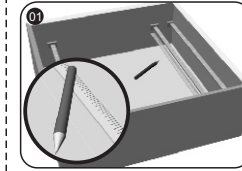

- After cleaning the installing surface, determine the installing position and quantity.

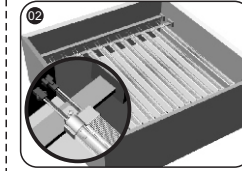

- Put the rigid LED lights into the corresponding positions and secure the end caps at both ends with screws.

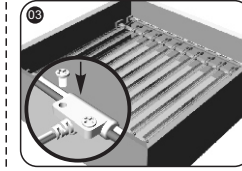

- Connect the T-wire to the wires of rigid LED lights and secure the T-wire well with screws.

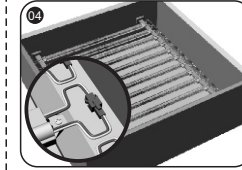

- Connect the rigid LED lights (male socket to female socket) and fix them.