

Limited Warranty for your Playtex® Petite Breast Pump

This product is warranted by Playtex Products, Inc. to the original retail purchaser to be free from defects in material and workmanship for the period of six months on the pump mechanism and 90 days on all other components, beginning on the date of purchase. In the event of a defect as verified by the manufacturer, Playtex will repair or, at Playtex's option, replace this product without charge for such replacement or parts or labor. Purchaser is responsible for all expenses related to the return of this product to Playtex and must present dated proof of purchase when making a claim, as well as a description of the defect. This warranty does not apply to any product used commercially or which has been subject to accident, misuse, abuse or alteration.

Any and all implied warranties, including the warranty of merchantability (an unwritten warranty that the product is fit for ordinary use), are limited to a duration of 90 days from date of purchase. Some states or countries do not allow limitations on how long an implied warranty lasts, so the above limitation may not apply to you.

This warranty gives you specific legal rights and you may also have other rights which can vary from state to state or in your country.

This product was designed for use by one person. Use of this product by more than one person will void the warranty. (Please see product instructions for detailed information.)

Before you make a claim under this warranty, call Playtex Consumer Affairs at **1-800-222-0453** for a return authorization number.

We can also be reached at:
Consumer Affairs Department
PLAYTEX PRODUCTS, INC.
75 Commerce Drive
Allendale, NJ 07401

For information regarding the use of this product, please call Playtex Consumer Affairs at **1-800-222-0453** Monday through Friday from 8:00am to 6:00pm or visit our website at **www.playtexbaby.com**.

© 2006 Playtex Products, Inc. Playtex is a licensed trademark. Avent is a trademark of Cannon Rubber Limited. The First Years is a trademark of First Years, Inc. All other trademarks are owned by Playtex Products, Inc.



Petite Double Electric Breast Pump

Getting Started Guide



Keep this guide with your
Playtex® Petite Breast Pump

Important Safeguards

When using electrical products, especially when children are present, basic safety precautions should always be followed, including the following:

READ ALL INSTRUCTIONS BEFORE USING THIS BREAST PUMP.

DANGER – To reduce the risk of electrocution:

1. Always unplug this product immediately after using.
2. Do not use while bathing.
3. Do not place or store product where it can fall or be pulled into a tub or sink.
4. Do not place in or drop into water or other liquids.
5. Do not reach for this product if it has fallen into water. Unplug immediately.

WARNING – To reduce the risk of burns, electrocution, fire or injury to persons:

1. This product should never be left unattended when plugged in.
2. Close supervision is necessary when this product is used near children or invalids.
3. Use the pump only for its intended use as described in this manual. Do not use accessories or attachments not recommended by the manufacturer.
4. Never operate this product if it has a damaged cord or plug, if it is not working properly, if it has been dropped or damaged, or if it has been dropped into water.
5. Keep the cord away from heated surfaces.
6. Never operate while sleeping or drowsy, or while driving.
7. Do not operate outdoors, where aerosol products are being used, or where oxygen is being administered.
8. Use only the AC/DC Adapter provided with the Playtex® Breast Pump.
9. Do not unplug by pulling on the cord.
10. When pump is not in use, be sure all tubing, parts and accessories are stored safely, away from children.
11. Plug the AC/DC Adapter into the pump unit first, then plug into wall socket.

SAVE THESE INSTRUCTIONS.

The Playtex® Petite Breast Pump is intended for household use.

Congratulations

on your purchase of the Playtex® Petite Double Electric Breast Pump

The Playtex® Petite Breast Pump System offers top-of-the-line features and important benefits to moms who want a compact yet efficient electric breast pump.

- ✓ **Ultra Comfortable Breast Cups**
 - Soft Comfort® Breast Cups gently plump nipples and surrounding milk ducts, minimizing pulling or stretching of nipples.
- ✓ **State-of-the-Art Efficiency**
 - The Playtex® Petite Breast Pump provides massage AND suction, to express milk most efficiently.
- ✓ **Suction Control at Your Fingertips**
 - You control your own comfort level with 3 levels of suction.
- ✓ **Unsurpassed Hygiene**
 - The Playtex® Petite Breast Pump has a unique closed system that protects against contamination from bacteria and germs. The silicone breast cup provides a physical barrier between mother's milk and the air in the pump and the room.
 - Milk cannot back up into system.
 - Prevents collected milk from being exposed to ambient air.
 - Ambient air and any germs and bacteria in the air cannot be blown into mom's breast milk during pumping.
 - Wide openings on breast cups are easy to thoroughly clean in the dishwasher or by hand.

Table of Contents

How to Maintain and Clean the Breast Pump	2
Getting to Know your Playtex® Petite Breast Pump	3
Quick Start	
How to Assemble the Breast Pump	4, 5
How to Connect the Breast Pump	6
How to Operate the Breast Pump	7
How to Disassemble the Breast Pump	8
Troubleshooting Tips	9, 10
How to Store Breast Milk	11, 12
How to Order Replacement Parts	13

Save These Instructions

CALL US FIRST!

The Playtex® Petite Breast Pump is a personal care item and cannot be returned once opened. At Playtex, we understand that sometimes breastfeeding and breast pumping can be challenging. Our Consumer Affairs Representatives are here to help make it more successful for you. Call us at **1-800-222-0453** Monday through Friday from 8:00am to 6:00pm, or visit www.playtexbaby.com.

How to Maintain and Clean your Playtex® Petite Breast Pump

Pump, Tubing and “Y” Connector Care

- **CAUTION** – Do not attempt to remove back of pump housing due to risk of electric shock. Doing so will void the product warranty. If pump requires servicing, call Playtex Consumer Affairs at **1-800-222-0453** Monday through Friday 8:00am to 6:00pm.
- **DO NOT sterilize or wash the pump, tubing or “Y” connector.** The Playtex® Petite Breast Pump has been designed so that no breast milk will ever come in contact with these components, and no air from these components will come in contact with your breast milk. Therefore, there is no need to wash or sterilize these parts.
- **Clean the pump with a soft cloth.** DO NOT put the pump in the dishwasher or allow the pump to get wet. The pump is an electrical appliance and must be kept away from liquids.
- **Be sure all tubing is stored safely, away from children.**
- **If the tubing or “Y” connector is lost, worn or damaged,** call **1-800-667-4860** to purchase replacement parts. See the list of replacement parts on page 13.

Cleaning the Breast Cup and Breast Milk Storage Components

- Prior to first use and before each use, disassemble, wash and sanitize or sterilize all Breast Cup and Breast Milk Storage components. Wash these parts in the dishwasher (top rack only) or hand wash in hot, soapy water for about one minute and rinse thoroughly. Sterilize these parts in a steam sterilizer or sanitize by boiling for 20 minutes in water.
- As with all infant feeding products, clean as soon as possible after each use.
- Discard Drop-Ins® Pre-Formed Liners after each use.
- If any parts are lost or damaged, call **1-800-667-4860** to purchase replacement parts. See the list of replacement parts on page 13.

AC/DC Adapter and Cord Care

- Plug the AC/DC Adapter into the Pump first, then plug into wall socket.
- Unplug AC/DC Adapter when not in use.
- Keep cord stored safely away from children.
- Do not unplug by pulling on the cord. Pull on the plug to remove from socket.

IMPORTANT – This product is intended for a single user only.

Getting to Know your Playtex® Petite Breast Pump

Breast Pump



Soft Comfort® Breast Cup Assembly

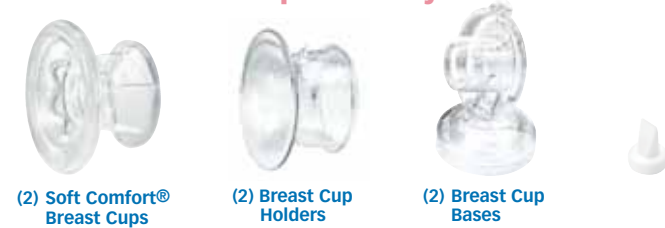

Bottles and Accessories



NOTE: Actual product may appear slightly different than photograph.

How to Assemble your Playtex® Petite Breast Pump



1 Insert the Breast Cup.

Insert the breast cup into the front of the breast cup holder. Be sure to pull the breast cup all the way through the holder so the edges are firmly in place around both the front and back of the holder.



2 Attach the Breast Cup Holder to the Base.

Snap the breast cup holder onto the front of the breast cup base. You should hear a distinct "click" sound.



How to Assemble (cont.) your Playtex® Petite Breast Pump

3 Attach the Pump Valve.

Press the pump valve onto the round opening on the bottom of the breast cup base.



4 Attach a bottle.

Screw a Playtex® Drop-Ins™ System Holder with a Drop-Ins® Pre-Formed Liner onto the bottom of the breast cup base.



Troubleshooting Tips

- ✓ Check that the breast cup is pulled all the way through the breast cup holder so the edges are firmly in place around both the front and back of the holder.
- ✓ Check that the breast cup holder is securely snapped onto the front of the breast cup base (you should hear a distinct "click" sound).
- ✓ Check that the pump valve is securely attached onto the round opening on the bottom of the breast cup base.

Unsurpassed Hygiene

The Soft Comfort® Breast Cup is a unique closed system design that protects against contamination from bacteria and germs. The silicone breast cup provides a physical barrier between mother's milk and the air in the pump and the room.

- Milk cannot back up into the tubing and pump.
- Ambient air and any germs and bacteria in the air cannot be blown into mom's breast milk during pumping.

How to Connect your Playtex® Petite Breast Pump

After you assemble the breast cups, connect to the pump using the tubing.

1 Connect Tubing to the Pump.

- Connect the long tubing piece to the white air supply nozzle on the bottom of the pump.



- Attach the bottom of the "Y" connector to the other end of the long tubing piece.



DOUBLE

- If you are double pumping, attach a short tubing piece to each hole on the "Y" connector.



SINGLE

- If you are single pumping, attach a short tubing piece to one hole on the "Y" connector. Insert the attached plug into the other hole on the "Y" connector.

2 Connect Tubing to the Breast Cups.

Attach the open end of the short tubing securely onto the post on the side of the breast cup holder. If you are double pumping, attach both short tubing pieces to the breast cup holders.



3 Connect the Adapter.

Connect the AC/DC adapter to the bottom of the pump first and then plug it into the wall outlet.



Troubleshooting Tips

- ✓ Make sure all tubing connections are secured properly.
- ✓ Check the connections to the "Y" connector.
- ✓ Check the two connections to the pump.
- ✓ If single pumping, seal the open hole on the "Y" connector with the attached plug.
- ✓ To prevent tubing from kinking during use, be sure that the tubing post is pointed downward.

How to Operate your Playtex® Petite Breast Pump

Before you operate your Playtex® Petite Breast Pump, be sure you have correctly assembled the breast cups and connected them to the pump. **For proper suction levels and function, there must be no air leaks or openings between the pump and the breast cups.** Check that the tubing and breast cups are fully sealed.



1 If Single Pumping...

If single pumping, position the breast cup on your breast with your nipple centered.

SINGLE



If Double Pumping...

If double pumping, try holding both cups with one arm, as shown. This method allows you to keep one hand free while you begin pumping. Be sure to position each breast cup with your nipple centered.

DOUBLE



2 Begin Pumping.

Press the On/Off button on the pump to begin pumping. We recommend that you start with the suction level on its lowest setting.



3 Adjust Suction Level.

Using the dial, increase/decrease the suction level until you find the level that is comfortable for you.



4 Stop Pumping.

When you have finished pumping, press the On/Off button on the pump.

How to Disassemble your Playtex® Petite Breast Pump



1 Detach the bottle.
Unscrew the breast cup base from the bottle.



2 Detach the Breast Cup Holder from the Base.

a. Holding the breast cup holder in one hand, place your other hand on the breast cup base with your thumb on the thumb tab at the top.



b. Using the thumb tab, separate the breast cup base from the breast cup holder.



3 Remove the Breast Cup.
Slide the breast cup out of the breast cup holder through the front of the holder.



4 Detach the Pump Valve.
Remove the pump valve from the bottom of the breast cup base.



5 Refer to Cleaning Instructions on Page 2.

NOTE: Be sure to disassemble all components prior to cleaning.

Troubleshooting Tips

We are here to help!

Why won't the pump work when it is turned on?

- Be sure that you are using the 12V AC/DC adapter provided with the pump.
- Check the plug connections.
- Check that the outlet has power. Some outlets are turned on/off by a light switch.

Why is there no suction (or low suction) when I try to pump?

- **For proper suction levels and function, there must be no air leaks or openings between the pump and the breast cup. Be sure your tubing and breast cups are fully sealed.** See the instructions on "How to Assemble" on page 4.
- Check the breast cup.
 - **Two of the most common reasons for suction problems are: 1) forgetting to attach, or 2) loosely attaching, the pump valve. Make sure the valve is securely in place.**
 - Check that the rim of the breast cup is wrapped firmly around the entire edge of both the front and back of the breast cup holder.
 - Check that the breast cup holder is securely snapped into the front of the breast cup base. You should hear a distinct "click" sound when the two parts snap together.
- Check the tubing and "Y" connector.
 - Check that the tubing is not kinked.
 - If you are single pumping, check that the open hole on the "Y" connector is sealed with the attached plug.
 - If you are double pumping at the highest suction level and require stronger suction, try switching to single pumping to increase the suction.
 - To prevent tubing from kinking, be sure that the tubing post on the breast cup holder is pointed downward.

The pump is working, so Why can't I express any milk?

- The positioning of the breast cup on your breast is very important. Make sure the breast cup is centered on your nipple .
- Pumping is an emotional as well as a physical experience. Be sure that you are relaxed and in a comfortable place, and try to think about your baby.

Troubleshooting Tips

We are here to help!

What should I do if I am engorged?

- To relieve engorgement, we recommend double pumping at low suction. Double pumping combined with simultaneous massage helps relieve the pressure associated with engorgement.
- If engorgement continues, seek advice from your physician or lactation consultant. Fever higher than 101°F and/or severe pain may signal a breast infection. If this occurs, stop use immediately and consult your physician.

What should I do if pumping becomes painful or if I need to release the pump quickly?

- If pumping becomes painful or if you need to release the pump quickly, press the "Off" button, and insert your finger between your breast and the breast cup to release the suction on your breast.
- With subsequent use, be sure to use the pump at a lower, more comfortable suction setting.

Why won't the breast cup base fit on my bottles?

- The breast cup base is designed to fit all Playtex® Drop-Ins™ System holders and Playtex® VentAire® System bottles.
- The breast cup base also fits most standard reusable bottles.
- The breast cup base is not compatible with certain bottle systems such as Avent® and The First Years®.

Why can't I detach the breast cup holder from the breast cup base?

- The breast cup holder must be attached securely to the breast cup base for the pump to function properly, so some force may be required to detach the holder from the base. See the instructions on "How To Disassemble" on page 8.

How to Store Breast Milk

using your Playtex® Drop-Ins® Pre-Formed Liners



Sealing Disc



Nipple Ring



Liner Ring



Breast Cup



1 Snap the sealing disc into the nipple ring to create a storage cap.



2 Set a Drop-Ins® Pre-Formed Liner into the liner ring.

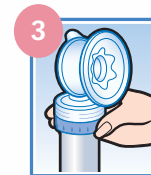

3 Screw the breast cup onto the top of the liner ring. Pump breast milk directly into the Drop-Ins® Pre-Formed Liner.



4 When pumping is completed, remove the breast cup from the liner ring.



5 Screw the storage cap onto the liner ring to seal the breast milk inside the Drop-Ins® Pre-Formed Liner.

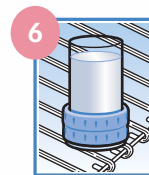

6 Set the sealed breast milk upside down inside the freezer or refrigerator for storage. This keeps the filled liner stable on your shelf.

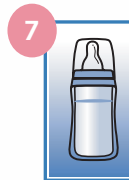

7 Remove the breast milk from the freezer or refrigerator. Screw the sealed liner onto a Nurser holder.

Thaw frozen breast milk in refrigerator or by running under warm water.

Remove the storage cap and replace the sealing disc with a nipple and you are ready to feed.

Using Reusable Bottles to Store Breast Milk

The Playtex® Petite Breast Pump System can also be used to store breast milk in reusable bottles including Playtex® VentAire® System bottles. Use the sealing discs with the nipple rings to create storage caps.

How to Store Breast Milk (cont.)

using your Playtex® Drop-Ins® Pre-Formed Liners

WARMING INSTRUCTIONS: *Either* a) Warm liquid in the assembled Nurser by placing Nurser under tap water or in a pan of warm water removed from the heat source.
Or b) Before pouring into assembled Nurser, warm liquid in a separate container and cool to lukewarm (at least 15 minutes if boiled).

Always test liquid temperature on inside of wrist before giving to baby!

WARNINGS: Failure to follow the instructions below may cause the liner to burst, spilling hot liquid and causing injury:

- Do **not** boil any liquid, heat in microwave oven or sterilize inside the liner or Nurser.
- Do **not** heat Nurser directly on a heat source.
- Do **not** shake or mix contents of Nurser while liquid is hot.
- Do **not** give Nurser to baby if liner is hot to the touch. Always test the temperature of the liquid before feeding the baby.

To avoid injury, do not let baby walk with Nurser.

Do not put baby to bed with Nurser. Prolonged contact with liquids may cause severe tooth decay. Ask your doctor or dentist for more information.

Milk Storage Chart

Form of breast milk	Where Stored	For How Long
Fresh Milk	Room temperature below 72°F	10 Hours
Fresh Milk	Insulated bag with cooling pack	Up to 24 Hours
Fresh Milk	Refrigerator at 32°F to 39°F	Up to 8 Days
Frozen and Thawed	Refrigerator at 32°F to 39°F (Never re-freeze)	Up to 24 Hours

Store breast milk at the back of the freezer and never in the door section

Frozen Milk	Freezer compartment inside refrigerator	Up to 2 Weeks
Frozen Milk	Refrigerator freezer with own door	3 to 4 Months
Frozen Milk	Separate deep freeze at 0°F	6 Months

NOTE: FOR BEST RESULTS, REFRIGERATE/FREEZE BREAST MILK AS SOON AS POSSIBLE AFTER PUMPING.

Note: Only Playtex® Drop-Ins® Pre-Formed Liners are guaranteed to seal with the Playtex® Petite Breast Pump System. Other liners are not made to the specifications of Playtex® liners and are not guaranteed to work.

How to Order Replacement Parts

To order replacement parts, call Playtex Customer Care 1-800-667-4860.



Item No.	Part No.	Description
1	PYX-020	Pump Unit
2	PYX-002	12V AC/DC Adapter with Cord
3	PYX-005	"Y" Connector with Tubing
4	PYX-026	Breast Cup Assembly (4 Pieces)
5	PYX-027	Soft Comfort® Breast Cup
6	PYX-008	Pump Valves (Set of 4)

For additional sealing discs, nipple rings and liner rings, purchase the Playtex® One Step® Breast Milk Storage Kit. Available at many major retailers, the One Step® Breast Milk Storage Kit contains 4 sealing discs, 4 nipple rings, 4 liner rings, a pump adapter and 10 Drop-Ins® Pre-Formed Liners. For more information on the One Step® Breast Milk Storage Kit, call Playtex Consumer Affairs at **1-800-222-0453** Monday through Friday from 8 am to 6 pm, or visit www.playtexbaby.com.