

RETURN FOR REPAIR POLICY

Every effort has been made to provide reliable, superior quality products. However, in the event your instrument requires repair, forward unit to Service Center freight prepaid to the address below with return address, phone number and/or email address.

SERVICE CENTER
2651 W 81st Street
Hialeah, FL 33016

WARRANTY POLICY

The ATD3698 Refrigerant Gas Leak Detector is warranted to be free of defects in materials and workmanship for a period of two years from the date of purchase including an industry first two year warranty on the sensor. This warranty applies to all repairable instruments that have not been tampered with or damaged through improper use including unauthorized opening of the unit. Please ship warranty units that require repair freight prepaid to Service Center along with proof of purchase, return address, phone number and/or email address.



Model ATD3698 Refrigerant Gas Leak Detector

Detects all CFC, HFC, HCFC
Refrigerants including blends

User Manual



Design Certified
to meet SAE J2791
for R134a



INTRODUCTION

The ATD3698 features a long life heated sensor technology that is designed to detect the more current and difficult HFC refrigerants such as R-134a in addition to all HCFC (R22) and CFC (R12) refrigerants including SNAP approved hydrocarbon blends. The ATD3698 does not require rechargeable batteries.

FEATURES

- Unique numeric leak size Indicator
- R134a sensitivity .05 oz/yr
- Designed certified SAE 2791 standard
- Low battery indicator
- 2- year warranty including 2 years for the sensor
- Uses 4 AA alkaline batteries
- Long life, stable sensor
- R22 sensitivity .025 oz/yr
- Automatic calibration and reset to ambient
- 3 adjustable sensitivity levels
- True mechanical pump
- CE Certified
- Made in USA

Replacement Parts

Item	Part Number
Sensor with Filter	PRT3700-01
Filter Kit	PRT3700-02
Test Vial	PRT3700-03

Product Specifications

Model #	ATD3698
Name	Leak Detector, Refrigerant Gas
Sensitivity	.05 oz/yr R134a .025 oz/yr R22
Sensor Life	> 300 hours
Response Time	Instantaneous
Power Supply	4 AA Alkaline batteries
Battery Life	8 hours continuous
Warm up time	< 20 seconds
Probe length	17 inches
Weight, lbs	1.5 lbs
Warranty	2 years (2 yrs for sensor)

Maintenance

Batteries:

Install Batteries: Remove screw located at rear end of unit and pull down hinged battery door to open as shown. Always insert all 4 batteries into the compartment in the same direction. Note the polarity mark on the inside of the battery door for proper battery installation.

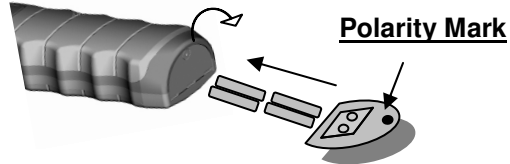

Sensor:

Replace Filter: Unscrew sensor tip as shown to replace filter. Replace filter whenever it becomes visibly dirty or every 2 to 3 months depending on use.

Replace Sensor: Remove sensor by pulling out of socket. Install the new sensor by aligning the notch in sensor cover with the raised keyway on sensor socket holder (see figure below).

Note: Do not force sensor into socket. Misalignment can damage the sensor pins.

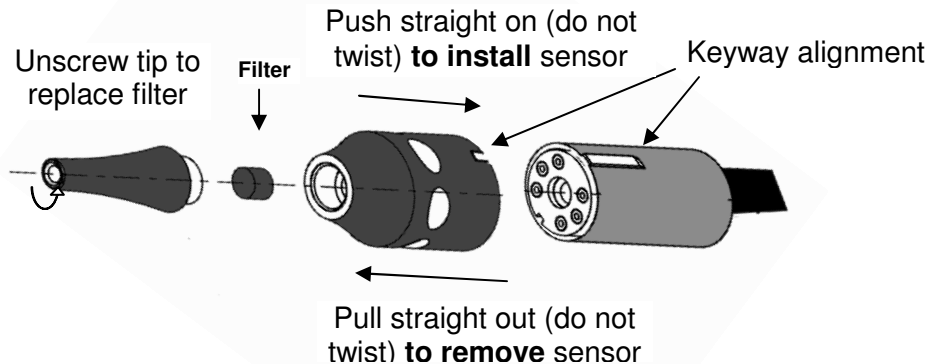

ATD3698 Control Panel



Operating Instructions

1. **TURN ON:** Press the ON/OFF button once to turn on and again to turn off.
2. **WARM UP:** The detector automatically starts heating the sensor. During the heating cycle, the detector will sound a slow "beep". Warm up is usually less than 20 seconds.
3. **READY:** The detector is ready to begin searching for leaks when the green sensitivity LED turns on. The audio "beep" increases in frequency.

Low Battery Indicator

Replace the 4 AA Alkaline batteries when the red LED on the control panel is lit. Follow battery installation instructions under **Maintenance** section.

Adjusting Sensitivity Levels

The Leak Detector will default to the NORM sensitivity level automatically once the unit comes out of the warm up cycle and the green LED will turn on.

To change sensitivity levels, press the SENS once for HI sensitivity (red LED will turn on) and again for LO sensitivity (yellow LED will turn on).

Leak Test Vial

The leak detector comes with a Leak Test Vial that allows the user to make sure the detector is performing properly. To test:

1. Remove the plastic seal cap on top of the Leak Test Vial by pulling it off (see fig. below).
2. Turn on the detector and allow the unit to complete the warm up cycle.
3. Place the sensor close to the small hole in the top of the Leak Test Vial. The beep rate should increase and the Digital Leak Size Indicator should display a number from 4-6 indicating that the sensor and electronics are working properly.

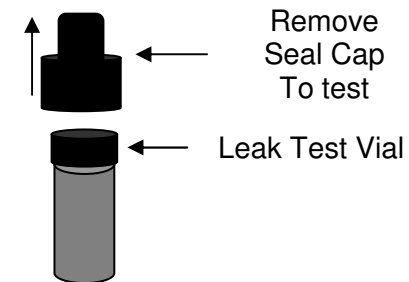

NOTE: Always remember to replace plastic seal cap after leak test is completed. Replace Test Vial when the green color is no longer visible.