

PocketScan ***User's Manual***

Safety Precautions

Before using this device, please read through and follow the *Safety Precautions* as listed below.

- Keep this User's Manual for future reference.
- This device is NOT waterproof. Avoid all contact with water.
 - ☛ Avoid placing a container filled with water (or any type of liquids) near the device.
 - ☛ Avoid spilling water on the device.
 - ☛ Avoid using the device near water.
 - ☛ Dry your hands before using the device.
- Do not store the device in a place with high humidity.
- Do not install the device near appliances that emit heat such as heater, light bulb, etc.
- Do not install the device in a dusty area.
- Do not apply excessive shock to the device.
- Do not place heavy objects on the top of the device.
- Avoid looking directly into the laser beam when scanning the document.
- Do not use the device if its USB cable is damaged.
- Unplug the device from your computer if you are not using the device for an extended period of time.
- Keep the device out of the reach of children.

Caution

- Risk of Explosion if Battery is replaced by an Incorrect Type. Dispose of Used Batteries According to the Instructions.
- **Laser Class 1 product**
 - ☛ Exempt group LED
 - ☛ There is the danger of explosion if the battery is replaced incorrectly.
 - ☛ Replace the battery only with the same or equivalent type recommended by the manufacturer.
 - ☛ Dispose of used batteries according to the manufacturer's instructions.
- **Notes on Battery Charging**

To ensure the device is charging properly, observe the following:

 - ☛ Before charging the battery, make sure the device is properly turned off.
 - ☛ Using a USB cable, connect your device to a notebook, computer or USB power adapter.
 - ☛ Do not plug the USB cable during scanning. Doing so may cause your device to malfunction.

Basic Care For Your Device

To optimize scan performance, we recommend you clean the pocket scanner at least once a week.

- Wipe the device gently with a dry clean cloth.
- Do not apply pressure to the scan window when cleaning the bottom of the device.
- When cleaning the scan window, be careful not to scratch the window surface.

INTRODUCTION

Congratulations on purchasing this All-in-One Pocket Scanner. This device with its easy-to-use software lets you scan any type of document or pictures with one click! Once the scanning process is complete, the scanned image is then ready for editing, saving, or sharing with your family or friends.

Features

- Scan variety types of printed document including text, images, tables, and QR code.
- Support OCR function.
- Support document editing right after scanning complete.
- Save scanned document in multiple file formats (JPEG / PNG / BMP / XLS / DOC / PDF).
- Support sharing and upload functions via social networking site or e-mail service.
- Support image searching and text translation functions via Google.

Package Contents

The following items should be included in your package.

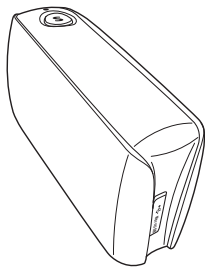

PocketScan

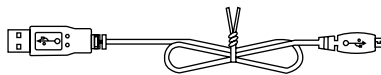

USB Charging Cable

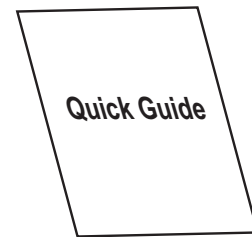

Quick Guide

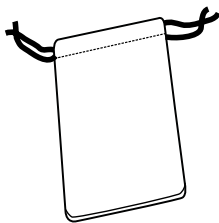

Protect Pouch

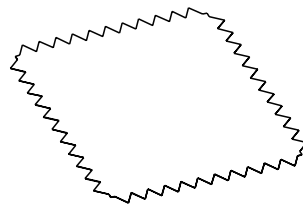

Clean Cloth

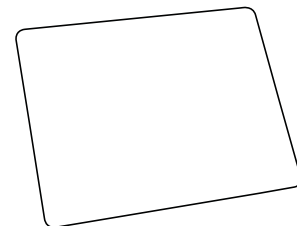

Scan Pad

Product Overview

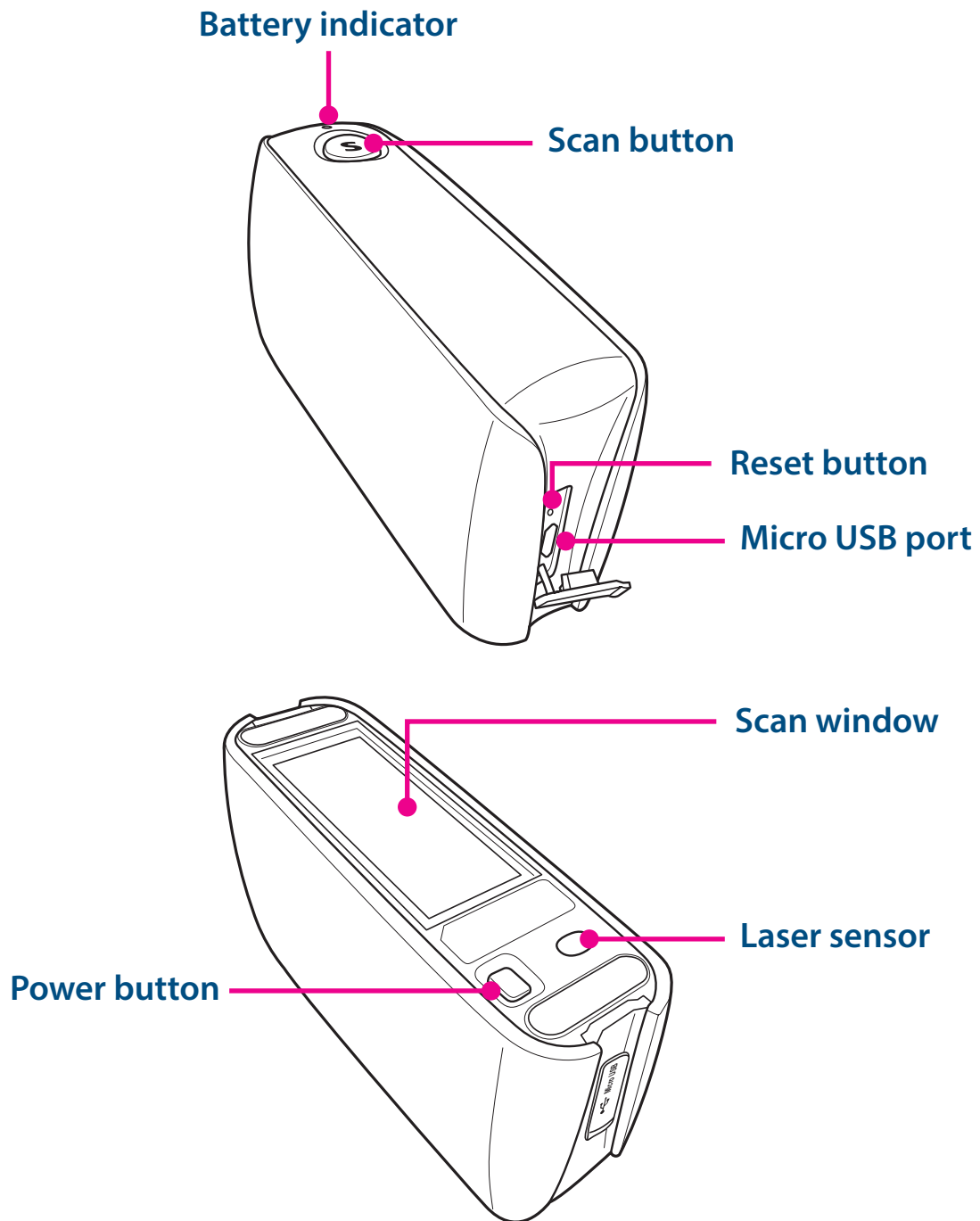
**Note:**

- Be sure to remove the protective film attached on the scan window before using the device.

GETTING STARTED

Charging the Device

Before using this device for the first time, you need to charge the device using the supplied USB charging cable.

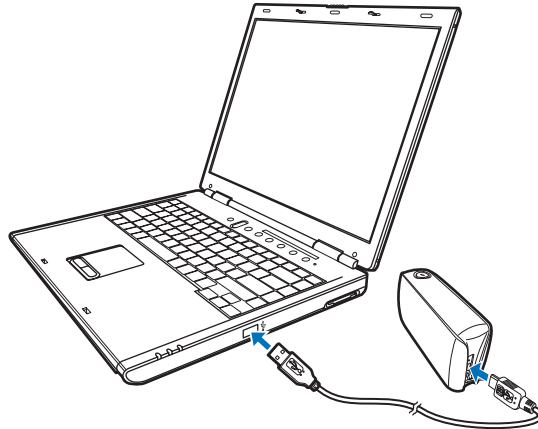

Downloading the Software

iOS and Android:

Search for “Dacuda PocketScan” app in iOS Appstore or in Google Play Store.

Windows and Mac:

Download the software from the following website:
<http://www.dacuda.com/downloadPocketScan>.



Note:

- For more information on how to install the software, refer to “SOFTWARE INSTALLATION” on page 9.

Connecting Your PocketScan

The first time you use the device, you need to pair your PocketScan with the computer or portable devices.

- 1 Hold the **Power** button for 4 seconds. The blue and red lights will blink, indicating the device is in pairing mode.

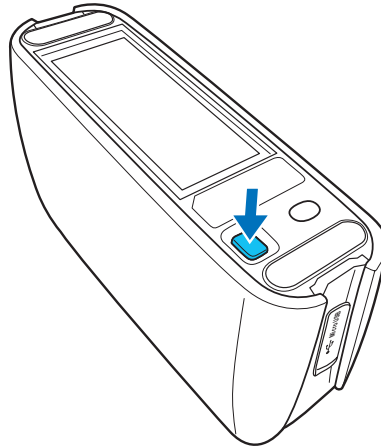

- 2 In the operating system's Bluetooth setting, select **PocketScan** from the available devices.

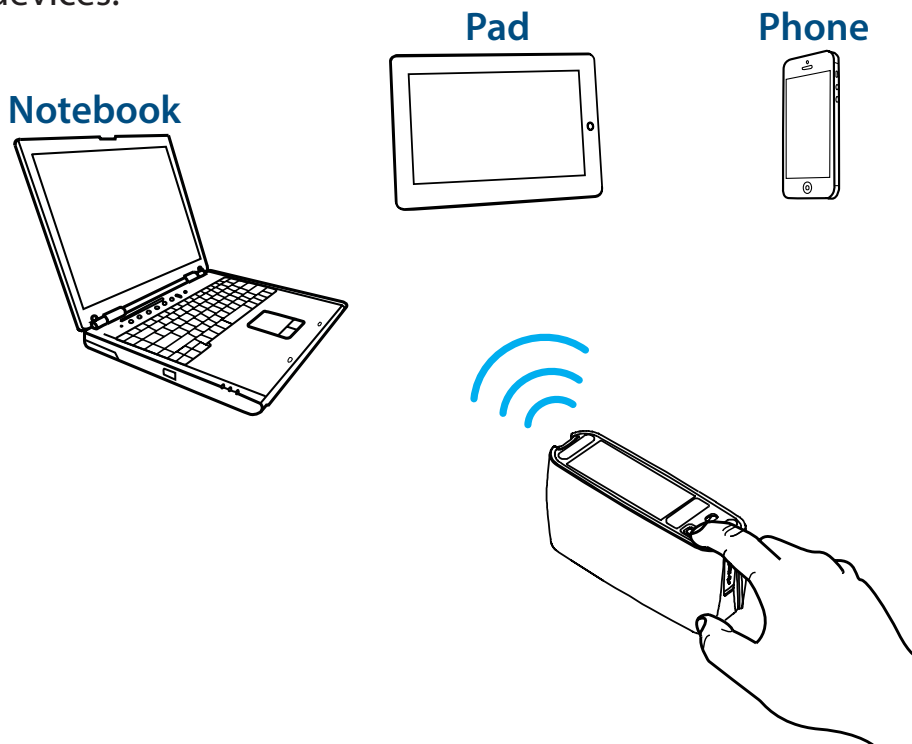

- 3 Go back to the PocketScan application and wait until it shows that the devices are properly connected. You are now ready to scan.

 **Note:**

- For the next time, just press the **Power** button for 1.5 seconds and the paired devices will be automatically connected.

Scanning the Document

To scan a document, perform the following:

- 1 Place your PockeScan on the document that you want to scan.
- 2 Press the **Scan** button to start scanning.
The scanning screen appears.

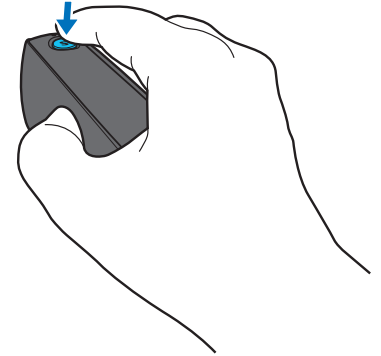

- 3 Move your PockeScan steadily over the document to scan the desired area.

 **Note:**

- We highly recommend you scan the document in S-shape (from top to bottom).
- Make sure to always cover some of the already scanned content to ensure the highest scan quality. In case an area is not perfectly scanned, simply move the device over this area again and the scan quality will improve.
- The scanning process is automatically paused when you lift the mouse. To resume, place the mouse at an area where you have scanned earlier.
- When scanning multi-language document or document in a language other than English, you can specify the OCR language in **Settings** menu.
- When scanning a book, be sure the position of the laser sensor is within the area of the scanned page.
- PocketScan can correct scanning mistakes: While scanning, you can move back to places which you would like to improve.



- 4 Press the **Scan** button again to end scanning.

SOFTWARE INSTALLATION

When using the pocket scanner for the first time, you need to install the software on your computer.

System Requirements

Before installing the software, be sure that your pad/computer meets the following specifications:

❖ Interface

- Bluetooth v4.0 (chicony B914B0)
- USB -- for charger / FW updated / calibration

❖ Supported Devices (PAD)

OS Type	Android	iOS
Supported Operating Systems	Android 4.2 /4.3 /4.4	iOS version 8
Minimum System	Google Nexus 7, Samsung Galaxy Tab S8.4, Samsung Galaxy Tab S10.5, Samsung Galaxy Note 10.1, Samsung Galaxy Note 2, Samsung Galaxy Note 3, more devices added later Mac OS: 10.8, 10.9 and 10.10 - no support for 10.7	iPad 3rd generation and later, iPad mini 2nd generation and later, iPhone 5, 5s and 6

SOFTWARE INSTALLATION

❖ Supported Devices (PC)

PC Type	Windows	Mac
Supported Operating Systems	<ul style="list-style-type: none"> Windows Vista - 32 Bit and 64 Bit Windows 7 - 32 Bit and 64 Bit Windows 8 - 32 Bit and 64 Bit 	<ul style="list-style-type: none"> Mac OS X 10.7 Max OS X 10.8
Minimum System	<ul style="list-style-type: none"> Intel® Core™ Duo 1.2GHz or AMD Athlon™ 64 X2, 1.7GHz or better 2 GB of RAM of which at least 512 MB are free 128 MB NVIDIA® GeForce® 8400 GS or 128 MB ATI Radeon™ X1300 or 384 MB (shared) Intel® GMA X3000 or better 1 GB free disk space 	<ul style="list-style-type: none"> Intel® Core™ Duo 1.8 GHz (MacBook Pro 1.1) or Intel® Core™ 2 Duo 1.4 GHz (MacBook Air 3.1) or better 2 GB of RAM or more of which at least 512 MB are free ATI Mobility Radeon™ X1600 128 MB DDR3 dedicated (MacBook Pro 1.1) or NVIDIA® GeForce® 320M 256 MB DDR3 SDRAM shared (MacBook Air 3.1) or better 1 GB free disk space
Recommended System	<ul style="list-style-type: none"> Intel® Core™ i5 or better 4 GB System RAM or more 512 MB Graphics memory or more 	

APPENDIX

Specifications

Category	Specifications
MOUSE	
Image Sensor	640 × 480 (VGA)_ OV7740
Lens	KINKO DIF-3203A-FH
Navigation Sensor	1 Laser Sensor + 1 Gyroscope Sensor
Light Source	3 LED/40mA
Scan Resolution	Optical resolution: 380 DPI Software resolution: Max to 400 DPI
Scan Size	Up to A3
Scan Speed (Moving Speed)	20 cm Per Second
Scan window (1 frame)	15mm x 40mm
Battery capacity	1090mAh
FUNCTIONS (For PAD -- Andriod / iOS)	
Main	Scan / Edit / Save / Share / Image & Text Paste / Print (TBD)
Edit	Auto De-skew / Crop / Rotation / Zoom In and Out / Brightness / Contrast (TBD)
Save Format	JPEG / PNG / BMP / XLS / DOC / PDF (TBD)
Share	Facebook / Twitter / Flickr / E-mail (TBD)
Text Recognition	OCR Function Supported (TBD)
FUNCTIONS (For PC -- Win / Mac)	
Main	Scan / Edit / Save / Share / Image & Text Paste / Print
Edit	Auto De-skew / Crop / Rotation / Zoom In and Out / Brightness / Contrast
Save Format	JPEG / PNG / BMP / XLS / DOC / PDF
Share	Facebook / Twitter / Flickr / E-mail
Text Recognition	OCR Function Supported

APPENDIX

APPEARANCE	
Dimension (mm)	101(L) × 54(W) × 29(H)
Weight (g)	100 ± 10 (TBD)
Color	Black / Silver (TBD)
RELIABILITY	
Operation condition	Degree (°C): 5°C ~ 35°C Humidity (%): 10 ~ 80
Storage condition	Degree (°C): -20°C ~ 60°C Humidity (%): 85%
Unit drop (Hight)	15 cm (Function need to work) 60 cm (Must not have danger)
Packing drop	82 cm
Pad life	35 km
Button life	Power button : 12000 times (20times*240days* 2years*1.2safety factor) Scan button: 35000 times (60times*240days* 2years*1.2safety factor)
Battery life	3.5 hours (continue scan @ 25°C) TBD Hours (continue scan @ LL)
Extremely High Temperature (simulation in Car)	85°C±2°C for 48 hours
Water Splash	200cc (with/without operating condition)

* Specifications are subject to change without notice.

Safety Regulations



FCC (Federal Communications Commission)

This device complies with Part 15 of the FCC Rules.

Operation is subject to the following two conditions:

- (1) This device may not cause harmful interference, and
- (2) this device must accept any interference received, including interference that may cause undesired operation.

FCC	FCC part 15 Subpart B class B FCC part 15C
ICES003	CAN/CSA-CEI/IEC CISPR 22 RF:RSS-220
EMC Directive (CE) 2004/108/E	EU EN55022 Class B, EN55024 & EN 301489-1 / -17 RF:EN 300 328 & EN 62479 CB Report: IEC/ EN60950-1
UL60950	UL60950-1
IEC62133	IEC62133:2012(2nd)
UL1642	UL1642 fourth edition
UN38.3	
FDA	