

User's Manual

P/N 1-960387-51
Edition 2
September 1998



EasyCoder 601 S Bar Code Label Printer

 **ntermec**

A **UNOVA** Company

Intermec EasyCoder 601 S – User's Manual

CONTENTS

Introduction	Presentation of the <i>EasyCoder 601 S</i>	3
Get to Know Your Printer	Front View	4
	Rear View	4
	Paper Stock Compartment	5
Paper Load	Tear-Off	6
	Cut-Off	9
Ribbon Load	Loading Instructions	12
	Ribbon Width Adjustment	14
Maintenance	Printhead Cleaning	15
	External Cleaning	17
	Printhead Replacement	18
	Troubleshooting	19

Intermec EasyCoder 601 S
User's Manual
Edition 2, September 1998
Part No. 1-960387-51

Intermec EasyCoder 601 S – User's Manual

Information in this manual is subject to change without prior notice and does not represent a commitment on the part of Intermec Printer AB.

© Copyright Intermec PTC AB, 1998. All rights reserved. Published in Sweden.

EasyCoder, Fingerprint, and LabelShop are registered trademarks of Intermec Technologies Corp. Apple and Macintosh are registered trademarks of Apple Computer Inc.

Microsoft is a registered trademark of Microsoft Corporation.

Speedo is a trademark of Bitstream, Inc.

Torx is a registered trademark of Camcar Division of Textron Inc.

TrueType is a trademark of Apple Computer Inc.

Windows is a trademark of Microsoft Corporation.

FCC Notice United States of America

WARNING:

This equipment generates, uses, and can radiate radio frequency energy and if not installed and used in accordance with the instructions manual, may cause interference to radio communications. It has been tested and found to comply with the limits for a Class A computing device pursuant to Subpart J of Part 15 of FCC Rules, which are designed to provide reasonable protection against such interference when operated in a commercial environment. Operation of this equipment in a residential area is likely to cause interference in which case the user at his own expense will be required to take whatever measures may be required to correct the interference.

DOC Notice Canada

Canadian Dept. of Communication REGULATIONS COMPLIANCE (DOC-A)

This digital apparatus does not exceed the class A limits for radio noise emissions from a digital apparatus as set out in the radio interference regulations of the Canadian Department of Communication.

* * *

Ministère des Communications du Canada CONFORMITE DE REGLEMENTS (DOC-A)

Le présent appareil numérique n'émet pas de bruits radio-électriques dépassant les limites applicables aux appareils numériques de classe A prescrites dans le règlement sur brouillage radioélectrique édicté par le Ministère des Communications du Canada.

INTRODUCTION

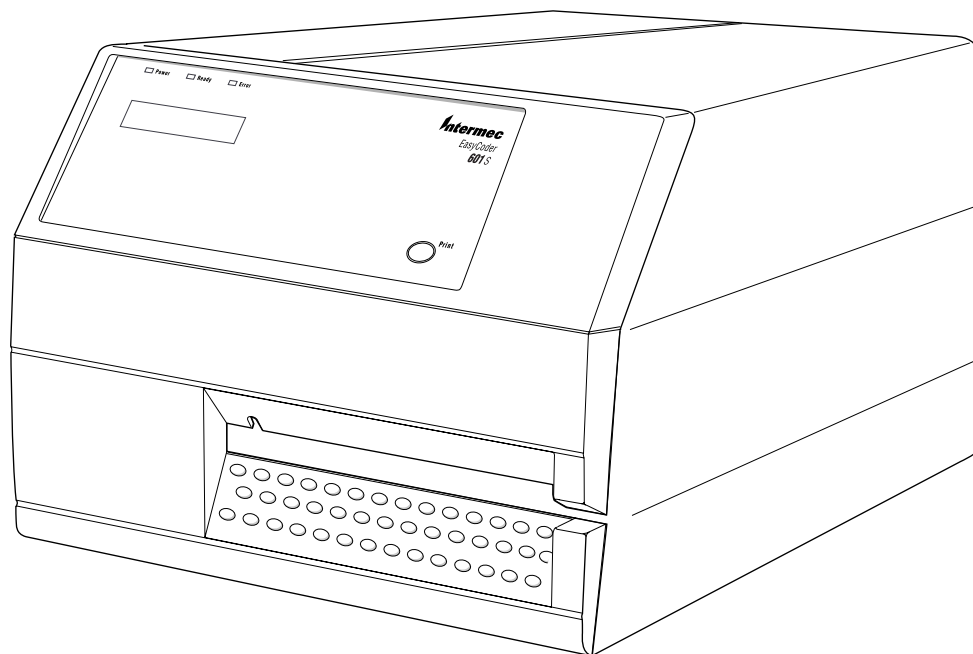

The *EasyCoder 601 S* is a modular multipurpose thermal transfer/direct thermal printer for wide labels, tickets, tags or strip from an external supply, usually in the form of fan-folds. The print width is 160 mm (6.3") and the printhead density is 8 dots per mm (203.2 dots per inch).

The *EasyCoder 601 S* can optionally be fitted with a software package that can handle *TrueType* and *Speedo* fonts, a memory card adapter, a parallel interface board, a paper cutter, and other useful accessories.

The built-in *Intermec Shell* startup program makes the printer very suitable for installations, where you want to switch between different application programs, such as the *Intermec LabelShop* label-editing program for Windows, or the *Intermec Windows Drivers*.

You can also edit label layouts and add variable data by means of the *Intermec Direct Protocol*, or create your own programs in the built-in *Intermec Fingerprint* programming language. Comprehensive information on installation, setup, paper, transfer ribbons, options and computer connection can be found in the *Technical Manual*.

The following manuals may also be of interest to the operator or programmer:

- *Intermec EasyCoder 601 S, Operator's Guide*
- *Intermec Shell Standard 4.01, Startup Manual*
- *Intermec Direct Protocol 6.13, Programmer's Guide*
- *Intermec Fingerprint 6.13, Programmer's Guide*
- *Intermec Fingerprint 6.13, Reference Manual*
- *Intermec LabelShop, various manuals*

GET TO KNOW YOUR PRINTER

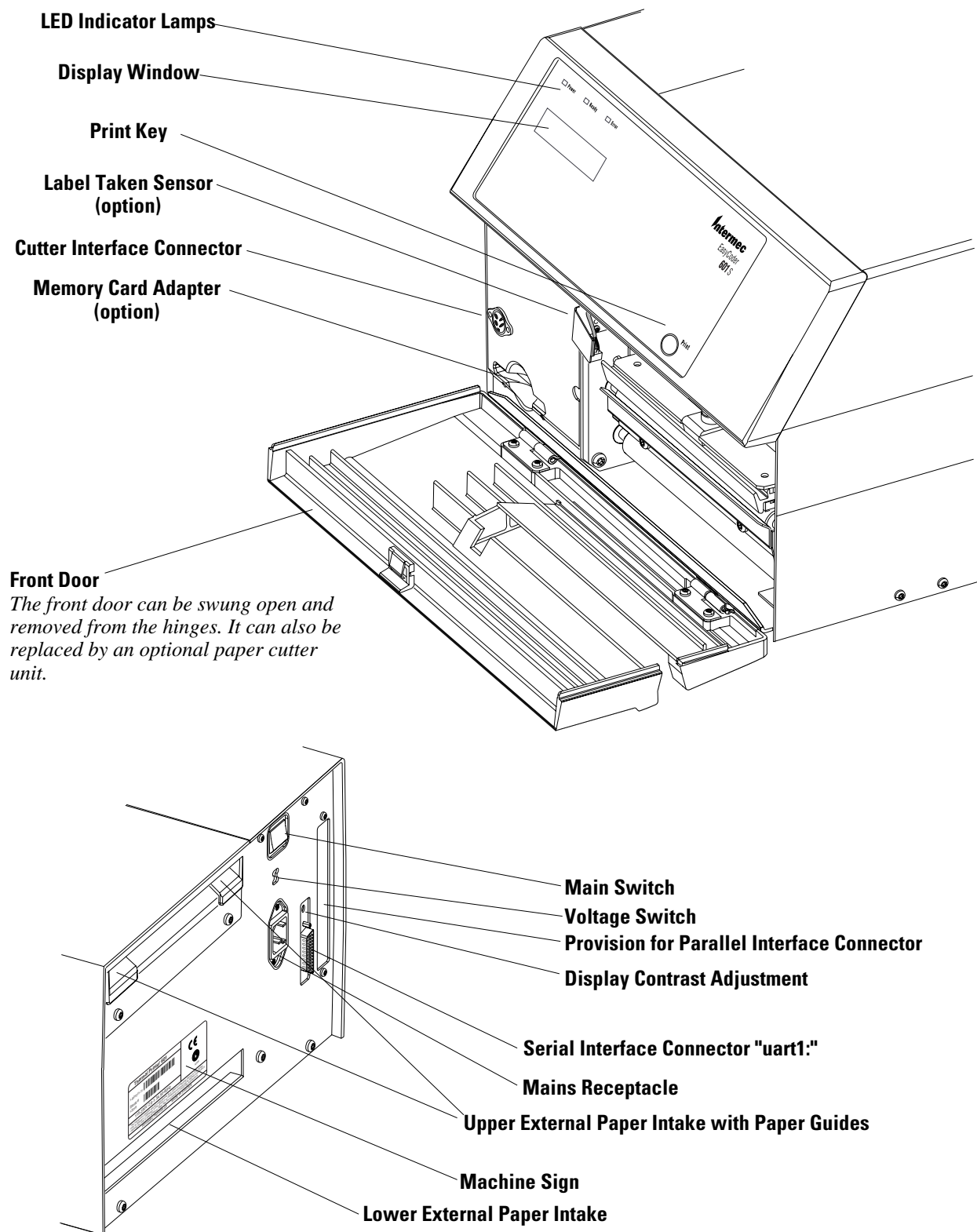

Continued!

GET TO KNOW YOUR PRINTER, cont'd.

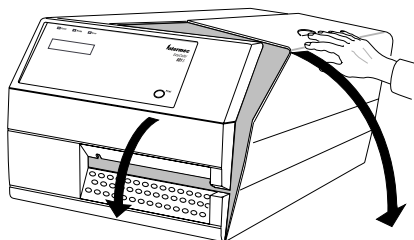

The paper stock compartment becomes accessible when the right-hand and front doors are swung open. Although the printer is operable when the doors are left opened or completely removed, you are strongly recommended to keep them closed during normal operation, so as to prevent the printer mechanism from being exposed to dust.

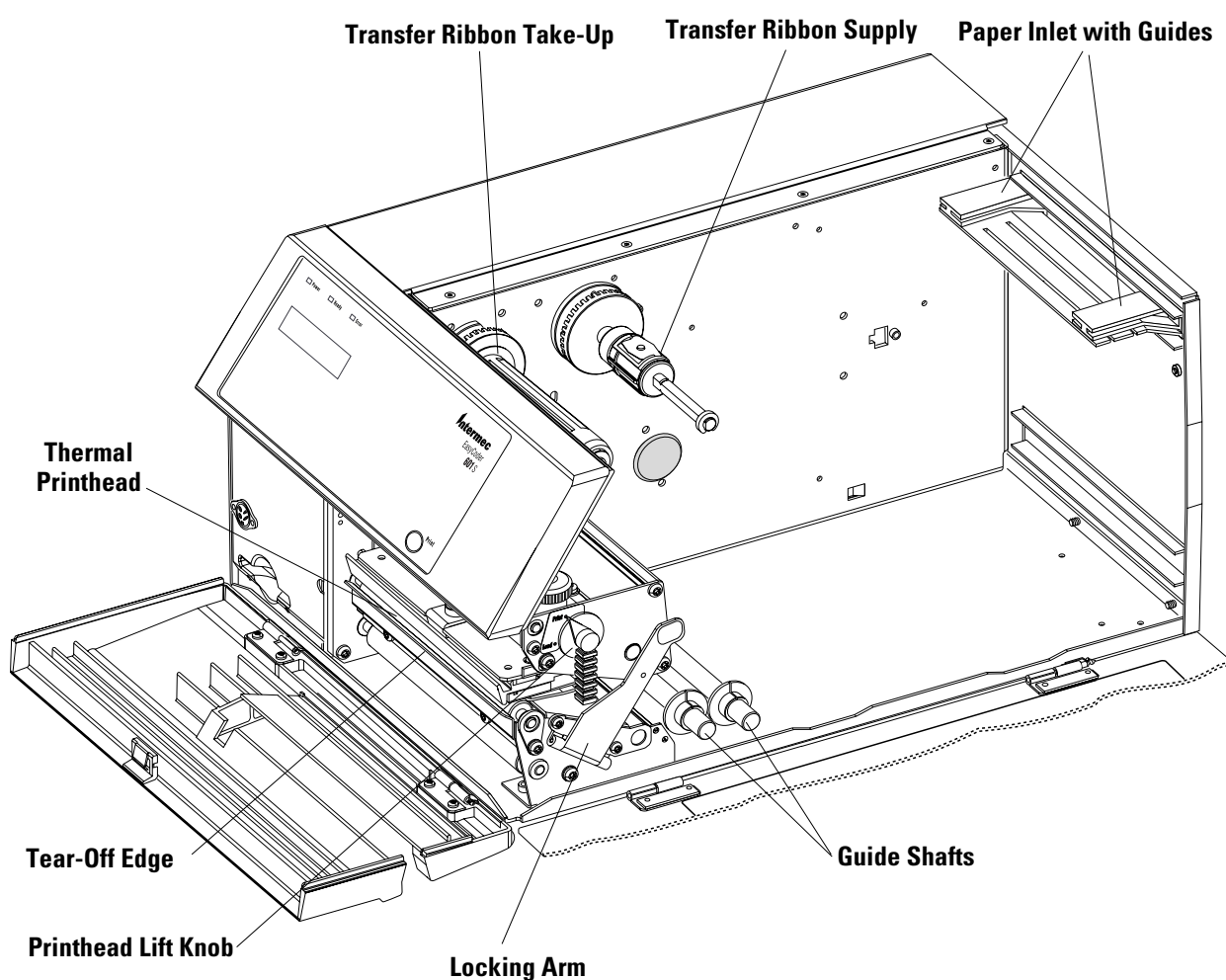

PAPER LOAD – TEAR OFF

1

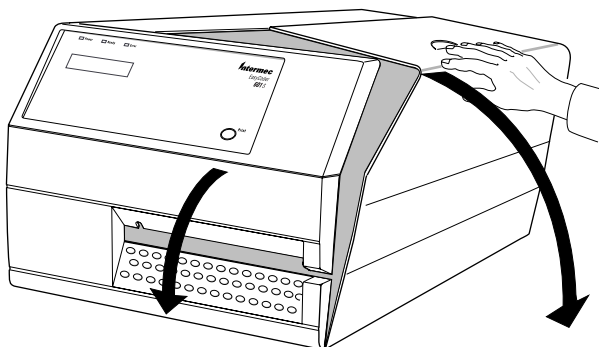

Open the front and right-hand doors.

2

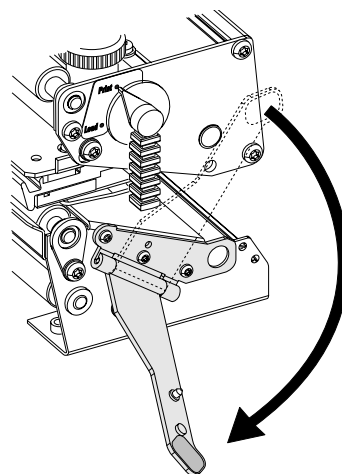

Fold the locking handle downward/outward.

3

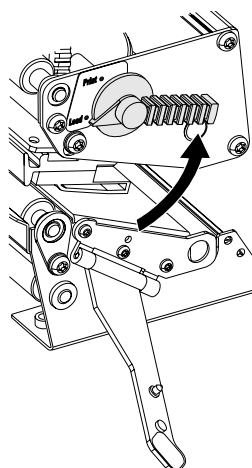

Turn the printhead lift knob to "Load" position.

4

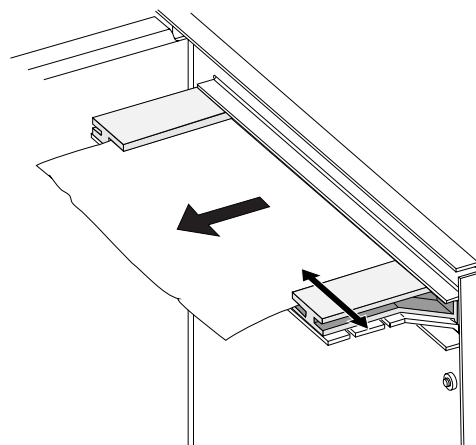

Insert the paper through the paper guides in the rear plate and adjust the position of the outer guide.

5

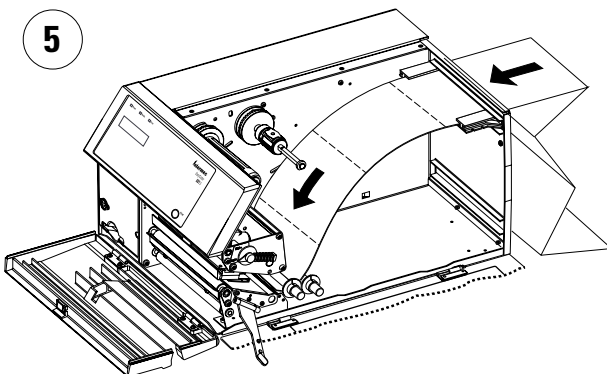

Thread the paper above the rear guide shaft, under the front guide shaft, and into the print unit.

6

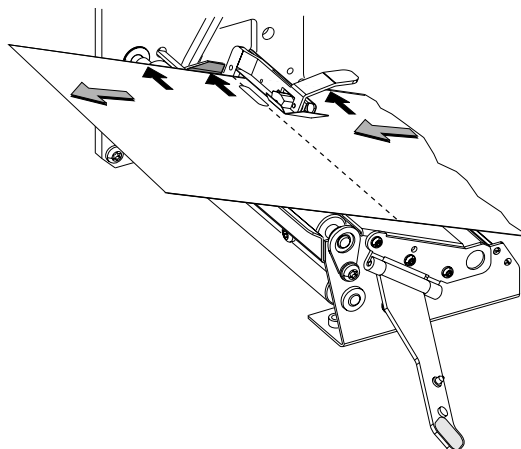

*Thread the paper forward under the label stop sensor.
Push the paper inwards as far as it will go.*

PAPER LOAD – TEAR OFF, cont'd.

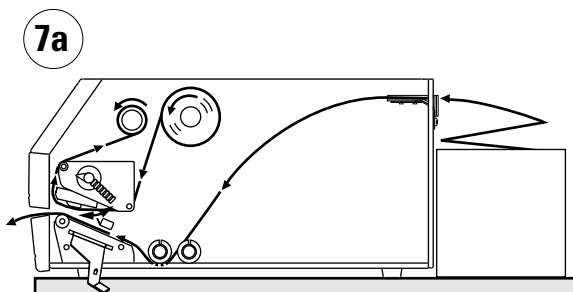

This diagram shows the path of the paper when the paper guides are in upper position (standard).

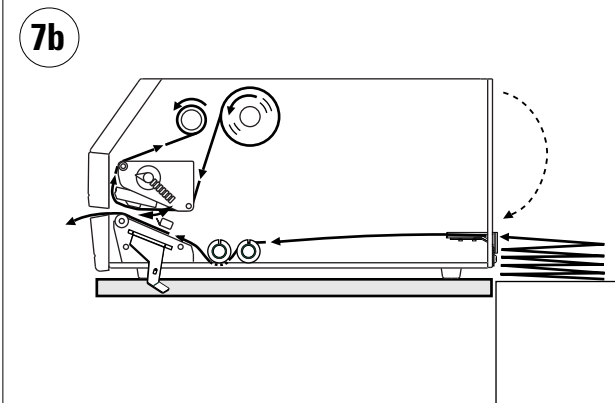

The paper guides are held by two Torx screws and can easily be moved to the lower position when the paper supply is placed low, e.g. on the floor.

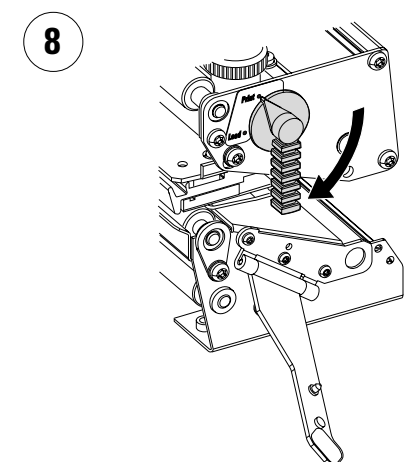

Turn the printhead lift knob to "Print" position.

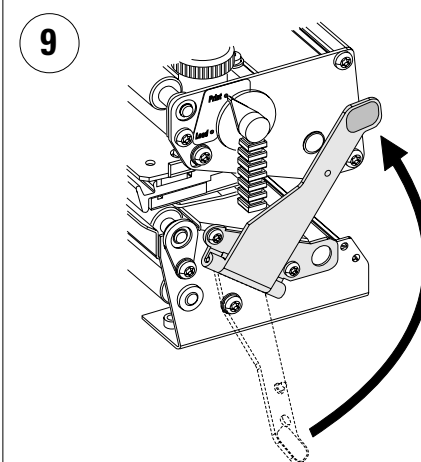

Return the locking handle to closed position.

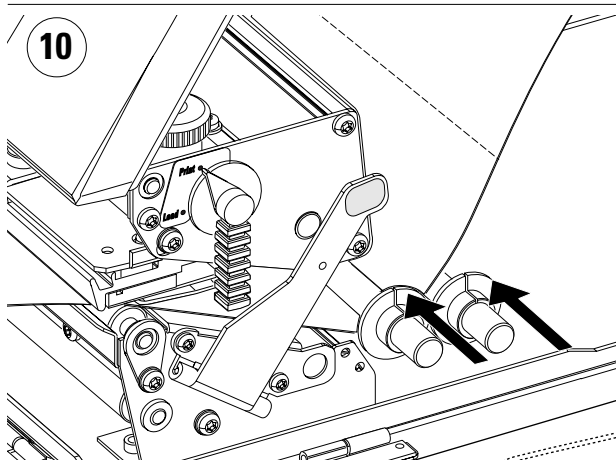

Adjust the position of the two guide rings so they guide the paper with a minimum of play.

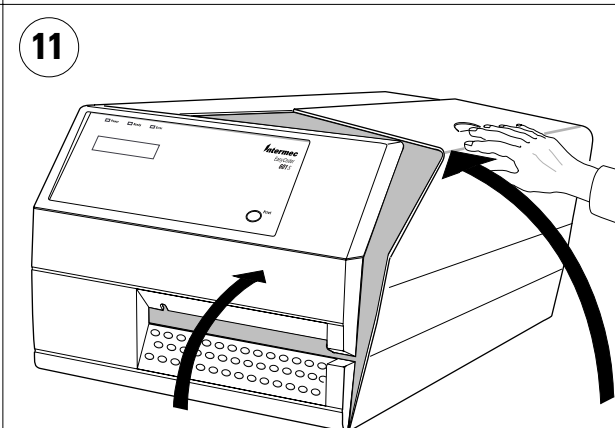

Close the front and side doors.

PAPER LOAD – TEAR OFF, cont'd.

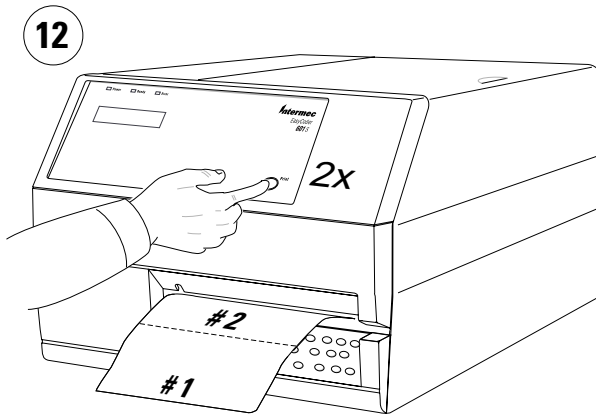

Feed out two blank copies by pressing the <Print> key twice.

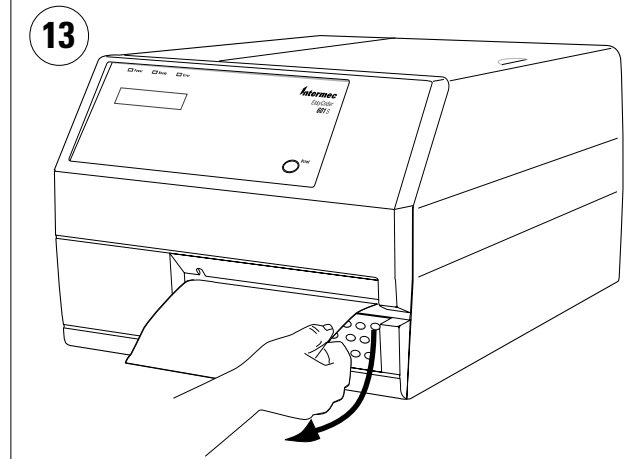

*To tear off the paper, pull it **downwards**.*



Take precautions to protect the paper stock from sand, grit and other hard particles, that may damage the printhead!

PAPER LOAD - CUT OFF

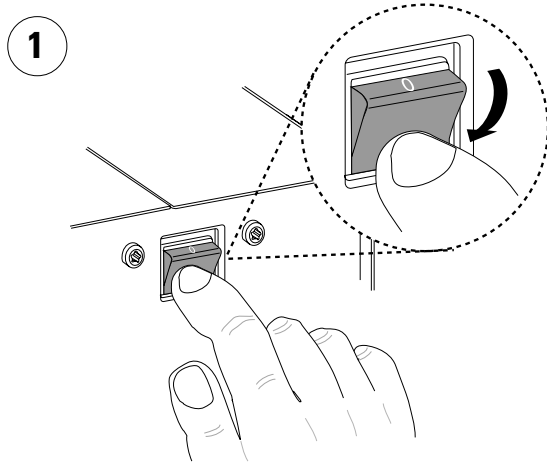

Turn off the power using the switch on the rear plate.

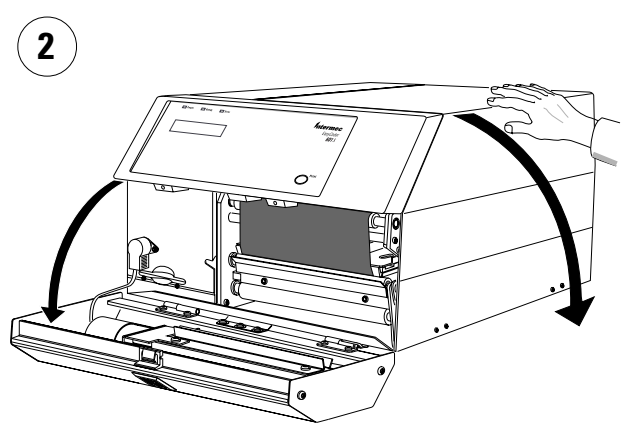

Open the optional cutter unit and the right-hand door.

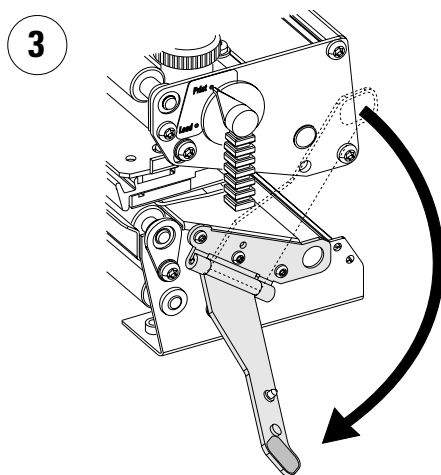

Fold the locking handle downward/outward.

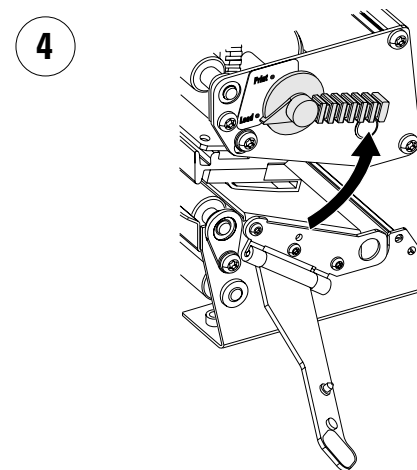

Turn the printhead lift knob to "Load" position.

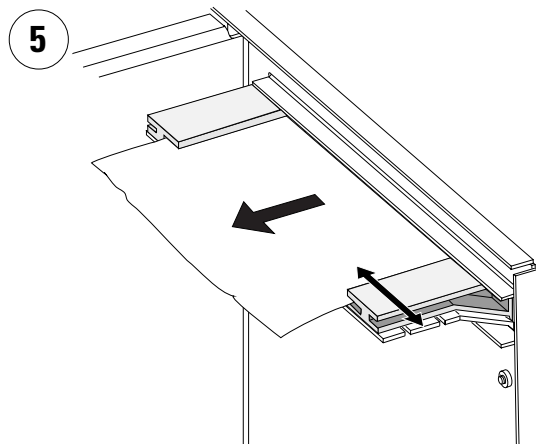

Insert the paper through the paper guides in the rear plate and adjust the position of the outer guide.

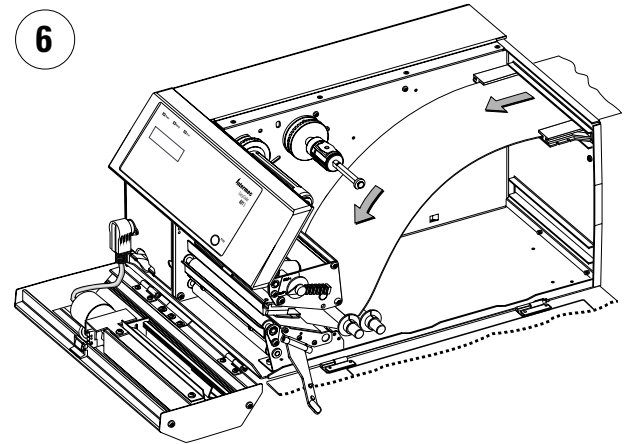

Thread the paper forward between the two guide shafts and into the print mechanism.

PAPER LOAD - CUT OFF, cont'd.

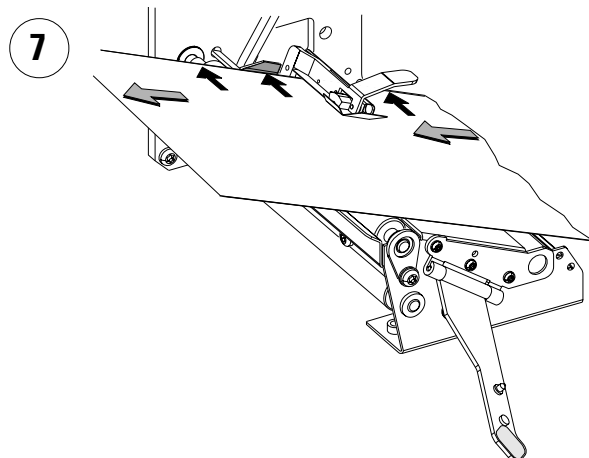

Thread the paper forward under the label stop sensor.
Push the paper inwards as far as it will go.

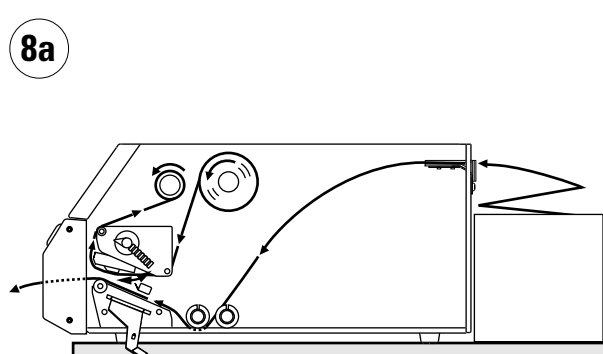

This diagram shows the path of the paper when the paper guides are in upper position (standard).

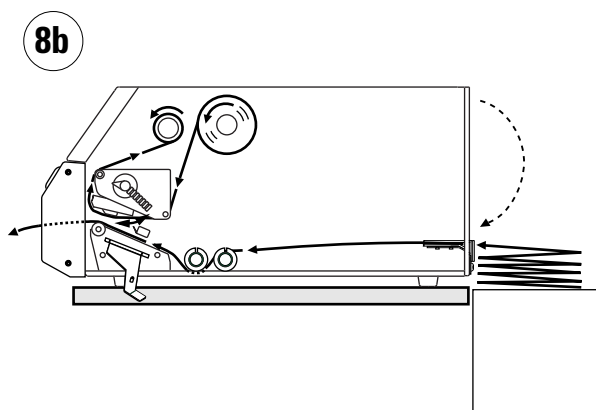

The paper guides are held by two Torx screws and can easily be moved to the lower position when the paper supply is placed low, e.g. on the floor.

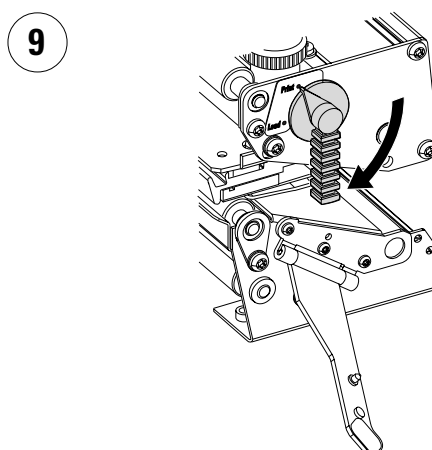

Turn the printhead lift knob to "Print" position.

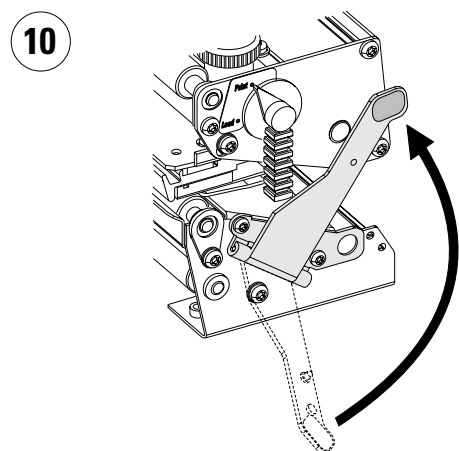

Return the locking handle to closed position.

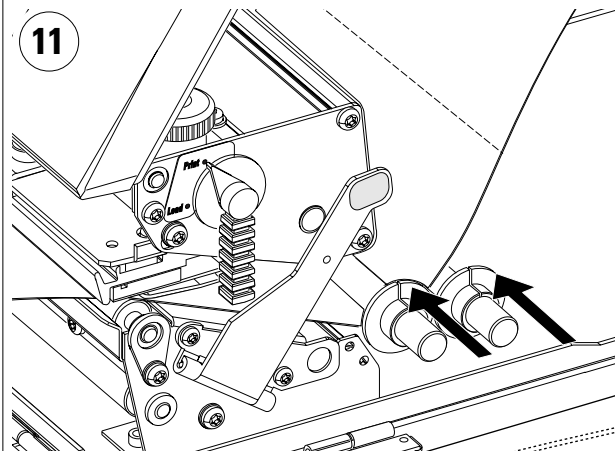

Adjust the position of the two guide rings so they guide the paper with a minimum of play.

PAPER LOAD - CUT OFF, cont'd.

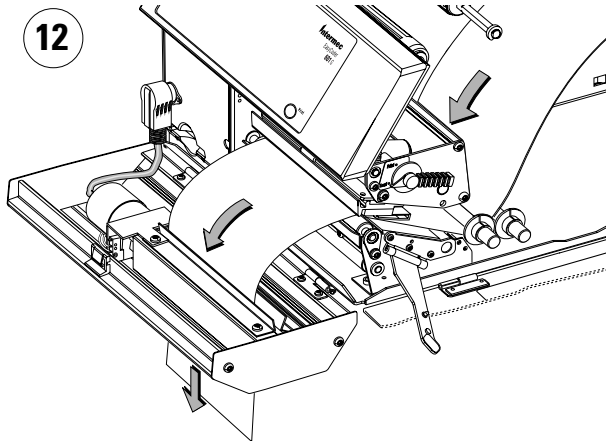

Thread the paper through the cutter between the two guide plates.

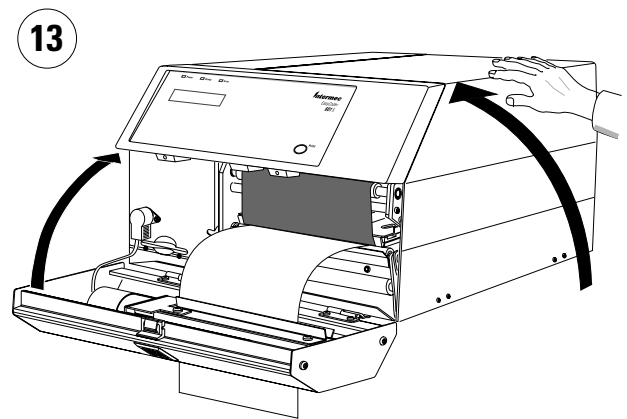

Close the cutter unit while pulling at the end of the paper.
Close the right hand door.

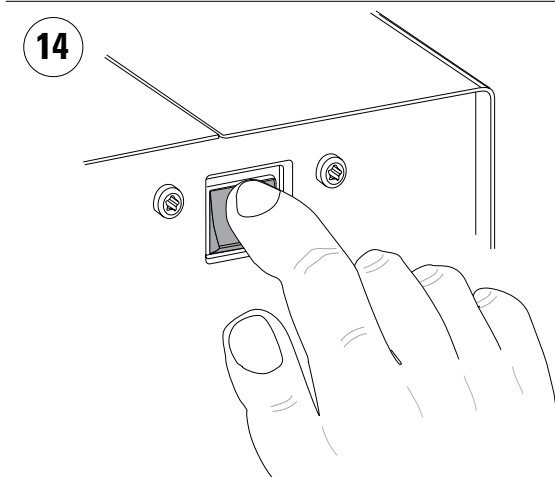

Turn on the power using the switch on the rear plate.

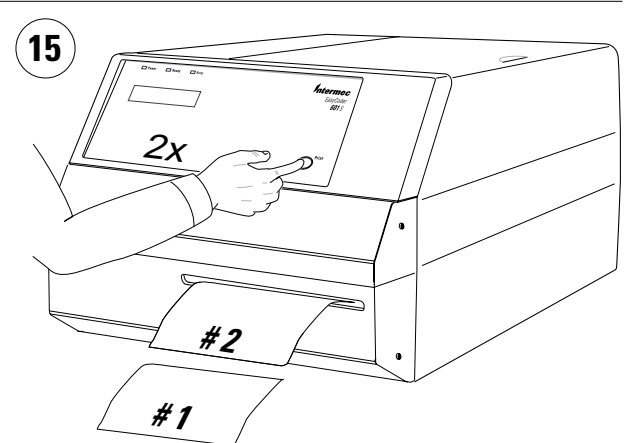

Feed out and cut two blank copies by pressing the
<Print> key twice.



**Take precautions to protect the paper stock
from sand, grit and other hard particles,
that may damage the printhead!**

RIBBON LOAD

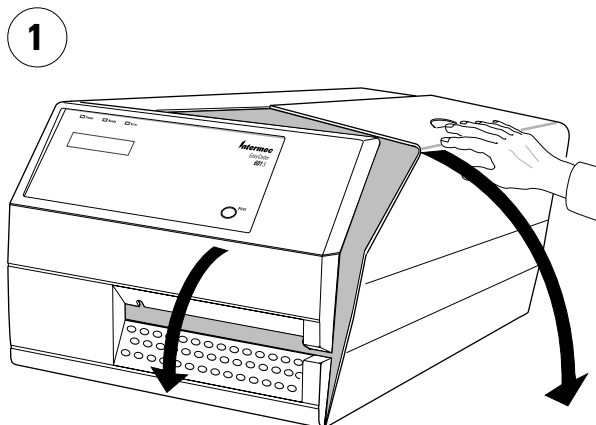

Remove the front and right-hand doors.

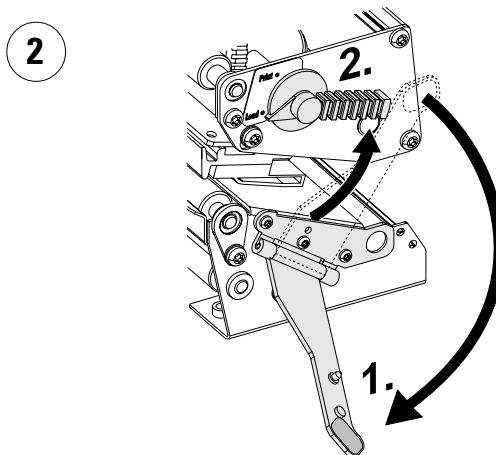

Fold the locking handle downward/outward (1). Then turn the printhead lift knob to "Load" position (2).

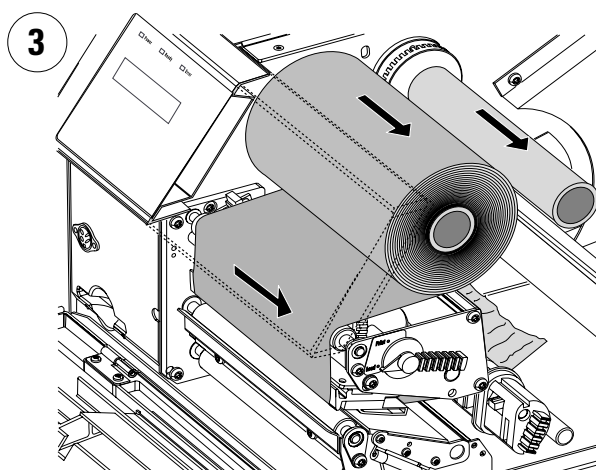

Pull out the used-up ribbon and the empty ribbon core.

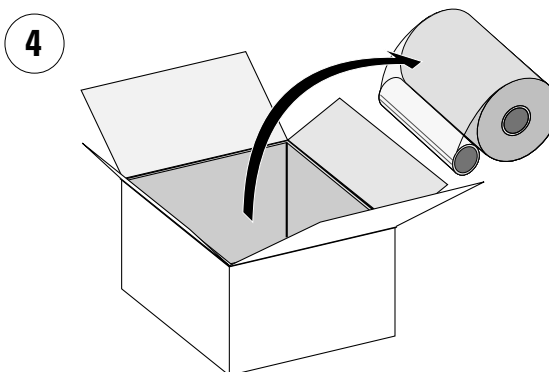

Unpack a roll of original Intermec transfer ribbon. The use of any thermal transfer ribbon, other than those supplied by Intermec, will invalidate the printhead warranty.

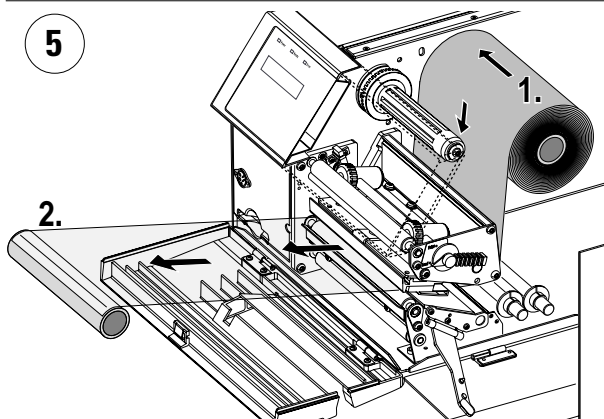

Press the ribbon roll onto the ribbon supply spool (1) and thread the ribbon under the upper part of the print unit. Pull out approx. 20 cm (8") of ribbon (2).

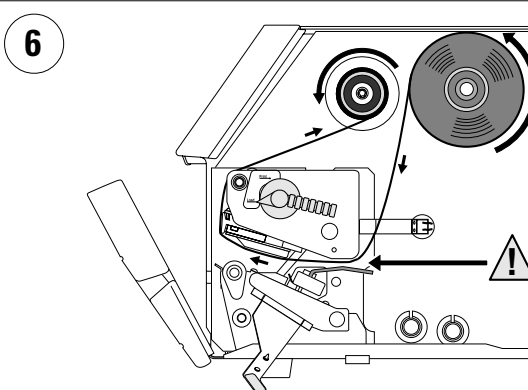

Be careful to thread the ribbon **above** the handle of the label stop sensor! The ribbon must be fitted so the spools rotate counter-clockwise, as illustrated above.

RIBBON LOAD, cont'd.

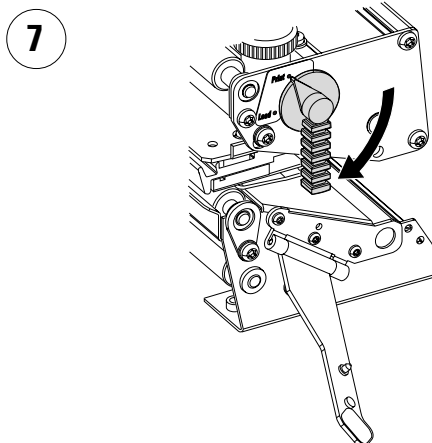

Without releasing the ribbon, turn the printhead lift knob to "Print" position so as to lock the ribbon.

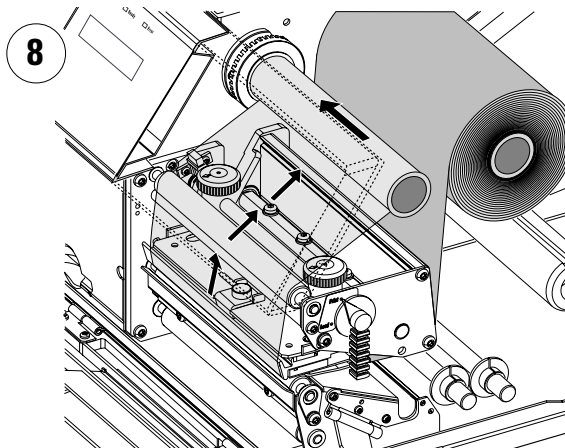

Press the cardboard core fitted at the front end of the ribbon onto the take-up spool.

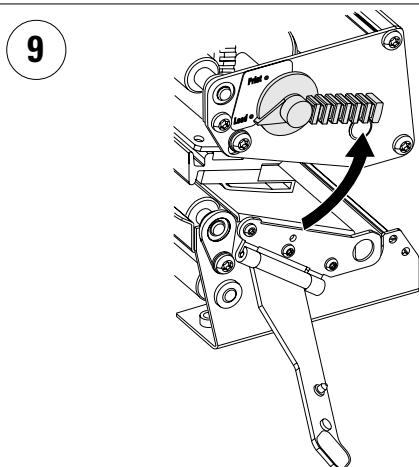

Turn the printhead lift knob to "Load" position.

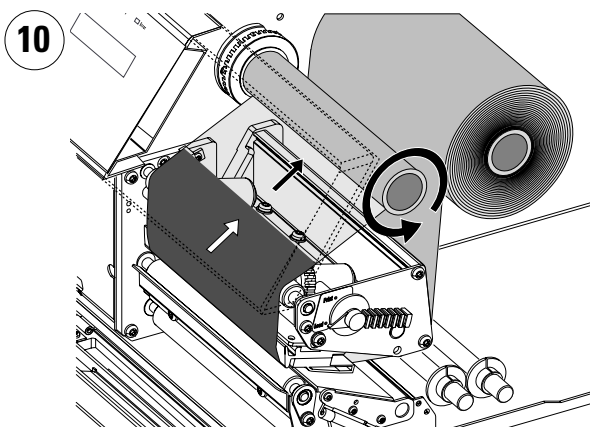

Wind up the ribbon until all of the transparent part has passed the printhead and the ribbon becomes tight.

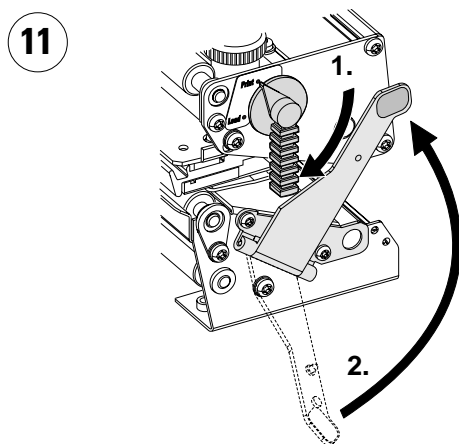

Turn the printhead lift knob to "Print" position (1) and return the locking handle to closed position (2).

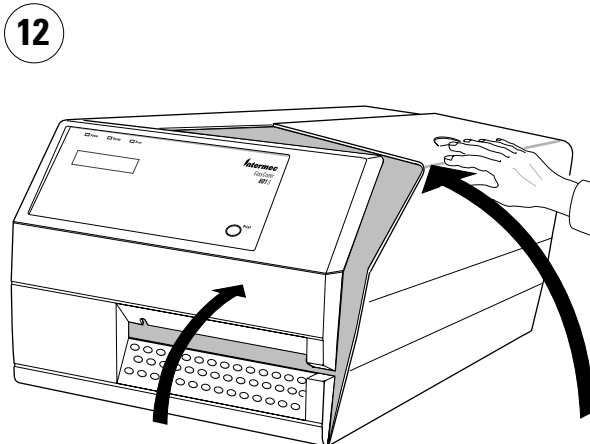

Close the front and side doors.

RIBBON WIDTH ADJUSTMENT

The *EasyCoder 601 S* printer is fitted with a pivoting ribbon supply spool intended to help avoiding ribbon wrinkling. The spool can be moved sideways along the shaft, so as to place the pivoting point at the centre of the ribbon path.

To move the spool, compress it and move it between the six grooves in the shaft according to the table below:

Groove No.	1	2	3	4	5	6
Position	Inner	⇒	⇒	⇒	⇒	Outer
Ribbon width (mm)	55	88	110	130	154	166
Ribbon width (inch)	2.28	3.47	4.33	5.12	6.07	6.54

Make sure the snap-lock has hit a groove by trying to move the spool without compressing it.

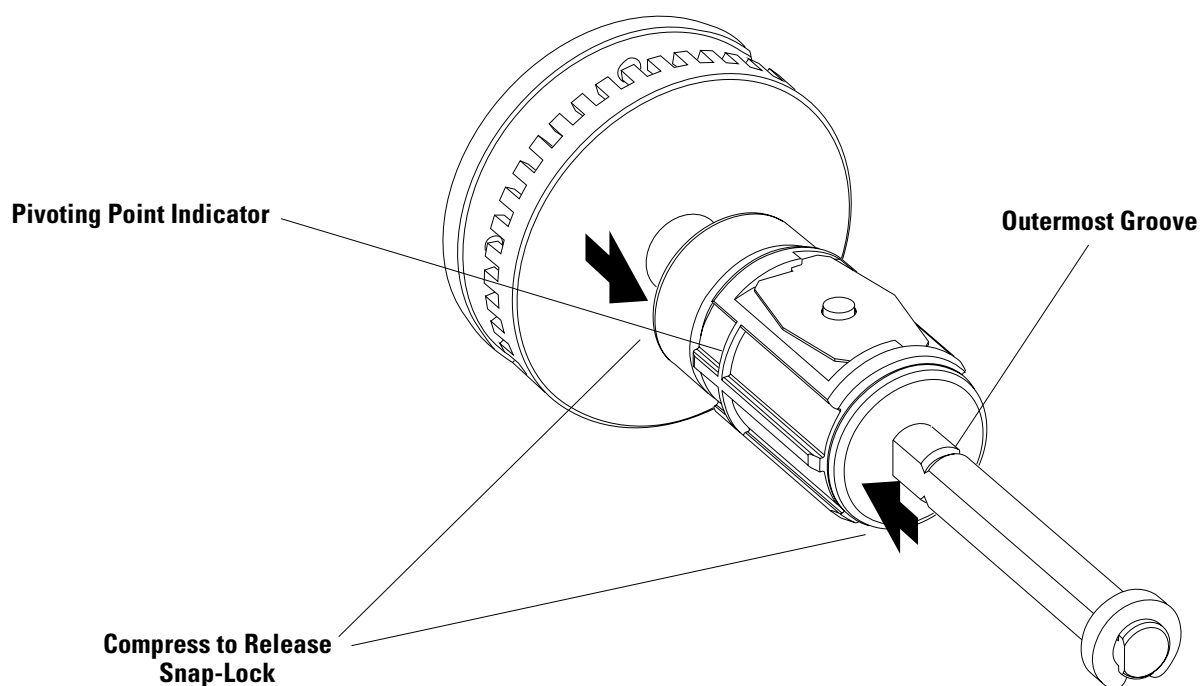

PRINthead CLEANING

Cleaning of the printhead on a regular basis, preferably in connection with each ribbon or paper reload, is important for the life of the printhead and for the printout quality. Below is a description on how to clean the printhead by means of Cleaning Cards. If additional cleaning is required, e.g. for removing adhesive residue from the print roller or dispenser edge, use a cotton swab moistened with isopropyl alcohol.

Caution:
Isopropyl alcohol [(CH₃)₂CHOH; CAS 67-63-0] is a highly flammable, moderately toxic and mildly irritating substance.

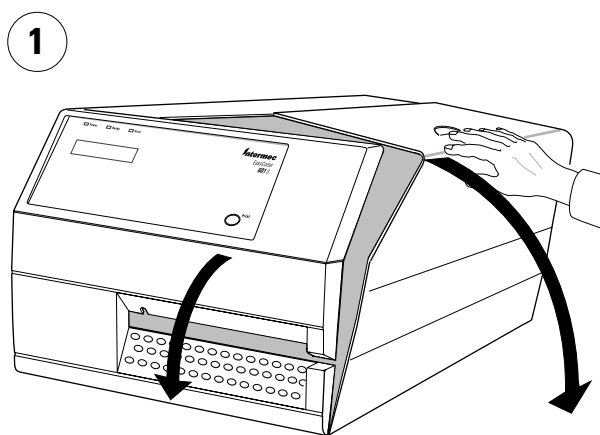

Open the front and right-hand doors.

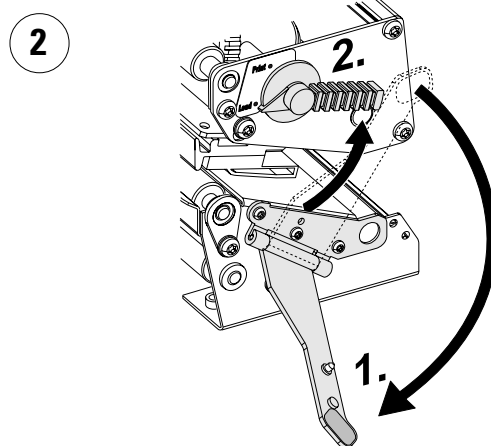

Fold the locking handle downward/outward (1). Then turn the printhead lift knob to "Load" position (2).

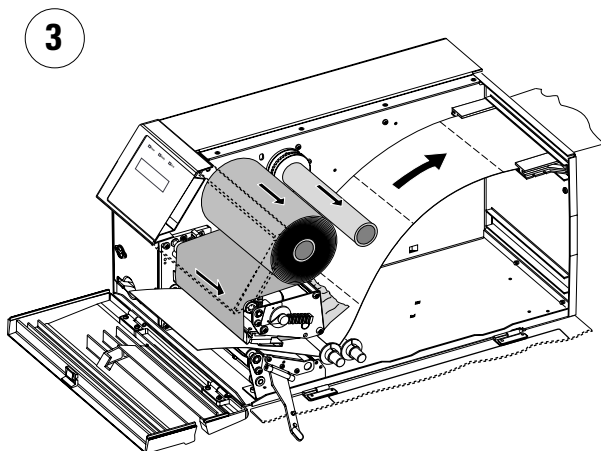

Remove the transfer ribbon and paper supplies.



Open the Cleaning Card pouch. The cleaning card contains isopropyl alcohol, see "Caution" above.

PRINthead CLEANING, cont'd.

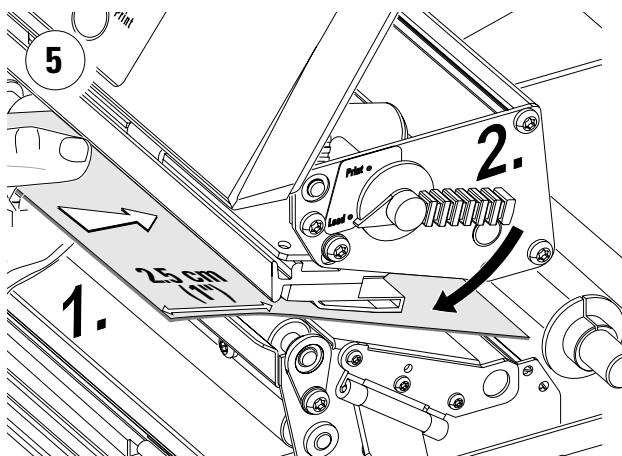

Insert most of the cleaning card under the printhead (1).
Turn the printhead lift knob to "Print" position (2).

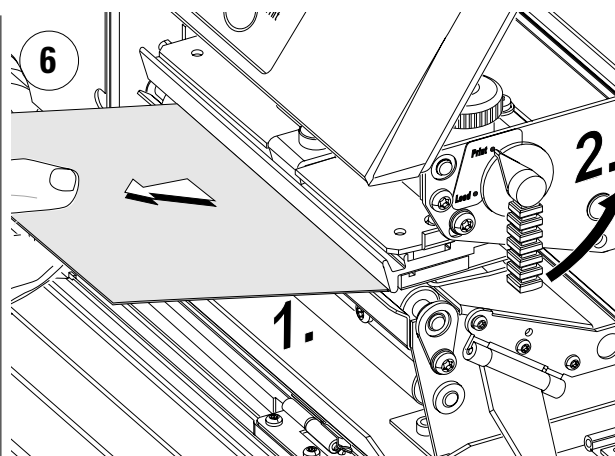

Pull out the cleaning card (1) and turn the printhead lift knob to "Load" position (2).

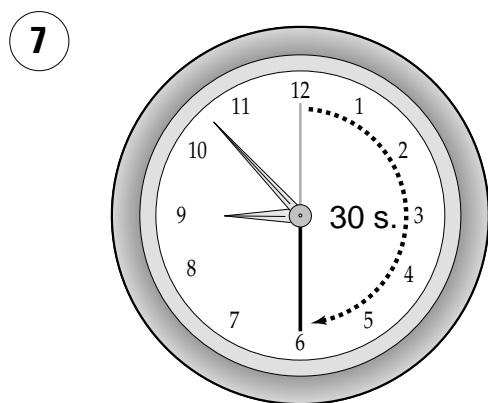

Wait for approx. 30 seconds.

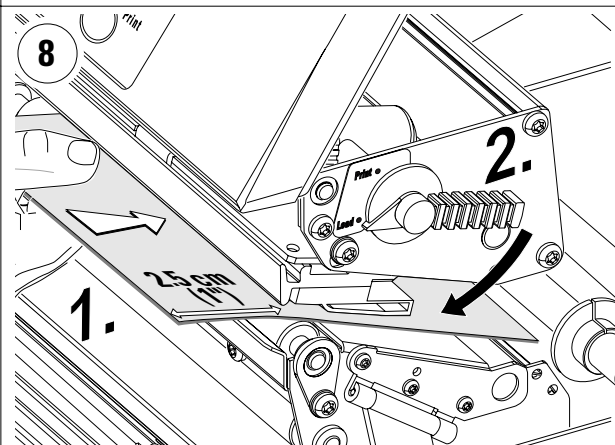

Insert the cleaning card under the printhead again (1).
Turn the printhead lift knob to "Print" position (2).

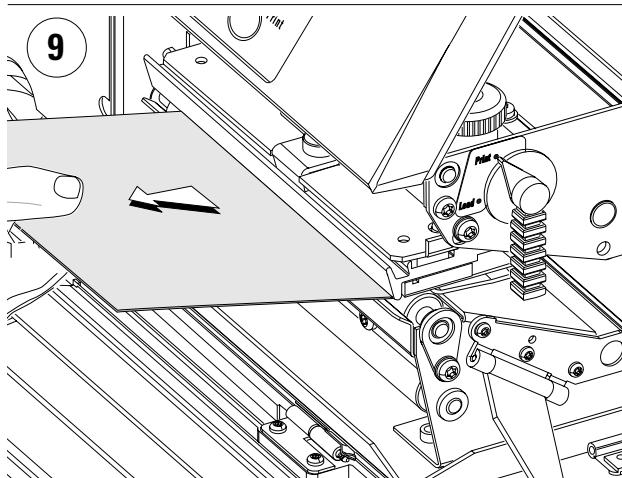

Pull out the cleaning card. Repeat if necessary.

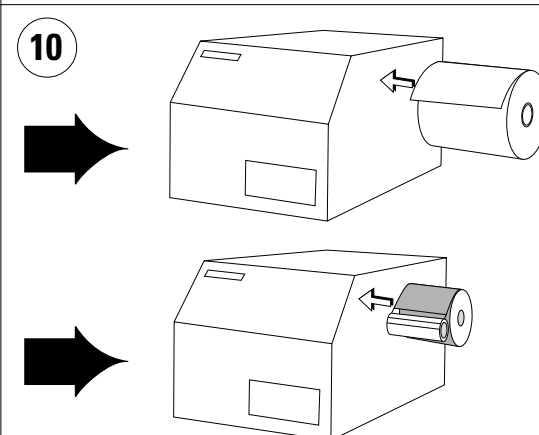

Allow the cleaned part to dry before loading the printer
with paper and thermal transfer ribbon.

EXTERNAL CLEANING

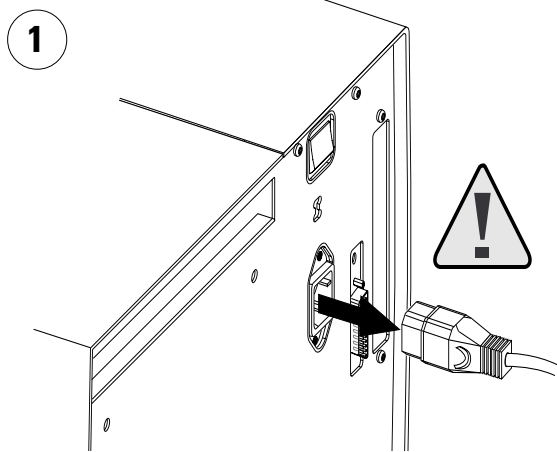

Always remove the power cord before cleaning!

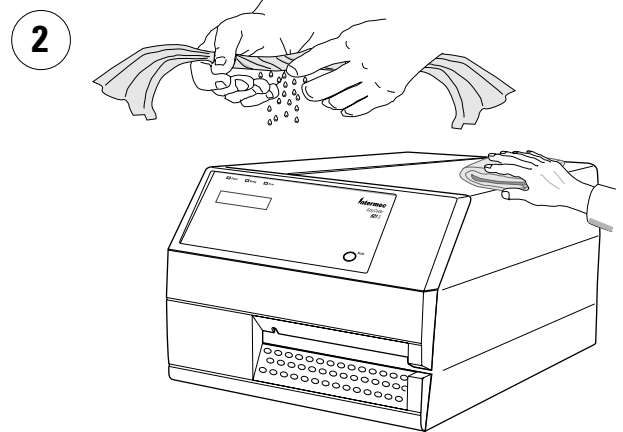

Wipe external surface with a soft cloth moistened with water and, if necessary, a mild detergent.

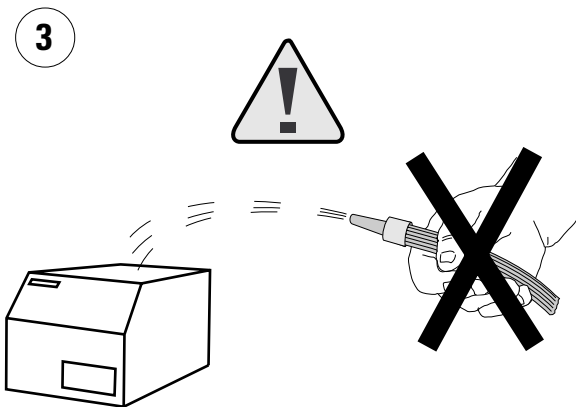

Never spray the printer. Protect the printer from water when cleaning the premises.

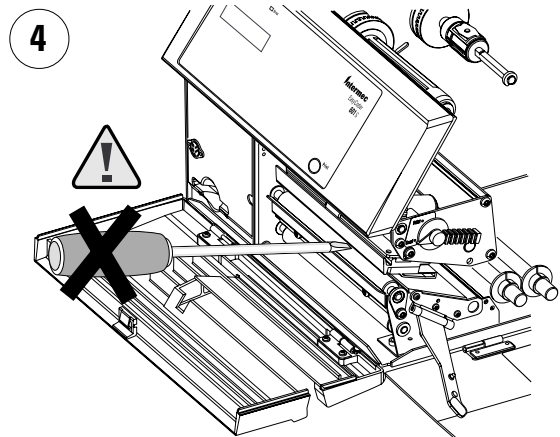

Never use any sharp tools for removing stuck labels. The printhead and the print roller are easily damaged.

PRINthead REPLACEMENT

The quick-mount thermal printhead is easy to replace:

- Turn off the printer.
- Open the front and right-hand doors.
- Lift the printhead and remove the paper and ribbon stocks.
- Turn the printhead lock handle counter-clockwise to *open* position, see illustration.
- Remove the printhead assy carefully as far as the cables allow.
- Remove the two printhead cables by pulling at the connectors.
- If you want to change the lateral position of the printhead, move the #T20 Torx screw to its alternative position.
- Connect the two cables to the printhead.
- Fit the replacement printhead assy back into the bracket so the guide screw fits into its slot and the rear end of the assy is held by the two lugs.
- Turn the locking handle clockwise to *locked* position.
- Load paper and transfer ribbon. Then lower the printhead.
- Turn on the power. At power-up, the printer will automatically reset itself to the characteristics of the printhead in regard of head resistance and density.
- Close the front and right-hand door and the printer is ready for operation.

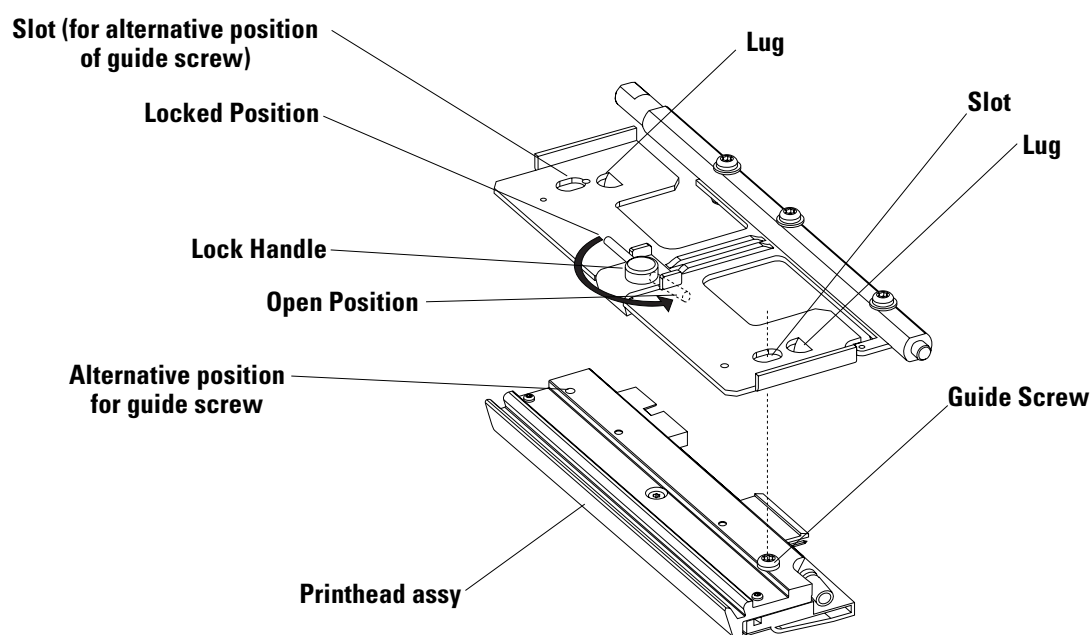

TROUBLE SHOOTING

The list below is intended to help the operator to correct possible printout troubles or flaws in printout quality, and to decide when assistance from the Service dept. of the nearest *Intermec* distributor is required. Note that most problems are due to operating errors or normal wear of the printhead.

Symptom	Possible Cause	Remedy	Refer to
Overall weak printout	Wrong Paper type setup Low Contrast setup Printhead pressure too low Worn printhead Wrong printhead voltage	Change setup Change setup Adjust both knobs Replace printhead Replace CPU board	Technical Manual Technical Manual Technical Manual User's Manual ☛ Call Service
Printout weaker on one side	Uneven printhead pressure	Adjust outer knob	Technical Manual
Weak spots	Foreign particles on paper/ribbon Paper/ribbon don't match Poor paper or ribbon quality Worn printhead Worn pressing roller	Clean Use other media Use other media Replace printhead Check/replace	n.a. Technical Manual Technical Manual User's Manual ☛ Call Service
Overall dark printout	Wrong Paper Type setup Too high Contrast setup value Printhead pressure too high Wrong printhead voltage	Change setup Change setup Adjust both knobs Replace CPU board	Technical Manual Technical Manual Technical Manual ☛ Call Service
Excessive bleeding	Wrong Paper Type setup Contrast setup value too high Printhead pressure too high Faulty energy control	Change setup Change setup Adjust both knobs Replace CPU board	Technical Manual Technical Manual Technical Manual ☛ Call Service
Transfer ribbon breaks	Ribbon fitted around label stop sensor Wrong Paper Type setup Ribbon unwind unit stuck Bad energy control	Reload ribbon Change setup Adjust Check CPU board	User's Manual Technical Manual ☛ Call Service ☛ Call Service
White parts at transfer printing	Transfer ribbon wrinkled	Adjust	See next paragraph
Transfer ribbon wrinkles	Incorrect paper guide ring adjustment Ribbon obstructed by printhead cable Too strong printhead pressure	Adjust Clear Adjust both knobs	User's Manual n.a. Technical Manual
Dark lines along paper web	Foreign objects on printhead	Clean printhead	User's Manual
White lines along paper web	Printhead dirty Missing dots on printhead	Clean printhead Replace printhead	User's Manual User's Manual
Large part of dot line missing	Wrong X-start or Width setup Failing printhead Failing strobe signal	Change setup Replace printhead Check CPU-board	Technical Manual User's Manual ☛ Call Service
Last part of label missing	Too small image buffer	Increase buffer	Technical Manual
Printout missing along inner edge	Bad paper alignment X-start setup value too low	Adjust Increase	User's Manual Technical Manual

NOTES
