



INSTRUCTION MANUAL

VCC-9784VA
VCC-9785VP

Color CCD Camera

THIS INSTALLATION SHOULD BE MADE BY A QUALIFIED SERVICE PERSON AND SHOULD CONFIRM TO ALL LOCAL CODES.

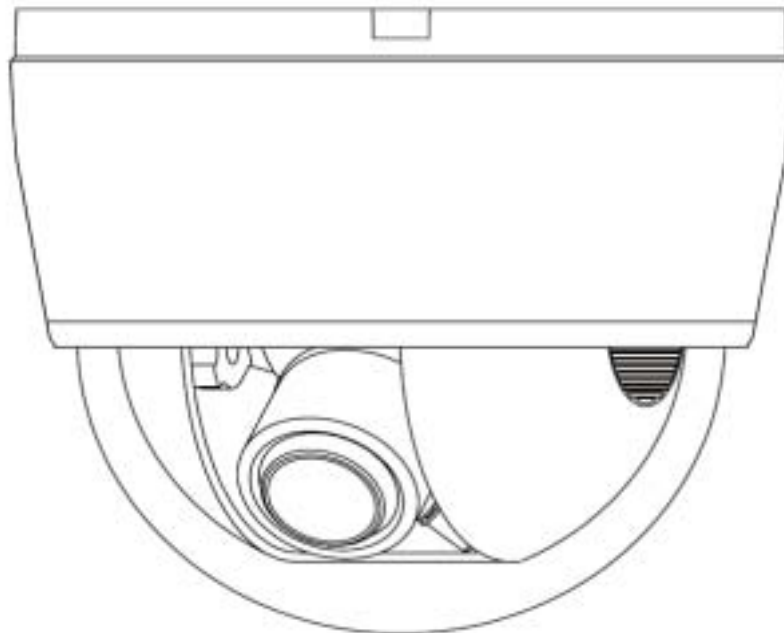

Please read this instruction manual carefully in order to ensure correct installation.

This manual covers 2 models. Any difference between the 2 models is indicated when necessary.

CONTENTS

■ PRECAUTION	2
■ NOTES OF USE	5
■ INSTALLATION	8
■ CCD CHARACTERISTIC	10
■ SPECIFICATION	11

PRECAUTION

Safety Guard



CAUTION: TO REDUCE THE RISK OF ELECTRIC SHOCK, DO NOT REMOVE COVER (OR BACK)
NO USER-SERVICEABLE PARTS INSIDE.
PREFER SERVING TO QUALIFIED SERVICE PERSONNEL.



The lightening flash with arrowhead symbol, within an equilateral triangle, is intended to alert the user to the presence of uninsulated "dangerous voltage" within the product's enclosure that may be of sufficient magnitude to constitute a risk of electric shock to persons.



The exclamation point within an equilateral triangle is intended to alert the user to the presence of important operating and maintenance (servicing) instructions in the literature accompanying the product.

WARNING: To reduce a risk of fire or electric shock, do not expose this appliance to rain or moisture.

■ For Russian Users



АЯ46

This product certified by official certification company which is authorized by Russian Federation.

ДЛЯ ПОЛЬЗОВАТЕЛЕЙ РОССИИ

Данная продукция сертифицирована официальным органом по сертификации Российской Федерации.

CAUTION: Changes or modifications not expressly approved by the manufacturer may void the user's authority to operate this equipment.

This equipment has been tested and found to comply with the limits for a Class B digital device, pursuant to Part 15 of the FCC Rules.

These limits are designed to provide reasonable protection against harmful interference in a residential installation. This equipment generates, uses, and can radiate radio frequency energy and, if not installed and used in accordance with the instructions, may cause harmful interference to radio communications.

However, there is no guarantee that interference will not occur in a particular installation. If this equipment does cause harmful interference to radio or television reception, which can be determined by turning the equipment off and on, the user is encouraged to try to correct the interference by one or more of the following measures:

- Reorient or relocate the receiving antenna.
- Increase the separation between the equipment and receiver.
- Connect the equipment into an outlet on a circuit different from that to which the receiver is connected.
- Consult the dealer or an experienced radio/TV technician for help.

For the customers In Canada

This class B digital apparatus complies with Canadian ICES-003.

For EU Users



Please note:

Your SANYO product is designed and manufactured with high quality materials and components which can be recycled and reused.

This symbol means that electrical and electronic equipment, at their end-of-life, should be disposed of separately from your household waste.

Please dispose of this equipment at your local community waste collection/recycling centre.

In the European Union there are separate collection systems for used electrical and electronic products.

Please help us to conserve the environment we live in!

This symbol mark and recycling system are applied only to EU countries and not applied to countries in other areas of the world.

SANYO FISHER Sales (Europe) GmbH

Stahlgruberring 4, D 81829 Munich, Germany

SANYO Electric Co., Ltd.

1-1, Sanyo-cho, Daito City, Osaka 574-8534, Japan

PRECAUTIONS

■ In case of a problem

Do not use the unit if smoke or a strange odor comes from the unit, or if it seems not to function correctly. Turn off the power immediately and disconnect the power cord, and then consult your dealer or an Authorized Sanyo Service Center.

■ Do not modify

Do not modify the cabinet and camera, as it may be dangerous and cause damage to the unit. For repairs, consult your dealer or an Authorized Sanyo Service Center.

■ Be careful when handling the unit

To prevent damage, do not drop the unit or subject it to strong shock or vibration.

■ Do not put objects inside the unit

Make sure that no metal objects or flammable substances get inside the unit. If used with a foreign object inside, it could cause a fire, a short-circuit or damage. Be careful to protect the unit from rain, sea water, etc. If water or liquid gets inside the unit, turn off the power immediately and disconnect the power cord, and then consult your dealer or an Authorized Sanyo Service Center.

■ Do not install this unit close to magnetic fields

The magnetic fields may result in unstable operation.

■ Protect from humidity and dust

To prevent damage, do not install the unit where there is greasy smoke or steam, where the humidity may get too high, or where there is a lot of dust.

■ Protect from high temperatures

Do not install close to stoves, or other heat sources, such as spotlights, etc., or where it could be subject to direct sunlight, as this could cause deformation, discoloration or damage.

■ Cleaning

* Dirt can be removed from the cabinet by wiping it with a soft cloth. To remove stains, wipe with a soft cloth moistened with a soft detergent solution and wrung dry, then dry by wiping with a soft cloth.

* Do not use benzene, thinner or other chemical products on cabinet, as this may cause deformation and paint peeling. Before using a chemical cloth, make sure to read all accompanying instructions. Make sure that no plastic or rubber material comes into contact with the cabinet for a long period of time, as this may cause damage or paint peeling.

NOTES OF USE

■ Power supply

This dome camera can operate on AC24V or DC12V. The camera automatically transfers the power. When connecting DC12V power source, check polarity before switching on as a precaution. Wrong connection may cause malfunction and/or damage to the video camera.

■ Operating or storage location

1. Avoid viewing very bright objects, such as light fittings for long extended periods.
2. Avoid operating or storing the unit in the following locations:
 - Extremely hot or cold places (operating temperature: -10°C to $+50^{\circ}\text{C}$).
 - Close to sources of strong magnetism.
 - Close to sources of powerful electromagnetic radiation, such as radio's or TV transmitters.
 - In humid and excessively dusty places.
 - Where exposed to high mechanical vibrations.
 - Close to fluorescent lamps or objects reflecting light.
 - Under unstable light sources (it may cause flickering).

■ Attached the dome casting

Attach the dome casing with the supplied screw fittings.

■ Transportation

When transporting the camera, repack in it's originally packing or in materials equal in quality.

■ Cleaning

1. The dome cover is the optical part. Use a soft dry cloth to remove any fingerprints or dust.
2. Use a blower to remove dust from the lens.
3. Clean the camera casing with a dry soft cloth. More stubborn stains, use a cloth dampened with a small quantity of neutral detergent, then wipe dry.
4. Do not use volatile solvents such as alcohol, benzene or thinners as they may damage the surface finishes

■ Transportation

Pattern attached for localisation camera on wall/ceiling.

NOTES OF USE

■ CONNECTION

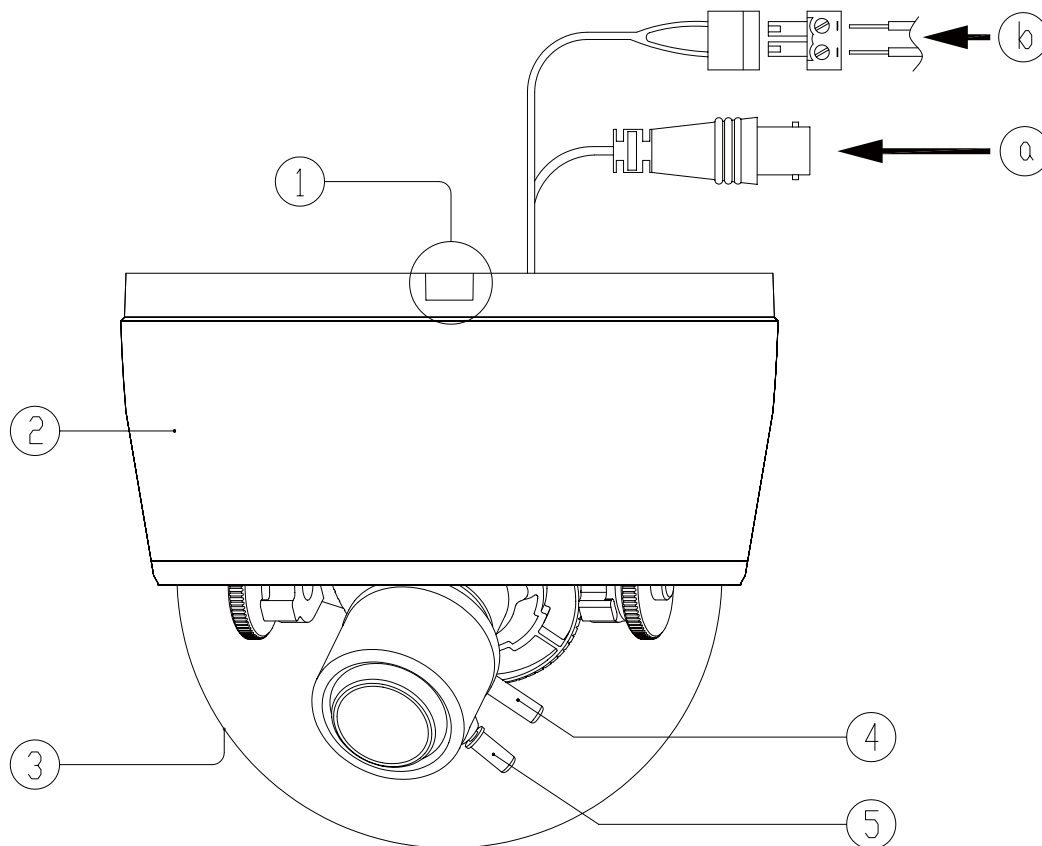

Fig-1

(a) Video out connector

(b) Power connector (DC12V/AC24V)

■ LOCATION AND FUNCTION OF PARTS

(1) Conduit holes (sealed):

Connect the wires through the hole. The conduit holes are on the side of the unit casing. The access hole is sealed at the factory. Pierce the hole as needed and connect the line.

(2) Unit Casing:

The unit casing is made of Acrylonitrile Butadiene Styrene(ABS) 30% + Polycarbonate (PC)70%.

(3) Dome Casing:

The dome cover is made of polycarbonate.

(4) Zoom lever:

Loosen lock screw anti-clockwise and adjust the camera's focal range as desired. Tighten lock screw clockwise after adjustment.

(5) Focus lever:

Loosen lock screw anti-clockwise and adjust focus for best picture sharpness. Tighten lock screw clockwise after adjustment.

NOTES OF USE

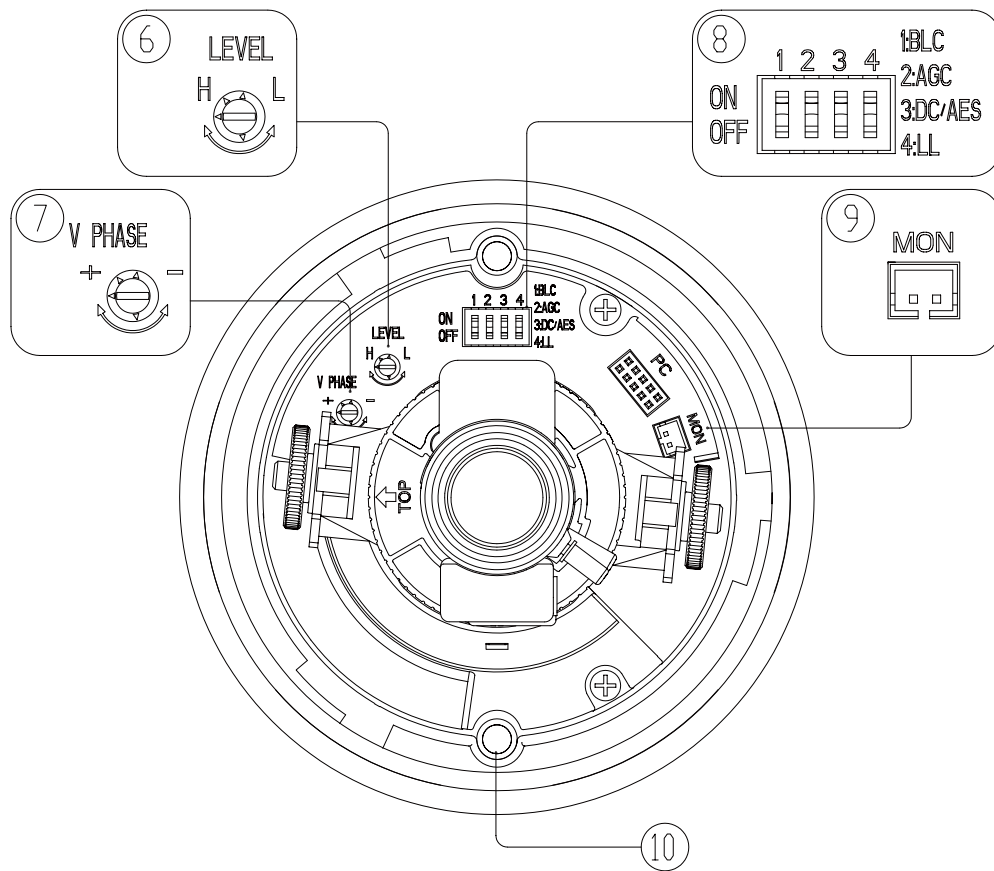

Fig-2

(6) LEVEL adjustment Pot (Iris Level):

Use it to compensate for the iris level. Turn toward L (low) to make the picture darker. Turn toward H (high) to make the picture brighter

(7) V Phase adjustment Pot (PAL model only):

Adjust the phase difference between this camera and other cameras when in line lock mode.

Note: Line lock function won't be active on VCC-9784VA.

(8) Mode setting DIP switch:

The following DIP switches are set to default position (shaded) as shipped from factory.

1: BLC (backlight compensation) ON/OFF switch

When switched on, the function adjusts exposure to compensate for situations where the subject is lit from behind.
(Initial setting: OFF)

2: AGC (automatic gain control) ON/OFF switch

The automatic gain function automatically adjusts picture in accordance with the brightness of subject. (Initial setting: ON)

NOTES OF USE

3: DC/AES Mode switch

- DC : Suitable to DC lens.
- AES: Suitable to AES lens.

4: LL switch (VCC-9785VP only)

Use this switch to set the camera synchronization mode internal or line lock. When the camera power is using DC12V power input, the camera is in the internal operation mode regardless of the switch setting.(Initial setting:LL)

(9) Monitor out:

Connect monitor to adjust the angle of view when installing the camera.

(10) Camera installation holes

Insert the screws (TP4*15) through these holes and tighten onto the wall or ceiling. Tighten the screws so that camera is firmly secured.

INSTALLATION

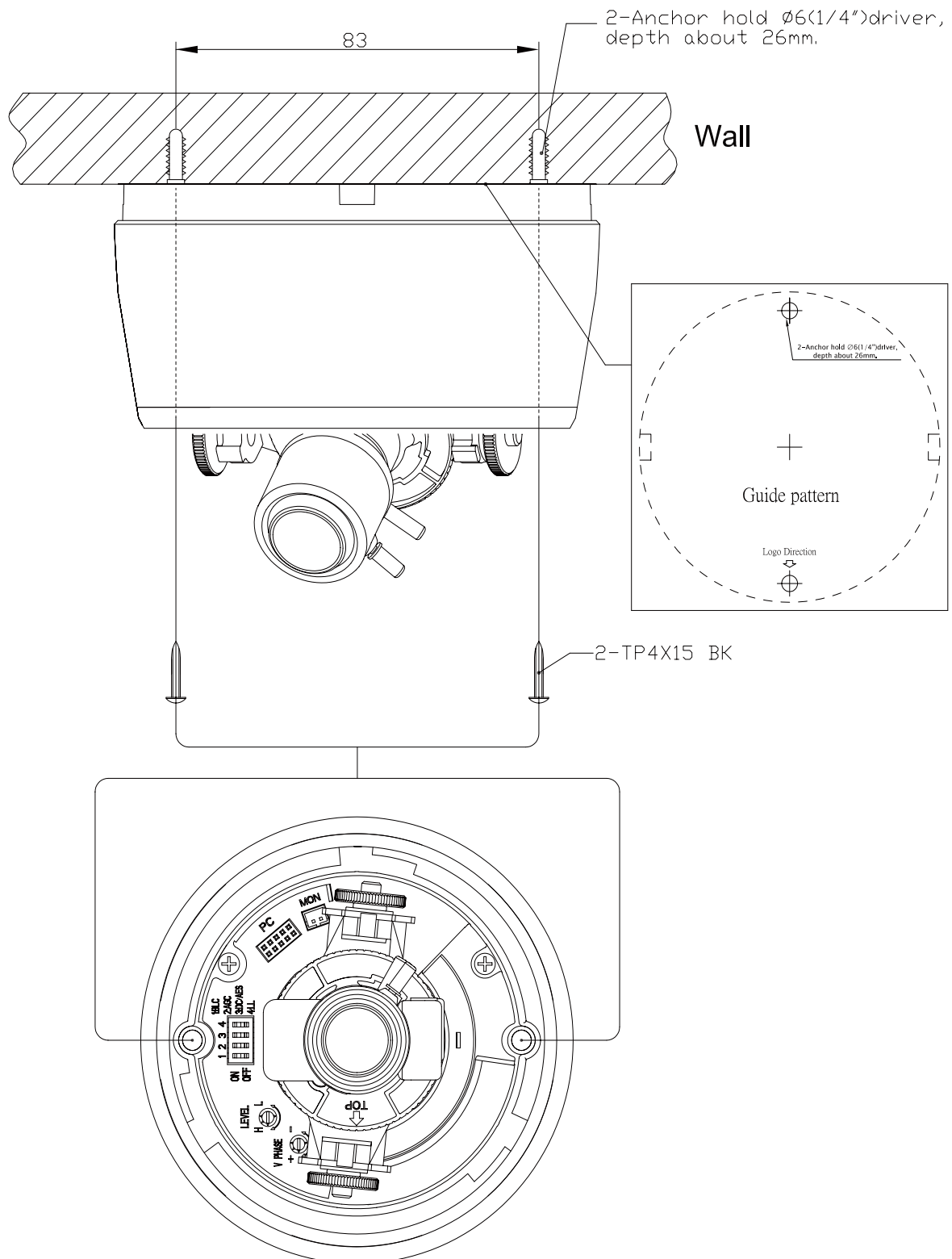

Fig-3

1. Stick the guide pattern on the wall/ceiling (See Fig-3 on page 6).
2. Drill two holes according the guide pattern then plug anchor hold driver into the holes.
3. Install the camera through these holes onto the wall with the provided screws (TP4*15)

INSTALLATION

■ ADJUSTMENT

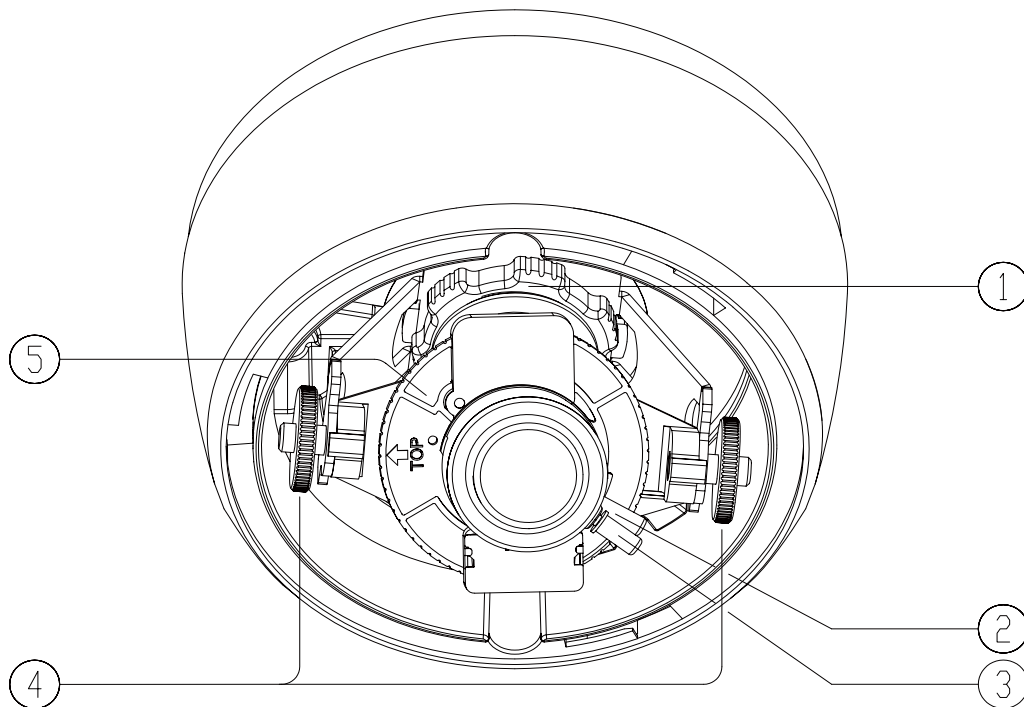

Fig-4

- | | | |
|--------------------|----------------|-----------------|
| (1) Lock ring | (2) Zoom lever | (3) Focus lever |
| (4) Tilt-adj screw | (5) Axis ring | |

Adjusting procedures:

1. Hold the lens so that it does not rotate. Loosen the lock ring (1) and Tilt-adj screw (4). Make sure to hold the lens when you turn the lock ring, otherwise the lens may rotate with the lock ring and the cable may become twisted.
2. Turn the lens and axis ring in the desired direction.
3. After determining the direction of the lens, lightly tighten the lock ring and Pan-adj screw.
4. Loosen the zoom lever (2) counterclockwise a little, rotate the zoom ring and determine the image view. Tighten after adjustment.
5. Loosen the focus lever (3) counterclockwise a little, adjust the focus for optimum picture sharpness. Tighten after adjustment.
6. Repeat steps 2 through 5 until the desired range and focus are set.

NOTE:

* If the camera movement is not smooth, loosen the lock ring all the way. The lock ring has an internal stopper and will not fall off.

* After adjusting the zoom and focus, make sure to lock the positions, otherwise the positions may move, for example, temperature changes or vibrations

CAUTION:

* Do not turn the lens more than 360°. Doing so may cause the internal cables to twist and cause damage to wiring loom.

INSTALLATION

■ ATTACH THE DOME COVER

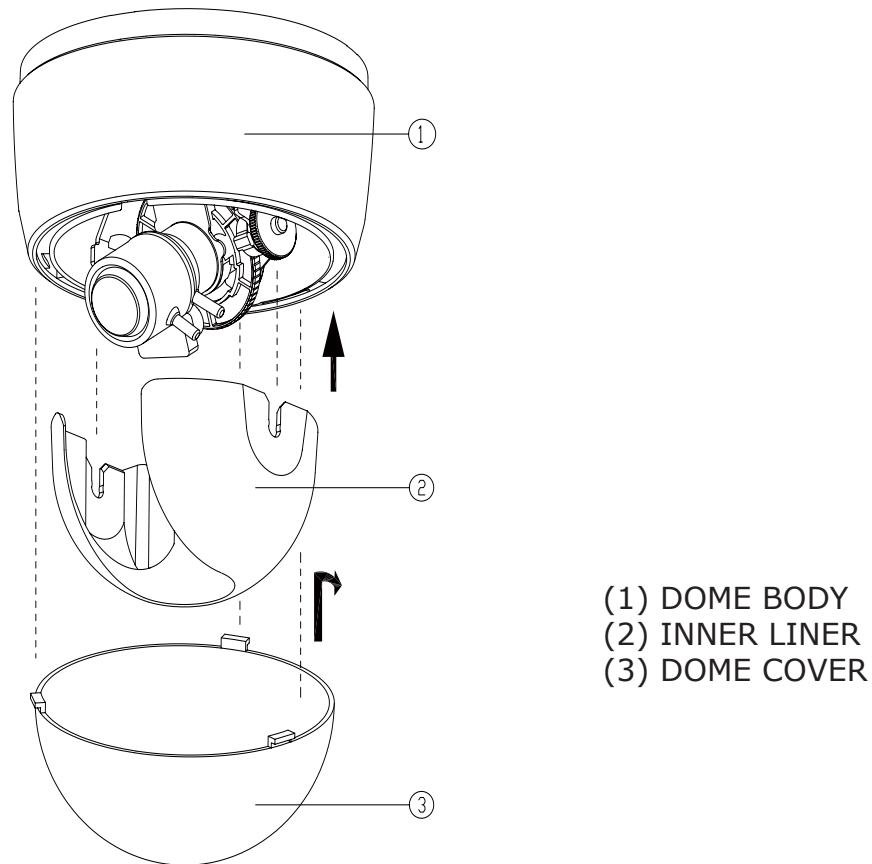

Fig-5

1. Match the screws on the unit casing casing to the screw holes (3 locations) on the unit casing
2. Fix the inner liner into the pan-adj screw.
3. Holding the dome casing to maintain the matched positions. Tighten the three screws with the screwdriver, Lock the dome casing to the unit casing.

CCD CHARACTERISTIC

The following are characteristics that may be observed when using a CCD camera. These are inherent characteristics of the CCD camera and do not stem from any fault within the camera itself.

Vertical smear: This phenomenon occurs when viewing a very bright object.

Patterned noise: This is a fixed pattern which may appear over the entire monitor screen.

Jagged picture: When viewing stripes, straight lines, or similar patterns, the image on the screen may appear jagged.

SPECIFICATION

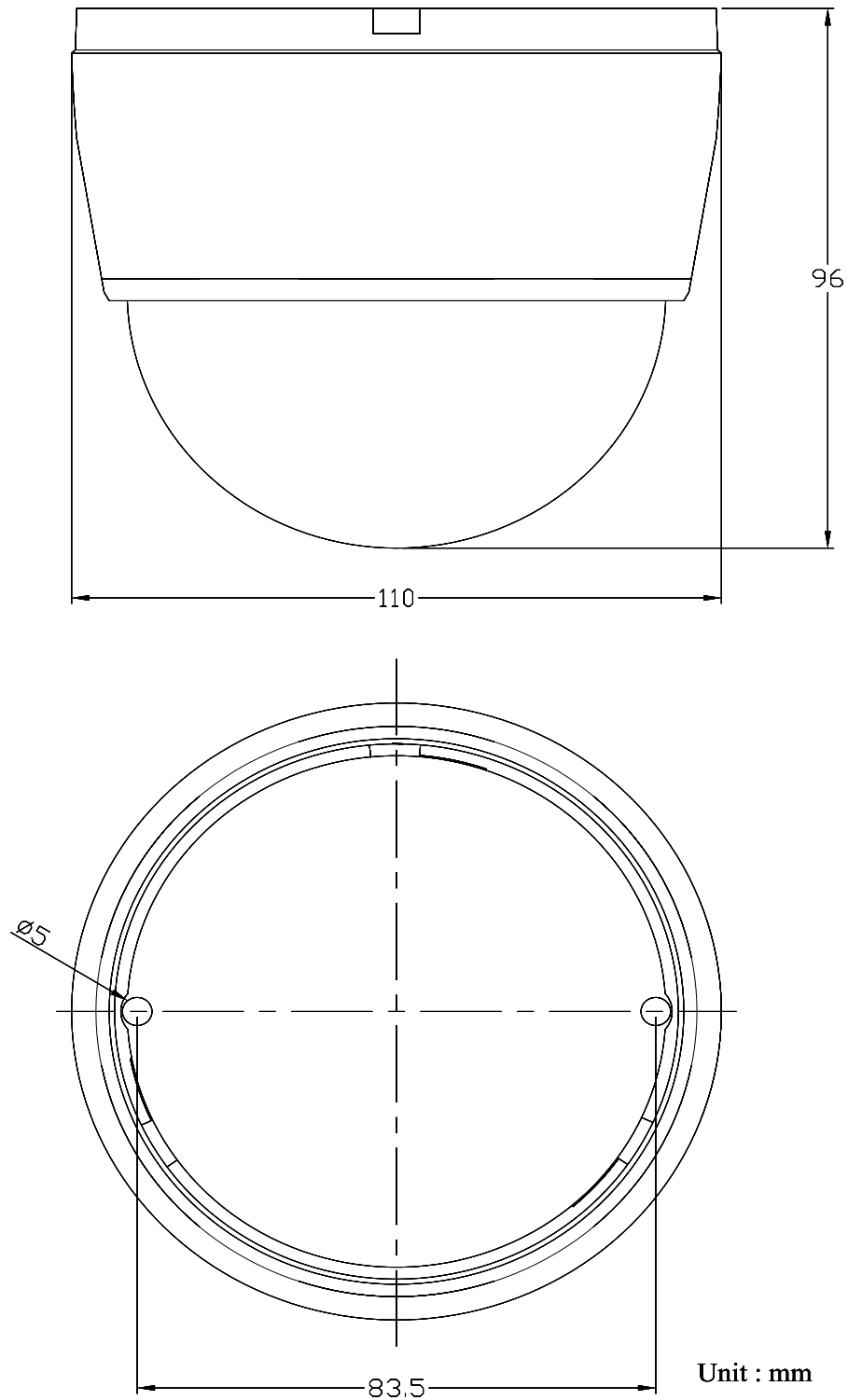

Fig-6

SPECIFICATION

		VCC-9785VP	VCC-9784VA
Scanning system		PAL standard 625 lines 50fields/sec.	NTSC standard 525 lines 60fields/sec.
Image sensor		1/3" Interlace CCD sensor	
Number of effective pixels		752(H) x 582(V)	768(H) x 494(V)
Horizontal resolution		540 TV lines (Typical)	
Lens		Buit-in varifocal lens, f=2.8 to 10 mm (F1.3)	
Panning range		±180°	
Tilting range		±83°	
Rotation		±180°	
Sysnchronizing system		Internal / linelock	Internal
Minimum illumination	20IRE	0.16 lux (F1.3, AGC on)	
	50IRE	0.40 lux (F1.3, AGC on)	
Video S/N ratio		More than 48dB (AGC off)	
Backlight compensation		ON/ OFF	
Electric Shutter		1/50 to 1/10000	
White balance		Auto	
Auto iris drive		DC	
AGC gain		ON/ OFF	
Flicker less		NO	Flickless shutter speed 1/100sec
Gamma correction		0.45	
Video/ Monitor output		1.0V p-p (75ohm, composite)	
Operating Environment	Temperature	-10°C to +50°C (14°F to 122°F)	
	Humidity	90% RH	
Power supply		12VDC+/-10%, 24VAC+/-10%, 50/60Hz	
Power consumption		3.5W	
Dimensions (Φ x H)		110mm x 96mm (4.33"x 3.78")	
Weight		Approx. 300g (105.82oz)	
Accessories		Guide Pattern x 1 Screw P 4*15TP-1 BK x 2 Monitor out cable x 1 White Plastice Screw Anchor 1/4 x 2 User Manual x 1	

The contents are subjects to be changed without notice.



Sanyo Electric Co., Ltd.
Printed in Taiwan