

Taste it, Love it!



USER MANUAL

Lily

Welcome to the *Lily Electronic Cigarette*

Thank you for purchasing this *Lily Electronic Cigarette* and Welcome to the Future.

The *Lily Electronic Cigarette* is the result of years of Research and Development in both technology and design.

First of all, please ensure that your Innokin *Lily* is a Real Innokin product.

To do this:

- 1) Find your Lily's Unique Authorization number which is included on the packaging.
- 2) Visit the Official Innokin website at <http://www.Innokin.com>.
- 3) Enter the Authentication number in the Authentication field.
- 4) Verify your Lily is a Real Innokin.

If you have any questions or suggestions we invite you to please write to us at Lily@innokin.com. We will be happy to hear from you.



Prepare yourself for the Beautiful Intelligence of the Innokin *Lily*.

WARNING:

Please read this section carefully to ensure you receive maximum benefits from your Lily and enjoy vaping with it in the most safe and effective ways possible.

1. This Advanced Personal Vaporizer may be used with e-liquids that contain nicotine. **Please check with your e-liquid provider.** This product is only intended for use by adults of legal smoking age (18+) and should not be used by children, women who are pregnant or breastfeeding, or persons with or at risk of heart disease, high blood pressure, diabetes or taking medicine for depression or asthma, or who otherwise may be sensitive to nicotine. Nicotine is addictive and habit forming, and it is very toxic by inhalation, in contact with the skin or eyes, or if swallowed. Ingestion of the non-vaporized concentrated e-liquid ingredients can be poisonous. Keep away from children and pets.
2. This Advanced Personal Vaporizer may be used with e-liquids that contain nicotine, a chemical known to the State of California to cause birth defects or other reproductive harm. **Please check with your e-liquid provider.** (For products sold in California.)

3. This Advanced Personal Vaporizer is only designed to be used with high quality e-liquid. **Please check with your e-liquid provider.** This device is not intended for use with loose tobacco leaf or herbal substances.
4. This Advanced Personal Vaporizer has not been evaluated by the Food and Drug Administration and is not intended to treat, mitigate, prevent or cure any disease or condition. This product is not intended for use as a smoking cessation device.
5. This product is intended for use with the charger provided with the unit. We recommend you always use a high quality 5V 500mA USB wall charger (CE/UL Certified). Use of unauthorized chargers may lead to overheating and possible burning of items in contact with the unit. Innokin Technology is not responsible for battery and charger explosions, fires or malfunctions due to the use of a low-quality charger. This product does not come included with any wall charger
6. This Advanced Personal Vaporizer does not come included with car charger or car charger adapter. This device is not designed for use with a car charger. Use of unauthorized chargers may lead to overheating and possible burning of items in contact with the unit.
7. All empty clearomizers must be disposed of properly and out the reach of children and pets.

- 
- 
- 
8. This Advanced Personal Vaporizer includes small parts such as the mouth piece. Always keep any small parts out of reach of children and pets to prevent swallowing or other harm.
 9. Obey local laws or regulations regarding Electronic Cigarettes when vaping. If you are in an area where there are any bans or potential dangers, please do not use your Advanced Personal Vaporizer.
 10. Do not misuse, mishandle or store your Advanced Personal Vaporizer improperly. Even though it is made of high quality stainless steel it may become damaged when dropped or otherwise mishandled.
 11. Do not drop, throw, or mishandle your Advanced Personal Vaporizer as the outer shell or inner components may become damaged. If the shell of the device becomes damaged or the structural integrity of the battery becomes compromised, discontinue use immediately and contact your Authorized Innokin Technology Vendor.
 12. In order to prolong the operation of your Advanced Personal Vaporizer, please do not place or store in excessively hot or cold environments.
 13. Your Advanced Personal Vaporizer is not waterproof. Keep it dry at all times. Do not submerge this device or expose it to moisture.
 14. Keep your Advanced Personal Vaporizer away from sources of excessive heat or cold as damage may occur.
 15. Do not attempt to repair the unit by yourself as damage or personal injury may occur.

16. In order to guarantee the normal functioning of your Advanced Personal Vaporizer, and maximize the pleasure of vaping, we strongly advise that you charge the battery when the power level drops below 10 percent
17. Do not leave the battery depleted for long periods of time between recharging or the battery capacity may be decreased.
18. Do not leave this device unattended while charging.
19. If the device becomes excessively hot, discontinue use immediately and contact your Authorized Innokin Technology Vendor.
20. If the device will not power off, discontinue use immediately and contact your Authorized Innokin Technology Vendor.
21. If the device functions in a way which is not stated in the manual contact your Authorized Innokin Technology Vendor.
22. As this device has an internal Lithium Ion Battery, the lifespan of the product will be limited.

WARNING:

It is very important that all empty Vacap cartridges be disposed of properly and out of the reach of children and pets.

The Primary Features of the Lily Electronic Cigarette:

Battery Level Indicator:

The Lily Electronic Cigarette battery capacity is displayed via green, yellow and red LED lights.

Green = Fully Charged

Yellow = Half Power.

Red = Low Power. Please Charge.

Large battery capacity:

The Lily Electronic Cigarette has a built-in 350 mAh polymer Li-Ion rechargeable battery.

ON/OFF battery switch:

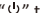
Please press the power button “” three times in rapid succession to turn on the Lily Electronic Cigarette. Once the Lily is On please hold down the power button to activate the atomizer and vape. When the Lily is not in use please press the power button “” three times in succession to turn off the Lily Electronic Cigarette. Always power off the Lily Electronic Cigarette when it is not going to be used, or when it is going to be stored in a pocket, bag or purse.

SAFETY:

10 second cutoff:

If the activation button is held for 10 seconds or longer, the Lily Electronic Cigarette will stop firing until the button is released and pressed again.

Short Circuit/Atomizer Protection:

Short Circuit/Atomizer Protection protects the Lily Electronic Cigarette against shorted atomizers, and will stop the unit from functioning in unsafe conditions.

Over-Discharge Protection:

The Lily Electronic Cigarette monitors the battery voltage and will automatically power off when the battery is discharged.

OPERATION GUIDE

To POWER ON the Lily:

Pressing the power button “” three times in rapid succession will power on the Lily Electronic Cigarette. The main LED light will blink from red to yellow to green, after which the Lily Electronic

enter standby mode. The final color of the LED will indicate the current power level.
When the Lily Electronic Cigarette has been powered on, hold the button down to activate the unit.

Low Voltage Warning

The Red LED will keep blinking for eight seconds when battery capacity is lower than 3.3V and the Lily Electronic Cigarette will automatically power off.

Battery Capacity Display

The main LED light will display green to indicate full battery charge, yellow to indicate half capacity and red to indicate immediate charging is required.

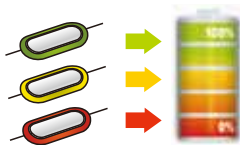

To POWER OFF the Lily:

Press the “” button three times in succession to power off your Lily Electronic Cigarette.

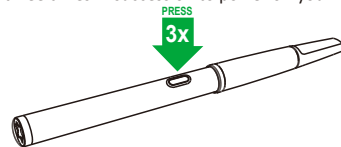

Short Circuit

The Red LED light will stay lit for five seconds if a load short circuit is detected, after which no vapor will be produced. Please check the device carefully to determine the cause of the short circuit.

Lily Electronic Cigarette Atomizer & Vacap Cartridges (Vacap Cartridge System) V.C.S.

The internal components of the Lily combine an atomizer (the heating element), a Vacap juice cartridge and an internal wicking system. The clear cartridge allows for the remaining juice level to be clearly seen. Each Vacap cartridge is initially empty and is disposable after use. When using your Lily Electronic Cigarette for the first time always use a new empty Vacap cartridge.

Vacap Cartridge

Your Lily Electronic Cigarette includes four packaged atomizers with four empty Vacap cartridges. To fill the Vacap with your favorite ejuice:

- 1) Detach the Vacap from the atomizer.
- 2) Open the Vacap by holding the top and bottom and pulling firmly to separate the two parts.
- 3) Fill the bottom section of the Vacap with your favorite ejuice*. **Do not overfill.**
If the e-juice comes into contact with skin please wash immediately with soap and water. If the e-juice is ingested or comes into contact with nose or eyes, please seek immediate professional medical attention.
- 4) Place the top of the Vacap into the bottom of the Vacap and press firmly to close and connect the two parts. Ensure that the Vacap is firmly sealed before using.

WARNING:

Ejuice may contain Nicotine. Nicotine is a poisonous chemical and should never be ingested or come into contact with the skin or eyes. Please be very cautious of using and storing the Lily Vacaps. The Vacaps **must** be stored out of the reach of children and pets.

All empty Lily Vacaps **must** also be disposed of properly and out the reach of children and pets.

If a child or pet ingests a filled Lily Vapecap, or any product which contains Nicotine: **you must seek immediate professional medical attention.**

*Ejuice sold separately.

To assemble your Lily Electronic Cigarette:

- 1) Unscrew and remove the Top Section and the Mouthpiece.

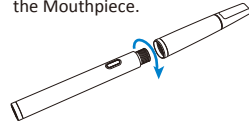

- 3) Carefully re-attach the mouth piece to the battery and turn it until it is firmly in place.

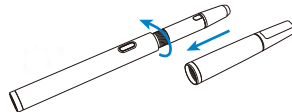

- 2) Correctly place the new, filled Vacap cartridge into the atomizer (see previous section for Vacap filling instructions). Attach the atomizer to the battery and turn until it is firmly in place. Do not over tighten the atomizer or damage may

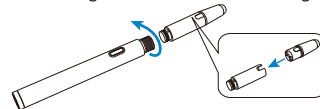

Please wait 2-3 seconds to allow for the atomizer wicks to absorb the e-juice from the Vacap. Congratulations! Your Lily Electronic Cigarette is now ready to be vaped and enjoyed.

To Charge The Lily Electronic Cigarette



To Charge the Lily Electronic Cigarette battery, gently screw the battery into the USB Charger and plug the USB Cable into a USB wall charger or computer. The Lily will begin charging.

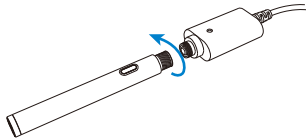

The main Lily LED power light will blink from red to yellow to green, after which the Lily Electronic Cigarette will enter standby mode. The final LED color will indicate the current power level. The main LED light will display green to indicate a full battery charge, yellow to indicate power is at half capacity and red to indicate immediate charging is required.

Red LED light = battery voltage is lower than 3.6V

Yellow LED light = battery voltage is around 3.6V-3.75V

Green LED light = battery voltage is higher than 3.75V

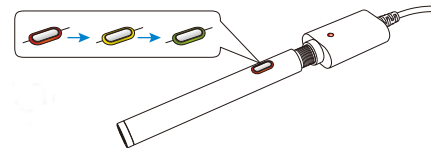

PLEASE NOTE:

The Red LED will blink for eight seconds when battery capacity is lower than 3.3V and the Lily Electronic Cigarette will automatically power off.

If a load short circuit is detected the Red LED light will stay lit for five seconds, after which no vapor will be produced. If the RED light remains lit for more than five seconds, and your device is within the 3 month warranty period, please contact your official vendor.

When the Lily Electronic Cigarette is fully charged the LED light will turn green and power off.

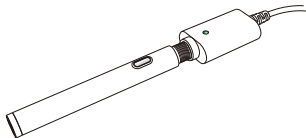

Technical Specifications:

Standby current: 10uA max

Maximum output voltage: 3.5V (unloaded)

Clearomizer Resistance: 1.5 ohm (minimum)

Battery: Built-in 350 mAh polymer Li-Ion rechargeable battery.

Charging: 4.2V 350 mA

Short Circuit Protection: 0.6 +/-0.2 ohm

WARRANTY INFORMATION

Innokin provides a three month after sales service warranty to all of our authorized vendors.

Please consult your Authorized Innokin Vendor for more information and terms of service.

Innokin's warranty does not apply to products purchased through third-party vendors.