



**VELOCE**

# User Manual

Ultralight Folding Wheelchairs



**MOTION**  
**COMPOSITES**

# Maintenance manual & warranty information

**Dealer:** This manual must be given to the user of the VELOCE wheelchair before its first use.

**User:** Prior to using the VELOCE wheelchair, carefully read this manual and keep it for future reference.

For more information about this product, its parts/accessories and the services provided, please visit : [www.motioncomposites.com](http://www.motioncomposites.com)

## VELOCE

Thank you for selecting the VELOCE wheelchair. Please do not hesitate to send us your feedback or questions regarding this product's reliability, safety, usability, as well as any repair/maintenance services offered by an authorized Motion Composites dealer.

### Made in Canada

with Canadian and imported parts

### Contact information:

**Motion Composites Inc.**  
519 J-Oswald Forest, suite 101  
Saint-Roch-de-l'Achigan, Quebec  
J0K 3H0 Canada  
Phone: 1-866-650-6555  
Fax: (450) 588-0200  
[support@motioncomposites.com](mailto:support@motioncomposites.com)  
[www.motioncomposites.com](http://www.motioncomposites.com)

[www.facebook.com/heliowheelchair](http://www.facebook.com/heliowheelchair)  
[www.twitter.com/mcwheelchairs](http://www.twitter.com/mcwheelchairs)

### Important information

If you have any questions about safety, adjustments, accessories, use, or maintenance, please contact your authorized Motion Composites dealer.

Please record the following information for future reference:

Date of purchase \_\_\_\_\_

Serial Number \_\_\_\_\_

Supplier \_\_\_\_\_

Address \_\_\_\_\_

Telephone \_\_\_\_\_



### The lightest folding wheelchair in the world.

The VELOCE is the most technologically advanced wheelchair for active users. It redefines what a wheelchair should be by offering unrivaled lightness, rigidity and responsiveness while keeping the important advantage of a compact folding system. With a total weight starting at 8.0 kg and a transport weight of only 5.1 kg, it feels like a Formula 1 but fits in the trunk of a Mini.

### Adjustability without the weight.

The VELOCE is completely adjustable for a perfect fit. You can easily adjust front and rear seat-to-floor heights, seat angle, center of gravity and frame angle. All of the options offered on our line of wheelchairs are also compatible with the Veloce for true customization.

### Get more mileage out of your energy.

Every little detail of the VELOCE was specifically optimized to help you go farther. Featuring an entirely symmetrical carbon fiber crossbrace, oval shaped tubes and oversized pivot axles, our unique Ultrarigid Folding System (UFS) maximizes frame rigidity and responsiveness.

### Headturning design.

With its spirited Mantis Frame, signature triangular tube shape and full carbon fiber finish with color highlights, the Veloce is truly a feast for the senses. It also comes standard with one-sided forks for an added sense of flair.



European  
authorized  
representative :

Advena Ltd  
Pure Offices  
Plato Close  
Warwick  
CV34 6WE  
United Kingdoms



## Introducing the Mantis Frame.

It's an entirely new type of wheelchair construction inspired by the rigidity of box frames and the look and lightness of cantilever frames. The result is a closed frame in the back to fit our UFS (Ultrarigid Folding System) and a minimalist front end offering full configuration possibilities and an outstanding look.

## High-Modulus Carbon Fiber : The ultimate sophistication.

We use the same high quality material used in F1 and aerospace to design and build the lightest wheelchairs on earth. Our T700 high-modulus carbon fiber is unrivaled when it comes to strength and rigidity. This means our frame is not only ultra light, but also exceptionally strong.



**Mantis Frame** - Fusion of a boxed frame in the back for enhanced crossbrace rigidity and cantilever frame in the front for a minimalist look



**High-Modulus Carbon T700** - The lightest and most rigid material available, also renowned for its vibration dampening properties.



**Rigid Unibody Frame** - A unibody frame is much stronger and needs less maintenance than a standard two-part frame. It also reduces weight while maximizing propulsion efficiency.



**Symmetrical Molded Crossbrace 3D** - Entirely symmetrical carbon fiber crossbrace for reduced torsion and a better distribution of forces throughout the frame.



**Ultrarigid Folding System** - Extremely precise tolerances and oversized pivot axles for best-in-class propulsion efficiency.



**Forged Vertical Axleplate +** - Offers the most precise rear wheel adjustability of the industry. The vertical mounting maximizes rigidity and responsiveness.



**V Shaped Stem** - Stylised stem that offers more than looks. It provides precise seat-to-floor and angle adjustments of the front wheel.



**Newton Accessories** - The whole range of newton accessories are designed to be light and offer improved functionalities.



## Table of contents

<b>WELCOME TO VELOCE</b>	<b>2</b>	<b>10</b>	<b>ADJUSTMENTS AND MAINTENANCE OF YOUR VELOCE</b>	<b>12</b>
<b>CONTACTING US</b>		10.1	SERVICE	
<b>IMPORTANT INFORMATION</b>		10.2	REPLACEMENT PARTS	
			ORDERING INFORMATION:	
<b>TABLE OF CONTENTS</b>	<b>4</b>	10.3	TOOLS NEEDED	
		10.4	GENERAL MAINTENANCE	
3.	<b>PRODUCT OVERVIEW</b>	10.4.1	TIRE PRESSURE	
	PARTS LIST	10.5	BACKREST	
		10.5.1	REMOVING/INSTALLING THE BACK CANES	
4.	<b>BEFORE USE</b>	10.5.2	ADJUSTING THE BACK ANGLE	
4.1	GENERAL WARNING	10.5.3	REMOVING/INSTALLING THE SEAT BELT	
4.2	SYMBOLS	10.5.4	ADJUSTING THE BACKREST HEIGHT	13
			SEAT	
5.	<b>TECHNICAL SPECIFICATIONS</b>	10.5.5	INSTALLING/REMOVING STANDARD SEAT UPHOLSTERY	
5.1	STRUCTURE	10.6	ARMRESTS	
5.2	DIMENSIONS	10.6.1	INSTALLING FLIP-BACK ARMRESTS	
5.3	ADJUSTABILITY	10.6.2	ADJUSTING THE HEIGHT OF FLIP-BACK ARMRESTS	
		10.6.3	INSTALLING REMOVABLE T-ARMRESTS AND RIGID SIDEGUARD	
6.	<b>SAFETY</b>	10.6.4	REPLACING ARMRESTS PAD	14
6.1	PERIODIC CHECKLIST	10.6.5	INSTALLING THE SWING-AWAY ARMREST RECEIVER	
6.2	WEIGHT LIMITATION	10.6.6	ADJUSTING SWING-AWAY ARMREST HEIGHT	
6.3	WEIGHT TRAINING AND SPORTING ACTIVITIES	10.7	FRONT RIGGINGS	
		10.7.1	ADJUSTING FOOTREST LENGTH	
7.	<b>TUTORIAL</b>	10.8	SEAT	15
		10.8.1	REPLACING SEAT UPHOLSTERY	
8.	<b>RIDING YOUR VELOCE</b>	10.9	SEAT-TO-FLOOR HEIGHT	
8.1.1	TO REDUCE THE RISK OF ACCIDENT	10.9.1	CHANGING THE FRONT SEAT-TO-FLOOR HEIGHT	
8.1.2	ENVIRONMENTAL CONDITIONS	10.9.2	CHANGING REAR SEAT-TO-FLOOR HEIGHT	
8.1.3	CAREGIVERS	10.9.3	CHANGING FRONT & REAR SEAT-TO-FLOOR HEIGHT	
8.2	RIDING YOUR WHEELCHAIR	10.10	FRONT CASTORS, FORKS AND FORK STEM ASSEMBLIES	
8.2.1	BALANCE POINT	10.10.1	REMOVING/INSTALLING/REPOSITIONING THE FRONT WHEELS	
8.2.2	WHEELIES	10.10.2	REMOVING/INSTALLING THE CASTER HOUSING	
8.2.3	TRANSFERRING	10.10.3	REMOVING/INSTALLING THE STEM BOLT ASSEMBLY	16
8.2.4	GETTING DRESSED	10.10.4	ADJUSTING THE CASTOR HOUSING ANGLE	
8.2.5	REACHING/LEANING/BENDING	10.11	REAR WHEELS	
8.2.6	MOVING BACKWARDS	10.11.1	ADJUSTING QUICK-RELEASE AXLES	
8.2.7	RAMPS, SLOPES & SIDE HILLS	10.11.2	REPLACING/ADJUSTING HAND RIMS	17
8.2.8	OBSTACLES		USE A PLASTIC TIRE REMOVAL TOOL TO TAKE OFF THE TIRE.	
8.2.9	CURBS AND STEPS	10.11.3	ADJUSTING THE REAR AXLE HEIGHT	
8.2.10	MOVING WITH ASSISTANCE	10.11.4	ADJUSTING REAR WHEEL SPACING	
8.2.11	MOVING WITHOUT ASSISTANCE	10.11.5	ADJUSTING THE TOE-IN/TOE-OUT WITH REAR WHEEL CAMBER.	
8.2.12	STAIRS	10.12	WHEEL LOCKS	
8.2.13	ESCALATORS	10.12.1	REPLACING/ADJUSTING THE WHEEL LOCKS	
		10.13	EXTENSION BRAKES	18
9.	<b>HOW TO USE YOUR VELOCE</b>	10.13.1	REPLACING/ADJUSTING THE BRAKE EXTENSION	
9.1	FOLDING & UNFOLDING	10.14	ANTI-TIPPERS	
9.1.1	FOLDING	10.14.1	ADJUSTING THE HEIGHT OF THE ANTI-TIPPERS	
9.1.2	UNFOLDING	10.15.	HEADREST KIT AND HEADREST SUPPORT	
9.2	WHEEL LOCKS	10.15.1	INSTALLING A HEADREST SUPPORT	
9.4	FOOTREST	10.15.2	INSTALLING HEADREST KIT	
9.5	ARMRESTS	10.16	AMPUTEE EXTENSION PLATE	19
9.5.1	FLIP-BACK ARMRESTS			
9.5.2	REMOVABLE T ARMRESTS	11	<b>USING A PARATRANSIT SERVICE</b>	19
9.5.3	SWING-AWAY ARMRESTS			
9.5	SEAT BELTS	12	<b>MOTION COMPOSITES LIMITED WARRANTY</b>	20
9.5.1	AUTO BUCKLE AND AIRCRAFT BUCKLE SEATBELTS	13	<b>NOTES</b>	
9.5.2	VELCRO™ BELT			
9.6	ANTI-TIPPER	14	<b>SAFETY INSPECTION CHECKLIST</b>	21
9.7	REAR WHEELS	15	<b>PARTICULAR DAMAGES</b>	
9.8	SEAT SLINGS	16	<b>DECLARATION OF CONFORMITY</b>	22
		I.	<b>APPENDIX</b>	23





### 3. Product Overview

#### Parts List

- 1 Back Cane
- 2 Mudguard
- 3 Rear wheel
- 4 Wheel brake
- 5 Seat rail
- 6 Footplate
- 7 Caster
- 8 Fork
- 9 Caster Housing
- 10 Crossbrace
- 11 Back wheel axle plate

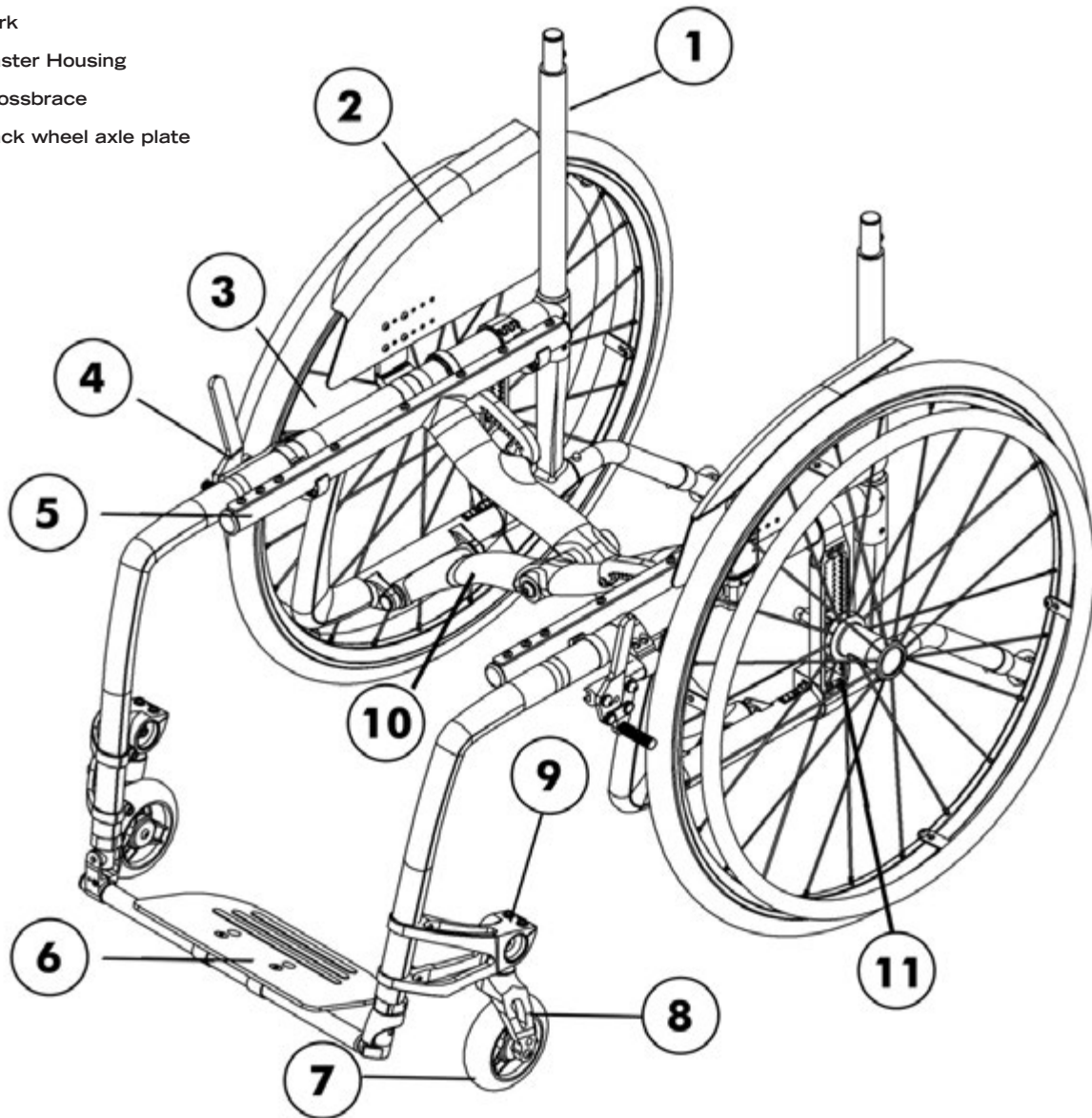

## 4. Before use

### 4.1 General Warning

Your VELOCE wheelchair has been designed by professionals with proper use of aluminium in mind. DO NOT TRY TO MODIFY THE FRAME BY ANY MEANS. THE FRAME MAY BE SEVERELY DAMAGED IN THE EVENT OF DRILLING AND GRINDING, THUS VOIDING THE WARRANTY. Only use Motion Composites approved and designed clamps and accessories on your VELOCE wheelchair.

#### 4.1.1 Note to users:

Carefully read the instructions in this manual before using or servicing your wheelchair. If you have any questions or difficulties understanding the following instructions, please contact a qualified technician; you may also wish to contact a Motion Composites technician by phone or email (see contact information on previous page).

#### 4.1.2 Note to dealers & qualified technicians

Read this manual before servicing, repairing, operating or adjusting the wheelchair. If you have any questions or difficulties understanding the following instructions, please contact a qualified technician; you may also wish to contact a Motion Composites technician by phone or email (see contact information on previous page).

### 4.2 Symbols

The following symbols are used throughout this manual. Please familiarize yourself with their meaning.



The warning sign indicates important information to prevent injuries and property damage.



Useful information for the user

### 4.3 Label Locations

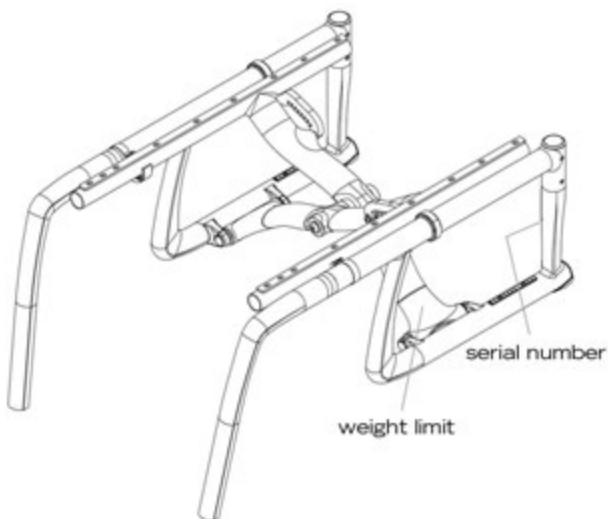

Do not remove or alter any labels on the wheelchair. If the label is damaged, replace it with a new one.



Initial setup of your VELOCE wheelchair must be done by a qualified technician.



The latest version of this manual can be found on our website at [motioncomposites.com](http://motioncomposites.com)



Regular maintenance of your VELOCE will extend the life of the wheelchair. Take your wheelchair to a qualified technician every year for inspection and servicing.



Do not use air or electric tool, tightening should be done manually.

## 5. Technical Specifications

### 5.1 Structure

Frame	Folding Mantis Frame
Material	T 700 High-Modulus carbon fibre
Weight	7 lbs (3.17 kg) (w/o rear wheels)
Weight capacity	250 lb (113.3 kg)

### 5.2 Dimensions

Width	14" (35.5 cm) to 20" (50.8 cm)
Depth	14" (35.5 cm) to 20" (50.8 cm)
Front seat-to-floor height	16" (40.6 cm) to 20" (50.8 cm)
Rear seat-to-floor height	13½" (33.0 cm) to 20" (50.8 cm)

### 5.3 Adjustability

Upholstery	Tension adjustable or bolt on
Back height	9" (22.8 cm) to 21" (53.3 cm)
Adjustable angle	from 70° to 110°
Footrest	One piece
Camber	0°, 3°, 6°
Centre of gravity	from ½" (1.2 cm) to 4½" (10.1 cm)



## 6. Safety

### 6.1 Periodic Checklist

See related appendix (section 14).

### 6.2 Weight Limitation

The VELOCE wheelchair has a weight limit of 220 lbs (100.0 kg). The specified weight capacity includes: both the rider and any luggage. A user with a 10lb backpack, for example, should not exceed a weight of 210 lbs. It is of utmost importance that the total weight be below the above specified capacity.

The wheelchair is designed to support only one person. Please do not stand up on the footrests.

Motion Composites is not responsible for any damages or injuries caused by the misuse of this wheelchair.

### 6.3 Weight Training and Sporting Activities

This wheelchair was not designed or tested as a weight training apparatus. Do not attempt to use this wheelchair in weight training. The warranty shall be void if the wheelchair has been used for any weight training purposes.

This wheelchair is not intended to be used during sporting activities.



**Should you make any adjustments, repairs or do any servicing, ensure that all fasteners are tightly secured before use.**



**Exceeding the specified weight limit could damage the wheelchair and/or cause severe injuries.**



**This wheelchair was designed to be tailored to the dimensions of its owner and as such should only be used by its owner unless a qualified specialist, approved by Motion Composites, has readjusted it.**

## 7. Tutorial

Please find many tutorial and maintenance tips on our YouTube page at : <http://www.youtube.com/heliowheelchair>

## 8. Riding your VELOCE



**Should you make any adjustments, make sure to familiarize yourself with the wheelchair movements before removing the anti-tippers.**



**The wheelchair should be dried with a cloth immediately after being exposed to water.**

### 8.1.1 To reduce the risk of accident

We recommend that you review safe wheelchair use with your physician prior to using this equipment.

Take the time to read the instructions in this manual to ensure that you feel comfortable using the wheelchair without assistance.

Always be aware of hazards.

Always use anti-tippers.

### 8.1.2 Environmental Conditions

The VELOCE was designed to be used on hard and plane surfaces like asphalt, concrete, and indoor flooring such as carpeting.

Beware that the manoeuvrability of the wheelchair is significantly affected by different outside conditions such as sand, mud, rain, snow and rough surfaces. If you use your wheelchair in these conditions, it is recommended that you have it frequently serviced.

Be careful when using your wheelchair on wet or slippery surfaces.

Exposure to water or excessive moisture can be damaging and may even cause the wheelchair to corrode over the long-term.

Do not leave your wheelchair in humid environments such as the bathroom (e.g. while taking a shower).

Do not use your wheelchair in the shower, pool, or other water situations.

### 8.1.3 Caregivers

- Never use removable parts (e.g. armrests, footrests) to push the wheelchair and never use lifting supports since they could cause injuries or damage.
- Ensure that the wheelchair is equipped with push handles and that its grips are securely in place.
- Turn anti-tipping devices upwards or remove them to avoid tripping.
- Should you need to leave the wheelchair user unattended, engage the wheel locks and place the anti-tipping devices back in the downward position.
- Ask an experienced caregiver to explain safe assistance methods to you.
- Ensure ongoing communication between you and the wheelchair user as to avoid any kind of confusion.
- Maintain proper posture to tilt or lift the wheelchair; keep your back straight and bend at the knees.
- Instruct the wheelchair user to lean his/her back when you are tilting the wheelchair.

## 8.2 Riding your wheelchair

**i** Various adjustments of your wheelchair (seat height/depth/system, back angle, rear & front wheels camber/size/position, position of the front riggings) could affect the center of gravity. The adjustments should be performed by a professional and the wheelchair user should be aware that the stability could be affected by these adjustments.

**!** Do not tilt the wheelchair or perform a wheelie without assistance.

### 8.2.1 Balance point

It is important to begin by learning all of the specific characteristics of your wheelchair. Ask a health professional to explain them to you. Carrying a backpack will affect the balance point of your wheelchair. Be aware of resulting handling factors in relation to your body position, posture or weight distribution. The center of gravity is affected by the angle of the wheelchair on a ramp or slope. This can be felt in forward and backward as well as side to side movements. Make sure to review the different riding techniques prior to using the wheelchair. Use anti-tippers until you are skilled at riding your wheelchair in any situation.

### 8.2.2 Wheelies

Wheelies involve lifting the front casters off the ground while maintaining balance on the rear wheels. Performing this manoeuvre, while allowing you to easily avoid obstacles, may result in serious injuries. Consult your doctor before doing wheelies.

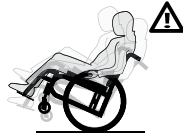

### 8.2.3 Transferring

Rotate the front casters forward to enhance stability. Place the wheelchair as close to your transfer location as possible. Engage wheel locks. Position yourself as far back as possible when transferring weight to reduce risk of tipping forward. If you have good upper body strength, balance and agility, you may be able to perform transfers independently. Rotate or remove footrests if at all possible as to avoid putting weight on them. If possible, make use of a transfer board.



**!** Always ask a healthcare provider to learn safe transfer methods.

### 8.2.4 Getting Dressed

When dressing or undressing on the wheelchair, rotate the front casters forward and lock anti-tippers in the lower position. If your wheelchair is not equipped with anti-tippers, back it against a wall and lock the rear wheels.

### 8.2.5 Reaching/Leaning/Bending

**!** The balance point may shift when you are putting on clothes and/or reaching for objects while sitting in the wheelchair.

If at all possible, use a reaching device or ask for assistance when reaching for objects.

Move the wheelchair as close as possible to the required object.

Rotate the casters as far forward as possible from the rear wheels.

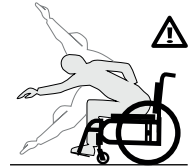

Never reach for objects between your legs, but rather position yourself to the side of these objects.

Do not shift your weight sideways, but rather rise up from the seat or move forward in the seat. Always use both hands and grab the opposite side wheel or armrest if you are capable of reaching sideways. Never reach to the rear of the wheelchair unless it is equipped with anti-tippers. Never reach for objects over the seat back: reach only as far as your arm naturally extends without moving on the seat.

Do not lock the rear wheels if you are reaching backwards. Avoid putting pressure on the footrests.



### 8.2.6 Moving backwards

Lock anti-tippers in lower position.

Move slowly: the wheelchair is designed to provide you with more stability when moving forward. Look around as often as possible to avoid obstacles in your path.

### 8.2.7 Ramps, Slopes & Side Hills

Do not ride hills with an elevation slope of more than 10% (one foot elevation change for every 10 feet).

Try to move straight up or down the slope. Avoid turning on a downhill slope.

Stay in the center of sidewalks and ensure that there is enough space for the wheels.

Avoid stopping on slopes and never use the wheel locks to slow yourself on a downhill slope. Maintain your speed by holding the hand rims.

Do not ride on wet or slippery surfaces. Be cautious for changes in terrain height or stairs at the end of a slope (front casters may lock from simply hitting a small bump).

Ask for help should any situations arise. Incline yourself while moving down a slope as to adjust your centre of gravity.

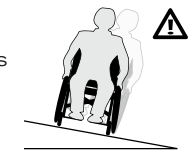
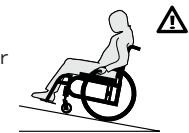

### 8.2.8 Obstacles

Always look for obstacles or road hazards (potholes, broken surfaces, etc.). Clear your own environment (work, home) of any obstacles. Never use objects (furniture, ramps, and doorknobs) to push yourself out of the wheelchair.

Lean your upper body slightly forward as you move up an obstacle. Do the reverse while moving down an obstacle. Keep both hands on the hand rims while passing over the obstacle.

### 8.2.9 Curbs and Steps

Remove or rotate the anti-tippers upwards to go up or down a curb or step. Move straight up and down and never angle the wheels.





### 8.2.10 Moving with Assistance

Caregivers should read the “Caregiver” section of this manual.

#### 1 - Going up a curb or step

- Place yourself behind the wheelchair.
- Go forward and tilt the wheelchair with the rear wheels by making sure that the front casters do not touch the curb or the step.
- Once the front wheels are elevated and you have passed the obstacle, put them back on the ground and continue pushing the wheelchair.

#### 2 - Going down a curb or step

- Place yourself behind the wheelchair.
- Before reaching the edge of the curb or step, change the direction of the wheelchair by turning it around the obstacle.
- Pull the wheelchair while going down the curb or step.
- Pull the wheelchair until the rear wheels reach the edge of the curb or step; the rear wheels must slowly touch the lower level.
- Pull the wheelchair backward until the front wheels touch the edge and then lower the front back to the ground.
- Return the wheelchair to its normal driving position.

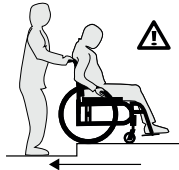

### 8.2.11 Stairs

Use an elevator wherever possible.

Ask for help from two people to move the wheelchair up or down stairs (the caregivers should read the “Caregiver” section of this manual).

Fasten your seat belt when being lifted in the wheelchair.

#### Going up or down the stairs

Tilt the wheelchair back to its tipping point.

When going up, bring the wheelchair backwards until the rear wheels touch the first step.

When going down, bring the wheelchair forward to the edge of the stairway.

Pull up or lower the wheelchair to the next step: one assistant should be behind you and the other in front of you.

Repeat the same movements for every step until you reach the end of the stairway.

Lower the front of the wheelchair to the ground once the front wheels are not touching the floor.

### 8.2.12 Escalators

Under no circumstances should this wheelchair be used on an escalator, not even with the help of an attendant. This could cause severe injuries.

## 9. How to use your VELOCE

### 9.1 Folding & Unfolding

#### 9.1.1 Folding

- Rotate front riggings forward until they lock.
- Flip up the footplates.
- Remove the seat cushion.
- Lift the handle on the seat upholstery.
- Pull the wheels towards each other.

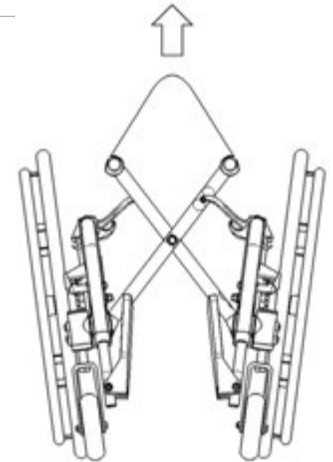

#### 9.1.2 Unfolding



**When unfolding the wheelchair, be careful not to put your fingers between the pivot links, or under the seat rails. Always push or pull on the seat upholstery. Make sure the wheelchair is fully opened before transferring or sitting.**

- Tilt the wheelchair towards you; make sure the opposite wheels are off the ground.
- Push the edge of the seat upholstery towards you until it closes properly.
- Press downwards on both seat rails in order to engage the lock mechanism of the wheelchair. It is necessary to push down on the middle of the seat rails to make sure that they are correctly positioned in the seat rail supports. You will feel a click between frame components.

## 9.2 Wheel Locks



Never use wheel locks to stop wheelchair movement. **WHEEL LOCKS ARE NOT BRAKES.** Make sure the surface is not slippery as the wheelchair could move even though the wheel locks are engaged.



Ensure that brake locks imbed at least 1/8" into the tire rubber when chair is in locked position.

Ensure the wheelchair is stable and locked with wheel locks.

- To engage the locks, push wheel lock handle forward (for push-to-lock type) or pull wheel lock backward (for pull-to-lock type) until the lock is fully engaged.

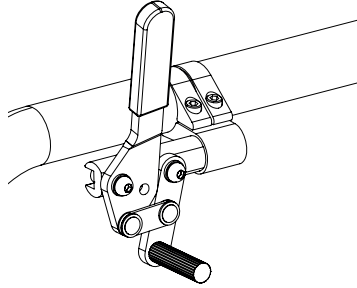

- To release the locks, pull wheel lock handle backward (for push-to-lock type) or push wheel lock handle forward (for pull-to-lock type) until the lock is fully disengaged.

## 9.3 Footrest

- When transferring, avoid putting weight on the footrest and be careful not to stand behind the footrest.
- Never use footplates to lift the wheelchair.
- Only use non-detachable parts to lift the wheelchair.

## 9.4 Armrests



Ensure that armrests are securely locked into arm sockets and armrest release buttons are locked into place prior to using the wheelchair.

- Never lift the wheelchair by holding the armrests.
- Use only non-detachable parts for lifting.

### 9.4.1 Flip-back armrests

To lift the armrests:

- Pull lever (1) upwards to release the system.
- Rotate the armrest all the way up and down.

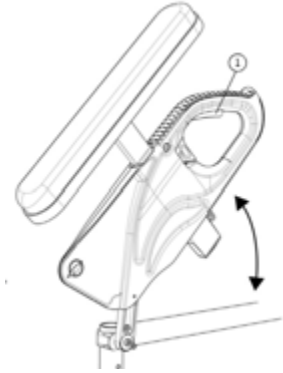

To reinstall the armrests in closed position:

- Rotate the armrests downward until the front slide plate enters in the armrest receiver and snaps into place.
- Make sure the locking lever is engaged to avoid any movement.

### 9.4.2 Removable T armrests

To remove the armrests:

- Pull lever (1) upwards to release the system.
- Pull the armrest all the way up.

To reinstall the armrests:

- Bring the armrests downward until the slide (3) enters in the armrest receiver (4) and snaps into place.
- Make sure locking lever (2) is engaged to avoid any movement.

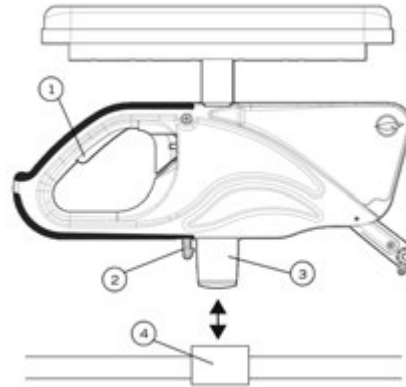



### 9.4.3 Swing-Away Armrests

To remove the armrests from the wheelchair.

- Lift them straight up to release the armrest.
- To reinstall the armrests, insert them back in the armrest receiver (1) until they set into place.

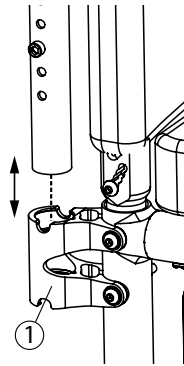

## 9.5 Seat belts



Use positioning belts **ONLY** to help support the rider's posture. Improper use of these belts may cause severe injuries to the rider.



Make sure the rider does not slide down in the wheelchair seat. If this occurs, the rider may suffer chest compression or suffocate due to pressure from the belts.



Never use belts as a motor vehicle restraint.

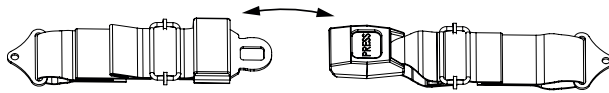

- The seatbelt should be used at all times in accordance with instructions.
- There should be approximately one hand width of space between the seat belt and thigh; do not exceed this amount of space.
- Ensure that the seat belt is properly fastened as to avoid serious injuries.
- In case of emergency, ensure that seat belt can be easily unfastened.

### 9.5.1 Auto buckle and aircraft buckle seatbelts

- To fasten your seatbelt, insert the clip into the buckle until it snaps.
- Make sure the belt is securely fastened.
- To unfasten your seat belt, lift the flap on the aircraft buckle seatbelt or push the button on the auto buckle seatbelt.
- To adjust your seat belt, pull each strap towards the opposite side until you get the desired tension and keep the buckle centered.

### 9.5.2 Velcro Belt

- To fasten your seatbelt, insert the long side of the seatbelt into the buckle on the other side.
- Apply pressure on the belt for a firm grip of the velcro.

## 9.6 Anti-Tipper



Motion Composites strongly recommends the use of anti-tippers

Anti-tippers were designed to prevent falls from the wheelchair.

- To remove or rotate the anti-tippers up, push the release button (1) and pull out or rotate the anti-tippers (2).
- To replace the anti-tippers, press the release button and insert them into the frame until they snap into position.
- Highest Curb Clearance : 1 1/2" to 2", depending on configuration.

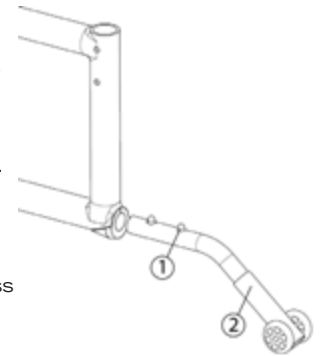

## 9.7 Rear Wheels

### 9.7.1 Quick-release axles

- To remove the rear wheels, push the button in the center of the wheel's hub and pull the wheels off (1).
- To reinstall the rear wheels on the wheelchair, push the button of the quick-release axles, insert the axle into the wheelchair axle bushing and release the button
- Always make sure that the quick release detent balls (2) extend beyond the axle bushing for a secure lock.

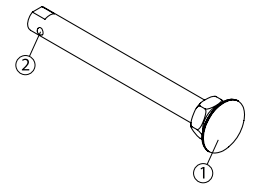

### 9.7.2 Fixed axles

- To remove the rear wheels: unscrew the bolt (1) located inside the wheelchair axle bushing and pull out the wheel.
- To reinstall the rear wheels on the wheelchair: insert the threaded axles (2) in the axle bushing.
- Tighten the bolt (1) and make sure that the wheel is still turning without any restrictions.

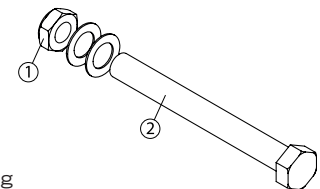

## 9.8 Seat slings

- Seat slings are not intended to be used as a seating surface. Always use a cushion.
- Ensure that the sling is in good condition (e.g. no fraying, no wear and no tears).

## 10. Adjustments and maintenance of your VELOCE

### 10.1 Service

Refer to your dealer for service. A complete and updated list of service providers can be found on our website.

### 10.2 Replacement Parts

Ordering information:  
Consult our website to download the parts manual and view ordering information.

Please contact us at:

#### Motion Composites Inc.

519 J-Oswald Forest, suite 101  
Saint-Roch-de-l'Achigan, Quebec  
J0K 3H0 Canada  
Phone: 1-866-650-6555  
Fax: (450) 588-0200  
support@motioncomposites.com  
www.motioncomposites.com

### 10.3 Tools needed



The **VELOCE** was designed to be serviced with **regular tools**. All screws and bolts are standard and can be adjusted with a wrench, socket wrench, or Allen key. Do not use air or electric tool, tightening should be done manually.

## 10.4 General maintenance

### 10.4.1 Tire pressure

- Check tire pressure with a tire gauge.
- Inflate if pressure is below recommended amount as labelled on the sidewall.
- Do not inflate tire over recommended pressure.
- Over inflation could result in tire failure and injury.
- Under inflation could result in a flat tire.

		Max pressure
Pneumatic	1 3/8"	65 psi
Pneumatic HP	1 3/8"	110 psi
Pneumatic HP	1"	145 psi
Pneumatic HP Plus	1"	145 psi

### 10.4.2 Cleaning your wheelchair

- Use a soft clean cloth with soap and water to clean your wheelchair.
- Rinse and dry the wheelchair adequately.
- Do not use abrasive cleaners.
- Do not use a pressure cleaner.

## 10.5 Backrest

### 10.5.1 Removing/Installing the Back Canes

- Loosen the top bolts (1) and (2), which are also used to support the armrest socket (Swing Away and Flip Back armrest up).
- Slide the back post to remove it from the tube.
- Reinstall the back post in the reverse order and tighten screws snugly.
- Tighten bolts (1) and (2) firmly.
- Wheelchairs equipped with Flip Back armrests; tighten screw (1) while paying special attention to the force needed to flip back the armrest.

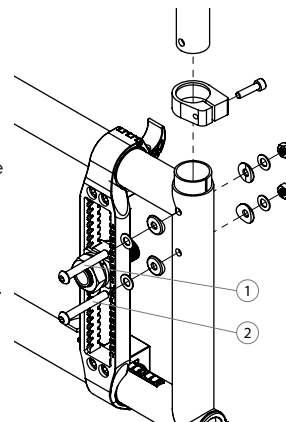

### 10.5.2 Adjusting the Back Angle

- Loosen screw (1) and remove screw (2) from the levelling device.
- Adjust to desired angle by sliding the mechanism.
- Reinstall screw (2) and tighten both screws to fit snugly.

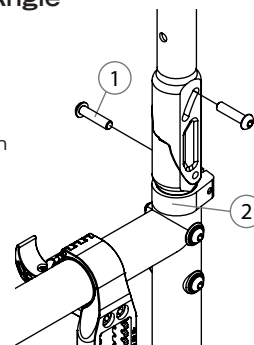

### 10.5.3 Removing/Installing the seat belt

- Remove Screw (1) in order to remove the seat belt clamp (2) that is attached to the belt
- Reinstall screw (1) directly on the frame clamp (3)
- Tighten screw (1) until it is properly tightened.
- Repeat the same steps on the other side

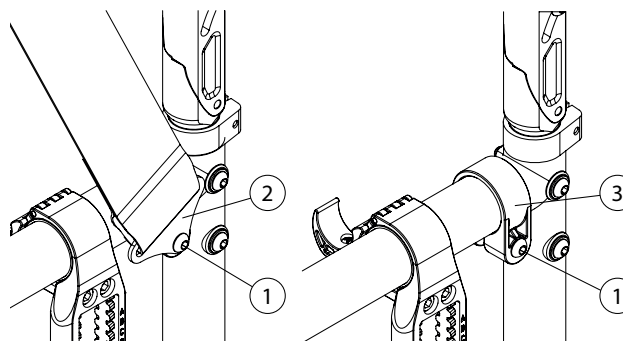



### 10.5.4 Adjusting the Backrest Height

- Loosen the screw (1) that holds the back upholstery.
- Pull backrest upholstery down several centimetres in order to access screw (2) that holds the push handle.
- Remove screw (2) and the backrest handle.
- To adjust the backrest height, with the help of a threaded rod ( $\frac{1}{4}$ "-20), move the dowel nut (3), which is located inside the handle.
- Once this step is completed, use screw (2) to hold the dowel nut (3) while removing the threaded rod.
- Remove screw (2) and reinstall backrest handle.
- Align screw (2) with the mounting hole.
- Reinstall and tighten screw (2) and the washer.
- Repeat the same steps on the other side.
- Reinstall the backrest upholstery with screw (1) and tighten to fit snugly.

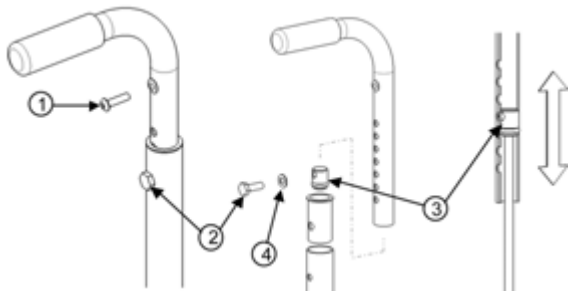

## Seat

### 10.5.5 Installing/Removing Standard Seat Upholstery

- Remove screw (1) that holds the back upholstery.
- Pull backrest upholstery down several centimetres to gain access to screw (2), which holds the push handle.
- Remove screw (2) and then remove the backrest handle.
- Remove or install back upholstery.
- Once, the new back upholstery is installed, reinstall the handles by aligning them with the mounting holes.
- Reinstall and tighten screw (2) firmly.
- Install back upholstery at and fix it firmly with screw (1) on each back cane.

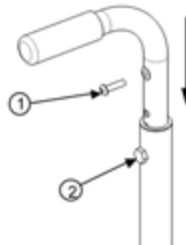

## 10.6 Armrest

### 10.6.1 Installing Flip-back Armrests

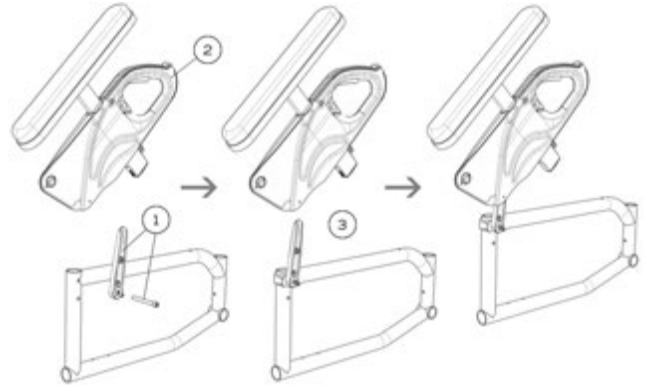

- Insert the flip-back pivot (1, 2) (Fig. 14a) and screw it in place, making sure it stays in place but can rotate easily.
- Insert the armrest (Fig. 14b) on the flipback pivot than rotate it until it clicks with the armrest receiver (Fig. 14c) (for clamp installation, see 10.6.3 installing removable T-armrests).

### 10.6.2 Adjusting the height of Flip-back armrests

- Flip lever (1) left or right to unlock the armrest.
- To adjust height, slide the upper part of the armrest into the lower part.
- Adjust the structure (2) at the desired height.
- Flip the lever back to the closed position.
- Make sure the armrest clicks in place for complete securement.

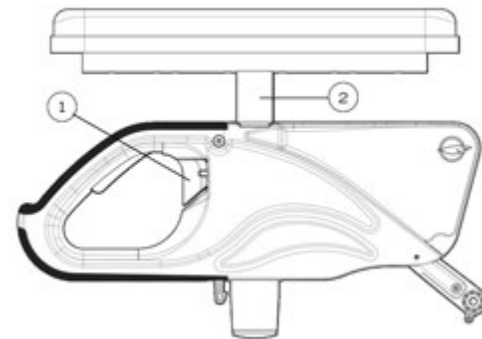

### 10.6.3 Installing removable T-armrests and rigid sideguard

- Install armrest receiver (1) (Fig. 19) on the upper tube of the frame at a distance of 160mm (6 1/4") from the rear tube of the frame.
- Slightly tighten screws (2) to allow the clamp to rotate.
- Insert armrest or sideguard into receiver (1).
- Rotate receiver (1) until the sideguard is perpendicular to the seat.
- Tighten screws (2) firmly.

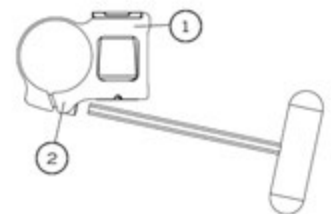



## 10.6.4 Replacing Armrest Pad

- Remove screws (1) located under pad (through the tube).
- Replace with new armrest pad.
- Reinstall screws (1) and tighten firmly.

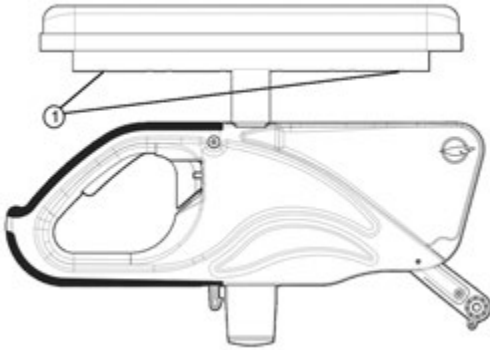

## 10.6.5 Installing the Swing-away Armrest receiver

- Remove the two bolts (1).
- Align the armrest receiver with the mounting holes of the frame and of the transit securement anchor.
- Reinstall the bolts and tighten firmly.

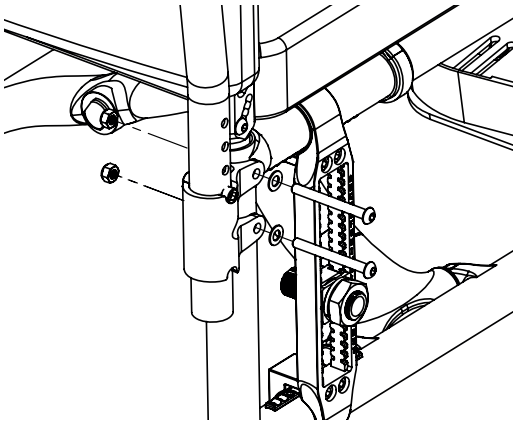

## 10.6.6 Adjusting Swing-away Armrest height

- Pull the armrest out of the receiver (1).
- Remove screws (2).
- Inside the armrest tube, slide the dowel nut with a long flat screwdriver at the desired height (3).
- Reinstall screws (2).
- Reinsert armrest in receiver.

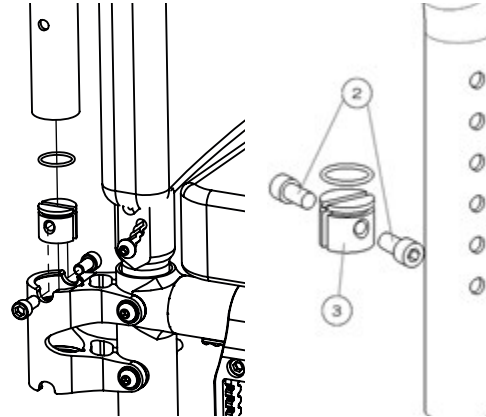



## 10.8 Seat



It may be difficult to unfold the wheelchair if the seat upholstery has been installed too tight.

### 10.8.1 Replacing Seat Upholstery

#### SLIDED SLING

- Remove end cap (1).
- Slide in new seat upholstery.
- Reinstall end cap (1)
- Adjust tension with the velcro located under the seat upholstery.
- Fully open the wheelchair and make sure the upholstery is tight. The seat rails must be snapping easily in the seat rail supports.

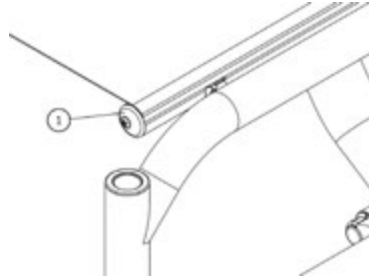

#### SCREWED SLING

- Remove end cap (1).
- Slide in new seat upholstery.
- Reinstall end cap (1)
- Adjust tension with the velcro located under the seat upholstery.
- Fully open the wheelchair and make sure the upholstery is tight. The seat rails must be snapping easily in the seat rail supports.
- Firmly tighten all screws on the seat rails.

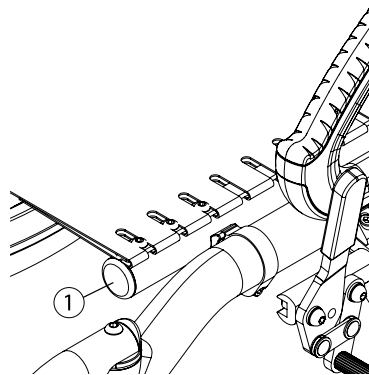

## 10.9 Seat-to-floor height

Any modification to the seat-to-floor height involves adjustment of anti-tippers, front caster angle, and rear wheel toe-in/toe-out if equipped with 3° or 6° camber. It is important to do these adjustments before using the wheelchair as to reduce risk of injuries.

### 10.9.1 Changing the Front Seat-to-Floor Height

To change the front seat-to-floor height, you can do one of the following:

- Install the front caster in a different hole on the fork
- Install different caster size.

### 10.9.2 Changing Rear Seat-to-Floor Height

To change the rear seat-to-floor height, you do one of the following:

- Install the rear wheel axle bushing in a different position along the mounting plate.
- Install different sized rear wheels.

### 10.9.3 Changing Front & Rear Seat-to-Floor Height

To change the front and rear seat-to-floor height simultaneously, you can:

- Use another seat cushion with a different thickness.

## 10.10 Front casters, forks and fork stem assemblies

### 10.10.1 Removing/Installing/Repositioning the Front Wheels

- Loosen and unscrew (1).
- Remove, install or reposition the front castor.
- Tighten screw (1) firmly.

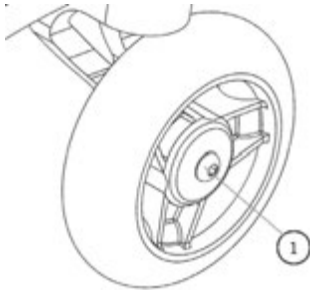

### 10.10.2 Removing/Installing the caster housing

- Remove screw (1).
- Remove screw (2).
- Slide the caster housing out of the frame.

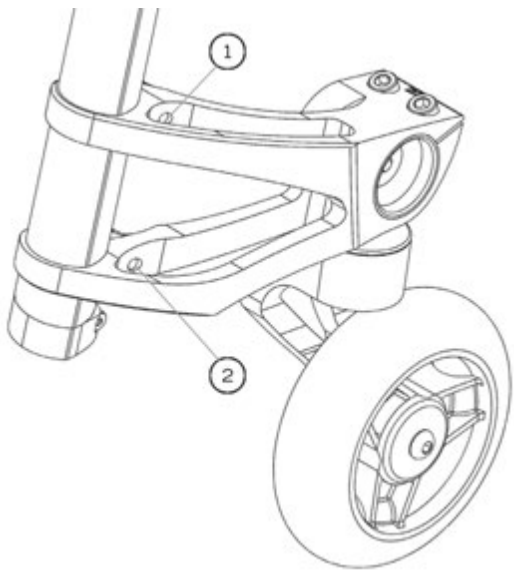

### 10.10.3 Adjusting the castor housing angle

- All four wheels should be touching the floor.
- Use a set square and place it on the ground and along the caster housing.
- The housing should be parallel to the set square.
- If the housing is not parallel to the set square, loosen screws (1)
- Rotate the caster housing to adjust the angle.
- Tighten screws (1). This will hold the caster housing position.
- Check again that the caster housing is perpendicular to the ground using the set square.

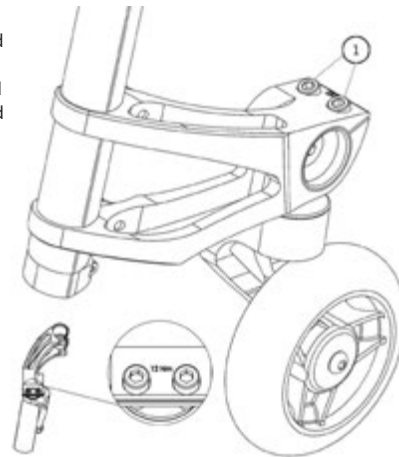

## 10.11 Rear wheels

### 10.11.1 Adjusting Quick-Release Axles

- Remove the rear wheel from the wheelchair.
- Behind the quick release button, there is a nut that adjust the length of the axle.
- Hold the axle with a wrench at the other end (near the detent balls) (Fig. 33) and turn the nut behind the quick release button to change the length of the axle.
- Reinstall the quick release into the axle bushing on the wheelchair
- Quick release detent balls should extend beyond the axle bushing for a secure lock.

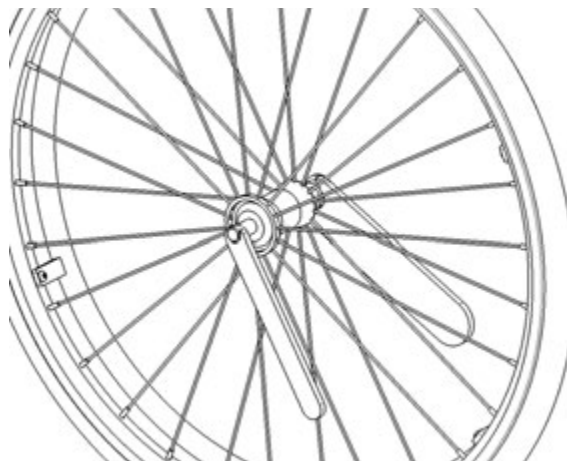



### 10.11.2 Replacing/Adjusting hand rims

- Use a plastic tire removal tool to take off the tire (1) (Fig. 34).
- Remove all nuts (2) inside the rim (3).
- Replace the handrim (4) with a new one and align the mounting holes (5).
- Reinstall and tighten the nuts firmly.
- Reinstall the tire on the rim.

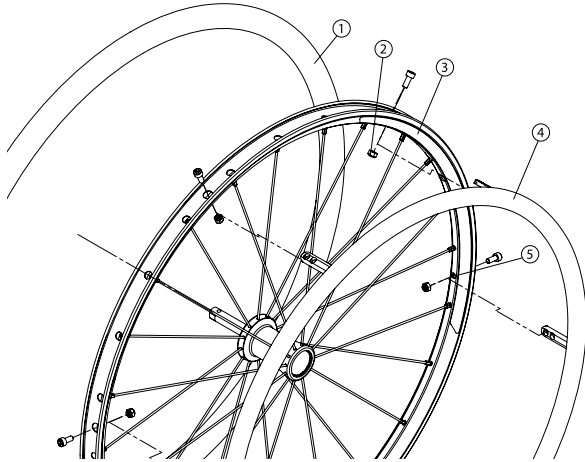

### 10.11.3 Adjusting the rear axle height

- Loosen the nut holding the axle bushing (3).
- Move axle bushing (1) along mounting plate (2).
- Reinstall the bushing in the desired mounting hole and tighten nut (3).

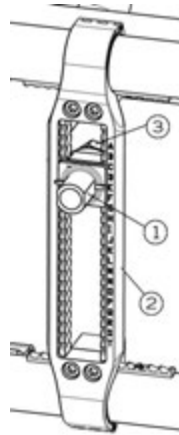

### 10.11.4 Adjusting rear wheel spacing

The rear wheels can be adjusted laterally by repositioning axle bushing (1) on mounting plate (2).

- Loosen nuts (3) on the axle bushing (1).
- Turn the bushing (1) in the desired direction to adjust the spacing.
- Firmly tighten the nuts (3).

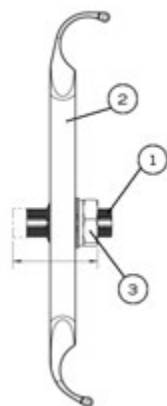

### 10.11.5 Adjusting the toe-in/toe-out with rear wheel camber.

- Remove the rear wheels.
- Maintain the wheelchair on a horizontal plane with the support of the three other wheels.
- Loosen nuts (2) while keeping a bit of tension.
- Put the camber adjustment tool on the axle bushing
- Use a set square and rotate the axle bushing so that the tool is parallel to the set square (and perpendicular to the ground)
- With one hand, hold the tool and the mounting plate together to keep the setting.
- With the other hand, use a ratchet to tighten firmly the nut (2) facing inside the wheelchair.

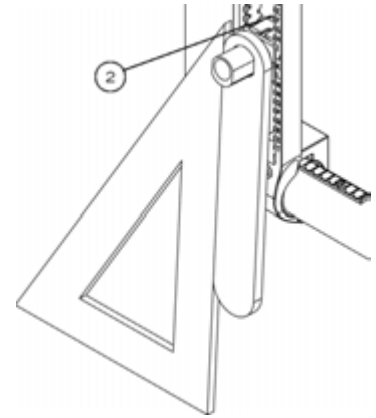

## 10.12 Wheel Locks

### 10.12.1 Replacing/Adjusting the Wheel Locks

- Loosen screws (1).
- Slide the lock to the desired position.
- Tighten screws (1) to a snug fit. Final tightening should be done manually.
- Once engaged, the lock should embed 3 mm into the tire.

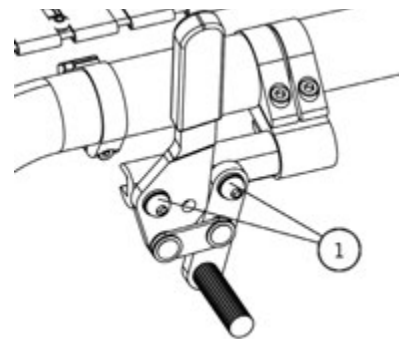

## 10.13 Extension brakes

### 10.13.1 Replacing/Adjusting the brake extension

- Loosen screw (1).
- Align eyelet (2) with the mounting hole.
- Re-tighten screw (1) on the brake lever.

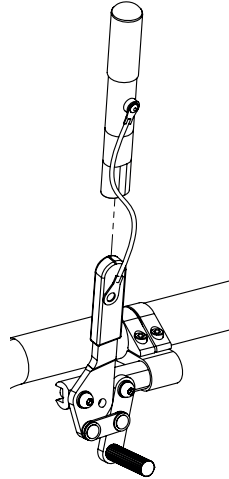

## 10.14 Anti-tippers

### 10.14.1 Adjusting the Height of the Anti-tippers

The anti-tippers should be between 1½ and 2¾ inches (40 to 70 mm) off the ground. Improper spacing may result in wheelchair hang ups over obstacles or not preventing the wheelchair from tipping.

- Press the push-button and slide anti-tippers extensions to desired length.
- Ensure the button snaps back into place.

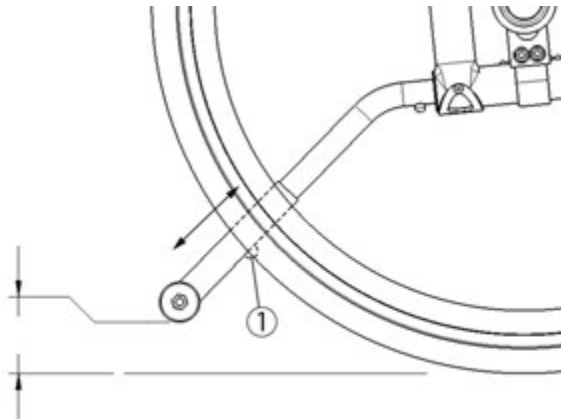

**i** If you are unable to adjust the anti-tippers to the proper height, contact your Motion Composites dealer to replace your anti-tipper for another size.

## 10.15. Headrest Kit and Headrest Support

### 10.15.1 Installing a headrest support

- Cut the end of the push-handle with a knife in order to be able to see the inside of the push handle.
- Insert a 1/4"-20 grip nut (1) with the grip nut insertion tool (2) inside the handle (40 mm).
- Install fastening device of the headrest support by tightening it in the 1/4"-20 roll pin.

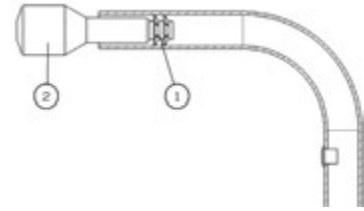

### 10.15.2 Installing Headrest Kit

- Once the headrest support is installed, insert the adjustable headrest into the horizontal receiver.
- Install headrest on the ball pivot and tighten the three screws (1).
- Once the adjustment is completed, firmly tighten all parts.

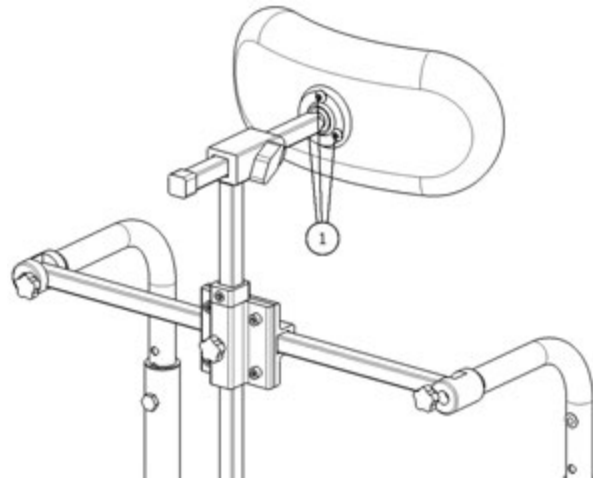





## 12 Motion Composites limited warranty

### A. Frame – 5 years

Motion Composites warrants the wheelchair frame and cross braces against defects in materials and workmanship for five years from the date of purchase.

### B. Components – one year

Motion Composites warrants all Motion Composites-made components against defects in materials and workmanship for one (1) year from the date of purchase, except for parts listed below.

### C. Limitations and exclusions

- 1 Motion Composites covers the following items for 30 days:**
  - tires and tubes for front or rear wheels, upholstery (including cushions, seat slings, armrest upholstery) and push-handle grips;
- 2 This warranty does not cover:**
  - damage arising from normal wear and tear or from other circumstances beyond Motion Composites' control; or
- 3 The foregoing warranty shall not apply if:**
  - the original Motion Composites serial number tag has been removed, altered or defaced; or
  - the wheelchair has been subjected to negligence, accident, improper maintenance, storage or operation as required by your Motion Composites Owners Manual, commercial or institutional use, misuse or abuse, including, but not limited to, exceeding the maximum weight capacity of 250 pounds (113,4 kg); or
  - the wheelchair has been damaged by improper repairs or repairs made to any component without the express written consent of Motion Composites; or
  - the wheelchair has been modified without Motion Composites' express written consent, including, but not limited to, modification through the use of unauthorized parts or attachments; or
  - the wheelchair has been used as a weight training apparatus; or
  - the wheelchair's Transit Tie-Down System (TTDS) has been misused; if TTDS is not attached to the four tarpaulin bows identified and installed by Motion Composites.
- 4 This warranty is extended only to the original consumer purchasers of Motion Composites' product.**

### D. Our responsibility

Motion Composites' sole obligation and your exclusive remedy under this warranty shall be limited to such repair and/or replacement.

### E. Warranty Service

If your wheelchair requires warranty service, please contact an authorized Motion Composites Dealer in Canada or an authorized international distributor. In the event of a defect in material or workmanship, the Dealer or Distributor must obtain a return authorization (RA) number from Motion Composites. Motion Composites issues RA numbers only to authorized Motion Composites Dealers and Distributors. In the event that you do not receive satisfactory warranty service, please write directly to Motion Composites Customer Service at 519 J-Oswald Forest, suite 101, Saint-Roch-de-l'Achigan, Qc, J0K 3H0 or send an email at: [service@motioncomposites.com](mailto:service@motioncomposites.com). Do not return products to our factory without our prior consent.

### CONSUMER NOTICE

- 1** The foregoing warranty is exclusive, and in lieu of all other express warranties, whether written or oral, express or implied. Motion Composites shall not be liable for any consequential or incidental damages whatsoever. By registering your Motion Composites wheelchair, you will be deemed to agree with all provisions of this warranty.
- 2** It is forbidden to alter or extend the foregoing express warranty or to waive any of the limitations or exclusions.





## 15 Particular damages

### 15.1 Damages requiring service by a qualified service agent

If any of the following conditions are observed, the wheelchair must be serviced by a qualified service agent:

- Any wheel adjustment;
- Any defective ball bearings of the forks;
- Any defective ball bearings of the front wheels;

### 15.2 Special damages that require the return of the wheelchair to the manufacturer

If any of the following conditions are observed, always contact your service agent prior to sending your wheelchair for repairs at Motion Composites.

- Part of the frame or cross brace is cracked;
- The thread of a riv nut is damaged;
- Part of the frame or cross brace is broken;
- Cross brace becomes worn;
- Problems continue to be identified after several adjustments or repairs have been made by a qualified service agent.

## 16. DECLARATION OF CONFORMITY

### Name and Address of Product Owner

Motion Composites  
519 J-Oswald-Forest Suite 101, St-Roch-de-l'Achigan  
Quebec, Canada, J0K 3H0  
Phone: 1-866-650-6555  
Fax: (450) 588-0200  
support@motioncomposites.com  
www.motioncomposites.com

### Authorized representative

Advena Ltd.  
Pure Offices, Plato Close, Warwick  
CV34 6WE, United Kingdoms

We hereby declare that the below mentioned devices have been classified according to the classification rules and conform to the Essential Principles of Safety and Performance as laid out in the Health Products (Medical Devices) Regulations 93/42/CEE.

### Medical Device(s):

Helio A7 manual wheelchair

### Manufacturing site:

Motion Composites  
519 J-Oswald-Forest Suite 101, St-Roch-de-l'Achigan  
Quebec, Canada, J0K 3H0

### Risk classification:

Class 1 Medical Device (per 93/42/CEE).

### Standards applied:

- **NF EN ISO 7176-1:**  
Wheelchairs, part 1: Determination of static ability.
- **NF EN ISO 7176-5:**  
Wheelchairs, part 5: Determination of dimensions, mass and manoeuvring space.
- **NF EN ISO 7176-8:**  
Wheelchairs, part 8: Requirements and test methods for static, impact and fatigue strengths.
- **NF EN ISO 7176-11:**  
Wheelchairs, part 11: Test Dummies.
- **NF EN ISO 7176-15:**  
Wheelchairs, part 15: Requirements for information disclosure, documentation and labeling.

This declaration of conformity is valid from 2013/01/16.

## I. Appendix

### I.I TABLE "FRONT SEAT-TO-FLOOR HEIGHTS"

Frame Angle	Height available $\pm \frac{1}{4}$ " (0.6 cm)
70°	16" (40.6 cm) to 19" (48.2 cm)
80°	16" (40.6 cm) to 20" (50.8 cm)
90°	16" (40.6 cm) to 20" (50.8 cm)

### I.II TABLE "REAR SEAT-TO-FLOOR HEIGHTS"

Wheel size	Height available $\pm \frac{1}{4}$ " (0.6 cm)
22" wheel	13 $\frac{1}{2}$ " (34.2 cm) to 18" (45.7 cm)
24" wheel	14 $\frac{1}{2}$ " (36.8 cm) to 19" (48.2 cm)
25" wheel	15" (38.0 cm) to 19 $\frac{1}{2}$ " (49.5 cm)
26" wheel	15 $\frac{1}{2}$ " (39.3 cm) to 20" (50.8 cm)



## Tools

---

**Allen keys:**

2,5 mm  
3 mm  
4 mm  
5 mm

---

**Keys:**

10 mm  
11 mm  
1/2" (13 mm)

---

**For Quick Release:**

7/16" (11 mm)  
3/4" (19 mm)  
1" 1/16 (27 mm)

---

**Other:**

Wrench  
Phillips screwdriver

## Conversion chart

Inches	Metric	Inches	Metric	Inches	Metric	Inches	Metric
1/4"	0.6 cm	1"	2.5 cm	10"	25.4 cm	19"	48.3 cm
1/2"	1.3 cm	2"	5.0 cm	11"	28.0 cm	20"	50.8 cm
3/4"	2.0 cm	3"	7.6 cm	12"	30.5 cm	21"	53.3 cm
		4"	10.2 cm	13"	33.0 cm	22"	55.9 cm
		5"	12.7 cm	14"	35.6 cm	23"	58.4 cm
		6"	15.2 cm	15"	38.1 cm	24"	61.0 cm
		7"	17.8 cm	16"	40.6 cm	25"	63.5 cm
		8"	20.3 cm	17"	43.2 cm	26"	66.0 cm
		9"	22.9 cm	18"	45.7 cm		



## **Motion Composites**

519 J-Oswald-Forest Suite 101, St-Roch-de-l'Achigan  
Quebec, Canada, J0K 3H0  
Phone: 1-866-650-6555  
Fax: (450) 588-0200  
[support@motioncomposites.com](mailto:support@motioncomposites.com)  
[www.motioncomposites.com](http://www.motioncomposites.com)