

AIR PUMP III TROUBLESHOOTING GUIDE

Warnings



The sensor and the copper sample tube are hot. Before touching the sensor or the sample tube, make sure it has cooled.



Before turning the pump on, verify there is no water in the filter bowl. Always empty the bowl before turning the pump on.



Warm up the vehicle before placing the copper sample tube in the exhaust to avoid drawing excess water through the pump assembly.



Keep the air pump assembly upright. Tipping the pump assembly may result in damage to the sensor.



Before assembling the filter, lubricate the threads on the filter stem and filter bowl using the grease provided with the replacement filters or a similar grease. Do not use silicone. The filter stem may break if not lubricated.



Running the pump with the filter clogged, hose kinked, or filter removed will damage the pump and void the warranty.



Always allow the air pump to run after the dyno runs are complete to clear all water from the filter bowl and allow the air pump to cool.

note: The Air Pump Assembly has a 90 day warranty.

note: Remember to empty the exhaust collection bottles regularly.

note: Leaks in the system will result in erroneous readings. Verify there are no cracks or holes in the hoses and filter bowl. Verify the sensor is seated properly in the sensor block.

note: Do not allow the filter bowl to fill with water during operation. Refer to the Air Fuel Ratio Module User Guide for filter bowl information.

note: Depending on usage, the pump will need periodic maintenance. Refer to the Air Fuel Ratio Module User Guide for pump maintenance instructions.

Filter Assembly

A clogged filter may cause erroneous readings or slow response. Clean the filter daily or more often depending on usage.

- ✓ Refer to the Air Fuel Ratio Module User Guide for instructions on cleaning and replacing the filter.
- ✓ If cleaning the filter does not result in free air flow, replace the filter. Be sure to check for other restrictions in the system.
- ✓ Refer to the back of this card for the filter assembly and other common replacement parts.

Refer to the Air Fuel Ratio Module User Guide for proper operating and maintenance procedures. Failure to follow proper procedures may result in inaccurate data or damage to the equipment. This manual can be found on your WinPEP CD or at www.dynojet.com/manuals.shtml.

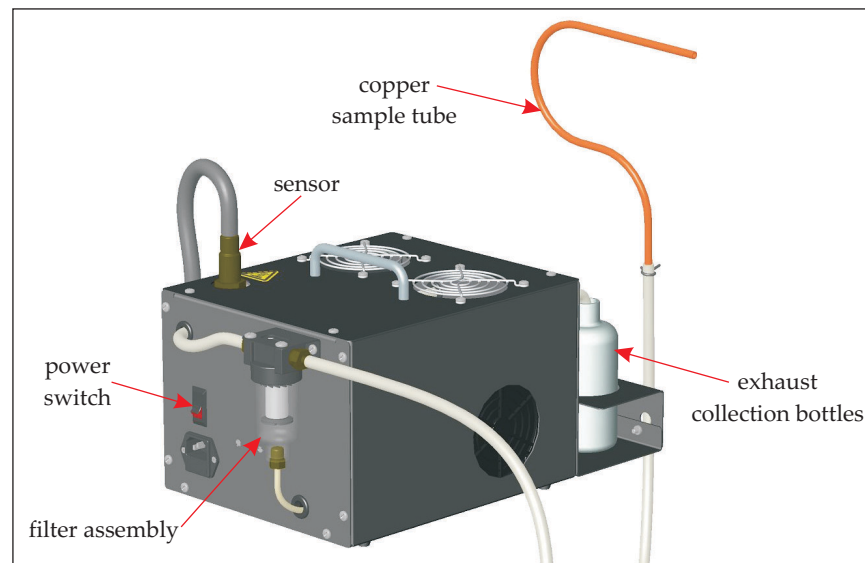

AIR PUMP III TROUBLESHOOTING GUIDE

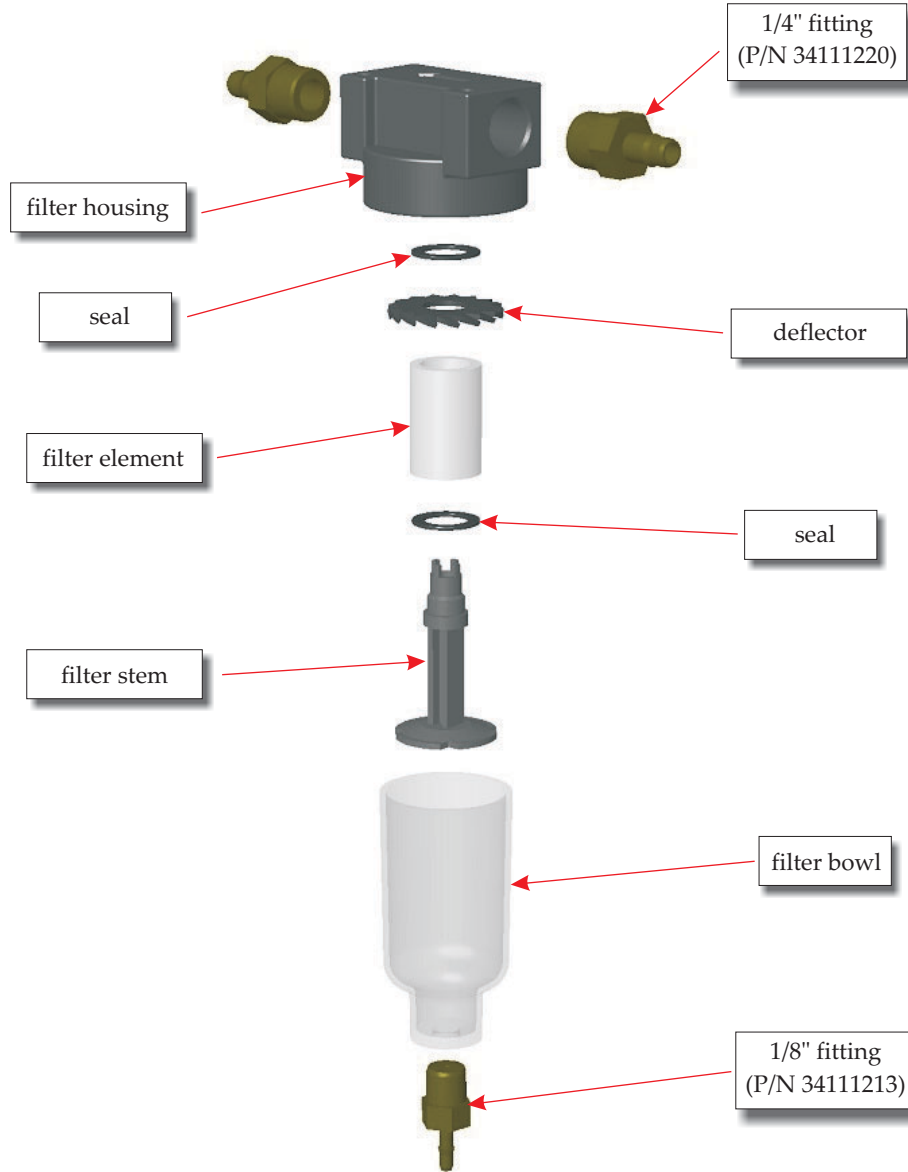

Replacement Parts

part number	description
Filter assembly replacement parts:	
29909000	filter bowl (metal)
29909001	filter bowl (poly carbonate)
34491000	filter element kit (includes seals and grease)
34491001	filter element
34492000	filter stem
Additional replacement parts:	
11108800	silicone tube (not shown)
24730300	copper sample tube (not shown)
79190003	pump maintenance kit (not shown)
The following parts are included in P/N 34420001:	
• filter housing	• filter element
• filter stem	• seal (2)
• filter bowl (poly)	• deflector

