

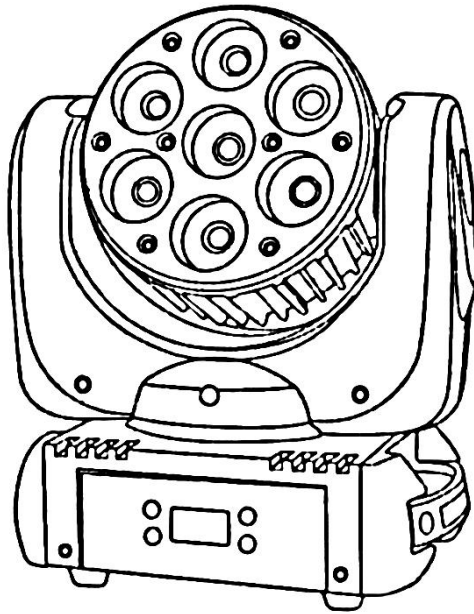

FLASH



LED MOVING HEAD BEAM 7x15W RGBW
4in1 OSRAM 5°/25°
F7000563a

Table of Contents

1	Introduction.....	2
2	Safety information	2
3	Product information	3
3.1	Features	3
3.2	Specification.....	3
4	Installation.....	4
5	Connections.....	6
5.1	Connecting DMX signal.....	6
5.2	Voltage specification.....	7
5.3	Connecting power supply	7
6	Maintenance and Cleaning.....	7
7	Operation manual.....	8
7.1	Control panel	8
7.2	Menu.....	8
7.3	DMX channel list.....	9

1 INTRODUCTION

Thank you for purchasing this LED MOVING HEAD. For safety reasons and to ensure the trouble-free operation, carefully read the instructions before installing the device. Please install and operate the fixture with following instructions.

2 SAFETY INFORMATION

This device has left the factory in perfect condition. In order to maintain this condition and to ensure a safe operation, it is absolutely necessary for the user to follow the safety instructions and warning notes written in this user manual.

IMPORTANT! Damages caused by the disregard of this user manual are not subject to warranty. The dealer will not accept liability for any resulting defects or problems.

1. Installation should be done by qualified personnel in order to minimize the risk of accidental electric shock
2. Disconnect the power supply before installation.
3. Before connecting the unit to the mains, make sure it is not damaged mechanically. If you notice any signs of damage you should contact your dealer immediately. Do not connect the device to the mains.
4. Do not use the device in high humidity conditions and at temperatures above 45° C
5. The device must be installed on stable structures.
6. If the device has been exposed to temperature changes due to environmental changes, do not switch it on immediately. The arising condensation could damage the device.
7. Leave the device switched off until it has reached room temperature.
8. This device falls under protection-class I. Therefore it is essential that the device be earthed.
9. The device shall only be used with rate voltage and frequency.
10. Make sure that the available voltage is not higher than stated at the end of this manual.
11. Make sure the power cord is never crimped or damaged by sharp edges. If this would be the case, replacement of the cable must be done by an authorized dealer.
12. Always disconnect from the mains, when the device is not in use or before cleaning it. Only handle the power cord by the plug. Never pull out the plug by tugging the power cord.
13. During initial start-up some smoke or smell may arise. This is a normal process and does not necessarily mean that the device is defective, it should decrease gradually.
14. Please don't project the beam onto combustible substances.
15. Fixtures cannot be installed on combustible substances, keep more than 50cm distance with wall for smooth air flow, so there should be no shelter for fans and ventilation for heat radiation.
16. If the external flexible cable or cord of this luminaire is damaged, it shall be exclusively replaced by the manufacturer or his service agent or a similar qualified person in order to avoid a hazard.

3 PRODUCT INFORMATION

This Fixture is made of a new type of high temperature strength of engineering plastics and cast aluminum casing with nice outlook. The fixture is designed and manufactured strictly following CE standards, complying with international standard DMX512 protocol. It's available independently controlled and linkable with each other for operation. And it is applicable for large-scale live performances, theater, studio, nightclubs and discos.

4-IN-1 LEDs (RGBW) which features high brightness and stability. Please carefully unpack it when you receive the fixture and check whether it is damaged during the transportation. And please check whether the following items are included inside the box: Moving Head, Power Cable, User Manual

3.1 Features

- 7PCS OSRAM 15W 4-IN-1 LEDs (R,G,B,W)
- 60,000 hours life span for LEDs and low power consumption
- Intelligent temperature sensor for LEDs (overheat protection)
- High efficiency 8° optic lens
- Color range with 16.7 millions additive RGBW colors
- High light output as 860LUX@7M at full
- 0-100% smooth linear dimmer with flicker free
- 20t/s strobe effect with variable speed
- Pre-programmed random strobe and pulse effects
- 17/40 CH DMX channels
- Built-in programs with macro effects
- DMX512, master-slave and sound activated controllable or auto operation
- High definition TFT LCD display
- Quiet, smooth and fast PAN/TILT movement
- Low noise and efficient FAN cooling system
- 540° PAN and 250° TILT movement
- Scan position memory, auto reposition after unexpected movement
- Compact size with only 4,9KG body and 31mm in height
- powerCON connector
- 45°C max ambient temperature
- IP20 protection rating
- 3-Pin XLR DMX input/output

3.2 Specification

- Input Voltage: AC90-260V 50/60Hz
- LED Quantities: 7PCS of 15W OSRAM 4-IN-1 LEDs (R, G, B, W)
- Control Signal: DMX512, master-slave and sound activated or auto operation
- Control Channel: 17/40 DMX channels
- Power Consumption: 100W
- Dimensions: 152mm(L) 265mm(W) 310mm(H)
- Packing Dimensions: 260 mm(L) 320mm(W) 335mm(H)
- Net Weight: 4,9kg
- Gross Weight: 7,5kg

4 INSTALLATION

When installing the unit please comply with the following rules:

1. The moving head is for wash effect for on-site decoration purpose.
2. Don't turn on the fixture if it's been through severe temperature difference like after transportation because it might damage the light due to the environment changes. So make sure to operate the fixture until it is in normal temperature.
3. This light should be kept away from strong shaking during any transportation or movement.
4. Don't pull up the light by only the head, or it might cause damages to the mechanical parts.
5. Don't expose the fixture in overheat, moisture or environment with too much dust when installing it. And don't lay any power cables on the floor. Or it might cause electronic shock to the people.
6. Make sure the installation place is in good safety condition before installing the fixture.
7. Make sure to put the safety chain and check whether the screws are screwed properly when installing the fixture.
8. Make sure the lens are in good condition. It's recommended to replace the units if there are any damages or severe scratch.
9. Make sure the fixture is operated by qualified personnel who knows the fixture before using.
10. Keep the original packages if any second shipment is needed.
11. Don't try to change the fixtures without any instruction by the manufacturer or the appointed service centers.
12. It is not in warranty range if there are any malfunctions from not following the user manual to operate or any illegal operation, like shock short circuit, electronic shock, lamp broke, etc.

After removing the packaging, check if the device was not damaged during transport. Before connecting to the mains, make sure that the device is securely mounted. The manufacturer is not responsible for damage caused by unstable mounting.

Ensure proper connection to the mains and proper grounding. Make sure that the electrical parameters are consistent with device requirements. All activities, including connecting the device to the mains must be performed by qualified personnel.

CAUTION! For added protection mount the fixtures in areas outside walking paths, seating areas, or in areas where the fixture might be reached by unauthorized personnel.

Before mounting the fixture to any surface, make sure that the installation area can hold a minimum point load of 10 times the device's weight.

Fixture installation must always be secured with a secondary safety attachment, such as an appropriate safety cable.

Never stand directly below the device when mounting, removing, or servicing the fixture from a periodic safety inspection of all installation material and the fixture. If you lack these qualifications, do not attempt the installation yourself. Improper installation can result in bodily injury.

Be sure to complete all rigging and installation procedures before connecting the main power cord to the appropriate wall outlet.

Clamp Mounting: The LEDBEAM 120F provides a unique mounting bracket assembly that integrates the bottom of the base, the included “Omega Bracket,” and the safety cable rigging point in one unit (see the illustration below). When mounting this fixture to truss be sure to secure an appropriately rated clamp to the included omega bracket using a M10 screw fitted through the center hole of the “omega bracket”. As an added safety measure be sure to attached at least one properly rated safety cable to the fixture using on of the safety cable rigging point integrated in the base assembly.

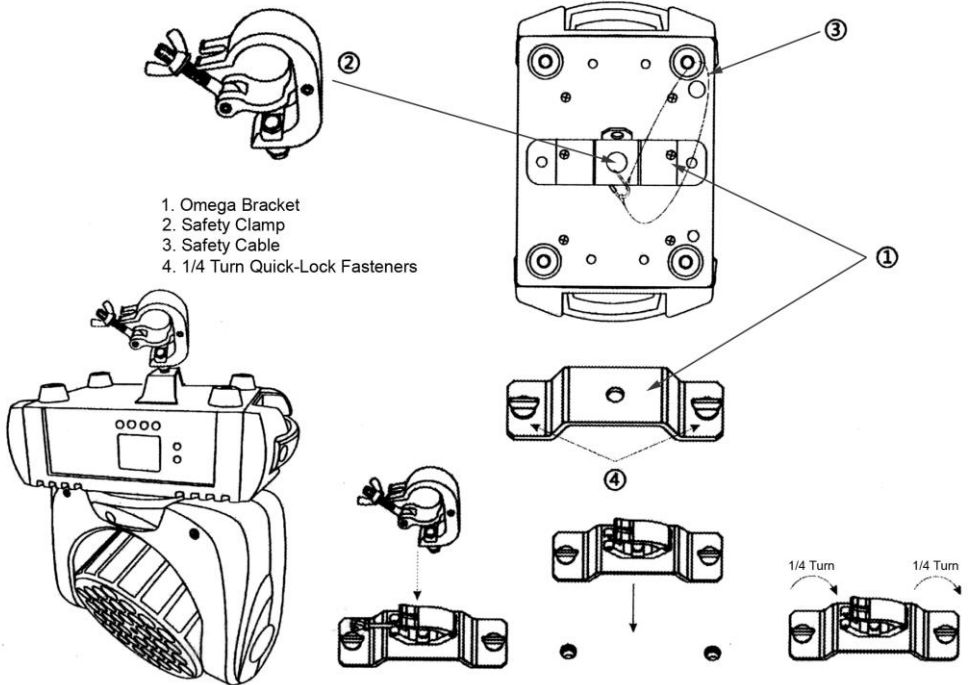

Regardless of the rigging option you choose for your LEDBEAM 120F, always be sure to secure your fixture with a safety cable. The fixture provides a built-in rigging point for a safety cable on the hanging bracket as illustrated above. Be sure to only use the designated rigging point for the safety cable and never secure a safety cable to a carrying handle.

5 CONNECTIONS

The device is equipped with the following interfaces:

1. DMX (in/out): XLR 3-pin socket
2. Power (in/out): powerCON socket

5.1 Connecting DMX signal

The connection is performed using cable with XLR-female -> XLR-Male plugs.

Connect the provided XLR cable to the female 3-pin XLR output of your controller and the other side to the male 3-pin XLR input of the moving head. You can chain multiple devices. The cable should be two core, screened cable with XLR input and output connectors. Please refer to the diagram below.

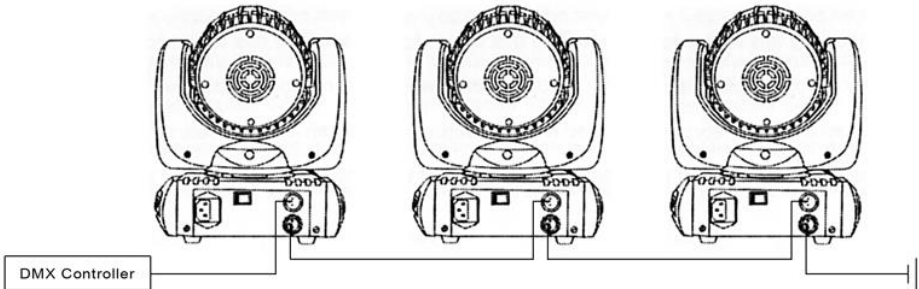
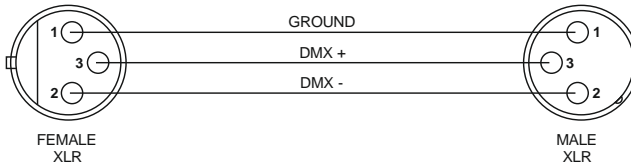

For installations where the DMX cable has to run a long distance or is in an electrically noisy environment, such as in a discotheque, it is recommended to use a DMX terminator. This helps in preventing corruption of the digital control signal by electrical noise. The DMX terminator is simply an XLR plug with a $120\ \Omega$ resistor connected between pins 2 and 3, which is then plugged into the output XLR socket of the last fixture in the chain. Please see illustrations below.

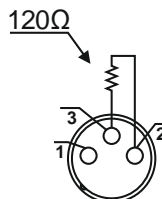

5.2 Voltage specification

Input Voltage	Total Power	Frequency
90~260V	100W	50/60Hz

5.3 Connecting power supply

The connection is performed using power cable with PowerCon connector (included).

The device must be operated by qualified personnel. Make sure that the power grid supply parameters are consistent with device parameters and limitations are not exceeded.

CAUTION! In the case of cable damage do not attempt to repair. Replacement or repair can be made only on the manufacturer or by a person with appropriate permissions.

6 MAINTENANCE AND CLEANING

The following points have to be considered during the inspection:

1. All screws for installing the devices or parts of the device have to be tightly connected and must not be corroded.
2. There must not be any deformations on the housing, color lenses, fixations and installation spots (ceiling, suspension, trussing).
3. Mechanically moved parts must not show any traces of wearing and must not rotate with unbalances.
4. The electric power supply cables must not show any damage, material fatigue or sediments.
5. Further instructions depending on the installation spot and usage have to be adhered by a skilled installer and any safety problems have to be removed.

CAUTION! Disconnect from mains before starting maintenance operation.

In order to make the lights in good condition and extend the lifetime, we suggest a regular cleaning to the lights.

1. Clean the inside and outside lens each week to avoid the weakness of the lights due to accumulation of dust.
2. Clean the fan each week.
3. A detailed electric check by approved electrical engineer each three month, make sure that the circuit contacts are in good condition, prevent the poor contact of circuit from overheating.

We recommend a frequent cleaning of the device. Please use a moist, lint-free cloth. Never use alcohol or solvents. There are no serviceable parts inside the device. Please refer to the instructions under "Installation" instructions. If you need any spare parts, please order genuine parts from your local dealer.

7 OPERATION MANUAL

7.1 Control panel

The control panel is equipped with LCD display and 4 control buttons with the following functions:

1. MENU – go to next menu option
2. DOWN – edit value
3. UP – edit value
4. ENTER - confirm changes

7.2 Menu

Menu diagram:

DMX-MODE	→	17 Channels mode	CH17
		40 Channels mode	CH40
DMX-ADR	→	DMX address edit	001-512
ADJ-R	→	Adjust brightness for Red color	001-512
ADJ-G	→	Adjust brightness for Green color	001-512
ADJ-B	→	Adjust brightness for Blue color	001-512
ADJ-W	→	Adjust brightness for White color	001-512
PROGRAM	→	Inner program selection	001-018
ADJ-S	→	Inner program speed selection	001-016
TEST-MOD	→	Auto mode	AUTO-MD
		Sound mode	SOUND-MD
SLAVE	→	Slave mode off	OFF
		Slave mode on	ON

7.3 DMX channel list

17CH mode		
Channel	Function	Effect
CH 1	PAN	0-255
CH 2	TILT	0-255
CH 3	PAN fine	0-255
CH 4	TILT fine	0-255
CH 5	PAN/TILT speed	0-255
CH 6	Dimmer	0-255: 0-100%
CH 7	Strobe	0-255:1-20Hz
CH 8	Red	0-255: 0-100%
CH 9	Green	0-255: 0-100%
CH 10	Blue	0-255: 0-100%
CH 11	White	0-255: 0-100%
CH 12	Color selection	0-255: various colors
CH 13	Sequence effect	0-49: 7 50-79: 6 80-109: 5 110-149: 4 150-197: 3 180-209: 2 210-255: 1
CH 14	Program	0-74: No function 75-84: Program 01 85-94: Program 02 95-104: Program 03 105-114: Program 04 115-124: Program 05 125-134: Program 06 135-144: Program 07 145-154: Program 08 155-164: Program 09 165-174: Program 10 175-184: Program 11 185-194: Program 12 195-204: Program 13 205-214: Program 14 215-224: Program 15 225-234: Program 16 235-255: Program 17
CH 15	Program speed	0-255: fast to slow
CH 16	Operation	0-63: No function 64-127 + Wait 10s: Auto mode 128-191 + Wait 10s: Sound mode 192- + Wait 10s: Reset
CH 17		0-63: No function 64-127: X axis invert 128-191: Y axis invert 192-255: X and Y axis invert

40CH mode

Channel	Function	Effect
CH 1	PAN	0-255
CH 2	TILT	0-255
CH 3	PAN fine	0-255
CH 4	TILT fine	0-255
CH 5	PAN/TILT speed	0-255
CH 6	Dimmer	0-255: 0-100%
CH 7	Strobe	0-255:1-20Hz
CH 8	Section 1 - Red	0-255: 0-100%
CH 9	Section 1 - Green	0-255: 0-100%
CH 10	Section 1 - Blue	0-255: 0-100%
CH 11	Section 1 - White	0-255: 0-100%
CH 12	Section 2 - Red	0-255: 0-100%
CH 13	Section 2 - Green	0-255: 0-100%
CH 14	Section 2 - Blue	0-255: 0-100%
CH 15	Section 2 - White	0-255: 0-100%
CH 16	Section 3 - Red	0-255: 0-100%
CH 17	Section 3 - Green	0-255: 0-100%
CH 18	Section 3 - Blue	0-255: 0-100%
CH 19	Section 3 - White	0-255: 0-100%
CH 20	Section 4 - Red	0-255: 0-100%
CH 21	Section 4 - Green	0-255: 0-100%
CH 22	Section 4 - Blue	0-255: 0-100%
CH 23	Section 4 - White	0-255: 0-100%
CH 24	Section 5 - Red	0-255: 0-100%
CH 25	Section 5 - Green	0-255: 0-100%
CH 26	Section 5 - Blue	0-255: 0-100%
CH 27	Section 5 - White	0-255: 0-100%
CH 28	Section 6 - Red	0-255: 0-100%
CH 29	Section 6 - Green	0-255: 0-100%
CH 30	Section 6 - Blue	0-255: 0-100%
CH 31	Section 6 - White	0-255: 0-100%
CH 32	Section 7 - Red	0-255: 0-100%
CH 33	Section 7 - Green	0-255: 0-100%
CH 34	Section 7 - Blue	0-255: 0-100%
CH 35	Section 7 - White	0-255: 0-100%
CH 36	Color selection	0-255: various colors

CH 37	Program	0-74: No function 75-84: Program 01 85-94: Program 02 95-104: Program 03 105-114: Program 04 115-124: Program 05 125-134: Program 06 135-144: Program 07 145-154: Program 08 155-164: Program 09 165-174: Program 10 175-184: Program 11 185-194: Program 12 195-204: Program 13 205-214: Program 14 215-224: Program 15 225-234: Program 16 235-255: Program 17
CH 38	Program speed	0-255: fast to slow
CH 39	Operation	0-63: No function 64-127 + Wait 10s: Auto mode 128-191 + Wait 10s: Sound mode 192- + Wait 10s: Reset
CH 40	X/Y motor parameters	0-63: No function 64-127: X axis invert 128-191: Y axis invert 192-255: X and Y axis invert