

# THE NAVIGATOR



Fiji™

## FROZEN CONCOCTION MAKER™

*The Best Margaritas Come From Margaritaville®*

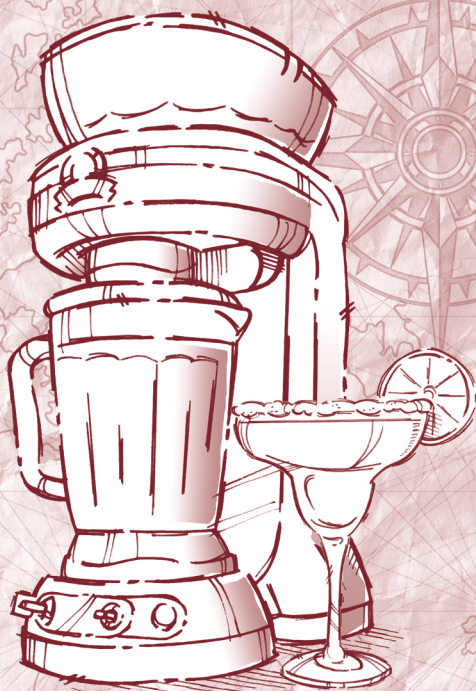

**Model DM2000-033** User Manual

# IMPORTANT SAFEGUARDS

WHEN USING ELECTRICAL APPLIANCES, BASIC SAFETY PRECAUTIONS SHOULD ALWAYS BE FOLLOWED, INCLUDING THE FOLLOWING:

1. **READ ALL INSTRUCTIONS BEFORE USING.**
2. To protect against electric shock, do not immerse appliance, cord or plug in water or other liquids.
3. Close supervision is necessary when any appliance is used near children. This appliance should not be used by children.
4. Unplug from outlet when not in use, before putting on or taking off parts, and before cleaning.
5. Power Indicator Light flashes when unit is plugged in to indicate ready for use. Avoid contact with blades or moveable parts.
6. Do not operate any appliance with damaged cord or plug or after the appliance malfunctions, or is dropped or damaged in any manner. Contact 1-800-667-8623 for customer service.
7. Do not use outdoors.
8. Do not let cord hang over the edge of a table or counter, or touch hot surfaces, including the stove.
9. Keep hands and utensils out of container while blending and/or ice shaving to reduce risk of severe injury to persons or damage to the unit. A rubber spatula may be used but must be used only when the appliance is not running.
10. Blades are sharp; handle carefully.
11. Always operate appliance with Jar Lid and Ice Reservoir Lid in place.
12. The use of attachments not recommended or sold by the manufacturer may cause fire, electric shock or injury.
13. Do not use broken, chipped, or cracked Blending Jar or Ice Reservoir.
14. To reduce risk of injury to persons, never place blending blade assembly on base without the Glass Blending Jar properly attached.
15. Do not leave appliance unattended while it is operating.

16. To disconnect, turn control to off, then remove plug from wall outlet.
17. Do not use appliance for other than intended use.
18. Never place fingers or other utensils into feed or discharge areas.
19. Check Ice Reservoir for presence of foreign objects before using.
20. Be certain the Jar Lid and Ice Reservoir Lid are securely locked in place before operating appliance.
21. Do not blend hot liquids.

**NOTE: NEVER SHAKE OR REMOVE BLENDER JAR DURING OPERATION AS JAR BLADE ASSEMBLY CAN GET DAMAGED.**

## **SAVE THESE INSTRUCTIONS FOR HOUSEHOLD USE ONLY**

### **Grounded Plug**

This appliance is equipped with a 3-prong plug. This is a safety feature intended to help reduce the risk of electrical shock. If you are unable to insert the plug into the outlet, contact a qualified electrician to replace the obsolete outlet. Do not attempt to defeat the safety purpose of the 3-prong plug by modifying the plug in any way.

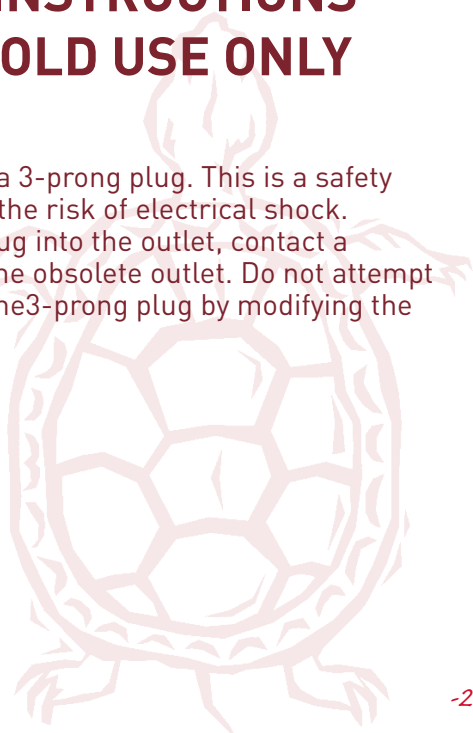



# WELCOME

*Congratulations on your purchase of the Margaritaville®  
Frozen Concoction Maker™ – DM2000-033*

To learn more about Margaritaville® products,  
please visit us at [www.margaritavillecargo.com](http://www.margaritavillecargo.com).

## FROZEN CONCOCTION MAKER™

### PARTS LIST

- 1 Ice Reservoir Lid** – Covers the Ice Reservoir.
- 2 Ice Reservoir** – Holds the ice for making frozen drinks.
- 3 Shaving Paddle** – Moves ice across the Shaving Blade.
- 4 Ice Hopper**
- 4a Ice Hopper (ice deflector blade assembly)** – Feeds ice from reservoir to Shaving Blade.
- 5 Ice Shaving Blade** – Shaves ice.
- 5a Ice Shaving Blade with deflector** – Shaves ice.
- 6 Shaving Blade Assembly Nut** – Holds Shaving Blade in place.
- 6a U-Lock** – Holds Shaving Blade in place.
- 7 Ice Chute** – Directs ice from Ice Hopper into Blending Jar.
- 8 Blending Base** – Holds Blending Jar securely in place.
- 9 Control Panel** – Contains all necessary controls to operate your unit.
- 10 On/Off Switch.**

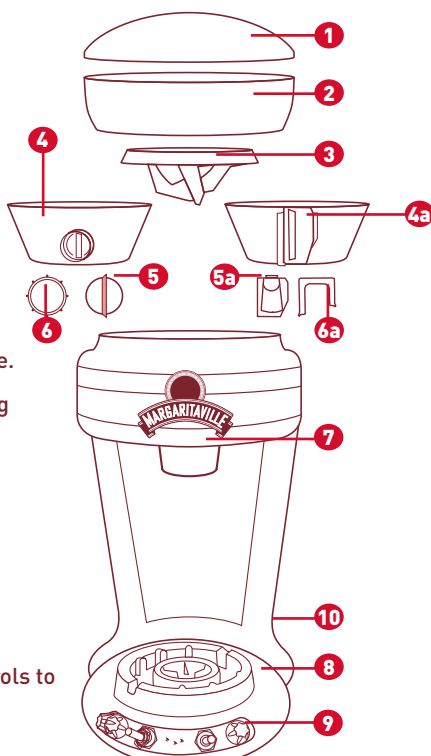

- 11 Jar Lid** – Seals the blending jar.
- 12 Blending Jar** – Maximum capacity of 36 oz.
- 13 Blending Blade Sealing Ring** – Seals the blending jar and blending base.
- 14 Blending Blade** – Creates forward action when blending drinks.
- 15 Jar Base** – Designed with wide base for stability.

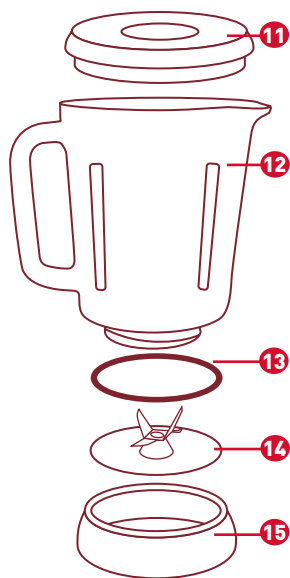

- 16 Ice Reservoir Release Button** – Releases ice reservoir from unit.
- 17 Ice Melt Reservoir** – Contains melted ice excess.
- 18 Cord Storage Door** – Covers power cord storage area.

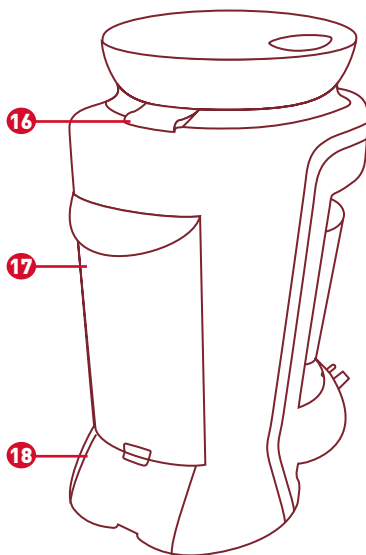

# CONTROL PANEL

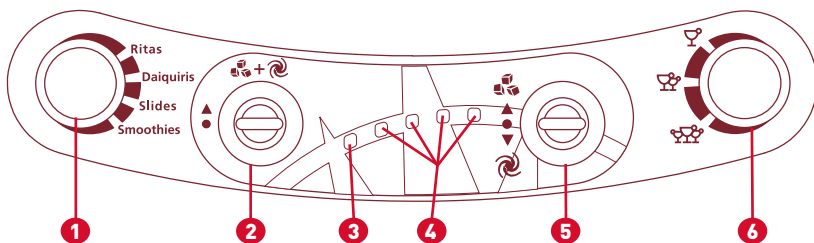

- 1 Drink Selector Rotary Switch** – Selects from 4 different types of drinks.
  - **Ritas** – liquid ingredients only
  - **Daiquiris** – liquid ingredients + frozen fruit
  - **Slides**– liquid ingredients + ice cream
  - **Smoothies** – liquid ingredients + fresh fruit
- 2 Shave 'n Blend™ Toggle Switch** – Used to select automatic Shave 'n Blend™ cycle.
- 3 Power Indicator Light** – Blinks when unit is plugged in to indicate ready for use. Avoid contact with blades or moveable parts.
- 4 Progress Indicator Lights** – Shows status of Shave 'n Blend™ cycle.
- 5 Blend Only/Shave Only Toggle Switch** – Used to manually operate ice shaver and blender.
- 6 Number of Drinks Rotary Switch** – used to select 1, 2 or 3 twelve oz. frozen drinks.

# MAKING FROZEN DRINKS

1. Place the unit on a clean dry flat surface.
2. Place the Ice Reservoir on the unit front first, then push down firmly on back. Reservoir must click into place. *Figure 1*

**NOTE: IF ICE RESERVOIR IS NOT SEATED FIRMLY IN PLACE THE UNIT WILL NOT OPERATE.**

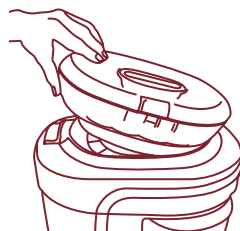

*Figure 1*

3. Remove the Cord Storage Door by pushing down on the release tab located on the Cord Storage Door. Remove the power cord and plug the unit into a standard 120 Volt wall socket. Replace the cord storage door and position the power cord in the slot below the cord storage release tab. *Figure 2*

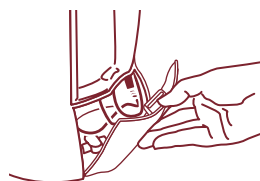
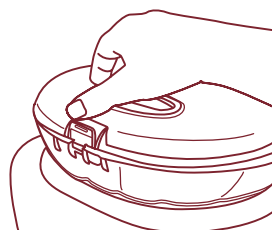

*Figure 2*

4. Remove the Ice Reservoir Lid using the Release Button located on the top of the Ice Reservoir. *Figure 3*

**NOTE: NEVER PUT ANYTHING BUT ICE IN THE ICE RESERVOIR.**

5. Fill the Ice Reservoir with ice cubes. *Figure 4*
6. Replace the Ice Reservoir Lid and snap closed.
7. Lift and remove the Blending Jar. The Ice Chute is spring-loaded and can be pushed up.
8. Remove Blending Jar Lid.
9. Add appropriate amount of ingredients to the Blending Jar for the number of drinks being made (1, 2 or 3).



*Figure 3*



*Figure 4*

## The Best Margarita Recipe – “Ritas”

Ingredients	Amount (12 fluid oz drink)					
	1 Drink		2 Drinks		3 Drinks	
	fl oz	ml	fl oz	ml	fl oz	ml
Margaritaville® Gold Tequila	1 1/3	40	2 2/3	80	4	120
Triple Sec	1/3	10	2/3	20	1	30
Lime Juice	2/3	20	1 1/3	40	2	60
Orange Juice	2/3	20	1 1/3	40	2	60
Margaritaville® Margarita Mix	1 1/3	40	2 2/3	80	4	120

## The Best Daiquiri Recipe – “Daiquiris”

Ingredients	Amount (12 fluid oz drink)					
	1 Drink		2 Drinks		3 Drinks	
	fl oz	ml	fl oz	ml	fl oz	ml
Light Rum	1.5	45	3	90	4.5	135
Sugar	1Tbs	15	2Tbs	30	3Tbs	66.5
Cranberry Juice	3	90	6	180	9	270
Frozen Strawberries	2/3C	157	1 1/3C	315	2C	473

## The Best Slide Recipe – “Slides”

Ingredients	Amount (12 fluid oz drink)					
	1 Drink		2 Drinks		3 Drinks	
	fl oz	ml	fl oz	ml	fl oz	ml
Bailey's Irish Cream	1 1/3	40	2 2/3	80	4	120
Kahlua	1 1/3	40	2 2/3	80	4	120
Vanilla Ice Cream	4Tbs	59	8Tbs	118	12Tbs	177
Chocolate Syrup	2/3	20	2/3	40	2	60

## The Best Smoothie Recipe – “Smoothies”

Ingredients	Amount (12 fluid oz drink)					
	1 Drink		2 Drinks		3 Drinks	
	fl oz	ml	fl oz	ml	fl oz	ml
Raspberry Sherbert Ice Cream	4Tbs	59	8Tbs	118	12Tbs	177.5
Pineapple Juice	3	90	6	180	9	270
Fresh Strawberries	1/2C	118	1C	236	1 1/2C	355

C=cups Tbs=Tablespoons

10. Replace Blending Jar Lid and return Blending Jar to Blending Base by pushing up on the Ice Chute with the Blending Jar and then placing it on the Blending Base.

11. Set the Number of Drinks Rotary Switch to correspond to the number of drinks being made.

12. Select the type of drink to be made by turning the drink selector rotary switch to the desired setting.

13. Turn the ON/OFF switch (located at the right side of unit) to the ON position.

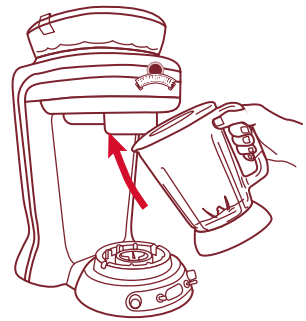

**NOTE: NEVER SHAKE OR REMOVE JAR DURING OPERATION  
– BLADE ASSEMBLY WILL GET DAMAGED.**

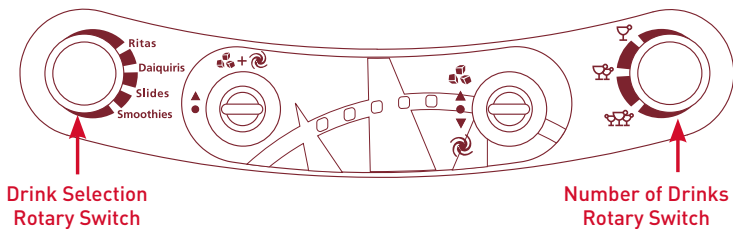

## Automated Shave 'n Blend™ Cycle

14. Start the automatic shave and blend cycle by pushing up on the Shave 'n Blend™ Toggle Switch.
15. The unit will shave ice for the appropriate time. The blender will start automatically. The unit will stop at the completion of the cycle.

**NOTE: DURING THE SHAVE AND BLEND CYCLE THE PROGRESS INDICATOR LIGHTS WILL ILLUMINATE IN A SEQUENCE FROM LEFT TO RIGHT TO INDICATE THE CYCLE PROGRESS. DO NOT REMOVE THE BLENDING JAR WHILE THE PROGRESS INDICATOR LIGHTS ARE ILLUMINATED.**

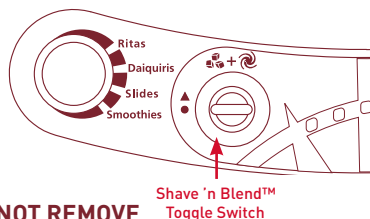

16. The Power Indicator Light will blink to indicate the unit is ready to make more drinks. Avoid any contact with blades or moveable parts.
17. To serve:
  - a. Lift and remove the Blending Jar.
  - b. Remove Blending Jar Lid.
  - c. Pour and enjoy.



**NOTE: TO REMOVE EXCESS ICE FROM THE ICE RESERVOIR HOLD THE SHAPE ONLY TOGGLE SWITCH IN THE SHAPE ONLY POSITION UNTIL THE ICE RESERVOIR IS EMPTY. WARNING: DO NOT PLACE FINGERS IN THE ICE HOPPER THE SHAVING BLADE IS SHARP AND COULD CAUSE INJURY.**

18. Turn off the unit.
19. Periodically check the Ice Melt reservoir and empty as needed.

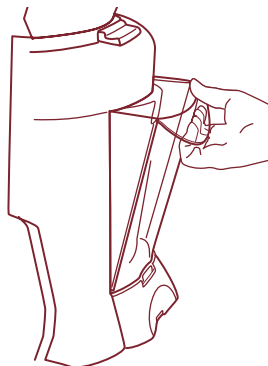

## Manual Cycle

### To make a thicker drink:

- Hold the “Blend Only/Shave Only” Toggle Switch in the Shave Only position to add more ice to the Blending Jar.
- To stop adding ice, release the toggle switch.
- To mix the newly added ice into the drink, hold the Blend Only/Shave Only Toggle Switch in the blend only position until the desired consistency is achieved. To stop the blending release the toggle switch.
- Use less drink mixer than in recipe.  
(example: for 3 drinks, use 9 oz. liquid content)

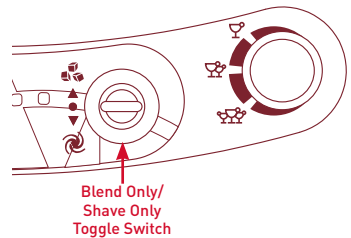

### To make a thinner drink:

- Hold the Blend Only/Shave Only Toggle Switch in the Blend Only position until the desired consistency is achieved.
- To stop blending release the toggle switch.
- Add more drink mixer than in recipe  
(example: for 3 drinks, use 10.5 oz. of total mix)

# CLEANING AND MAINTENANCE

**IMPORTANT:** Your Blending Jar, Shaving and Blending Blades are subject to wear during normal use. Always inspect for nicks, chips, or cracks. Always inspect for broken, cracked, or loose blades. If the jar or Shaving and Blending Blades are damaged, do not use. Call our toll-free customer service number, 1-800-667-8623, to obtain replacement parts.

1. Make sure unit is unplugged. Place on a clean dry surface. Turn the unit so the back is facing you. Push down on the Ice Reservoir Release Button. Lift the back of the Ice Reservoir and remove. This will expose the Shaving Paddle and Ice Hopper. *Figure 1*

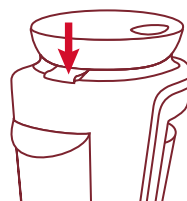
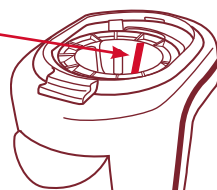

*Figure 1*

Note the location of the Shaving Blade inside the Ice Hopper. *Figure 2*

**WARNING: DO NOT PLACE FINGERS INSIDE THE ICE HOPPER NEAR THE SHAVING BLADE. BLADE IS SHARP HANDLE CAREFULLY.**

**SHAVING  
BLADE**



*Figure 2*

2. To Remove the Shaving Paddle: Press the button located behind the Ice Chute. If the button cannot be pressed, rotate the Shaving Paddle for a half turn and retry.

**While pressing the button, rotate the Shaving Paddle counter-clockwise (to the left) by placing fingers in the ridges of the Shaving Paddle and unscrew. This will expose the Ice Hopper and Shaving Blade. *Figure 3***

To re-assemble the Shaving Paddle, simply replace it into the threaded insert and rotate clockwise. Hand tighten only.



*Figure 3*

3. Press the two Ice Hopper release catches and lift the Ice Hopper to remove. *Figure 4*
4. Remove the ice deflector blade assembly by pushing and sliding the u-lock upwards. Pull the ice deflector blade from the ice hopper and store in a safe place. *Figure 5*

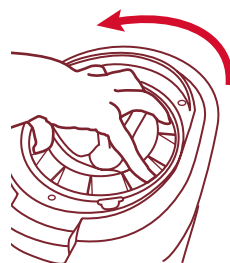

*Figure 4*

**IMPORTANT: YOUR ICE HOPPER COMES WITH ONE OF TWO TYPES OF SHAVING BLADE ASSEMBLIES**

- a. Shaving blade assembly nut
- b. Ice deflector blade assembly

**PLEASE FOLLOW THE BELOW INSTRUCTIONS TO SAFELY REMOVE THE SHAVING BLADE ASSEMBLY FROM THE ICE HOPPER**

- 4a. Turn the shaving blade assembly nut counter clockwise (to the left) and remove, then remove the Shaving Blade and store in a safe place
- 4b. To remove the ice deflector blade assembly, push and slide the u-lock upwards and pull the ice deflector blade from the ice hopper and store in a safe place.

**BE SURE TO RINSE THE SHAVING BLADE AND DRY THOROUGHLY BEFORE STORAGE**

- 5. Carefully lift the Glass Blending Jar straight up to remove. The Ice Chute is spring-loaded and can be pushed up. If the Blending Jar is not easily removed, rock gently and lift. Do not twist. *Figure 5*
- 6. Turn the Blending Jar upside down and unscrew the Jar Base counter clockwise (to the left). Carefully remove the Blending Blade, and Blending Blade Sealing Ring.

**WARNING: THE BLENDING BLADE IS SHARP. HANDLE WITH CARE.**

- 7. To remove the Ice Melt Reservoir hold the unit still and pull straight out on the handle. *Figure 7*
- 8. The Ice Reservoir Lid, Ice Reservoir, Shaving Paddle, Ice Hopper, Shaving Blade Assembly Nut, Shaving Blade, Blending Jar Lid, Blending Jar, Blending Blade, Blending Blade Sealing Ring, Jar Base and Ice Melt Reservoir can be safely washed in the top rack of your dishwasher. Use only top rack. Failure to do so will result in damage.
- 9. Use a damp cloth to clean the outside of the unit.

**WARNING: UNPLUG UNIT BEFORE CLEANING. DO NOT USE SOLVENTS. NEVER IMMERSE THE UNIT IN WATER.**

- 10. Clean the inside walls of the ice chute with a damp cloth after every use.

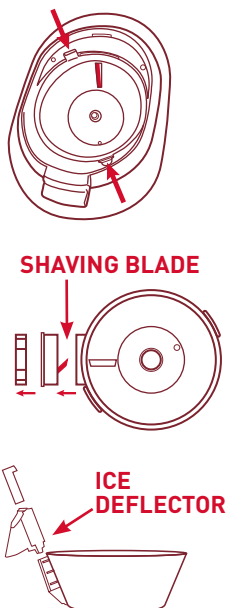

*Figure 5*

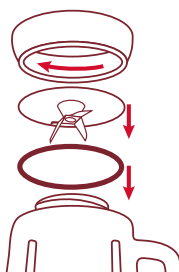

*Figure 6*

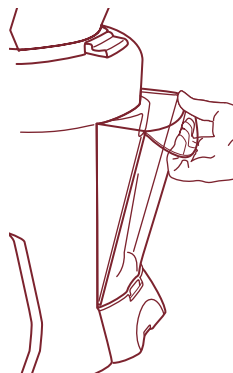

*Figure 7*

## Troubleshooting

---

**If the Power Indicator Light does not light:**

Check that the unit is plugged into a working power outlet.

---

**If liquid leaks from the base of the Blending Jar:**

Remove it from the unit and check that the Blending Blade Sealing Ring is properly installed and that the Blending Jar Base is tightened.

---

**If water leaks from the unit:** Empty the Ice Melt Reservoir and make sure reservoir is in place.

---

**If the Blending Jar overflows during the Shave 'n Blend™ cycle:**

Follow the drink recipes included in “making frozen drinks” section and make sure to not exceed the specified total volume.

---

**If the Blending Jar will not sit on the Blending Base:**

Remove it from the unit and check for ice on the Blending Base.

**WARNING:** unplug the unit before removing ice from the Blending Base.

---

**If the shaver does not shave sufficient ice for the liquid in the Blending Jar:**

Check that the Number of Drinks Rotary Switch setting corresponds to the amount of liquid in the Blending Jar.

---

**If the drink is too watery:** Make sure to follow the recipe guide (pg.6) or manually shave more ice until the desired consistency is achieved.

---

## Dos and Don'ts

---

**DO NOT** Place fingers into the Blending Jar or Ice Hopper. The blades in this unit are sharp and could cause injury.

---

**DO NOT** place Blending Jar onto Blending Base while motor is running. The spinning Blending Base could damage the Blending Jar.

---

**DO NOT** twist Blending Jar when removing. Simply lift and remove. Twisting the Blending Jar could loosen the Blending Jar Base causing it to leak.

---

**DO NOT** put hot liquid into the Blending Jar. Hot liquids could be ejected during the blending process causing injury.

---

**DO NOT** place ice, frozen foods or very cold liquids into a Blending Jar which has come directly from a hot dishwasher. The sudden change in temperature could cause the Blending Jar to crack.

---

**DO NOT** place very hot liquids or foods into a Blending Jar that has come directly from the freezer. The sudden change in temperature could cause the Blending Jar to crack.

---

**DO** Follow the Cleaning and Maintenance instructions prior to your first use.

---

**DO** unplug the unit when not in use.

---

## **1 Year Limited Warranty**

Sunbeam Products, Inc. doing business as Jarden Consumer Solutions or if in Canada, Sunbeam Corporation (Canada) Limited doing business as Jarden Consumer Solutions (collectively "JCS") warrants that for a period of one year from the date of purchase, this product will be free from defects in material and workmanship. JCS, at its option, will repair or replace this product or any component of the product found to be defective during the warranty period.

Replacement will be made with a new or remanufactured product or component. If the product is no longer available, replacement may be made with a similar product of equal or greater value. This is your exclusive warranty. Do NOT attempt to repair or adjust any electrical or mechanical functions on this product. Doing so will void this warranty.

This warranty is valid for the original retail purchaser from the date of initial retail purchase and is not transferable. Keep the original sales receipt. Proof of purchase is required to obtain warranty performance. JCS dealers, service centers, or retail stores selling JCS products do not have the right to alter, modify or any way change the terms and conditions of this warranty.

This warranty does not cover normal wear of parts or damage resulting from any of the following: negligent use or misuse of the product, use on improper voltage or current, use contrary to the operating instructions, disassembly, repair or alteration by anyone other than JCS or an authorized JCS service center. Further, the warranty does not cover: Acts of God, such as fire, flood, hurricanes and tornadoes.

### **What are the limits on JCS's Liability?**

JCS shall not be liable for any incidental or consequential damages caused by the breach of any express, implied or statutory warranty or condition.

Except to the extent prohibited by applicable law, any implied warranty or condition of merchantability or fitness for a particular purpose is limited in duration to the duration of the above warranty.

JCS disclaims all other warranties, conditions or representations, express, implied, statutory or otherwise.

JCS shall not be liable for any damages of any kind resulting from the purchase, use or misuse of, or inability to use the product including incidental, special, consequential or similar damages or loss of profits, or for any breach of contract, fundamental or otherwise, or for any claim brought against purchaser by any other party.

Some provinces, states or jurisdictions do not allow the exclusion or limitation of incidental or consequential damages or limitations on how long an implied warranty lasts, so the above limitations or exclusion may not apply to you.

This warranty gives you specific legal rights, and you may also have other rights that vary from province to province, state to state or jurisdiction to jurisdiction.

### **How to Obtain Warranty Service**

If you have any question regarding this warranty or would like to obtain warranty service, please call 1-800-667-8623 and a convenient service center address will be provided to you.

In the U.S.A., this warranty is offered by Sunbeam Products, Inc. doing business as Jarden Consumer Solutions located in Boca Raton, Florida 33431. In Canada, this warranty is offered by Sunbeam Corporation (Canada) Limited doing business as Jarden Consumer Solutions, located at 20 B Hereford Street, Brampton, Ontario L6Y 0M1. If you have any other problem or claim in connection with this product, please write our Consumer Service Department.

**PLEASE DO NOT RETURN THIS PRODUCT TO ANY OF THESE ADDRESSES  
OR TO THE PLACE OF PURCHASE.**



**DO NOT RETURN THIS PRODUCT TO THE PLACE OF PURCHASE**

For product questions:

Sunbeam consumer services

Canada 1-800-667-8623

[www.margaritavillecargo.com](http://www.margaritavillecargo.com)

©2012 Sunbeam Products, Inc. doing business as Jarden Consumer Solutions. All rights reserved. Imported and distributed by Sunbeam Corporation (Canada) Limited doing business as Jarden Consumer Solutions, 20B Hereford Street, Brampton, Ontario L6Y 0M1.

Margaritaville® is a registered trademark of Margaritaville®.

Printed in China

P. N. 161861