

DVR

SHA Series

SUPPORT MANUAL

Contents

Mobile Device Access	4
Android® Phones.....	4
Blackberry® Phones	6
iPhone® Phones	8
Symbian® Phones.....	11
Windows® Mobile Phones.....	13
Supported Devices List	15
HDD Spported List.....	15
USB Device Support List.....	16
Supported Mobile Phones	16

Mobile Device Access

The DVR can be remotely viewed and controlled on your mobile phone using the utility software. The utility software is included on the supplied CD-ROM. However, for the latest software version, it is recommended to download the utility software from your mobile phone's download application.

Installation and software interface vary depending on the mobile phone. See succeeding sections for further instructions.

Android® Phones

Installing the Utility Software

1 Make sure your mobile phone is connected to the Internet (either by mobile data connection or Wi-Fi).

2 Open the **Android Market** application and search to download **Asee**.

2a. On the Market search bar, enter “**Asee**” to search for the application.

2b. Select and download the application.

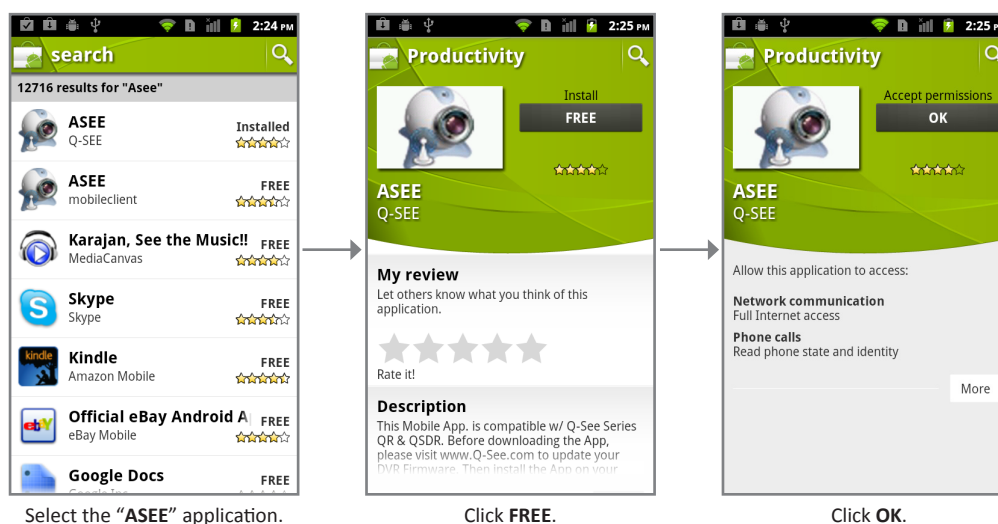
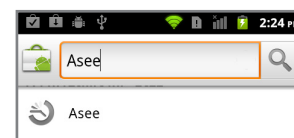

Select the “Asee” application.

Click **FREE**.

Click **OK**.

The utility software icon is displayed on the application screen.

3 Click the icon to open the utility software.

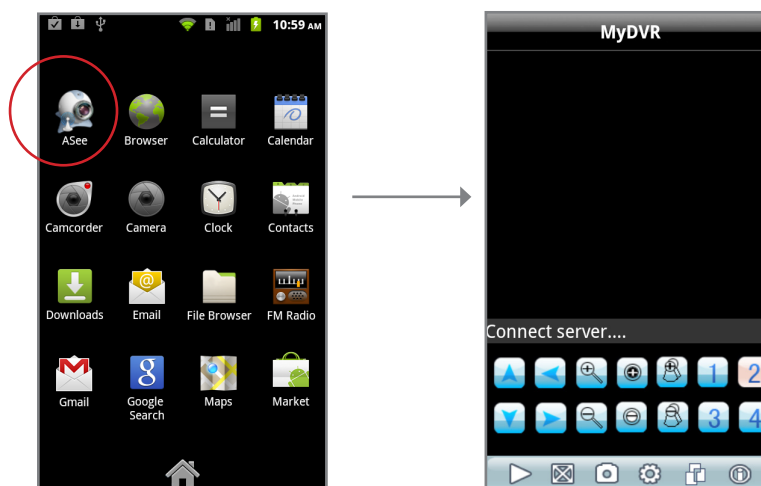

4 Click  to open the Settings page and enter the required settings.

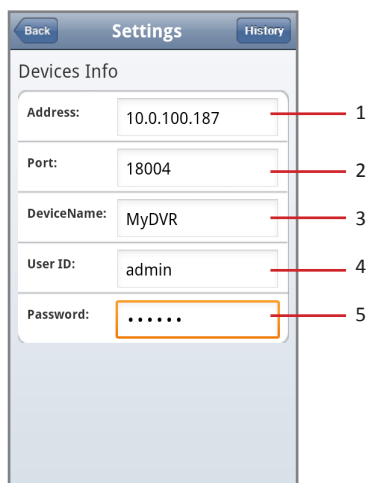

Back Settings History

Devices Info

Address: 10.0.100.187 1

Port: 18004 2

DeviceName: MyDVR 3

User ID: admin 4











Password: 5



No.	Item	Description
1	Address	Enter the IP address assigned to the DVR. Consult your network administrator or ISP to obtain this information.
2	Port	Enter the server port number that you configured in the DVR menu. Refer to your DVR User Manual for details.
3	Device Name	Enter the desired DVR name.
4	User ID	Enter the user name that you configured in the DVR menu. Refer to your DVR User Manual for details.
5	Password	Enter the password that you configured in the DVR menu. Refer to your DVR User Manual for details.

5 Click **Back** to view the main screen.

Using the Utility Software



No.	Item	Icon	Description
1	Display Screen	-	Displays the channel.
2	PTZ Control Buttons	     	<p>Click the arrow buttons to move the camera direction (for PTZ camera only).</p> <p>Click the icons to adjust the zoom (for PTZ camera only).</p> <p>Click the icons to adjust the aperture (for PTZ camera only).</p> <p>Click to adjust the camera focus (for PTZ camera only).</p>
3	Play/Pause Button		Click to play or pause channel viewing.
	Full Screen Button		Click to view the channel in full screen.
	Capture Button		Click to capture the screen shot. The screen shot is saved in the path sdcard\MeyePic .
	Settings Button		Click to open the Settings page.
	Toggle Button		Click to view more channel buttons.

No.	Item	Icon	Description
3	About Button		Click to view the software information.
4	Channel Buttons		Click a channel button to view on the display screen. More channel buttons are available by clicking  .

Blackberry® Phones

Installing the Utility Software

1 Make sure your mobile phone is connected to the Internet (mobile data connection or preferably by Wi-Fi).

2 Open the **App World** application.

2a. Search for “Asee”.

2b. Select and download the application.

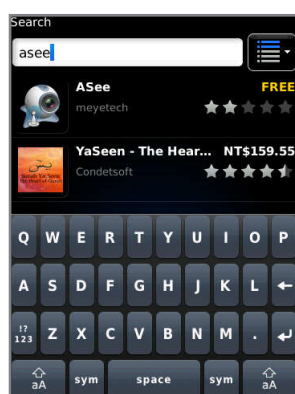
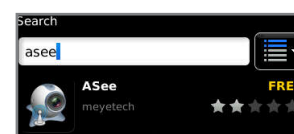

Select the “ASee” application.

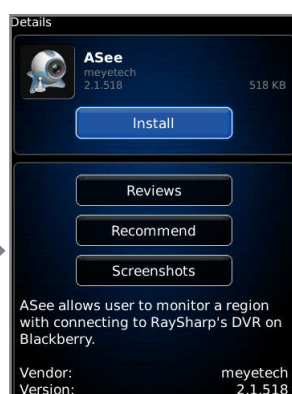

Click **Install**.

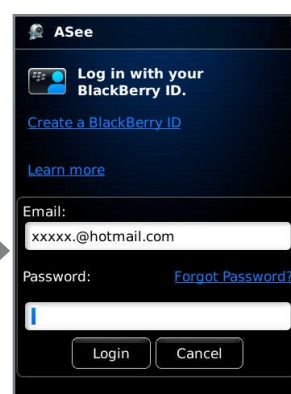

Login with your **BlackBerry ID**.

3 After installation, click the utility  icon to open the application.

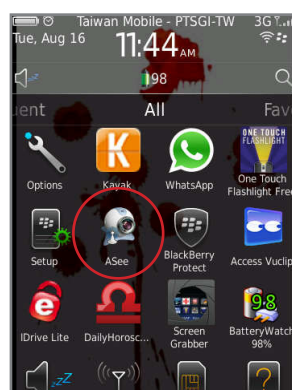

4 On the Setting page, enter the necessary settings.

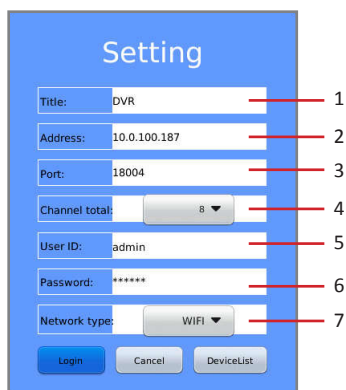

No.	Item	Description
1	Title	Enter the desired DVR name.
2	Address	Enter the IP address assigned to the DVR. Consult your network administrator or ISP to obtain this information.
3	Port	Enter the server port number that you configured in the DVR menu. Refer to your DVR User Manual for details.
4	Channel Total	Select the DVR maximum channel capacity.
5	User ID	Enter the user name that you configured in the DVR menu. Refer to your DVR User Manual for details.
6	Password	Enter the password that you configured in the DVR menu. Refer to your DVR User Manual for details.
7	Network Type	Select the network to use to connect to the DVR (WiFi/3G).

5 Click **Login** to view the main screen.

Using the Utility Software

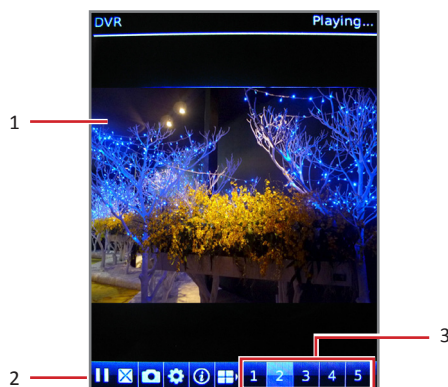

No.	Item	Icon	Description
1	Display Screen	-	Displays the channel.
2	Play/Pause Button		Click to play or pause channel viewing.
	Full Screen Button		Click to view the channel in full screen.
	Capture Button		Click to capture the screen shot and then select the storage memory where to save the image file.
	Settings Button		Click to open the Settings page.
	About Button		Click to view the software information.
	Toggle Button		Click to view other channel buttons or the PTZ control buttons.
3	Channel Buttons		Click a channel button to view on the display screen. More channel buttons are available by clicking .
	PTZ Control Buttons		Click the arrow buttons to move the camera direction (for PTZ camera only).
			Click the icons to adjust the zoom (for PTZ camera only).
			Click the icons to adjust the aperture (for PTZ camera only).
			Click to adjust the camera focus (for PTZ camera only).

iPhone® Phones

Installing the Utility Software

1 Make sure your mobile phone is connected to the Internet (either by mobile data connection or Wi-Fi).

2 Open the **App Store** application and search to download **Asee+**.

2a. On the search bar, enter “**Asee+**” to search for the application.

2b. Select and download the application.

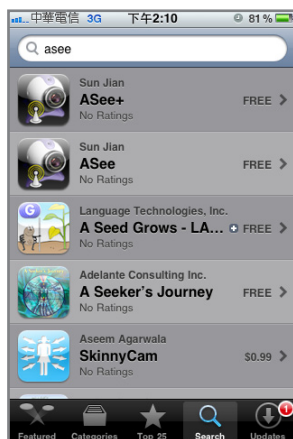

Select the “Asee+” application.



Click **FREE**.



Click **INSTALL**.

You may be asked to login with your iTunes account to continue. After download, the utility software icon is displayed on the application screen.

3 Click the icon to open the utility software.



4 Click  to open the Device Manage page, then click **Add**.

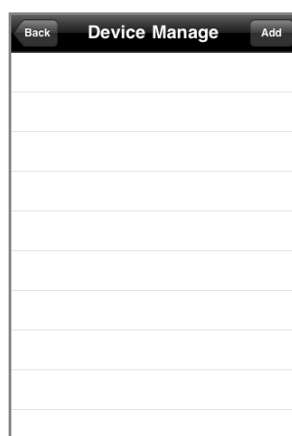

5 Enter the required settings.

Device Name: DVR 1
Address: 10.0.100.187 2
Port: 10080 3
User ID: admin 4
Password: 5
Max Channel: 8 6

OK Cancel

No.	Item	Description
1	Device Name	Enter the desired DVR name.
2	Address	Enter the IP address assigned to the DVR. Consult your network administrator or ISP to obtain this information.
3	Port	Enter the server port number that you configured in the DVR menu. Refer to your DVR User Manual for details.
4	User ID	Enter the user name that you configured in the DVR menu. Refer to your DVR User Manual for details.
5	Password	Enter the password that you configured in the DVR menu. Refer to your DVR User Manual for details.
6	Max Channel	Enter the maximum channels that can be connected to the DVR.

5 Click **OK**. The Device Manage screen appears again. Click the device name to view the main screen.

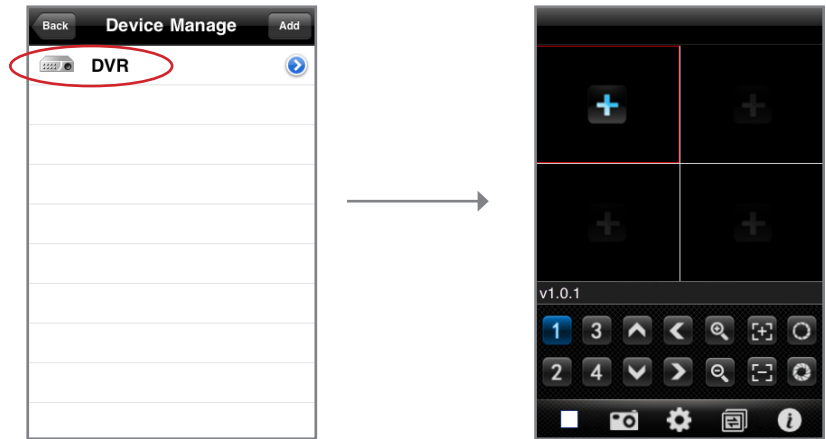

Using the Utility Software

Viewing Channels

To view channels on your iPhone, you must assign a channel to the window first. To do this perform the following:

1 Click **+** of the window to assign a channel. The Device List screen appears. Click **>** to display the channel list.



- 2 Click a channel to assign to the window.
- 3 Repeat the above procedures to assign other windows.

Switching Screen Modes

By default, the channels are displayed on a 4-window display. To view a channel in full screen, double-tap the window.

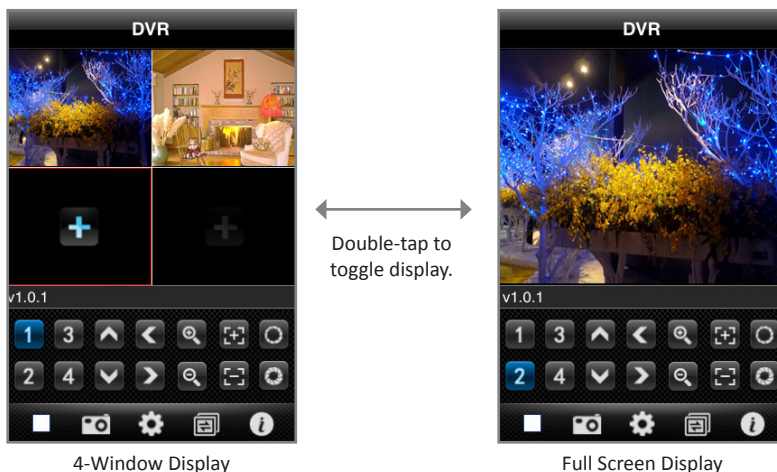

Other Functions



No.	Item	Icon	Description
1	Display Screen	-	Displays the channels.
2	Channel Buttons		When in full screen mode, click a channel button to view the channel. More channel buttons are available by clicking
3	Stop Button		Click to stop viewing channels.
	Capture Button		Click to capture the screen shot. The screen shot is saved in the photo album.
	Settings Button		Click to open the Device Manage screen. To adjust settings, click
	Toggle Button		Click to view more channel buttons.
	About Button		Click to view the software information.
4	PTZ Control Buttons		Click the arrow buttons to move the camera direction (for PTZ camera only).
			Click the icons to adjust the zoom (for PTZ camera only).
			Click the icons to adjust the aperture (for PTZ camera only).
			Click to adjust the camera focus (for PTZ camera only).

Symbian® Phones

Installing the Utility Software

1 Make sure your mobile phone is connected to the Internet (either by mobile data connection or Wi-Fi).

2 Open the **Ovi Store** application and search to download **Asee**.

2a. On the search bar, enter “**Asee**” to search for the application.

2b. Select and download the application.

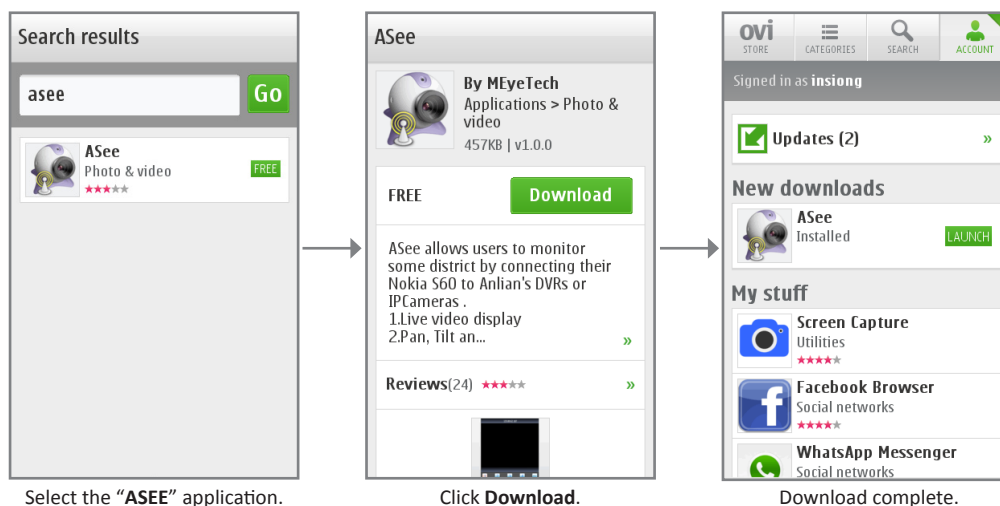

Select the “ASee” application.

Click **Download**.

Download complete.



Note:

Depending on your mobile phone settings, the phone may prompt you to select the type of network connection before proceeding.

3 Click **Launch** from the Ovi screen or click the  icon from the application menu to open the utility software.

4 Click  to open the Settings page and enter the required settings.

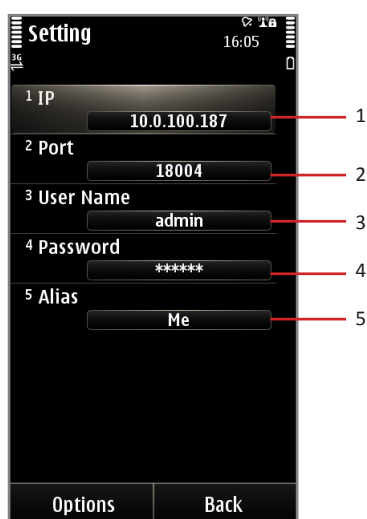

No.	Item	Description
1	IP	Enter the IP address assigned to the DVR. Consult your network administrator or ISP to obtain this information.
2	Port	Enter the server port number that you configured in the DVR menu. Refer to your DVR User Manual for details.
3	User Name	Enter the user name that you configured in the DVR menu. Refer to your DVR User Manual for details.
4	Password	Enter the password that you configured in the DVR menu. Refer to your DVR User Manual for details.
5	Alias	Enter the desired DVR name.

5 Click **Back** to view the main screen.

Using the Utility Software



No.	Item	Icon	Description
1	Display Screen	-	Displays the channel.
2	Channel Buttons		Click a channel button to view on the display screen. More channel buttons are available by clicking .
3	Play/Pause Button		Click to play or pause channel viewing.
	Full Screen Button		Click to view the channel in full screen. The screen orientation changes to landscape mode.
	Capture Button		Click to capture the screen shot. The screen shot is saved in the path sdcard\MeYePic .
	Settings Button		Click to open the Settings page.
	Exit Button		Click to close the application.
4	Toggle Button		Click to view more channel buttons.
5	PTZ Control Buttons		Click to display or hide the PTZ control buttons.
			Click the arrow buttons to move the camera direction (for PTZ camera only).
			Click the icons to adjust the zoom (for PTZ camera only).
			Click the icons to adjust the aperture (for PTZ camera only).
			Click to adjust the camera focus (for PTZ camera only).

Windows® Mobile Phones

Installing the Utility Software

Connect your mobile phone to the computer before proceeding.

- 1 Insert the CD-ROM to a CD drive. The CD will automatically run and display the KGuard Standalone DVR Solution screen automatically. Otherwise, double-click **Autorun.exe**.
- 2 Click **Mobile** > **3rd Party** > **Symbian**. Then, copy the *.CAB file from the CD to the internal memory of your mobile phone or the memory card.



- 3 After copying the file, disconnect your mobile phone from the computer.
- 4 On your mobile phone, browse for the utility file and run it for installation. You may be prompted to specify the installation location.

When installation is complete, the utility software icon is displayed on the application screen.

- 5 Click the  icon to open the utility software.

- 6 Enter the required settings.

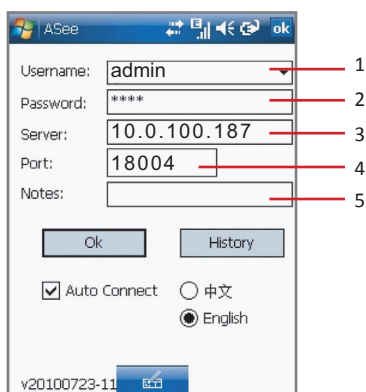

No.	Item	Description
1	User Name	Enter the user name that you configured in the DVR menu. Refer to your DVR User Manual for details.
2	Password	Enter the password that you configured in the DVR menu. Refer to your DVR User Manual for details.
3	Server	Enter the IP address assigned to the DVR. Consult your network administrator or ISP to obtain this information.
4	Port	Enter the server port number that you configured in the DVR menu. Refer to your DVR User Manual for details.
5	Notes	Enter a description if necessary.

- 7 Check **Auto Connect** to automatically connect to the DVR once the application is opened and select the screen language.
- 8 Click **OK** to confirm the connection information and then click **OK** again to view the main screen.

Using the Utility Software

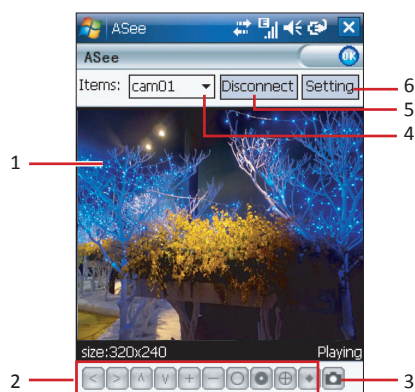

No.	Item	Icon	Description
1	Display Screen	-	Displays the channel.
2	PTZ Control Buttons		Click the arrow buttons to move the camera direction (for PTZ camera only).
			Click the icons to adjust the zoom (for PTZ camera only).
			Click the icons to adjust the camera focus (for PTZ camera only).
			Click the icons to adjust the aperture (for PTZ camera only).
	Full Screen Button		Click to view the channel in full screen.
3	Capture Button		Click to capture the screen shot. The screen shot is saved in the path: Program > Files > Moveeye .
4	Channel Selection	-	Click the box and select the channel to view.
5	Disconnect Button		Click to disconnect from the DVR.
6	Settings Button		Click to open the Settings page.

Supported Devices List

HDD Support List

Below is a list of common HDD models that is supported by the DVR.

Brand	Model	Capacity
Seagate	Pipeline HD	250 GB
		320 GB
		500 GB
		1 TB
	Barracuda 7200.12	250 GB
		500 GB
	Barracuda 7200.10	1 TB
		2 TB
Seagate	Barracuda LP	250 GB
		320 GB
		500 GB
		1 TB
	SV35.3	750 GB
		1 TB
WD	SV35.4	320 GB
		500 GB
	SV35.5	1 TB
		2 TB
	WD AV-GP	250 GB
		320 GB
		500 GB
		1 TB
Hitachi	WD Caviar Blue	1.5 TB
		2 TB
	WD Caviar Green	250 GB
		320 GB
Hitachi	WD RE4-GP	500 GB
		1 TB
	HDT721032SLA360	2 TB
		320 GB
Hitachi	HDT725032VLA380	320 GB
		320 GB
	HDS721010KLA330	1 TB
		1 TB
Samsung	CinemaSta (HCT721755SLA380)	750 GB
		750 GB
	HD502HI	500 GB
		500 GB
Samsung	HD103SI	1 TB
		1 TB



Note:

- The hard disk drive must at least have a minimum capacity of 250 GB.
- The supported list above may have been updated since the time that this documentation has been written. Check the website (www.kguardsecurity.com) for the latest information.

USB Device Support List

Below is a list of common USB 2.0 device manufacturers that is supported by the DVR.

Brand	Capacity
Sandisk	4 GB
Kingston	4 GB / 8 GB
Kingston (DT Mini Slim)	4 GB
Transcend	4 GB
Kingmax	2 GB / 8 GB
UNIS	4 GB



Note:

The supported list above may have been updated since the time that this documentation has been written. Check the website (www.kguardsecurity.com) for the latest information.

Mobile Phones Support List

Below is a list of common mobile phone manufacturers that is supported by the DVR.

Brand \ Operating System	Android	BlackBerry	iPhone	Symbian	Windows Mobile
Acer	√				√
Asus					√
BenQ					√
BlackBerry		√			
Dell	√				√
Garmin	√				
Gigabyte	√				√
Google	√				
HP					√
HTC	√				√
i-Mate					√
iPhone			√		
Kyocera	√				√
Lenovo					√
LG	√				√
Motorola	√				√
Nokia				√	
Palm					√
Pantech	√				√
Samsung	√			√	
Sharp	√				
Siemens					√
Sony Ericsson				√	√
Toshiba					√
Vodafone					√



Note:

- The supported list above may have been updated since the time that this documentation has been written. Check the website (www.kguardsecurity.com) for the latest information.
- To ensure optimum performance, download and use Asee on Android 1.6 or above.



Copyright © 2011
All rights reserved

Customer Support

KGUARD INFORMATION CO., LTD.

Address: 4F, No.113, Jian 2nd Road,
Jhonghe District, New Taipei City 23585, Taiwan
TEL: +886-2-8228-6080
FAX: +886-2-8221-6857
Email: support@kguardsecurity.com

USA Technical Support Contact

TEL: 1-949-450-0052
Email: support@kworldcomputer.com