

**RACK-232 CHASSIS
USER'S MANUAL**

Copyright Notice

This document and product is copyrighted, January 2000, by ICP Electronics Inc. All rights are reserved. No part of this manual may be reproduced, copied, or translated without prior notice to ICP Electronics Inc.

The information provided in this document is for reference only. We do not assume any responsibility arising out of the application of the products. This manual is subject to change without any notice.

RACK-232, ICP are trademark of ICP Electronics Inc.

Table of Contents

Chapter 1 Product Information

- 1.1 General Information
- 1.2 Product Specifications
- 1.3 Dimensions

Chapter 2 System Setup

- 2.1 Front Panel of RACK-232
- 2.2 LP-01 Control Panel of RACK-232
- 2.3 Rear Panel of RACK-232
- 2.4 Removing the chassis cover
- 2.5 Backplane Installation
- 2.6 Disk Drives Installation
- 2.7 Power Supply Installation
- 2.8 Fan Installation

Appendix A Passive Backplane

Appendix B Exploded Diagram

Chapter 1 Product Information

1.1 General Information

RACK-230A IPC chassis is a rugged PC/AT compatible computer designed for the factory floor and other Industrial harsh environment. RACK-230A features 2 slots Passive Backplanes and high reliability ACE-890 series power supply.

The chassis can easily be installed on 19" Rack or Desktop with the supplied brackets.

1.2 Product Specifications

General specification

- Construction : Heavy-duty Consideration
- Disk Driver : One 5.25" CD-ROM ,One 3.5" FDD Drive and One 3.5" HDD or Two 2.5" HDD drives spaces.
- Cooling Fan : Triple Ball bearing fans
- Indicator : Two LEDs to monitor the status of HDD and Power Supply
- Dimension : 483 x 486 x 44 (W x D x H)
- I/O Port : One USB Port (Type A)
- Reset Button : Yes
- Buzzer : Yes

Passive Backplanes (Optional)

PCI-2SD – 2 slot ISA/PCI bus Backplane (VER:1.3)

IP-2SD – 2 slot PCISA bus Backplane(VER:2.1)

Power Supply

Standard equipped power supply for the RACK-232 is : ACE-890A.

Optional: ACE-890P 70V-132VDC input power supply.

ACE-890T 36V-72VDC input power supply.

ACE-890C 18V-36VDC input power supply.

ACE-890V 9V-16VDC input power supply.

Working Environment

- Operating Temperature : 0~50°C
- Relative Humidity : 5~95% Relative
- Vibration : 5-17Hz, 0.1" double amplitude displacement
17-640Hz, 1.5G acceleration peak to peak
- Shock : 10G acceleration peak to peak
- Safety approval : meet CE, FCC

Cooling Fan

Triple rear ball bearing cooling fans.

Drive Capacity

One 5.25" CD-ROM, one 3.5" FDD and one 3.5" HDD drive spaces or two 2.5" HDD Drives spaces.

1.3 Dimensions

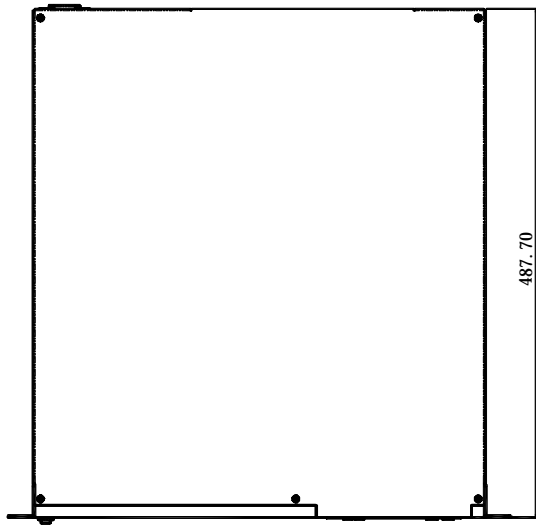

UNIT:mm

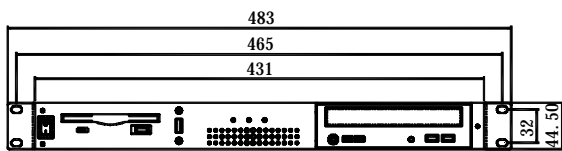
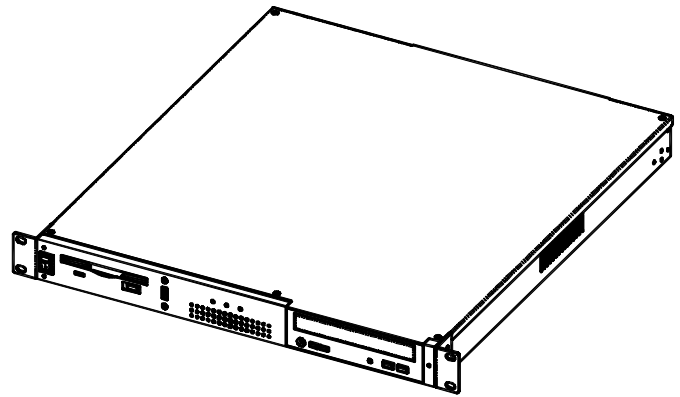

Chapter 2 Installation Procedure

The following set up procedures are provided to assist you in installing the system unit, please follow the steps below:

2.1 Front Panel of RACK-232

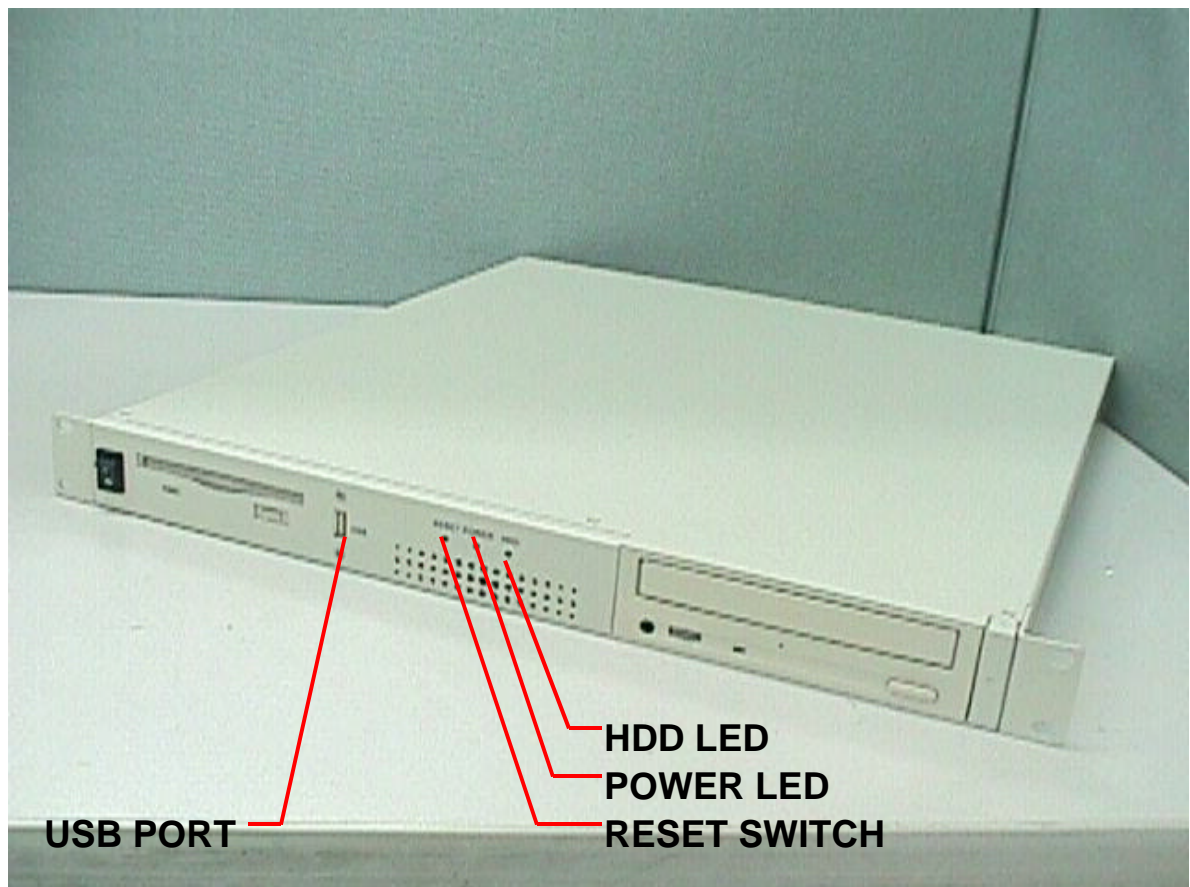

2.2 LP-01 Control Panel of RACK-232

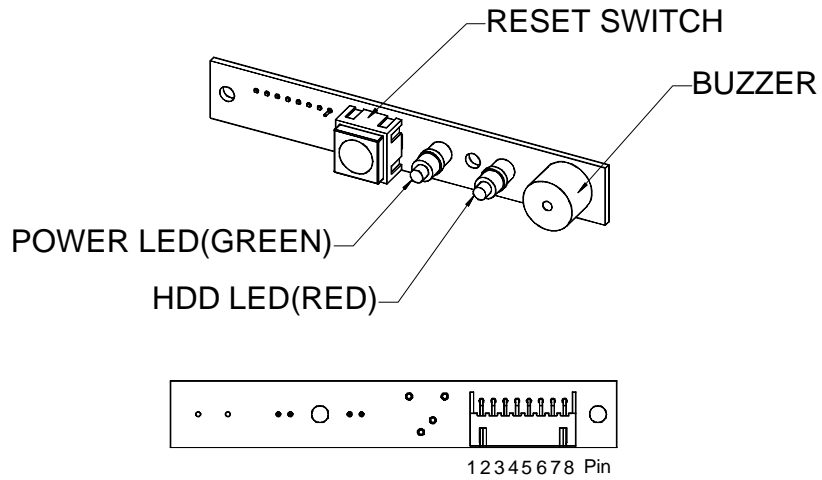

LP-01 Panel

BZ1: BUZZER

D1: POWER LED

D2: System HDD LED

SW1: RST system reset button

CN1:

Pin #	FUNCTION
1	SPEAKER (+)
2	SPEAKER (-)
3	POWER LED (-)
4	POWER LED (+)
5	HDD LED(-)
6	HDD LED(-)
7	RESET (1)
8	RESET (2)

2.3 Rear Panel of RACK-232



AC INPUT

2.4 Removing the chassis cover

The cover is mounted by five screws on the top of the chassis, remove them and slide the cover to the rear of the chassis. Figure below shows how to remove the chassis cover.

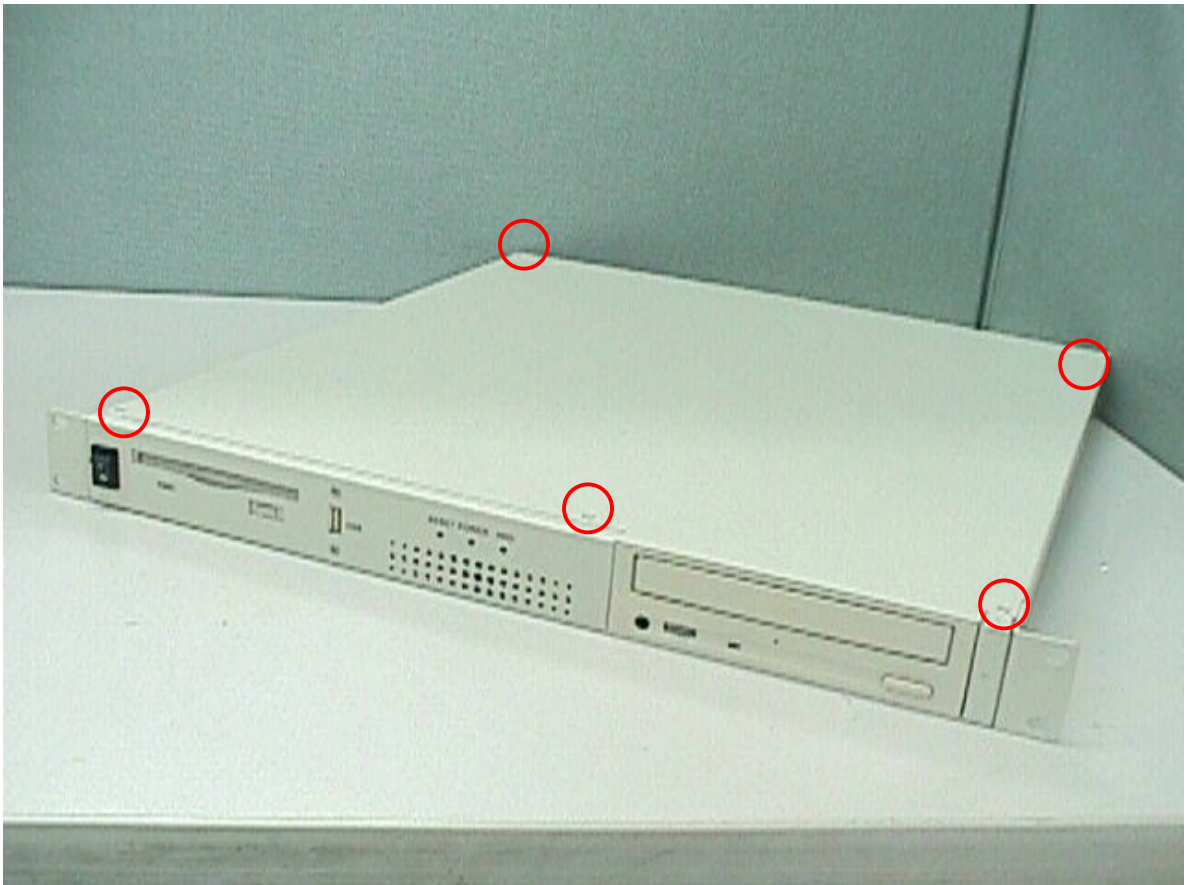

2.5 Backplane Installation

Figure below illustrates how to install the backplanes on the RACK-232

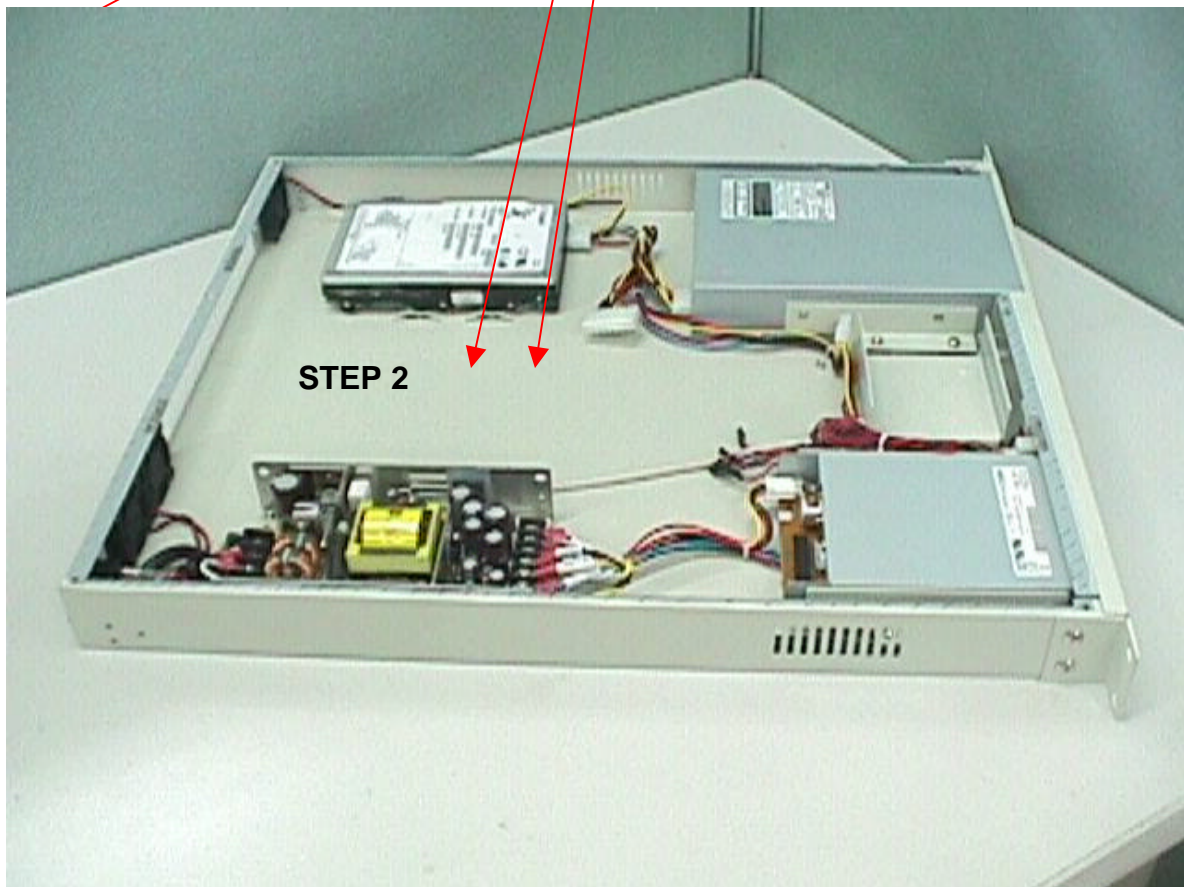
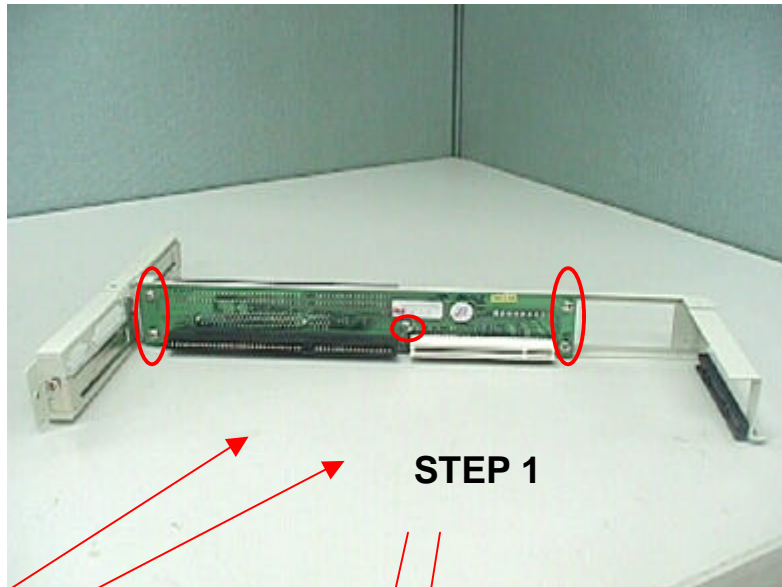

Please plug the connector of ACE-890 to the Backplane
IP-2SD(VER:2.1)
PCI-2SD(VER:1.3)

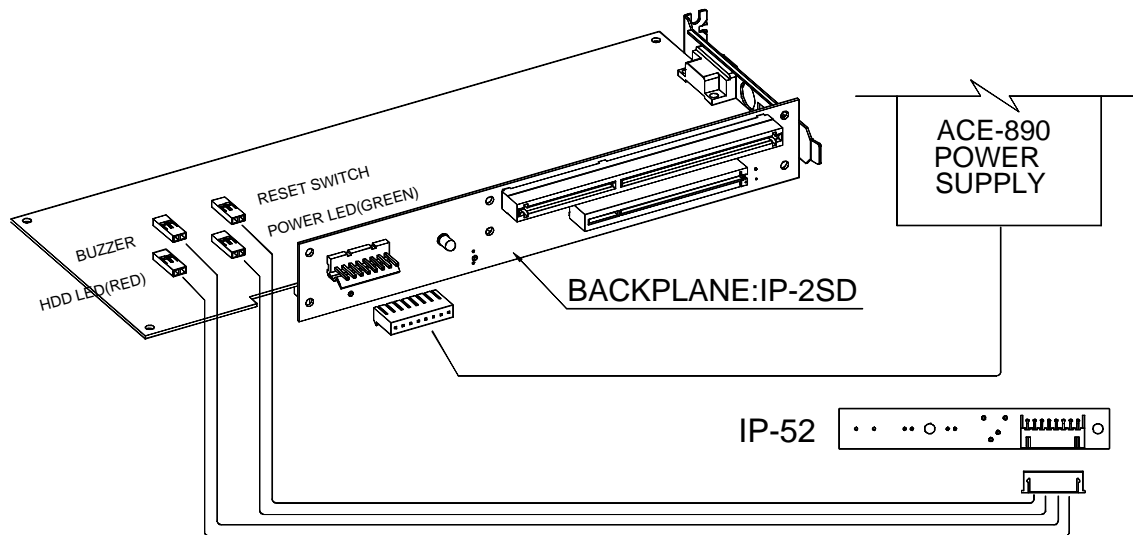

2.6 Disk Drives Installation

1. Open the upper disk drive cover.
2. Mount the drive rails on the side of FDD
3. Attach the FDD to the bracket with four screws and connect FDD cable & power cable to the FDD.
4. Directly fix the 3.5" HDD with four screws into chassis and connect a 40-pin flat cable & power cable to it.



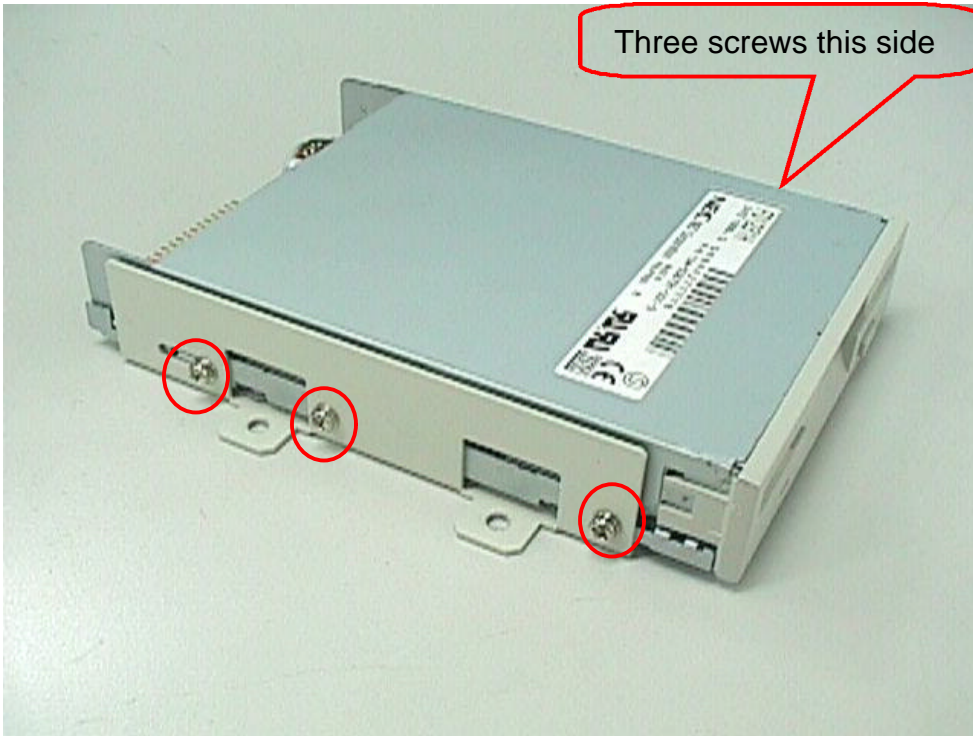

FDD



CD ROM

2.7 Power Supply Installation

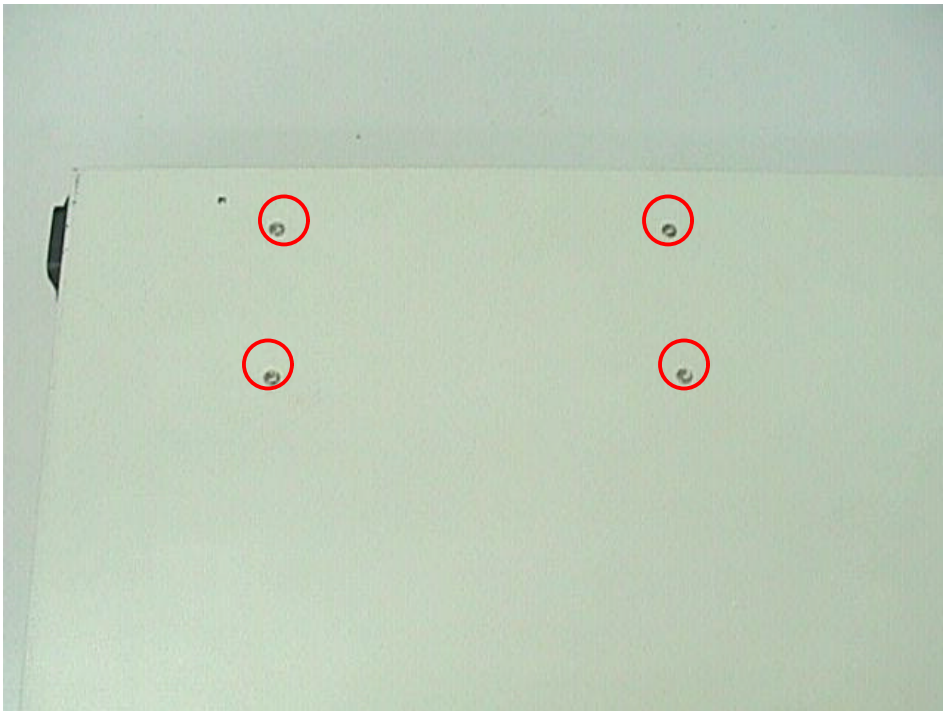

2.8 Fan Installation

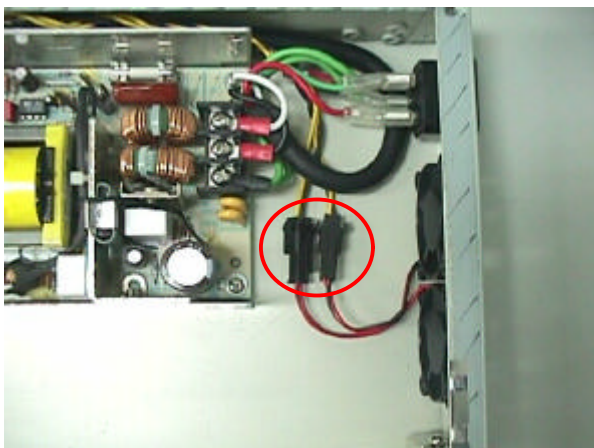
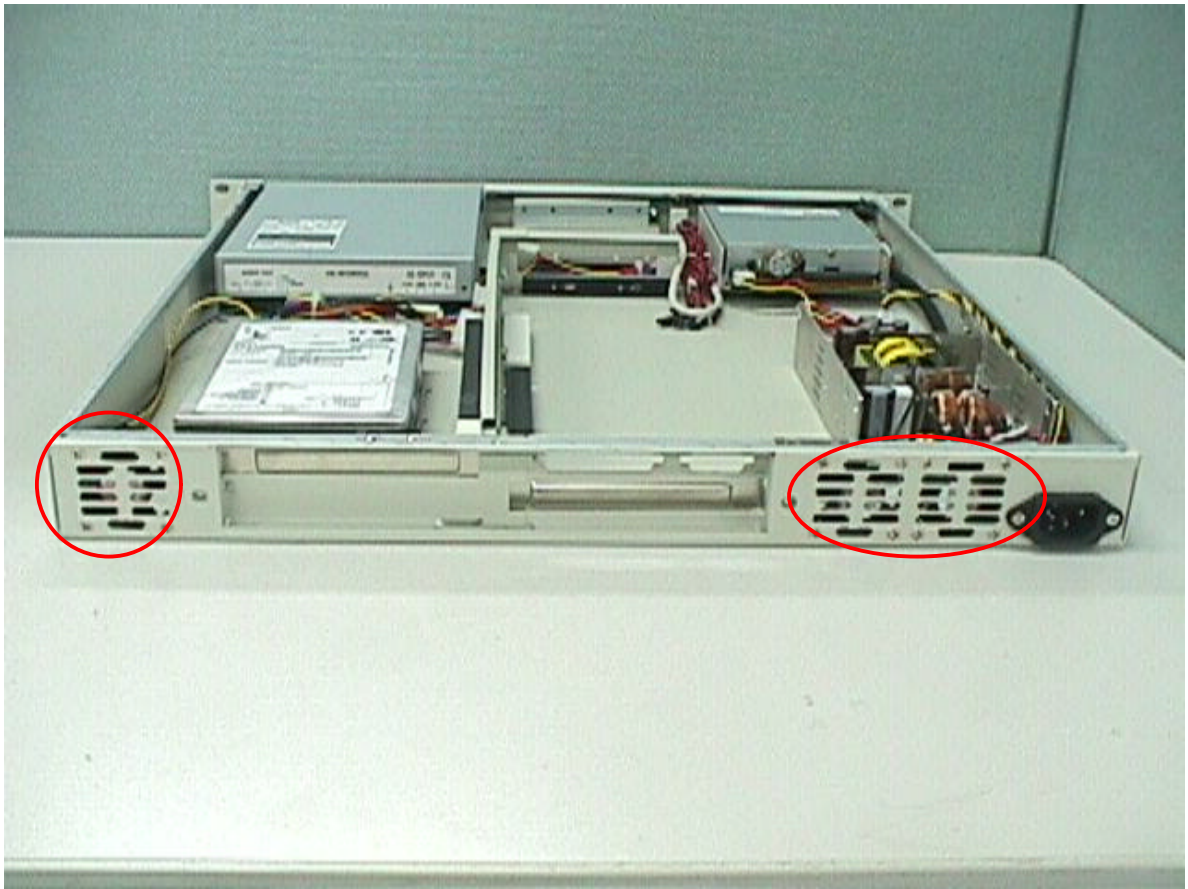

APPENDIX A PASSIVE BACKPLANES

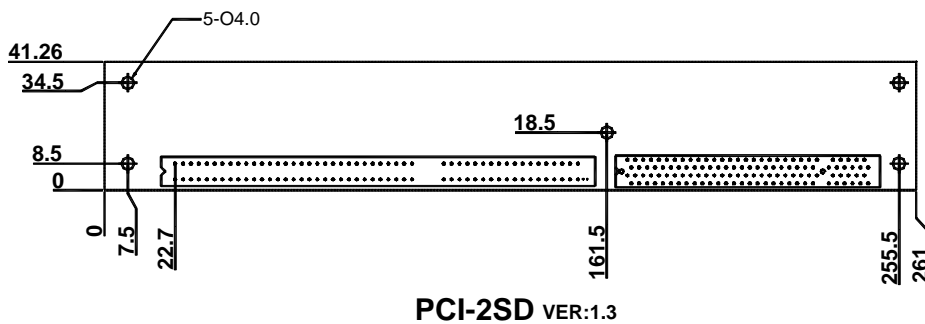
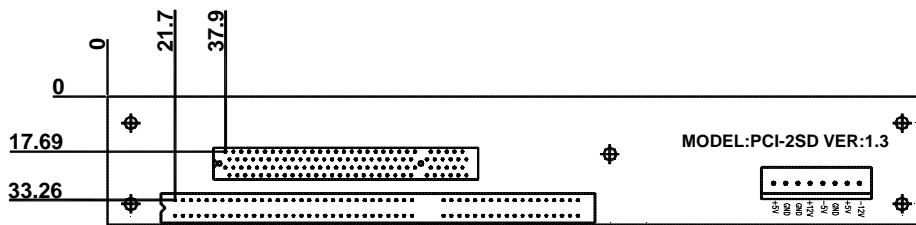
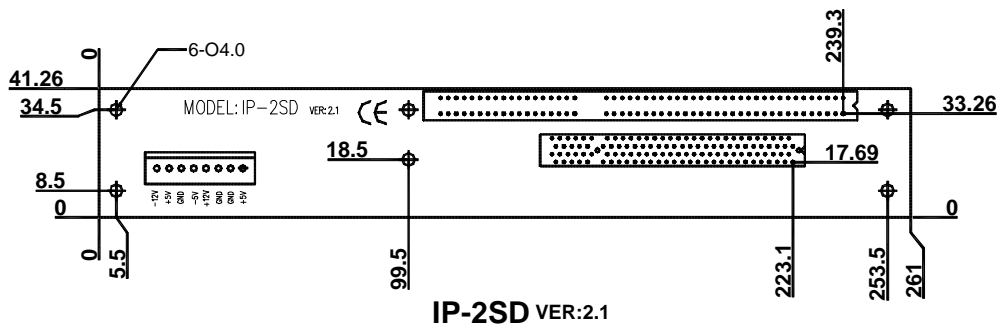
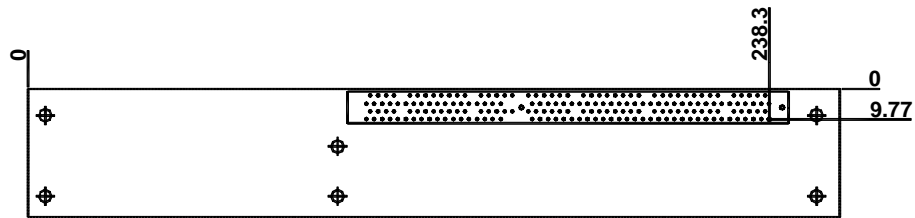

APPENDIX B

EXPLODED DIAGRAM

