

Register your product and get support at  
[www.philips.com/welcome](http://www.philips.com/welcome)

Enregistrez votre produit et bénéficiez d'une assistance à l'adresse suivante  
[www.philips.com/welcome](http://www.philips.com/welcome)

AT940, AT893, AT890, AT753, AT752, AT750



**PHILIPS**



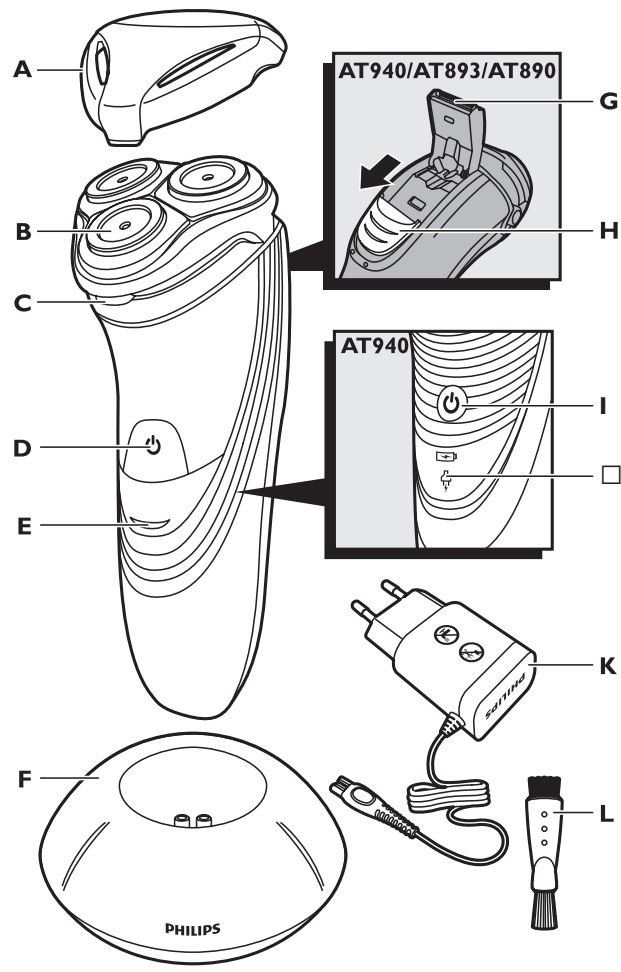



**AT940, AT893, AT890, AT753, AT752, AT750**

**ENGLISH 6**

**FRANÇAIS (CANADA) 23**

### Introduction

Congratulations on your purchase and welcome to Philips! To fully benefit from the support that Philips offers, register your product at [www.philips.com/welcome](http://www.philips.com/welcome).

Please read this user manual, as it contains information about the wonderful features of this shaver as well as some tips to make shaving easier and more enjoyable.

### General description (Fig. 1)

- A** Protection cap
  - B** Shaving unit
  - C** Shaving unit release button
  - D** Shaver on/off button (AT893/AT890/AT753/AT752/AT750)
  - E** Charging light (AT893/AT890/AT753/AT752/AT750)
  - F** Charging stand (AT940 only)
  - G** Trimmer (AT940/AT893/AT890 only)
  - H** Trimmer release slide (AT940/AT893/AT890 only)
  - I** Shaver on/off button (AT940 only)
  - J** Battery symbol and plug symbol (AT940 only)
  - K** Adapter
  - L** Cleaning brush
- Not shown: Storage pouch (AT940/AT893/AT890 only)

**Note:** You can find the type number on the back of the shaver.

**Important**

Read this user manual carefully before you use the appliance and the charging stand (AT940 only). Save it for future reference.

**Danger**

- Make sure the adapter does not get wet.

**Warning**

- The adapter contains a transformer. Do not cut off the adapter to replace it with another plug, as this causes a hazardous situation.
- This appliance is not intended for use by persons (including children) with reduced physical, sensory or mental capabilities, or lack of experience and knowledge, unless they have been given supervision or instruction concerning use of the appliance by a person responsible for their safety.
- Children should be supervised to ensure that they do not play with the appliance.
- Always unplug the shaver before you clean it under the tap.

**Caution**

- Never use water hotter than 80°C to rinse the shaver.
- Be careful with hot water. Always check if the water is not too hot, to prevent your hands from getting burnt.
- Do not immerse the charging stand (AT940 only) in water or any other liquid, nor rinse it under the tap.
- The shaver and the charging stand (AT940 only) are not dishwasher-proof.
- Water may leak from the socket at the bottom of the shaver when you rinse it. This is normal

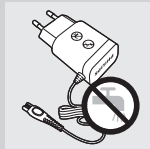

## 8 ENGLISH



and not dangerous because all electronics are enclosed in a sealed power unit inside the shaver.

- Do not use the shaver, adapter or charging stand (AT940 only) if it is damaged, as this may cause injury. Always replace a damaged adapter or charging stand with one of the original type.
- Charge and store the appliance at a temperature between 10°C and 35°C.
- Always place and use the shaver and the charging stand (AT940 only) on a surface that is fluid-resistant.
- Only use the adapter and the charging stand (AT940 only) supplied.
- Always put the protection cap on the shaver to protect the shaving heads when you are travelling.
- If the shaver is subjected to a major change in temperature, pressure or humidity, let it acclimatise for 30 minutes before you use it.

### **Compliance with standards**

- This shaver complies with the internationally approved safety regulations and can be safely used in the bath or shower and cleaned under the tap.
- This Philips appliance complies with all standards regarding electromagnetic fields (EMF). If handled properly and according to the instructions in this user manual, the appliances are safe to use based on scientific evidence available today.

### **General**

- The appliance is equipped with an automatic voltage selector and is suitable for mains voltages ranging from 100 to 240 volts.
- The adapter transforms 100-240 volts to a safe low voltage of less than 24 volts.



**Charging**

*Note: The shaver cannot be used directly from the mains.*

AT940/AT893/AT890 only: It takes approx. 1 hour to fully charge the shaver.

AT753/AT752/AT750: It takes approx. 8 hours to fully charge the shaver.

When you charge the shaver for the first time or after a long period of disuse, let it charge until the white battery symbol lights up continuously (AT940) or the charging light lights up green continuously (AT893/AT890/AT753/AT752/AT750).

A fully charged shaver provides up to 21 (AT940), 17 (AT893/AT890) or 14 (AT753/AT752/AT750) cordless shaves.

The shaving time may be less than expected as a result of your shaving behaviour, your cleaning habits or your beard type.

**Charge indications**

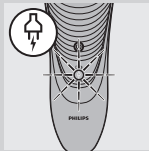

**Battery low**

- AT940: When the battery is almost empty (when there are only 5 or fewer shaving minutes left), the orange plug symbol starts to flash. When you switch off the shaver, the orange plug symbol continues to flash for a few seconds.

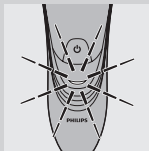

- AT893/AT890/AT753/AT752/AT750: When the battery is almost empty (when there are only 5 or fewer shaving minutes left), the charging light starts to flash orange. When you switch off the shaver, the charging light continues to flash orange for a few seconds.

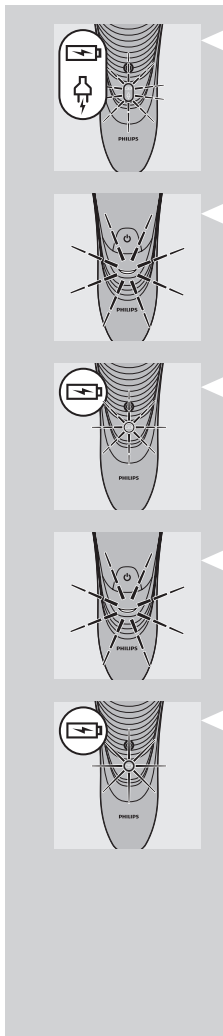

**Quick charging (AT940/AT893/AT890 only)**

- AT940: When you start charging the empty battery, both the white battery symbol and the plug symbol flash. After approx. 3 minutes, the orange plug symbol goes out, while the battery symbol continues to flash. The shaver now contains enough energy for a 5-minute shave.
- AT893/AT890: When you start charging the empty battery, the charging light alternately flashes orange and green. After approx. 3 minutes the charging light continues to flash green. The shaver now contains enough energy for a 5-minute shave.

**Charging**

- AT940: When the shaver is charging, the white battery symbol flashes.
- AT893/AT890/AT753/AT752/AT750: When the shaver is charging, the charging light flashes green.

**Battery fully charged**

- AT940: When the battery is fully charged, the white battery symbol lights up continuously.

*Note: After approx. 30 minutes, the battery symbol goes out to save energy.*

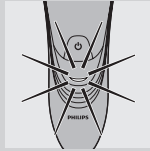

- AT893/AT890/AT753/AT752/AT750: When the battery is fully charged, the charging light lights up green continuously.

*Note: After approx. 30 minutes, the charging light goes out to save energy.*

#### Charging with the adapter

- 1 Put the small plug in the shaver.
- 2 Put the adapter in the wall socket.
  - ▶ The charging light shows the charging status of the shaver (see section 'Charge indications' in this chapter).

#### Charging in the charging stand (AT940 only)

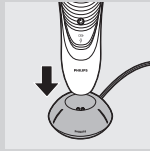

- 1 Put the small plug in the charging stand.
- 2 Put the adapter in the wall socket.
- 3 Place the shaver in the charging stand.
  - ▶ The charging light shows the charging status of the shaver (see section 'Charge indications' in this chapter).

#### Using the shaver

*Note: This shaver can be used in the bath or shower. It can therefore not be used directly from the mains for safety reasons.*

#### Shaving tips and tricks

- This shaver is suitable for both wet and dry use. Use the shaver with shaving gel or foam for extra skin comfort, or use the shaver dry for extra convenience.

## 12 ENGLISH

*Note: We advise you to use the shaver with shaving gel or foam when you use it for a wet shave. Do not use thick shaving cream or shaving oil with this shaver.*

- For optimal shaving results, make circular movements during use.
- The shaver is waterproof and can be used in the bath or shower.
- Your skin may need 2 or 3 weeks to get accustomed to the Philips shaving system.

### Wet shaving

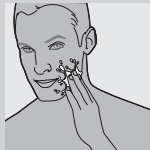

- 1** Apply some water to your skin.



- 2** Apply shaving foam or shaving gel to your skin.

- 3** Rinse the shaving unit under the tap to ensure that the shaving unit glides smoothly over your skin.

- 4** Press the on/off button once to switch on the shaver.

- 5** Move the shaving heads in circular movements over your skin.



*Note: Rinse the shaver under the tap regularly to ensure that it continues to glide smoothly over your skin.*

- 6** After shaving, press the on/off button once to switch off the shaver and dry your face.

- 7** Clean the shaver (see chapter 'Cleaning and maintenance').

*Note: Make sure you rinse all foam or shaving gel off the shaver.*

**Dry shaving**



- 1** Press the on/off button once to switch on the shaver.
- 2** Move the shaving heads in circular movements over your skin.
- 3** After shaving, press the on/off button once to switch off the shaver.
- 4** Clean the shaver (see chapter 'Cleaning and maintenance').

**Trimming (AT940/AT893/AT890 only)**

You can use the trimmer to groom your sideburns and moustache.

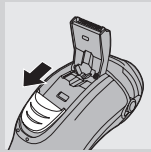

- 1** Push the trimmer slide downwards to open the trimmer.
  - 2** Press the on/off button once to switch on the shaver.
- ▶ You can now start trimming.



- 3** After trimming, press the on/off button once to switch off the shaver.
- 4** Clean the trimmer (see chapter 'Cleaning and maintenance').
- 5** Close the trimmer ('click').

**Cleaning and maintenance**

Never use compressed air, scouring pads, abrasive cleaning agents or aggressive liquids such as petrol

or acetone to clean the shaver and the charging stand (AT940 only).

Always unplug the shaver before you clean it under the tap.

- Clean the shaver after every shave for optimal shaving performance.
- Regular cleaning guarantees better shaving performance.
- For the best cleaning results, we advise you to use the Philips Cleaning spray (HQ110).
- Be careful with hot water. Always check if the water is not too hot, to prevent your hands from getting burnt.

*Note: Water may leak from the socket at the bottom of the shaver when you rinse it. This is normal and not dangerous because all electronics are enclosed in a sealed power unit inside the shaver.*

#### **Cleaning the shaving unit under the tap**



- 1** Switch off the shaver.
- 2** Press the release button to open the shaving unit.
- 3** Rinse the shaving unit and hair chamber under a hot tap for 30 seconds.

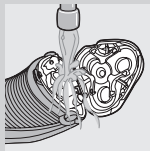

Be careful with hot water. Always check if the water is not too hot, to prevent your hands from getting burnt.

- Rinse the hair chamber and the inside of the shaving unit.



- Rinse the outside of the shaving unit.

**4** Close the shaving unit and shake off excess water.

Be careful not to hit the shaving unit against anything while shaking off excess water.

Never dry the shaving unit and the hair chamber with a towel or tissue, as this may damage the shaving unit.

**5** Open the shaving unit again and leave it open to let the shaver dry completely.

**Cleaning the shaving unit with the cleaning brush**

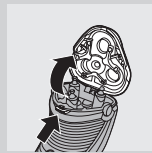

**1** Switch off the shaver.

**2** Press the release button to open the shaving unit.

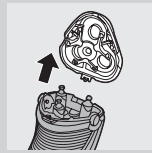

**3** Pull the shaving unit off the shaver.



**4** Turn the lock anticlockwise (1) and remove the retaining frame (2).

## 16 ENGLISH

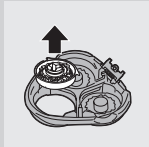

- 5** Remove and clean one shaving head at a time. Each shaving head consists of a cutter and a guard.

*Note: Do not clean more than one cutter and guard at a time, since they are all matching sets. If you accidentally mix up the cutters and guards, it may take several weeks before optimal shaving performance is restored.*

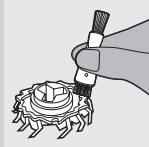

- Remove the cutter from the shaving guard and clean it with the brush.

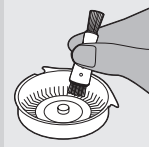

- Clean the inside and outside of the shaving guard with the brush.



- 6** Put the shaving heads back into the shaving unit.

Make sure that the projections of the shaving heads fit exactly into the recesses.



- 7** Put the retaining frame back into the shaving unit and turn the lock clockwise.

- 8** Insert the lug of the shaving unit into the slot in the top of the shaver (1). Then close the shaving unit (2).

*Note: If the shaving unit does not close smoothly, check if you have inserted the shaving heads properly and if the retaining frame is locked.*



**Cleaning the trimmer with the cleaning brush (AT940/AT893/AT890 only)**

Clean the trimmer every time you have used it.

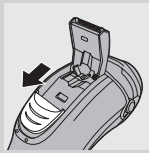

- 1** Switch off the shaver.
- 2** Push the trimmer slide downwards to open the trimmer.

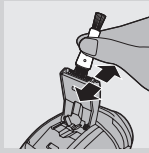

- 3** Clean the trimmer with the short-bristled side of the cleaning brush. Brush up and down along the trimmer teeth.

- 4** Close the trimmer ('click').



*Tip: For optimal trimming performance, lubricate the trimmer teeth with a drop of sewing machine oil every six months.*

**Storage**

There are several ways to store the shaver or to take it with you when you travel:



- Always put the protection cap on the shaver to prevent damage.
- AT940/AT893/AT890 only: Store the shaver in the pouch supplied.
- AT940 only: Store the shaver in the charging stand.

**Replacement**

For maximum shaving performance, we advise you to replace the shaving heads every year. Replace damaged shaving heads right away.

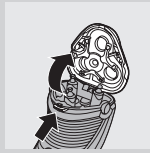

Only replace the shaving heads with original HQ9 Philips Shaving Heads (for AT940) or HQ8 Philips Shaving Heads (for AT893/AT890/AT753/AT752/AT750).

**1** Switch off the shaver. Disconnect the shaver from the mains or remove it from the charging stand (AT940 only).



**2** Press the release button to open the shaving unit.

**3** Pull the shaving unit off the shaver.



**4** Turn the lock anticlockwise (1) and remove the retaining frame (2).

**5** Remove the shaving heads and place new ones in the shaving unit.

Make sure that the projections of the shaving heads fit exactly into the recesses.

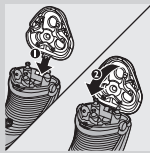

**6** Put the retaining frame back into the shaving unit and turn the lock clockwise.

**7** Insert the lug of the shaving unit into the slot in the top of the shaver (1). Then close the shaving unit (2).

*Note: If the shaving unit does not close smoothly, check if you have inserted the shaving heads properly and if the retaining frame is locked.*

### Accessories

To retain the top performance of your shaver, make sure you clean it regularly and replace its shaving heads at the recommended time.



**Shaving heads**

- We advise you to replace your shaving heads every year. Always replace with HQ9 Philips Shaving Heads (for AT940) or HQ8 Philips Shaving Heads (for AT893/AT890/AT753/AT752/AT750).

**Cleaning**

- Use Cleaning spray (HQ110) to clean the shaving heads thoroughly.

**Environment**



- Do not throw away the appliance with the normal household waste at the end of their life, but hand them in at an official collection point for recycling. By doing this, you help to preserve the environment.



- The built-in rechargeable shaver battery contains substances that may pollute the environment. Always remove the battery before you discard or hand in the shaver at an official collection point. Dispose of the battery at an official collection point for batteries. If you have trouble removing the battery, you can also take the appliance to a Philips service centre. The staff of this centre will remove the battery for you and will dispose of it in an environmentally safe way.

**Removing the rechargeable shaver battery**

Only remove the rechargeable battery when you discard the shaver. Make sure the rechargeable battery is completely empty when you remove it.

- 1** Disconnect the shaver from the mains or remove it from the charging stand (AT940 only).
- 2** Let the shaver run until it stops.
- 3** Undo the screws in the back of the shaver and in the hair chamber.
- 4** Remove the front panel and the back panel.
- 5** Bend the 6 hooks aside and take out the power unit.

Be careful, the hooks are sharp.

- 6** Remove the battery.

Be careful, the battery strips are sharp.

Do not connect the shaver to the mains again or put it back into the plugged-in charging stand (AT940 only) after you have removed the rechargeable battery.

#### **Guarantee and service**

If you need service or information or if you have a problem, please visit the Philips website at [www.philips.com](http://www.philips.com) or contact the Philips Consumer Care Centre toll free at 1-866-800-9311.

#### **Guarantee restrictions**

The shaving heads (cutters and guards) are not covered by the terms of the international guarantee because they are subject to wear.

**Troubleshooting**

This chapter summarises the most common problems you could encounter with the appliance. If you are unable to solve the problem with the information below, contact the Consumer Care Centre in your country.

Problem	Possible cause	Solution
The shaver does not shave as well as it used to.	The shaving heads are damaged or worn.	Replace the shaving heads (see chapter 'Replacement').
	Foam or gel residues clog up the shaving heads.	Rinse the shaving unit under a hot tap (see section 'Cleaning the shaving unit under the tap' in chapter 'Cleaning and maintenance').
	Long hairs obstruct the shaving heads.	Clean the shaving heads one by one (see section 'Cleaning the shaving unit with the cleaning brush' in chapter 'Cleaning and maintenance').
	You have not inserted the shaving heads properly.	Make sure that the projections of the shaving heads fit exactly into the recesses (see section 'Cleaning the shaving unit with the cleaning brush').
The shaver does not work when I press the on/off button.	The rechargeable battery is empty.	Recharge the battery (see chapter 'Charging').

## 22 ENGLISH

Problem	Possible cause	Solution
	The temperature of the shaver is too high. In this case, the shaver does not work.	As soon as the temperature of the shaver has dropped sufficiently, you can switch on the shaver again.
The shaver does not work, although it is connected to the mains.	If the shaver does not work when you press the on/off button, the battery is empty.	This shaver is not designed to be used directly from the mains, so you should recharge the battery (see chapter 'Charging').