

SEASON

IKRA
tools for home and garden



2014 /2015 



www.ikra.de
info@ikra.de
Germany - HQ
ikra GmbH
Schlesier Straße 36
D-64839 Münster-Altheim
Germany

Phone: 0049-6071-3003-0
Fax: 0049-6071-3003-30

Success and passion

For 37 years, IKRA mogatec has been manufacturing high quality lawn and garden products. Throughout those years, we have provided our customers with quality, individuality, flexibility and attractive prices.

The course of success began with the launch of the first grass-trimmer in 1977 by the company founder Reinhard H. Jachmann.

History

1977 Founding of ikra by Reinhard H. Jachmann. Aim: to produce and to market electric gardening tools.

1978 Production of grass trimmer.

1992 Establishment of the manufacturing company Mogatec in Saxony by Reinhard H. Jachmann (18 employees). In the following years both companies experienced a strong expansion (>200 employees).

Total turnover: 62 million EUR on an output of 1.8 million units p.a.

2004 Production expansion by commercial goods.

2008 Introduction "Tonino Lamborghini" - garden machinery range

2012 New product line "FlexoTrim". ikra becomes Member of Business Social Compliance Initiative (BSCI)

IKRA mogatec
Münster-Altheim Drebach

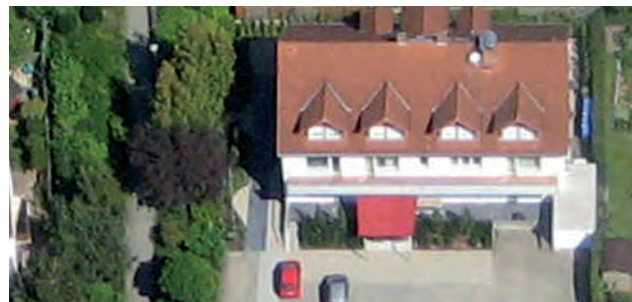



CONTENT

Page

Grass Trimmer	03-06
Brushcutter	07-10
Brushcutter & Pole Pruner Set	11-12
Extended Reach Hedge Trimmer and Pruning Saw	13-14
Hedge Trimmer	15-18
Chainsaw	19-22
Grass and Shrub Shear	23-24
Vacuum Blower	25-26
Cultivator	27-28
Scarifier	29-30
Garden Shredder	31-32
Lawn Mower	33-38

Grass Trimmer



Specifications	RT 2122 A	RT 2124 DA	RT 1603 DA
Power	250 W	350 W	350 W
Voltage	230 V	230 V	230 V
Cutting System	Tap'n'go, Single-line	Tap'n'go, Double line	Tap'n'go, Double line
Spool m / Ø	1 x 6 / 1.4 mm (A)	2 x 4 / 1.4 mm (DA)	2 x 4 / 1.4 mm (DA)
Cutting Width	220 mm	240 mm	250 mm
Sound Power Level	96 db(A)	96 db(A)	96 db(A)
Weight	1.41 kg	1.97 kg	1.95 kg
Model-N°	11021500	11021600	11021800

HINT

Sometimes the most simple grass trimmer can serve all needs. It is light, small and comes as one solid piece without any assembling and angle adjustments before use. It simply gets the job done.



- Adjustable support handle



- 180° turning handle
- Telescopic height adjustment



- 3-point cutting angle adjustment



- Incl. 1 extra spool



RT 2122 A



RT 2124 DA



RT 1603 DA



Accessories



A-Spool
13001552



DA-Spool
13005001

Grass Trimmer



Specifications	RT 2107 D	RT 2110 D	RTA 2118 LI
Power	520 W	600 W	18 V
Voltage	230 V	230 V	1.5 Ah
Cutting System	Tap'n'go, Double-line	Tap'n'go, Double-line	Tap'n'go, Single-line
Spool m / Ø	2 x 4 / 1.4 mm (D)	2 x 4 / 1.4 mm (D)	1 x 6 / 1.4 mm (A)
Cutting Width	300 mm	300 mm	220 mm
Sound Power Level	96 db(A)	96 db(A)	96 db(A)
Weight	2.67 kg	2.72 kg	1.89 kg
Model-N°	11021200	11021300	11021450

HINT
 Hardly reachable spaces, vertical edging and trimming around flowers – for such demanding multipurpose use, you want to have a grass trimmer that features ergonomic adjustability.



- Adjustable support handle



- 180° turning handle
- Telescopic height adjustment



- 3-point cutting angle adjustment



- Adjustable support handle



- 180° turning handle
- Telescopic height adjustment



- 3-point cutting angle adjustment



- Adjustable support handle



- 180° turning handle
- Telescopic height adjustment



- 3-point cutting angle adjustment

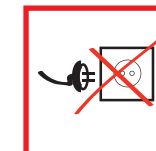

- Cordless (Li-Ion battery)



RT 2107 D
RT 2110 D

- Cutting width indicator



- Operating Time
Approx. 30 min.
- Charging Time
3 - 5 hours



RTA 2118 LI



Accessories



A-Spool
13001552



D-Spool
13001731



Lithium Ion battery
17180219

Brushcutter



Specifications

BT 25

Power	0.75 KW / 1.0 hp - Air-cooled 2-stroke engine
Voltage / Displacement	25.0 cc
Cutting System	Tap'n'go, Duo, Double-line
Spool m / Ø	2 x 3.0 / 2.0 mm Ø (DA-F7)
Cutting Width	380 mm
Petrol Tank / Mixture	450 ml / 1:40
Sound Power Level	112 db(A)
Weight	4.55 kg

Model-N°

73046000



- Height adjustable handle



- Split shaft with quick-release fastener



- Electric ignition primer / choke



Accessories



DA-F7-Spool
73500207



Shoulder Belt
73000502

Brushcutter



Specifications	BF 25	BF 33	BF 43
Power	0.75 kW / 1.0 hp - Air-cooled 2-stroke engine	0.9 kW / 1.2 hp - Air-cooled 2-stroke engine	1.25 kW / 1.7 hp - Air-cooled 2-stroke engine
Displacement	25.0 cc	33.0 cc	43.0 cc
Cutting System	Tap'n'go, Double-line / 4-tooth blade	Tap'n'go, Double-line / 4-tooth blade	Tap'n'go, Double-line / 4-tooth blade
Spool m / Ø	2 x 2.5 / 2.5 mm Ø (DA-F15)	2 x 2.5 / 2.5 mm Ø (DA-F15)	2 x 2.5 / 2.5 mm Ø (DA-F15)
Cutting Width (string/blade)	430 mm / 230 mm	430 mm / 230 mm	430 mm / 230 mm
Petrol Tank / Mixture	450 ml / 1:40	750 ml / 1:40	700 ml / 1:40
Sound Power Level	112 db(A)	112 db(A)	113 db(A)
Weight	5.96 kg	6.58 kg	7.50 kg
Model-N°	73046100	73046200	73046300

HINT

A brushcutter can be a powerful assist in not only cutting grass and brush, but also bushes and thin grove. With the 4-tooth and 8-tooth blades these tools can considerably be enhanced.



- Height adjustable bike handle



- Split shaft with quick-release fastener



- Electric ignition primer / choke



- Height adjustable bike handle



- Split shaft with quick-release fastener



- Electric ignition primer / choke



- Height adjustable bike handle



- Split shaft with quick-release fastener



- Electric ignition primer / choke



BF 25



BF 33



BF 43



Accessories



DA-F15-Spool
73500600



8-tooth-blade
73104512



Shoulder Belt
73000502



Professional
Shoulder Belt
30000091

Brushcutter & Pole Pruner Set



Specifications	IBAS 3330	IBKH 33
Power	0.9 kW / 1.2 hp - Air-cooled 2-stroke engine	0.9 kW / 1.2 hp - Air-cooled 2-stroke engine
Displacement	32.7 cc	32.7 cc
Cutting System	Chain	Tap'n'go, Double line / 4-tooth blade / Blade / Chain
Spool / Cutting length	300 mm "Oregon"	2 x 2m / 2.4 mm Ø (DA-F16) / 400 mm / 300 mm "Oregon"
Cutting Width string/4-blade/ blade	-	430 mm / 255 mm / 24 mm
Petrol Tank / Oil tank / Mixture	900 ml / 150 ml / 1:40	900 ml / 150 ml / 1:40
Sound Power Level	112 db(A)	112 db(A)
Weight	8.35 kg	6.5 kg + Attachment
Model-N°	73046650	73046700

HINT

A 4in1 Set is not only convenient, it also saves you money. Buy one driving unit and get four matching functional attachments. You will be covered for most of your garden work.



- Incl. 80 cm extension tube for extra long reach



- Split shaft with quick-release fastener



- Chain saw attachment 110cm length with adjustable angle



- Incl. 80 cm extension tube for extra long reach



- Split shaft with quick-release fastener



- Chain saw attachment 110cm length with adjustable angle



- Hedge trimmer attachment 11 angle adjustment up to 180cm



Accessories



DA-F16-Spool
73500700



Shoulder Belt
78011225



8-tooth blade
73104512



Professional
shoulder belt
30000091

Extended Reach Hedge Trimmer & Pruning Saw



Specifications	IEAS 600	THS 500	ITHK 800
Power	600 W	500 W	800 W
Voltage	230 V	230 V	230 V
Cutting Length / Bar Length	200 mm "OREGON"	400 mm	410 mm / 200 mm "OREGON"
Cutting Width	-	18 mm	18 mm
Working Height	≤ 4 m	≤ 4 m	≤ 4 m
Oil Tank	60 ml	-	100 ml
Sound Power Level	108 db(A)	108 db(A)	104 db(A)
Weight	3.40 kg	4.00 kg	5.00 kg / 3.20 kg
Model-N°	78001700	78001400	78001200-1

VIDEO

Take a look at the THS 500 telescopic hedge trimmer.

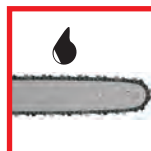

- Automatic chain lubrication



- Angle-adjustable handle



- Fibreglass telescopic shaft
- Variable height adjustment



- Double-acting blades



- 6-position angle adjustment up to 135°



- Fibreglass telescopic shaft
- Variable height adjustment



- Angle-adjustable handle, support handle and attachments



- Angle-adjustable support handle and attachments



- Lightweight telescopic shaft
- Variable height adjustment

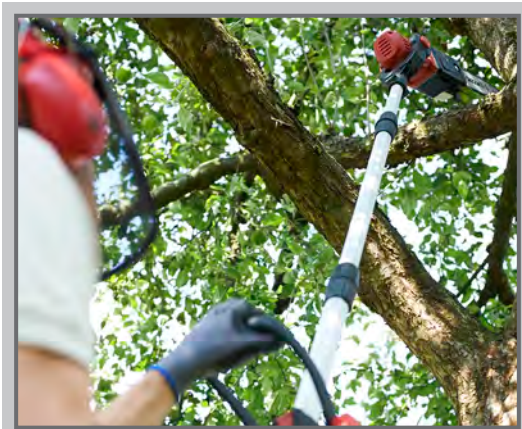

IEAS 600

- Working height up to 4.0 m



THS 500

- Working height up to 4.0 m



ITHK 800

- Working height up to 4.0 m



Accessories



Chain N° 38
30090330



Maintenance Spray
30000035



Shoulder Belt
78011225

Hedge Trimmer



Specifications	HTMN 520	IHS 600 / IHS 650*	AHS 4518
Power	520 W	600 W / 650 W	18 V
Voltage	230 V	230 V	1.5 Ah
Cutting Legth	460 mm	550 mm	450 mm
Cutting Gap	16 mm	20 mm / 22 mm	15 mm
Quick stop	yes	yes	yes
Sound Power Level	104 db(A)	104 db(A)	86 db(A)
Weight	2.72 kg	3.25 kg / 3.35 kg	2.22 kg
Model-N°	43224700	43225650	76181050

DID YOU KNOW?

Every hedge trimmer's performance can be further increased with high-quality manufactured blades. The IHS 650 features "Made in Germany" laser cut and diamond ground blades, which improve cutting performance and lower vibration.

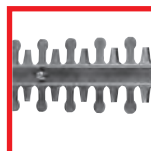

- Double acting and hardened blades



- 2-handed safety switch

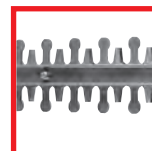

- Double acting and hardened blades



- 2-handed safety switch



- Turnhandle

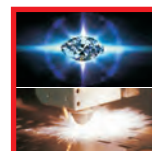

- *Laser cut and diamond ground blades "Made in Germany"

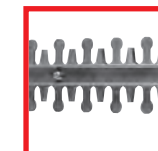

- Double acting and hardened blades



- 2-handed safety switch



- Metal gear

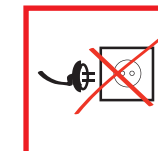

- Cordless (Li-Ion battery)



HTMN 520



IHS 650 blades

made in Germany



IHS 600
IHS 650*



AHS 4518



- Operating Time
Approx. 35 min.
- Charging Time
3 - 5 hours



Accessories



Maintenance Spray
30000035



Lithium Ion Battery
76180052

Hedge Trimmer



Specifications

BHSN 602

Power	0.9 kW /1.2 hp - Air-cooled 2-stroke engine
Displacement	25.4 cc
Cutting Legth	600 mm
Cutting Gap	27 mm
Petrol Tank	600 ml
Sound Power Level	114 db(A)
Weight	6.38 kg

Model-N°

82016720



- 180° turning handle for ergonomic horizontal and vertical cut



- Toolfree air filter cleaning

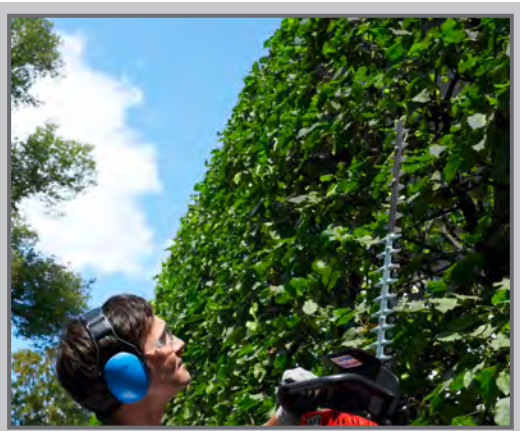

BHSN 602



Accessories



Maintenance spray
30000035

Chainsaw

Specifications	KES 1800-35	KES 1800-40	EKSN 2200-40 WK
Power	1.800 W	1.800 W	2.200 W
Voltage	230 V	230 V	230 V
Bar Length	350 mm "OREGON"	400 mm "OREGON"	400 mm "OREGON"
Chain Speed	13.5 m/s	13.5 m/s	13.5 m/s
Oil Tank	140 ml	140 ml	140 ml
Sound Power Level	108 db(A)	108 db(A)	107 db(A)
Weight	4.20 kg	4.30 kg	4.53 kg
Model-N°	71207000	71207050	71206200

DID YOU KNOW?

Many people assume that electric chainsaws are less powerful than their petrol powered counterparts. But 2,200 W are 2,2 kW and translate into 3.0 hp. That is powerful!



- Mechanical chain brake

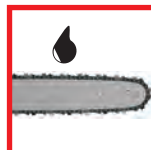

- Automatic chain lubrication

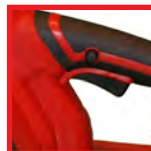

- Safety switch



- Mechanical chain brake

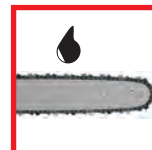

- Automatic chain lubrication



- Safety switch



- Mechanical chain brake



- Automatic chain lubrication

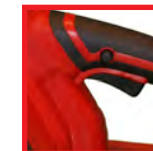

- Safety switch



- Toolfree chain tensioning



KES 1800-35



KES 1800-40



EKS N 2200-40 WK



Accessories



Chain N° 6
35 cm
30019521



Chain N° 11
40 cm
30019571



Carrying bag
27122017

Chainsaw



Specifications	PCS 2525	IPCS 46	PCS 5046
Power	0.9 kW / 1.2 hp - Air-cooled 2-stroke engine	1.8 kW / 2.4 hp - Air-cooled 2-stroke engine	2.2 kW / 3.0 hp - Air-cooled 2-stroke engine
Displacement	25.4 cc - Walbro carburetor	45.8 cc - Walbro carburetor	49.3 cc - Walbro carburetor
Bar Length	250 mm "OREGON"	450 mm "OREGON"	450 mm "OREGON"
Chain Speed	14.9 m/s	24.4 m/s	21.2 m/s
Petrol Tank / Oil Tank	200 ml / 140 ml	550 ml / 260 ml	550 ml / 260 ml
Sound Power Level	110 db(A)	114 db(A)	113 db(A)
Weight	3.71 kg	6.10 kg	6.58 kg
Model-N°	75074050	75074400	75074310

WARNING
 The top handle chainsaw PCS 2525 is suitable for advanced users working in tree care, only. Further information can be found in the user manual.



- Mechanical chain brake

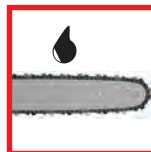

- Automatic chain lubrication



- Mechanical chain brake

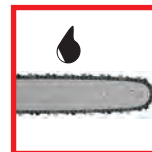

- Automatic chain lubrication



- Auto choke

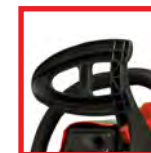

- Mechanical chain brake



- Automatic chain lubrication



- Electric ignition / Auto choke

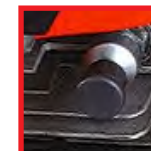

- Decompression outlet



PCS 2525



PCS 5046



IPCS 46



Accessories



Chain N° 39
30019400



Chain N° 16
30019721



Chain N° 41
30019611



Carrying bag
27122017

Grass and shrub shear



Specifications	GBS 3,6 LI	GBS 9054
Power	3.6 V	7.2 V
Voltage	1.3 Ah	2.0 Ah
Cutting Length (grass / shrub)	75 mm / 120 mm	80 mm / 160 mm
Cutting gap (shrub)	7.8 mm	7.8 mm
Operating Time	approx. 45 min.	approx. 160 min.
Sound Power Level	92 db(A)	92 db(A)
Weight	532 - 750 g	606 - 680 g
Model-N°	50808100	50807100

NOTE



The quick-change blade system, in particular, makes the GBS 9054 a grass shear officially rated “Very Good”.



- 180° turning handle



- Toolless change of blades



- Safety switch



- Toolless change of blades (quick-change)



- Safety switch



- Operating Time
Approx. 35 min.
- Charging Time
3 - 5 hours



GBS 3.6 LI



- Operating Time
Approx. 160 min.
- Charging Time
3 - 5 hours



GBS 9054

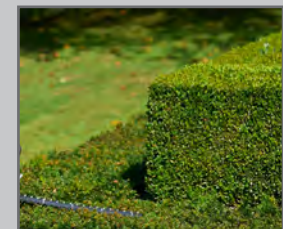

Accessories



Mains Adapter
3.6 V
50800015



Mains Adapter
7.2 V
50800035



GBS 9054
Long-handle
51141007

Vacuum Blower



Specifications	IEBV 2600	BV 2800 E	BLS 31
Power	2.600 W	2.800 W	0.75 kW / 1.0 hp Air-cooled 2-stroke engine
Voltage / Displacement	230 V	230 V	31.0 cc
Air Flow	13.2 m ³ /min	13 m ³ /min	12 m ³ /min
Air Speed	76 m/s	76 m/s	70 m/s
Collecting Bag Volume	35 l	45 l	45 l
Petrol Tank	-	-	415 ml
Sound Power Level	102 db(A)	100 db(A)	108 db(A)
Weight	2.84 kg	3.50 kg	6.47kg
Model-N°	74202700	74204000	80020010

WARNING
 Vacuuming/shredding functions should only be applied under dry conditions. Otherwise, functionality and safety are affected.



- 3 functions - blowing, vacuuming, shredding



- Electric power control



- Pipe with wheels



- 3 functions - blowing, vacuuming, shredding



- Electric power control



- Pipe with wheels



- Telescopic pipe (approx. 300 mm extension)



- 3 functions - blowing, vacuuming, shredding



- Pipe with wheels



IE BV 2600



BV 2800 E



BLS 31



Accessories



IE BV 2600
Shoulder Belt
78011225
Collecting Bag
74200020



BV 2800 E
Shoulder Belt
73400009
Collecting Bag
74200172



BLS 31
Shoulder Belt
73104004
Collecting Bag
80020152

Cultivator



Specifications

	IEM 750	EM 1200
Power	750 W	1200 W
Voltage	230 V	230 V
Working Width / Depth	280 mm / 200 mm	400 mm / 220 mm
Blade System	16 front-tines, exchangeable	24 front-tines, exchangeable
Rotational Speed	430 rpm	360 rpm
Sound Power Level	93 db(A)	93 db(A)
Weight	7.31 kg	12.60 kg

Model-N°	70300050	70300300
----------	----------	----------



- Worm gear in oil bath



- Safety lock-off switch



- Foldaway handle



- 2-stage worm gear in oil bath



- Safety lock-off switch



- Foldaway handle



- Drag bar & transport wheel



IEM 750



EM 1200



Scarifier



Specifications

IEVL 1400

Power	1.400 W
Voltage	230 V
Working Width (Scarifier)	360 mm
Working Width (Aerator)	350 mm
Collecting Bag Volume	48 l
Sound Power Level	105 db(A)
Weight	12.40 kg

Model-N°

80200700

HINT

A 2in1 tool treats your lawn like conditioner treats hair. An aerator removes moss, allows more air to get to the plants and ultimately facilitates thicker grass growth. A scarifier cuts thin slits into the ground to let water seep in more easily.

HINT

Fill the slits with sand – it will prevent them from closing for a while and allow water and air to come through.



- Interchangeable scarifier & aerator drums



- 4-position central height adjustment



- Adjustable & foldaway handlebar



IEVL 1400



▪ Scarifier



▪ Aerator drums

Garden Shredder



Specifications	EGN 2500	GSLN 2600
Power	2.500 W	2.600 W
Voltage	230 V	230 V
Cutting Width	≤ 40 mm	≤ 40 mm
Self-hauling system	yes	yes
Collecting Box	50 l	60 l
Sound Power Level	111 db(A)	89 db(A)
Weight	14.36 kg	27.90 kg
Model-N°	81012500	81002860

Horizontal and vertical blade silent shredder both have their advantages. The first cuts thinner clippings, but in very small pieces, whereas the latter can take it up with thicker branches and operates more quietly.

HINT

Always use the debris as a natural fertilizer for your plants. Mulch keeps the grounds moist and plants like that.



- Restart-proof and zero voltage switch

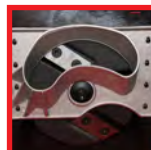

- Horizontal cutting system with hardened steel blades



- Quick-lock access cover



- Restart-proof and zero voltage switch



- Non-rebound drum system with 8 blades



- Robust epicyclic gear



EGN 2500



GSLN 2600

Silent Shredder



Lawn Mower



Specifications	ILME 1000	ELM 1200 U	ELM 1434 U / ELM 1638 U
Power	1.000 W	1.200 W	1.400 W / 1.600 W
Voltage	230 V	230 V	230 V
Cutting Width	320 mm	320 mm	340 mm / 380 mm
Cutting Height	25 mm - 55 mm, 3-position, manual	20 mm - 60 mm, 3-position, manual	25 mm - 65 mm, 5-position, central
Collecting Box Volume	35 l	30 l	35 l / 45 l Hard case
Sound Power Level	96 db(A)	96 db(A)	96 db(A)
Weight	12.50 kg	9.80 kg	10.55 kg / 12.47 kg
Model-N°	77031900	77031200	77031400 / 77031600

RECOMMENDED LAWN SIZES

SQ M	↓	Mower
300		ILME 1000
400		ELM 1200 U
500		ELM 1434 U
600		ELM 1638 U



- Foldaway handle bar



- Cable strain relief



- Foldaway carrying handle



- Cable strain relief



- Foldaway carrying handle



- Cable strain relief



- High-wheeled
14 cm / 16 cm
14 cm / 18 cm



ILME 1000



ELM 1200 U



ELM 1434 U
ELM 1638 U



Accessories



ILME 1000
Blade
77030079



ELM 1200 U
Blade
77031090



ELM 1434 U
Blade
77031032



ELM 1638 U
Blade
77031059

Lawn Mower



Specifications	BRM 1040	BRM 1446 S	BRM 1446 SSM BS
Power/Engine	1.6 kW Ducar, 4-stroke OHV engine	1.8 kW Ducar, 4-stroke OHV engine	2.1 kW B&S 500E, 4-stroke OHV engine
Displacement	98 cc	140 cc	140 cc
Cutting Width	400 mm	460 mm	460 mm
Cutting Height	25 mm - 75 mm, 7-position, central	25 mm - 75 mm, 6-position, central	30 mm - 80 mm, 6-position, central
Mulching and side discharge	-	-	yes
Collecting Bag Volume	45 l Textile	50 l Textile	50 l Textile with hard top
Sound Power Level	96 db(A)	96 db(A)	96 db(A)
Weight	21.30 kg	28.00 kg	32.60 kg
Model-N°	77005200	77005300	77005350

RECOMMENDED LAWN SIZES

SQ M
450
600
700



Mower
BRM 1040
BRM 1446 S
BRM 1446 SSM BS



- Primer



- Steel deck



- Wheels
15 cm / 18 cm



- Auto Choke



- Steel deck



- Wheels
18 cm / 20 cm



- Self-propelled

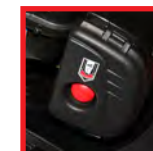

- Primer



- Steel deck



- Wheels
18 cm / 20 cm



- Self-propelled,
GT (France)
transmission



BRM 1040



BRM 1446S



BRM 1446SSM BS



Accessories



BRM 1040
Blade
77030079



BRM 1446 S
Blade
77031090



BRM 1446 SSM BS
Blade
77031032

Lawn Mower



Specifications	BRM 1746 SSM TL	BRM 1954 SSM BS	BRM 2354 SSM TL
Power/Engine	2.6 kW TL LM 710, Tonino Lamborghini	2.6 kW B&S 675EX, 4-stroke OHV engine	3.5 kW TL LM 910, Tonino Lamborghini
Displacement	173 cc	190 cc	223 cc
Cutting Width	460 mm	540 mm	540 mm
Cutting Height	30 mm - 80 mm, 6-position, central	27 mm - 90 mm, 7-position, central	27 mm - 90 mm, 7-position, central
Mulching and side discharge	yes	yes	yes
Collecting Bag Volume	50 l Textile with hard top	70 l Textile with hard top	70 l Textile with hard top
Sound Power Level	96 db(A)	98 db(A)	98 db(A)
Weight	34.50 kg	37.00 kg	37.00 kg
Model-N°	77005400	77005450	77005500

RECOMMENDED LAWN SIZES

SQ M

800

1000



Mower

BRM 1746 SSM TL

BRM 1954 SSM BS

BRM 2354 SSM TL



- Primer



- Steel deck



- Wheels
18 cm / 20 cm



- Self-propelled,
GT (France)
transmission



- Auto choke „Ready start“



- Steel deck



- High-wheeled
20 cm / 28 cm



- Self-propelled,
GT (France)
transmission



- Primer & auto
choke



- Steel deck



- High-wheeled
20 cm / 28cm



- Self-propelled,
GT (France)
transmission

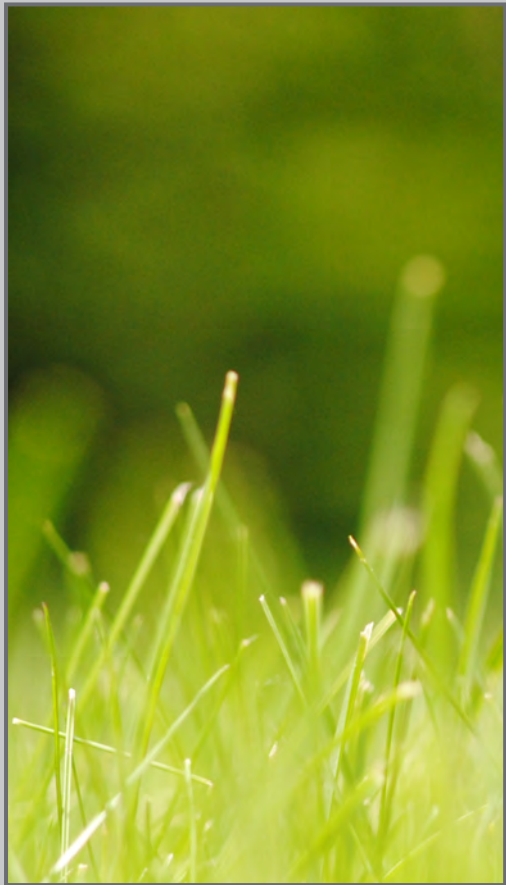

BRM 1746 SSM TL



BRM 1954 SSM BS



BRM 2354 SSM TL



Accessories



BRM 1746 SSM TL
Blade
77030079



BRM 1954 SSM BS
Blade
77031090



BRM 2354 SSM TL
Blade
77031032

SERVICE

IKRA

tools for home and garden

Aktuelle Service-Adressen finden Sie immer unter:
Latest service addresses can be found at:
Vous trouvez nos adresses SAV sous:
Las direcciones actuales para asistencia técnica
las encuentran siempre en:

<http://www.ikra.de>

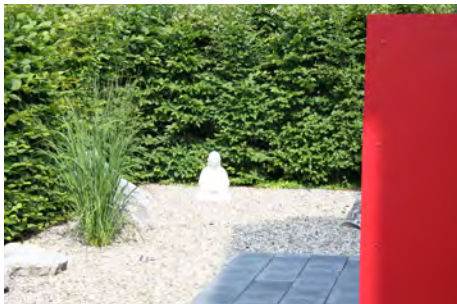

SERVICE - Germany

Mogatec

Moderne Gartentechnik GmbH

Im Grund 14

D - 09427 Drebach (GERMANY)

Phone: 0049 3725 449-335

Fax: 0049 3725-449 324

Email: info@ikra.de