

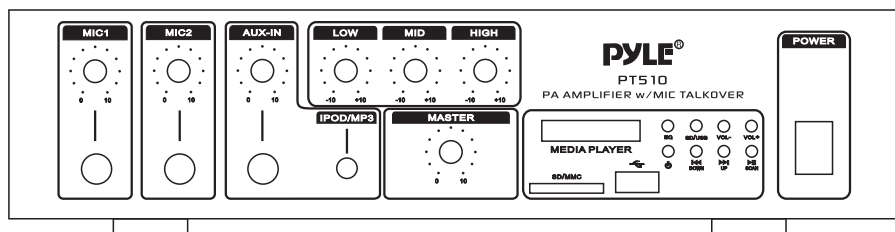

**240 Watt Public Address Power Amplifier, w/ 70V Output & Mic Talkover, USB/SD Card MP3 Player, Built-in FM Radio**



**MODEL:PT510 PA AMPLIFIER**

# INTRODUCTION

Your New PYLE PT510 AMPLIFIER gives you the power and versatility you need in a professional sound system.

The amplifier's wide frequency response makes it suitable for amplifying music or vocal program material. It can be used for live bands, office paging systems, public announcements, or a variety of other installations.

Please read this manual thoroughly before you attempt to set up and use the amplifier. It contains a range of installation suggestions as well as instructions to ensure safe usage. Installed properly, you can expect years of trouble-free service from this product.

## FEATURES AND CONTROLS

### FRONT PANEL- PT510

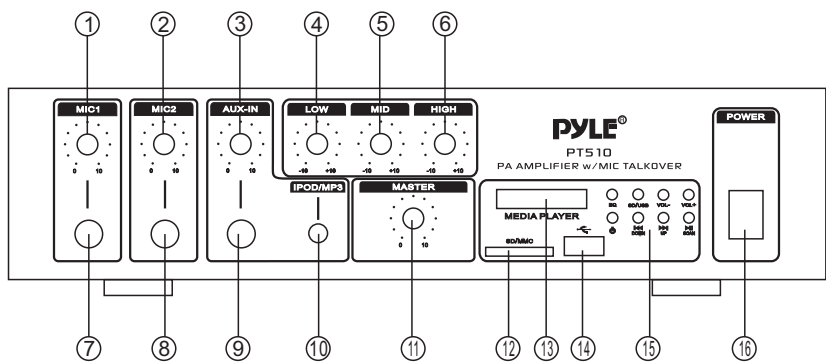

### REAR PANEL- PT510

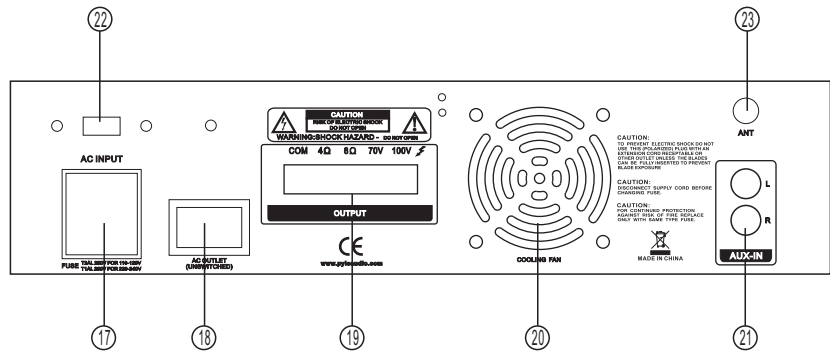

## MODEL:PT510 PAAMPLIFIER

1. MIC1 Volume Control
  - Volume control for MIC1.
2. MIC2 Volume Control
  - Volume control for MIC2.
3. AUX-IN VOLUME CONTROL
  - Allow you to control any high level sound source inputs (by 1/4" Audio Input, 1/8" iPod/MP3 input, and RCA Audio Input to connect any high level sound source inputs).
4. LOW Tone Control
  - Lets you adjust the sound of bass frequency to the acoustic of a Particular performance environment.
5. MID Tone Control
  - Lets you adjust the sound of middle range frequency to the acoustic of a Particular performance environment.
6. HIGH Tone Control
  - Lets you adjust the sound of treble frequency to the acoustic of a Particular performance environment.
7. MIC1 1/4" Input Jack
8. MIC2 1/4" Input Jack
9. Audio 1/4" Input Jack
  - allow you to connect any high level sound source, such as a CD player, tape deck, or tuner, to the CD/AUX jack.
10. IPOD/MP3 1/8" Input Jack
  - Let you easily connect the computerized MP3 Device(player) sources, such as PC (CD ROM) , Laptop, Walkman, iPod, and Cell Phone, iPhone, iPad, ect.
11. MASTER Volume Control
  - Lets you adjust the overall sound level.
12. SD/MMC Socket for Playing SD/MMC cards.
13. Function Blue LED Display Window.
14. USB Socket for playing the USB function.
15. Keys for MP3(USB/SD/MMC) Function Control:
  - EQ: Equalizer adjustment for the USB/SD.
  - SD/USB: Switch between the USB and SD playing.
  - Vol-/VOL+: Adjust MP3(USB/SD) volume- or volume+
  - $\Phi$  Power on or off for MP3(USB/SD/MMC)

## MODEL:PT510 PAAMPLIFIER

- DOWN/UP: Song Selection Control both for MP3(USB/SD/MMC) and FM Tuner
- PLAY/PAUSE: Play or Pause control for MP3(USB/SD/MMC) and FM Tuner.

16. Power On/Off for the Whole Machine.

### 17.AC INPUT

- When plug the power supply cable on the machine, pls make sure the switch as above is in the proper position before operating,

### 18.AC OUTLET

- Unswitched AC Accessory Outlet-300W MAX.

### 19.Push-Terminal Connectors

- Let you easily connect the speaker wires directly to the amplifiers

### 20.FAN: Cooling Fan

### 21.AUX INPUT JACK

- Allows you to connect any high level sound source, such as a CD player, tape deck, or tuner, to the CD/AUX jack.

### 22.110V/220V Voltage Switch

- The amplifier has selectable input voltage from 110V/60Hz which is the standard in USA and CANADA. You can also switch the input voltage to 220V/50Hz for EUROPEAN operation. Pls make sure the switch as above is in the proper position before operating,

### 23.ANT

- Connect for FM Antennas

## INSTALLATION GUIDELINES

Connecting the GND (GROUND) screw terminal

If you connect a low level audio input source (turntable) to the PHONO, please connect your turntable's ground wire (usually black or green) to the amplifier's GND terminal, to avoid a low frequency hum.

You can also use this screw to ground any other system connection.

### Input connections

The PT 510 accept a board range of input sources, including:

Microphones (up to two simultaneously)  
Compact Disc (CD) player  
Cassette, Reel-to-Reel or other tape player  
Radio Tuner  
Magnetic Cartridge Turntable

## Connecting microphones

The MIC 1 and MIC 2 jacks permit you to connect two microphones with 6.35mm plug.

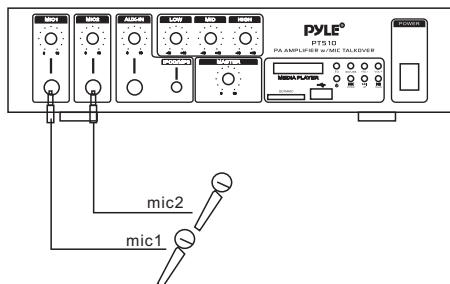

## Connecting a turntable

In this Situation, set the PHONO and AUX/CD SELECTOR switch to the PHONO.

## Speaker connections

One or more speakers ( 4 or 8 – Ohm) speakers can be connected to the amplifier with or without transformers. However, before you connect any speaker to the amplifier, the total speaker impedance must be calculated in order to avoid damage to the amplifier. A total speaker impedance greater than 8 Ohms or less than 4 Ohms can cause this damage to occur. To begin with, in order to ensure equal volume from each speaker, all connected speakers should have the same impedance.

A proper total impedance within the 4 to 8 Ohms range can be achieved by combining series and parallel speaker connections. Please see the diagrams which follow the same impedance.

Finally, always use the shortest length of speaker wire possible of proper gauge. Usually, 18-gauge wire is adequate for lengths under 25 feet, while 16-gauge is used for greater lengths.

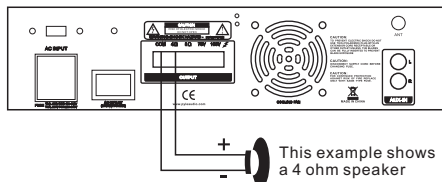

### System 1: Single speaker system

1. Connect the speaker (-) terminal to the amplifier COMMON terminal
2. Depending on the speaker being used, connect the speaker (+) terminal to the amplifier's 4-Ohm or 8- Ohm amplifier terminal.

## System 2: Two (or more) speakers in series

1. Connect the LEFT SPEAKER (-) to the amplifier COMMON terminal.
2. Connect the LEFT SPEAKER (+) to the RIGHT SPEAKER (-).
3. Connect the RIGHT SPEAKER (+) to the amplifier's 4-Ohm or 8-Ohm terminal, depending on the TOTAL IMPEDANCE of the two speakers.

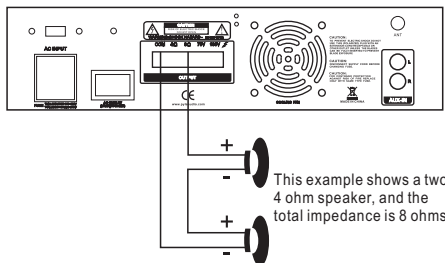

## TO THE 8-OHM TERMINAL

### System 3: Two (or more) speakers in parallel

1. Connect the LEFT SPEAKER (-) to the RIGHT SPEAKER (-).
2. Connect BOTH the LEFT SPEAKER (-) and the RIGHT SPEAKER (-) to the amplifier COMMON terminal.
3. Connect the LEFT SPEAKER (+) to the RIGHT SPEAKER (+).
4. Connect BOTH the LEFT SPEAKER (+) and RIGHT SPEAKER (+) to the amplifier 4-Ohm or 8-Ohm terminal, depending on the TOTAL IMPEDANCE of the two speakers. If each speaker has an impedance of 8-Ohm, the total speaker impedance in this parallel configuration is 4 Ohms.

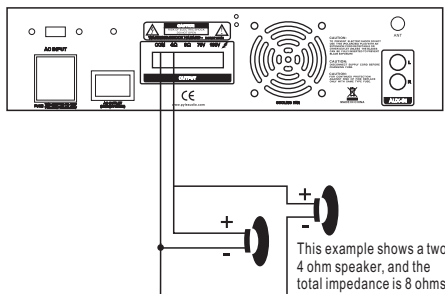

System4: Connecting speakers with transformers

- 1. Locate the input taps on your transformer. These taps are on side of the transformer, and are rated in watts, 10, 5, 2.5, 1.25 or 0.62. Usually, each speaker in a system uses the same wattage tap.
- Connect the selected tap to the amplifier 70V RMS terminal.
- If you wish a particular speaker to have a higher volume level, connect the wire from 70V RMS to a higher wattage tap on the transformer.
- 2. Connect the transformer's COMMON tap on the primary side to the amplifier COMMON terminal.
- 3. Connect the speaker's (+) terminals to the transformer's secondary tap that matches the speaker's TOTAL IMPEDANCE. Locate on the opposite side of the transformer, these secondary taps are outputs, and are rated in Ohms 4 or 8 .
- 4. Connect the speaker's (-) terminals to the transformer's COMMON tap on the secondary side.

NOTE: Before connecting the speakers, please be sure the total wattage of the primary tap you use does not exceed the amplifier's maximum power rating .

ALSO: Avoid, where possible, multiple connections to the 70V RMS and COMMON terminals.

Specifications

Output Power at THD 10% , 1 kHz .....	50W
Maximum Power .....	240W
THD at 1W, 1 kHz Low-Pass Filter	
MIC 1.....	1%
MIC 2.....	1%
AUX/ CD .....	1%
Frequency Response (at 1W, +/- 3 dB)	
MIC 1.....	80 Hz - 20 kHz
MIC 2.....	80 Hz - 20 kHz
AUX/ CD .....	80 Hz - 20 kHz
Input Sensitivity (at 10% THD, 1kHz)	
MIC 1.....	2.5 mV
MIC 2.....	2.5 mV
AUX/ CD.....	150mV
Signal-Noise Ratio (Input Shorted) with WTD	
MIC 1.....	60dB
MIC 2.....	60dB
AUX/ CD .....	70dB
Noise Level (Input Shorted).....	0.75mV

Equalizer Control Range

100 Hz.....	+/- 10 dB
1 kHz.....	+/- 10 dB
8 kHz.....	+/- 10 dB

Power Requirement

120V AC, 60 Hz/ 240V AC, 50 Hz

Power Fuse

120V AC .....	2 A
240V AC .....	1 A

Dimensions H x W x D,

12.6x7.48x3.15 (inches)  
32x19x8(cm)

Weight, (kg)

4.2KGS

