

User's Manual

Stay Cool 2000!

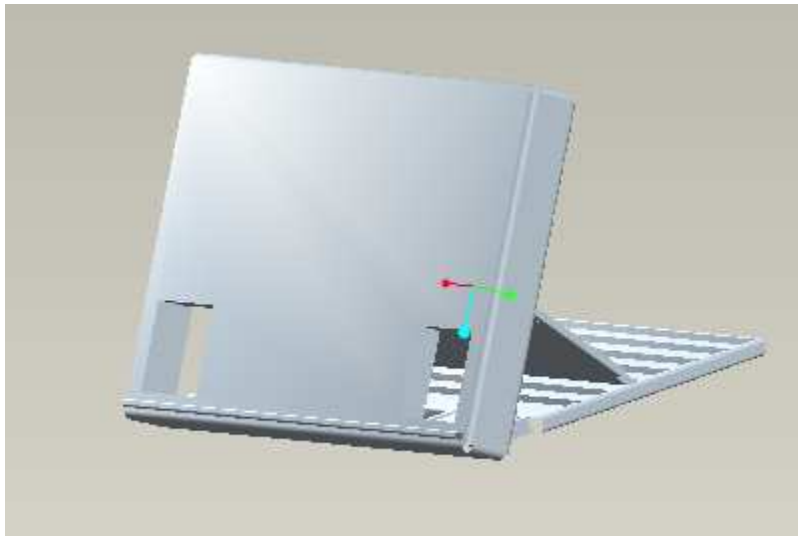

Congratulation on your purchase!!!

At DK Engineering, we strive to bring cutting edge technology straight to you. Our products are made with the best materials and craftsmanship in the market. Hope you enjoy your new Stay Cool 2000!.

Table of Contents

1. Items included with the Stay Cool 2000!
Page 3
2. Assembly and instructions
Pages 5-7
3. Maintenance and Service
Page 9
4. Warranty Information
Page 10

Included items for the Stay Cool 2000!

1. (1) Master piece

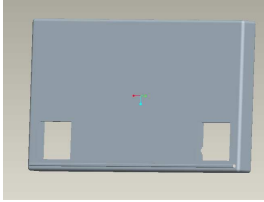

2. (1) Base

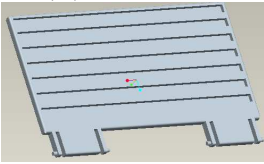

3. (1) Support

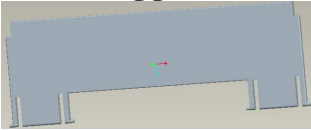

4. (1) Battery Box cover



5. (4) AAA Batteries



6. (1) Metal Screw



Assembly

Step 1: Remove contents from the container and check for all parts listed above.



Step 2: Connect support to master piece

- Squeeze tabs so that the support pieces dowels will fit into their holes in the master piece.

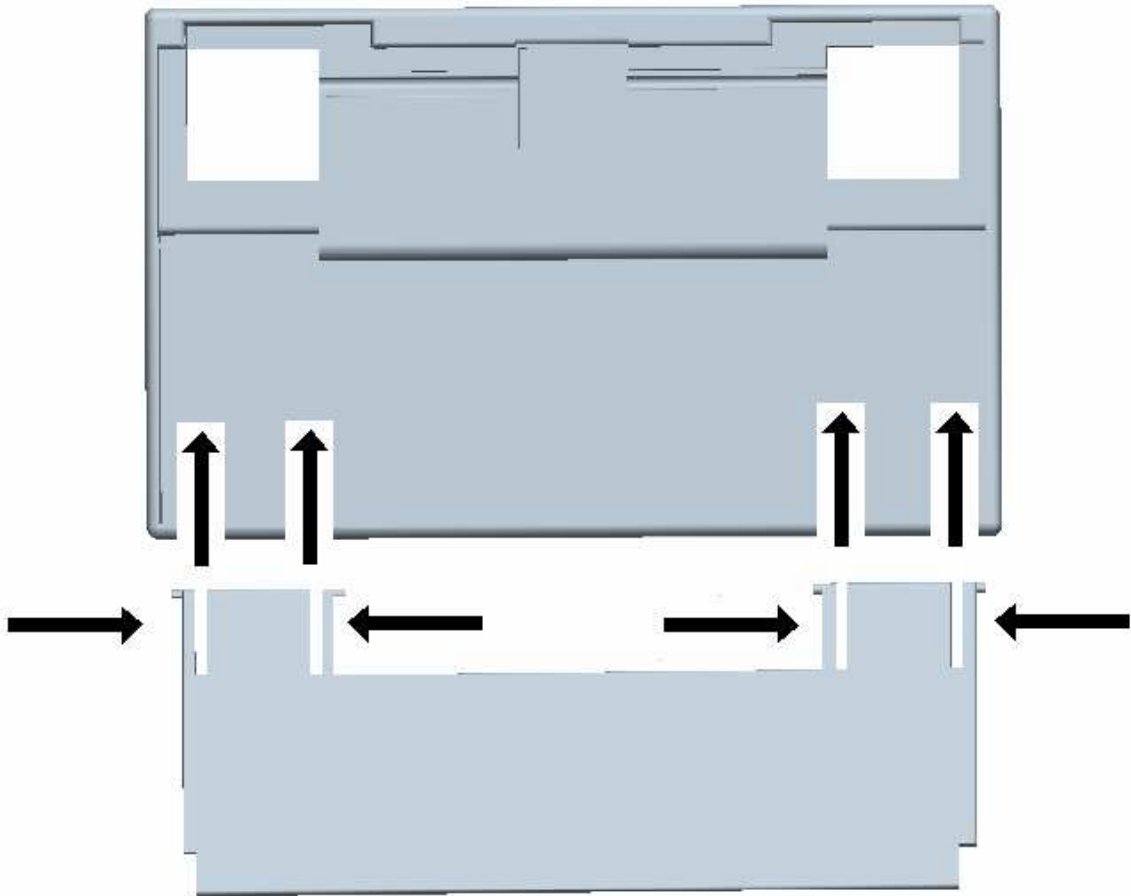

Step 3: Connect Battery Box

-Battery box cover has two extrusions that will fit into the designated holes. First put one extrusion into it appropriate hole. *****MAKE SURE THAT IT IS POINTING WITH THE BEVELED HOLE FACING OUT*****. Then push the cover into the other hole.

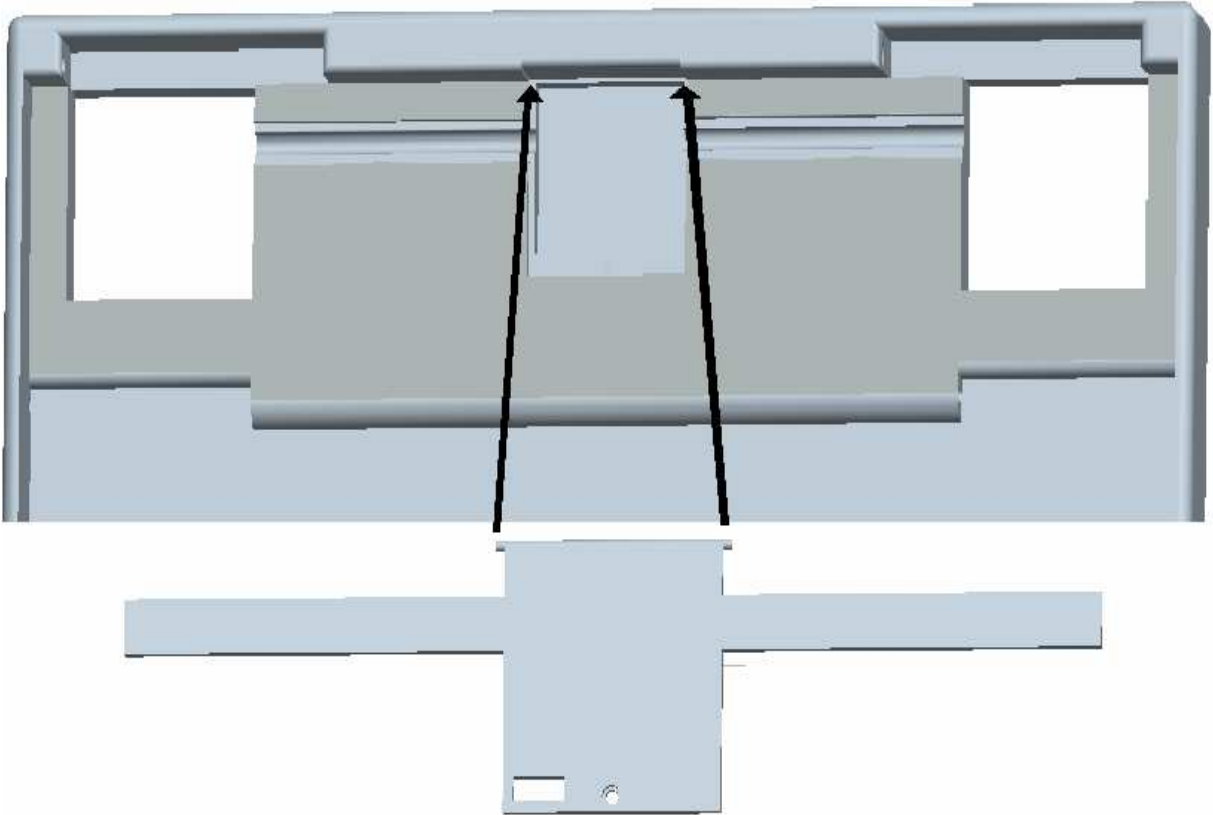

Step 4: Connect Base to Master piece.

- Squeeze tabs at bottom of Base together so that the dowels sticking out from the base will go inside with the holes in the Master Piece.
****MAKE SURE RIDGES ARE FACING TOWARDS MASTER PIECE DURING ASSEMBLY****

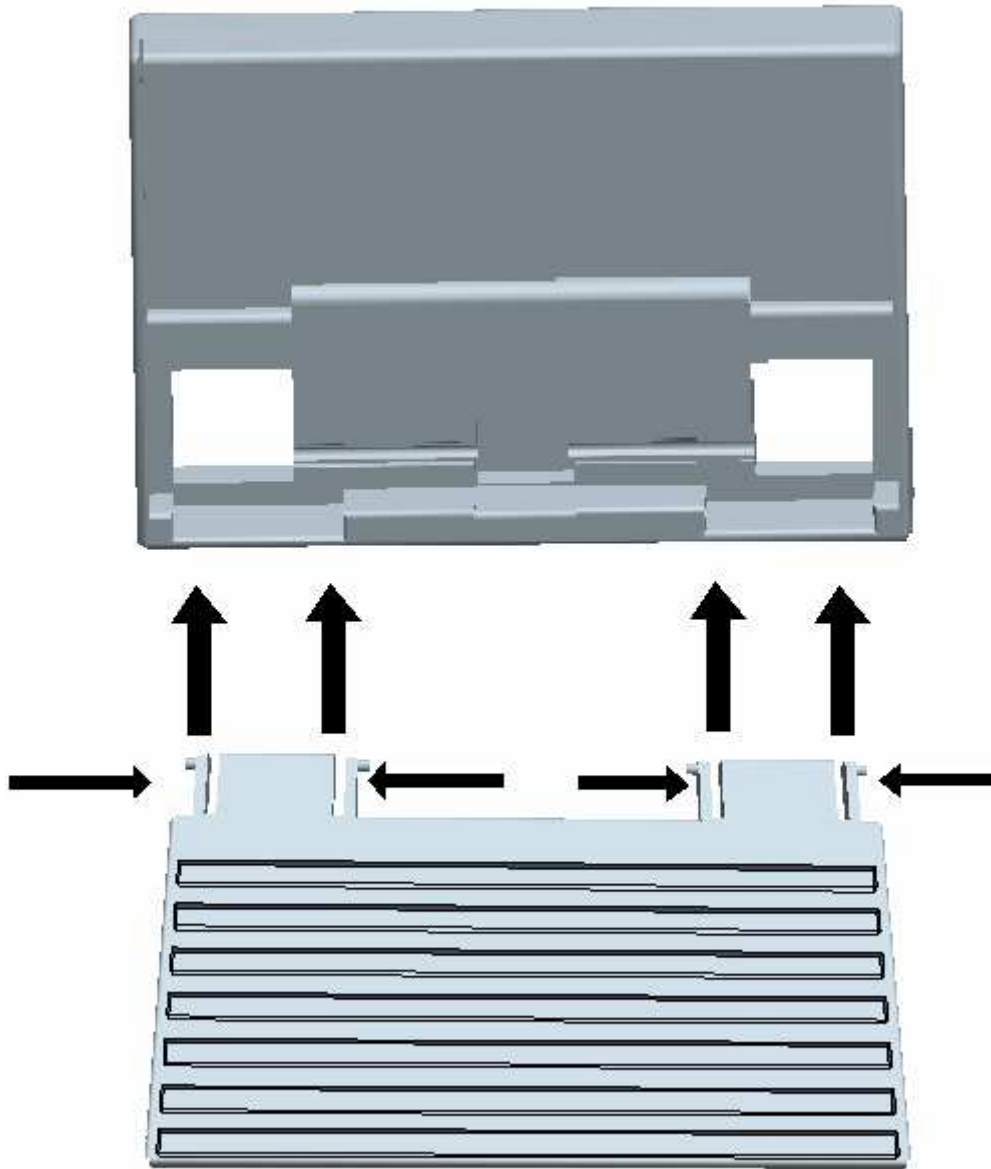

Step 5: Install batteries into battery box. **** Do not mix batteries or install batteries in wrong way. Batteries can be toxic, and should be kept away from children****

Step 6. Screw metal screw through battery box cover and into master piece with a Phillips head screwdriver until screw is flush with battery box cover.

Usage Instructions

Step 1: Unfold Base from Main structure. *****Do not force base past 90 ° of main structure*****

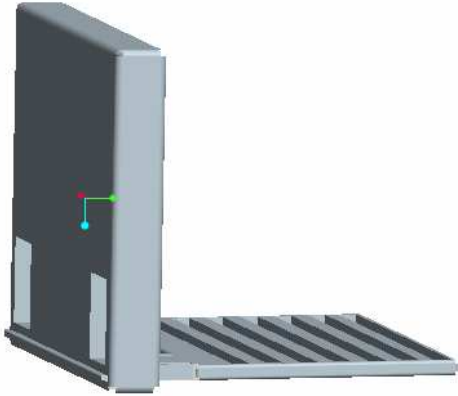

Step 2: Unfold Support from Main Structure and set product to desired angle of usage.

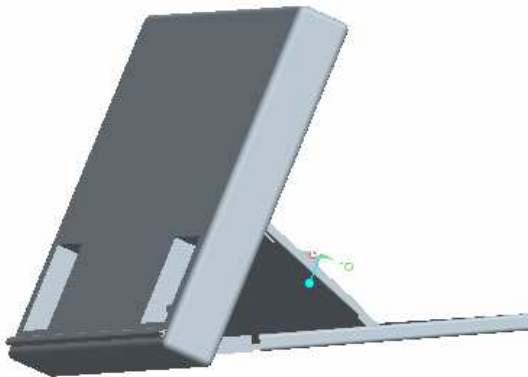

Step 3: Turn on fans by moving the switch found near top right of battery box. (if desired)

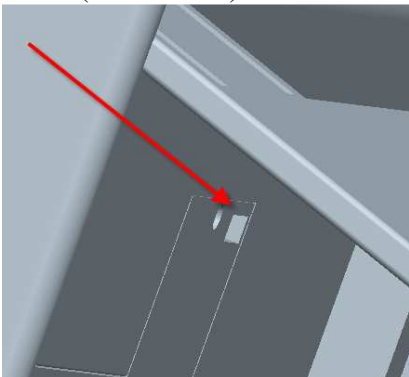

Warranty Information

DK Engineering One – Year Limited Warranty

DK Engineering’s warranty obligations for this product are limited to the terms set forth below:

DK Engineering warrants this product against defects in the material and or workmanship under normal use for a period of one (1) year, Warranty Period, from original purchase date. If a defect arise, and a valid claim is received by the service center listed in previously in this manual, within the Warranty Period, DK Engineering will either (1) replaced the defective part with new or refurbished parts at no charge, (2) replace the product with a new or refurbished product that is at least functionally the same as the original product, (3) refund the original purchase price of the product, proof of purchase might be required.

Exclusions and Limitations

The Limited Warranty only applies to those product manufactured by DK Engineering. The warranty does not apply (1) to damage caused by accident, misuse, food, flood, fire, earth quake or other external causes, (2) to damage caused by operating the product outside of parameters given in this manual.

Consumer Protection Laws

For full information on consumer protection laws, contact DK Engineering Service Center as listed previously in this manual.

Obtaining Warranty Service

If you feel you have a valid warranty claim as described above, please contact DK Engineering Service Center as listed previously in this manual, for warranty claim help and service.

DK Engineering