

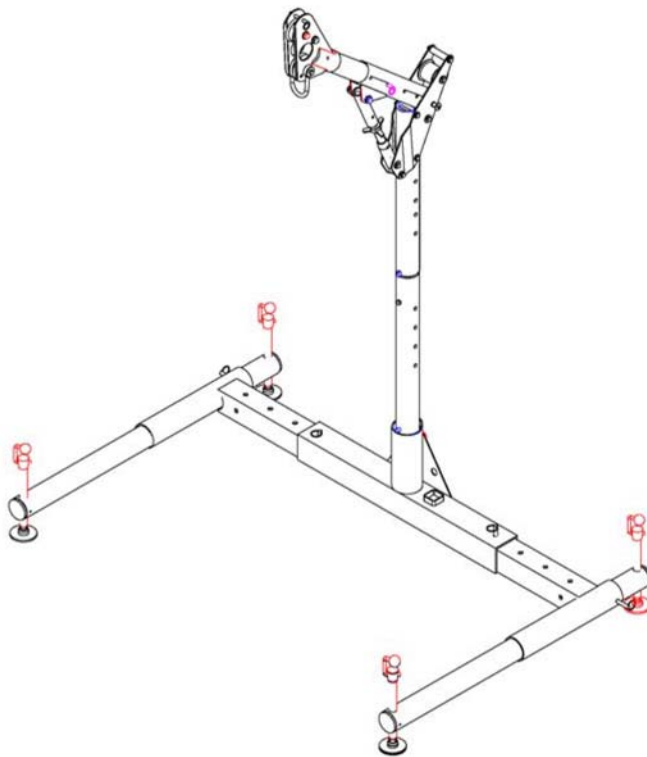

ISO 9001 REGISTERED

&

CE CERTIFIED



**MAN RATED  
CONFINED SPACE  
ENTRY/RETRIEVAL  
12"-29" ADJUSTABLE/  
VARIABLE OFFSET HOIST SYSTEM  
OPERATOR'S MANUAL**



## **LIMITED WARRANTY**

This Limited Warranty is given exclusively to:

---

Name

---

Address

---

Telephone No.

by Unique Concepts Ltd. ("Unique Concepts") in respect of the following product(s) manufactured by it (the "Products"):

---

---

---

Subject to the conditions and restrictions contained in this Limited Warranty, Unique Concepts warrants to the Customer that the Products are free from defects in materials and workmanship under normal use and service for a period of twelve (12) months from the date the Products are purchased by the Customer, in new and unused condition, from Unique Concepts or its agent (the "Warranty Period"). Unique Concepts' entire liability and the Customer's exclusive remedy regarding any such defects is limited to the repair or replacement of the defective Products (as Unique Concepts, in its sole discretion, deems appropriate) which are returned to Unique Concepts in accordance with the procedures set forth below.

### **Terms and Conditions**

1. This Limited Warranty will be void unless:
  - (a) this Limited Warranty is fully completed by or on behalf of the Customer and returned to Unique Concepts within fourteen (14) days following the date the Customer purchases the Products, by registered mail addressed to: Unique Concepts Ltd., 1500 King Edward Street, Winnipeg, Manitoba, R3H 0R5 (the "Manufacturer's Address");
  - (b) written notice of any defect is delivered to the Manufacturer's Address by registered mail within five (5) days after any defect in the Products becomes apparent; and
  - (c) any defective Products in respect of which the Customer wishes to make a warranty claim are delivered to Unique Concepts, with all postage or freight charges prepaid, within the Warranty Period and no later than fourteen (14) days after any defect in the Products becomes apparent.
2. This Limited Warranty shall not apply to any Products which have been used with unapproved assemblies or sub-assemblies, or which have been customized or modified, altered, damaged or misused.
3. Following the repair or replacement of any defective Products in respect of which a warranty claim is validly made by the Customer, or, alternatively, following the date Unique Concepts determines either that the warranty given hereby has been voided or that the returned Products do not exhibit any defects in materials or workmanship, Unique Concepts will return the Products to the Customer. All such shipments will be made to the Customer's address listed above, and will be at the Customer's sole expense.

4. The Customer will incur all risk of loss, theft or damage to the Products during shipment to Unique Concepts and during their subsequent return to the Customer. Without limiting the foregoing, the common carrier chosen by Unique Concepts to return the Products to the Customer will be deemed to be an agent of the Customer.

5. If, on its inspection of any Products returned to it by the Customer, Unique Concepts determines that such Products require maintenance or repairs which are outside the scope of its warranty obligations. Unique Concepts may contact the Customer with a view to obtaining authorization (which may be written or oral) to complete such maintenance or repairs at rates then customarily charged by Unique Concepts to its customers. The Customer hereby releases and indemnifies Unique Concepts, together with its directors, officers, agents, employees, successors and assigns, and anyone else who has been involved in the inspection of the Products returned by the Customer, from all claims, losses, expenses and damages (including damages for loss of business profits, business interruption, loss of business information, loss of health or for any other loss whatsoever) arising directly or indirectly, as a result of the failure by Unique Concepts to perform or adequately perform any maintenance or repairs which are outside the scope of its warranty obligations hereunder, whether or not resulting from any negligent or improper inspection of such Products, or from the failure of the Customer to authorize the performance of such maintenance or repairs.

6. THE WARRANTY SET OUT HEREIN IS THE ONLY WARRANTY OF ANY KIND, EITHER EXPRESS OF IMPLIED, STATUTORY OR OTHERWISE (INCLUDING BUT NOT LIMITED TO THE IMPLIED WARRANTIES OR MERCHANTABILITY AND FITNESS FOR A PARTICULAR PURPOSE) THAT IS MADE BY UNIQUE CONCEPTS. WITHOUT LIMITING THE GENERALITY OF THE FOREGOING, UNIQUE CONCEPTS DOES NOT WARRANT THAT THE PRODUCTS WILL MEET ALL REQUIREMENTS OF ALL APPLICABLE LAWS, REGULATIONS OR OTHER ENACTMENTS APPLICABLE IN EACH JURISDICTION IN WHICH THEY MAY BE USED OR STORED, OR THE REQUIREMENTS OF THE CUSTOMER.

7. NO ORAL OR WRITTEN INFORMATION OR ADVICE GIVEN BY UNIQUE CONCEPTS, ITS DEALERS, DIRECTORS, OFFICERS, DISTRIBUTORS, AGENTS OR EMPLOYEES SHALL CREATE A WARRANTY OR IN ANY WAY INCREASE THE SCOPE OF THIS LIMITED WARRANTY, AND THE CUSTOMER MAY NOT RELY ON ANY SUCH INFORMATION OR ADVICE.

8. THE CUSTOMER AGREES THAT, TO THE MAXIMUM EXTENT PERMITTED UNDER APPLICABLE LAW, NEITHER UNIQUE CONCEPTS NOR ITS DEALERS, DIRECTORS, OFFICERS, DISTRIBUTORS, AGENTS OR EMPLOYEES, OR ANYONE ELSE WHO HAS BEEN INVOLVED IN THE CREATION, PRODUCTION OR DELIVERY OF THE PRODUCTS, WILL BE LIABLE FOR ANY DIRECT, INDIRECT, CONSEQUENTIAL OR INCIDENTAL DAMAGES (INCLUDING DAMAGES FOR LOSS OF BUSINESS PROFITS, BUSINESS INTERRUPTION, LOSS OF BUSINESS INFORMATION, LOSS OF HEALTH OR ANY OTHER LOSS WHATSOEVER) ARISING OUT OF THE USE OR INABILITY TO USE SUCH PRODUCT, EVEN IF UNIQUE CONCEPTS HAS BEEN ADVISED OF THE POSSIBILITY OF SUCH DAMAGES.

9. The Customer is not entitled to assign this Limited Warranty to any party. To the maximum extent permitted under applicable law, and at its sole discretion, Unique Concepts is entitled to assign its obligations hereunder to any third party.

10. This Limited Warranty is governed by the laws of the Province of Manitoba and will benefit Unique Concepts and its successors and assigns.

### **ACKNOWLEDGEMENT**

THE CUSTOMER ACKNOWLEDGES THAT HE/SHE HAS READ THIS LIMITED WARRANTY, UNDERSTANDS IT, AND AGREES TO BE BOUND BY ITS TERMS AND CONDITIONS. THE CUSTOMER FURTHER AGREES THAT THIS LIMITED WARRANTY CONTAINS THE COMPLETE AND EXCLUSIVE STATEMENT OF AGREEMENT BETWEEN THE PARTIES, AND SUPERSEDES ALL PROPOSALS OR PRIOR AGREEMENTS ORAL AND WRITTEN, AND ANY OTHER COMMUNICATIONS BETWEEN THE PARTIES, RELATING TO THE SUBJECT MATTER OF THIS LIMITED WARRANTY.

---

Date

---

Customer

**WARRANTY VOID IF NOT REGISTERED**



## UNIQUE CONCEPTS

### CONFINED SPACE ENTRY/RETRIEVAL UCL ADVANCED 12-29" ADJUSTABLE VARIABLE OFFSET HOIST SYSTEM

#### WARRANTY REGISTRATION FORM & INSPECTION REPORT

##### WARRANTY REGISTRATION (please print)

This form must be filled out by the dealer and signed by both the dealer and the customer at the time of delivery.

Customer's Name \_\_\_\_\_

Dealer Name \_\_\_\_\_

Address \_\_\_\_\_

Address \_\_\_\_\_

City, State/Province, Code \_\_\_\_\_

City, State/Province, Code \_\_\_\_\_

Phone Number ( \_\_\_\_ ) \_\_\_\_\_

Phone Number ( \_\_\_\_ ) \_\_\_\_\_

Contact Name \_\_\_\_\_

Manufactured by: Unique Concepts Ltd.

1500 King Edward Street, Unit 1

Winnipeg, Manitoba, Canada

R3H 0R5

Model \_\_\_\_\_

Phone Number (204) 694-7432

Serial Number \_\_\_\_\_

Fax Number (204) 694-7612

Delivery Date \_\_\_\_\_

Toll Free 1-800-455-9673

#### DEALER INSPECTION REPORT

- \_\_\_ All Appropriate Fasteners Torqued
- \_\_\_ Check that all fasteners and mechanical components are present
- \_\_\_ Check Winch with Winch Warranty Card
- \_\_\_ No Mechanical Damage
- \_\_\_ Check for finish damage

#### SAFETY

- \_\_\_ All Labels Installed Correctly and Legible
- \_\_\_ Review Operating and Safety Instructions

I have thoroughly instructed the buyer on the above described equipment which review included the Operator's Manual content, equipment care, adjustments, safe operation and applicable warranty policy.

Date \_\_\_\_\_ Dealer's Rep. Signature \_\_\_\_\_

The above equipment and Operator's Manual have been received by me and I have been thoroughly instructed as to care, adjustments, safe operation and applicable warranty policy.

Date \_\_\_\_\_ Owner's Signature \_\_\_\_\_

**Please cut out, photocopy for your records and send signed original back to UCL.**





## SERIAL NUMBER LOCATION

Always give your dealer or distributor the serial number of your **12"-29" ADJUSTABLE/ VARIABLE OFFSET HOIST SYSTEM** when ordering parts or requesting service or other information.

The serial number plate is located where indicated. Please mark the number in the space provided for easy reference.

DBI  
**SALA**

www.capitalsafety.com

COMPONENT MODEL:

MFG DATE:

MADE IN CANADA      P#: 12817 Rev.03

LOT No.

SYSTEM MODEL:

SERIAL No.

## SERIAL NUMBER LABEL

Model\_\_\_\_\_

Serial Number\_\_\_\_\_



# 1 INTRODUCTION

Congratulations on your choice of a Unique Concepts Man Rated Confined Space Entry/Retrieval 12" (305 mm) to 29" (737mm) Adjustable/Variable Offset Hoist System to compliment your entry/retrieval operation. This equipment has been designed and manufactured to comply with the requirements of **ANSI Z 359.1-1992, A 10.14-1991 & CE** to meet the needs of a discriminating operator for the efficient entry/or retrieval of people from a confined space.

Safe, efficient and trouble free operation and maintenance for your component or system requires that you or anyone else who will be operating, maintaining or inspecting the equipment, read, understand and follow all the Safety, Installation, Operation, Maintenance and Inspection instructions contained in this manual, and in any related manuals referenced in this manual and/or supplied with the system.

This manual covers the 12" to 29" Adjustable/ Variable Offset Hoist System manufactured by Unique Concepts. Use the Table of Contents or Index as a guide when searching for specific information.

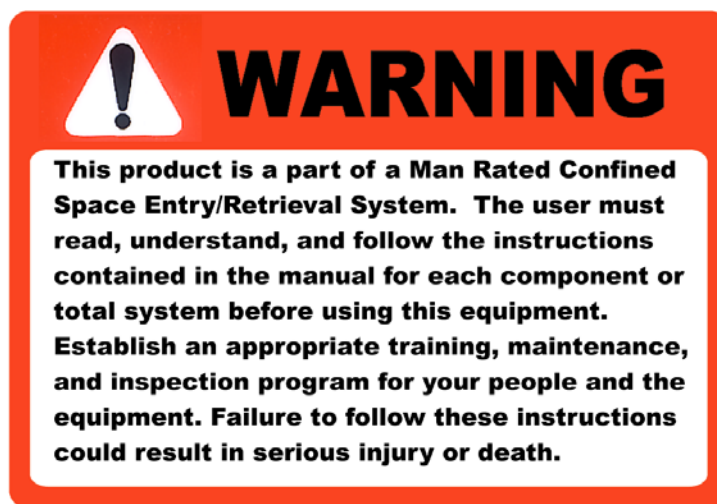

Keep this manual handy for frequent reference and to pass to new operators. Establish a regular training program for experienced and new operators per these instructions. Establish a regular maintenance and inspection program to keep the equipment in top condition.

Modular components are labeled with the capacities and rating to which they were designed, tested, and manufactured. The rating of any system is considered to be the rating of the lowest rated component contained in the system.

Do not use the equipment if rating stickers are damaged or illegible. New stickers are available from the manufacturer. When ordering replacement stickers be sure to include:

- 1) The part number from the bottom right hand corner of the sticker, when available.
- 2) The serial number of the unit.
- 3) The part (item) number of the component (consult the appropriate section of this manual).
- 4) Any other numbers stamped on the components.

## 2 SAFETY

### SAFETY ALERT SYMBOL

This Safety Alert symbol means  
**ATTENTION! BECOME ALERT!**  
**YOUR SAFETY IS INVOLVED!**

The Safety Alert symbol identifies important safety messages on your equipment and in the manual. When you see this symbol, be alert to the possibility of personal injury or death. Follow the instructions in the safety message.



Why is SAFETY important to you?

#### 3 Big Reasons

**Accidents Disable and Kill**  
**Accidents Cost You Money**  
**Accidents Can Be Avoided**

#### SIGNAL WORDS:

Note the use of the signal words **DANGER**, **WARNING**, and **CAUTION** with the safety messages. The appropriate signal word for each message has been selected using the following guide-lines:

**DANGER** - Indicates an imminently hazardous situation that, if not avoided, will result in death or serious injury. This signal word is to be limited to the most extreme situations, or for hidden or unseen hazards.

**WARNING** - Indicates a potentially hazardous situation that if not avoided, could result in death or serious injury, and includes obvious and hidden hazards. It may also be used to alert against unsafe practices.

**CAUTION** - Indicates a potentially hazardous situation that, if not avoided, may result in minor or moderate injury. It may also be used to alert against unsafe practices.

# SAFETY

**YOU** are responsible of the **SAFE** operation, maintenance and inspection of your Unique Concepts Man Rated Confined Space Entry/ Retrieval 12" to 29"Adjustable/ Variable Offset Hoist System. **YOU** must ensure that you and anyone else who is going to operate, maintain, inspect or work around the equipment be familiar with the operating and maintenance procedures and related **SAFETY** information contained in this manual. This manual will take you step-by-step through your working day and alerts you to all good safety and operating practices while using the equipment.

Remember, **YOU** are the key to safety. Good safety practices not only protect you, but also the people around you. Make these practices a working part of your safety program. Be certain that **EVERYONE** operating this equipment is familiar with the procedures recommended and follows safety precautions. Remember, most accidents can be prevented. Do not risk injury or death by ignoring good safety practices.

- Owners must give operating instructions to operators or employees before allowing them to use the equipment, and at least annually thereafter.
- The most important safety device on this equipment is a **SAFE** operator. It is the operator's responsibility to read and understand **ALL** Safety and Operating instructions in the manual and to follow these. All accidents can be avoided.
- A person who has not read, been trained in using and understood all operating and safety instructions is not qualified to operate this equipment. An untrained operator exposes himself and others to possible serious injury or death.
- Do not modify the equipment in any way. Unauthorized modification may impair the function and/or safety and could affect the life of the equipment.
- Think **SAFETY!** Work **SAFELY!**

## 2.1 GENERAL SAFETY

1. Read, understand and follow the User Manual and all safety signs before using, maintaining or inspecting the equipment.
2. Refer to and follow applicable **ANSI, OSHA, CE** or other Standards and local regulations. Comply with requirements of local regulations for your applications.
3. Establish an equipment–use training program for experienced employees. Only trained, competent persons shall use the equipment. An untrained operator is not qualified to operate the system.



4. Have a first-aid kit available for use should the need arise and know how to use it.
5. Provide a fire extinguisher for use in case of an accident. Store in a highly visible place.
6. Install and properly secure all guards and shields before operating.
7. Wear appropriate protective gear. This list includes but is not limited to:



- A hard hat
- Safety glasses
- Protective shoes with slip resistant soles
- Heavy gloves
- Protective clothing
- Face protection



8. Review and follow the Pre-Operation Inspection before using a component in the system or the system itself.
9. Establish a regular Maintenance and Inspection program with your equipment and maintain detailed records.
10. Review safety related items and operating instructions with all personal on a regular basis.
11. Be aware of your environmental surroundings; be sure not to use the equipment during an electrical storm. (this equipment is conductive)
12. When using our winch, the noise level does not exceed 70 dba.

## 2.2 OPERATING SAFETY

1. Read, understand and follow the Operator's Manual and signs on the equipment before using, maintaining or inspecting the equipment.
2. Train all operators before allowing them to use the equipment. An untrained operator exposes themselves, bystanders and workers to possible serious injury or death.
3. Visually inspect the equipment and all auxiliary components and equipment before using. Correct any problems before using the equipment.
4. Securely anchor the winch before using, where applicable.
5. Use only certified anchor and connector components in your system.
6. Use only an approved full body harness for the workers.
7. Always work in teams. One person works in the confined space and the other one pays out the line and reels it in.
8. Do not use the winch when the brake wear indicators display in the red or the counter exceeds 30,000 cycles or 5 years. Return winch to manufacturer for service. (Refer to the Digital Winch Operators Manual for detailed information on winch operation.)
9. Do not exceed 450lbs. (205 kg) on the line during operation.
10. Establish a regular training program for new and experienced workers.
11. Establish a detailed inspection program for your equipment and document the findings. Return the equipment to the manufacturer for rework if any problems are found.
12. Plan your work program before starting. Have the required people, equipment and procedures available to do the job.
13. Do not use the equipment around physical or environmental hazards. This list includes but is not limited to:

- a. Corrosion that may affect the structural integrity of the life line or other components
- b. Chemicals which can degrade components and not be visible.
- c. Toxic gases: Rescuers or workers can be killed in toxic environments.
- d. Heat or elevated temperatures.
- e. Moving machinery: Workers or auxiliary equipment can be contacted by or pulled into moving components.
- f. Sharp edges: Workers or the equipment can be injured or damaged by sharp edges or components.
- g. Electrical hazards: Stay away from power lines or components carrying electrical power.
- h. Overload: Do not exceed 450 lbs. (205 kg) during operation.
- i. Follow confined space regulations in Standards.
- j. Noise: wear appropriate noise protection where necessary.
- k. Environmental hazards: do not operate equipment during electrical storms.

## 2.3 MAINTAINANCE/ INSPECTION SAFETY

1. Read, understand and follow the User Manual and signs on the equipment before using, maintaining or inspecting the equipment.
2. **ANSI, OSHA & CE** requires a regular inspection program for all Confined Space Entry/Retrieval Equipment and to maintain documented results of these inspections. Follow the inspection procedure contained in this manual and use the inspection form to document the results.
3. Keep instructional and safety signs clean and legible at all times. Clean or replace as required.
4. Lubricate winch as per instructions in Section 4 of this manual.
5. Remove the equipment from service if a problem is found during the inspection. Return to an authorized repair depot or the factory for service.

### **3 OPERATING, NEW OPERATOR OR OWNERS**

The 12" to 29" Adjustable/ Variable Offset Hoist System is designed to attach to a person (entrant) and allow them to enter a confined space and assist in exiting if required. Every new operator must read, understand and follow the instructions in all applicable manuals. No one should be allowed to use the equipment without training. The training should be reviewed with experienced operators on a regular basis. At regular intervals perform a detailed inspection of the equipment and document the results. Remove from service if deficiencies are found. Alterations or misuse of this equipment or failure to follow instructions, may result in serious injury or death.

**It is the responsibility of the owner's organization or operator to read this manual and to train all other operators before they start working with the equipment. Follow all safety instructions exactly. Safety is everyone's business. By following recommended procedures, a safe working environment is provided for the operator, bystanders and the area around the work site. Untrained operators are not qualified to operate the equipment.**

Many features incorporated into this equipment are the result of suggestions made by customers like you. Read this manual carefully to learn how to operate the equipment safely and how to set it to perform as intended. By following the operating instructions in conjunction with a good maintenance program, your equipment will provide many years of trouble-free service.



## OPERATING SAFETY

1. Read, understand and follow the User Manual and signs on the equipment before using, maintaining or inspecting the equipment.
2. Train all operators before allowing them to use the equipment. An untrained operator exposes themselves, bystanders and workers to possible serious injury or death.
3. Visually inspect the equipment and all auxiliary components and equipment before using. Correct any problems before using the equipment.
4. Securely anchor the winch before using.
5. Use only certified anchor and connector components in your system.
6. All anchor points, or mounting/setup locations for permanent or portable systems must be approved to local standards by a qualified engineer.
7. Use only an approved body harness for the workers.
8. Always work in teams. One person works in the confined space and the other one pays out the line and reels it in.
9. Do not use the equipment when the winch brake wear indicators display in the red, the counter exceeds 30,000 cycles or 5 years in service (which ever comes first). Return equipment to manufacturer for service.
10. Do not exceed 450lbs. (205 kg) on the line during operation
11. Use only retractable lifelines or shock absorber with a maximum arrest force (MAF) equal to or lower than the lowest rated component of your system.
12. Establish a regular training program for new and experienced workers.
13. Establish a detailed inspection program for your equipment and document the findings. Return the equipment to the manufacturer for rework if any problems are found.
14. Plan your work program before starting. Have the required people, equipment and procedures available to do the job.
15. Do not use the equipment around physical or environmental hazards. This list includes but is not limited to:
  - a. Corrosion that may affect the structural integrity of the life line or other components .
  - b. Chemicals which can degrade components and not be visible.
  - c. Toxic gases: Rescuers or workers can be killed in toxic environments.
  - d. Heat or elevated temperatures.
  - e. Moving machinery: Workers or auxiliary equipment can be contacted by or pulled into moving components.
  - f. Sharp edges: Workers or the rescue equipment can be injured by or damaged by sharp edges or components.
  - g. Electrical hazards: Stay away from power lines or components carrying electrical power.
  - h. Overload: Do not exceed 450 lbs. (205 kg) during operation.
  - i. Follow confined space regulations in Standards.
  - j. Noise: wear appropriate noise protection where necessary.
  - k. Environmental hazards: do not operate equipment during electrical storms.



## The Evolution is here!!

This product is not only lighter because of it's all aluminium design but stronger with it's design features. New style of mounting the winch with our extruded winch mount bracket. Reducing confusion with pin holes and all around simplicity of the unit. Collapsible feature of davit head to reduce wasted space and more convenient bag transport/storage.

We are featuring a new one piece design which features a variety of lengths eliminating the breakdown and storage of parts.

Last but not least, the introduction of our color Flourscent Green. This brings out the products visibility adding to it's safety features.

The UCL Advanced Variable Offset Mast is the newest generation of mast for **UCL Safety Systems**. This mast is so flexible not only in it's capabilities shown throughout this manual but lends itself to variations for many different features in the future. This instructional manual will show the 12" to 29" (305 mm to 737 mm) UCL Advanced Variable Offset Mast as shown here, additions and/or addendums will come with this manual as this fine product evolves.

If you are familiar with our product line, you will see an advanced style (as shown) of our wide range of offset masts we have sold in the past.

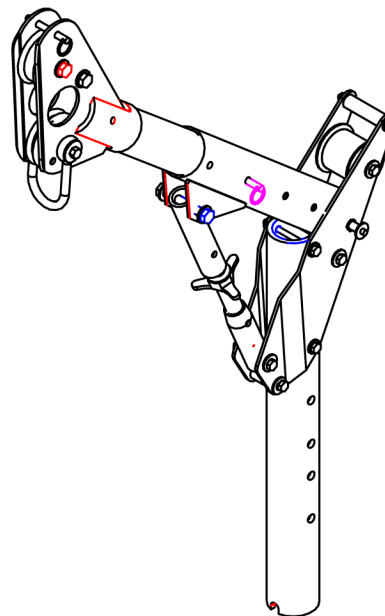

Setup for this mast now has endless variations, therefore the operator must take care in setting up the offset to allow for the work positioning to be free of obstructions on the descent & ascent.

Make note that the 5000 lb. (22.2 kN) anchor point is available to be located at the end of the adjustable gusset allowing for less entanglement of lines and greater flexibility of blocks/winches that you available to be might already own.

### Pre-use Setup

- ❶ Plug Variable Offset Mast into Lower Mast lining up the key into key way on the offset mast.
- ❷ When using this mast pay attention to what base you may be using with your mast assembly in case base rating capacities changes for different offsets'.
- ❸ If you are using the UCL Safety Systems 3 pieces expandable base (Pt # 18005) adjust the base according to the instructions on the page 5.
- ❹ Adjust mast using page 4 of this manual noting all maximum & minimum positions for the offset.
- ❺ New one piece mast design, advantages/disadvantages.

### HINTS:

- a] If you are finding overhead obstructions are in your way, adjust the screw on the gusset to its collapsed position. (no exposed threads)
- b] If you are finding obstructions with the front of your mast (e.g.. a wall near the confined space entry) adjust the screw on the gusset to its full length. (Max. exposed threads)

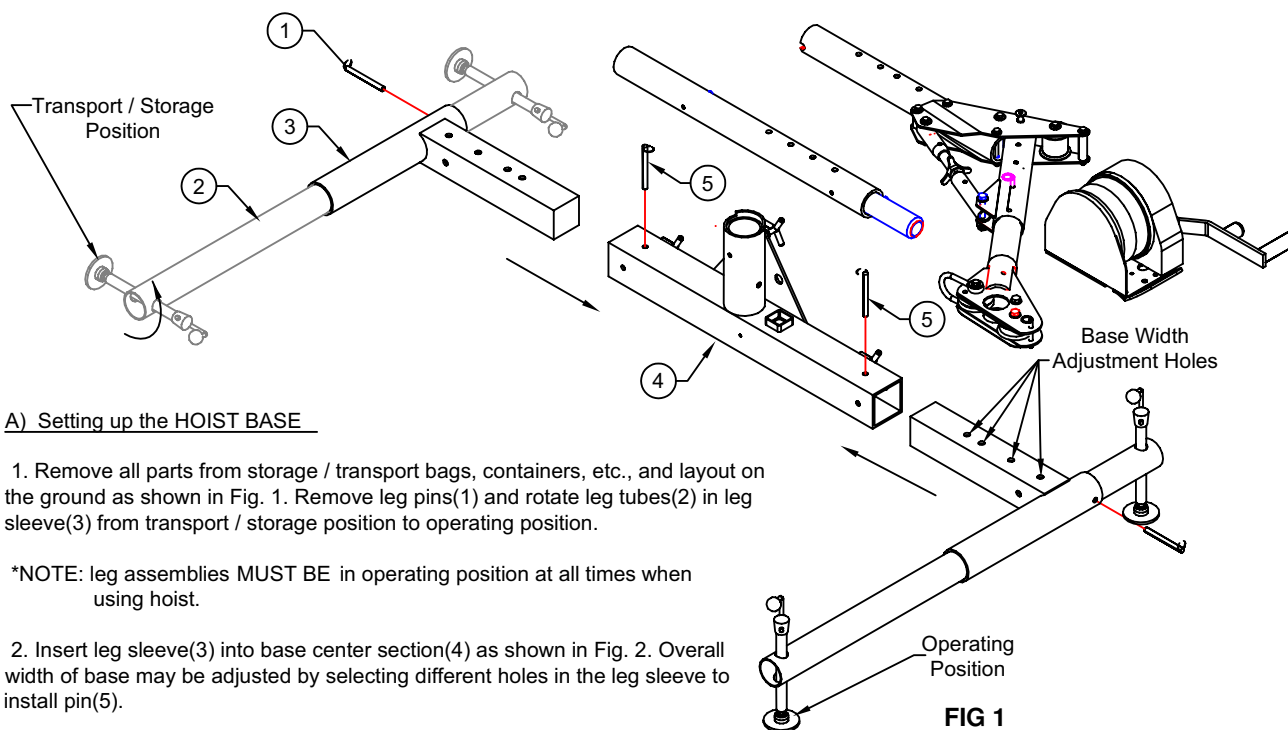

## A) Setting up the HOIST BASE

1. Remove all parts from storage / transport bags, containers, etc., and layout on the ground as shown in Fig. 1. Remove leg pins(1) and rotate leg tubes(2) in leg sleeve(3) from transport / storage position to operating position.

**\*NOTE:** leg assemblies **MUST BE** in operating position at all times when using hoist.

2. Insert leg sleeve(3) into base center section(4) as shown in Fig. 2. Overall width of base may be adjusted by selecting different holes in the leg sleeve to install pin(5).

**\*\*NOTE:** Base **MUST BE** pinned into position through hole in both center section & leg sleeve at all times when using hoist.

3. Tighten tri-screws(6) after width adjustment to remove play from base.

4. Move base into position over opening. Adjust base height & level using adjuster screws(7) & level indicator(8).

**\*\*\*NOTE:** Base **MUST BE** level at all times when using hoist.

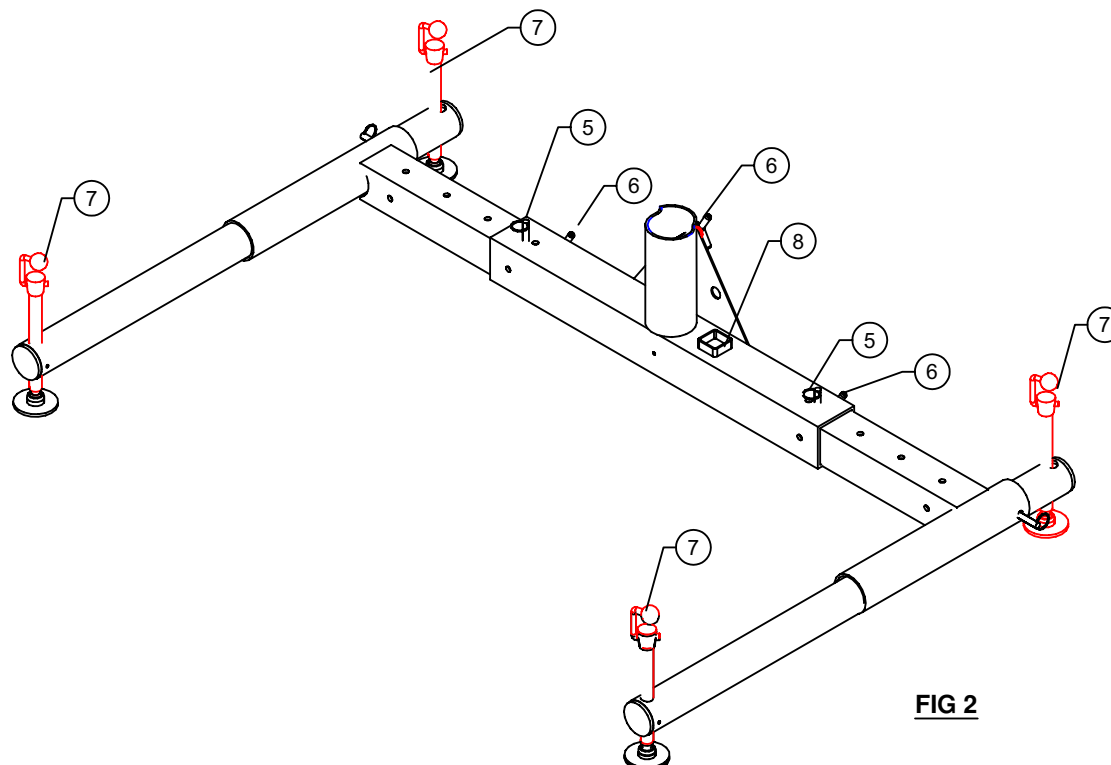

## B) Setting up the HOIST MAST ASSEMBLY

5. Insert lower mast (9) into base sleeve (10) as shown in Fig.3.

Make sure that the stop dog (11) faces the front of the sleeve, and that the lower mast rotates freely throughout its range of rotation. The lower mast may be locked in position by tightening the triscrew (13) located at the back of the sleeve. Do not over tighten as this may interfere with mast rotation in a rescue situation.

6. Install upper mast assembly (14) as shown in Fig 3. Make sure that the locating key on the lower mast completely engages the slot of upper mast (see Fig 4).

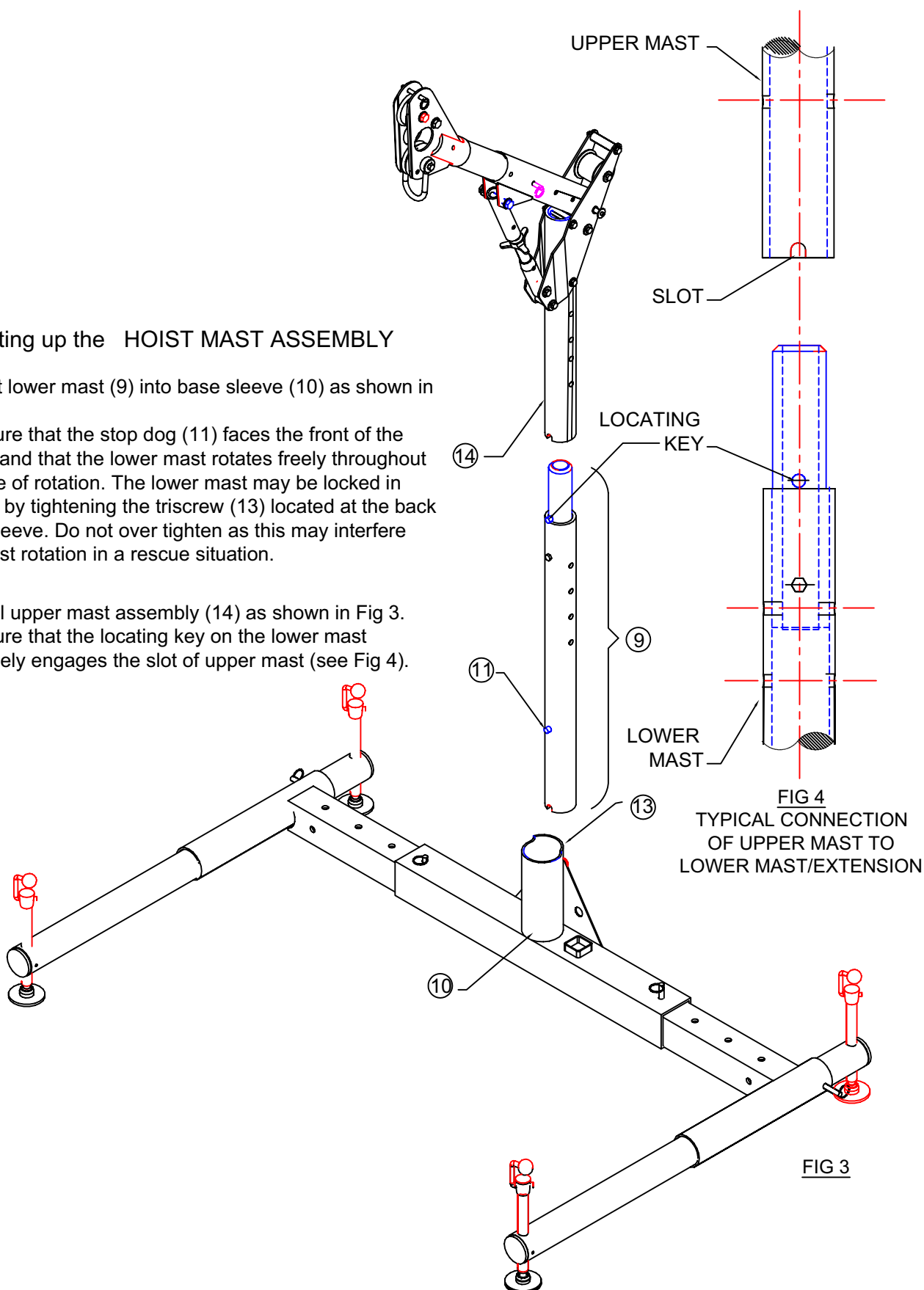

\* ALL PICTURES SHOWN WITH MINIMUM OFFSET

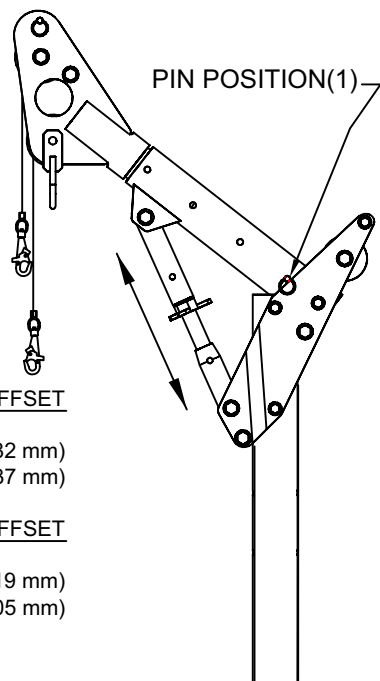

TOP PULLEY OFFSET

MAXIMUM 19.00" (482 mm)  
MINIMUM 13.25" (337 mm)

BOTTOM PULLEY OFFSET

MAXIMUM 16.50" (419 mm)  
MINIMUM 12.00" (305 mm)

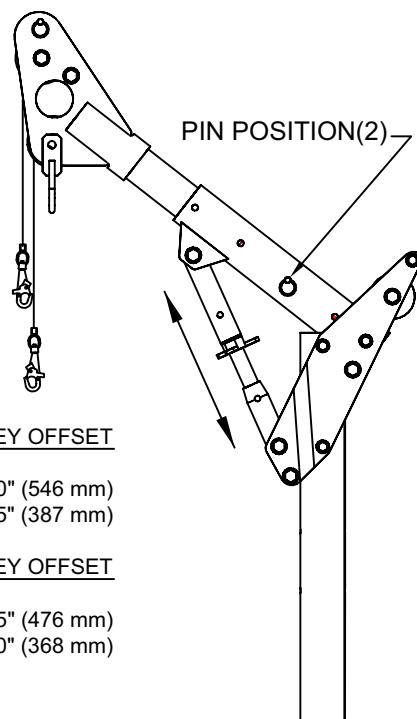

TOP PULLEY OFFSET

MAXIMUM 21.50" (546 mm)  
MINIMUM 15.25" (387 mm)

BOTTOM PULLEY OFFSET

MAXIMUM 18.75" (476 mm)  
MINIMUM 14.50" (368 mm)

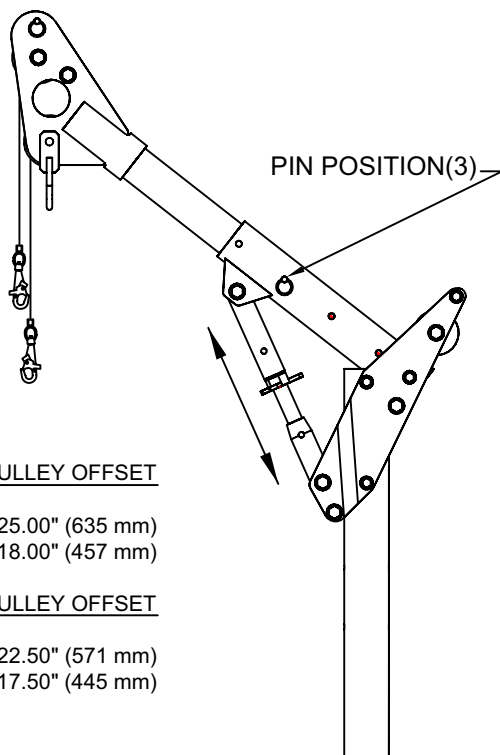

TOP PULLEY OFFSET

MAXIMUM 25.00" (635 mm)  
MINIMUM 18.00" (457 mm)

BOTTOM PULLEY OFFSET

MAXIMUM 22.50" (571 mm)  
MINIMUM 17.50" (445 mm)

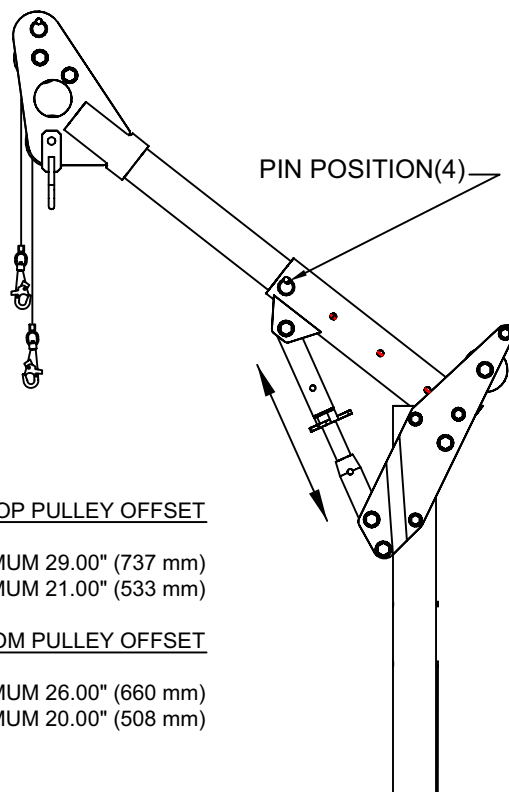

TOP PULLEY OFFSET

MAXIMUM 29.00" (737 mm)  
MINIMUM 21.00" (533 mm)

BOTTOM PULLEY OFFSET

MAXIMUM 26.00" (660 mm)  
MINIMUM 20.00" (508 mm)

\* MAXIMUM OFFSET DETERMINED WITH ADJUSTABLE GUSSET FULLY COLLAPSED (NO VISIBLE THREADS)

\* MINIMUM OFFSET DETERMINED WITH ADJUSTABLE GUSSET FULLY EXTENDED( AS SHOWN IN ALL PICTURES ABOVE)

To avoid tipping the base when swinging the mast from side to side follow these setup instructions carefully.

### B) ADJUSTING THE BASE

1. Determine the maximum operating offset of the Variable Offset Mast using page 4.
2. Adjust base according to the Positions diagram(Fig. 1) shown for the base and match the base position setting with the setting of the Variable Offset Mast. (e.g.. Pin Position 4 **MUST USE** Base Position 4)
3. Level the base by adjusting the screw legs and by centering the bubble in the level indicator.

**⚠ WARNING**

This base is to be used only with the following offsets:

6"   12"   18"   24"   30"   36"   48"

Pt #14755

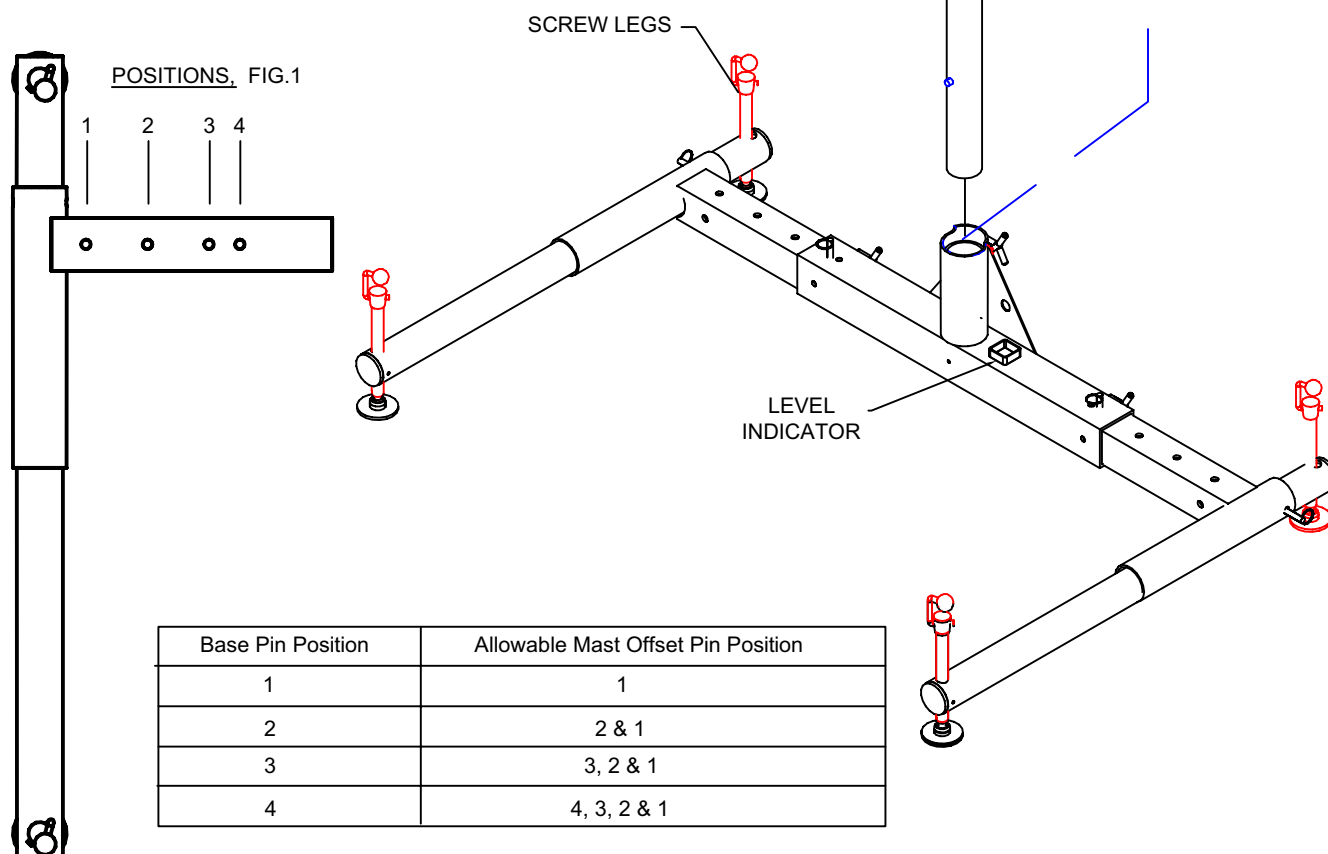

HINT: When not sure of your offset, use base position 4 on base setup.

ON UCL QUICK PLATES

**C) Installation of winch(s) [UCL Safety Systems only]**

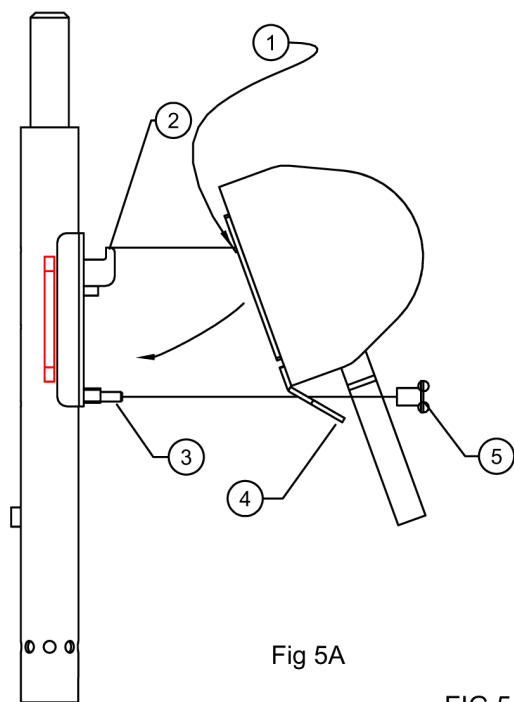

Fig 5A

1. Install winch with upper slot in back plate(1) over hook on quick mount plate(2). (see Fig 5A)

2. Swing winch in & down so that the mounting stud(3) engages hole in winch carrying handle(4).

3. Thread clamp knob(5) onto stud(3) and tighten securely by hand. (see Fig 5B)

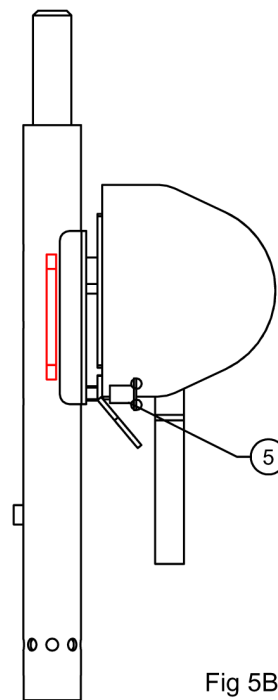

Fig 5B

FIG.5 Typical installation on UCL quick plate PT # 10757 or PT # 10222

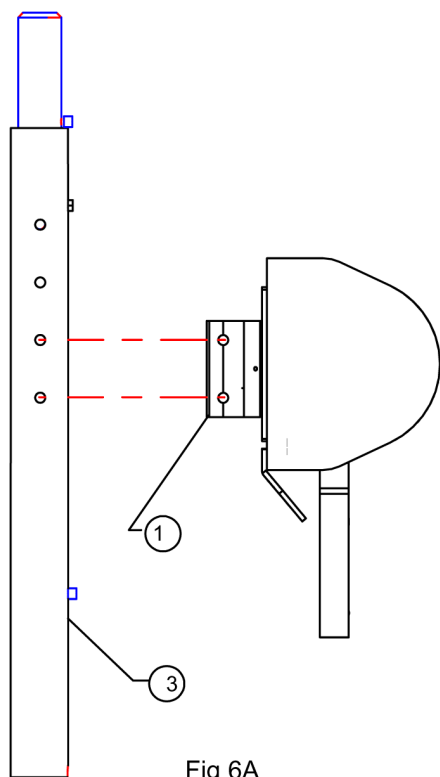

Fig 6A

1. Install winch/bracket assembly by aligning two holes & pinning bracket to mast vertical.

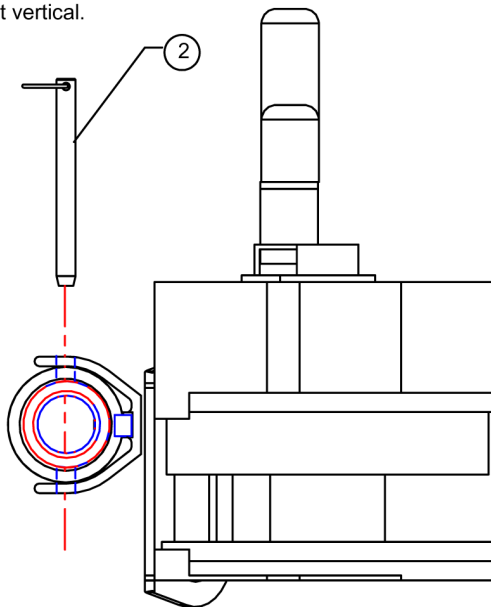
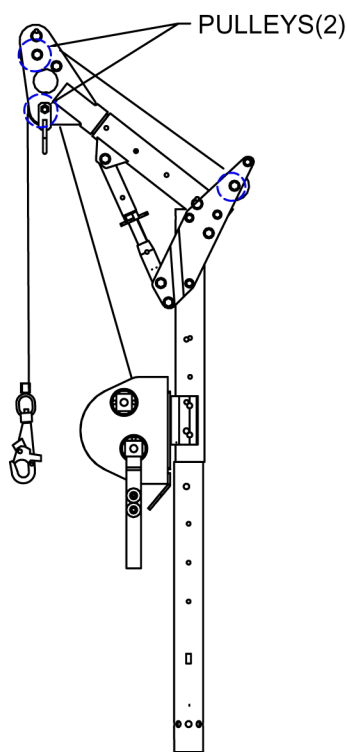

Fig 6B

**Fig 6 Typical installation of mounting bracket PT # 16824**

**FIG. 6) Typical installation of UCL mounting bracket to 2 pcs Mast**



**6a) FRONT MOUNT**

1. Pay out 5'-10' of cable from winch, maintaining at least 10 lb. of tension on cable at all times.
2. Route cable over pulleys and/or rollers as applicable. (see Fig 6A-6B)

*\*Note: in applications involving front & back mounted winches or SRL's, life lines **MUST BE** installed over each pulley at the top of the mast.*

**WARNING!**

Winches or blocks are not to be mounted to the front side of lower masts or mast extensions.

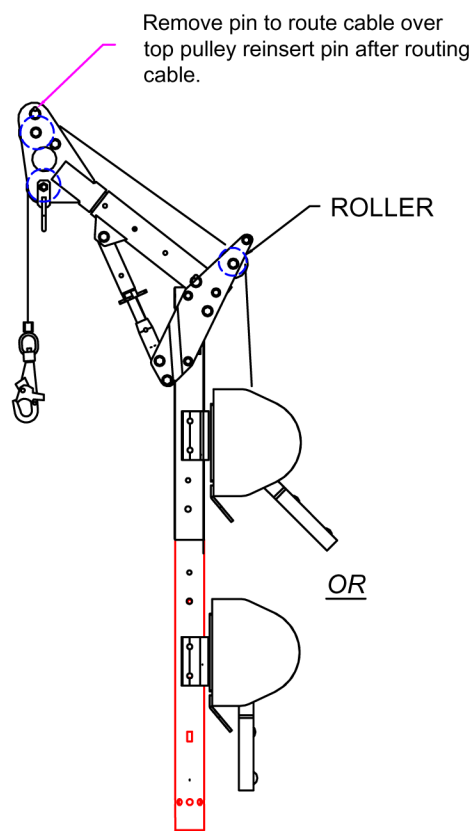

**6b) REAR MOUNT**

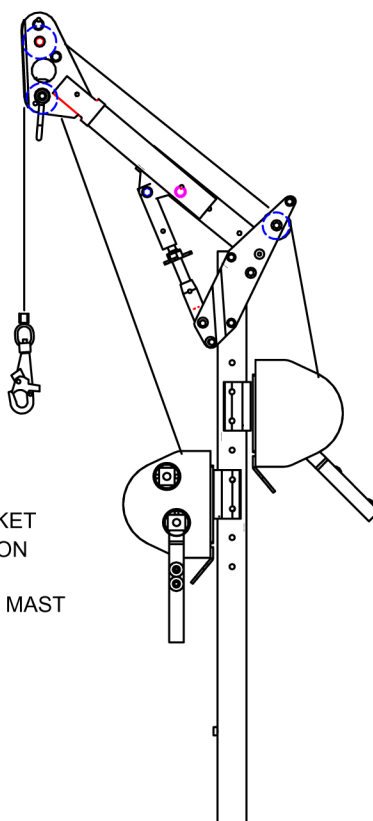

**FIG. 7) Typical installation of UCL mounting bracket to 1 pc Mast**

**INFORMATION**

WINCH MOUNT BRACKET MAY BE POSITIONED ON THE FRONT OF 1 PIECE VERTICAL MAST

**D) INSTALLATION OF WINCHES, SELF-RETRACTING LIFELINES ( SRL's ), WORK POSITIONING AND FALL-ARREST  
DEVICES NOT MANUFACTURED BY UNIQUE CONCEPTS LTD.**

Your Variable Offset Mast can be used as a support structure for various types of safety devices.

Some of these can mount directly to the u-bracket at the top of the mast, while others may require an adapter bracket available from your UCL Safety Systems dealer. Any accessories being used for the hoist **MUST BE** installed, inspected, maintained and operated according to the manufactures instructions. All installations **MUST BE** approved to local standards by a qualified engineer.

**E) INSPECTION OF EQUIPMENT PRIOR TO USE.**

- Check all structural parts for damage: dents, cracked welds bend or crushed tubes. Minor cosmetic damage will not affect the structural integrity of the hoist, but any seriously damaged parts **MUST BE** repaired or replaced before using the hoist.
- Check all hardware ( pins, tri-screws, adjuster screws, nuts, bolts, pulleys, rollers and winch brackets) for damaged threads, bend, damaged or missing fasteners, loose fasteners. Check all pulleys and rollers for chips, grooves and excessive wear. Ensure that all pulleys and rollers turn freely.
- Inspect all equipment for missing, damaged or otherwise illegible warning stickers. Any damaged, missing or otherwise illegible stickers **MUST BE** replaced before using hoist.
- If you are using UCL Safety Systems Winches with your hoist, inspect the winch and cable as outlined in the "maintenance and inspection" section of the Digital Series Winch operators manual.
- Any additional winches, self-retracting lifelines (SRL's), work positioning or fall-arrest equipment being used with your UCL Safety Systems Hoist **MUST BE** installed, inspected, maintained and operated according to the manufactures instruction.
- Report any problems with the equipment to your supervisor and **DO NOT USE** the equipment until it has been repaired or replaced.

**F) INSPECTION / MAINTENANCE SCHEDULE**

**DAILY ( BEFORE EACH USE ) :** (SEE ABOVE) INSPECTION OF EQUIPMENT PRIOR TO USE

**WEEKLY:** Perform a complete visual inspection of equipment as outlined in " Inspection of Equipment Prior to Use". Clean equipment as required, to thoroughly inspect all welds, labels, pins, fasteners, pulleys, rollers, brackets and parts. Record all findings on a copy of the "hoist inspection log". If any problems are found with the equipment **DO NOT USE** until it has been repaired.

**ANNUALLY:** Clean unit throuroghly, using a damp cloth and a mild soap solution. Perform a complete visual inspection as described in section(F) " Inspection of Equipment Prior to Use" Record all findings on a copy of the "hoist inspection log". If any problems are found with the equipment **DO NOT USE** until it has been repaired.





MODEL #

SERIAL #

MFG. DATE

HOIST INSPECTION LOG: (SAMPLE FORM - Copy to start inspection log book)

TYPE OF INSPECTION: ☐ DAILY ☐ WEEKLY ☐ ANNUALLY

Date of Inspection (d / m / y)

Inspected By:

M  
A  
S  
T

LABELS

DAMAGE

CORROSION

FASTENERS

PULLEYS

ROLLER

U-BRACKET

WINCH BRACKET

SRL's BRACKET

WELDS

OTHER

COMMENTS:

\* FAILURE TO COMPLY AND FOLLOW REGULAR INSPECTION PROCEDURES STATED IN THIS MANUAL WILL RESULT IN VOIDING OF THE MANUFACTURES WARRANTY AND / OR POSSIBLE SERIOUS INJURY OR DEATH TO THE OPERATOR / ENTRANT.





## **6 SPECIFICATION SHEETS**

### **6.1 General**

These specification sheets contain information necessary for the proper installation and use of the equipment mentioned in this manual. These specifications contain application specific ratings and mounting requirements determined through design and testing.

Please read and follow these specification sheets carefully to ensure the proper installation of each item.



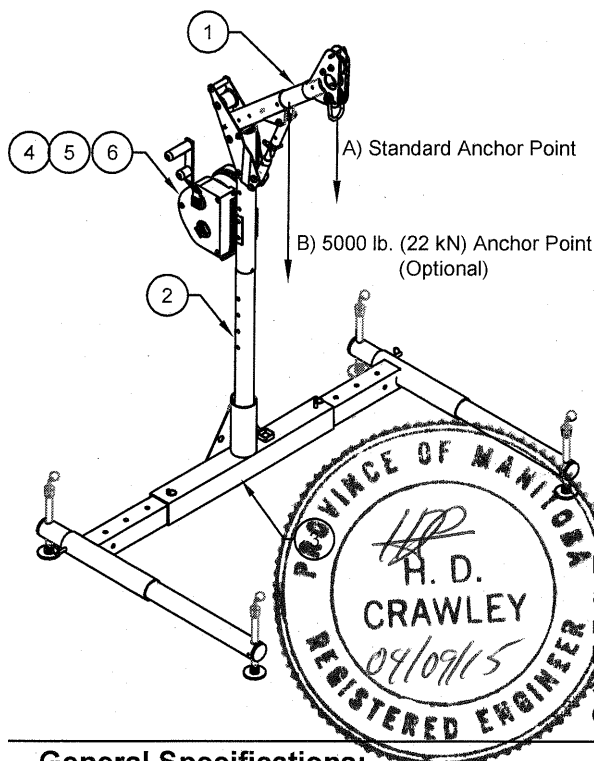

**Model 8518000 includes the following**

Item	Part #	Qty.	Description
1	8518001	1	12" to 29" Variable Offset Mast
2	8518002	1	UCL Advanced 33" Lower Mast
3	8518005	1	UCL Advanced Base Assembly
shown but not included			
4	8516824	1	Quick Mount Bracket
5		1	Digital Winch
6		1	UCL Cable Assembly

**DESCRIPTION**

The Model 18000 Advanced Breakdown Hoist System is designed for manhole and confined space entry / retrieval applications. Modular design allows use of components in various configurations and applications. Multiple winches and/or lifeline systems may be mounted as required. Tool-less design breaks the system into lightweight, manageable components for storage, transport and setup. The model 18000 features UCL's new Advanced Variable Offset Mast to further increase adjustability and setup options.

**General Specifications:**

Rated Capacity (Working Load Limit) 450 lb.(204 Kg.) working load @ minimum 4:1 safety factor

**PROOF LOAD RATINGS**

Anchor points

A) Standard

Pin Position 1 & 2 5000 lb. (22 kN)  
Pin Position 3 3600 lb. (16 kN)  
Pin Position 4 3000 lb. (13 kN)

B) Optional

5000 lb (22 kN)

Winch / S.R.L. Mount Positions

A) Rear Mount

Pin Position 1 & 2 5000 lb. (22 kN)  
Pin Position 3 3600 lb. (16 kN)  
Pin Position 4 3000 lb. (13 kN)

B) Front Mount

Pin Position 1 & 2 2500 lb. (11 kN)  
Pin Position 3 & 4 1800 lb. (8 kN)

Proof Tests UCT-408, UCT-409, UCT-410  
Weight 100.5 lb.(45.7 Kg.)

**Materials & Construction:**

General Construction Welded Aluminum  
Weld Certification CWB-47.2  
Hardware Gr.5, CS 500  
Material  
Structure 6061-T6, 5052-H32, 7075-T6  
Aluminum, Mild Steel, Black Acetal,  
Block Anchor 304 Stainless Steel  
Finish Florescent Green powder coat

**Application Restrictions:**

1. UCL Advanced Lower masts and mast extensions are designed to function as the same component. A maximum of two components may be combined, but must not exceed 90" (2286 mm) in height. Multiples of three or more must be reviewed and approved by Unique Concepts Ltd on an application specific basis.
2. Winches and Blocks **MAY NOT** be mounted in the front position on mast extensions. Rear mounting is allowed at any point.
3. All winch and block mounting parts and hardware **MUST BE** supplied or approved by Unique Concepts Ltd.
4. Retractable devices or shock absorbers **MUST BE** installed and used in accordance with the manufacturer's instructions.
5. Masts **MUST BE** used with bases or sleeves approved for use with the applicable mast offset.
6. Upper masts **MUST BE** used with an appropriately sized lower mast.
7. Where required by regulation, each installation **MUST BE** approved to all applicable standards by a qualified engineer.
8. All equipment **MUST BE** set up and operated under the supervision of a competent person according to the manufacturer's instructions.

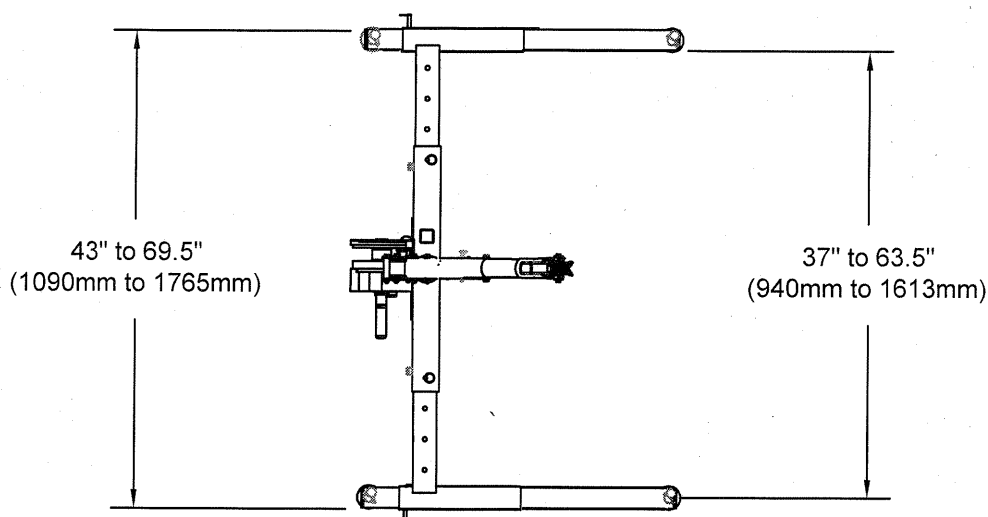

Please refer to Model 18001 Advanced 12" to 29" Variable Offset Mast specification sheets and / or operators manual for complete technical and instructional material.

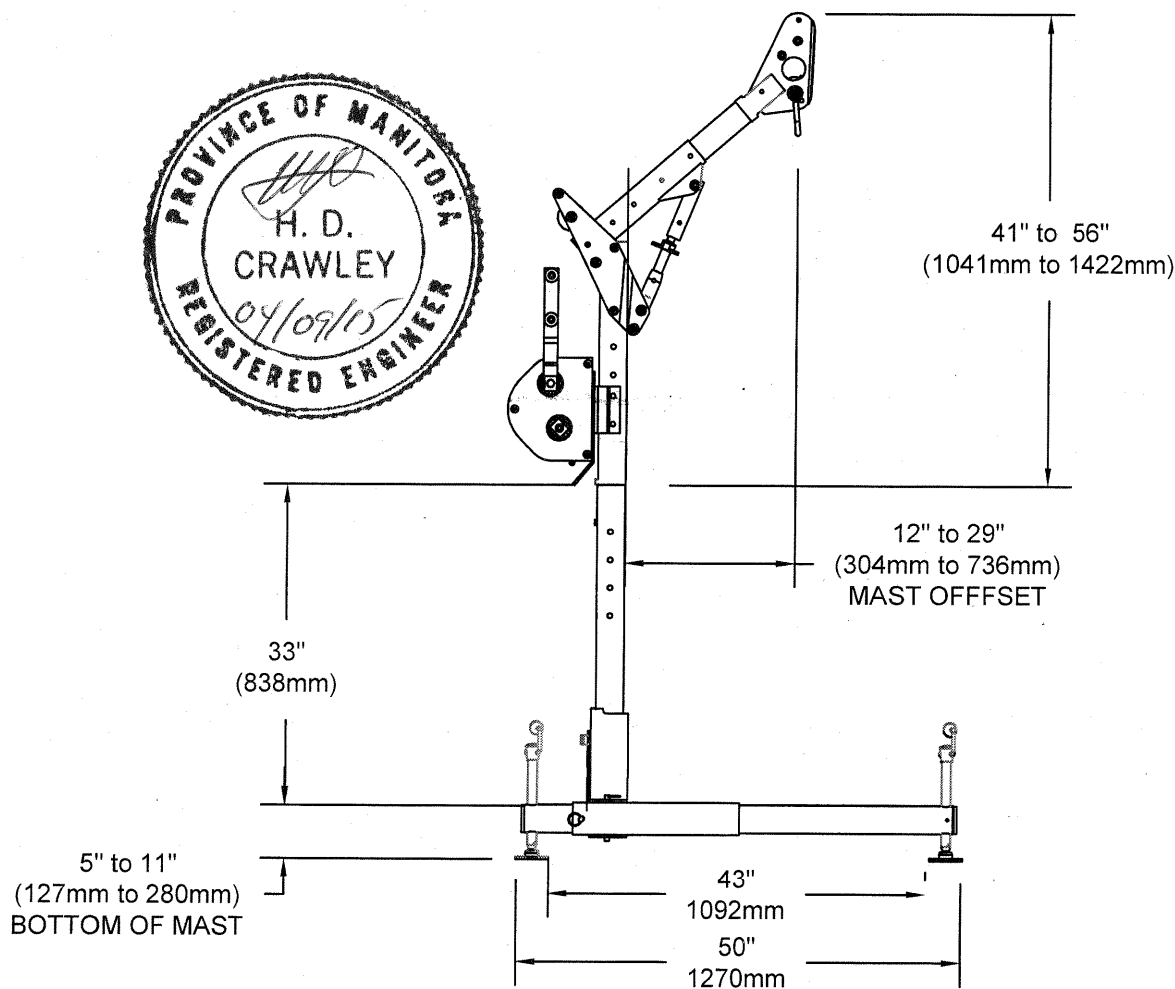

**Model 8518501 includes the following**

Item	Part #	Qty.	Description
1	8518005	1	3 Pc. Expandable Base (37.5 to 64 inches)
2	8518382	1	UCL Advanced 1 Pc. 66" to 76" Variable Offset Mast
SHOWN BUT NOT INCLUDED			
3	8515651	1	Gusset Mounted U-Bracket (5000lbs)

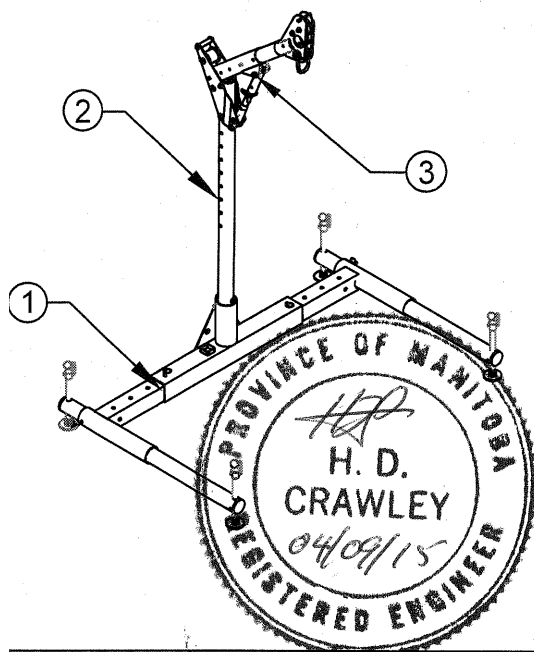

**DESCRIPTION:**

The Model 18501 Advanced Breakdown Hoist System is designed for manhole and confined space entry / retrieval applications. Modular design allows use of components in various configurations and applications. Multiple winches and/or lifeline systems may be mounted as required. Tool-less design breaks the system into lightweight, manageable components for storage, transport and setup. The model 18501 features UCL's new Advanced 1 Piece Variable Offset Mast to further increase adjustability and setup options.

**General Specifications:**

Rated Capacity (Working Load Limit) 450 lb.(204 Kg.) working load @ minimum 4:1 safety factor

**PROOF LOAD RATINGS**

Anchor points

A) Standard

Pin Position 1 & 2 5000 lb. (22 kN)  
Pin Position 3 3600 lb. (16 kN)  
Pin Position 4 3000 lb. (13 kN)

B) Optional

5000 lb (22 kN)

Winch / S.R.L. Mount Positions

A) Rear Mount

Pin Position 1 & 2 5000 lb. (22 kN)  
Pin Position 3 3600 lb. (16 kN)  
Pin Position 4 3000 lb. (13 kN)

B) Front Mount

Pin Position 1 & 2 2500 lb. (11 kN)  
Pin Position 3 & 4 1800 lb. (8 kN)

Weight

Mast Assembly 29 lb. (13.2 Kg.)  
Base Center 21 lb. (9.5 Kg.)  
Base Legs (x2) 20 lb. (9.1 Kg.)

**Materials & Construction:**

General Construction Welded Aluminum  
Weld Certification CWB-47.1, 47.2  
Hardware Gr.5 Zinc Plated  
Material  
Structure 6061-T6, 5052-H32, 7075-T6  
Aluminum  
Block Anchor 304 Stainless Steel  
Finish Fluorescent Green powder coat  
Type II Zinc, SC-2 ASTM B633

**Application Restrictions:**

- One mast extension up to a maximum of 57" (1448 mm) may be used. Use of the mast extensions may need to be reviewed and approved by Unique Concepts Ltd. on an application specific basis. Multiple mast extensions **MAY NOT** be used.
- Winches and Blocks **MAY NOT** be mounted in the front position on lower masts or mast extensions. Rear mounting is allowed at any point.
- All winch and block mounting parts and hardware **MUST BE** supplied or approved by Unique Concepts Ltd.
- Retractable devices or shock absorbers **MUST BE** installed and used in accordance with the manufacturer's instructions.
- Masts **MUST BE** used with bases or sleeves approved for use with the applicable mast offset.
- Upper masts **MUST BE** used with an appropriately sized lower mast.
- Where required by regulation, each installation **MUST BE** approved to all applicable standards by a qualified engineer.
- All equipment **MUST BE** set up and operated under the supervision of a competent person according to the manufacturer's instructions.

**\*\*ALL PICTURES SHOWN WITH MINIMUM OFFSET**

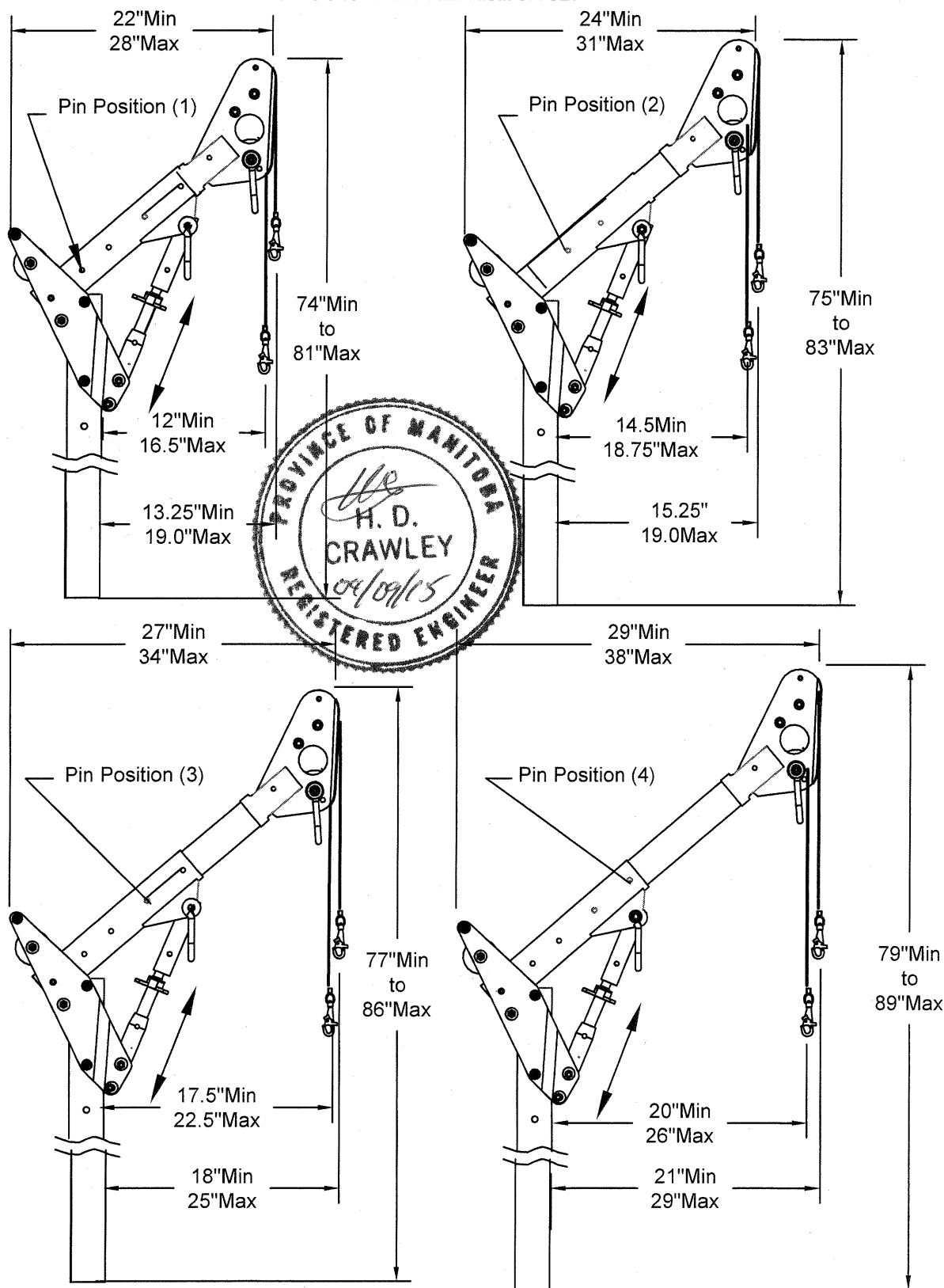

\*MAXIMUM OFFSET DETERMINED WITH ADJUSTABLE GUSSET FULLY COLLAPSED (NO VISIBLE THREADS)

\*MAXIMUM OFFSET DETERMINED WITH ADJUSTABLE GUSSET FULLY EXTENDED (AS SHOWN IN ALL PICTURES ABOVE)



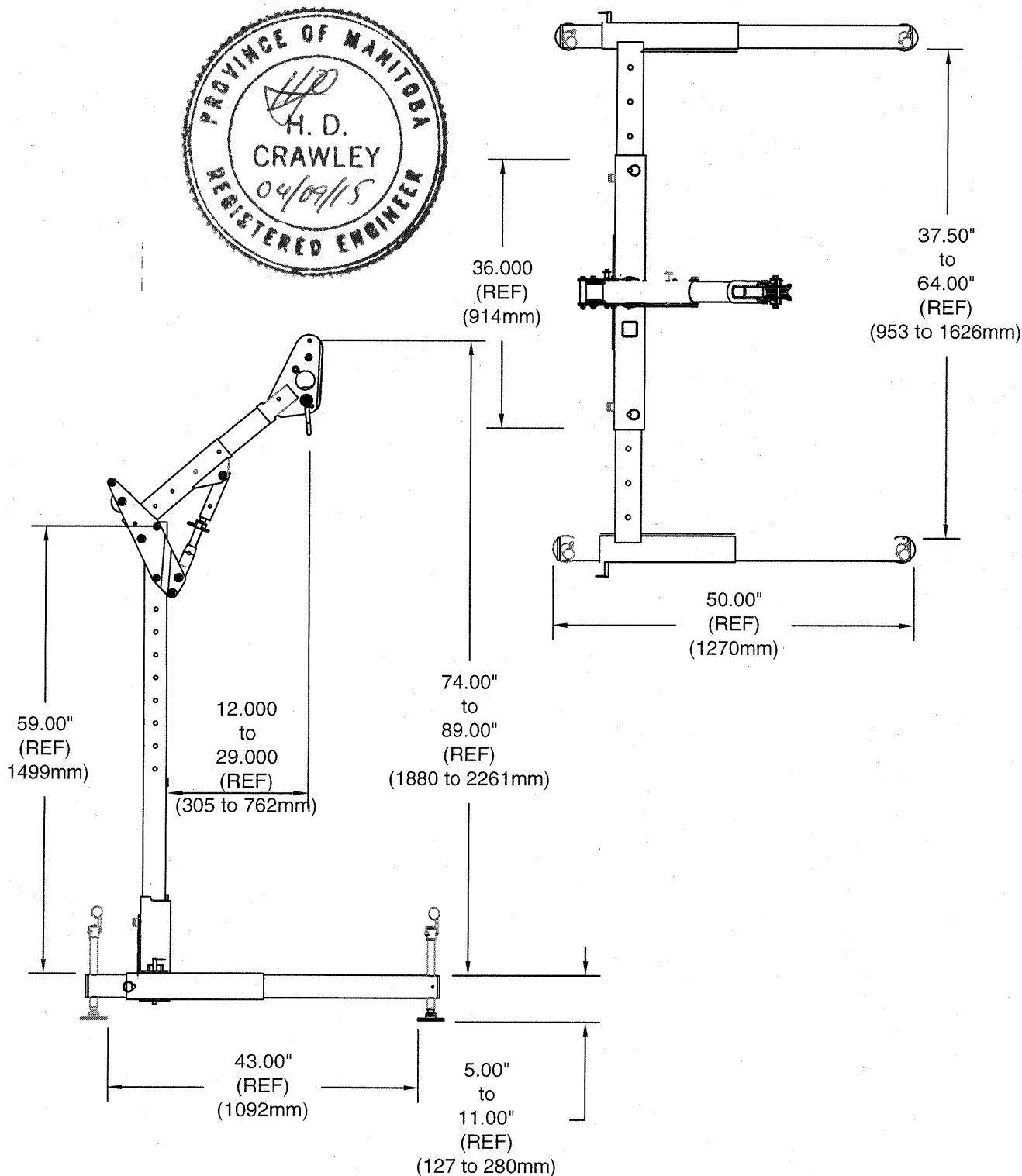
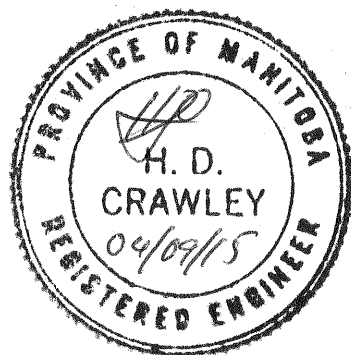



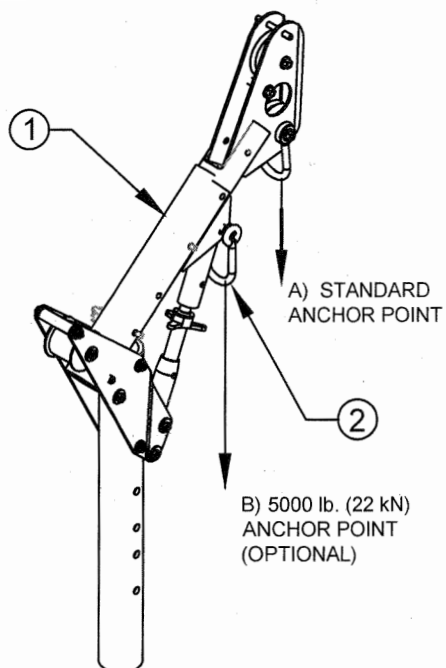

**Model 8518001 includes the following**

Item	Part #	Qty.	Description
1	8518001	1	UCL Advanced 12" to 29" Variable Offset Mast
SHOWN BUT NOT INCLUDED			
2	8515651	1	Head Mounted U-Bracket

**DESCRIPTION:**

The UCL model 18001 Advanced Variable Offset Mast is designed for use where multiple offset masts are required, and is compatible with UCL Safety Systems Advanced lower masts, mast extensions and bases. The Variable Offset Mast may be equipped with front mounted and/or back mounted winches & SRL's and features a 5000 lb.(2272 Kg) capacity anchor point for fall-arrest anchorage. For applications with overhead clearance restrictions, the adjustable height of the Variable Offset Mast can eliminate the need for custom length lower masts and mast extensions. Powder-coated aluminum construction for lightweight durability. The addition of a quick release pin allows for easy collapsability and transport.

**General Specifications:**

Rated Capacity  
(Working Load Limit) 450 lb.(204 Kg.) working load @  
minimum 4:1 safety factor

**PROOF LOAD RATINGS**

Anchor points

A) Standard

- Pin Position 1 & 2
- Pin Position 3
- Pin Position 4

5000 lb. (22 kN)  
3600 lb. (16 kN)  
3000 lb. (13 kN)

B) Optional

5000 lb (22 kN)

Winch / S.R.L. Mount Positions

A) Rear Mount

- Pin Position 1 & 2
- Pin Position 3
- Pin Position 4

5000 lb. (22 kN)  
3600 lb. (16 kN)  
3000 lb. (13 kN)

B) Front Mount

- Pin Position 1 & 2
- Pin Position 3 & 4

2500 lb. (11 kN)  
1800 lb. (8 kN)

**Proof Tests**

UCT-395, UCT-405, UCT-406,  
UCT-407, UCT-408, UCT-409,  
UCT-410

**Weight**

22.6 lb.(10.3 Kg.)

**Materials & Construction:**

General Construction  
Weld Certification  
Hardware  
Material  
Structure

Welded Aluminum  
CWB-47.2  
Gr.5, CS500 Zinc Plated

Block Anchor  
Finish

6061-T6, 5052-H32, 7075-T6  
Aluminum  
304 Stainless Steel  
Fluorescent Green powder coat

**Application Restrictions:**

1. UCL Advanced Lower masts and mast extensions are designed to function as the same component. A maximum of two components may be combined, but must not exceed 90" (2286 mm) in height. Multiples of three or more must be reviewed and approved by Unique Concepts Ltd on an application specific basis.
2. Winches and Blocks **MAY NOT** be mounted in the front position on lower masts or mast extensions. Rear mounting is allowed at any point.
3. All winch and block mounting parts and hardware **MUST BE** supplied or approved by Unique Concepts Ltd.
4. Retractable devices or shock absorbers **MUST BE** installed and used in accordance with the manufacturer's instructions.
5. Masts **MUST BE** used with bases or sleeves approved for use with the applicable mast offset.
6. Upper masts **MUST BE** used with an appropriately sized lower mast.
7. Where required by regulation, each installation **MUST BE** approved to all applicable standards by a qualified engineer.
8. All equipment **MUST BE** set up and operated under the supervision of a competent person according to the manufacturer's instructions.

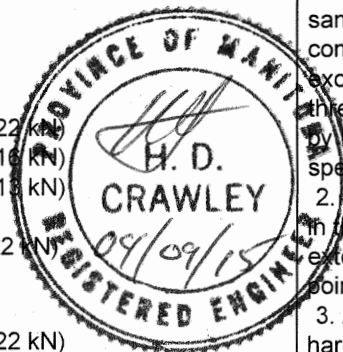

**\*\*ALL PICTURES SHOWN WITH MINIMUM OFFSET**

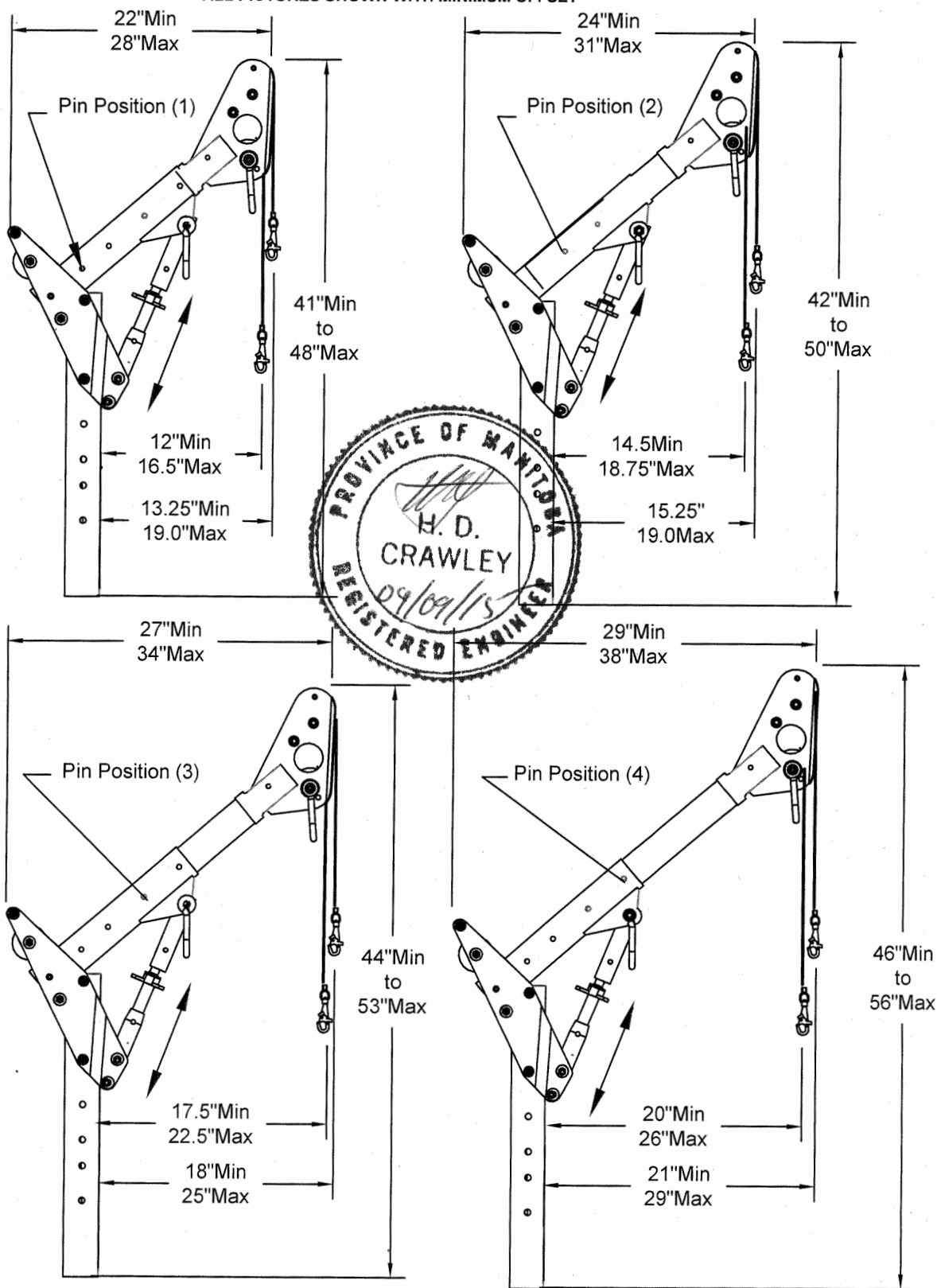

\*MAXIMUM OFFSET DETERMINED WITH ADJUSTABLE GUSSET FULLY COLLAPSED (NO VISIBLE THREADS)

\*MAXIMUM OFFSET DETERMINED WITH ADJUSTABLE GUSSET FULLY EXTENDED (AS SHOWN IN ALL PICTURES ABOVE)

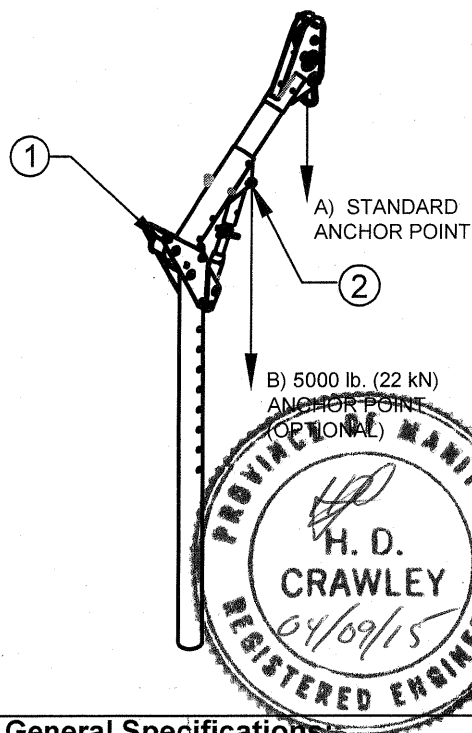

**Model 8518382 includes the following**

Item	Part #	Qty.	Description
1	8518382	1	UCL Advanced 1 Piece 12" to 29" Variable Offset Mast
SHOWN BUT NOT INCLUDED			
2	8515651	1	Gusset Mounted U-Bracket

**DESCRIPTION:**

The UCL model 18382 Advanced Variable Offset Mast is designed for use where multiple offset masts are required, and is compatible with UCL Safety Systems Advanced lower masts, mast extensions and bases. The Variable Offset Mast may be equipped with front mounted and/or back mounted winches & SRL's and features a 5000 lb. (2272 kg) capacity anchor point for fall-arrest anchorage. For applications with overhead clearance restrictions, the adjustable height of the Variable Offset Mast can eliminate the need for custom length masts and mast extensions. Powder-coated aluminum construction for lightweight durability. The addition of a quick release pin allows for easy collapsibility and transport.

**General Specifications:**

Rated Capacity (Working Load Limit) 450 lb. (204 Kg.) working load @ minimum 4:1 safety factor

**PROOF LOAD RATINGS**

Anchor points

A) Standard

Pin Position 1 & 2 5000 lb. (22 kN)  
Pin Position 3 3600 lb. (16 kN)  
Pin Position 4 3000 lb. (13 kN)

B) Optional

5000 lb (22 kN)

Winch / S.R.L. Mount Positions

A) Rear Mount

Pin Position 1 & 2 5000 lb. (22 kN)  
Pin Position 3 3600 lb. (16 kN)  
Pin Position 4 3000 lb. (13 kN)

B) Front Mount

Pin Position 1 & 2 2500 lb. (11 kN)  
Pin Position 3 & 4 1800 lb. (8 kN)

Weight 29 lb. (13.2 Kg.)

**Materials & Construction:**

General Construction Welded Aluminum  
Weld Certification CWB-47.2  
Hardware Gr.5, CS500 Zinc Plated  
Material  
Structure 6061-T6, 5052-H32, 7075-T6  
Aluminum  
Block Anchor 304 Stainless Steel  
Finish Fluorescent Green powder coat

**Application Restrictions:**

1. One mast extension up to a maximum of 57" (1448 mm) may be used. Use of the mast extensions may need to be reviewed and approved by Unique Concepts Ltd. on an application specific basis. Multiple mast extensions MAY NOT be used.
2. Winches and Blocks **MAY NOT** be mounted in the front position on lower masts or mast extensions. Rear mounting is allowed at any point.
3. All winch and block mounting parts and hardware **MUST BE** supplied or approved by Unique Concepts Ltd.
4. Retractable devices or shock absorbers **MUST BE** installed and used in accordance with manufacturer's instructions.
5. Masts **MUST BE** used with bases or sleeves approved for use with the applicable mast offset.
6. Upper masts **MUST BE** used with an appropriately sized lower mast.
7. Where required by regulation, each installation **MUST BE** approved to all applicable standards by a qualified engineer.
8. All equipment **MUST BE** set up and operated under the supervision of a competent person according to the manufacturer's instructions.



**\*\*ALL PICTURES SHOWN WITH MINIMUM OFFSET**

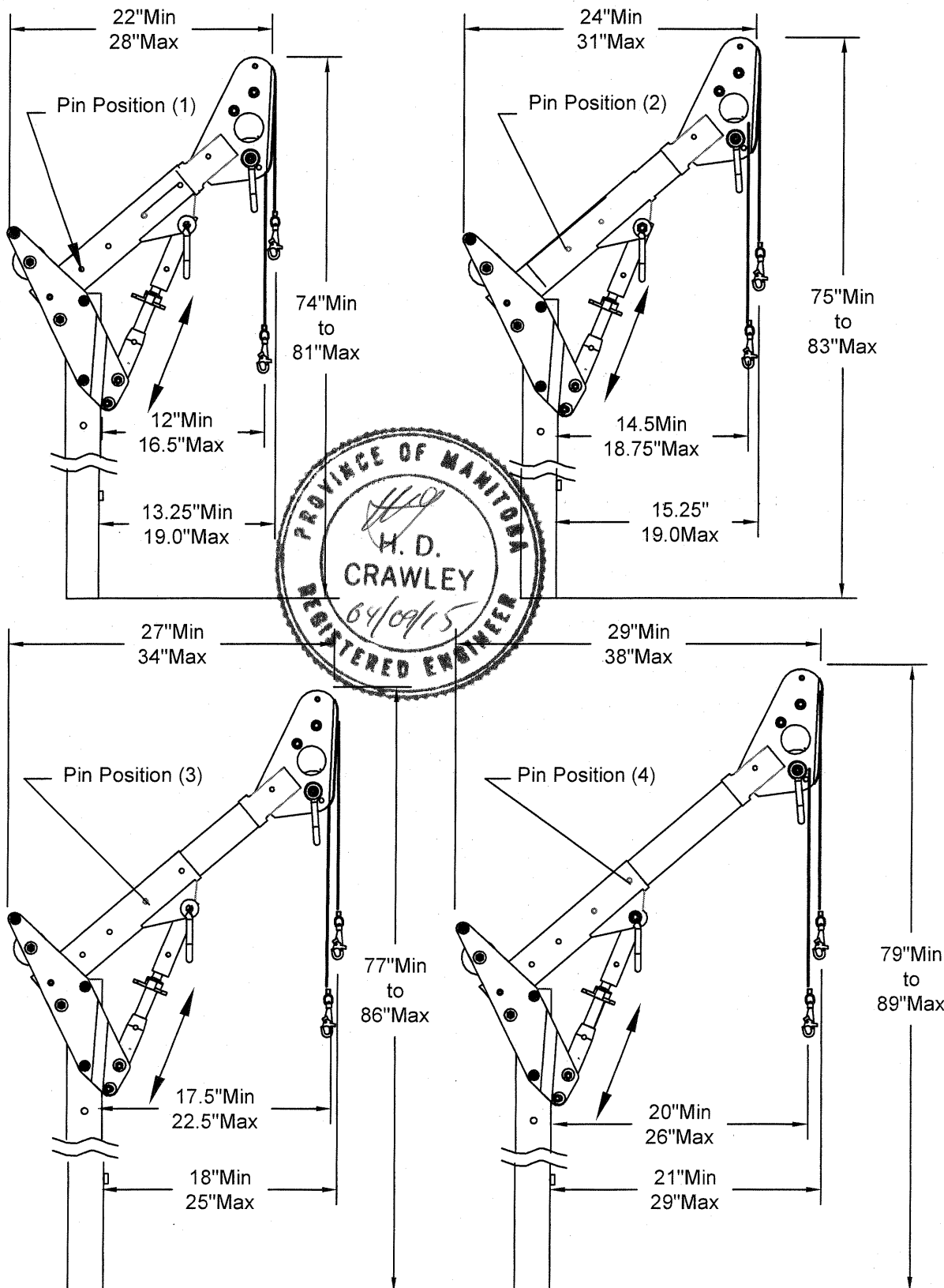

\*MAXIMUM OFFSET DETERMINED WITH ADJUSTABLE GUSSET FULLY COLLAPSED (NO VISIBLE THREADS)

\*MAXIMUM OFFSET DETERMINED WITH ADJUSTABLE GUSSET FULLY EXTENDED (AS SHOWN IN ALL PICTURES ABOVE)

## **7 REPLACEMENT PARTS**

### **7.1 General**

These drawings are to provide you with an easy reference to order replacement labels and parts when required. Please follow each of the drawings to locate the part numbers required to order from UCL by either referencing the bill of materials on the right hand side of the drawing and then locating the balloon pointing out the replacement part for verification or visa versa.





NOTE: FOR STICKER LOCATIONS  
SEE PAGE 2

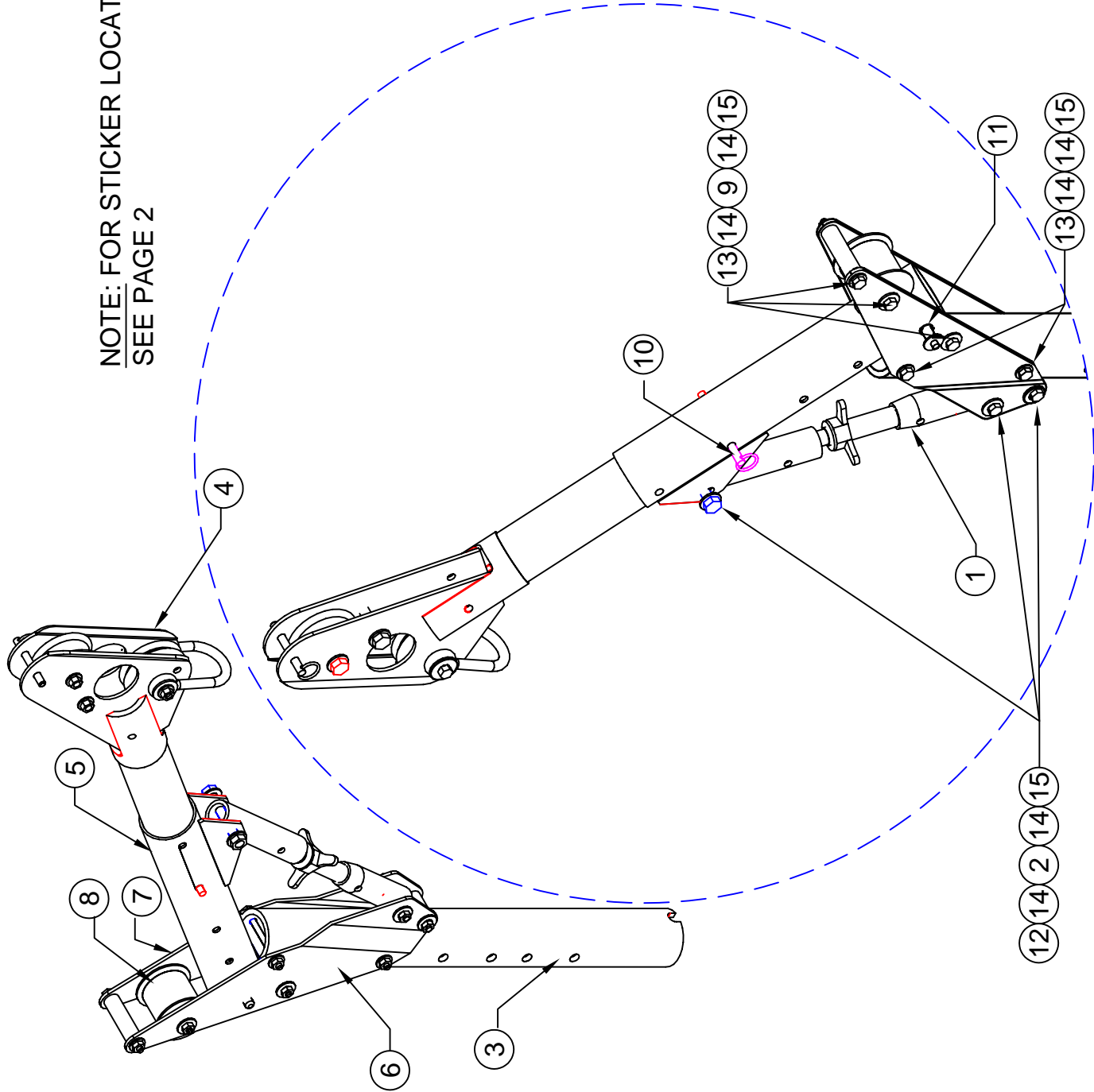

15	10035	8	Ø3/8" UNC ACORN NUT, PLTD.
14	13343	16	Ø5/16 USS FLAT WASHER
13	10039	5	Ø3/8 UNC x 4.0, HHCS, GR.5, PLTD.
12	12493	3	Ø3/8 UNC x 2.50 HHCS, GR.5, PLTD
11	19494	1	Ø1/2 x 3.5 PLP c/w LANYARD
10	15114	1	Ø3/8 x 3 Q.R. PIN c/w LANYARD
9	15157	3	SIDE PLATE SPACER
8	15111	1	BACK MOUNT ROLLER (MSP)
7	15153	1	MAST SIDE PLATE (L.H.S.)
6	15152	1	MAST SIDE PLATE (R.H.S.)
5	17875	1	WA, HEAD RECEIVER TUBE
4	19285	1	MAST HEAD ASSEMBLY
3	17873	1	UPPER MAST UPRIGHT TUBE
2	15253	3	ADJUSTABLE GUSSET SPACER
1	15225	1	MA, ADJUSTABLE GUSSET
ITEM #	PART #	QTY	DESCRIPTION

Unique Concepts Ltd.

Manufacturers of Industry Standard Confined Space Entry / Retrieval Systems

Drawn by: OD

Scale: 1:8

Dimensions: INCHES

Date: 08APR03

Checked by:

Date:

Approved by:

Date:

Project: UCL ADVANCED 12-29' OFFSET MAST

DWG SIZE: A

REV # 1

SHEET: 1

Description: COMPLETE ASSEMBLY

Dwg. # 1800

1	26APR04	CORRECTED PARTS LIST	JS
REV #	DATE	DESCRIPTION OF REVISION	BY



## WARNING

Refer to the Warning Label containing information on the working load and maximum M.A.F. rating of this mast. This mast has offset(s) of:

12" 18" 24" 30"

Pl #14756

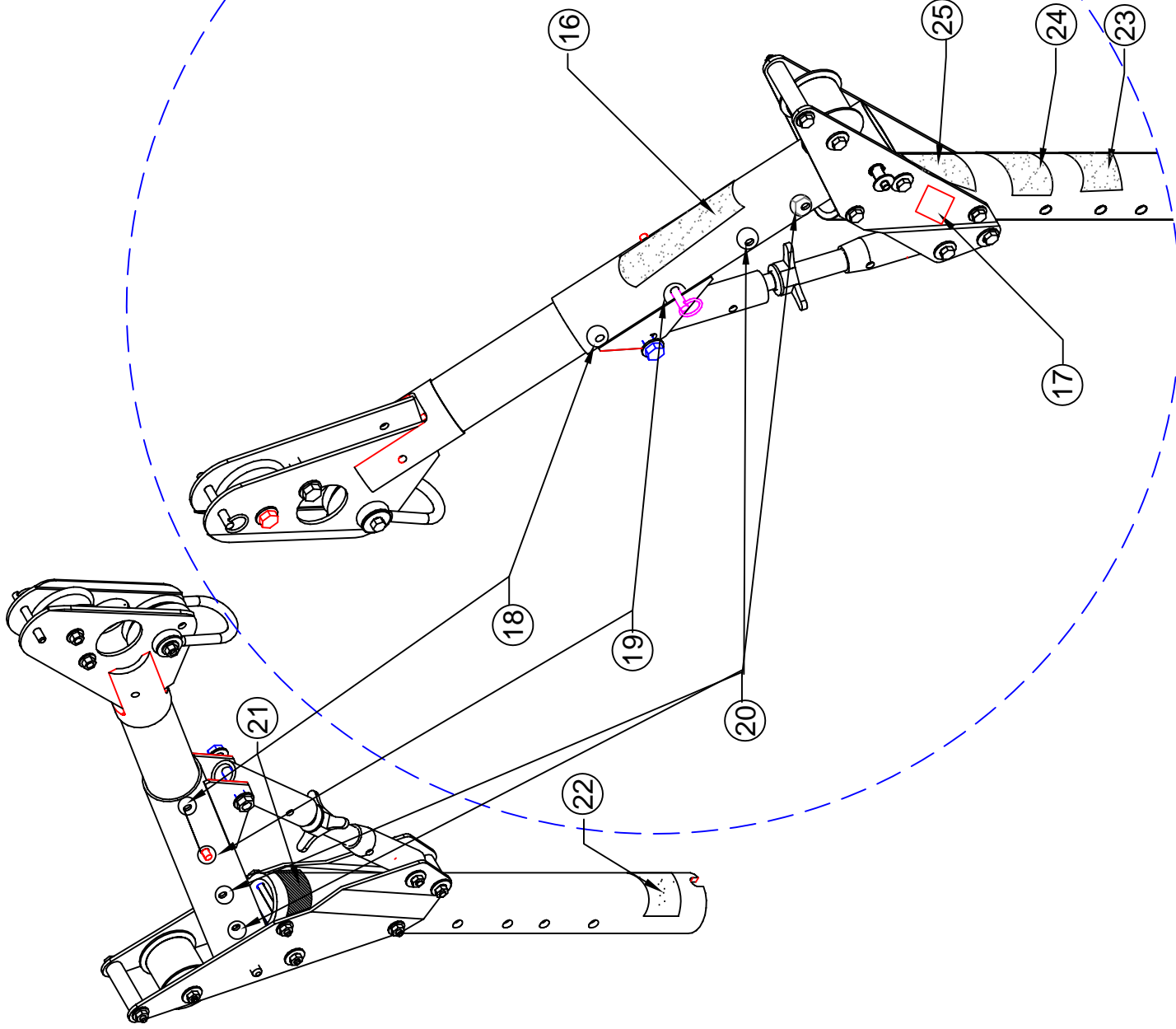

25	15570	1	READ MANUAL LABEL
24	13219	1	LABEL, WARNING 900 Lbs MAF
23	14756	1	MAST OFFSET LABEL (SEE ABOVE)
22	12817	1	UCL SERIAL NUMBER PLATE
21	12998	1	DESIGNED & MANUFACTURED BY UNIQUE
20	15778	4	5000 LB ANCHOR POINT ROUND LABEL
19	15777	2	3600 LB ANCHOR POINT ROUND LABEL
18	15776	2	3000 LB ANCHOR POINT ROUND LABEL
17	15272	1	CE LABEL
16	16840	1	UCL ADVANCED SAFETY SYSTEMS LABEL
ITEM #	PART #	QTY	DESCRIPTION

Unique Concepts Ltd.			
Manufacturers of Industry Standard Confined Space Entry / Retrieval Systems			
Drawn by: OD	Scale: 1:8	Dimensions: INCHES	Date: 08APR03
Checked by:	Date:	Approved by:	Date:
Project: UCL ADVANCED 12-29' OFFSET MAST	DWG SIZE: A	SHEET: 1	REV # 1
Description: COMPLETE ASSEMBLY	Dwg. # 1800		

1	26APR04	CORRECTED PARTS LIST	JS
REV #	DATE	DESCRIPTION OF REVISION	BY

FRONT VIEW

SIDE VIEW

BACK VIEW

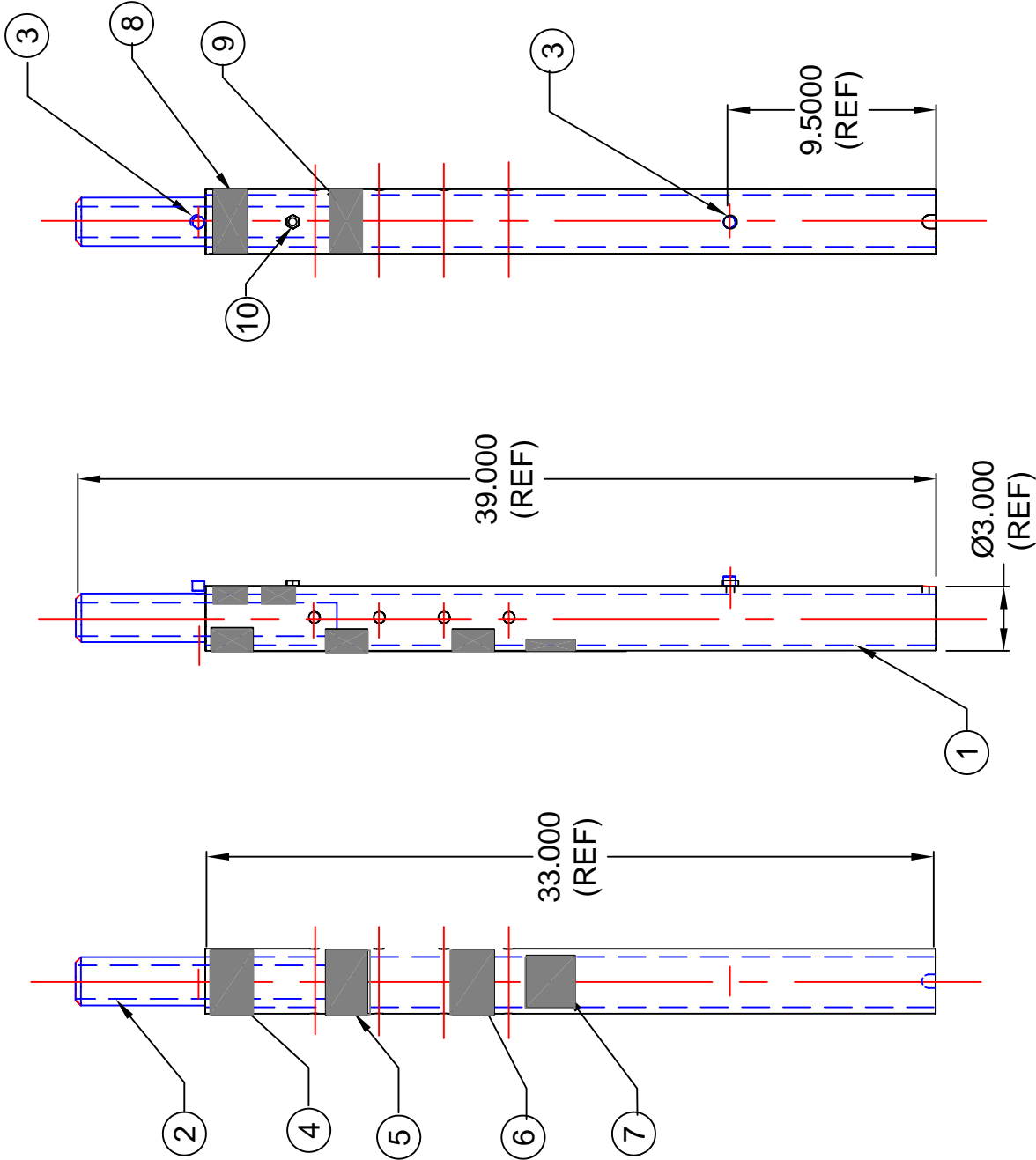

10	18228	1	3/8 UNCx0.25 S/S S.S.C.
9	15570	1	WARNING LABEL READ MANUAL
8	12817	1	UCL NAME PLATE
7	15272	1	CE LABEL
6	13419	1	WARNING LABEL, 450 Lb
5	13423	1	WARNING LABEL
4	12811	1	STICKER UCL, GREEN ON CLEAR
3	12508	2	3/8 UNCx0.5 SKT.HEAD CS
2	17867	1	INNER TUBE
1	17868	1	LOWER TUBE
ITEM #	PART #	QTY	DESCRIPTION

Unique Concepts Ltd. Manufacturers of Industry Standard Confined Space Entry / Retrieval Systems			
Drawn by: OD	Scale: 1:8	Dimensions: INCHES	Date: 08APR03
Checked by:	Date:	Approved by:	Date:
Project: UCL ADVANCED BREAKDOWN MAST	DWG SIZE: A	REV # 0	SHEET: 0
Description: 33" LOWER MAST/MAST EXTENSION	Dwg. # 1800		

0	27JAN04	CORRECTED DESCRIPTION & PROJECT NAME ADDED REF. DIM'S	GH
REV #	DATE	DESCRIPTION OF REVISION	BY

ANGLES  $\pm 1^\circ$  DEG

1 26APR04 CORRECTED PARTS LIST JS

1	26APR04	CORRECTED PARTS LIST	JS

16	13494	1	Ø1/2 x 3.5 PLP α/w LANYARD
15	15114	1	Ø3/8 x 3 Q.R. PIN α/w LANYARD
14	12508	1	Ø3/8 x 0.5 SHCS, PLTD
13	10035	8	Ø3/8" UNC ACORN NUT, PLTD.
12	13343	16	Ø5/16 USS FLAT WASHER
11	10039	5	Ø3/8 UNC x 4.0, HHCS, GR.5, PLTD.
10	12493	3	Ø3/8 UNC x 2.50 HHCS, GR.5, PLTD
9	15111	1	BACK MOUNT ROLLER (MSP)
8	15157	3	SIDE PLATE SPACER
7	15153	1	MAST SIDE PLATE (L.H.S.)
6	15152	1	MAST SIDE PLATE (R.H.S.)
5	17875	1	WA, HEAD RECEIVER TUBE
4	19285	1	WA, MAST HEAD
3	18391	1	59" MAST UPRIGHT TUBE
2	15253	3	ADJUSTABLE GUSSET SPACER
1	15225	1	MA, ADJUSTABLE GUSSET
ITEM #	PART #	QTY	DESCRIPTION

**Unique Concepts Ltd.**

Manufacturers of Industry Standard Confined Space Entry / Retrieval Systems

Drawn by:	OD	Scale:	1:8	Dimensions:	INCHES	Date:	09OCT0:
Checked by:		Date:		Approved by:		Date:	
Project		UCL ADVANCED ONE PIECE OFFSET MAST		DWG SIZE	A	REV #	1
Description:		UCL ADVANCED ONE PIECE (66"-76" OAH) 12-29 VARIABLE OFFSET MAST		SHEET:		OF:	1838:



## WARNING

Refer to the Warning Label containing information on the working load and maximum M.A.F. rating of this mast. This mast has offset(s) of:

12" 18" 24" 30"

Pl #14756

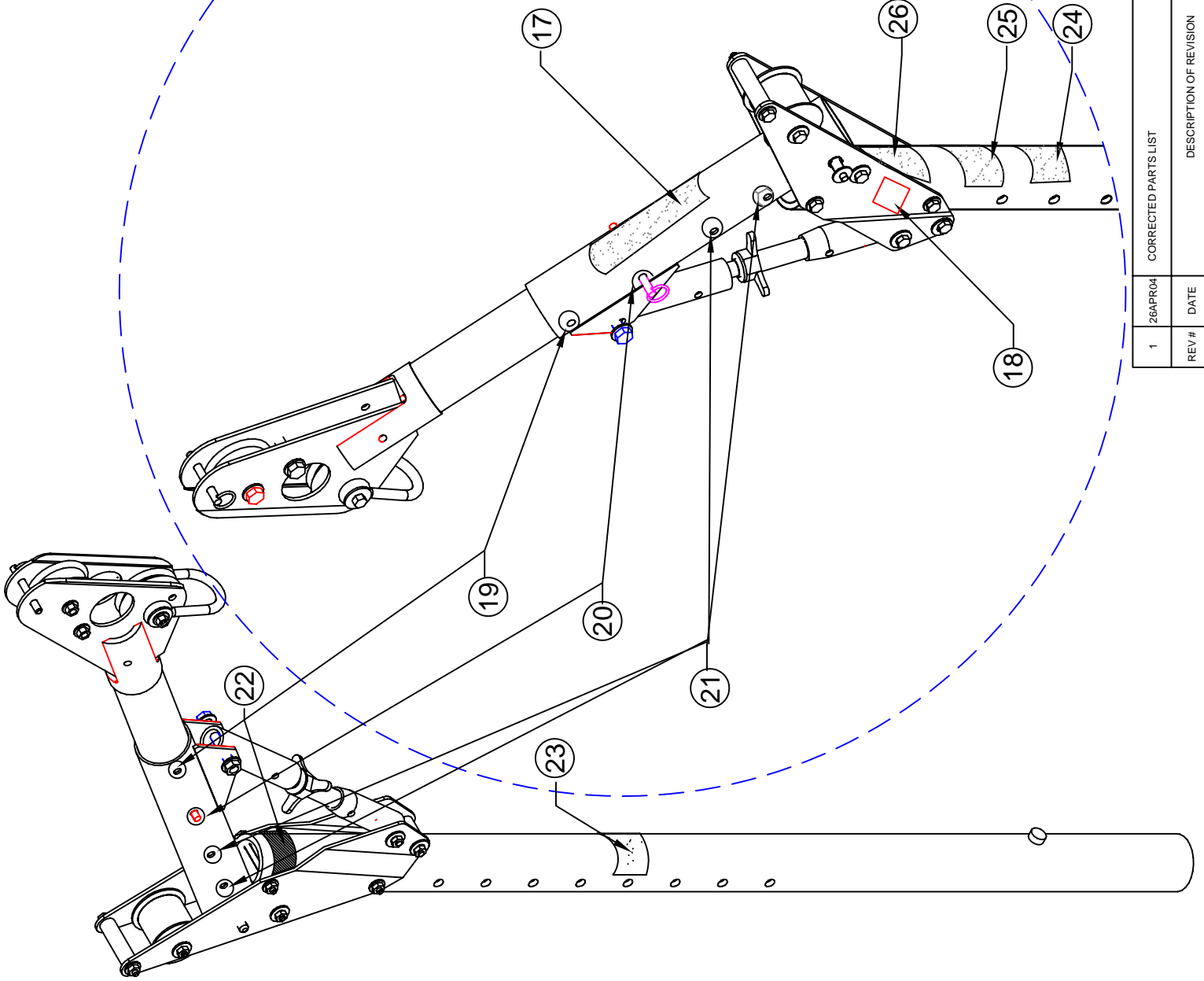

26	15570	1	READ MANUAL LABEL
25	13219	1	LABEL, WARNING 900 Lbs MAF
24	14756	1	MAST OFFSET LABEL (SEE ABOVE)
23	12817	1	UCL SERIAL NUMBER PLATE
22	12998	1	DESIGNED & MANUFACTURED BY UNIQUE
21	15778	4	5000 LB ANCHOR POINT ROUND LABEL
20	15777	2	3600 LB ANCHOR POINT ROUND LABEL
19	15776	2	3000 LB ANCHOR POINT ROUND LABEL
18	15272	1	CE LABEL
17	16840	1	UCL ADVANCED SAFETY SYSTEMS LABEL
ITEM #	PART #	QTY	DESCRIPTION

Unique Concepts Ltd.			
Manufacturers of Industry Standard Confined Space Entry / Retrieval Systems			
Drawn by: OD	Scale: 1:8	Dimensions: INCHES	Date: 09OCT01
Checked by:	Date:	Approved by:	Date:
Project: UCL ADVANCED ONE PIECE OFFSET MAST	DWG SIZE: A	REV # 1	SHEET: 1 OF: 1
Description: UCL ADVANCED ONE PIECE (66"-76" OAH) 12-29 VARIABLE OFFSET MAST	Dwg. # 1838		

1	26APR04	CORRECTED PARTS LIST	JS
REV #	DATE	DESCRIPTION OF REVISION	BY

TOLERANCES  
(UNLESS OTHERWISE SPECIFIED)  
.X±0.040  
.XX±0.020  
.XXX±0.010  
ANGLES ±1°DEG

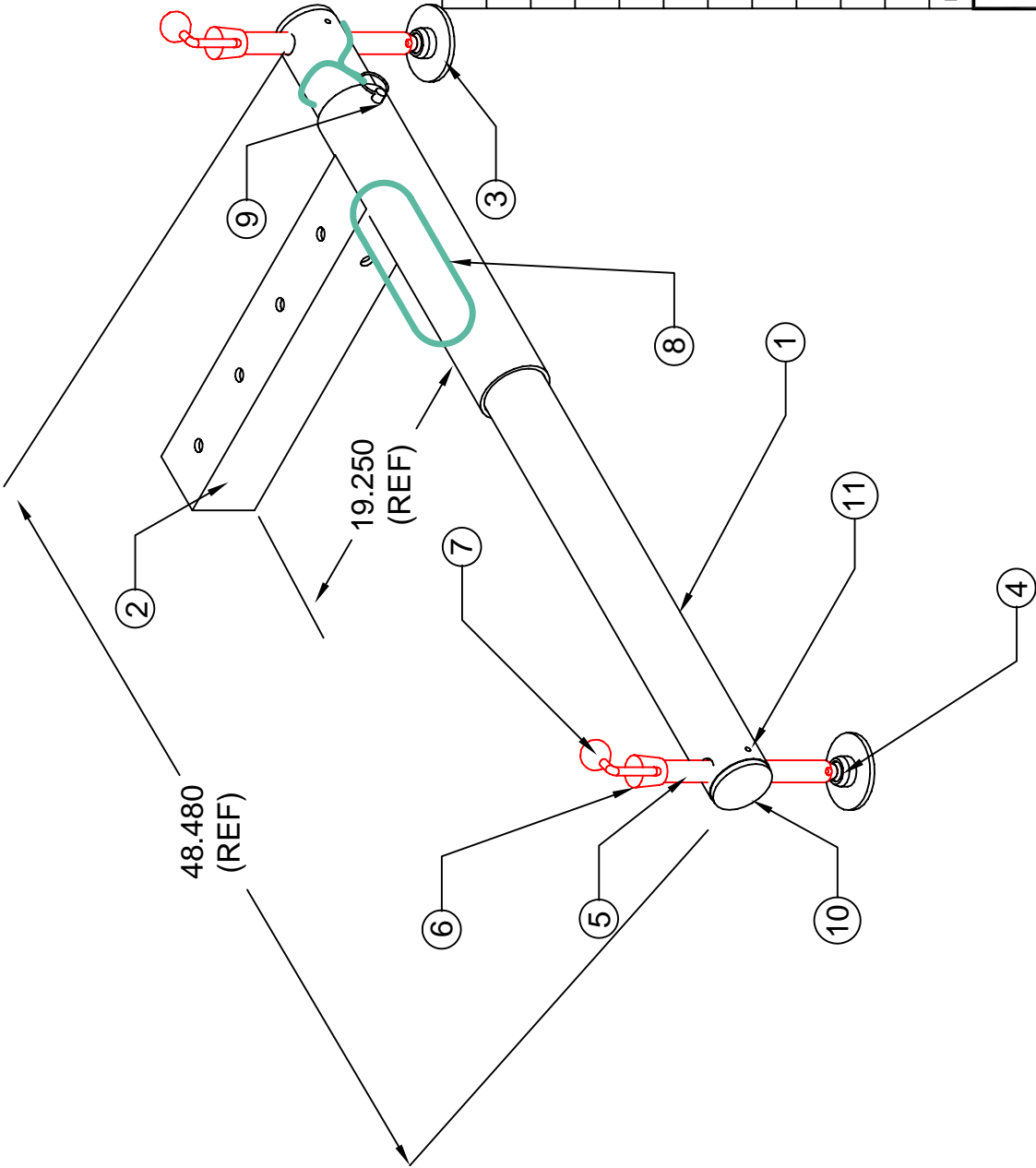

11	17365	4	3/16 x 1/2 POP RIVET, STEEL
10	13585	2	PLASTIC LEG TUBE NUT
9	13891	1	1/2 x 4.0" Q.R. PIN w/ 12" P.L. LANYARD
8	16840	1	LABEL, UCL ADVANCED SYSTEMS
7	10414	2	SCREW LEG HANDLE ASSEMBLY
6	10019	2	LEG CAP
5	17237	2	Ø1-10 DBL START x 10.75" SCREW, AL.
4	12521	2	1/4NF x 1/4 HALF DOG SET SCREW
3	10502	2	Ø3.5" SWIVEL FOOT PAD
2	17019	1	LEG SLEEVE
1	17017	1	48" LEG TUBE
ITEM #	PART #	QTY	DESCRIPTION

Unique Concepts Ltd. Manufacturers of Industry Standard Confined Space Entry / Retrieval Systems			
Drawn by:	Scale:	Dimensions:	Date:
JS	1:8	INCHES	03MAR03
Checked by:	Date:	Approved by:	Date:
Project: UCL "ADVANCED" BREAKDOWN BASE		DWG SIZE	REV #
Description: 48" LEG ASSEMBLY		A	0
			SHEET: 1721
			OF:

0	20JAN04	ADDED DIM'S: 19.250(REF) & 48.480(REF) CHANGED SCALE 1:8 WAS NTS	GH
REV #	DATE	DESCRIPTION OF REVISION	BY

$\cdot X \pm 0.040$   
 $\cdot XX \pm 0.020$   
 $\cdot XXX \pm 0.010$   
**ANGLES  $\pm 1^\circ$  DEG**

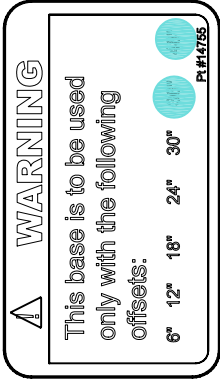

13	10074	1	SLEEVE CAP
12	14755	1	LABEL, MAX OFFSET
11	15570	1	LABEL, READ & UNDERSTAND INSTRUCTION
10	12817	1	LABEL, FOIL NAMEPLATE
9	12998	1	LABEL, DESIGNED BY UNIQUE
8	13443	1	Ø1/16 x 6" P.L. LANYARD ASSY
7	13908	2	1/2 x4.0" Q.R. PIN & LANYARD for TRI-SCREW
6	10047	1	1/4" FLAT WASHER
5	13446	1	1/4 NC x 0.75 T.C. HHCS, PLTD
4	11952	1	LEVEL INDICATOR
3	13136	1	PVC SLEEVE LINER
2	11951	3	TRI-SCREW
1	17018	1	W/A. SENTRE SECTION
ITEM #	PART #	QTY	DESCRIPTION

Manufacturers of Industry Standard Confined Space Entry / Retrieval Systems				
Drawn by:	OD	Scale:	NTS	Dimensions: INCHES
Checked by:		Date:	Approved by:	Date: 03OCT02
Project:	UCL "ADVANCED" BREAKDOWN BASE		DWG SIZE: A	REV # 0 SHEET: OF:
Description:	36" CENTRE SECTION ASSEMBLY			
				Dwg. # 1702

0	17JUL03	ADDED ITEM 13 & OVERALL DIM'S	JS
REV #	DATE	DESCRIPTION OF REVISION	BY

## **8. SERVICE CENTERS**

### **8.1 General**

This list provides a general list of the manufacturer(s) as well as certified service centres in different countries.

If you require assistance in finding the closest service centre please call the manufacturer(s) directly.

#### **Manufacturer(s)**

##### **CANADA**

Capital Safety - Canada  
260 Export Boulevard  
Mississauga, ON L5S 1Y9  
Phone: 905.795.9333  
Toll-Free: 800.387.7484  
sales.ca@capitalsafety.com

##### **USA**

Capital Safety  
3833 SALA Way  
Red Wing, MN 55066-5005  
Phone: 651.388.8282  
Toll-Free (US): 800.328.6146  
solutions@capitalsafety.com

##### **ASIA**

Capital Safety Group Asia Pte Ltd.  
No. 6, Tuas Avenue 18  
Singapore 638 892  
Phone: 65 6558 7758  
inquiry@capitalsafety.com

##### **AUSTRALIA / NEW ZEALAND**

Capital Safety Australia Ltd.  
20 Fariola Street  
Silverwater  
Sydney NSW 2128  
Australia  
Toll Free: 1 800 245 002 (Australia)  
Toll Free: 0800 212 505 (New Zealand)

##### **EUROPE / MIDDLE EAST / AFRICA**

Capital Safety Group E.M.E.A.  
Le Broc Center– Z.I. 1ère Avenue  
5600 M B.P. 15 06510  
Carros Le Broc Cedex  
France  
Phone: + 33 4 97 10 00 10  
information@capitalsafety.com

##### **NORTHERN EUROPE**

Capital Safety Group Northern Europe  
Unit 7 Christleton Court  
Manor Park  
Runcorn  
Cheshire, WA7 1ST  
Phone: + 44 (0)1928 571324  
csgne@csgne.co.uk







**Capital Safety** USA: 800.328.6146 • Canada: 800.387.7484 •  
Asia: + 65 6558 7758 • Australia/New Zealand: 800 245 002 •  
Europe, Middle East, Africa: +33 (0) 497 10 00 10 •  
Northern Europe: +44 (0) 1928 571324  
**[www.capitalsafety.com](http://www.capitalsafety.com) • [info@capitalsafety.com](mailto:info@capitalsafety.com)**