

Denali Stroller Instruction Manual



Only suitable for use as a travel system with compatible RECARO infant carriers.

Use the stroller only with children who weigh up to 50 lbs (22.5 kg) and whose height is less than 44 in (111.8 cm)

El manual de instrucciones Denali Stroller esta disponible en español en www.recaro-cs.com. Por favor visite el internet para bajar una versión en español.



Please read instructions prior to installation. Store this manual in the seat back pocket.

Contents

Section 1: Safety Warnings	p. 4-5
Section 2: General Information	p. 6
Section 3: Register your New Denali Stroller.....	p. 7
Section 4: Getting to know your Denali Stroller.....	p. 8
Section 5: Parts List	p. 9
Section 6: Assembly.....	p. 10-11
Section 7: Operations and Use	p. 12-16
Section 8: Cleaning and Maintenance	p. 17
Section 9: Warranty.....	p. 18-19
Section 10: Replacement Parts.....	p. 20
Section 11: Additional Contact Information	p. 21

Dear Parents,

Welcome to the RECARO family of high quality child safety products and thank you for purchasing your new RECARO stroller.

RECARO has over 100 years of experience in the design and manufacturing of high performance safety seating systems for the world's most prestigious automobiles, airlines and race cars. To ensure all products RECARO manufactures are worthy of the name, we've subjected them to a comprehensive development program, complying with ASTM F833 safety standards. RECARO is also ISO 9001 certified, which helps ensure the most comprehensive product development system available.

Although each RECARO stroller system is equipped with state-of-the-art safety features, it is not a guarantee that this stroller will prevent injury. However, if you stress careful maneuvering and proper use of your stroller, it can reduce the risk of serious injury.

Therefore, please make sure to carefully review all information in this instruction manual to learn how to properly secure your child when using this product. Also, before using your new stroller for the first time, please review all components thoroughly to make sure nothing has been damaged during shipping. Failure to follow these instructions and the labels on the stroller can result in serious injury.

The RECARO stroller you have purchased is a high quality product. Its different settings and stable ergonomic design ensures that the RECARO stroller is a safe and comfortable place for your child to sit. However, before you use it, you need to adjust the settings to your child's size so that the stroller will perform as required. These instructions will help you do this, so please read them carefully.

Thank you again for choosing RECARO and enjoy your new stroller! If you have any questions or need assistance of any kind, please contact us at:

RECARO Child Safety, LLC
1600 Harmon Road
Auburn Hills, MI 48326

Tel: 1-888-9RECARO
Internet: www.recaro-cs.com
E-mail: info-usa@recaro-cs.com

El manual de instrucciones Denali Stroller esta disponible en español en www.recaro-cs.com. Por favor visite el internet para bajar una versión en español.

Yours sincerely,

The RECARO Child Safety Team

Section 1: Safety Warnings



WARNING! SERIOUS INJURY
can occur

- Never leave child unattended.
- Read and understand all instructions in this user manual. Store manual in pocket located on the back of the stroller.
- Always engage the parking brake when the stroller is not moving.
- Avoid serious injury from falling or sliding out. Always use the restraint system.
- Do NOT use stroller with a child who weighs more than 50 lbs (22.7 kg).
- Do NOT use stroller with a child taller than 44 in (111.8 cm).
- Do NOT overload basket. Overloading the basket may cause the stroller to become unstable. The maximum weight in the basket is 25 lbs (11.3 kg).
- Do NOT overload the hood storage pocket. The maximum weight in the pocket is 2 lbs (0.9 kg).
- Do NOT overload the cup holder. The maximum weight in the pocket is 2 lbs (0.9 kg).
- Do NOT use stroller on stairs or escalators.
- Do NOT hang or place items on the stroller handle or frame unless approved by RECARO Child Safety. This may cause the stroller to become unstable.
- Adult assembly required.



WARNING! SERIOUS INJURY can occur

- Use care when folding and unfolding the stroller to avoid finger entrapment or pinching.
- Always make certain that the stroller is fully open and locked before use.
- Stroller is intended for use at walking speed only. Do NOT use while jogging, skating, etc.
- Do NOT allow children to climb or play with the stroller. Do NOT allow child to stand in stroller.
- Only use compatible RECARO infant carriers with the Denali stroller. Refer to the infant carrier manual for maximum weights and other instructions.
- The infant carrier MUST be installed rear-facing. See section 7
- Do NOT lift the stroller by the tray.
- Do NOT put hot liquid in the cup holder.

Section 2: General Information

Extreme Weather

When it is **hot**, RECARO recommends the following tips to reduce possible injury or discomfort to your child:

- Store your stroller in the shade to help keep it cooler.
- Cover the stroller with a sheet or blanket when not in use.
- **ALWAYS** check surface temperatures of the stroller before placing a child in it.

NEVER, EVER leave your child unattended.

Section 3: Register Your New Denali Stroller

Strollers can be recalled for safety reasons. You must register this stroller to be contacted in a recall. Send your name, address, email address if available, and the stroller's model number, serial number and manufacturing date to:



RECARO Child Safety, LLC
1600 Harmon Road
Auburn Hills, MI 48326

or call: 1-888-9RECARO



or register online at: www.registry.recaro-cs.com
E-mail: info-usa@recaro-cs.com



ALL information provided to RECARO on the registration card or on the online registry will **NOT** be sold, distributed, or used for any purposes other than to contact you in the event of a recall.

Section 4: Getting to Know Your Denali Stroller

It is important to become familiar with the features of your new stroller. This diagram will help you identify key features.



Section 5: Parts List



Stroller Frame

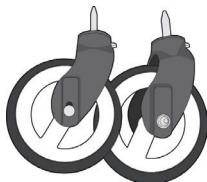

Front Wheels

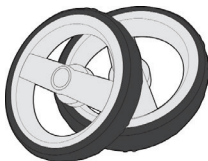

Rear Wheels

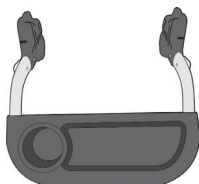

Tray with Adapters



Cup Holder

Section 6: Assembly

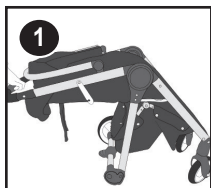

Unfolding

1. Lift handle until frame clicks into the upright position.



Front Wheels

2. The front wheels come assembled onto the frame. If front wheels rotate and lock, push down on lever to unlock.



NOTE: To remove the front wheels, push the gray button on the frame and pull the wheels away from the stroller.

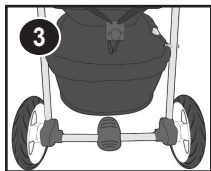

Rear Wheels

3. Push the metal tab on the underside of the rear wheel connection on the frame. Slide the rear wheel in and release the metal tab. Find the correct side for each wheel by observing the "V" shapes on the wheel. The point of the "V" should point towards the front of the stroller.

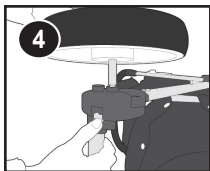

4. Gently pull on the wheel to ensure it is secure.

NOTE: To remove the rear wheels, press down on the metal tab and pull the wheel away from the stroller frame.

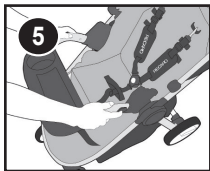

Child Tray

5. Align the inserts with the posts located on the frame of the stroller and slide in while engaging the buttons on the side of the tray until clicked into place.

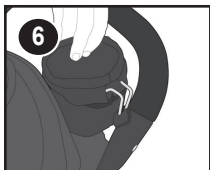

Cup Holder

6. Slide the metal bar into the pocket on the inside of the stroller push handle.

One cup holder comes with each stroller.

Section 7: Operations and Use

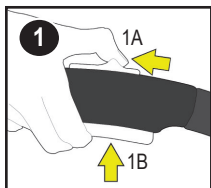

Folding

1. Slide button (1A) on the handle with your thumb and push the other button (1B) with the rest of your fingers.
2. Push handle down and toward the ground.
3. Rotate tray downward by pulling the lever on the front of the tray and pushing down.
4. Lift the stroller by the strap in the middle of the seat to carry and lock the hook on the side.

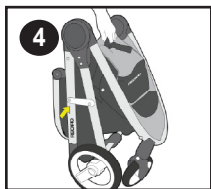
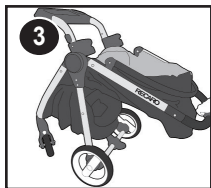

Push-Push Brake

5. Push the back of the brake pedal to lock the stroller's back wheels, push the stroller forward to ensure the brake is engaged.
6. Push down on the front of the brake pedal to unlock.

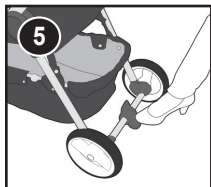

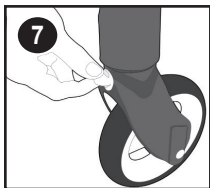

Front Wheel Swivel Brake

7. Lift up on the swivel lock lever on the front wheels to lock.
8. Push down the swivel lock lever to unlock the swivel on the front wheels.

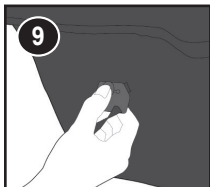

Recline

9. Squeeze the release button on the recline adjuster and slide it down and away from the seat.
10. To raise, pull the two straps away from each other.

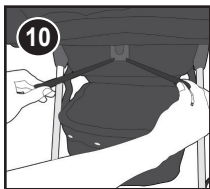

Canopy Rotation

11. Pull the front of the canopy forward to adjust.

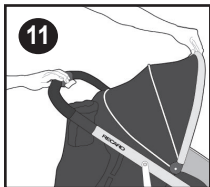



Child's Tray

12. Pull the front lever and push down toward the stroller seat to use in infant carrier mode.
13. To remove the child tray, pull on the tabs on both sides of the tray and remove the tray

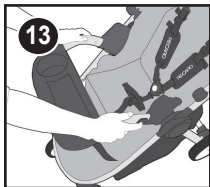

Securing Your Child

14. Adjust shoulder strap height by unclipping the harness clips and choosing one of the three height positions that is nearest to the child's shoulders.
15. Release the harness by pushing the gray button on the buckle.

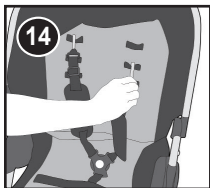



16. Place child in seat and buckle the harness by placing the inserts into the slots of the buckle assembly.



17. Tighten or loosen the harness straps by sliding the harness adjusters on the shoulder straps and the hip straps.

Infant Carrier Attachment

Attaching the RECARO infant carrier



18. Engage the parking brake and rotate the child tray downward.

19. Line up the adapter on the infant car seat with the receivers on the stroller.

20. Press down until secured into place.

21. Gently lift up on the infant carrier to ensure both sides are secure.

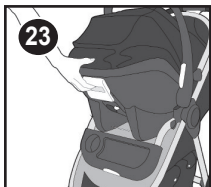

Removing the RECARO Infant Carrier

22. Engage parking brake
23. Lift up on release lever on the back of the infant carrier and lift the infant carrier up and out of the stroller posts.

Section 8: Cleaning and Maintenance

Fabric/Harness

1. The fabric and harness are not removable.
2. Clean by hand with a sponge or soft cloth using warm water and mild soap.
3. Pat dry with a clean, dry towel.
4. Allow to air dry.

Frame and Plastics

5. Clean by hand with a sponge or soft cloth using warm water and mild soap.
6. Dry the structure off thoroughly with a soft towel.

Storage

7. Only store your stroller when dry and in a dry environment.
8. Store away from extreme heat.
9. Do NOT place heavy objects on top of the stroller when stored.

Section 9: Warranty

RECARO Child Safety, LLC warrants this product against defects in materials or workmanship to the original purchaser for a period of 12 months. You must have the original purchase receipt for a warranty claim to be accepted.

The upholstery fabric is subject to a certain degree of wear even from normal use. This kind of normal wear is not covered under warranty.

Exclusions: A product will not be considered “defective” and this Warranty will not apply, where the claimed defect is attributable to:

- a) Improper use;
- b) Modification or alteration of the product;
- c) Failure to comply with RECARO’s instructions for service and maintenance;
- d) Accident, unauthorized repairs or unauthorized use;
- e) Any attachment or replacement part that was manufactured, supplied or added by others and was not part of the product;
- f) Exposure to corrosive materials, the elements (including, but not limited to, cold or freezing temperatures, excessive heat, fire, humidity, and sunlight), or other acts of God;
- g) Ordinary wear and tear (including fading and discoloration);

- h) Improper loads (including passenger weight in excess of design limits);
- i) Removal of the product from the original application or reinstallation of the product in the original or another application; or
- j) Any other neglect, abuse or misuse.

Section 10: Replacement Parts

RECARO offers a variety of replacement parts for your travel system. Please call us at 1-888-9RECARO and speak to one of our customer service representatives for more information on what is available for purchase.

Customer Service Contact Information:

Phone Toll Free: 1-888-9RECARO

Email Address: info-usa@recaro-cs.com

Website: www.recaro.com

Section 11: Additional Contact Information

For questions regarding this product, please use the following contact information:

RECARO Child Safety, LLC

1600 Harmon Road

Auburn Hills, MI 48326

Toll Free: 1-888-9RECARO (1-888-973-2276)

E-mail: info-usa@recaro-cs.com

Website: www.recaro.com



RECARO Child Safety, LLC

1600 Harmon Road, Auburn Hills, MI 48326

Tel: 1-888-9RECARO

Internet: www.recaro.com, E-mail: info-usa@recaro-cs.com

In the interest of product development, RECARO reserves all rights to make changes to the construction and design of its products without prior notification.

RECARO does not assume the liability in case of misprint. Pictures may include extras.

P/N 7220383 REV000