

# FINECEL

## Water Filtration System

**WINIX INC.**  
120 Prairie Lake Rd.  
Unit E  
East Dundee, IL 60118  
USA

*Please be sure to specify a model number*

- Tel : 1.847-551-9900
- Fax : 847-551-9200
- Toll-free : 1-877-MY-WINIX (699-4649)
- Email : [info@winixinc.com](mailto:info@winixinc.com)
- Website : [www.winixinc.com](http://www.winixinc.com)

Please contact your dealer for questions regarding your product and to purchase WINIX Replacement Filters.

2013.02.28

# WINIX FINECEL

Installation and Operation Manual

## Water Filtration System

Model : FCSPU1

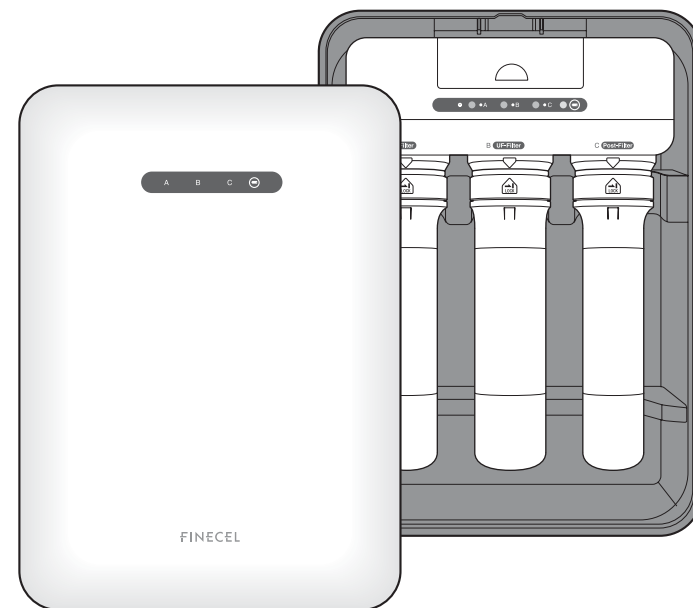

### CAUTION

Read and follow all Safety rules and instructions  
Before operating this equipment



System tested and certified by NSF International against NSF/ANSI Std. 53 and NSF/ANSI std. 42 for the reduction claims specified on the performance data sheet.

## TABLE OF CONTENTS

1.0 Warranty	2
2.0 Safety Instructions	3
3.0 Specification & Dimensions	4
4.0 Installation Instructions	5
4.1 Package contents	5
4.2 Tools needed	6
4.3 Installation overview	7
4.4 Turn off water supply	8
4.5 Determine the installation location	8
4.6 Drilling	9
4.7 Faucet mounting	9
4.8 4.8 Mounting Bracket System Installation	10
4.9 Install batteries	11
4.10 Cold water supply fitting	11
4.11 Making tubing connections	13
4.12 Connect water lines	14
4.13 Attaching the Diverter Valve	15
5.0 Filter Cartridge	17
5.1 Carbon Filter Cartridge Life	17
5.2 UF Cartridge Life	17
5.3 Filter Cartridge Replacement	18
6.0 Replacement Indicator	19
6.1 FCSPU1 Indicator	19
7.0 Troubleshooting	21

## 1.0 WARRANTY

### ONE YEAR LIMITED WARRANTY ON FINECEL WATER FILTRATION SYSTEM [EXCLUDING FILTER CARTRIDGES]

Warrantor: Winix Inc., 120 Prairie Lake Rd Unit E, East Dundee, IL 60118

Warrantor guarantees, to the original owner, that the FINECEL Water Filtration System, when installed and maintained in accordance with the instructions, will be free from defects in materials and workmanship for a period of one year from date of installation. If, within the first year, a part proves, after inspection, to be defective, Warrantor will, at its sole option, either replace or repair the part without charge except normal shipping and installation charges. Labor to maintain the equipment is not part of the warranty. Filters, which are expendable, are not covered by the warranty.

TO OBTAIN WARRANTY PARTS, SIMPLY CALL 1-877-MY-WINIX (699-4649), Monday - Friday, 8 am - 5 pm CST, for assistance. This warranty applies only while this product is in use in the United States or Canada.

#### General Provisions

The above warranties are effective provided the FINECEL Water Filtration System is operated at water pressures not exceeding 100 psi, and at water temperatures not exceeding 100 °F ; provided further that the FINECEL Water Filtration System is not subject to abuse, misuse, alteration, neglect, freezing, accident or negligence; and provided further that the FINECEL Water Filtration System is not damaged as the result of any unusual force of nature such as, but not limited to, flood, hurricane, tornado or earthquake.

Warrantor is excused if failure to perform its warranty obligations is the result of strikes, government regulation, materials shortages, or other circumstances beyond its control.

\*THERE ARE NO WARRANTIES ON THE FINECEL WATER FILTRATION SYSTEM BEYOND THOSE SPECIFICALLY DESCRIBED ABOVE. ALL IMPLIED WARRANTIES, INCLUDING ANY IMPLIED WARRANTY OF MERCHANTABILITY OR OF FITNESS FOR A PARTICULAR PURPOSE, ARE DISCLAIMED TO THE EXTENT THEY MIGHT EXTEND BEYOND THE ABOVE PERIODS. THE SOLE OBLIGATION OF WARRANTOR UNDER THESE WARRANTIES IS TO REPLACE OR REPAIR THE COMPONENT OR PART WHICH PROVES TO BE DEFECTIVE WITHIN THE SPECIFIED TIME PERIOD, AND WARRANTOR IS NOT LIABLE FOR CONSEQUENTIAL OR INCIDENTAL DAMAGES. NO WARRANTOR DEALER, AGENT, REPRESENTATIVE, OR OTHER PERSON IS AUTHORIZED TO EXTEND OR EXPAND THE WARRANTIES EXPRESSLY DESCRIBED ABOVE.

Some states do not allow limitations on how long an implied warranty lasts or exclusions or limitations of incidental or consequential damage, so the limitations and exclusions in this warranty may not apply to you. This warranty gives you specific legal rights, and you may have other rights which vary from state to state. This warranty applies to consumer-owned installations only.

## 2.0 SAFETY INSTRUCTIONS

- Read all steps and guides carefully before installing and using your Water Filtration System. Follow all steps exactly to correctly install. Reading this manual will also help you to get all the benefits from the Water Filtration System.
- Do not attempt to use this product to make safe drinking water from non-potable water sources. Do not use the system on microbiologically unsafe water, or water of unknown quality without adequate disinfection before or after the system.  
This system is certified for cyst reduction and may be used on disinfected water that may contain filterable cysts.
- Check with your state and local public works department for plumbing and sanitation codes. You must follow their guides as you install the system. Follow your local codes if they may differ with guides in this manual.
- The Water Filtration System works on water pressures of 20 psi (minimum) to 100 psi (maximum).  
If your house water pressure is over the maximum, install a pressure reducing valve in the water supply pipe to the Water Filtration System.
- Do not install the Water Filtration System outside, or in extreme hot or cold temperatures. Temperature of the water supply to the Water Filtration System must be between 33 °~100 °F(0.6~38 degrees C). Do not install on hot water.

**WARNING** : When using Saddle Valves, check with local ordinances.

## 3.0 SPECIFICATIONS & DIMENSIONS

Supply water Pressure : 20~100 psi (140~689kPa)  
Supply water temperature limits : 33 °~100 °F (0.6 °~38 °C)  
Tubing : 1/4" quick connect fittings and tubing included  
(Tubing is not Performance Tested or Certified by NSF)  
Capacity : 400 gal (1513 liters)  
Flow rate : 0.5 GPM (1.89 liters/min)

### FCSPU1

<Figure 3.0.1>

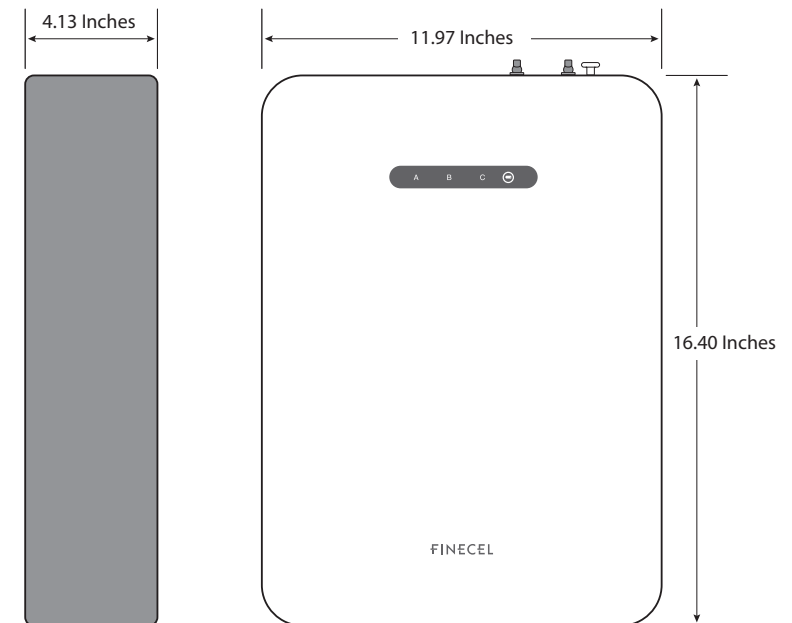

## 4.0 INSTALLATION INSTRUCTIONS

### 4.1 Package Contents

<Figure 4.1.1>

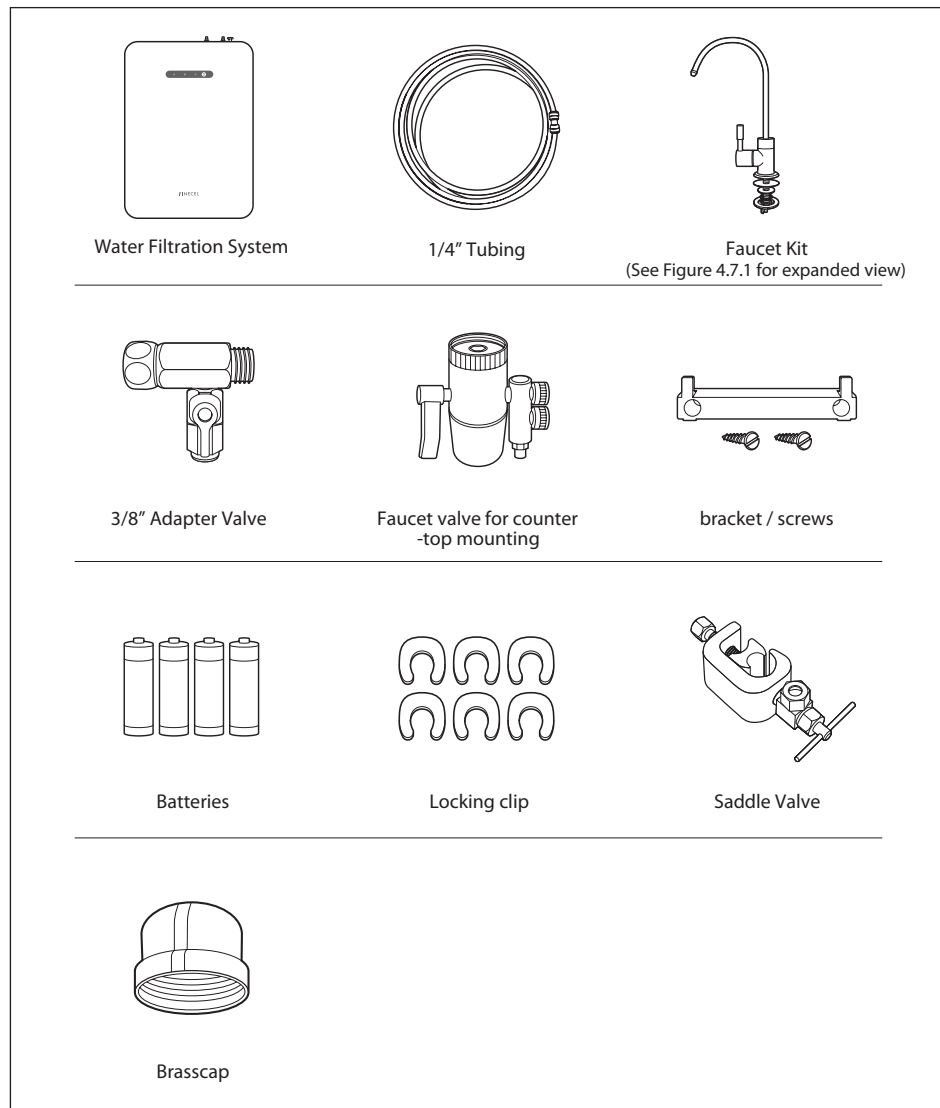

### 4.2 Tools Needed

#### NOTE

Gather the required tools before starting installation. Read and follow the instructions provided with any tools listed here.

<Figure 4.2.1>

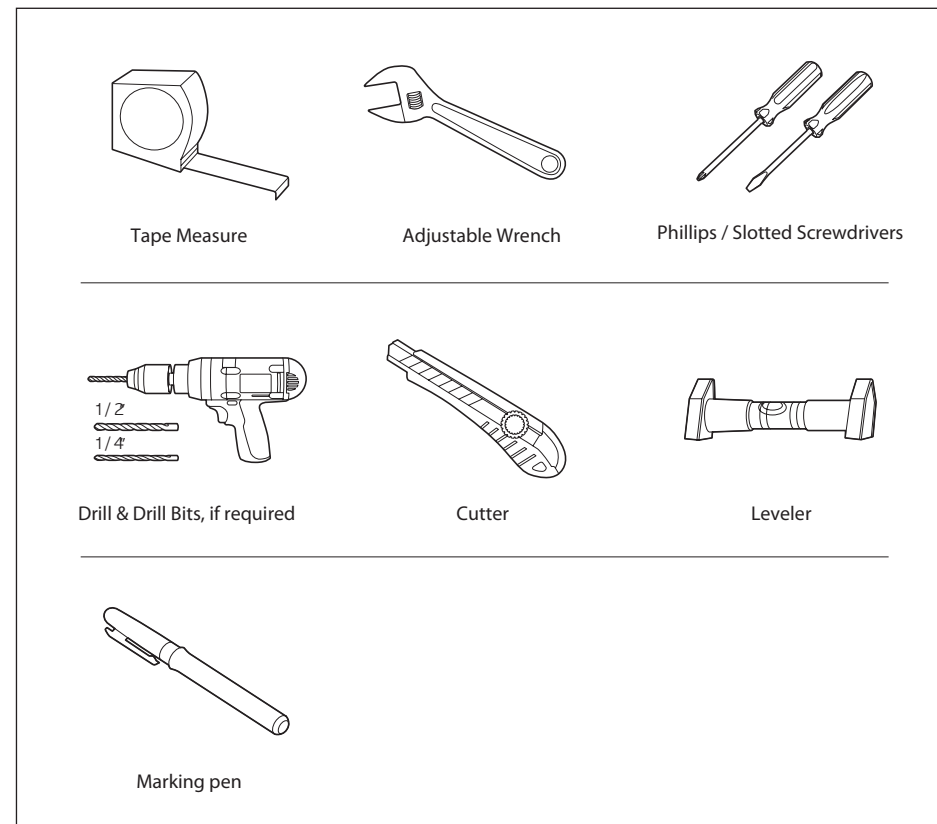

**IMPORTANT:** To avoid damaging the sink or counter, consult a qualified plumber or installer for drilling procedures in porcelain, stainless steel, granite, quartz or some other special material. WINIX is not responsible for any damage that occurs due to improper installation of the unit.

### 4.3 Installation Overview

Locate cold water supply pipe, under the sink that you wish to filter for drinking water.

<Figure 4.3.1>

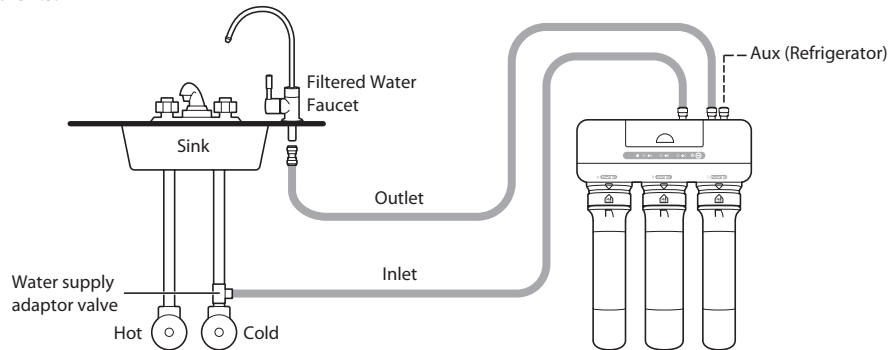

<Figure 4.3.2>

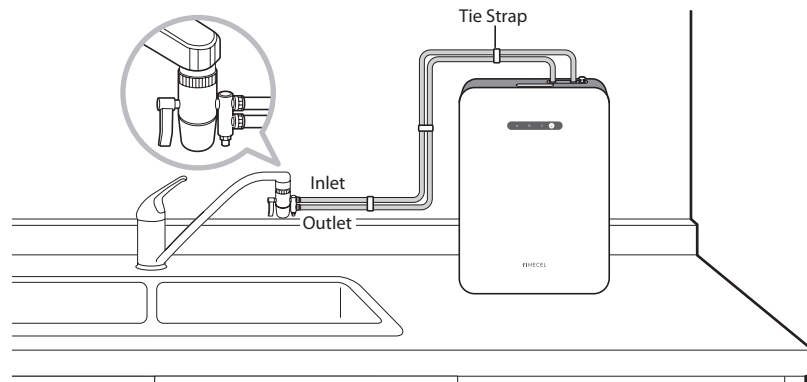

### 4.4 Turn Off The Water Supply

Before you begin, close the cold water/water supply valve that feeds water to your tap. Then open the faucet to drain water from the sink cold water pipe.

### 4.5 Determine The Installation Location

Determine the location where you intend to install the drinking water faucet. Make sure it is far enough away from the main faucet so that they don't interfere with each other-yet in a good location for filling pitchers or pots of water for cooking.

Most kitchens have a pre-existing hole near the main faucet that is sometimes used for a dish sprayer, or soap dispenser.

If you are removing a dish sprayer to make room for your drinking water faucet, we've included a 1/4 inch brass cap so that you can close off the existing stem.

<Figure 4.5.1>

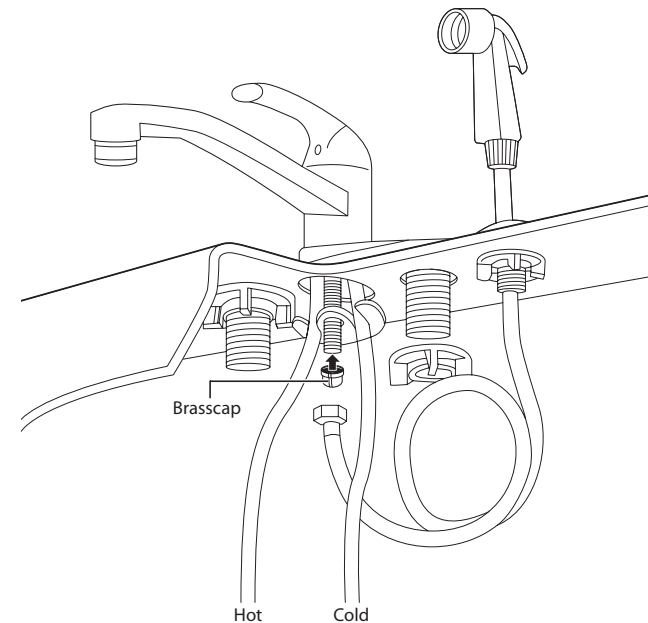

## 4.6 Drilling

If you need to drill a new hole for your drinking water system, take the base cover off the faucet and place it where you want to install the drinking water faucet, and then mark the location.

To avoid damaging the sink or counter, consult a qualified plumber or installer for drilling procedures in porcelain, stainless steel, granite, quartz or some other special material. WINIX is not responsible for any damage that occurs due to improper installation of the unit.

Before drilling, check for obstructions underneath the sink where the hole will be drilled. Make sure it is clear and safe to drill.

Use a 1/2inch drill bit to drill the hole

## 4.7 Faucet Mounting

(Faucet is not Performance Tested or Certified by NSF)

1. Insert Base, Rubber washer and Gasket onto mounting bolt on faucet.
2. Insert mounting bolt through the drilled hole in fixture.
3. Place Lock Washer Fixing Nut onto mounting bolt, position faucet on fixture, then tighten nut securely. Make sure the faucet is properly positioned on the counter top.
4. Connect flexible hoses to supply stops.

<Figure 4.7.1>

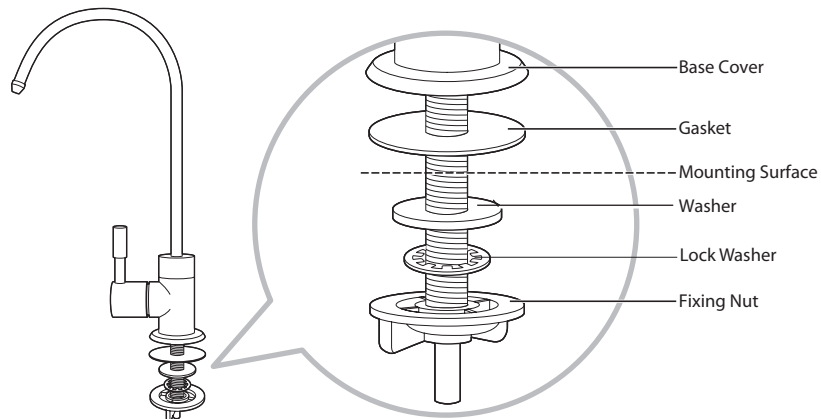

## 4.8 Mounting Bracket System Installation

1. Remove plastic panel on back at perforation with slotted screwdriver

<Figure 4.8.1>

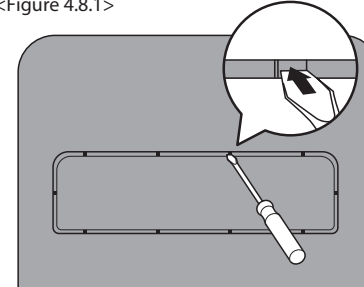

**IMPORTANT:** When using a flat tip screwdriver break each tab individually with a prying action.

3. Place unit above bracket and slowly set into place, aligning hooks on the bracket to the slots on the case. Push down slightly to fit securely. You may need to tilt the bottom of unit forward slightly when placing on bracket. The unit is secured when it no longer shifts from left to right.

<Figure 4.8.3>

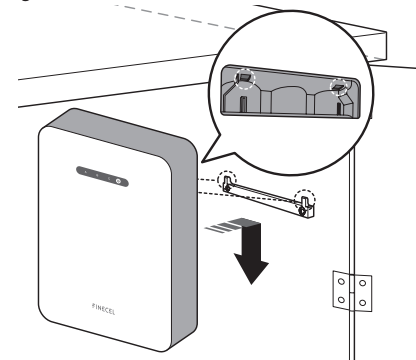

2. Measure proper dimensions for bracket placement. Do not place bracket closer than 5 inches to front or back of cabinet wall, 8 inches from countertop or 12 inches from cabinet floor. For best results install on the side of the cold water source. Mark holes for bracket and drill (if necessary) and attach brackets with screws provided with a phillips screwdriver.

<Figure 4.8.2>

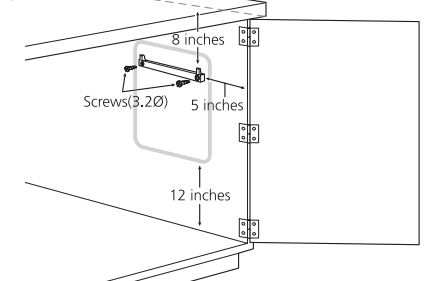

4. To remove filter and case simply tilt the bottom of the case forward and lift up.

<Figure 4.8.4>

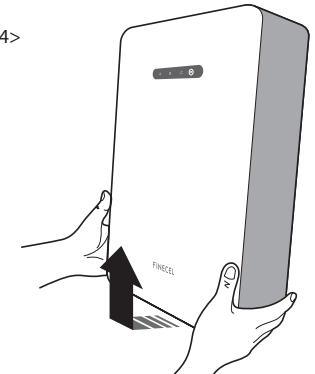

### NOTE

The unit is designed to function when not mounted. Mounting is optional but recommended.

## 4.9 Install Batteries

These will power the lights and other alerts that tell you when to change your filters

1. Push the "open" button of the filter case.
2. Press and slide open battery cover in red circle
3. Insert batteries with proper positive(+) and negative(-) alignment
4. Close the cover

Power on sequence

Battery in->LED1 on->LED2 on->LED3 on->LED4 on->LED all off->Beep

## 4.10 Cold Water Supply Fitting

There are two options to install a cold water feed line. The method that we recommended is to use the angle stop adaptor valve to simply divert water from the cold water line.

The other method is to use self piercing saddle valve, however, prior to using this method, we recommend that you check to ensure its use is permitted under your local ordinances.

### Option 1

#### Install angle stop adaptor valve.

A typical connection using the included adapter valve fitting is shown in the illustration below.

<Figure 4.10.1>

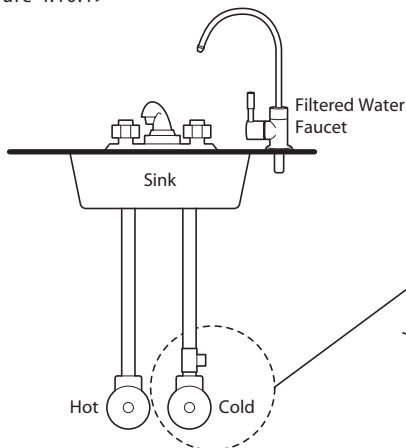

<Figure 4.10.2>

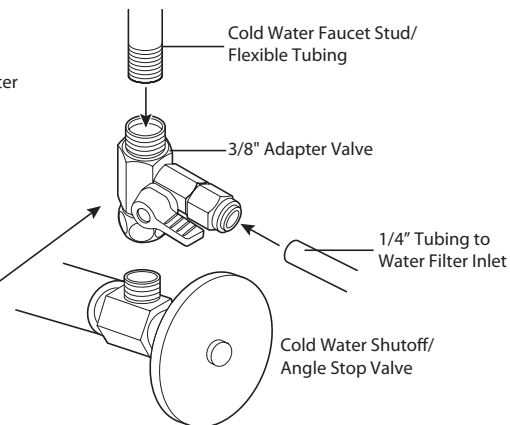

1. Close the water shut off valve/angle stop that is immediately in front of the supply tube and open the faucet to drain water from the sink cold water pipe.
2. Remove the nut that connects the cold water faucet to the supply tube. Some water may spill out.

### NOTES

- Be sure to turn off the water supply and open a faucet to drain the pipe.
- Make sure the gasket is installed in the 3/8" Adapter Valve.

3. Thread the 3/8" adapter valve onto pipe and reconnect nut to bottom of fitting.
4. Install 1/4" tubing. Make sure that 1/4" tubing is securely inserted into quick connect fittings. You should not be able to remove it.

### Option 2

#### Install saddle valve

This fitting will be installed on the cold water pipe. The fitting must provide a leak-tight connection to the 1/4" tubing. Complete the following steps to install the saddle valve assembly.

1. Review and familiarize yourself with all parts of the saddle valve. This valve will self-tap a hole in copper tubing or plastic pipe.

IMPORTANT: Before starting, close the hot and cold water shutoff valves.

2. If installing on iron pipe, drill a 1/8" hole for the piercing pin.
3. Clean the section of the pipe that the saddle valve will be placed on.
4. Turn the valve handle all the way out. (counter-clockwise) Be sure the piercing pin does not stick out beyond the seal.
5. Place the saddle valve on the cold-water pipe over the cleaned area, Tighten the bottom bolt until the valve is firmly mounted on the pipe.
6. Turn the valve handle all the way in. (clockwise) This will pierce the wall of the pipe.
7. Connect the tubing to the fitting like below picture.
8. Open the water shutoff valve(s) and start turning the saddle valve handle counterclockwise until you see water running from the attached tubing. Control the flow by turning the valve handle. After testing, close the valve and work on your appliance.

### NOTE

Once the saddle valve is installed, the nut near the handle may need to be tightened to prevent possible leaks.

## Saddle Valve Connections

<Figure 4.10.3>

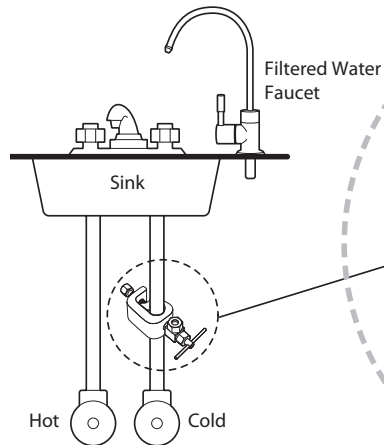

<Figure 4.10.4>

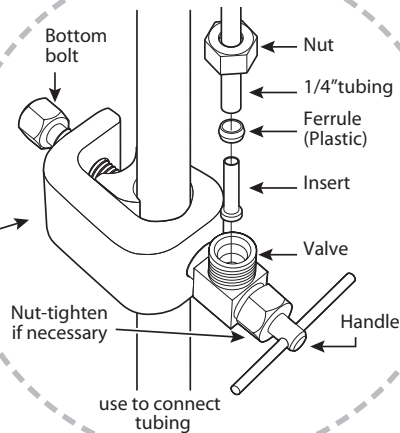

### 4.11 Making Tubing Connections

(Tubing is not Performance Tested or Certified by NSF)

1. Measure 3/4" from the end of each remaining piece of tubing (faucet end and inlet end) and mark with a pencil (Check for roundness, smoothness, cuts, nicks, flat spots and sharp edges.)

<Figure 4.11.1>



2. Push the tubing firmly into each fitting on the manifold until the line is flush with the fitting collar. (If the tubing is removed, re-cut the end, measure, mark and re-insert). Tubing must be fully inserted to avoid leaks (To remove tubing, depress and hold white collet; pull tubing out to remove.)
4. Pull out slightly on tubing to ensure a good seal. Do not pull too hard or it may damage related parts.
5. Install the other end of the tubing from the inlet side of the manifold to the feed water adapter.

6. Insert plastic tab to ensure quick connect fitting cannot come as done.

<Figure 4.11.2-4>

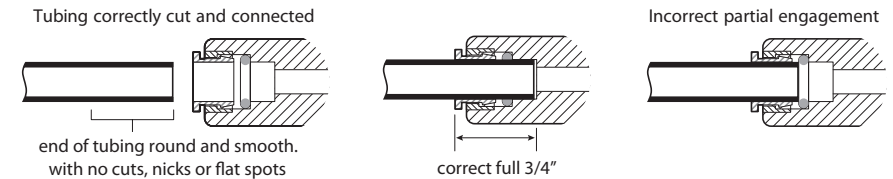

To Disconnect Tubing :

1. Remove plastic tab from fitting
2. Push the collet inward and hold with a finger while pulling the tubing out. Make sure the collet is pushed evenly on all sides. If only one side is pushed the tubing will not be able to be removed.

<Figure 4.11.5>

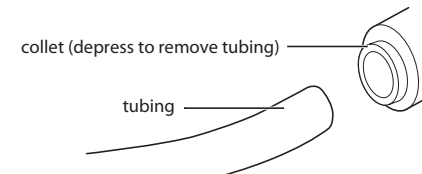

### 4.12 Connect Water Lines

**IMPORTANT:** Remove plastic plugs from water line inserts.

To connect the water lines, begin by taking the plastic supply line from the angle stop or saddle valve and firmly connect it to the left most quick connect on the top of the Fintel system labeled "In". Push the water line in completely and gently pull back out until it stops. Then insert a blue locking clip to secure it.

Take the second feed line and repeat the process with the middle quick connect labeled "Out".

Leave the auxiliary cap in if you're not using it to supply another faucet or appliance.

Take the free end of the second "Out" feed line and firmly attach it to the quick connect at the base of the drinking faucet stem. Assure it's properly connected like before and attach a blue locking clip



### 4.13 Attaching the Diverter Valve

1. Unscrew to remove the aerator(wire screen) and washer from the end of faucet.

&lt;Figure 4.13.1&gt;

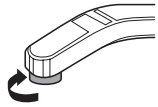

&lt;Figure 4.13.2&gt;

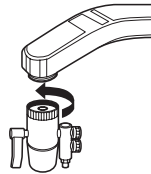

2. Position the Diverter Valve onto the faucet and hand tighten the textured collar counterclockwise until secure.

### Attaching the Tubing to the Diverter

1. Unscrew to remove the textured nuts.
2. With the threads facing out, push the nuts onto the tubes.

&lt;Figure 4.13.3-5&gt;

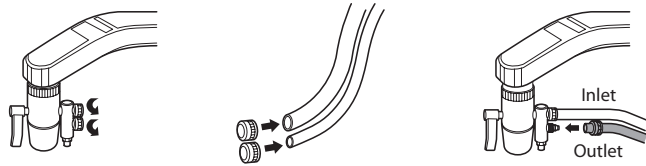

3. Firmly push the tubes onto the barbs.
4. Screw the nuts onto the barbs and hand tighten.
5. Use the Tie Straps to secure the tubing to the faucet.

&lt;Figure 4.13.6&gt;

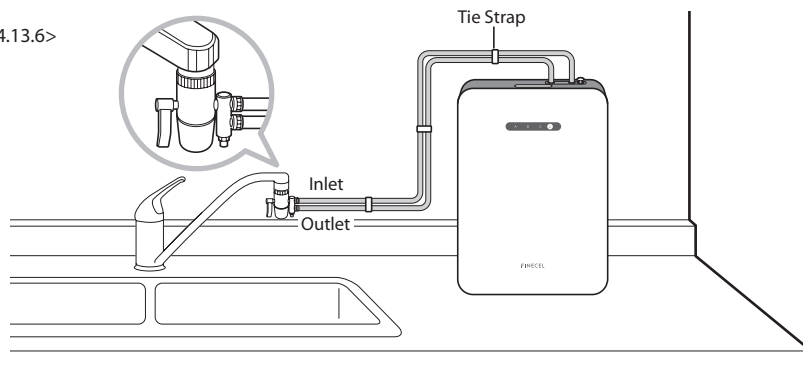

#### NOTE

Do not run hot water through system damage to filters will occur.

You are now ready to turn the water main back on. As the system fills, check for leaks and make sure that everything is connected properly.

Run the water to flush the system for about 2 minutes. You may notice some carbon dust in the water initially. This is normal and harmless. After flushing the system you should be able to check for clarity of the water in a clear glass

Your Fincel drinking water system from Winix is now ready for use;providing you and your family with clean, healthy and great tasting drinking water.

## 5.0 FILTER CARTRIDGE

### 5.1 Carbon Filter Cartridge Life

Taste and Odor, and Microbiological Purifying Cartridges: Taste and odor, and microbiological cartridges contain activated carbon. When new, a small amount of harmless carbon particles may be present in the filtered water. Open the faucet and flush for 2 minutes. It is recommended to replace carbon filter cartridges every six months or 400 gallons of use. There are several variables that determine how long a cartridge will last. These include:

1. How much water you use, and
2. How much sediment, taste and/or odor, or other unwanted substance, is in the water.

Use the following information as a guide. However, no matter which type of cartridge you are using, you will know it is time to replace them when you first notice the return of the unwanted sediment, taste and/or odor in your water, or when the flow diminishes or stops.

WINIX Water Filtration System model FCSPU1 with replacement filters SPCF1 and SPUF1 conforms to NSF/ANSI 42 and 53 for the specific performance claims as verified and substantiated by test data. The rated capacity for this system is 400 gallons (1513 liters) at a rated service flow of 0.5 gallons per minute.

### 5.2 UF Cartridge Life

The rated capacity for the UF Filter Cartridge is 1200 gallons or 18 months at a rated flow of 0.5 gallons per minute. This filter is responsible for a filtration process that removes: microbiological pollutants, heavy metals, and many other pollutants.

**IMPORTANT:** The UF Filter Cartridge must be operate when water is between 33° and 100° F.

**WARNING:** The UF Filter Cartridge will be damaged if frozen. The UF Filter Cartridge must be kept above temperatures of 32°F (0°C). Failure to do so may cause the UF Filter Cartridge to dry, freeze, become damaged, and will void all warranties. Operating a damaged system may lead to personal injury and/or physical harm.

### 5.3 Filter Cartridge Replacement

1. Turn filter cartridge to left (clockwise) until “Insert” arrow aligns with the arrow on the system manifold. Pull straight down to remove filter.\*
2. Dispose of filter cartridge properly.
3. Install new cartridge by aligning “Insert” arrow with the arrow on the manifold. Turn filter to right (counter clockwise) until “Lock” arrow is aligned with the arrow on the manifold.
4. Turn water and system faucet on to check for leaks. If leaking occurs, reinstall filter and check for proper arrow alignment.
5. Flush filter unit for at least 2 minutes prior to use.

\* Turn water off at plumbing connection first. While not necessary, it can reduce potential leaking

<Figure 5.3.1>

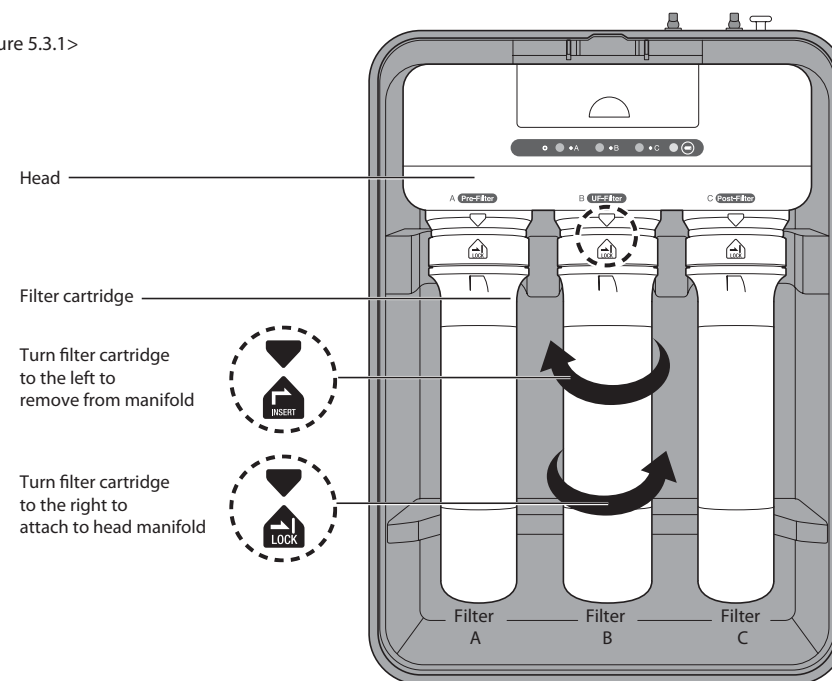

## 6.0 REPLACEMENT INDICATOR

### 6.1 FCSPU1 Indicator

The FINECEL Water Filtration System is equipped with a replacement indicator that measures both total flow of water AND the length of time each filter has been in use. There will be both a visual and audible signal to alert you to when each filter's life has been reached and when the total system is nearing the recommended capacity of 400 gallons for carbon filters and 1200 gallons for UF filter.

<Figure 6.1.1>

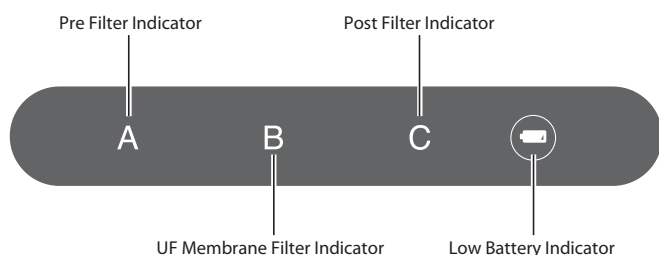

#### Pre Filter/ Post Filter Indicator

It is recommended to replace pre filter and post filter cartridges at least every 6 months of product water use. When the timer reaches 6 months, the LED indicator will turn on under A and C on readout and the unit will beep intermittently. Indicator will be automatically reset after replacing filter.

#### UF Membrane Filter Indicator

It is recommended to replace Ultra Filtration Membrane filter cartridge at least every 18 months of product water use. When the timer reaches 18 months, the LED indicator will turn on under B on the readout and the unit will beep intermittently. Indicator will be automatically reset after replacing filter.

### Battery Indicator

When the timer reaches approximately 18 months of use, it will flash. At this time it is recommended to replace battery. When the batteries are installed for the first time, the indicator display will beep and flash all indicator lights to ensure the user they are functioning correctly.

To change the battery, complete the following steps.

1. Push the "Open" button top of the filter case.
2. Press and slide open battery cover in red circle (shown below).
3. Insert batteries with proper positive(+) and negative(-) alignment.
4. Close the cover.
5. Push the reset button "B" to reinitialize indicator.  
(you can see the small hole around "B", push it with fine wire for 3 seconds)

<Figure 6.1.2>

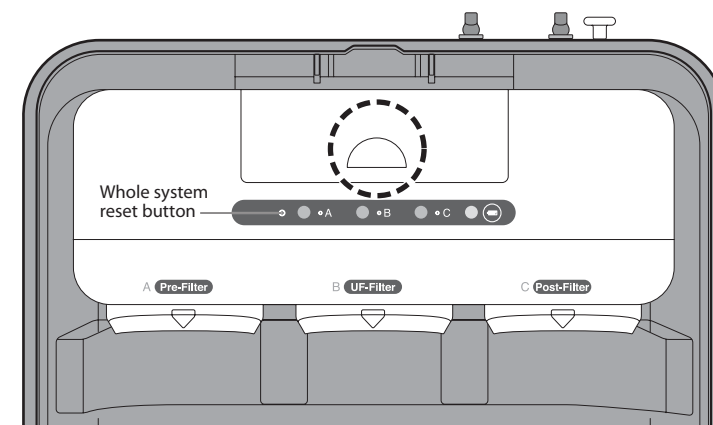

#### NOTE

If filters are replaced before the indicator light is activated, you must manually reset the filter indicator lights. To do this insert a paperclip into the hole next to the corresponding filter letter.

The large hole located to the far left of the indicator display is a full system reset. This hole will be used if all three filters are changed before their indicator lights are active. This allows for the user to reset all sensors simultaneously.

## 7.0 TROUBLESHOOTING

### Problem: Chlorine taste and/or odor in the filtered water.

Cause: The level of chlorine in your water supply exceeds maximum limits, and has destroyed the Ultra Filtration membrane.

Correction: If the water supply contains more than 2.0 ppm of chlorine, additional filtering of the water supply to the UF is needed. Correct this condition before doing maintenance on the Ultra Filtration system.

Cause: The pre filter is no longer reducing chlorine from the water supply.

Correction: Replace the pre filter, post filter and Ultra Filtration membrane cartridges.

### Problem: No water or decreased water flow.

Cause: Pre-Filter A is clogged.

Correction: Replace Pre-Filter A.

Cause: Flow through the microbiological purifying filter will decrease and eventually clog when exposed to an excess of microbiological loading materials in the water.

This failsafe feature reduces the chance of product use beyond its intended life, and will shut down the filter when it is exposed to contaminated water.

Correction: Replace all filter cartridges.

### Problem: Taste and/or Odor.

Cause: Filter cartridges exhausted.

Correction: Replace all filter cartridges.

Cause: System contaminated.

Correction: Sanitize system. Call location of purchase for instructions.

### Problem: FCSPU1 LED indicator light does not function after battery change.

Cause: Battery dead.

Correction: Replace with new battery.

Cause: Battery installed incorrectly.

Correction: Install battery correctly.

### Problem: Water leaks at push connect fittings.

Cause: Tubing not pushed in all the way.

Correction: Push tubing in all the way into fittings.

Cause: Tubing not cut square.

Correction: Cut tubing square.

Cause: Tubing nicked.

Correction: Remove nicked portion, reinsert tubing into fitting.

Cause: Outer tubing surface not smooth.

Correction: Remove rough portion, reinsert tubing into fitting.

### Problem: Tubing does not connect to water filtration system.

Cause: Black plugs are still connected to the unit.

Correction: Remove black plugs and insert tubing into fitting.