



**BOSCH**

---

# **IS76 Beacon with Ferrite Antenna**

## **Installation Manual**



Document No 953.26a  
IS76 Beacon with Ferrite Antenna: Installation Manual  
Edition: July 2009  
Editor: TeleAlarm SA  
All rights reserved.

TeleAlarm SA reserves the right to make changes to the information contained in this document at any time without prior notice. Great care has been given to the contents of this document; however TeleAlarm SA cannot be held liable for the consequences of any errors or omissions contained herein or for consequential or incidental damages incurred as a result of acting on information contained in the document.

**TeleAlarm SA Bosch Group**

Administration, R&D and Aftersale  
Rue du Pont 23  
CH-2300 la Chaux-de-Fonds  
Switzerland  
Phone +41 (0)32 911 11 11  
Fax +41 (0)32 911 11 00  
[www.telealarm.com](http://www.telealarm.com)

**Bosch Sicherheitssysteme GmbH**

**Haus-ServiceRuf**

Ingersheimer Straße 16  
D-70499 Stuttgart  
Germany  
Phone 0711 3653 1000  
Fax 0711 811 5125 294  
[Haus-Service.Ruf@de.bosch.com](mailto:Haus-Service.Ruf@de.bosch.com)  
[www.bosch-sicherheitsprodukte.de](http://www.bosch-sicherheitsprodukte.de)

**Bosch Security Systems Ltd**

Broadwater Park  
North Orbital Road  
Denham  
UB9 5HN  
United Kingdom  
Phone 01895-878088  
Fax 01895-878089  
[uk.securitysystems@bosch.com](mailto:uk.securitysystems@bosch.com)  
[www.boschsecurity.co.uk](http://www.boschsecurity.co.uk)

**Bosch Security Systems France**

Atlantic 361  
361, avenue du Général de Gaulle  
F-92147 Clamart  
France  
Phone + 33 (0)825 12 8000 (0,15 € TTC/Min)  
Fax + 33 (0)820 900 960 (0,12 € TTC/Min)  
[fr.securitysystems@bosch.com](mailto:fr.securitysystems@bosch.com)  
[www.boschsecurity.fr](http://www.boschsecurity.fr)

**Bosch Security Systems BV**

Postbus 80002  
NL-5600 JB Eindhoven  
Netherlands  
Phone +31 40 25 77 200  
Fax +31 40 25 77 202  
[nl.securitysystems@bosch.com](mailto:nl.securitysystems@bosch.com)  
[www.boschsecurity.nl](http://www.boschsecurity.nl)

**Bosch Security Systems nv/sa**

Torkonjestraat 21F  
B-8510 Marke  
Belgium  
Phone +32 (0)56 20 02 40  
Fax +32 (0)56 20 26 75  
[be.securitysystems@bosch.com](mailto:be.securitysystems@bosch.com)  
[www.boschsecurity.be](http://www.boschsecurity.be)

**Bosch Security Systems AB**

Vestagatan 2  
SE-416 64 Göteborg  
Sweden  
Phone +46 (0)31 722 5300  
Fax +46 (0)31 722 5340  
[se.securitysystems@bosch.com](mailto:se.securitysystems@bosch.com)  
[www.boschsecurity.se](http://www.boschsecurity.se)



## Content

Locator Function.....	4
IS76 Beacon with Ferrite Antenna.....	4
IS76 Ferrite Antenna .....	4
IS76 Ferrite Beacon Controller .....	5
System Supervision .....	5
Features of the IS76 Beacon System.....	5
IS76 Ferrite Antenna .....	6
IS76 Beacon Controller .....	6
Connection Compartment .....	7
Enable Locator Function in NurseCall System .....	7
Configuration and Wiring .....	8
Ferrite Beacon Antenna .....	9
Ferrite Beacon Controller .....	9



## Locator Function

The NurseCall system can be set to handle a Locator function. For this purpose, beacon modules and antennas of type IS75 or IS76 need to be installed on doors or corridors in the building you want to supervise. When passing one of these modules the Wristband Transmitters of type S37L or the Pendant Transmitters of type S35L refresh the position information that is stored into them. When triggering an Alarm, the transmitters S37L and S35L do not only transmit the identification (who sent the alarm), but also the position of the last passed module (where has the alarm been triggered).

At the arrival of a call, the information of the actual position is indicated additionally on the NurseCall units. This information can be made visible by pressing the yellow button on the NurseCall Main- or Relay Unit.

“Locator” information block:

HELP	A03
POS: 077	

255 positions (POS: 000 - 254) can be differentiated. When passing beacon modules with position numbers 231 - 254 the transmitters S37L and S35L can send a call for help automatically without manual activation (wandering). Fixed transmitters that do not handle a Locator function (N46) are always indicated with the position 000.

## IS76 Beacon with Ferrite Antenna

The IS76 Beacon system consists of two elements:

- The IS76 Ferrite Antenna
- The IS76 Ferrite Beacon Controller

### IS76 Ferrite Antenna

The IS76 Ferrite antenna has to be mounted on the place that has to be identified with a location beacon code. The antenna is well suited to be mounted in a vertical position on (or next to) a door frame. In some circumstances it may also be mounted horizontally. The IS76 Ferrite Antenna can be placed outdoors as well as indoors.

### IS76 Ferrite Beacon Controller

The IS76 Ferrite Beacon Controller is necessary to drive the IS76 Ferrite Antenna. It connects to the mains power via an external power supply. Up to two IS76 Ferrite Antennas may be connected to the IS76 Beacon Controller, depending on the size of the passage that has to be covered with the beacon. The beacon location code is set-up on the IS76 Ferrite Beacon Controller. Contrary to the ferrite antenna, the IS76 Ferrite Beacon Controller has to be mounted indoors, in a well ventilated cool place.

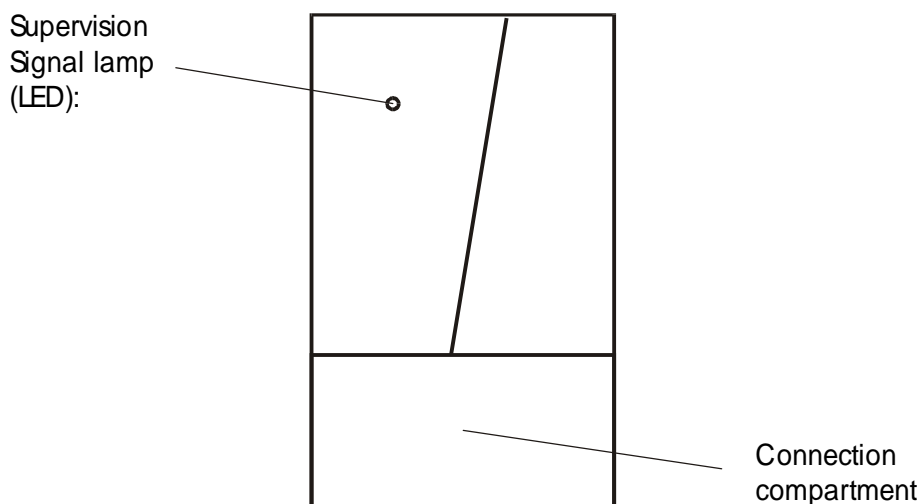

**Figure 1**

### System Supervision

The operation of the IS76 Beacon system is supervised. An eventual operation failure (broken wire or overload) is indicated by the front panel LED and by the opening of a "normally closed" relay contact that is accessible from the terminal block. The supervision output may be connected to an RAC-type alarm transmitter which would transmit the beacon operation failure to the NurseCall System.

### Features of the IS76 Beacon System

- Ferrite antenna offers a better defined capture range that is less dependent on the surrounding building material
- The antenna may be installed in or outdoors
- Up to 230 user selectable position (location) codes (001 to 230)
- Up to 24 user selectable "Wandering" codes (231 to 254)
- Supervision of the beacon functionality

### IS76 Ferrite Antenna

The Antenna is best fitted to be mounted vertically on a door's frame. In any case, the middle of the antenna should be at a height of 1 meter from the floor. The antenna has to be fixed by two screws, according to the figure below.

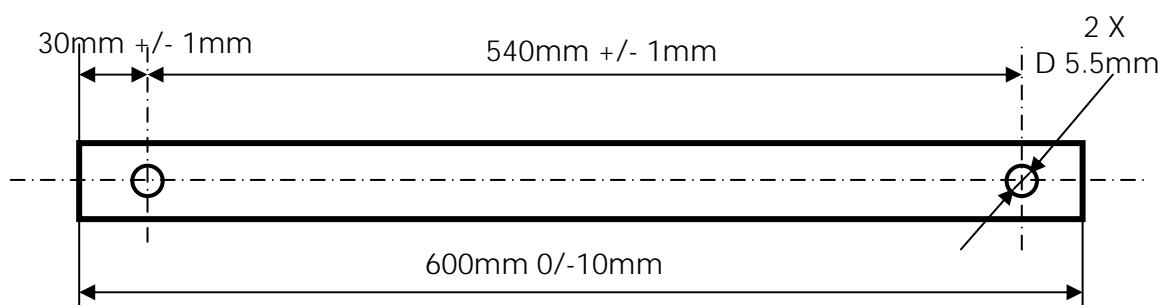

**Figure 2**

- Remove the cover caps at both ends of the antenna by sliding them against the outside
- Secure the antenna against the wall with both screws
- Replace the cover caps by sliding them over the housing

**Note:**

**Even if the functionality of the Ferrite Beacon System is not affected by the presence of metallic items, it is not recommended to fix the antenna directly against such items. In order to avoid overheating of the IS76 Beacon Controller, install the antenna at least 1.5 cm away from metallic frames or surfaces.**

### IS76 Beacon Controller

The IS76 Beacon Controller can be fixed with two to five screws on the wall. Two holes at 60 mm interval are provided for direct mounting on connection boxes.

The three upper holes are used for positioning the device and cannot be reached from the Connection Compartment.

Two of the lower holes can be reached from outside and thus used for fixing the device.

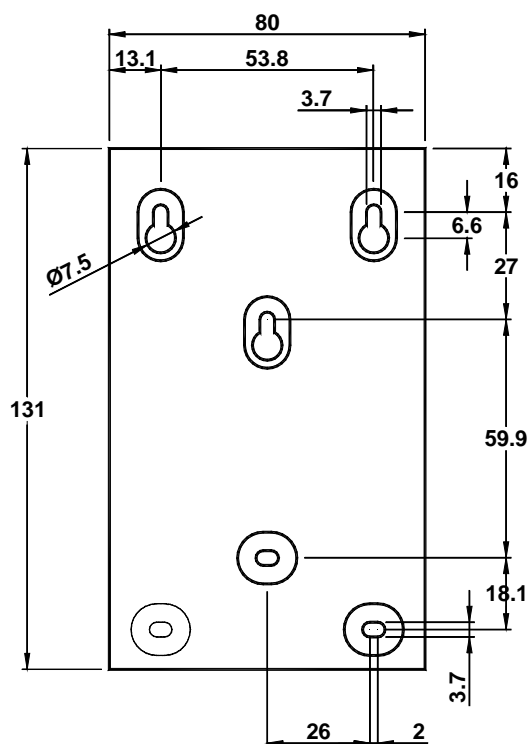

**Figure 3**

**Important Note:**

**In order to ensure proper cooling of the Beacon Controller, the unit needs to be installed vertically in a well ventilated place (avoid to mount it in sealed boxes).**

**Connection Compartment**

All of the wiring and configuration functions such as:

- Connection of the IS76 Ferrite Antenna(s)
- Connection of the wired supervision output
- Setting of the Location identification code

Can be carried out in the connection compartment. It is reached by taking off the lower part of the housing (see). This can be done even if the device is fixed on the wall.

The connection cables can be channelled towards the outside through the hole next to the terminal blocks or downwards by breaking off part of the rear housing.

Connection of the power supply can be done without taking off the lower part of the housing.

**Enable Locator Function in NurseCall System**

In order to be operational, the Locator function has to be enabled in the NurseCall Main Unit (refer to section "Selection Locate Function YES or No" in the NurseCall User Manual)

## Configuration and Wiring

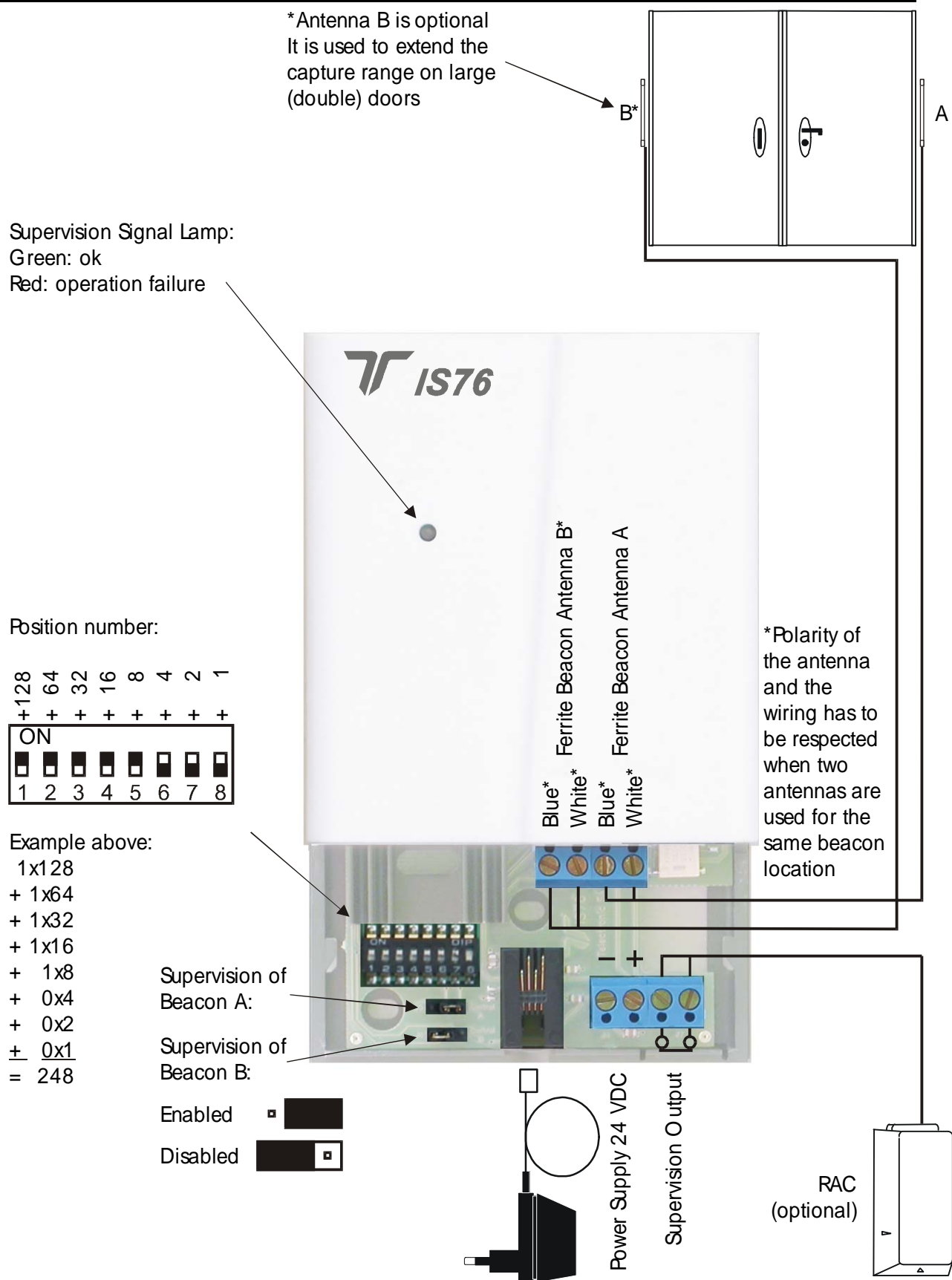





## Ferrite Beacon Antenna

### Housing

Plastic case ASA for wall mounting

- L x H x P 600 x 30 x 30 mm
- Weight about 700 g

### Connecting cable

- 2 m "twisted pair"
- (may be extended up to 10 m)

### Operation Range<sup>1</sup>

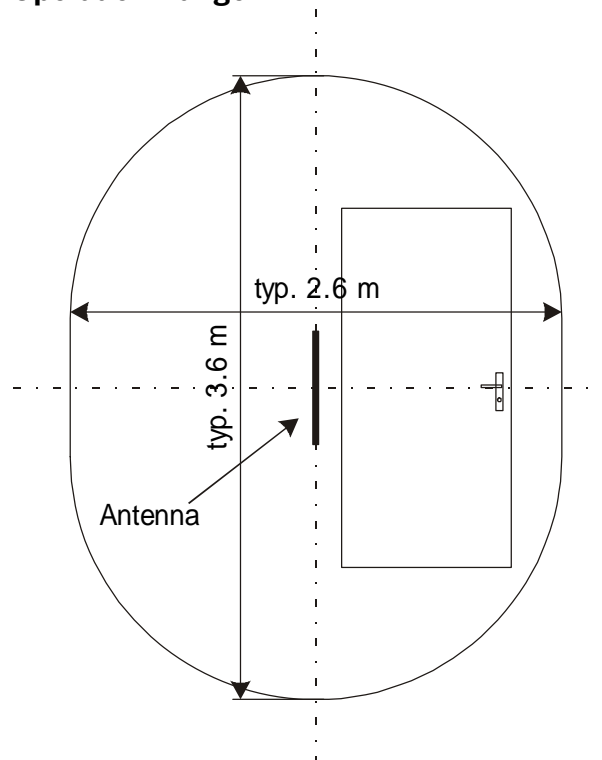

<sup>1</sup> When used in conjunction with S37L Wristband Transmitters of REV B and higher.

## Ferrite Beacon Controller

### Housing

Plastic case ASA

For wall mounting (L x H x P)

Weight

133 x 82 x 26 mm

about 200 g

AC Power supply (included)

100 – 240 VAC

DC Power supply

22 - 24 VDC / max. 400 mA (1 antenna)  
Max. 800 mA (2 antennas)

Frequency

68 kHz

### Supervision Output Relay

Max. Switching power

125 VA / 60 W

Max. Switching voltage

48 V DC

Max. switching current

2 A

Technical data is subject to changes.