



FORBES
INTELLIGENCE

Vacuum Cleaner - A healthy home made easy.

USER MANUAL

Healthier is Happier



CONTENTS

English

Know your Forbes Intelligence	2
Using your Forbes Intelligence	3-8
Safety Instructions	9
Warranty	10



Dear Customer,

We congratulate you for choosing Forbes Intelligence™ the first-class cleaning system. Before operating the unit please read this instruction manual carefully through and keep it for future reference.



KNOW YOUR FORBES INTELLIGENCE



- A** Hose connector with shutter
- B** Front lid
- C** Handle
- D** Side parking position
- E** LCD display
- F** Mode buttons
- G** Blow port
- H** Cable
- I** Cable winder foot pedal
- J** ON/OFF foot pedal
- K** Aroma compartment
- L** Electric hose
- M** Hose control handle
- N** Telescopic tube
- O** Autocombination floor nozzle
- P** Small combination nozzle
- Q** Radiator brush
- R** Crevice nozzle



USING YOUR FORBES INTELLIGENCE

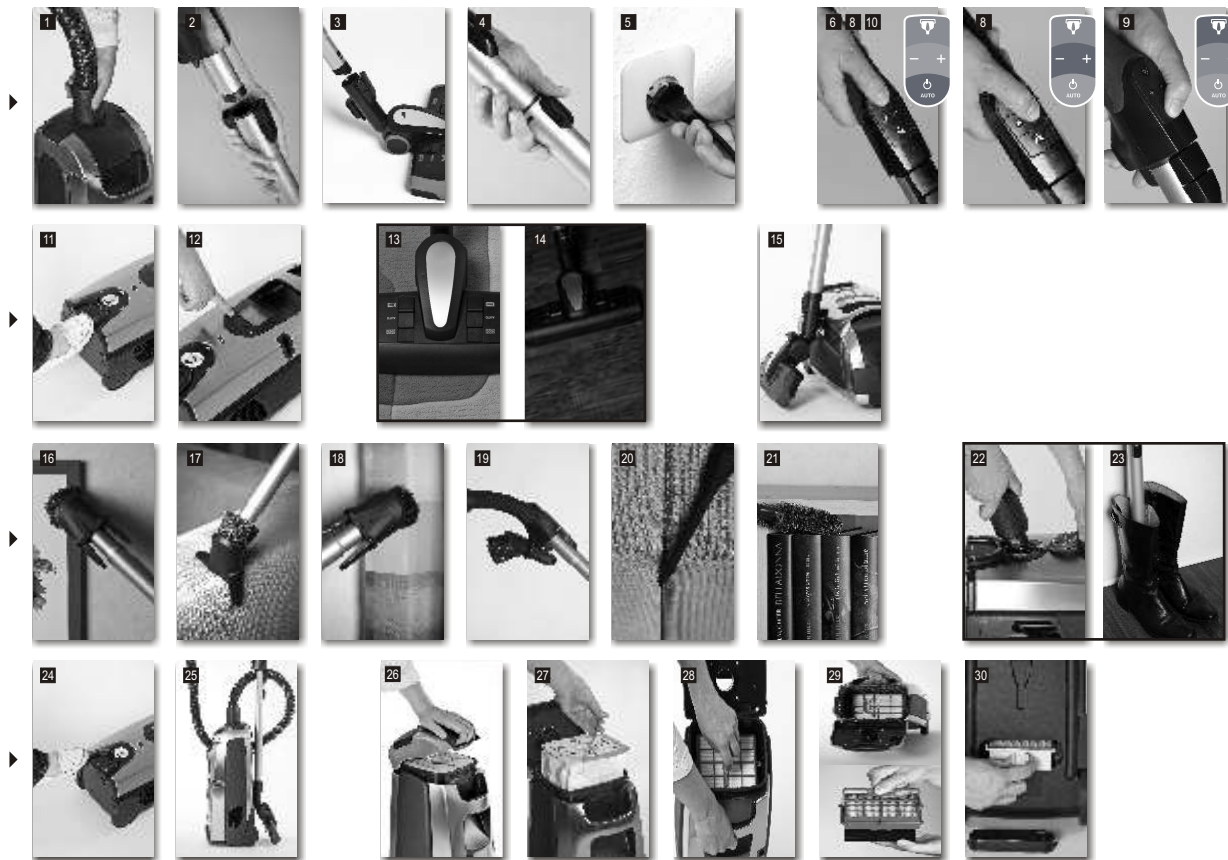



USING YOUR FORBES INTELLIGENCE

Assembly

(1) Open the shutter and push the hose in the canister opening. (2) Connect the hose handle to the telescopic tube. (3) Connect the telescopic tube to the Autocombination floor nozzle. (4) To extend the length of the telescopic tube slide the lock down. To reduce the extension, slide the lock up. (5) Pull out the cable and connect it to the mains.

Operation



From the handle

(6) To start the vacuum cleaner press on the ϕ /AUTO button. The unit will start in the Intelligent Power Control (IPC) mode. (7) To manually increase or decrease the power level, press on the + or – button. (8) To return to the Intelligent Power Control mode from the Manual mode press once on the ϕ /AUTO button. (9) Press on the “brush” button to turn ON/OFF the power brush (optional accessories). (10) In the Intelligent Power Control mode press once on the ϕ /AUTO button to turn off the vacuum cleaner.

From the unit

(11) To start the unit press on the ON/OFF foot pedal. The unit will start in Intelligent Power Control mode. To switch off the vacuum cleaner press on the ϕ foot pedal. (12) To change to the manual mode press on the +/- buttons. (13) You can manually set the carpet function by switching the button towards the back as indicated on the brush. (14) You can manually set the hard floor function by switching the button towards the front as indicated on the brush. (15) For short breaks insert the nozzle in the side parking position. The motor will then stop running. If the break is longer then 5 minutes the Forbes Intelligence™ will turn off automatically for safety reason.



USING YOUR FORBES INTELLIGENCE

Accessories

(16) Use the small combination nozzle on the brush side for dusting. (17) Use the combination nozzle on the wing side to vacuum upholstery. (18) When vacuuming curtains reduce the vacuum power manually. (19) The small combination nozzle can always be kept at hand by placing it on the handle support. (20) Use the crevice nozzle when vacuuming narrow spaces such as corners and grooves. (21) Place the radiator brush on the crevice nozzle.

Blowing function

(22) Open the lid and push the hose into the blow port connection. Use the buttons on the cleaner, since the handle buttons are not working. (23) Use the blowing function to dry shoes, or connected to a spray bottle (optional).

After the use

(24) Switch off the vacuum cleaner, unplug the cable and press on the cable winder foot pedal to wind it. (25) Always store your Forbes Intelligence™ cleaner as indicated in the picture in a dry cool space.



USING YOUR FORBES INTELLIGENCE

Technical Data

Double insulation

CE conforms to the EU directive for CE certification.

Safety approved according to IEC335-1 and 335-2-2.

Dimension 57.5 x 25 x 23.5 cm

Weight 6.7 kg

Max power consumption 1250 W

Max motor power consumption 1200 W

Voltage 230/50 V/Hz

Noise level vacuum cleaner 65 dBA

Operating radius 12.5 m

Forbes Intelligence is recommended by the German Allergy and Asthma Federation DAAB as a result of scientific tests run by the independent institutes TÜV NORD and GUI.

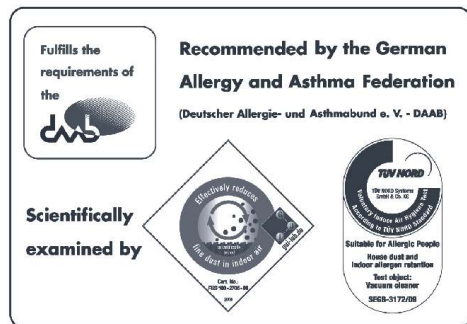



USING YOUR FORBES INTELLIGENCE

LCD Display



Replace the dust bag



HEPA 1

Change HEPA 1 and Carbon filter



HEPA 1

NO HEPA 1 in place

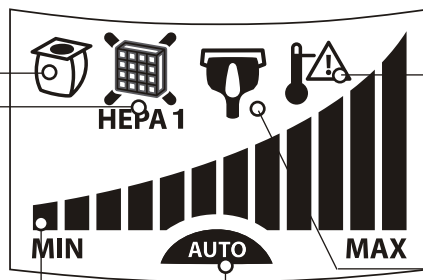

Power indication

AUTO function ON – Intelligent Power Control mode

Motor overheating
cool down for 5 min.
If the symbol appears
again contact the
closest Forbes service.



Power brush ON



Replacement of consumables (Dust bag and filters):

(26) Open the front lid by pressing on the apposite locking button. (27) To change the dust bag, take it out by the handle, dispose it and replace it with a new bag. Change the dust bag. If the dust bag is not in place the lid can not be closed. (28) To change the HEPA 1 H13 and the carbon filter unlock the HEPA 1 H13 filter handle in upright position and pull out the filters. Dispose them. (29) Click the carbon filter in the HEPA 1 H13 filter frame. Make sure that the filters are correctly in place. Lock the HEPA 1 H13 filter handle in position. (30) The long term HEPA 2 filter lasts in regular use some years before it has to be replaced. The warranty is valid only when using ORIGINAL Forbes bags and filters.



USING YOUR FORBES INTELLIGENCE

Forbes **mediclean™** a world revolution in healthy cleaning

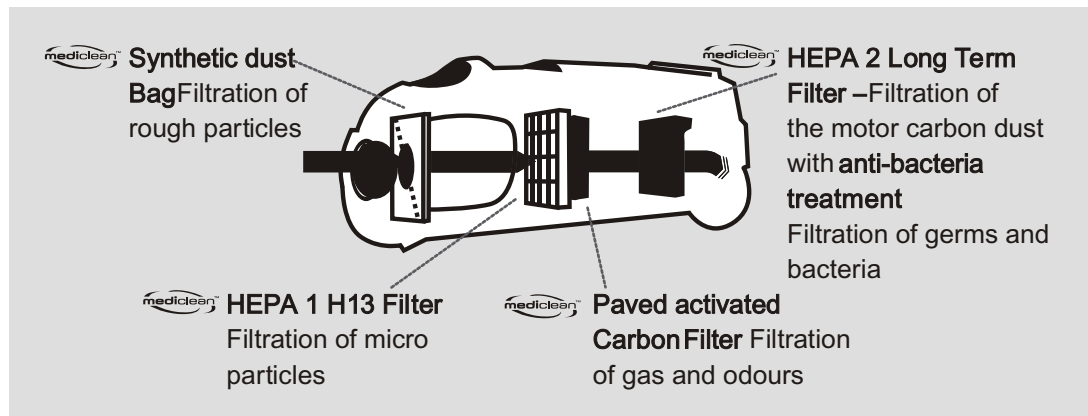

This symbol on the product or on its packaging indicates that this product may not be treated as household waste. Instead it shall be handed over to a Forbes service or collection point for the recycling of electrical and electronic equipment. By ensuring this product is disposed of correctly, you will help prevent potential negative consequences for the environment and human health which could otherwise be caused by inappropriate waste handling this product.



SAFETY INSTRUCTIONS

Please read through the important safety instruction carefully before you use the vacuum cleaner.

- The manufacturer is not liable for any damage caused by improper use.
- Persons who are physically, mentally or because of lack of experience unable to operate the vacuum cleaner safely are not allowed to operate this machine without supervision.
- Never leave small children unattended near the machine.
- Before cleaning the unit or changing the filters always switch off the vacuum cleaner and pull the plug out of the socket. Never pull the plug out by the cable.
- Never leave the vacuum cleaner connected to the mains when not in use.
- Compare the electric contact data on the rating plate with the mains voltage, frequency and maximal ampere, this figures have to comply.
- The mains have to be protected by a 16A or 10A fuse.
- The electric hose contains electrical connections:
 - do not use to vacuum water;
 - do not immerse it in water for cleaning;
- The hose should be checked regularly and must not be used if damaged.
- If the supply cord is damaged, it must be replaced by a Forbes service qualified person in order to avoid any hazard.
- Use the vacuum cleaner only for dry substances. Never use the machine in damp environment.
- Never vacuum people or animals.
- Never vacuum sharp-edged objects.
- Be careful that hair, fingers, clothing and the like never come in contact with the nozzle while the vacuum cleaner is connected to the mains.
- Never vacuum close to smoke, sparks or fire (such as cigarettes, matches, hot ashes), flammable liquids and gasses or explosive materials.
- Aerosols may not be sprayed in or on the vacuum cleaner it could explode.
- Do not use the machine if it is damaged and, if it breaks down. Check the electrical components regularly for defects. Have damaged connection cables, electro-hoses, electrical contacts and electric tubes exchanged immediately.
- Never clean your vacuum cleaner and all its electrical parts, especially the electrical connections, with water or liquid cleaners.
- Only use the socket on the vacuum cleaner for Forbes accessories mentioned in this instruction manual.
- Maintenance and repairs may only be undertaken by authorised Forbes customer service personnel. Use only ORIGINAL Forbes spare parts and accessories.
- Never attempt to modify the electric yourself.



WARRANTY

- The warranty and the extended warranty are only valid when using Forbes ORIGINAL spare parts, accessories and disposables.
- Repairs during the warranty period must be done by authorized Forbes repair people.
- Damage to the motor caused by penetration of water is not covered by the warranty.
- Never use dust bag and filters twice.
- The extended warranty (after the implied warranty) only applies when dust bags and filters are exchanged in reasonable time after indication on the vacuum cleaner with Forbes ORIGINAL consumables.



Produced for Forbes Lux Group, Switzerland

www.forbeslux.com