

NEXTIME

PLEASE READ THIS INSTRUCTION THOROUGHLY BEFORE ASSEMBLING AND OPERATING YOUR CLOCK

OPERATIONS:

- Take the clock out of the box with care, remove the back cover and insert 2 x 1.5V (D size) batteries (not included) into position "1" and 1 x 1.5V (C size) battery into position "2" as shown in drawing A
- Place the external figurine (with magnetic sheet on the base) onto location as shown in drawing B (model 3025 = Juliet; model 3027 = freedom bird)
- Only for model 3025 (Romeo & Juliet) –
 - Take the terrace out of the box with care,
 - Take off the protective sheet on the double sided tape,
 - Insert the terrace to the main housing ensuring the 4 pins on the terrace and holes on the house are fitting each other

To Set Time:

- Use one finger to sweep the minute (long) hand softly and slowly, following clockwise direction until the correct time is set

To Test Hourly Chime and Figurine Movement Function:

- Press the button "3" as shown in drawing A, the clock will perform the relevant sound of the clock (the figurine does not move at this moment); model 3025 (Romeo & Juliet) gives music sound, model 3027 (Freedom) gives bird sound
- During normal operation, there's hourly chime
- Turn the volume button "4" as shown in drawing A to reach desired volume of the hourly chime
- Press the button "5" as shown in drawing A, the figurine moves (the hourly chime does not sound at this moment)
- During normal operation, the figurine moves out of the main housing once every hour, together with the hourly chime

To Turn Off The Hourly Chime and Figurine Movement Function:

- Turn the switch to OFF on button "6" as shown in drawing A, the hourly chime as well as figurine movement function stops until the button "6" is switched back to ON position

Remarks - the clock running operation remains unaffected

Light Sensor Function:

- A built-in light sensor is placed on the lower right corner of the main housing
- During dark or dim light environment, the hourly chime and figurine movement functions will be turned off automatically even if the ON/OFF button is set to ON

Remarks - the clock running operation remains unaffected

CARE AND MAINTENANCE:

- Avoid exposing the clock to direct sunlight or high intensity lighting
- Protect the clock from extreme humidity and temperature changes
- Do not turn the hands (minute/long hand) anti-clockwise otherwise this will damage the clock movement / mechanism
- Take away ALL batteries when clock is not in use
- At time of
 - clock not running on time or
 - the volume of hourly chime turns lower than normal or
 - the figurine does not move

Please change ALL batteries

- It is necessary to sweep away dust once in a while around the area of light sensor as shown in drawing C since dust may accumulate to affect the light sensing function; also please ensure no object blocks the front area of the light sensor

Draw A:

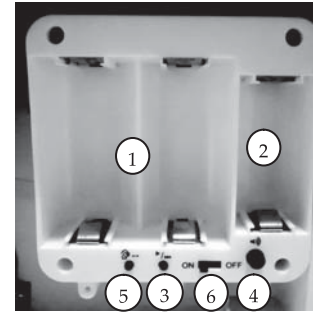

Draw B:

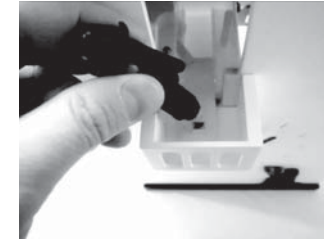

3025

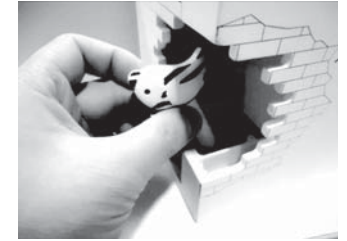

3027

Warranty - EN

Further to your purchase of this NeXtime clock, reading the time will become something special again. Like all NeXtime clocks, this clock was created as an addition to your interior design. With our 40 years of experiences in clock making and our strong team of designers, the Dutch design brand NeXtime ensures much more than just accurate time. You can find the whole NeXtime collection on our website at www.nextime.eu. All NeXtime designs are copyright protected.

For optimum life of your NeXtime clock you should adhere to the instructions in the user's manual. The quality of each and every NeXtime clock and your satisfaction are very important to us. Should you have any questions or remarks regarding this product, you should contact the shop or place of purchase.

ENVIRONMENT: The packaging of this clock can be recycled as used paper. We advise, however, that you save the packaging in case it is needed for shipping the product. Damaged or empty batteries should be returned to a collection point for old batteries. Never treat old batteries as household waste. Contact your local authority for more information on the correct disposal method for this product.

WHAT TO DO IN CASE OF MALFUNCTION: If your clock malfunctions, please first take a look at the user's manual. If the instructions given cannot solve the problem, please contact the shop / dealer where you purchased it.

THE WARRANTY EXPIRES DUE TO: Incorrect use, incorrect connection, leaking and/or wrongly inserted batteries, the use of parts or accessories which are not recommended, neglect, and through defects as a result of moisture, fire, flood, lightning strikes, natural disasters and prolonged exposure to direct sunlight. Unauthorised modifications and/or servicing by third parties. Incorrect transport of the product without adequate packaging and if the product is not accompanied by this Warranty Card and a valid proof of purchase. Connection cables, plugs, and batteries are not covered in this warranty. Every other liability for any consequential losses are excluded.

This NeXtime clock is covered by a 12-month warranty from the date of purchase. The final decision on repairs and/or replacement under warranty is at the discretion of NeXtime or its distributor.

see you NEXTIME

WARRANTY CARD

GARANTIEBEWIJS

GARANTIEKARTE

GARANTIE

TARJETA DE GARANTÍA

擔保證明

保証書

Please keep your proof of purchase here
Bewaar hier uw kassa- of aankoopbon
Heben Sie bitte Ihren Kaufnachweis hier auf
Conservez votre ticket de caisse ou
votre facture comme preuve de votre achat
Adjunte el recibo de compra aquí
請保留您的購買證明
ご購入証明をここに貼り付けてください

.....
Date of purchase / Aankoop datum / Kaufdatum / Date d'achat
Fecha de compra / 購買日期 / 購入年月日

.....
Dealer information / Winkel informatie / Händlerinformation / Lieu d'achat
Información sobre la tienda / 零售商資料 / 販売店情報

.....
Article nr. / Artikel nr. / Artikelnummer
N° du modèle / N° de artículo / 货品号码 / モデルナンバー