

## 1、 Introduction:

### ➤➤ Package Contents

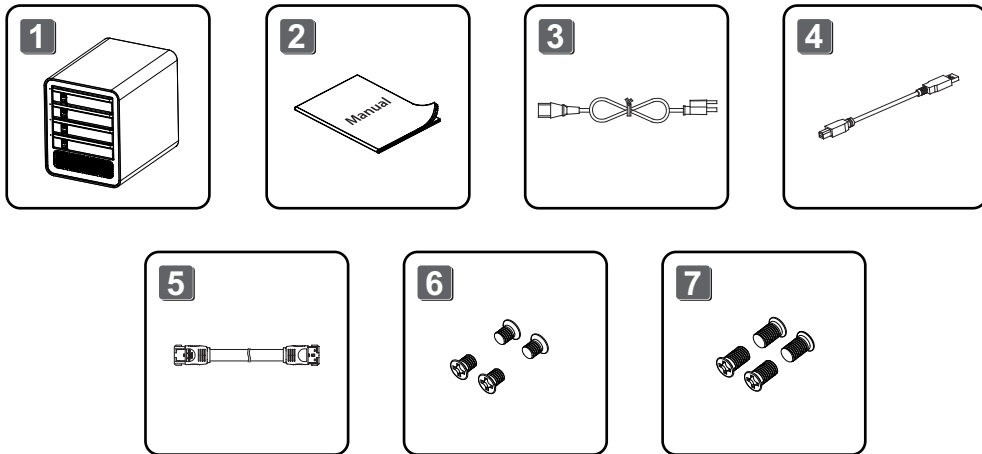

1、 Device with 4 trays	x 1
2、 User manual	x 1
3、 AC power cord	x 1
4、 USB 3.0 cable	x 1
5、 eSATA cable	x 1
6、 M3*4 screws for 2.5" HDD	x 16
7、 #6-32 screws for 3.5" HDD	x 16

### ➤➤ Product Features

- 3 speed fan control, including auto setting featuring Smart Cooling Technology.
- Supports eSATA Hot-Swap function.
- Supports sleep mode & S.M.A.R.T function.
- Plug & Play USB 3.0, no driver needed.
- Fits four 2.5" or 3.5" SATA I/II/III HDD/SSD.
- Power switch button (On/Off).
- Visual LED drive activity.
- Durable aluminum alloy body design.
- HDD stabilizing and shock absorbing EZ-Tray design.
- Easy maintenance, detachable 80mm ball bearing rear cooling fan.
- Rubber padded soles for bottom scratch protection.

## ➤➤ System Requirements

- Support Operating System: Latest version of Windows XP , Windows Vista, Windows 7, Windows 8
- Mac OS X 10.5 (Intel only), 10.6, 10.7, 10.8
- SATA Port Multiplier is required for the eSATA interface

## ➤➤ Product Specifications

Model	MB561U3S-4S / MB561U3S-4SB
Interface	USB 3.0 & eSATA
Support Drive Type	2.5" or 3.5" SATA I/II/III Hard Drive & SSD
Transfer Rate	Up to 5Gbps via USB 3.0
	Up to 480Mbps via USB 2.0
	Up to 6Gbps via eSATA
Power Supply	AC IN: 110V-240V
	DC OUT: 12V/4A (Maximum)
	5V/6A (Maximum)
Cooling Fan	80*80*25mm ball bearing fan

## 2、Device Information:

### ➤➤ Front Panel

- A** Tray eject button
- B** Tray handle
- C** LED indicator
- D** Aluminum Body
- E** Rubber Pad

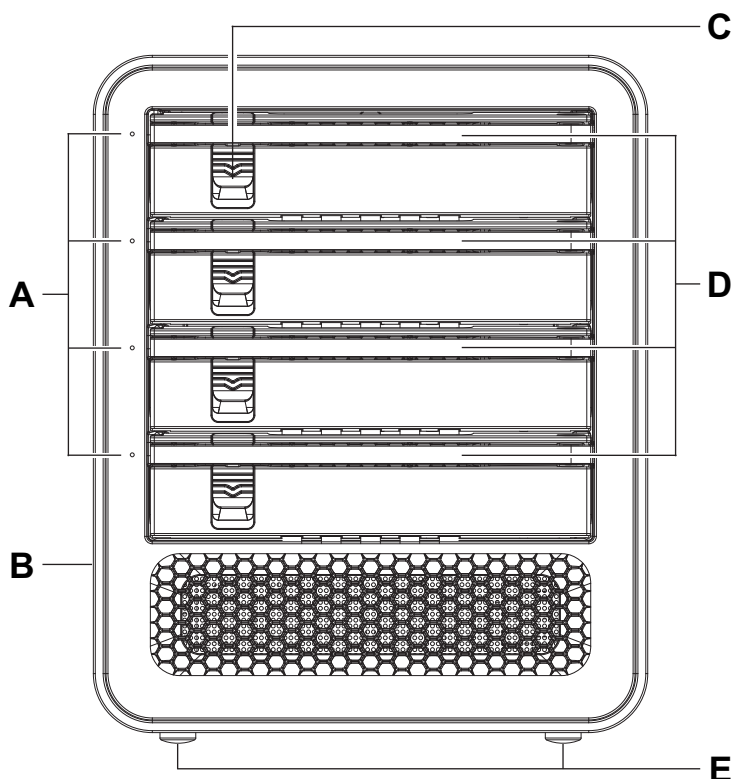

## ➤➤ Indicators

Device Activity	LED Status
Power On (No drive detected)	No light
Power On (Drive detected)	White LED light
Drive Read/Write	Flashing white LED light

**Note:** Due to different hard drive manufacturers' specifications, the LED activity indicators may not be compatible with some hard drives. This will not affect the device's functions, you will be still able to access to the hard drives when there are no LED indications. If there are no LED indications and the drives are not accessible, please contact us for further assistance.

## ➤➤ Rear Panel

- F Detachable cooling fan
- G Safety key lock
- H AC Power port
- I Power switch
- J eSATA port
- K USB 3.0 port
- L Fan speed cont

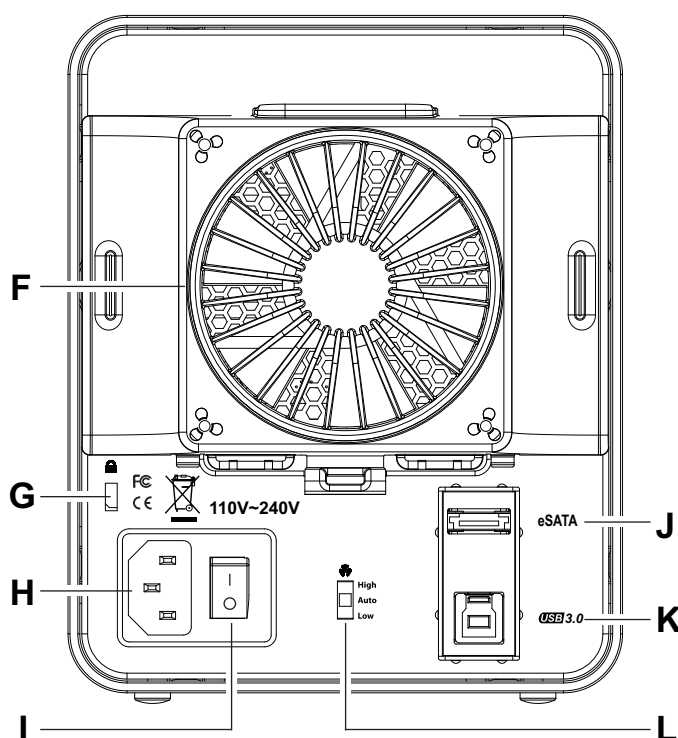

### 3、Installation Guide:

#### ➤➤ HDD/SSD Installation

A. Push down ejection tab to release tray lever.

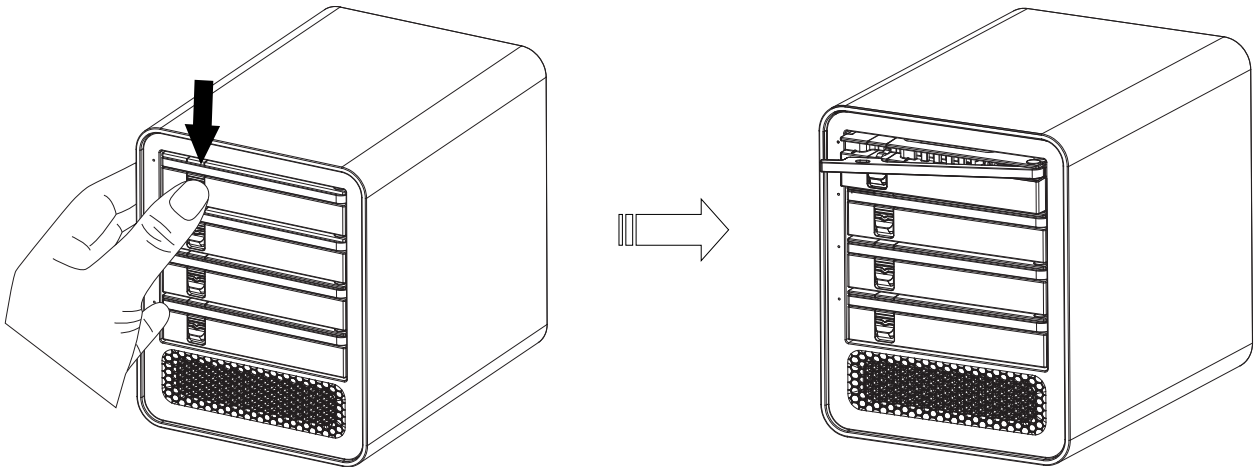

B. Remove the drive tray by pulling on the lever.

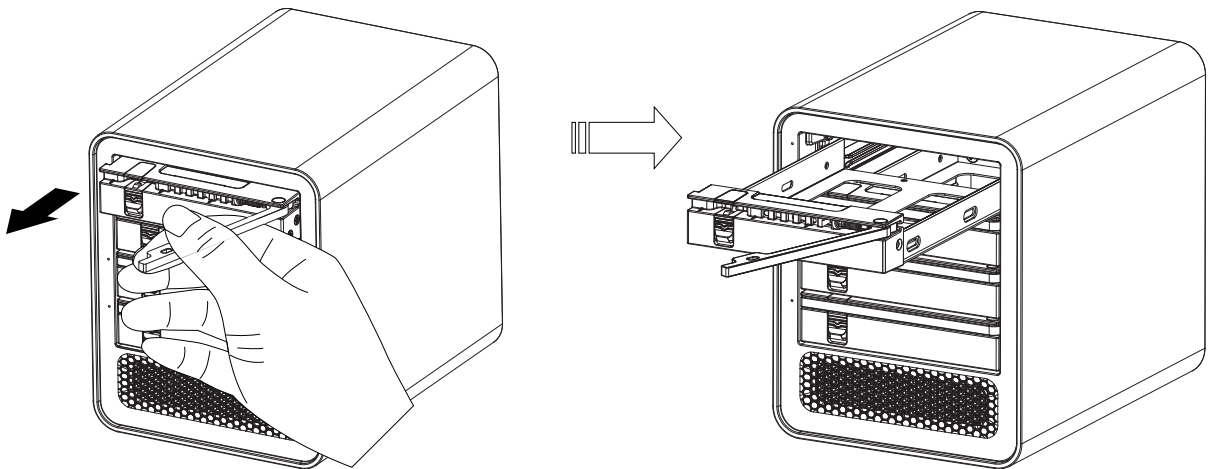

### C. 2.5" & 3.5" Drive Mounting Installation.

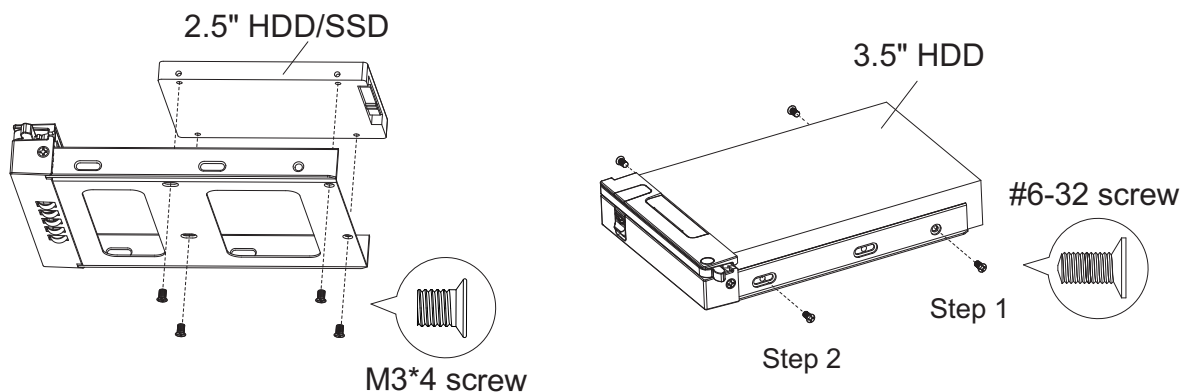

### D. Re-insert the drive tray with the hard drive into the device.

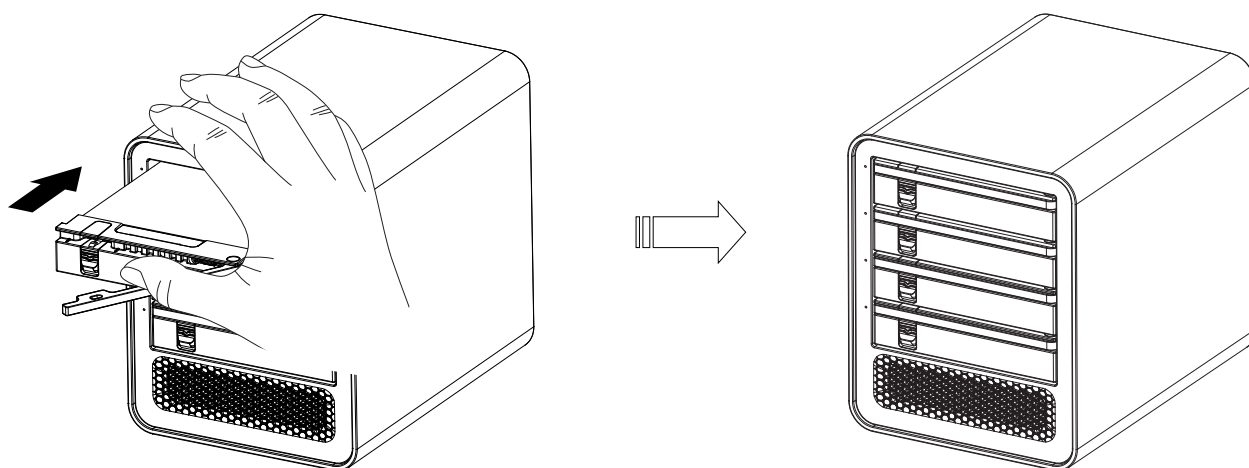

## ➤➤ Cable and Connections

Connect the power cord and USB 3.0 or eSATA to the specified ports on both your system and the unit. Turn on the power switch located at the rear panel of the device.

#### Note:

- USB 3.0 & eSATA cannot be connected at the same time. Connect only one for proper function.
- If your system cannot detect the device or hard drives, please go into device management to search for connected device or hard drives.
- Recommend users to "safely remove the drive in system" before powering off the device.

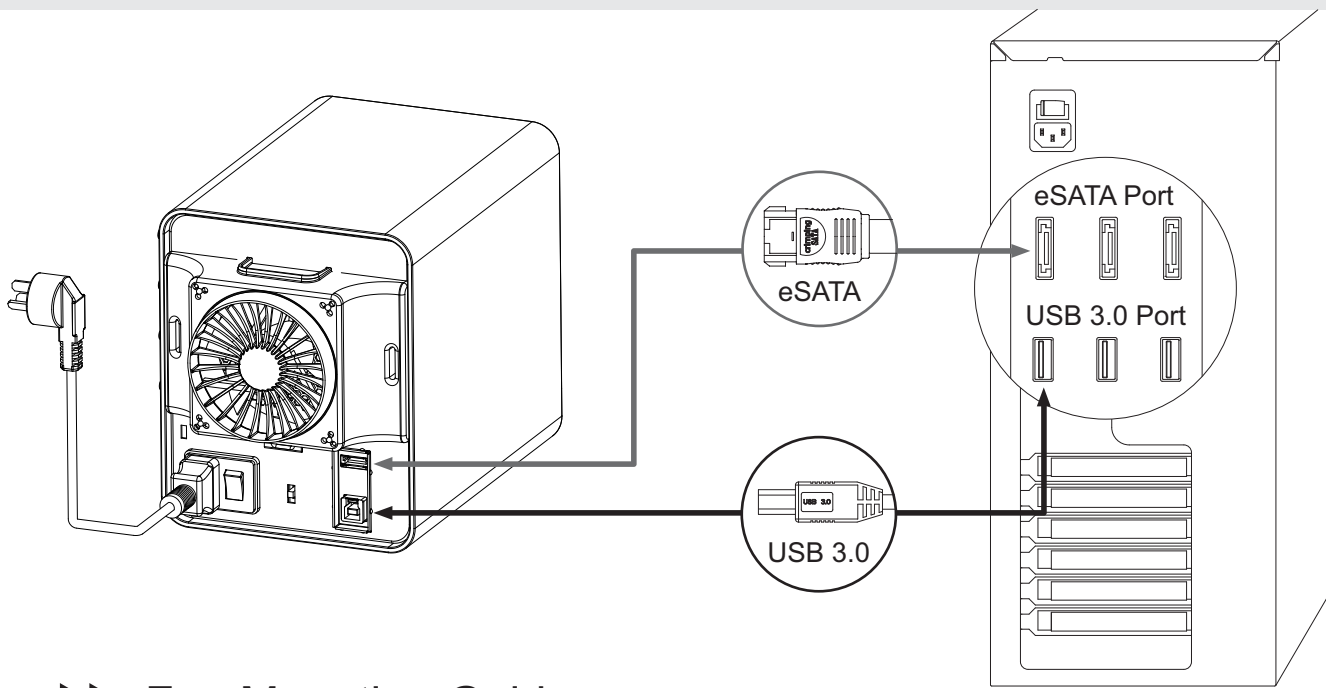

## ➤➤ Fan Mounting Guide

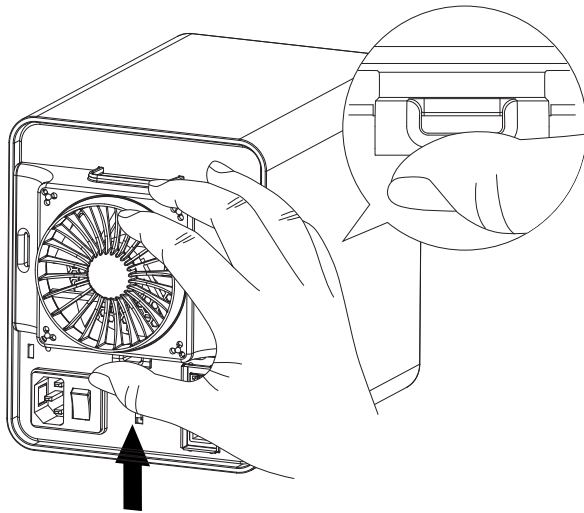

A. Press the tab up located below the fan to detach the fan.

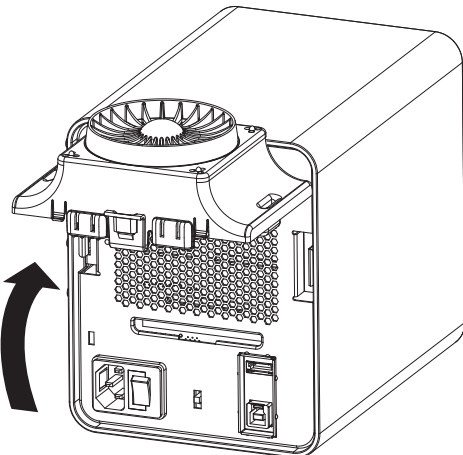

B. Detach the fan by lifting the fan up from the tab.

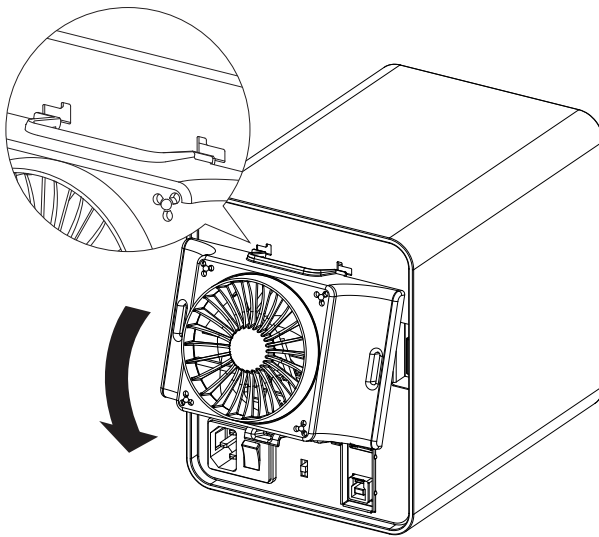

A. Slant the fan and match the hooks to the fan mounting hole.

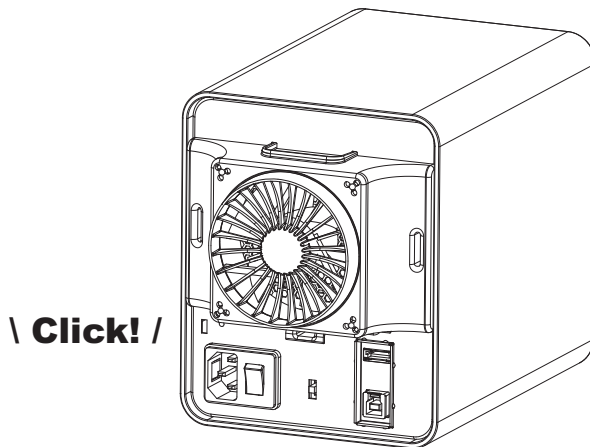

\ **Click!** /

B. Press down the fan until it is seated correctly with a "Click" sound.

## 4、Troubleshooting Topics:

Q: Why does USB 3.0 interface only shows USB 2.0 speed?

A: Please check if it is connected to USB 3.0 port. If the MB561U3S-4S / MB561U3S-4SB is connected to the USB 2.0 port, it will only have USB 2.0 transfer speed. If your system supports USB 3.0, please connect to the USB 3.0 port for higher transfer speed. Transfer speed may depend on the hard drive speed.

Q: Why does the drive shows a smaller capacity than the actual drive capacity?

A: The drive and the computer system calculates the capacity differently. For example, the drive capacity of 1GB = 1000MB, but in the system 1GB = 1024MB. If the drive has a actual capacity of 1.2TB, the system will only show as 1.09TB.

- Q: When using multiple drives through eSATA interface, how come the device is only detecting one drive?
- A: If the host does not support SATA port multiplier function, the computer will not be able to detect all drives simultaneously via single eSATA connection. You may need to purchase an additional eSATA controller card with port multiplier function in order to detect more than one drive. Mac systems do not offer eSATA interface, Mac users will need to purchase an eSATA controller card to use the eSATA interface (Intel Mac Pro only).
- Q: When using USB 3.0 interface, why does removing one drive cause the remaining drive(s) to refresh in the enclosure?
- A: When multiple hard drives share a single USB interface, the USB chipset needs to re-detect the hard drives when any drive(s) are removed from the enclosure. This process will interrupt any working tasks of remaining drives. Please allow all active tasks to complete prior to removing the hard drive(s).
- Q: Why does the my computer not show the HDD or SSD?
- A: New drives may require formatting first, please format the drives before using.
- Q: Does this device support drives with capacity greater than 3TB?
- A: This device supports drives with capacity greater than 3TB. When using Windows, drive capacity more than 3TB will have to use GUID Partition Table (GPT) in order to format 3TB or greater drives. When using 3TB or greater capacity drives, please check if your system supports GUID Partition Table.

## 4-2、 Note :

1. ICY DOCK will only be responsible for the unit repairs and services of ICY DOCK products and will not offer data recovery or backup services. ICY DOCK will not be responsible for any lost or damaged data. It is recommended to backup your data on a regular basis to prevent data lost.
2. ICY DOCK will not be liable for any software, hardware, or data stored within or interfacing with ICY DOCK products which will result in damage or malfunction.
3. ICY DOCK reserves the right to change technical specifications without prior notice. For more information about this product and the manufacture warranty, please visit our website: [www.icydock.com](http://www.icydock.com)