

ROCKVILLE

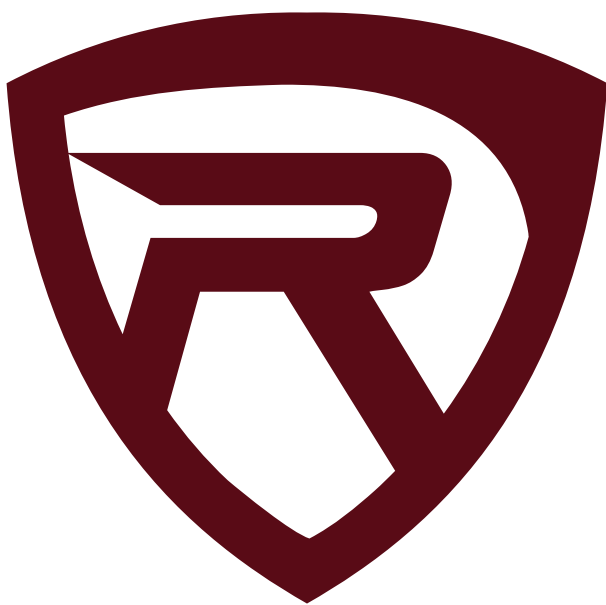

RVD13-FD
RVD15-FD
RVD17-FD

FLIP DOWN ROOF MOUNT TFT LCD MONITOR WITH DVD PLAYER

USER'S MANUAL

ROCKVILLE

Thank you for purchasing this Rockville Flip Down Roof Mounted DVD TFT LCD Monitor.

We are very proud to bring you what we consider to be the absolute best value in mobile audio products. This project has been a culmination of years of development involving a team of dreamers, engineers, designers and marketing gurus. Proudly conceived and developed in the USA, Rockville mobile audio products are designed and engineered by a team of car audio enthusiasts.

We have spared no expense in manufacturing these Flip Down Roof Mounted DVD TFT LCD Monitors to meet the highest quality standards. With proper care and installation this unit will provide you with the highest levels of sound quality. We hope that this unit will bring you years of performance and reliability.

Please read this installation guide carefully for proper use of your Rockville Flip Down Roof Mounted DVD TFT LCD Monitor. Should you need technical assistance during or after your installation please call our technical help line at 1-646-758-0144, Monday through Friday, 9am to 5pm EST.

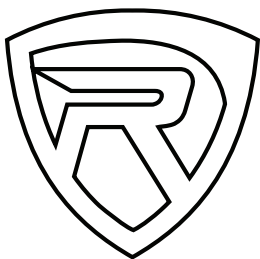

ROCKVILLE

Contents

Powering the Unit	3
User Interface	3
Control Panel	4
Remote	5-6
DVD	7
USB/SD	7
Installation Guide	8
Wiring	9

Precautions

- To minimize the risk of improper installation, Rockville recommends that the installation of this product be performed by an MECP-Certified professional installer.
- Improper installation may cause damage to the vehicle or injury to the driver and occupants.
- Installation must be performed according to this product installation manual. Rockville is not responsible for damages or injuries resulting from installation not performed strictly in accordance with the procedures described in this manual.
- Proper installation of this product may require the use of mounting hardware not included with this product.
- Use only new, unused and properly-sized fasteners to install this product. Do not use previously-installed or worn fasteners.
- No modifications to the product or mounting hardware are permitted.
- This product is designed to be used and viewed by rear seat passengers only. The monitor screen must not be visible to the driver. Viewing by the driver while operating the vehicle will create an unsafe condition.
- Rockville does not recommend connecting hanging wires or cables to auxiliary connectors while the vehicle is in motion.
- This product must not obstruct the driver's rear view when installed or used.
- Rockville disclaims all liability for any property damage or personal injury that may result from improper or unintended installation or use of this product.

Powering the Unit

- Turn the engine key to the “ACC” or “ON” position
- Press and hold the power button for 3 seconds
- The unit will turn on.
- When the engine key is turned to the “OFF” position, the unit will turn off.

Tip: If the unit does not turn on, check to ensure all wires are connected properly. It is strongly suggested you seek out the help of a professional when installing.

Tip: Most functions can be accessed from the control panel, but more in-depth functions can only be performed with the remote.

User Interface

Unit Settings

- Adjust the unit settings for optimal playback.
- Selected items are highlighted in yellow.



Tip: To display content from an external device, use the AV/IN option found on the control panel and remote.

Switch Media Devices

- Press the “USB/SD” button to switch between Disc, SD, and USB devices.

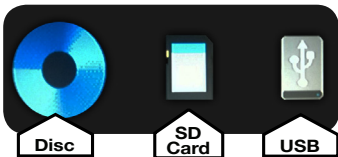

SD/USB Main Menu

- Browse the files stored in the SD or USB device.

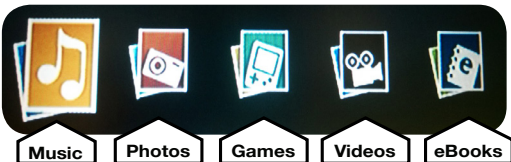

Tip: Refer to DVD and USB/SD sections for a list of playable media formats. pg.7

Control Panel

RVD13-FD
RVD15-FD
RVD17-FD

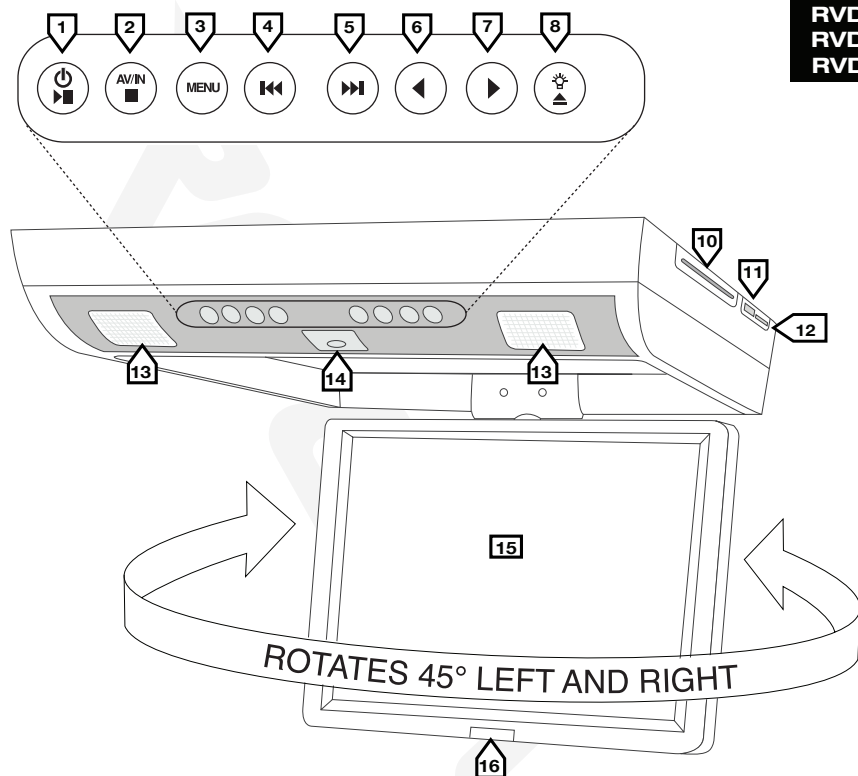

1	Power/Play/Pause	Press and hold for power. Press once to play and pause content.
2	AV IN/Stop	Press and hold to switch to AV IN. Press once to stop content.
3	Menu	Access and adjust the unit settings.
4	Skip Back	Skip to previous song, picture, page, or video.
5	Skip Forward	Skip to next song, picture, page, or video.
6	Move Left	Browse left.
7	Move Right	Browse right.
8	Light/Eject	Press and hold to eject disc. Press once to turn on overhead lights.
10	Disc Drive	Insert DVD or CD to access media content.
11	USB	Insert USB storage device.
12	SD	Insert SD card.
13	Overhead Lights	Super bright LED dome lights.
14	Release	Press to release the screen. (Screen swivels left and right for a better viewing experience).
15	Display	High Resolution TFT/LCD Widescreen display.
16	IR	Point the IR on the remote toward the IR on the unit when using.

RVD13-FD
RVD15-FD
RVD17-FD



Remote

RVD13-FD
RVD15-FD
RVD17-FD

1	Power	Turn unit on and off.
2	TFT Menu	Access unit settings menu.
3	PBC Menu	Setup playback settings.
4	Title	Return to the title screen.
5	Up Arrow	Navigate up when available.
6	Mute	Mute audio.
7	Program	Adjust unit functionality.
8	Right Arrow	Navigate right when available.
9	Enter	Select highlighted item.
10	USB/SD	Switch between USB and SD devices.
11	Down Arrow	Navigate down when available.
12	Volume Up	Increase volume level.
13	Fast Forward	Fast forward selected music or video.
14	Volume Down	Decrease volume level.
15	Next	Skip to next song, photo, page, or video.
16	Zoom	Zoom in on media content.
17	Slow	Decrease frame rate playback of videos.
18	Audio	Change the audio channel.
19	Subtitle	Toggle subtitles on/off when available.
20	DVD/AV	Switch between DVD and AV devices.
21	Number Pad	Enter digits 1-9. Use "10+" for faster input.
22	Previous	Skip to previous song, photo, page, or video.
23	Stop	Stop media playback.
24	Rewind	Rewind selected music or video.
25	Play/Pause	Play and pause media content.
26	Setup	DVD setup.
27	Open	Eject disc.
28	Left Arrow	Navigate left when available.
29	Repeat	Repeat current song or video in playlist.
30	Display	Adjust Video display size.
31	Game Start	For in game use.
32	Game Select	For in game use.
33	Game Input	For in game use.
34	Game Movement	For in game use.
35	Return	Return to the main menus.

DVD

Getting Started

1. Insert the DVD into the disc drive.
2. Wait for the DVD to load.
3. Navigate the DVD menu for options.

Control

- Play/pause and navigate through the DVD menu options using the designated buttons found on both the control panel and the remote.

Playable discs

- CD
- CD-R
- DVD-R
- DVD-RW
- CD-RW
- DVD+R
- DVD+RW

USB/SD

Getting Started

1. Insert the USB device or SD card into the designated slots found on the right side of the unit.
2. Wait for the unit to load the content.
3. Browse files using the designated commands on the unit or the remote.

Playable Media Formats

AUDIO

- MP3
- WMA
- WAV

VIDEO

- MP4
- AVI
- WMV
- VCD

PHOTOS

- JPG

GAMES

- NES

BOOKS

- TXT

Tip: Video from a USB/SD is controlled the same way as DVD.

INSTALLATION GUIDE

Install Instructions:

1. To prevent short circuits, remove the key from the ignition and disconnect the terminal of battery.
2. Disconnect the original dome light.
3. Detach metal mounting plate from the Rockville unit. Release the screen from its locked position to access the necessary screws.
4. Attach the metal mounting plate to the roof using the screws. Make sure screws attach to interior roof liner.
5. Connect the wire harness in the following order:
Ground wire (Black), Battery wire (Yellow), +ACC wire (Red)
6. Attach the Rockville unit to the metal mounting plate using the screws.

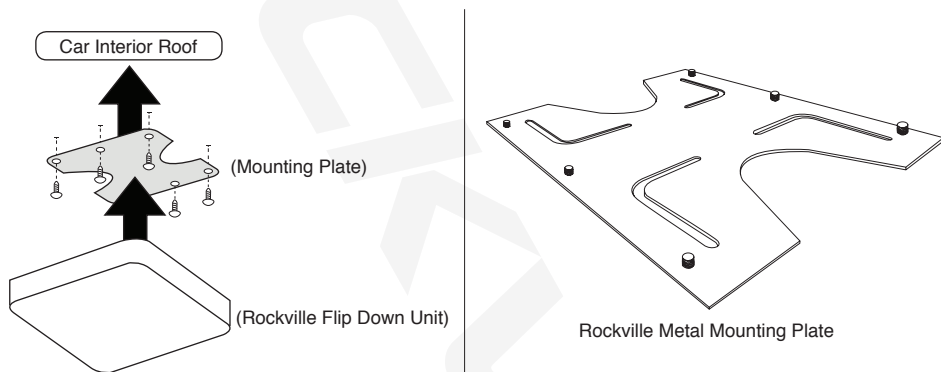

WARNING:

- Be careful not to screw and puncture the exterior roof.
- Use only the screws supplied.



Install Precautions

- This unit should be installed by qualified technician or service personnel.
- This product is designed to operate with a 12V DC, grounded battery system.
- Disconnect the ground wire from the battery terminal before connecting this unit to the electrical system.
- Use proper insulation and fastening materials to prevent electrical short-circuiting.
- Do not connect the yellow wire of this product directly to the battery terminal. Do remember to connect the red wire of this product to the ACC of the ignition key switch. Failure to do so may result in draining of the battery charge prematurely.
- Do not install this product at a position that may cause injuries to the passenger(s) during an accident.
- Due to different car specifications, please ensure that the display monitor is suitably located.
- Do not install this product at a declining angle exceeding 30°.
- Do not install screws over plane surface which may affect monitor ejector retract function.

WIRING

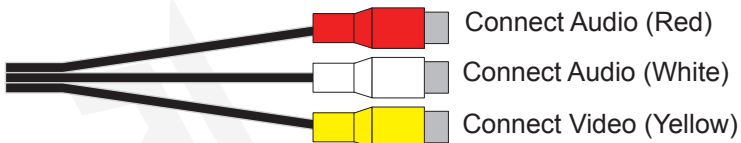

Connect Audio (Red)

- Left audio input.

Connect Audio (White)

- Right audio input.

Connect Video (Yellow)

- Video input.

Tip: AV/IN - Use these to connect an external media device. Camera, game console, etc.

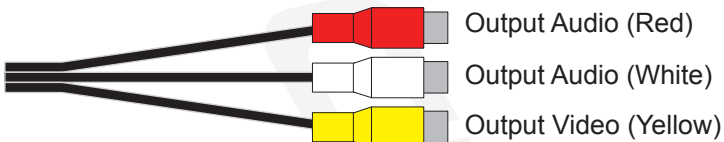

Output Audio (Red)

- Left audio output.

Output Audio (White)

- Right audio output.

Output Video (Yellow)

- Video output.

Tip: Use these to project the display onto external screens such as headrest monitor.

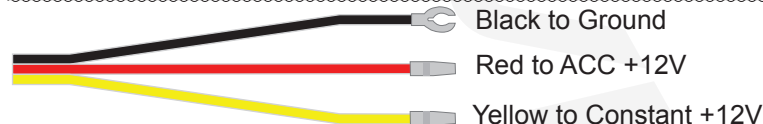

Black to Ground

- Connect the lead to bare metal surface on car.

Red to ACC +12V

- To 12 volt accessory power.

Yellow to Constant +12V

- To connect 12 volt constant power.

Note: When output to more than 1 external displays is desired the use of a video amplifier is recommended to preserve picture quality. (Refer to diagram below)

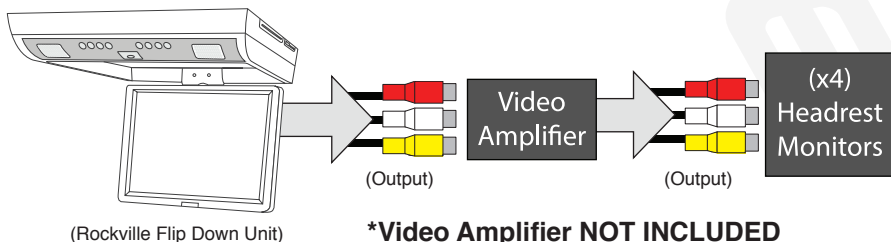

Visit us at:

Rockvilleaudio.com

Due to constant improvements, these specifications are subject to
change without notice.

Copyright 2014