

# Stage Lite Led sc

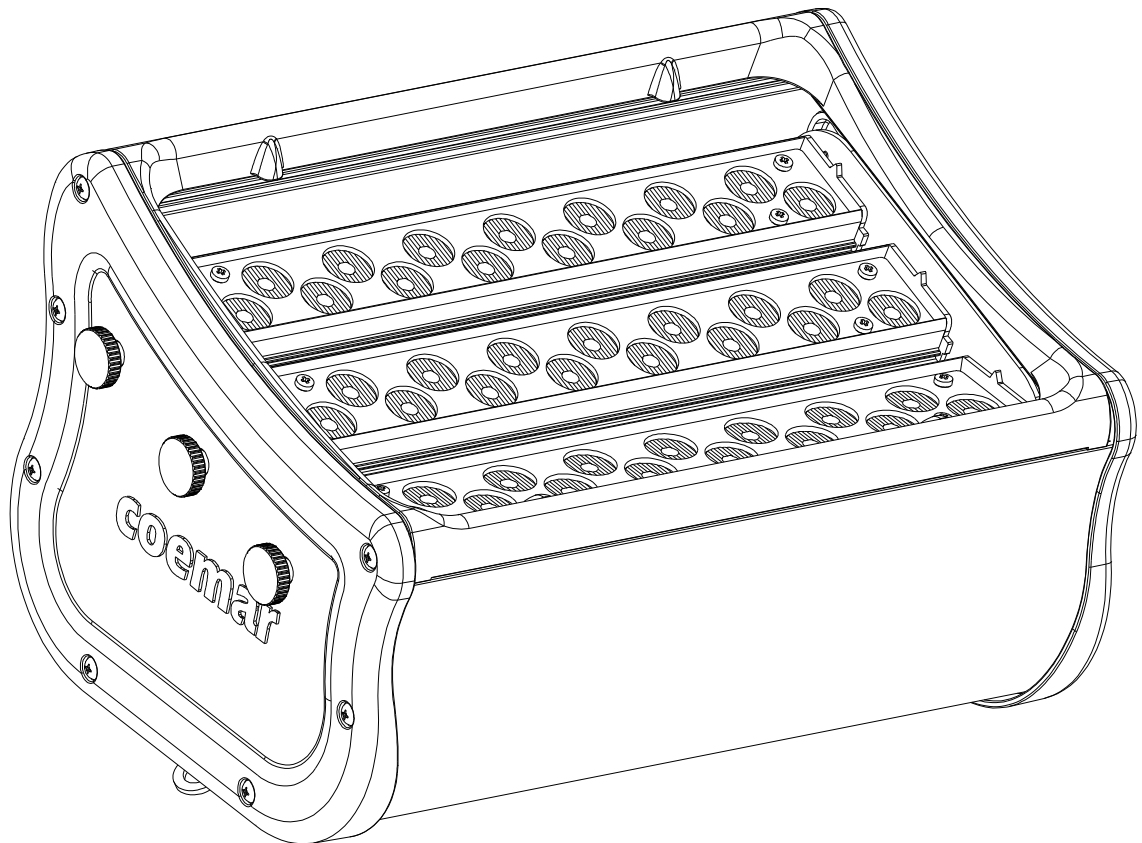

**instruction manual**  
**manuale di istruzioni**

Version 1.0  
DIS131



# Stage Lite Led sc

Serial number/numero di serie

Date of purchase/data di acquisto

Retailer/fornitore

Address/indirizzo

Suburb/cap/città

Capital city/provincial

State/stato

Tel./fax

Please note in the space provided above the relative service information of the model and the retailer from whom you purchased your **Stage Lite Led sc**: this information will assist us in providing spare parts, repairs or in answering any tecnica enquiries with the utmost speed and accuracy.

Prendete nota, nello spazio apposite, dei dati relative al modello e al rivenditore del vostro **Stage Lite Led sc**: questi dati ci permetteranno di assistervi con la massima rapidità e precisione.

**WARNING:** the security of the fixture is granted only if these instructions are strictly follone; therefore it is absolutely necessary to keep this manual.

**ATTENZIONE:** la sicurezza dell'apparecchio è garantita solo con l'uso appropriato delle presenti istruzioni, pertanto è necessario conservarle.

**User Manual Version 1.0**

edition October 2010

# Index

<b>1. Packaging and transportation</b> .....	6
1.1 Packaging .....	6
1.2 Transportation .....	6
<b>2. General information</b> .....	6
2.1 Important safety information .....	6
2.2 Warranty conditions .....	6
2.3 EC norms .....	6
<b>3. Product specifications</b> .....	7
3.1 Technical characteristics .....	7
3.2 Dimensions .....	7
3.3 Unit's main components .....	8
<b>4. Installation</b> .....	9
4.1 Mechanical installation .....	9
4.2 Safety chain .....	9
4.3 Adjusting unit tilt .....	10
4.4 Replacing lenses .....	10
<b>5. Powering up</b> .....	11
5.1 Operating voltage and frequency .....	11
5.2 Connection to mains power .....	11
<b>6. Control signal connections</b> .....	12
6.1 Control signal connection by XLR3 plugs .....	13
<b>7. Turning on the projector</b> .....	13
7.1 DMX address of the unit .....	13
7.2 DMX functions .....	14
<b>8. Display panel functions</b> .....	15
8.1 Quick guide to menu .....	15
8.2 Rapid count .....	15
8.3 MODE menu .....	15
8.4 Test and measures (MEAS) .....	16
8.5 Function settings (FUNC) .....	16
8.6 Connecting DR1 and DR1 Plus .....	17
8.7 Electronic led alignment .....	17
<b>9. Error messages</b> .....	18
<b>10. Spare parts</b> .....	19
<b>11. Maintenance</b> .....	19
11.1 Periodic cleaning .....	19
11.2 Periodic controls .....	19
11.3 Sostituzione dei fusibili guasti .....	19
<b>12. FAQ and answers</b> .....	20

# English

Congratulations on having purchased a Coemar product. You have assured yourself of a fixture of the highest quality, both in the componentry and in the technology used. We renew our invitation to you to complete the service information form on the previous page. This will assist in providing prompt and accurate advice from your Coemar service centre, which you can thoroughly trust and to which you can submit any requests for service or information. Following the instructions and procedures outlined in this manual will ensure the maximum efficiency of this product for years to come.

## 1. Packaging and transportation

### 1.1 Packaging

Open the packaging and make sure that no part of the equipment has suffered any damage during the transportation. In case of damage to the fixture, contact your carrier and your supplier immediately by telephone, fax or email, and inform them you will formally notify them in writing through registered letter.

#### Packing List

Make sure the packaging contains:

- 1 Stage Lite Led sc
- 2 This instruction manual.
- 3 Cam-Lock support brackets.
- 4-Cam Lock brackets for floor support.

### 1.2 Transportation

Stage Lite Led sc must be transported exclusively in its original packaging or in an appropriate flight case.

## 2. General information

### 2.1 Important safety information.

#### Fire prevention:

1. Never locate the fixture on any flammable surface.
2. Minimum distance from flammable materials: 0,5m.
3. Minimum distance from the closet illuminable surface: 0,5m.
4. Replace any blown or damaged fuse only with those of identical values. Refer to the schematic diagram if there is any doubt.
5. Connect the projector to mains power protected by a thermal magnetic circuit breaker.

#### Preventing from electric shock.

1. Presence of high voltage inside of the fixture. Insulate the projector from mains supply before opening or performing any function which involves touching the inside of the fixture, including lamp replacement..
2. For the connection to the mains, adhere strictly to the guidelines outlined in this manual.
3. The level of technology of **Stage Lite Led sc** requires the use of specialised personnel for all service applications; refer all work to your authorised **Coemar** service centre.
4. A good earth connection is essential for the proper functioning of the projector. Never connect the fixture if there is no earth connection.
5. Mains cables must not come into contact with other cables.
6. Do not operate the projector with wet hands or in an area where water is present.
7. The fixture must never be located in an exposed position, or in areas of extreme humidity.

#### Safety.

1. The projector must always be installed with bolts, clamps, or other fixing devices which are suitably rated to support the weight of the projector.
2. Always use a secondary safety fixing device with chain or steel wire of a suitable rating to sustain the weight of the unit in case of failure of the principal fixing point.
3. The external surfaces of the unit, at various points, may reach 80°C. Never handle the unit until at least 10 minutes have elapsed since the lamp was turned off
4. Never install the fixture in an enclosed area lacking sufficient air flow; the room temperature must not exceed 35°C.
5. The projector contains electronic and electrical components which must under no circumstances be in contact with water, oil or any other liquid. Failure to do so will compromise the proper functioning of the projector.

#### Protection rating against penetration by external agents (versione IP65):

The fixture has an IP65 protection rating; this indicates that it is protected against dust and significant showers of water. This protection rating allows the fixture to be installed in an exposed location in inclement weather conditions..

### 2.2 Warranty conditions

1. The fixture is guaranteed for a period of 12 months from the date of purchase against manufacturing or materials defects.
2. The warranty does not extend to damage caused by inappropriate usage, use by inexperienced operators or inadequate maintenance.
3. The warranty is immediately void if the projector has been tampered or opened by unauthorised personnel.
4. The warranty does not extend to fixture replacement.
5. Both the serial number and the model of the projector are required for any advice or service from your authorised service centre.

### 2.3 EC norms.

The projector meets all fundamental applicable EC requirements.

**3. Product specifications**

**3.1 Technical characteristics**

<b>Power</b>	90-250 Vac 50/60Hz Autosensing
<b>Maximum current</b>	0,5 A @230 Vac, - 1°@115Vac
<b>Power factor</b>	Cos φ = 0,6
<b>Light source wattage</b>	68 W
<b>Maximum room temperature</b>	35°C/95°F
<b>Weight</b>	6 Kg./13.2 lbs
<b>IP rating</b>	IP20 (standard version) – IP65 (IP version)

The technological heart of **Stage Lite Led sc** is made of 48 powerful leds projecting infinite combinations of colors, mounted on three parallel, 180° manually orientating bars. In the following pages, for convention, these bars are called lines and are enumerated from the bottom **line 1**, **line 2** and **line 3**.

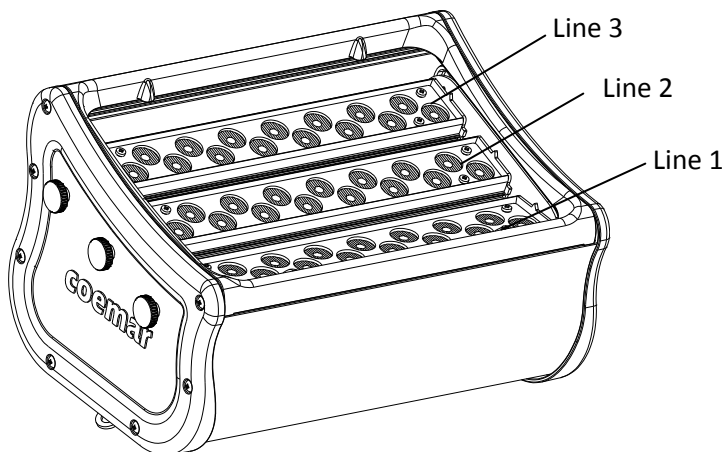

**3.2 Dimensions**

**Suspended installation version**

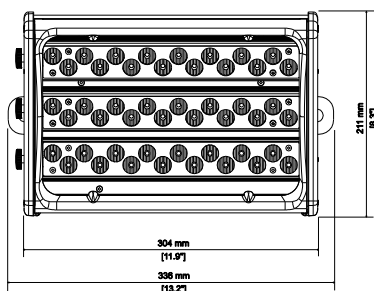
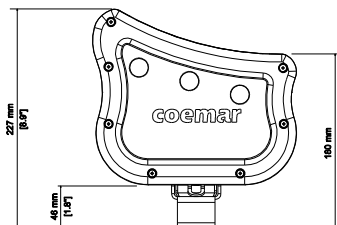
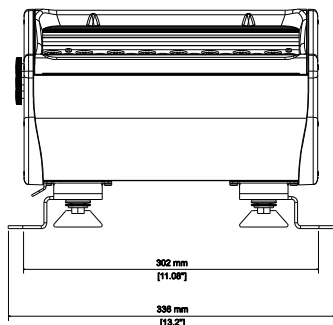

# English

Floor installation version.

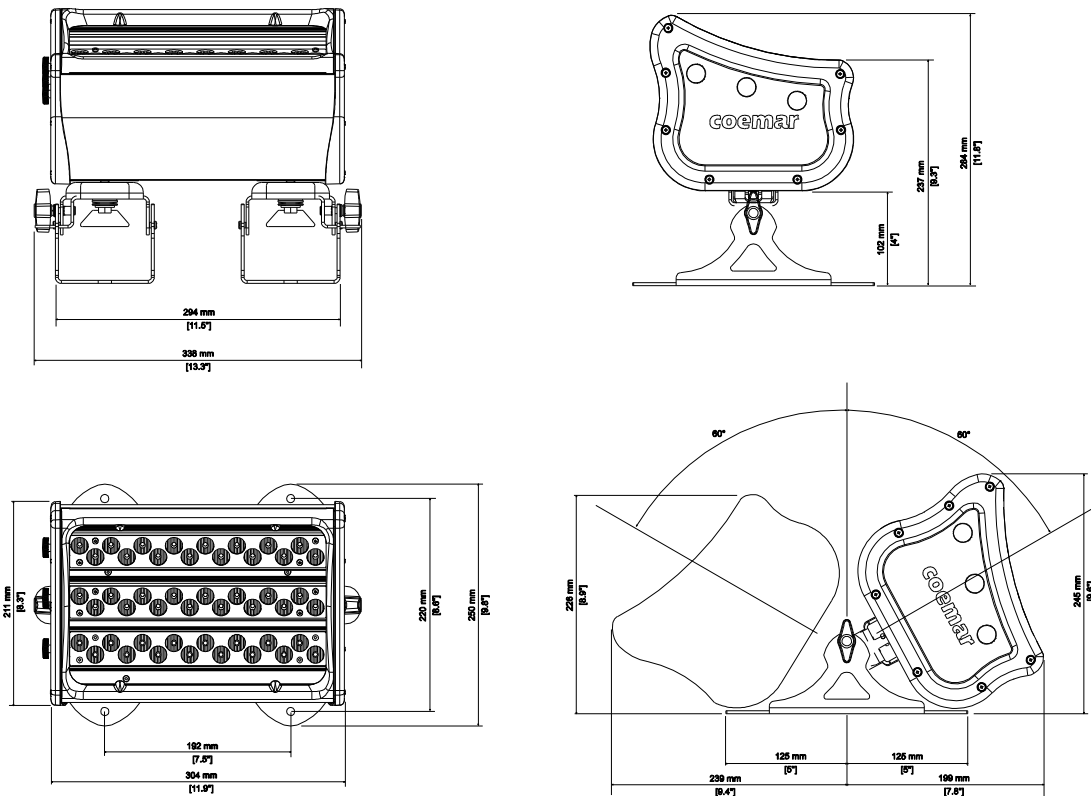

## 3.3 Unit's main components

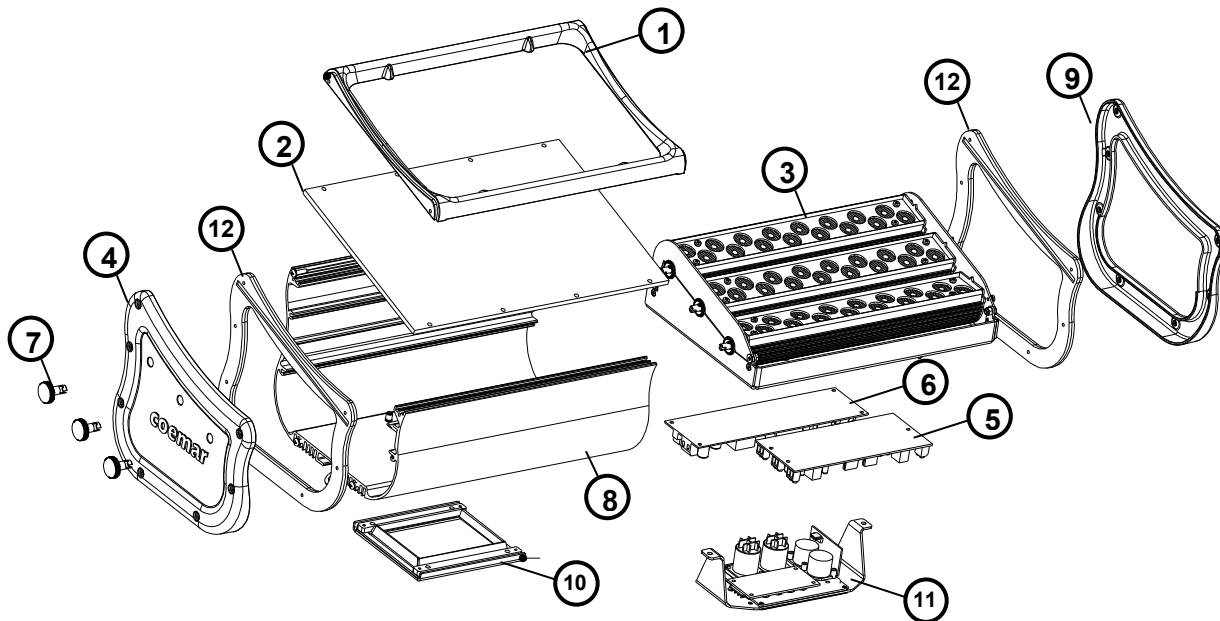

Components description	
1- Top frame	7- Adjusting knobs
2- Polycarbonate screen	8- Unit housing
3- Internal led lines group	9- Left header
4- Right header	10- DMX IP20 panel
5- Led controller PCB	11- Display panel
6- Power supply unit	12- Gasket

## 4. Installation

### 4.1 Mechanical installation

**Stage Lite Led sc** may be floor mounted or hung from an appropriate structure in any position.

If hanging the fixture from a lighting truss or similar, we recommend the use of an appropriate clamp "B" affixed to the fixture in the holes "A" provided, as shown in the following diagram.

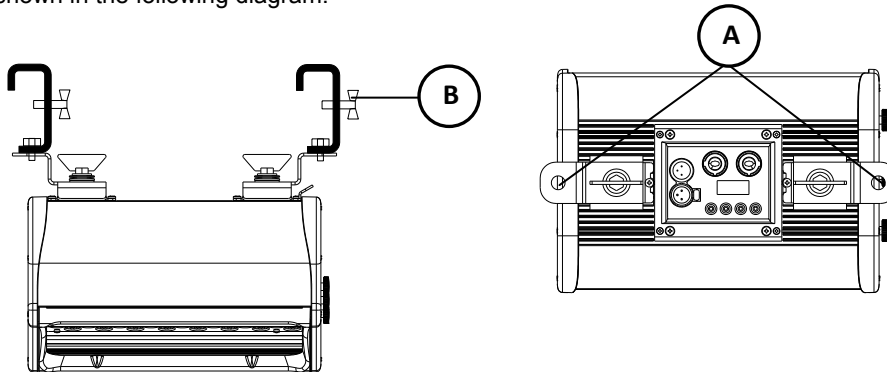

### WARNING!

Always ensure that your support structure and fixing (bolts, clamps, etc...) are rated to support the weight of the fixture.

### Floor installation

If the fixture is floor mounted, we recommend the use of appropriate clamps "C" as shown in the following diagram.

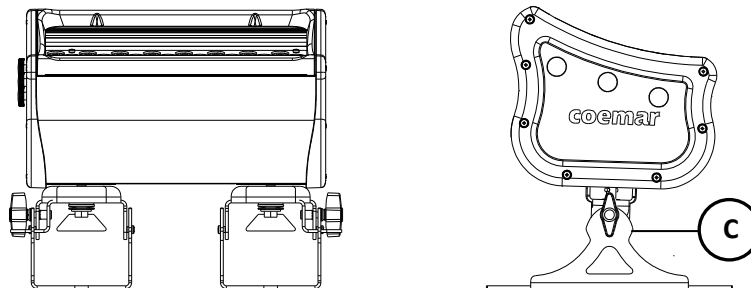

### 4.2 Safety chain

When hanging **Stage Lite Led sc** we recommend the use of a safety chain affixed to the body and to the suspension device. The safety chain should be either a metal rope or a metal chain, both suitably for the purpose.

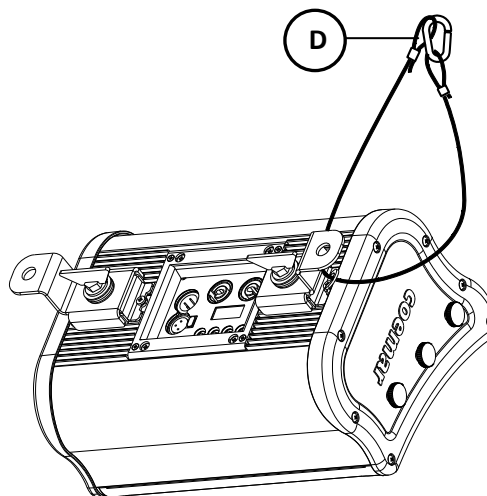

## English

### 4.3 Adjusting unit tilt

Stage Lite Led sc tilt, when floor mounted can be adjusted in a range of 120° as preferred. In order to adjust the tilt untight the “E” handles sited on the sides of the supports, adjust the tilt angle as preferred then tight again the handles. Move the knobs in order to orient the beams at the desired angle. The graduated board is a useful point of reference to achieve a sharp adjustment.

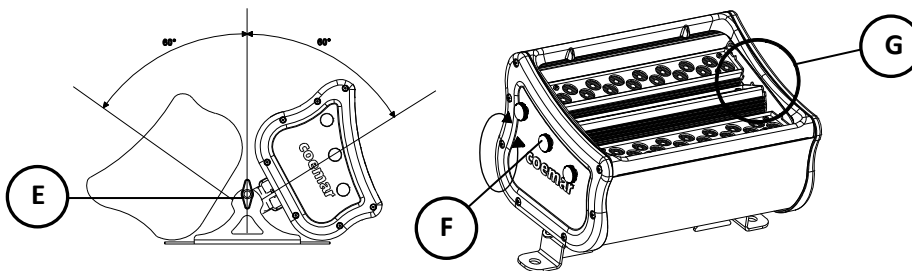

### 4.4 Replacing lenses

It is possible to mount optional lenses in order to get a different beam angle. The instruction for replacing the lenses are showed in the following pictures. This operation must be done by qualified personnel.

-remove the frame or the IP65 panel from the bottom of the fixture by unscrewing the 4 screws, then remove also the other 2 screws placed underneath in order to unlock the inner block.

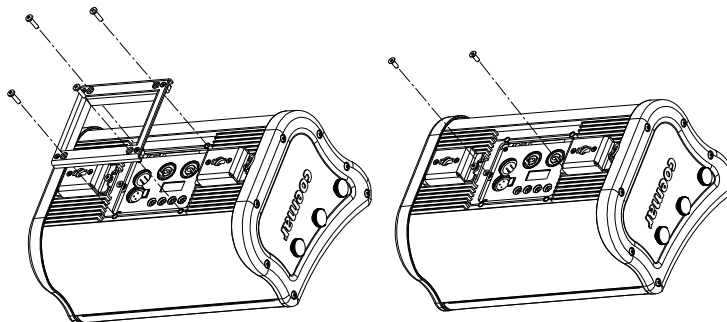

-remove the three adjusting knobs and the right side header from the fixture by removing the 7 screws; gently extract the inner block from the body. Be careful not to tear cables that can be caught in the body.

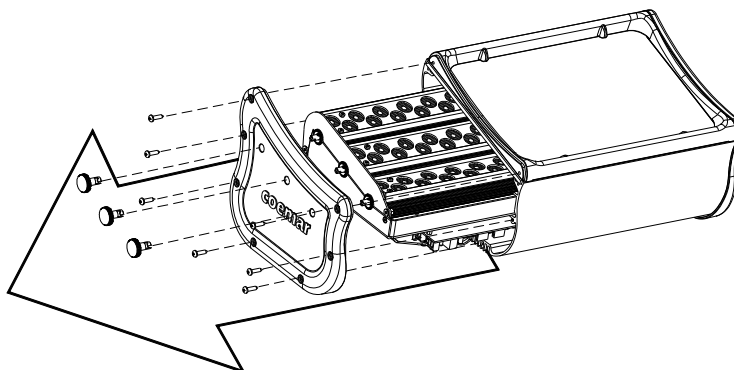

- Replace the lenses needed taking care not to make pressure on the lens for any reason. If the operation is difficult to perform, check for the correct orientation of the lens towards its receptacle.

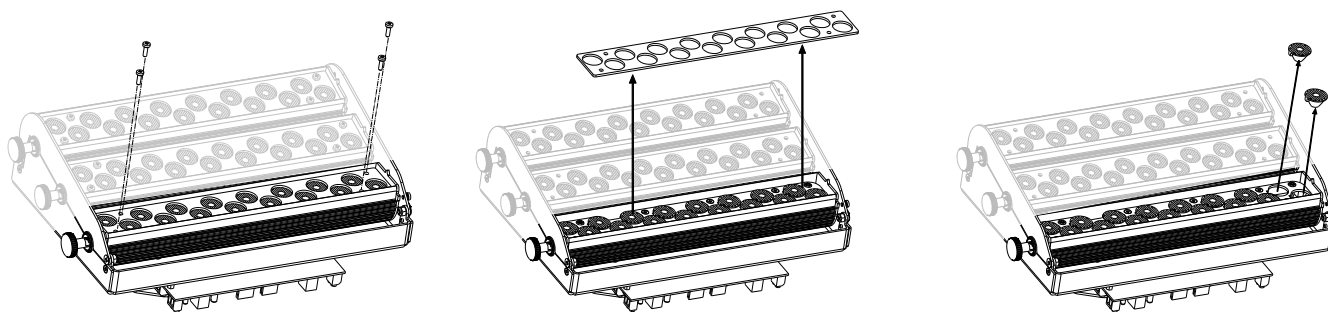

**WARNING !!**

Insert the lenses gently observing the points of reference. A wrong insertion can seriously damage the leds.

## 5. Powering up

### 5.1 Operating voltage and frequency

The unit may operate at voltage ranges from 90 to 250V<sub>aC</sub> at a frequency of 50 or 60 Hz. It is not needed to effect any setup procedures, Stage Lite Led sc will automatically adjust its operation to suit any frequency or voltage within this range.

### 5.2 Connection to mains power

#### Mains cable characteristics

The mains cable provided is thermally resistant, complying to the most recent International standards.

Note: in case of cable replacement, similar cable with comparable thermal resistant qualities must be used exclusively (cable 3 X 1,5  $\varnothing$  external 10 mm, rated 300/500V, tested to 2 KV, operating temperature -40°C + 180°C, **Coemar** cod. CV5311).

#### Connection to mains power

**Stage Lite Led sc** is equipped with two power connectors, one as input and one as output, which can be used to connect more fixtures in series. The maximum current absorbed from **Stage Lite Led sc** is indicated in the chart below:

-230/240V 0,5A amps constant current in normal operation.

-100/115V 1A amps constant current in normal operation.

The maximum working current of the connectors is 16A.

**WARNING !**

The absorption of Stage Lite Led sc ( $I_{max}$ ) can never be more than 16 A.

The maximum absorption  $I_{max}$  is given from the sum of the absorptions of all the **Stage Lite Led sc** connected in series.

#### Example:

For a series of 5 **Stage Lite Led sc** connected at 100V  $I_{max} = 1 \times 5 = 5A$

For a series of 5 **Stage Lite Led sc** connected at 230V  $I_{max} = 0,5 \times 5 = 2,5A$

In the following figure you can see an example of series connection:

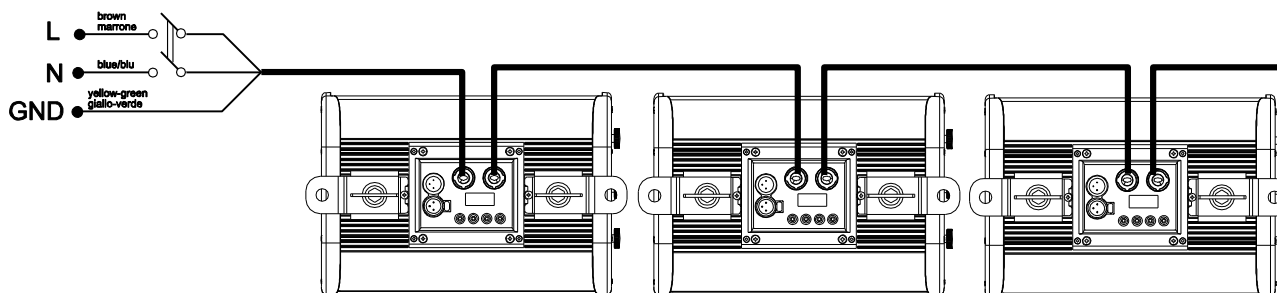

## English

### WARNING!!

- The use of a thermal/magnetic circuit breaker is recommended. Strict adherence to regulatory norms is strongly recommended.
- Stage Lite Led sc should not be powered through a dimmer as this may damage the internal switching power supply.
- Prior to connecting the device to mains power, ensure that the mains characteristics are within the recommended range for use with the Stage Lite Led sc.
- all cabling and connections should be carried out by suitably qualified personnel.

## 6. Control signal connections

### Stage Lite Led sc can operate in two modes:

- 1- using DMX512 control signal
- 2- automatic "STAND ALONE" or "MASTER/SLAVE" mode.

### 6.1 Control signal connection by XLR3 plugs.

The digital control signal is transmitted to the projector via a two pole cable screened as per International standards for the transmission of DMX 512 data. The connection must be serial, using connectors XLR3 male and female located on the back of **Stage Lite Led sc** labelled DMX512 IN e OUT (see diagram).

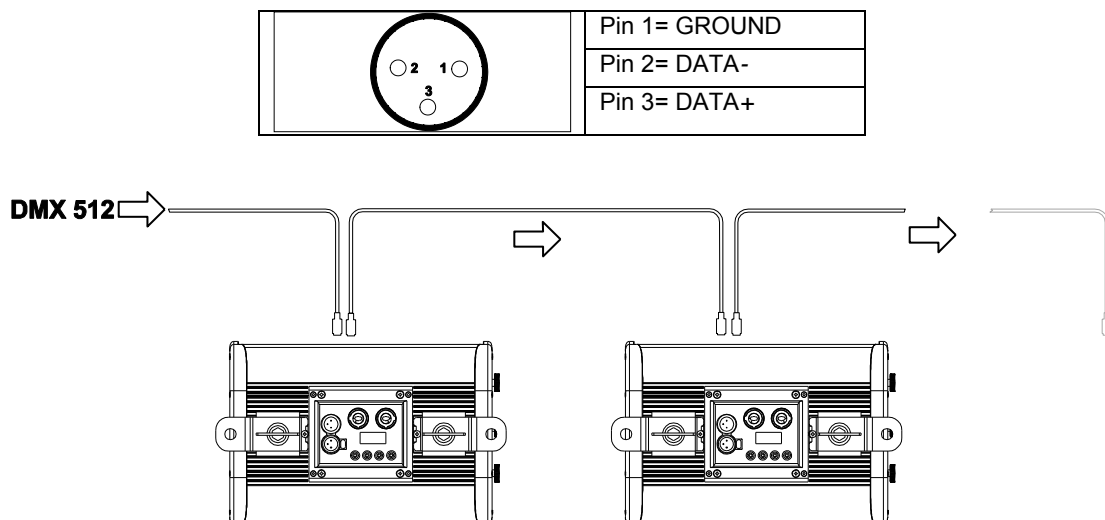

### ATTENZIONE !

Make sure that screening and conductors are not in contact one another or with the metal housing of the connector.  
Pin#1 and housing never must be connected to the power supply unit.

## 7. Turning on the projector

After having followed the preceding steps described, proceed with the power supply and turn on the projector connecting it to the mains power.

The display the software version installed on the internal microprocessors:

For example, when switched on **Stage Lite Led sc** may show:

**1.00** (actual software version installed)

If the address continues to blink and the “NO DMX SIGNAL” message appears, it means that the DMX signal has not been received. Check the connection cable and the mixer functioning.

### 7.1 DMX address of the unit

Each projector uses 8 address channels for its complete operation and is controlled by a DMX 512 signal (for further information, see section 7.2, DMX functions).

#### DMX addressing

When powered up initially, each projector will show A001, which indicates DMX address 001; a projector thus addressed will respond to commands of channel 1 to 8 from your DMX 512 controller. A second unit must be addressed as A016, a third as A024 and so on. The operation must be carried out on every **Stage Lite Led sc** which has an address different from A001.

#### Altering DMX address.

1. Press the + or – button until the display shows the required DMX address. The digits on the display will blink to indicate that the variation has not been registered.
2. Press the *enter* key to confirm your selection. The digits on the display panel will cease to blink and the projector will now respond to the new address.

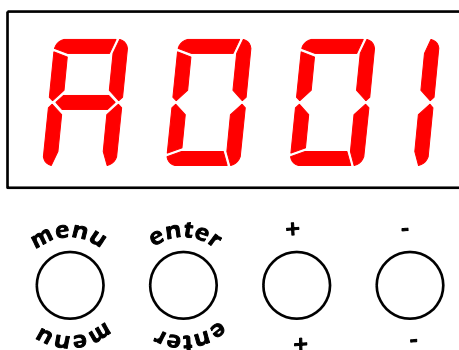

**Note:** by holding the + or – button down the scrolling will be faster; thus allowing a faster selection

#### WARNING!

If you alter the DMX address with no DMX signal connected, the digits on the display panel will continue to flash even after you have pressed ENTER button to confirm the address.

# English

## 7.2 DMX functions

channel	function	type of control	effect	decimal	percentage
1	<b>master dimmer</b>	proportional	adjusts luminous output intensity from 0 to 100%	0 - 255	0% - 100%
2	<b>red</b>	proportional	proportional control of the percentage of red colour from 0 to 100%	0 - 255	0% - 100%
3	<b>green</b>	proportional	proportional control of the percentage of green colour from 0 to 100%	0 - 255	0% - 100%
4	<b>blue</b>	proportional	proportional control of the percentage of blue colour from 0 to 100%	0 - 255	0% - 100%
5	<b>white</b>	proportional	proportional control of the percentage of white light from 0 to 100%	0 - 255	0% - 100%
6	<b>strobe effect</b>	step	no effect	0 - 9	0% - 4%
		proportional	variable speed strobing effect, from slow to fast	10 - 57	4% - 22%
		step	stop strobe	58 - 59	23% - 23%
		proportional	sequenced pulse effect, slow closing, fast opening (variable speed pulsing, from slow to fast)	60 - 108	24% - 42%
		step	stop strobe	109 - 110	43% - 43%
		proportional	sequenced pulse effect, fast closing, slow opening (variable speed pulsing, from slow to fast)	111 - 159	44% - 62%
		step	stop strobe	160 - 161	63% - 63%
		proportional	random strobe effect with variable speed from slow to fast and synchronised colours	162 - 207	64% - 81%
		step	stop strobe	208 - 209	82% - 82%
proportional	random strobe effect with variable speed from slow to fast and non-synchronised colours	210 - 255	82% - 100%		
7	<b>automated functions</b>	step	no effect	0 - 9	0% - 4%
		proportional	automated colors program 1; fade speed between colours from fast to slow (from 1 second to 1 minute)	10 - 50	4% - 20%
			automated colors program 2; fade speed between colours from fast to slow (from 1 second to 1 minute)	51 - 91	20% - 36%
			automated colors program 3; fade speed between colours from fast to slow (from 1 second to 1 minute)	92 - 132	36% - 52%
			automated colors program 4; fade speed between colours from fast to slow (from 1 second to 1 minute)	133 - 173	52% - 68%
			random program repeat; fade speed between colours from fast to slow (from 1 second to 1 minute)	174 - 214	68% - 84%
			repeat all programs in sequence; fade speed between colours from fast to slow (from 1 second to 1 minute)	215 - 255	84% - 100%
8	<b>special functions</b>	step	no effect	0 - 9	0% - 4%
		proportional	control of the pause time between colours (steps) of the program selected from channel 7; the pause time is adjustable proportionally from 1 second to 3.30 minutes	10 - 135	4% - 53%
		step	park, no functions	136 - 179	53% - 70%
			led control frequency tuning 1000 Hz	180 - 188	71% - 74%
			led control frequency tuning 1500 Hz	189 - 197	74% - 77%
			led control frequency tuning 2000 Hz	198 - 206	78% - 81%
			led control frequency tuning 2500 Hz	207 - 215	81% - 84%
			led control frequency tuning 3000 Hz	216 - 224	85% - 88%
			led control frequency tuning 3500 Hz	225 - 233	88% - 91%
			led control frequency tuning 4000 Hz	234 - 242	92% - 95%
			led control frequency tuning 4500 Hz	243 - 251	95% - 98%
			led control frequency tuning 5000 Hz	252 - 255	99% - 100%

Projector: Stage Lite Led sc

Table name: DMX 512 functions

Table number: 290

Edition: 0

Date: 05/10/2010

## 8. Display panel functions

By suitably using all the functions of **Stage Lite Led sc**, which can be activated through its display panel, it is possible to change some of the parameters and to add some functions.

Changing the preset settings made by **Coemar** can vary the functions of the projector so that it will respond differently to the controller; therefore carefully read about the functions described here before carrying out any possible selection..

### 8.1 Quick guide to menu

In order to access the functions, just press the menu button: one after the other, all the voices of the menu will be cyclically shown each time the key + or – will be pressed. To select the desired function, press *enter*.

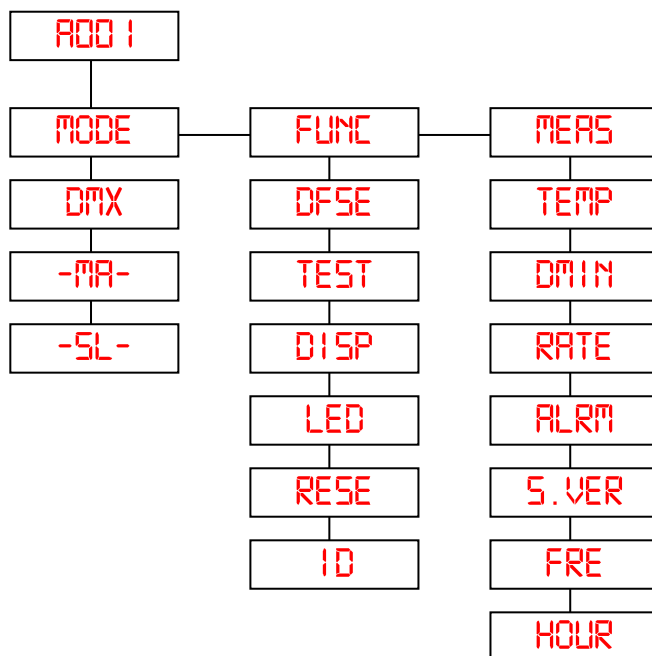

### 8.2 Rapid count

By the display panel of **Stage Lite Led sc** It is possible to quickly change the various numbers displayed for the different functions in the following 3 manners:

1. Pressing the + or – buttons will cause the count to be quicker.
2. Pressing first + and then – and then holding them down simultaneously will cause the numbers to jump to the highest value.
3. Pressing first – and then + and then holding them down simultaneously will cause the numbers to jump to the lowest value.

### 8.3 MODE menu

The projector gives the opportunity to change and customize some functional settings.

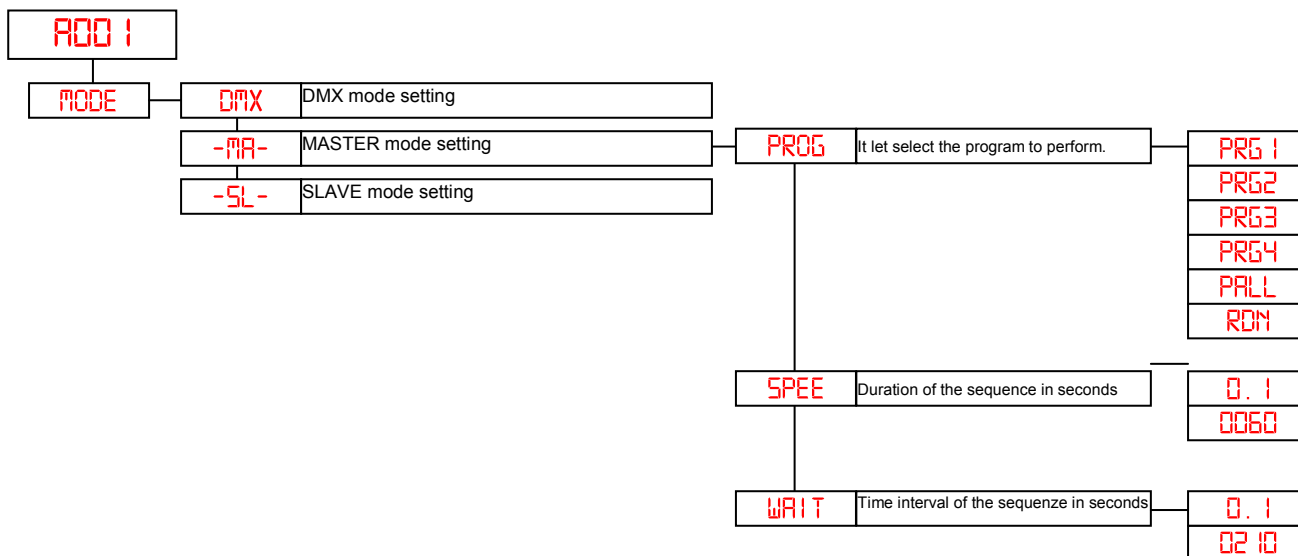

# English

## 8.4 Test and measures (MEAS)

The internal microprocessor of Stage Lite Led sc allows for several diagnostic and output parameter to be displayed.

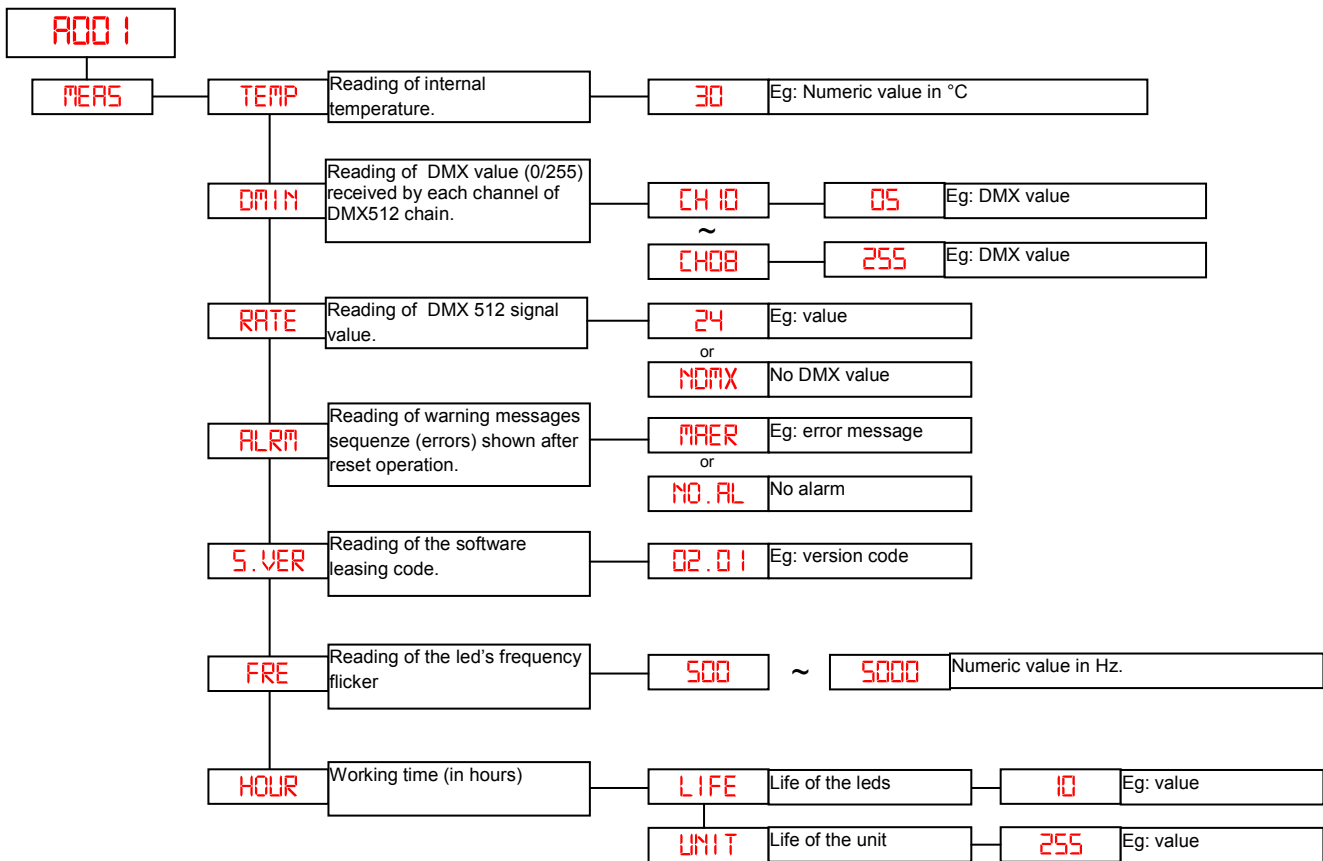

## 8.5 Function settings (FUNC)

The projector gives the opportunity to change and customize some functional settings.

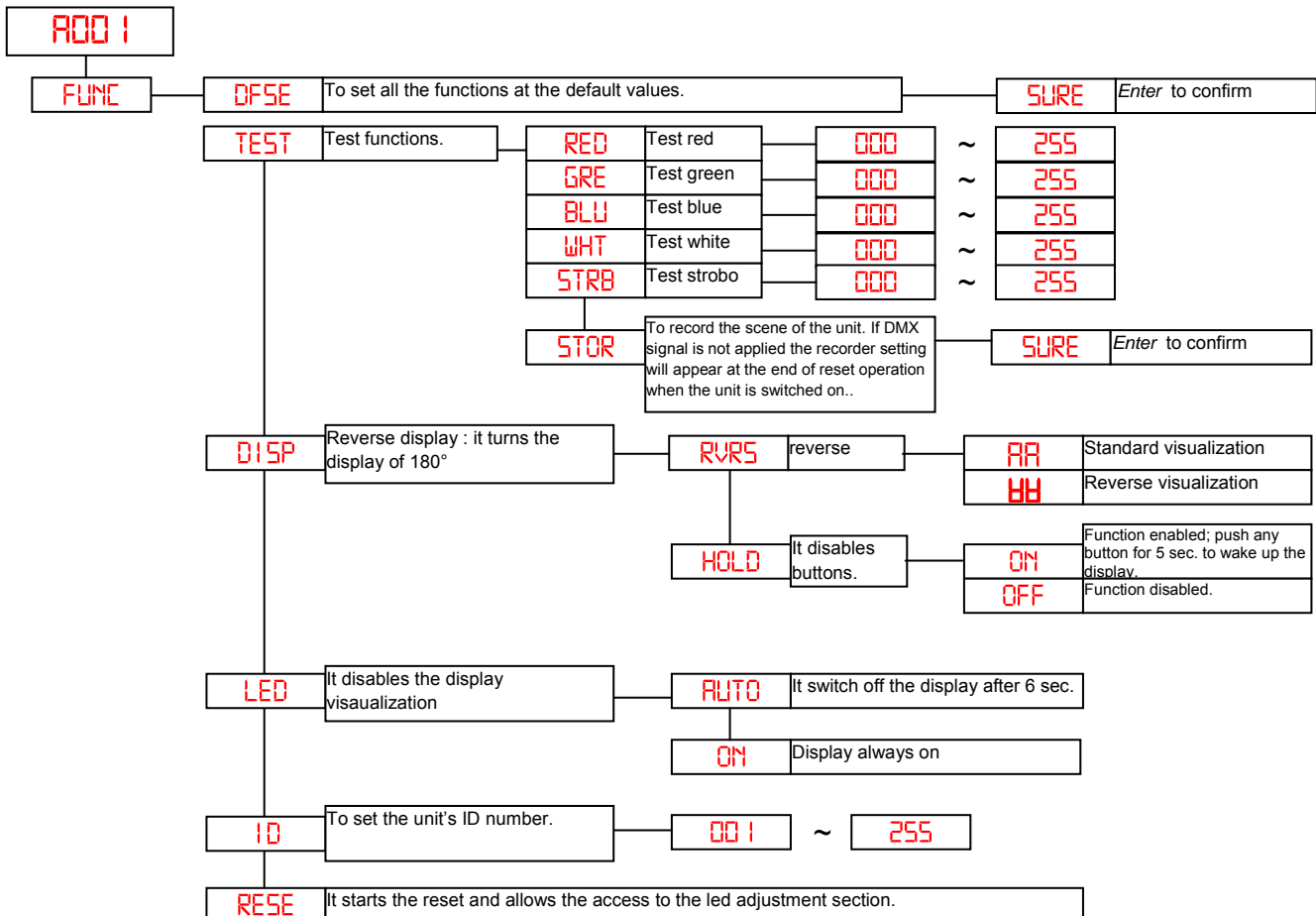

## 8.6 Connecting DR1 and DR1 Plus

All the menu functions can be remotely activated by **DR1** (cod. CO9707) and **DR1 Plus** (cod.CO9709). **DR1** and **DR1 Plus** are instruments designed for technicians who need to operate on the fixtures whilst they may be located in inaccessible positions without work directly on the fixture itself.

For example, **DR1** and **DR1 Plus** eliminate the need for climbing up the truss structures to gain physical access to the projector to alter such parameters as DMX address. **DR1** and **DR1 Plus** allow also the firmware updating of the fixtures

To enable any fixture for operating with **DR1** or **DR1 Plus**, you must first activate the identifying number of the projector (**ID**) which must be unique in the particular DMX universe in which it is currently installed. To change the **ID number** enter in **FUNE** menu, choose **ID** then change the ID number by + and – keys and confirm by *enter key* (see also **FUNE** menu).

### WARNING !

**-If you set a unit's identification number to "0" it will not be able to communicate with DR1 o DR1 Plus.  
-Never assign the same ID to two or more units. This may jeopardize the functioning of the entire system. ( DR1 and DR1 Plus will show an error message).**

For further information, consult the DR1 or DR1 Plus manual.

## 8.7 Electronic led alignment.

The display of **Stage Lite Led sc** enables the alignment of the leds; this procedure has been done by **Coemar** before leaving the factory. It may be needed to modify these settings in case of internal parts replacement. (PCBs , leds, etc..).

Modifying the settings made by **Coemar** may totally vary the behavior of the unit, so read carefully the following instructions before operate.

### WARNING !

**This procedure should only be undertaken by qualified and experienced technical personnel.**

#### To have access to the alignment function:

- 1- Press the *menu* button and then *enter* to confirm.
- 2- Press the + or – button until **FUNE** is displayed. Press *enter* to confirm.
- 3- Press the + or – button until **RESE** is displayed.
- 4-Press the *enter* and *menu* buttons simultaneously, holding them for at least 10". The motors will perform a reset and the display will show ---- for a few seconds. After this, the display will show **RLIG** confirming the entry in the electronic calibration mode.

### WARNING !

**The alignment procedure can only be carried out when DMX512 signal is connected.**

Consult the following diagram to get more details.

## English

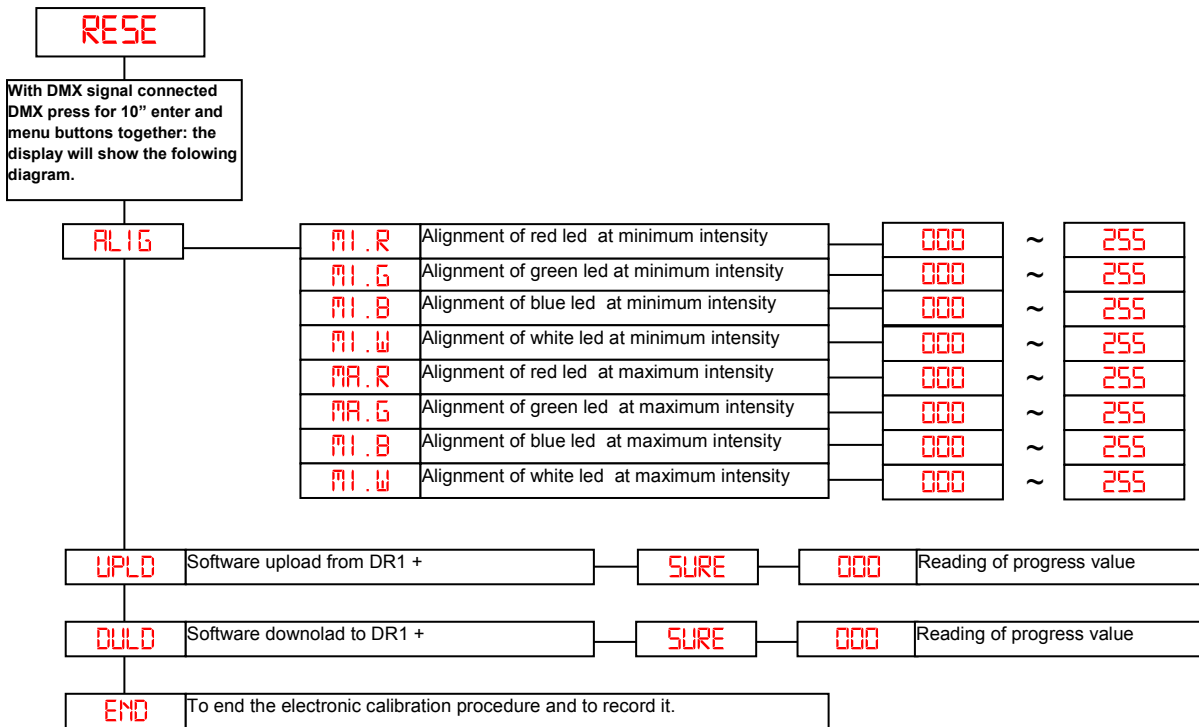

**Nota:** Simultaneously pressing + and – buttons will return the calibration value to 128 (default).

### UPLD Function (Upload)

this function allows to upgrade the firmware of **Stage Lite Led sc** only by DR1 or DR1 Plus and a Personal Computer. Read DR1 or DR1 Plus manual for further information.

### DULD Function (Download)

this function allows to download the software from **Stage Lite Led sc** only by DR1 or DR1 Plus and by a Personal Computer. Read DR1 or DR1 Plus manual for further information.

## 9. Error messages

If a malfunction occurs, **Stage Lite Led sc** has a self-diagnostic system that will show the error message on the display. The following table will explain in detail the most common errors. If, despite of suggested intervention, the problem persists, call the Coemar Service center near you.

Error message	Description and suggested solution.
<b>OTER</b>	<b>Data error.</b> The initial configuration settings are faulty or have been loaded incorrectly. The projector has loaded its default configuration. Turn the projector off and on again and if the error persists, it means that the EEprom is either defective or absent; refer to your Coemar service center for the replacement.
<b>ADER</b>	<b>DMX address error.</b> The projector is not receiving all the DMX channels necessary for its operation. Check the DMX address and the control console operation. Note that some controllers may not generate all 512 channels of signal.
<b>MAER</b>	<b>Master mode error.</b> This message indicates that the user has attempted to set the unit to MASTER mode whilst DMX signal is still being received. Detach any DMX control signal or remove MASTER mode settings on other units in the DMX chain.



## 10. Spare parts

All the components of **Stage Lite Led sc** are available as spare parts from your Coemar dealer or Service. Accurate description of the fixture, model number and type will assist us in providing for your requirements in an efficient and effective manner.

## 11. Maintenance

### 11.1 Periodic cleaning

#### Polycarbonate screen

Even a fine layer of dust can reduce the luminous output and alter the compactness of the beam. Regularly clean all filters and lenses using a soft cotton cloth, dampened with a specialist lens cleaning solution.

#### Cleaning of the unit

Use a soft brush or a common vacuum cleaner or a source of compressed air for removing dust from the heat sink on the back of the unit. For the cleaning of the housing use a soft cloth and a non-aggressive cleaner.

### 11.2 Periodic controls

#### Mechanical parts

Check the correct working of the mechanical parts and, if needed, replace them. Make sure the projector is not mechanically damaged. If necessary, replace the worn parts.

#### Electrical components

Check all electrical connections, in particular for correct grounding and correct attachment of all extractable connectors. Press the connectors if necessary and reposition as before.

### 11.3 Sostituzione dei fusibili guasti

Check the conditions of the fuses using an appropriate instrument; if damaged, replace them with equivalent ones. The following image shows position and value of the fuse.

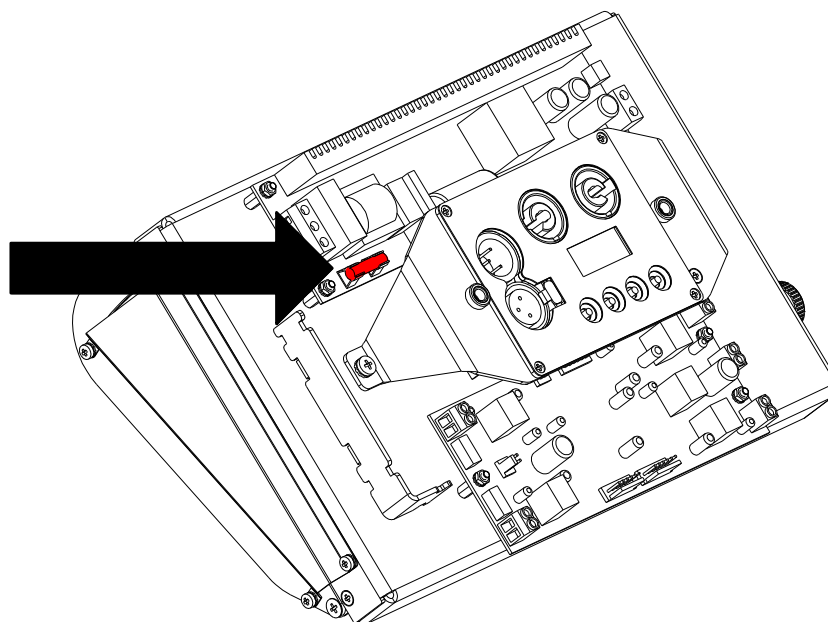

Fuse: 6,15 A F 250V

**12. FAQ and answers**

Question	Possible cause	Suggested solution
Stage Lite Led sc does not turn on.	-Unit not powered: 1- check that the green led on the back panel is lit. 2-The fuse may be blown.	1-Make sure the power cord is plugged in or test the input voltage. 2-Turn off the unit and replace the blown fuse.
Stage Lite Led sc does not respond, or responds incorrectly, to DMX signal..	The DMX signal may not come to Stage Lite Led sc.	Inspect the cable connection, correct poor connections or inefficient repair or replace damaged cables. Check DMX address of the unit.
Stage Lite Led sc has been set as MASTER unit but it do not run any program.	1-Another Stage Lite Lite Led sc set as MASTER is in the DMX chain. 2-Stage Lite Led sc receives a DMX signal. 3-There wasn't set any program.	1-Locate the other unit set as MASTER and set it as SLAVE. 2-Remove eventual DMX connection. 3-Set a program on MASTER unit.
Stage Lite Led sc is not recognized by DR1 or DR1 Plus.	ID set as 0 or another unit with the same ID is in the DMX chain.	Change the setting of the ID number different from 0 and different from any other unit in the line.

<b>Information on disposal of the equipment</b>	
	<p>The equipment at the end of its useful life must be disposed of at an appropriate recycling center for waste electrical and electronic equipment. The treatment and disposal of environmentally friendly, helps prevent potential negative environmental and health and promote the reuse and / or recycling of materials making up the equipment. Illegal disposal by the user includes the application of administrative sanctions provided by law.</p>



**Coemar s.p.a.**

via Inghilterra 2/A - 46042 Castel Goffredo (Mantova) Italy  
ph. +39 0376/77521 - fax +39 0376/780657  
info@coemar.com

**Coemar** si riserva il diritto di apportare modifiche senza preavviso.  
**Coemar** reserves the right to effect modifications without notification