

FILM SCANNER



USER'S MANUAL

CONTENTS

Preface	1
Safety Precautions.....	1
Checking package contents.....	1
Product Structure Diagram.....	2
Slide and negative holder loading method	3
Operation Guided	5
Product Specification.....	12
Declaration.....	13

8.Declaration

Please note products spec is subject to improvement .Any changes of product will not make additional specify.

7.Product Specification

Function	Film scanner/USB MSDC
Interface	USB2.0
Image Sensor	14.0 Mega pixels (4416*3312) 1/2.3" CMOS sensor
Display	Color 2.4" TFT LCD
Exposure Control	Automatic / Manual (-2.0 EV~ +2.0EV)
White Balance	Automatic
Resolution	14.0 Mega pixels/ 22Mega pixels (interpolation)
Film type	135 Film(36*24mm)、 126KPK Film(27*27mm)、 110 Film(17*13mm)、 Super8 Film(4.01*5.79mm)、 Monochrome、Slide
Picture Effects	B&W,Slides,Negatives
File format	Picture : JPEG
TV-OUT type	NTSC/PAL
Built-in memory	128M
External memory card	SD card up to 32GB
Power Supply	DC 5V Adapter/ USB Port
Language	S-Chinese / T-Chinese / English / French /German / Italian / Spanish / Japanese
Support system	Windows XP/vista/Windows7/ Mac10.7.3
Product Size	L104.5 x W90.5 x H102.5mm
Weight	272g

1.Preface

Thank you for purchasing this product ! Please read this user's manual carefully before using this product.
Please retain this manual for future reference.
Please use this product correctly

2.Safety Precautions

- Do not disassemble this unit.
- Do not touch inner part of the scanner after dropping or other damage suffering.
- Do stop using it if there is any problem with the scanner, such as smoke or smell while using.
- Do not clean the scanner with alcohol, gasoline, diluent and other organic solvent.
- Do not use it in many dusts with the damp environment.
- Do not overload the USB connections on your computer to avoid poor working of the scanner for overloading.
- Please use films of standard size.
- Cleaning : Please make sure the scanner is clean before using so as to produce a clean image.
- Non use period : The USB cord or adapter should be unplugged from the computer or plug seat when the unit is left unused for a long period of time.

3.Check Package Contents

Please check your scanner package whether it contained as followed objects ,if lack of any object, please contact with retailers whom you buythe product from.

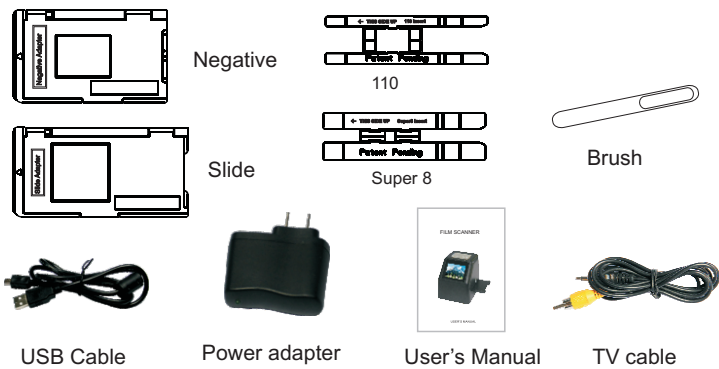

⚠ Please stretch into clean from product side,when you use cleaning brush to clean backlight

4.Product Structure Diagram

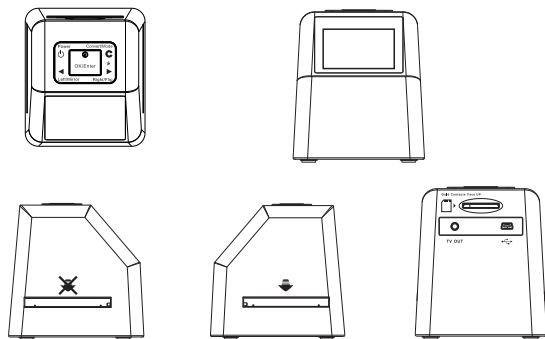



2

(8).Connect to computer
Under main menu mode, press , until , press **OK/Enter** .
After successfull connecting to computer , you can view and edit captured pictures.



11

(7).Formatting

In the main menu, press  to "",press "OK/Enter" button to enter.

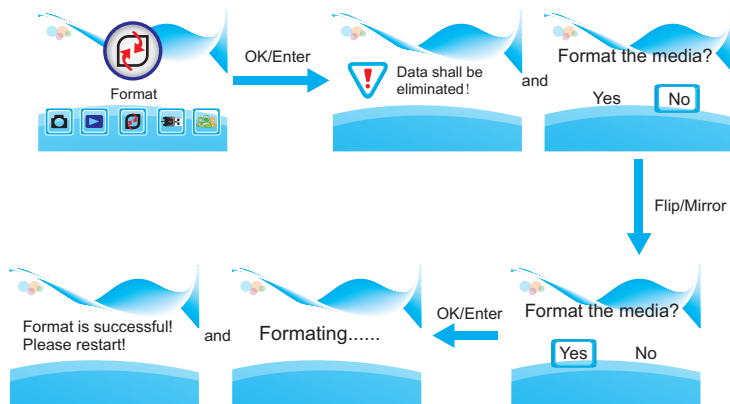

Note: After using this function, all the information in the Micro SD card will be deleted, please note it !

5.Slide and negative holder loading method

Loading Negatives

a. Hold up the negative toward the light. Face the right side of the negative to yourself.

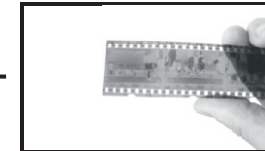

b. Take out negative holder out. Let the side with "open" logo face yourself, and let the side with "◀" logo face down. Open the negative holder, then place negative into recessed area in the holder. Close the negative holder and press the edges so that it locks in place

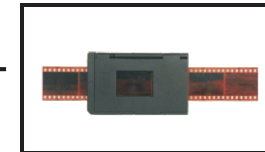

c. Insert the negative holder into the slot on the right side of the film scanner .



Loading Slides



a. Hold up the slide toward the light. Face the right side of the slide to yourself. (we don't provide white small holder)



b. Take out slide holder out. Let the side with "open" logo face yourself, and let the side with "◀" logo face down. Open the slide holder, then place slides into recessed area in the holder. (films also could be loaded as a strip into the slide holder, forming drawer type as below picture) Close the slide holder and press the edges so that it locks in place



c. Insert the slide holder into the slot on the right side of the film scanner as shown.

4



Enter

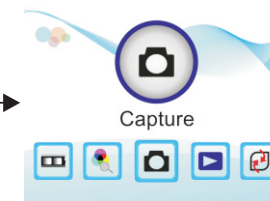

(5).Setting Language

Under main menu mode, press , until , press **OK/Enter** to chose language, then press and **OK/Enter**, one of following 8 language can be set: English、Franch、German、Italian、Spanish、T-Chinese、S-Chinese、Japanese.



OK/Enter



(6).Resolution Choosing

Under main menu mode, press , until , press **OK/Enter** to enter into Resolution Choosing Mode, you can choose 14M or 22M(interpolation)



OK/Enter



9

(4).How to playback captured picture

In main menu, press , until , press **OK/Enter** enter the picture auto-playback mode press again to stop auto playback and you can view captured pictures manually, you can press to view ; press **OK/Enter** again enter picture editing mode, you can rotate : delete, exit, save, and "home"back to main menu.

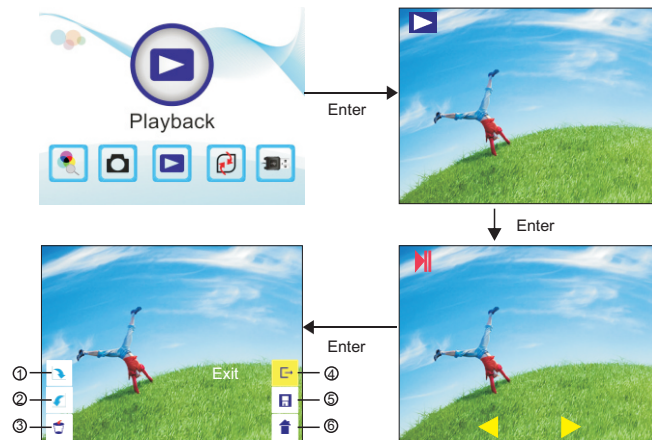

- 1 The current picture rotate 90 degree clockwisely
- 2 The current picture rotate 90 degree anticlockwisely
- 3 Deleting the current picture from memory card
- 4 Exit the submenu edit mode, back
- 5 Saving the current edited picture
- 6 Exit the submenu edit mode, back to scan

⚠:Handle films with care to avoid scratches or finger prints(for the best use cotton gloves when handling films)It is recommended to use compressed cotton to remove any dust on the films.

6.Operation Guided

(1).Introduction of Memu

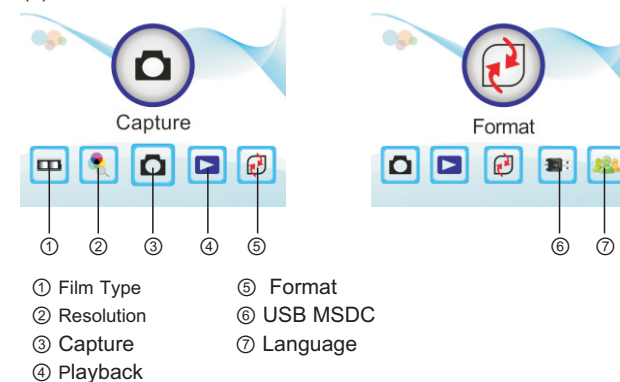

(2).Capture Picture

- a.Before scanning please make sure the inner backlight panel is clean.

Note: You can use the provided brush to clean the screen.

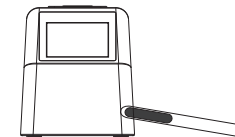

b. In main Menu mode press **OK/Enter** enter capture mode, then press **Mode** then press **OK/Enter** the picture would be captured.

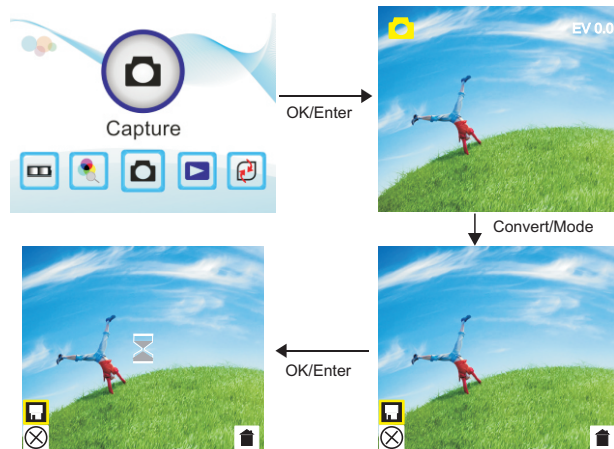

c. Before pressing **Mode** to capture picture, you can press left button to mirror and press right button to flip the current picture. And you can press OK button to set Exposure. Then press Convert/Mode button again back to main menu.

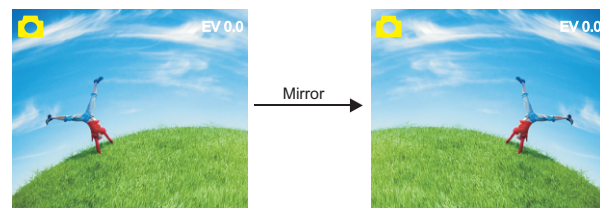

Press left key, the image position be altered from left to right

6

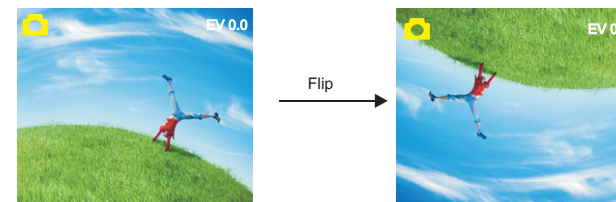

Press right key, the image position be altered from up to down

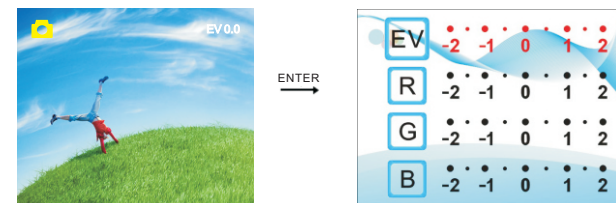

Press ENTER to set exposure compensation

(3).Operation Guide

In main menu, press **Left/Right**, until **Film Type**, then press **OK/Enter** you can chose negative(110、135、126KPK)、slide(110、135、126KPK、 Super8)、B&W(110、135、126KPK)

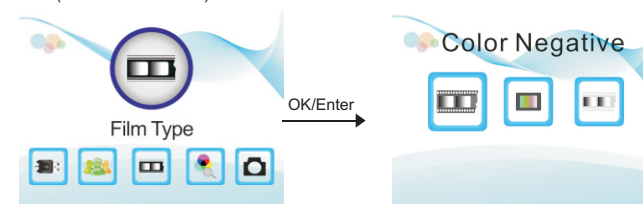

7