

für Verwendung in explosionsgefährdeten Bereichen

Wichtig: Vor Bedienung bitte Gebrauchsanweisung lesen !

Beschreibung:

KS-9800 ist eine Handlampe für den Gebrauch in potentiell explosionsgefährdeten Bereichen. Betrieben wird die Lampe von drei C Alkaline-Zellen. Sie hat zwei Schaltstufen für Stark- und Normallicht.

Batterien:

Benutzen Sie nur folgende ALKALINE Batterien:

- Typ: ENERGIZER
E93
DURACELL
MN1400
RAYOVAC 814
VARTA 04914

Eigenschaften:

- High power Cree LED
- IP 67
- Stark- und Normallicht
- schlag- und stoßgeschütztes Gehäuse

Zertifizierungen:



UL USA : UL FILE NO.: OERX.E324236
Class I Div 1 & 2 Grp ABCD
Class II Div 1 & 2 Grp EFG
Class III Temp Code: T4



IECEX Worldwide : IECEX CERTIFICATE NO.:
IECEX UL 13.0008X
Ex ia IIC T4 Ga



Ex Europe : ATEX CERTIFICATE NO.:
DEMKO 13 ATEX 1112940X
Ex II 1G Ex ia IIC T4



0539

Standards:

1. UL913, 7th edition
2. CAN/CSA C22. No.157-92
3. EN60079-26 : 2007
4. EN60079-0 : 2009
5. EN60079-11 : 2007
6. IEC60079-26 : 2006
7. IEC60079-0 : 2007
8. IEC60079-11 : 2006

Sicherheitswarnung:

1. Die Schraube zum Sichern des Lampenkopfes sollte jederzeit fest angezogen sein.
2. Niemals direkt in die Augen leuchten.



IECEX

Installation:

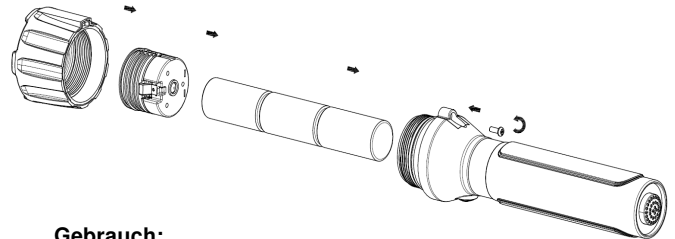

Gebrauch:

Zum Einschalten betätigen Sie den Druckknopf am hinteren Lampengehäuse. Einmaliges Schalten (Starklicht), zweimaliges Schalten (Normallicht), dreimaliges Schalten (Lampe erlischt.

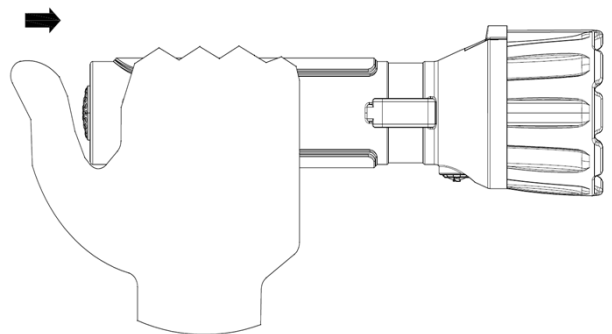

Gebrauch der Batterien:

Lampe nicht in explosionsgefährdeten Bereichen öffnen.

Um jegliches Explosionsrisiko auszuschließen, verwenden Sie nie gleichzeitig gebrauchte und neue Batterien oder Batterien unterschiedlicher Hersteller. Laden Sie diese Batterien entsprechend der Anweisung des Herstellers.

Entfernen Sie die Batterien, falls Sie die Lampe längere Zeit nicht gebrauchen.

Technische Daten :

| | Starklicht | Normallicht |
|-------------------|------------------|-------------|
| Lichtstrom | 125 lm | 80 lm |
| Leuchtdauer | 40 h | 60 h |
| Reichweite | 185 m | 144 m |
| Fallresistenz | 1 m | |
| Impressionsschutz | IP 67 | |
| Abmessungen | 225 x 60 x 85 mm | |
| Gewicht | 190 g | |

Serviceformular

Kundenname:

Kaufdatum:

Fehlerbeschreibung :

FLASHLIGHT FOR USE IN HAZARDOUS LOCATIONS



IECEX

Important:

READ THESE INSTRUCTIONS BEFORE USE AND MAINTAIN THE FLASHLIGHT FOR REFERENCE.

Instruction:

Thank you for choosing KS-9800 as your best selection with the highest standards and certifications approved.

Product:

KS-9800 Industrial Flashlight
For Use in Hazardous Locations

Battery:

3 x C ALKALINE batteries

Batteries type: ENERGIZER E93
DURACELL MN1400
RAYOVAC 814
VARTA 04914

Features:

- High intensity Cree LED
- Two ways position Clip
- The clamp fixed on
- conspicuous location
- On / Off Button
- Water Proof

Certifications:



UL USA : UL FILE NO.: OERX.E324236
Class I Div 1 & 2 Grp ABCD
Class II Div 1 & 2 Grp EFG
Class III Temp Code: T4



IECEX Worldwide : IECEX CERTIFICATE NO.:
IECEX UL 13.0008X
Ex ia IIC T4 Ga



Ex Europe : ATEX CERTIFICATE NO.:
DEMKO 13 ATEX 1112940X
Ex II 1G Ex ia IIC T4



0539

Standards:

1. UL913, 7th edition
2. CAN/CSA C22. No.157-92
3. EN60079-26 : 2007
4. EN60079-0 : 2009
5. EN60079-11 : 2007
6. IEC60079-26 : 2006
7. IEC60079-0 : 2007
8. IEC60079-11 : 2006

Safety warning:

Do not flash the light beam directly to human's eyes, it may cause temporarily dizzy, please leave away, and close your eyes immediately when light beam moves toward to your eyes directly. Batteries replacement can be only performed when in non-hazardous location. Always use this flashlight by following regular and legal rules governed by industrial control and management authority from every country.

Installation:

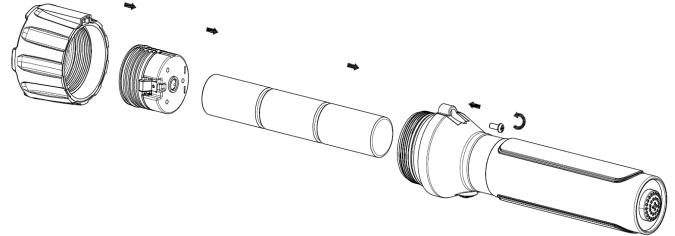

On and off button:

Lighting by pressing on/off rubber button on the end of KS-9800 by turning it on, and turn it off as well.

Operation:

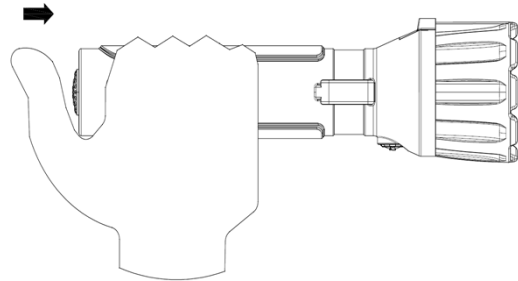

Change of batteries:

Warning – Replace batteries only in non hazardous areas. Please unscrew the front cap, please do not directly touch inside heat sink set, it might be a bit hot after long time using, remove the cap, remove the reflector with LED inserted, avoiding touching inside surface of reflector, it might affect the performance of lighting. Always using proper batteries to go with KS-9800, do not mixed brand using. Always replace all batteries at the same time, filling new batteries in corresponding to (+) positive and (-) negative mark sticker inside of battery case by three rules to batteries:

- a Use only battery type of Energizer E93 or Duracell MN1400 or Rayovac 814 or Varta 04914.
- b Do not mix used batteries with new batteries.
Do not mix batteries from different manufacturers.

Filling 3 pieces C type batteries with positive (+) pole identically Upward direction, when re-insert reflector set, with smart design, please gently insert it, it could slowly slide into groove and fit it well, please do not over-force on it. Closing the flashlight by screwing the cap right to end of the screw thread. And with long period of time without using the flashlight, batteries should be removed out for avoiding battery leaking which may cause damage to flashlight's life.

WARNING: The screw should be secured tightly after replacing of batteries.

Complaint data sheet

Customer:

Date of purchase:

Description of trip :
