

DDL-3

Digital delay line

USER MANUAL FOR USE AND MAINTENANCE

Read the instructions before using the device.

Keep this manual for periodic usage.



Sams elektronik d.o.o.
48 Zivka Davidovica st.
11050 Belgrade
Serbia
Tel/Fax: +381 11 3806 253
+381 11 2402 212
sams@sams.rs
www.sams.rs

Copyright © 1999 - 2014 Sams elektronik d.o.o.

Published: 21 january 2010.
Updated: 21. november 2014.



WARRANTY

Dear User,

Thank you very much for purchasing our product.

Your purchase is a wise investment. The equipment you have purchased is manufactured with great care from high-quality parts and materials. It is designed to fully meet the needs according to specifications, if properly installed, used and maintained according to the enclosed instructions.

Any technical failure or deficiency that occurs during the warranty period specified on the invoice of the purchased equipment will be inspected and serviced by Sams elektronik doo or an authorized service center of the manufacturer, with the conditions set out in the warranty statement.

THIS DEVICE IS INTENDED FOR PROFESSIONAL USE.**WARRANTY STATEMENT**

1. Product has declared characteristics. Within the warranty period, manufacturer ensures the removal of technical failures, product defects or replacement of products if declared characteristics of the product are changed.
2. If the goods are not delivered as specified with the contract, the consumer has the right to request from the manufacturer / service provider to eliminate the lack of conformity, without charge, repair or replacement, or to request an appropriate price reduction or terminate the contract.
3. Any repair or replacement must be made within a reasonable time without significant inconvenience to the consumer, taking into account the nature and the purpose for which the consumer has purchased the product.
4. The consumer has the right to terminate the contract, if he can realize the right to repair or replacement, or if the manufacturer / servicer has not completed repair or replacement within a reasonable time or if the manufacturer / servicer did not perform repair or replacement without significant inconvenience to the consumer.
5. The consumer may not terminate the contract if the lack of conformity of the product is negligible.
6. The product will function properly when used in accordance with the user manual.
7. Period of servicing the product is 6 years from the launch on the market.

The product purchased outside the territory of Serbia does not fall under the terms of this warranty, only to 1 year factory warranty from date of purchase.

TERMS OF WARRANTY

1. The warranty period begins on the date of sale referred in the invoice.
2. The buyer loses the right to warranty if the defect cause failure from not following the user manual instructions, improper installation, comes to mechanical damage during use, repairs and modifications by unauthorized persons, installation of non-genuine spare parts, and if the buyer does not comply with all warnings listed in the user manual.
3. The warranty is voided if the device is damaged during the disturbances from the environment, natural disasters (floods, hail, etc.), suffered an electric shock or lightning strike.

IMPORTANT NOTES

1. Be sure to thoroughly read the user manual.
If you have any doubts about the instructions, contact the technical support of the manufacturer.
2. Before contacting for technical help, please make sure that are provided with all necessary conditions for normal operation.
3. If the malfunction or defect in the device does not eliminate within a reasonable time from the date of failure, the warranty period shall be extended for as many days as the unit is in service.
4. For all maintenance interventions shall solely be authorized services listed in this Warranty Certificate.

SAFETY WARNINGS

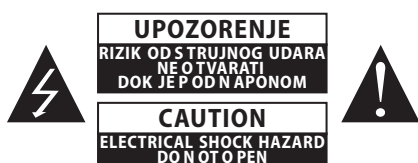

IMPORTANT SAFETY

WARNING

TO AVOID RISK OF FIRE OR ELECTRIC SHOCK
DO NOT EXPOSE THE UNIT TO MOISTURE OR RAIN



The symbol "lightning in a triangle" is to alert the user to the presence of high voltage. In poor conditions the user may be exposed to shock.



The symbol "exclamation mark in a triangle" is to alert the user to comply by the terms of use in user's manual, which is supplied with the device.



CLASS I DEVICE

Grounding is connected to the chassis of the device.

The power supply is protected with fuse against overload.

WARNING

TO AVOID ELECTRIC SHOCK, DO NOT OPEN COVER.

DEVICE MAINTENANCE REQUIRES PROFESSIONAL PERSON AUTHORIZED BY THE MANUFACTURER.

1. Read all safety and operating instructions before using the device.
2. Keep all safety and operating instructions.
3. Follow the instructions from the user manual.
4. Do not upgrade device, except in the case advised by the manufacturer.
5. Do not use the device in the presence of water and / or moisture.
6. Do not pour water or moisten the device with any type of liquid.
7. Openings on device are provided for ventilation.
8. Do not block air flow through the ventilation openings.
9. This product is powered by AC ~ 230V ± 10%, 50Hz.
10. This product is equipped with a three-wire cord with grounding.
11. This device is equipped with a protective fuse in the power outlet. Do not bypass fuse.
12. Do not replace the fuse. Replacement can be made by a person authorized by the manufacturer.
13. Do not bend the power cord so that it can be damaged.
14. Connect connectors as in the enclosed instructions. Deviations from the allowed values predicted for the inputs and outputs of the device can cause severe damage and warranty void.
15. Do not use the device in an environment that contains flammable or explosive materials in any physical state.
16. Turn off the power cord before cleaning. Do not use liquid, aerosol or flammable cleaners. Use only a dry cloth.
17. Servicing is performed by a qualified person. Removing the cover user is exposed to high voltages.
18. Never use the device when the cover is open and the device is powered on.
19. Do not expose to extreme high or low temperatures.
20. Do not expose to sudden temperature changes.
21. Call service in the following cases:
 - The power cord or plug is damaged
 - Liquid or foreign objects is inside the device
 - The machine is exposed to water and moisture
 - The device does not function according to specification
 - The unit has been dropped or damaged
 - The characteristics are significantly changed
22. Use only specified replacement parts.
23. Professional person authorized by the manufacturer must check the device after completion of service.
24. Allow a free rack unit (1RU) above and below the device for ventilation or put rack fan under the device.

Pictures and drawings listed in this user manual are for information purposes only and may differ from the actual device. Design and specifications of the device may change without prior notice.

TECHNICAL SUPPORT AND SERVICE

Sams elektronik has made every effort to ensure that the equipment works in perfect condition. In the event that problems that occur can not be resolved, or if you have any questions regarding this equipment or information about other products produced from Sams elektronik, contact your local sales representative or call Sams elektronik directly through one of the ways listed below:

Sales: +381 11 3806 254

Technical support: +381 11 2402 212

Service: +381 11 4056 051

Email:

Sales - sasa@sams.rs

Technical support and service - sams@sams.rs

Web site: www.sams.rs

Address:

SAMS ELEKTRONIK d.o.o.

48 Zivka Davidovica st

11050 Belgrade

Serbia

TABLE OF CONTENTS

Description	Page
UNPACKING AND INSTALLATION.....	6
MAINTENANCE.....	6
REMOVAL AND STORAGE.....	6
DESCRIPTION.....	7
INSTALLATION.....	8
NOTES	9

UNPACKING AND INSTALLATION

The box contains:

- Device
- Power corde
- User manual (optional)

Before use, check the contents of the box. For any deficiency report to the seller or the manufacturer of the product.

DEVICE IS INSULATED BY PROTECTIVE WRAP AND PACKED IN A CARDBOARD BOX. DEVICE IS SENSITIVE TO SHAKES AND DROPS. HANDLE WITH CARE DURING TRANSPORT AND ASSEMBLY.

Check if the product is damaged during transport.

PROCEDURES FOR SAFE USE OF THE DEVICE:

1. - Remove the protective wrap from the chassis.
- For devices that are AC 230V / 50Hz powered, the device is supplied with power cord.
- Use only power corde that comes with the device.
2. Device is mounted in a 19" special-purpose rack cabinets designed for this type of device. Screw device with four screws. Screws for fastening are not supplied with the device.
3. The device must be connected to ground. A device that is not connected to the grounding does not function properly according to factory declarations and can cause adverse effects on users and other equipment.
4. Strictly comply to all steps for proper connection of devices in the system.

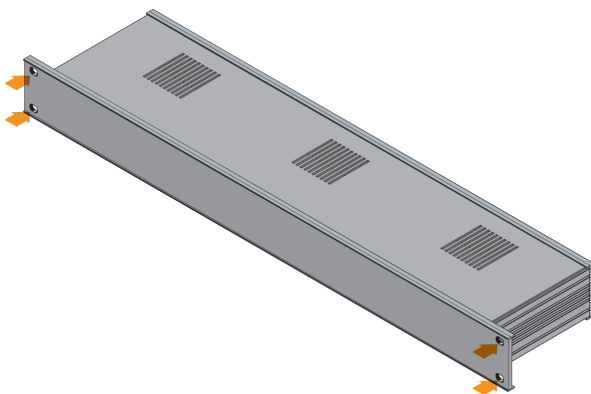

Places for fastening

MAINTENANCE

The system maintains only person authorized by Sams elektronik doo.

Any voluntarily opening device, upgrading or servicing is strictly prohibited and is subject to warranty void, and the possibility of injury.

REMOVAL AND STORAGE

1. Before dismantling the device, switch off the power, remove the power cord and remove all other connectors.
2. Remove the four screws for fastening.
3. Remove the device from rack cabinet.
4. Wrap the machine in the foil to protect it from dust. Package it in a box.
5. The device must be stored in a room without moisture.

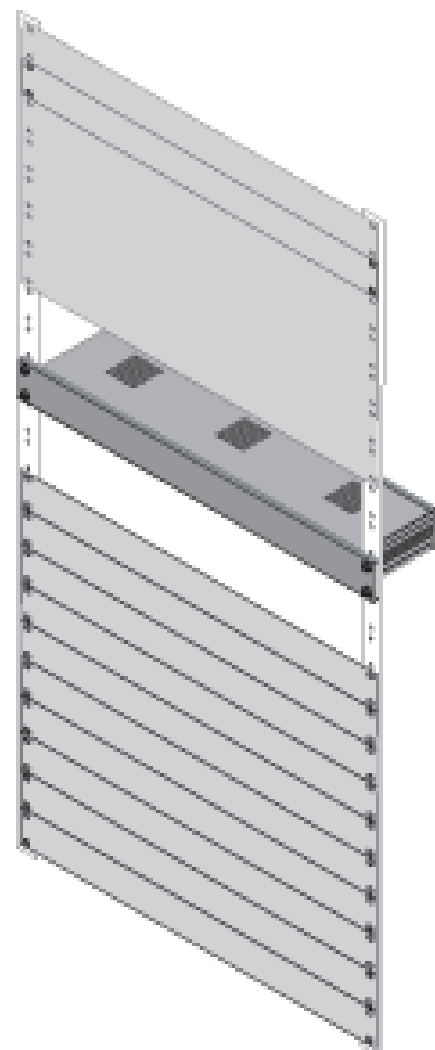

Illustration - mounted device

DESCRIPTION

DDL-3

Digital delay line



- High quality
- Delay up to 5 sec or 1sec
- Delay adjustment in frames, fields or milliseconds
- Panel lock
- Stereo balanced analog input and output
- 24 bit conversion, 48 KHz sampling rate
- 24dBu level
- Power down memory recovery
- Power off / unit fail bypass relay without delay

The DDL-3 products process up to 2 analog audio channels, with 24 bit AD/DA conversions. A/D and D/A signal path is fully differential from input to output, providing best audio performances. The DDL-3 it's easy to program by using the menu on front panel. During absence of power DDL-3 will pass through incoming audio signal without delay and interruption by use of bypass relay's inside the unit.



TECHNICAL SPECIFICATIONS

Specifications and designs are subject to change without notice

GENERAL INFORMATION

- Code: 006.100
- Weight: 2 Kg
- Type: 1RU rack frame
- Dimensions: 1RU x 19" x 150mm
- Delivery includes: device, power corde, user manual

INPUT

- Impedance: > 40Ω 0dB
- Input level: Balanced, max. +16dB
- Number: 2, female

OUTPUT

- Impedance: 600Ω
- Output level: 0dB, balansiran, max. +24dB
- Number: 2, XLR male

POWER

- Voltage: ~230V AC ± 10%
- Power: 30W
- Frequency: 50Hz
- Overload protection: front Mounted Circuit Breaker

TEMPERATURE

- Performance: 5-40°C
- Operating: 0-50°C

ORDERING INFORMATION

Code	Name	Description
006.100	DDL-3	Digital delay line

INSTALLATION

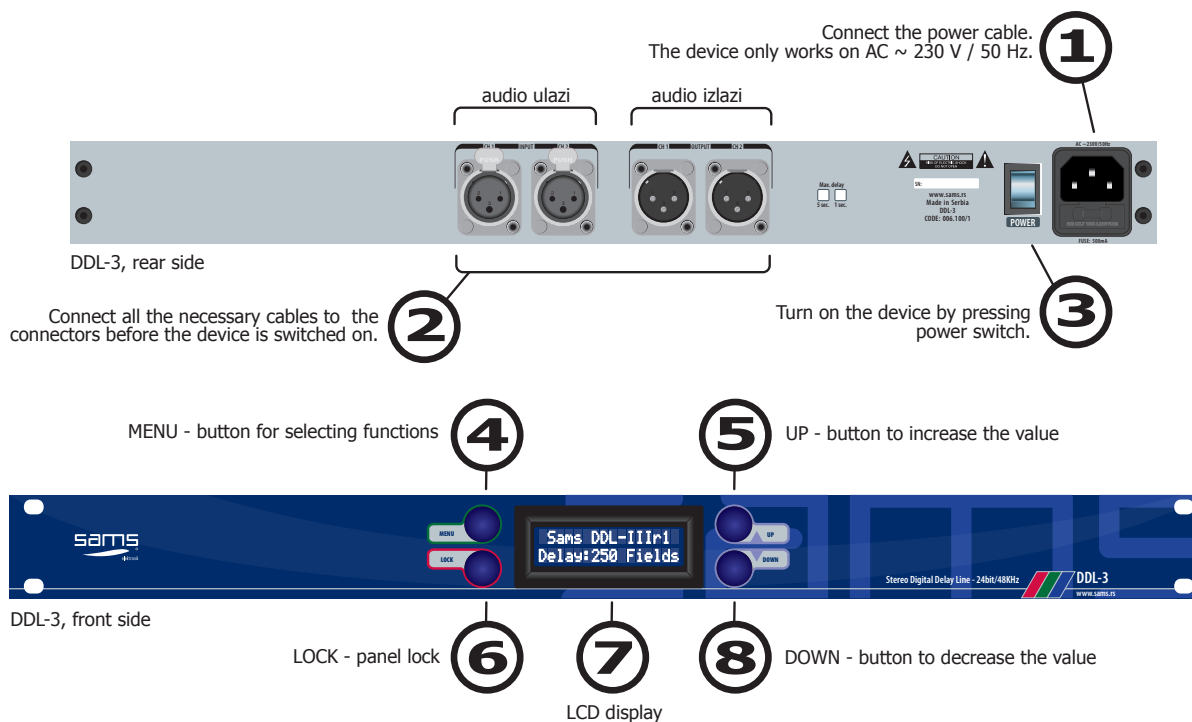

After switching on the device, wait about 10 seconds to initialize. Pressing the MENU button (4), shall be setting delays mode selection:

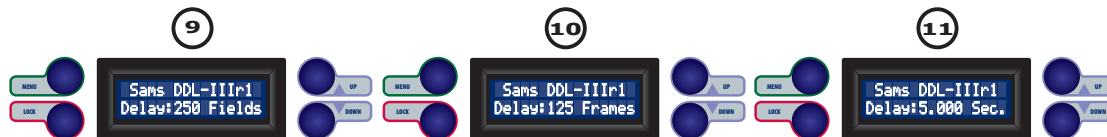

- 9 Setting the delay of 0-250 fields with step min. value of one field
- 10 Setting the delay of 0-125 frames with step min. a value of 1 frame
- 11 Setting the delay of 0-5 seconds with step min. value 1 millisecond

The adjustment is done in the following way:

- When selecting the type of delay (fields, frames or milliseconds), with the keys UP and DOWN (5 and 8), set the desired time delay in selected unit.
- Delay is currently running after selecting.
- If you change the type of delay, the value of the new unit will be adjusted in relation to the previous setting.

6 - LOCK button - to protect from accidental changes.

