

USER MANUAL

Revision 1, September 2002

IMPORTANT: Read these instructions before installing operating or servicing this system.

ERGOLIFT-WL

WALL- LIFT

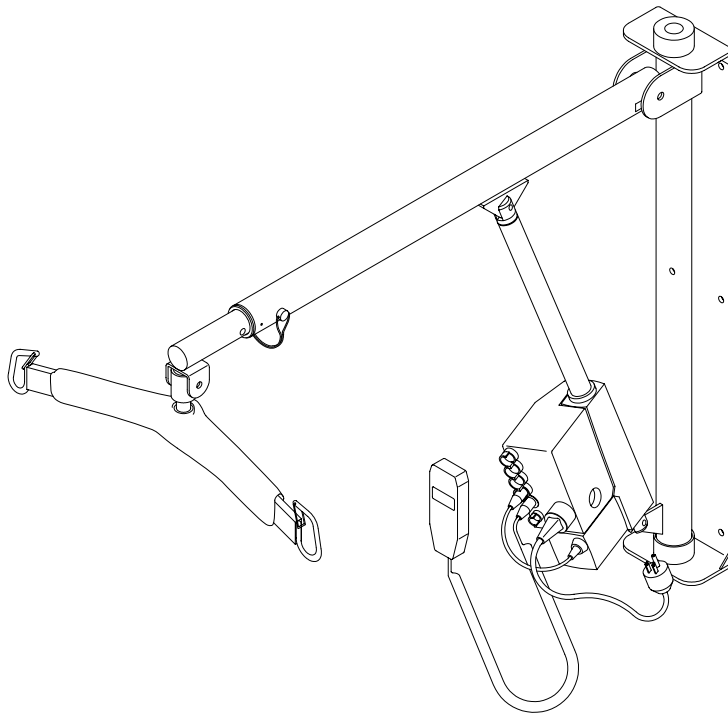

**DO NOT DESTROY
KEEP MANUAL WITH THE LIFT AT ALL TIMES.**

BHM MEDICAL INC., 2001 TANGUAY STREET, MAGOG, QUEBEC, CANADA, J1X 5Y5

Instruction manual Part # 001.04525

BHM *Medical Inc. designs and manufactures quality engineered patient lifting equipment for the care of the disabled in hospitals, nursing homes and home care.*

Please take the time to read the entire manual, including the section on "Safety Instructions and Warnings". It contains important information that will allow you to take advantage of all the characteristics of your BHM patient lift.

BHM Medical Inc. Credentials

- FDA Registration # 9681684
- CE mark (European Union Listing)
- Global Operations for in-warranty and out-of-warranty service support for all patient lifts.
- Each finished ERGOLIFT-WL is individually tested in our laboratory.
- Lifting Capacity is 350 lb. (160 kg). Engineering safety factors exceed European Standards.
- Complete range of patient lift slings and supports designed and manufactured by BHM Medical Inc. using medical quality materials and fabrics.
- ISO 9001

APPROVALS:

CSA 601.1
UL 2601.1
EN 60601.1
EN ISO 10535 (Lifting device) SGS
UK Test Report: DUR22107/AC/OO

Note: BHM Medical is constantly improving its products. For this reason, it may be possible to encounter a modification of product without revision of this manual.

Thank you for trusting your BHM Medical Partners.



How to contact us:

*BHM Medical Inc.
2001 Tanguay Street
Magog (Quebec)
Canada J1X 5Y5*

Phone: (819) 868-0441

*🕒 Service calls during business hours - extension #109
(8:00-12:00 and 1:00-5:00 p.m. E.S.T.)*

*🕒 Service calls outside regular business hours
Extension #6199 (you must press the pound key)*

Fax: (819) 868-2249

Web site: www.bhm-medical.com

Email: bhm@bhm-medical.com

TABLE OF CONTENTS

INTRODUCTION	4
HOW TO USE THIS MANUAL	4
EQUIPMENT IDENTIFICATION	4
RECEIPT OF EQUIPMENT	4
KEY TO SYMBOLS	4
SAFETY INSTRUCTIONS AND WARNINGS	5
DESCRIPTION OF EQUIPMENT	7
ERGOLIFT-WL	7
PARTS DESCRIPTION	7
DIMENSIONS	7
INSTALLATION	8
HOW TO INSTALL THE ERGOLIFT-WL	8
ACTUATOR INSTALLATION	9
BOOM INSTALLATION	9
CARRY BAR INSTALLATION	10
OPERATION	10
HOW TO USE THE ERGOLIFT-WL	10
ANTI-CRUSH FEATURE	11
STRETCHING THE BOOM	11
BHM ERGOFIT SLING	12
HAMMOCK SLING	12
SLING PLACEMENT - FROM CHAIR OR WHEELCHAIR	13
SLING ATTACHMENT OPTIONS	14
QUICK-FIT SLING	17
HYGIENIC SLING	19
SLING INSPECTION AND CARE	20
MAINTENANCE	21
DAILY CHECKLIST	21
INSPECTION AND CLEANING	21
HANDLING AND STORAGE	21
BOOM ACTUATOR REPLACEMENT	21
CARRY BAR REPLACEMENT	22
ANNUAL INSPECTION	22
MAINTENANCE INSPECTION CHECKLIST	23
TROUBLESHOOTING	25
ACCESSORIES	26
LOG BOOK	27
WARRANTY	29

INTRODUCTION

How to Use this Manual



DO NOT ATTEMPT TO USE THIS EQUIPMENT WITHOUT UNDERSTANDING THIS MANUAL.

To ensure safe operation, read carefully the entire manual, especially the section on "Safety Instructions and Warnings", before installing, operating, or servicing this equipment.

If anything is not completely understood, please contact your supplier for more details. Failure to comply with warnings in this manual may result in injuries.

Keep this manual with the lift and refer to it as required. Contents of this manual are subject to change without prior notice to users.

Throughout this manual, the following symbols may appear. Pay particular attention to the information provided under these headings. These special annotations are easily recognized as follows:



WARNING: this symbol is intended to alert the user to hazards or unsafe practices which could result in serious bodily harm.



CAUTION: this symbol is intended to alert the user of the presence of important operating and maintenance instructions which could prevent product damage or possible personal injuries.



NOTE: this symbol offers helpful information concerning certain operating procedures.

You can purchase additional copies of this manual by contacting your supplier. Include the User

Manual product number and equipment identification numbers.

Equipment Identification

The unit's identification number (specification, model and serial number) appears on a silver nameplate attached to the back of base.

Receipt of Equipment

Upon receipt of the equipment, verify it against the packing list to ensure it is complete and inspect the equipment for possible damage due to shipping. If there is any damage, DO NOT use the equipment. Notify the carrier immediately to file a claim. Provide complete information concerning damage claims or shipping errors to your supplier. Include all equipment identification numbers and group part numbers (if any) as described above along with a full description of damaged parts.

Key to Symbols

The following symbols are used on lifter's attachment labels:



This symbol is required to be displayed on regulated products for sale in the European Market. It indicates that the product complies with applicable European Directives related to health, safety, environment and consumer protection.



Safe Working Load represents the maximum load the lifter is rated for safe operation.

The following symbols are used on sling labels and related to washing instructions:



Maximum washing temperature is 60°C (140°F) for permanent cycle.



Do not use bleach.



Do not dry clean.



Tumble dry low temperature.



Do not iron.

Please refer to individual sling labels for complete instructions regarding washing and drying.

SAFETY INSTRUCTIONS AND WARNINGS

A. GENERAL

- **IMPORTANT – READ CAREFULLY THESE INSTRUCTIONS OR SERIOUS INJURIES MAY RESULT.**
- **KEEP THESE INSTRUCTIONS WITH THE LIFT AT ALL TIMES.**
- **READ OPERATING MAINTENANCE INSTRUCTIONS IN THIS MANUAL BEFORE INSTALLING, OPERATING, OR SERVICING THIS EQUIPMENT.**
- **YOUR LIFT is for transferring patients only. Do not use the lift for any other purpose.**
- **ALWAYS carry out the daily check list before using the lift.**
- **BHM Medical ERGOLIFT-WL is specifically designed for BHM Medical slings and accessories. Slings and accessories designed by any other manufacturer are prohibited and will void BHM Medical's warranty. Use only BHM Medical slings and accessories to maintain patient safety and product utility.**
- **BHM Medical ERGOLIFT-WL is intended to be used for patients within the specified weight limit indicated for the lift. Do not attempt to lift more than the weight limit indicated.**
- **BEFORE attempting to transfer, the patient must be assessed by a qualified professional.**
- **BHM Medical ERGOLIFT-WL must be used by a caregiver with proper training to work with the patient to be transferred.**
- **ONLY trained and qualified caregivers should transfer a patient. DO NOT attempt to use the lift if you have not been properly trained to do so.**
- **ALWAYS be prepared before attempting to transfer a patient.**
- **DO NOT use a sling that is not recommended for the lift.**
- **NEVER use a damaged, torn or frayed sling.**
- **ALWAYS place the sling around the patient according to the instructions enclosed.**
- **FOLLOW lifting procedures outlined in this manual.**
- **USE all controls and safety features only according to the rules specified in this manual. Never attempt to force a control or button on the lift.**
- **IMPORTANT: Keep all components of the lift clean and dry, and have electrical and mechanical safety checkpoints done as instructed in the "Maintenance" section of this manual.**
- **REPLACE any precautionary or instruction labels that cannot be easily read.**
- **DO NOT attempt to manoeuvre the lift by pushing on the mast, motor shaft, boom or patient.**
- **ALWAYS manoeuvre the lift with the handset provided.**
- **DO NOT use an electric lift in a shower.**

B. SHOCK PREVENTION

- **AVOID violent shock during transportation.**
- **DO NOT touch or use a lift with bare conductors or a damaged power cord. Electrically live equipment can electrocute a patient. If the lift has any exposed or damaged wires, contact your local dealer immediately.**
- **DO NOT cut or remove the round grounding prong from any plug. All BHM lifts are equipped with three-prong plugs to protect from shock hazard or electrocution. Any two-prong electrical outlet must be replaced with a properly grounded three-prong outlet**

SAFETY INSTRUCTIONS AND WARNINGS

B. SHOCK PREVENTION

according to the National Electrical Code and local codes. It is the responsibility of the customer to have the work done by a qualified electrician.

- **DO NOT** splash or expose electric parts of the device to water or moisture.
- **CHECK** nameplate for voltage and cycle requirements. These requirements differ by country. Do not attempt to use the lift in an area that has a different voltage and cycle.

C. EQUIPMENT WARNING LABELS

- **Inspect** all precautionary labels on the equipment. Order and replace all labels that cannot be easily read.

DESCRIPTION OF EQUIPMENT

ERGOLIFT-WL

The ERGOLIFT-WL wall lift is an excellent option for those situations where the ceiling lift or the floor lift is not quite the right solution. The wall lift can be mounted on a secure post next to a wall or next to a pool or hot tub.

With its ability to rotate, it allows access to a wide range, and, since the lift can be mounted at any height, the lift can be installed at just the right height for you. Extra wall brackets are available so you can use the lift in more than one location.

- Portable
- Built-in control box
- Weight (movable part) – 13.5 kg (30 lb.)
- Lifting capacity – 160 kg (350 lb.)
- Soft start & stop movement
- 360 degrees patient rotation capability / even at maximum height
- Universal carry bar
- Unit rotates 180 degrees
- Actuator with anti-crush mechanism.
- Water resistant control handset.
- Water resistant electronics and circuit board.
- Padded swivel carry bar.
- Vertical displacement speed – 1.75 cm/sec. (7 in/sec.)
- Meets CSA 601.1, CE and UL 2601-1 requirements.

PARTS DESCRIPTION

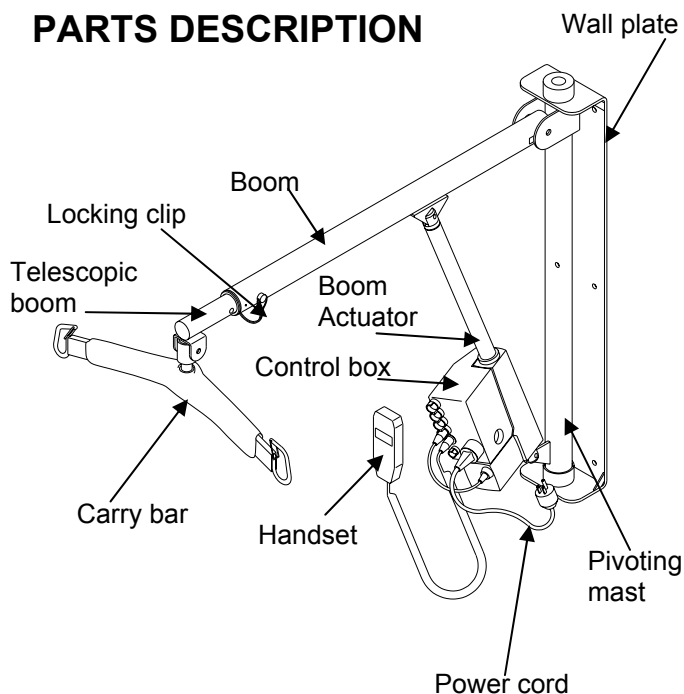

DIMENSIONS

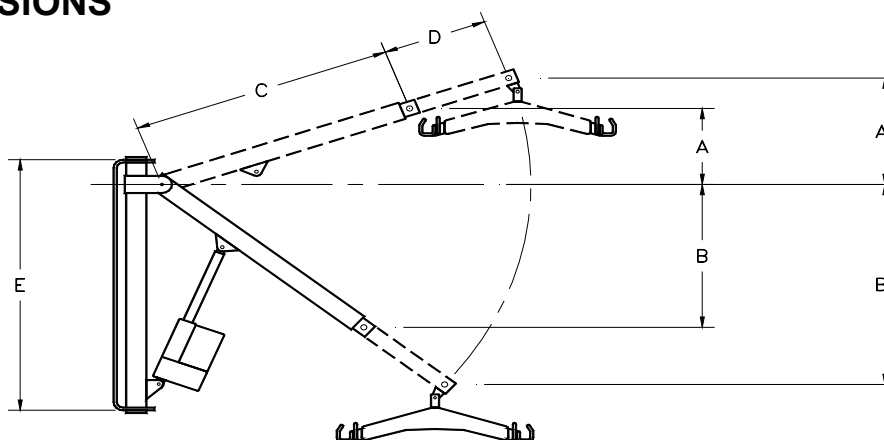

CAPACITY	A	A'	B	B'	C	D	E
KG/LBS.	CM/IN	CM/IN	CM/IN	CM/IN	CM/IN	CM/IN	CM/IN
160/350	30/12	41/16	53/21	75/29	84/33	30/12	79/35

INSTALLATION

How to install the Ergolift-WL

Before installing your wall bracket, determine where it will be positioned and what kind of structure you have (wood, concrete)

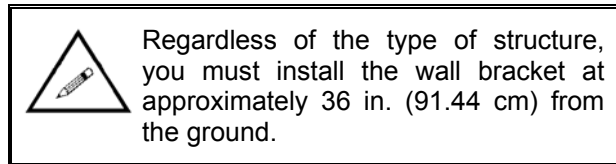

For all type of structures, put the plate against the wall and mark bolts position with a lead pencil. Remove the plate and drill holes.

Bracket installation

Type of walls

a) Wood structure

Fix the plate against the wall and screw lag bolts with a 9/16" socket.

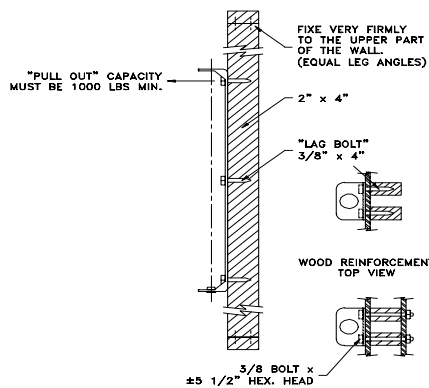

b) Concrete structure

Insert 6 concrete anchors 3/8" with a hammer into the concrete structure. Place the plate against the wall and screw bolts into the anchors

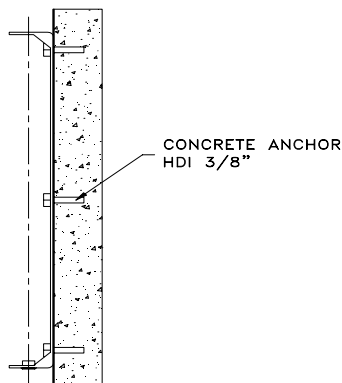

c) Installation between beams

If your plate is positioned between two wooden beams, you must install 3 unistruts to fix the plate. Be sure to align the unistrut with holes previously drilled. Fix unistruts into beams with lag bolts 3/8" and flat washers.

Insert 2 strut nuts on each unistrut and align them with holes then do a quarter-turn to lock the nut.

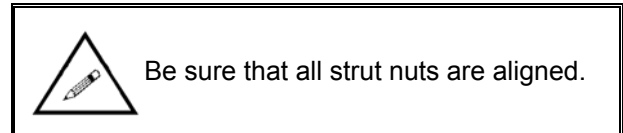

Put the wall bracket on unistruts and affix it by screwing bolts into strut nuts.

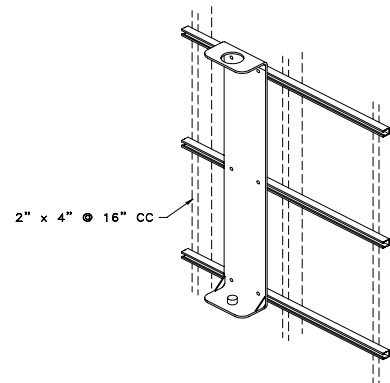

View of the installation from the side.

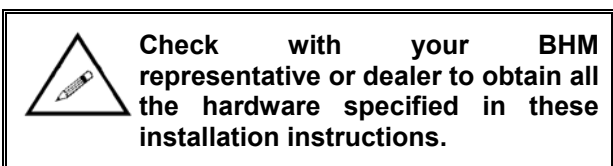
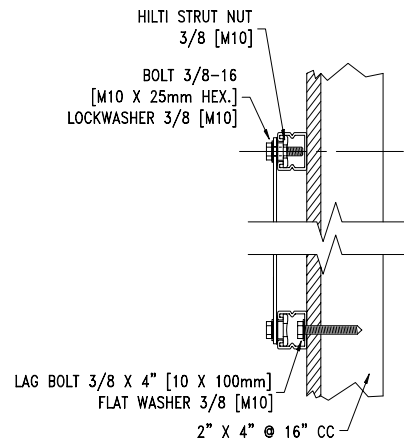



Check the strength of the installation before using it.

Actuator Installation

Insert the upper part of the actuator between the mid-boom brackets.

Insert the clevis pin and block it by inserting a split ring into the clevis pin.

Insert the lower part of the actuator between the mid-mast brackets.

Insert the clevis pin and block it by inserting a split ring into the clevis pin.



Be sure that the split ring is completely inserted into the clevis pin.

Boom Installation

To install the boom, insert the upper part into the wall plate hole.



Then insert the lower part of the mast into the metal pivot.



Plug the actuator and the handset plugs into the control box.

Plug the control box power cord into an electrical outlet.

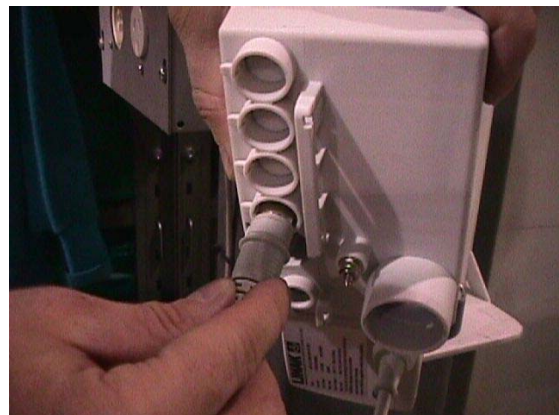



Carry bar installation

To install your carry bar, remove the clevis pin and the split ring from the end of the boom. Insert the carry bar between the two brackets. Reinsert the clevis pin and the split ring.



 Be sure that the split ring is completely inserted into the clevis pin.

OPERATION



How to use the Ergolift-WL,

 READ THE "SAFETY INSTRUCTIONS AND WARNINGS" SECTION BEFORE ATTEMPTING TO USE CAREFULLY THE LIFT.

Always carry out the daily checklist before each lift use.

Plug the lift into the electrical outlet.

Install the patient sling (see "Sling" section)

Raise / lower the boom (using the   buttons on the handset) so the carry bar is approximately to chest height of the patient.



Move the lift over to the patient, so the end of the boom is approximately 15 cm (6 inches) away from the patient. For a patient in a lying position, lower the lift so the carry bar is near the thorax, then install the straps.

 HAVE SOMEONE ASSIST YOU WHEN ATTEMPTING TO TRANSFER A PATIENT.

Attach the straps of the sling as described in the sling instruction section of the manual. Make sure that all straps are secure on the carry bar. Carefully observe the patient's safety as you lift the patient slightly by pressing the control button.

 BEFORE LIFTING THE PATIENT :

1. Make sure that all straps are attached to the carry bar.
2. Make sure the patient is comfortable.
3. Make sure the sling is not caught on any obstruction (wheelchair brake or arm of chair).

If any of the above occurs - Lower the patient immediately and correct the problem.

Lift until the patient's buttocks clear the arm supports or the top of the bath or bed before moving the patient. Guide the legs past any obstacle.

 THE BHM ERGOLIFT-WL IS NOT INTENDED TO BE A TRANSPORT DEVICE.

 DO NOT ATTEMPT TO MANOEUVRE THE LIFT BY PULLING ON THE MAST, BOOM, ACTUATOR OR PATIENT.

When the patient is located above the desired point of transfer and ready to be lowered, press the  button.

Make sure wheels are locked on the bed or wheelchair.

For a transfer into a seated position; use the handles on the back of the sling to position the patient when transferring into a chair. Hold the handles firmly as the sling lowers and the sling will tilt back to position the patient. As the boom lowers, guide the lift away from the patient (approx. 6 in/15 cm.).

Once the patient is properly seated and the straps are loose, remove the sling from the lift.

Push the lift away from the patient.

Sling can be removed from around the patient.

Anti-crush feature

To prevent damage or injury, the motor on the lift has a limit switch that recognizes when the boom is being lifted or pressed upward. This limit switch will stop the motor until the boom is no longer being lifted or pressed upward. This will ensure that the motor stops if the boom is unknowingly being lowered onto an object or patient. To check this feature, press the button on the handset or control box then lift up the boom. The motor should stop.

Stretching the Boom

To extend the boom, unclip the locking clip from the clevis pin.



Remove the clevis pin from the boom. Extend the boom to the length desired.

 Make sure not force or extend the boom beyond its reach. It can be hazardous to the patient.



Align the hole of the boom and the extension.



Insert the clevis pin back in into the boom.



Clip the locking clip back onto the clevis pin.



 Be sure that the locking clip is properly installed on the clevis pin before using it. Failure to do so, may cause serious injuries to the patient.

BHM ERGOFIT SLING

Every patient has different needs. It is very important to choose the right sling based on the needs of the patient to be transferred as well as their physical ability and size.

All BHM slings are made from a Polyester/ Nylon material, which is soft and pliable, easy to care for, and install. All slings are machine wash and dry in medium temperature. BHM slings are covered by a one-year warranty.



PLEASE READ CAREFULLY THE FOLLOWING, BEFORE USING A BHM MEDICAL ERGOFIT SLING.

- ALWAYS CARRY OUT THE DAILY CHECKLIST BEFORE EACH LIFT USE.
- BHM MEDICAL WALL LIFT IS SPECIFICALLY DESIGNED FOR BHM MEDICAL SLINGS AND ACCESSORIES. SLINGS AND ACCESSORIES DESIGNED BY ANY OTHER MANUFACTURERS ARE PROHIBITED AND WILL VOID BHM MEDICAL'S WARRANTY. USE ONLY BHM MEDICAL SLINGS AND ACCESSORIES TO MAINTAIN PATIENT SAFETY AND PRODUCT UTILITY.
- PATIENT TO BE TRANSFERRED MUST BE ASSESSED BY A QUALIFIED PROFESSIONAL BEFORE ATTEMPTING TO TRANSFER.

Observe a trained expert to perform the transfer procedures and then practice them several times with a capable individual acting as patient before attempting a transfer with a patient with limited capabilities.

- READ CAREFULLY ALL INSTRUCTIONS BELOW BEFORE ATTEMPTING TO INSTALL A SLING.
- IF YOU HAVE ANY DOUBTS, PLEASE CONTACT YOUR LOCAL REPRESENTATIVE.

Before transferring a patient from a stationary object (wheelchair, bath or bed), slightly raise the patient off the stationary object and check that all sling attachments are secure. If any attachment is not correct, lower the patient and correct the problem, then raise the patient and check again.

- USE A SLING RECOMMENDED BY

THE PATIENT'S PHYSICIAN, NURSE OR MEDICAL SPECIALIST AS APPROPRIATE FOR THE PATIENT'S ABILITY AND NEEDS.

DO NOT use any kind of plastic backed incontinence pad or seating cushion between the patient and sling material. That may cause the patient to slide out of the sling during a transfer.

DO NOT exceed the maximum weight limitation of the sling.

- **WHENEVER POSSIBLE, HAVE SOMEONE ASSIST YOU TO ENSURE THE PATIENT'S SAFETY AT ALL TIMES.**

Laundry instructions for all slings:

The following symbols are used on sling labels and related to washing instructions:



Maximum washing temperature is 60°C (140°F) for permanent cycle.



Do not use bleach.



Do not dry clean.



Tumble dry low temperature.



Do not iron.

User instructions for: Hammock Sling



Inspect each sling for wear, tears or loose stitching after each wash.

Hammock Sling (THA-S, M & L)

Our most universal sling, the Hammock sling is a mesh type material that dries quickly but is soft and pliable. The sling has an incorporated head support and a unique strap system that keeps the patient secure in the sling. A special polyester fabric in the seat area helps to reduce friction and makes the sling easy to place around a patient in a chair without lifting or remove the patient. The patient may be transferred in a seated, semi-reclined or fully reclined position. Best choice for most situations – including bathing. Fits to all BHM ceiling lift models as well as Ergolift Lift models. Available in sizes S, M & L. The weight capacity is 250 kg (550 lb.)

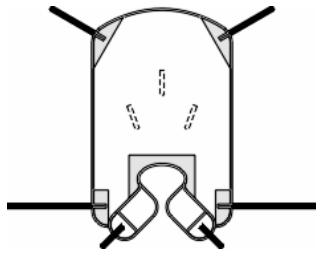

Hammock 6 Strap Sling (THA6-S, M & L)

Almost identical to the Hammock sling above, this sling provides extra security and a tighter fit for patients who are low-tone or who would prefer a more secure feeling. The head support is tighter and the extra straps on the side provide more lateral support. The patient may be transferred in a seated, semi-reclined or fully reclined position. Available in sizes S, M & L. The weight capacity is 250 kg (550 lb.)

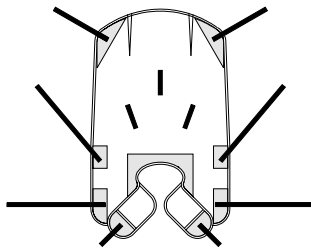

SLING SIZES AND PRODUCT NUMBERS:

	SMALL	MEDIUM	LARGE
Approximate weight:	20-46 kg (45-100 lb.)	46-95 kg (100-210 lb.)	95-250 kg (210-550 lb.)
Approximate height:	120-150 cm (4'-4'11")	151-180 cm (5'-5'11")	181 cm + (6' +)
Color Code	Red	Yellow	Green
Hammock Product #	THA-S	THA-M	THA-L
Hammock 6 Product #	THA6-S	THA6-M	THA6-L

Sling Placement - from Chair or Wheelchair

1. Sling has two sides, the white fabric indicates the side that is intended to be next to the patient and the label and colored handles are on the outside. The top of the sling is slightly rounded and the bottom has a U-shaped design.



(U-shaped and white fabric)

2. Lean the patient forward in the chair and make sure that the patient is supported.



Whenever possible have someone assist you to ensure the patient's safety at all times.

3. With the white fabric of the sling facing the patient, grab the sling at the top of the U-shaped and slide the sling down to the base of the spine or coccyx.



4. Tuck the sling down on each side to make sure that it is just slightly under the patient's buttocks. Check for the stitching of the sling handle at the center to make sure that it is in line with the patient's spine and bring the patient against the back of the chair or wheelchair.



6. Kneel in front of the patient so that your back is straight and so you are at eye level with your patient. Grab the end of the sling with the white fabric and make sure there are no twists in the sling. Make sure the white fabric is facing the patient's leg. Place one hand on the patient's knee to hold it in place and gently pull the sling forward with the other hand until the edge of the sling is approximately even with the patient's knee.
7. Place the patient's foot on your thigh and slide the white section of the sling under the leg.



7. Repeat steps 5 & 6 for the other leg.

Sling Attachment Options

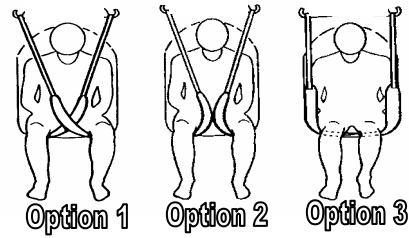

Option 1 - Bridge (The most recommended)

- a) Take the two straps between the legs – these are the short loops – and thread one loop through the other to cross them.



- b) Now take the long strap on the outside of each leg and string it through the inside strap. By crossing the straps as you see here, form a bridge above the patient's legs and protect them from any pinching or pressure, as well as keep the knees and hips in line.



Finally, place the patient's hands inside the sling.

OPTION 2 – Leg Separation



Using this method of sling placement will pull the patient's legs apart. Check with the patient's physician, nurse or medical specialist before attempting this method.

- a) Thread the long strap through the short strap on each leg.



- b) Each short strap should be attached to the long strap on the same leg.



- c) Place the hands inside the sling. See sling placement for leg separation as installed below.



OPTION 3 – Amputee



Do not use this method of sling placement for a patient who is agitated or spastic.

- a) Slide the sling end with the white fabric so that it is all the way under both legs. One sling strap will be on top of the other.



- b) Thread the long strap through the short strap that is next to it. The photo on the next shows clearly an example without a patient in it.



- c) When installed there should not be any sling material between the patient's legs. Place the hands inside the sling.

Sling Placement- from a lying position

1. Fold the sling in half lengthwise with the white part of the sling on the inside of the fold and place next to the patient to be transferred.





When transferring a patient from a bed, have people on each side of it, or raise the bed rails to ensure the patient does not roll off the bed.

2. With someone there to assist you, carefully roll the patient onto one side. Now, place the fold of the sling at the center of the bed or where the spine of the patient will be. The top of the U-shaped in the sling should be at the base of the spine or coccyx. The top of the sling should be next to the head. Lift the top fold and tuck next to the patient.



3. Lower the patient down on top of the sling. Roll the patient the opposite direction to pull the sling out the other side.



4. Place the straps in the same way as shown from a seated position for the hammock sling.



Sling attachment to Carry Bar

1. Ensure the sling is properly placed around the patient according to the instructions above.
2. Choose the color of the loop you will need for the position that the patient will be placed in. If transferring to a seated position, use the loops indicating it.

Sling position		
	BLACK	BLUE
	GREY	BLUE
	BLUE	BLUE
	BLUE	GREY



Always use the same color loop on the rear shoulder straps for both sides of the sling.

Use the same color loop on the leg straps for both sides of the sling.

Use the same color loop on the hip straps for both sides of the Hammock 6 straps sling.

3. Ensure the patient's arms are inside the sling and that it is not caught on any obstructions (eg. wheelchair brake or handle).
4. See Lift Instructions for next step.

**User Instructions for:
Quick-Fit Sling**

Specially designed for patients who are stocky or obese (especially in the midsection), padding around the buttocks and leg area helps to provide extra support. Upper portion of the sling is a mesh type material that dries quickly but is soft and pliable. This sling does not provide head support. The patient may be lifted in a seated, semi-reclined or fully reclined position. Available in sizes S, M & L. The weight capacity is 250 kg (550 lb.).



Do not use the Quick-Fit sling on a patient who cannot support his own head.

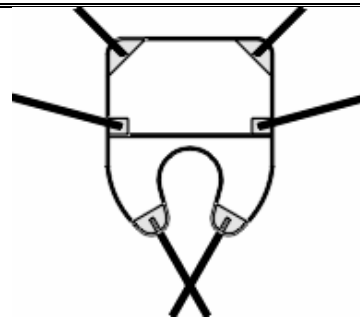

SLING SIZES AND PRODUCT NUMBERS:

	SMALL	MEDIUM	LARGE
Approximate weight:	20-46 kg (45-100 lb.)	46-95 kg (100-210 lb.)	95-250 kg (210-550 lb.)
Approximate height:	120-150 cm (4'-4'11")	151-180 cm (5'-5'11")	181 cm + (6' +)
Color Code	Red	Yellow	Green
Quick-fit	TIR-S	TIR-M	TIR-L

Sling Placement - from a Chair or a Wheelchair



Whenever possible have someone assist you to ensure the patient's safety at all times.

1. The sling has two sides, the white fabric indicates the side that is intended to be next to the patient and the label and colored handles are on the outside. The top of the sling is straight and the bottom of the sling has a U-shaped design.



2. Lean patient forward in the chair and make sure the patient is supported.
3. With the white fabric of the sling facing the patient, grab the sling at the top of the U-shaped and slide it down to the base of the spine or coccyx. Tuck the sling down on each side to make sure that it is just slightly under the patient's buttock. Check the seam for the sling handle at the center to make sure that it is in line with the patient's spine and bring the patient against the back of the chair.
4. Kneel in front of the patient so that your back is straight and so you are at eye level with your patient. Grab the end of the sling with the white fabric and make sure there are no twists in the sling. The white fabric should be facing the patient's leg. Place one hand on the patient's knee to hold it in place and gently pull the sling forward with the other hand until the edge of the sling is approximately even with the patient's knee.



5. Place the patient's foot on your thigh and slide the white section of the sling under the leg.
6. Take the two straps between the legs. There is a small loop on each strap, right next to the sling. Thread one strap through the other to cross them.



7. By crossing the straps as you see here, we keep knees and hips in line.



8. Place the patient's hands inside the sling before attaching it to the lift.

Sling attachment to Carry Bar

1. Ensure the sling is properly placed around the patient according to the instructions above.
2. Choose the color of the loop you will need for the position that the patient be placed in. If transferring to a seated position, use the loops indicated for a seated position.

Sling position		
	BLACK	BLUE
	GREY	BLUE
	BLUE	BLUE



Always use the same color loop on the rear shoulder straps for both sides of the sling.

Use the same color loop on the hip straps for both sides of the sling.

3. Ensure the patient's arms are inside the sling and that it is not caught on any obstructions (eg. Wheelchair brake or handle).
4. See Lift Instructions for next step.

**User Instructions for:
Hygienic Sling**

This sling is excellent for changing incontinence pads or to transfer onto a toilet as it provides an open area from the middle of the back to the middle of the thigh. The padding wraps around the patient's midsection and under each leg. In order to use this sling, the patient must have good muscle-tone in their shoulders and upper body. Available in sizes S, M & L. The weight capacity is 250 kg (550 lb.)



Do not use Hygienic sling on a patient who does not have good muscle-tone in their shoulders and neck.

Check with the patient's physician, nurse or medical specialist before using this sling.

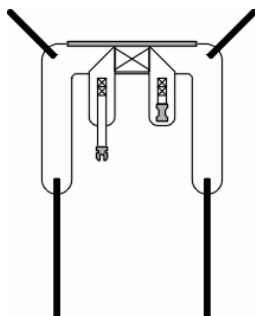

SLING SIZES AND PRODUCT NUMBERS

	SMALL	MEDIUM	LARGE
CHEST SIZE	68-89 cm (27-35")	89-107 cm (35-42")	107-125 cm (42-49")
PRODUCT #	THY-S	THY-M	THY-L
COLOR CODE	Red	Yellow	Green

1. Sling has two sides, the white fabric indicates the side that is intended to be next to the patient and the label and colored

handles are on the outside. The bottom of the sling has two long straps and the inside of the sling has a padded section with a belt.





Whenever possible have someone assist you to ensure the patient's safety at all times.

2. Lean patient forward in the chair and make sure the patient is supported.
3. With the white fabric of the sling facing the patient, place it approximately halfway down the back, or so the sling is below the shoulder blades. Lean the patient against the back of the chair.



4. Fold the padded fabric waist band with the belt attached across the mid-section of the patient and clip the belt to close it. Make sure the belt is secure.



5. Tighten the belt until snug by pulling gently on the end of the belt.
6. Kneel in front of the patient so that your back is straight and so you are at eye level with the patient. Grab the end of the sling with the white fabric and make sure there are no twists in the sling. Make sure the white fabric is facing the patient's leg. Place the patient's foot on your thigh and slide the white section of the sling under the leg.



7. The hygienic straps need not cross to allow better access to the toileting area. With the hygienic sling, the arms of the patient are always over top of the sling.

Sling attachment to Carry Bar

1. Ensure the sling is properly placed around the patient according to the instructions above.
2. Choose the color of the loop for the position that is best suited for the patient. For a larger patient, choose blue for both the leg and shoulder straps. A smaller patient may be better suited for the black loops on both the shoulder and leg straps.

Sling position		
	BLUE	BLUE
	GREY	GREY
	BLACK	BLACK



Always use the same color loop on the shoulder straps for both sides of the sling.

Use the same color loop on the leg straps for both sides of the sling.

3. Ensure the patient's arms are over top of the sling and that it is not caught on any obstructions (eg. Wheelchair brake or handle).
4. See Lift Instructions for next step.

Sling Inspection and Care

For maximum patient safety and hygiene, read the following instructions:

Chemical Attack

Oil, grease, creosote or paint stains are harmless but other forms of chemical attack of a sufficient degree may lead to deterioration or extreme softening of the webbing, which would lead to the fibres being rubbed off (almost as powder in extreme cases). It is best to avoid fumes, spray or mists of acid and alkalis or organic solvents. If contamination is suspected, wash out well in warm water. Avoid contact with excessive heat which is likely to affect the product.

Cleaning

Certain chemical substances mentioned above may be removed by a heavy duty cleaner diluted in warm water. Ensure that any cleaning agents are removed by rinsing thoroughly in warm water at a maximum temperature of 60°C (140°F), and allowed to dry naturally away from any source of direct heat.

For normal washing and cleaning, follow the care instructions on the label of the product.

Storage

Slings should be stored away from direct sunlight, stress, pressure, excessive heat or humidity. The sling should be kept away from contact with sharp objects, corrosives or other possible damaging material.

Daily Checklist

1. Check for any sign of wear on sling straps as described above and at the strap-sling junction. Buckles should be checked to ensure that the locking/unlocking mechanism opens and closes easily and is secure when locked.

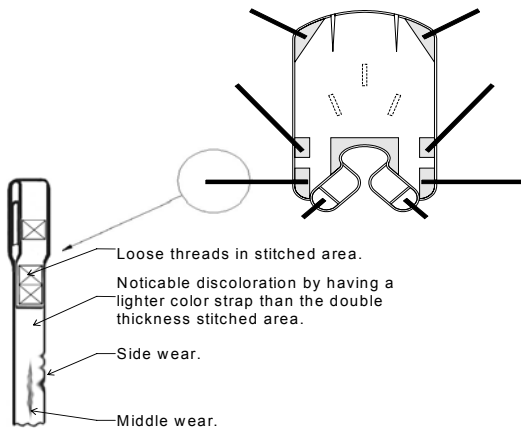

2. Check for any sign of deterioration of the sling material. Check for general external wear, local abrasions, cuts, holes or burns in the webbing and for chemical attack.
3. Look at "stitched areas" for broken, worn, pulled or unraveled stitches.
4. Sling should be cleaned as indicated on the tag.
5. If there is any sign of wear or deterioration as indicated above or other visual defect, the sling should be changed immediately. By continuing to use the lift without changing the sling, caregiver and patient safety is greatly compromised.



Take note of inspection results in the log book at the end of this manual.

MAINTENANCE



ALWAYS CARRY OUT THE DAILY CHECKLIST BEFORE EACH LIFT USE.

ERGOLIFT-WL and accessories must be inspected **ANNUALLY** by a certified

technician in addition to the daily and other periodic visual checks done by the user specified in this section.

Preventive maintenance specified in this manual can prevent accidents and reduce repair costs.

Note all services or repairs to the ERGOLIFT-WL or its accessories in the log book at the back of this manual. Have the document signed by a certified technician.

Daily Checklist

THE FOLLOWING PROCEDURE MUST BE FOLLOWED BEFORE EACH USE.

- Inspect the lift for any damage. If there are any cracks or other damage on the lift, or any parts are missing - **DO NOT USE IT.** Contact your local representative to have the lift serviced.
- Inspect the carry bar for any signs of cracking or damage and that it rotates freely.
- Inspect the actuator on the lift to ensure it is securely attached to the lift and has no visible damage.
- Inspect the sling for tears, frayed straps or loose stitches. If the sling has any of the above damage – **DO NOT USE IT.** Contact your local representative to have the sling replaced or repaired.

Inspection and Cleaning

Clean the lift with a soft dry cloth, or a soft cloth lightly moistened with a mild detergent solution. Do not use any type of solvent that may damage the finish.



DO NOT submerge the lift under water.

To touch-up scratches or chipped paint and prevent rust, apply white spray paint (BHM touch-up paint product # P6111)

Handling and Storage

Avoid violent shock during transportation.

Boom Actuator Replacement

1. Unplug the lift from the electrical outlet.
2. Unplug the actuator and the handset plugs from the control box.

3. Remove the boom from the wall plate and place it on a table.
4. Remove the split ring with a flat head screwdriver and the clevis pin from the upper part of the actuator.



5. Remove the boom from the actuator.



6. Repeat step 4 but for the lower part and remove it from the lower bracket.
7. Replace the actuator with a new one.
8. Insert the clevis pins and the split rings back into the upper and lower part of the actuator.



Be sure that the split rings are completely inserted into clevis pins.

9. Place the boom back into the wall plate. Follow instructions in the Boom Installation section.
10. Plug the actuator plug and the handset plug back into the control box and plug the lift in the outlet.
11. To check if the actuator is functional, press the handset buttons.

Carry Bar Replacement

1. To replace a carry bar, remove the split ring with a flat head screwdriver and the clevis pin from the end of the boom.
2. Replace the carry bar with a new one.
3. Reinsert the clevis pin and the split ring.



Make sure that the split ring is completely inserted.

Annual Inspection

The ERGOLIFT-WL and accessories must be inspected annually by a certified technician.



ERGOLIFT-WL and accessories must be serviced every 12 months as a minimum requirement.

Do not attempt to do the inspection unless you are certified to do so.

As part of the annual inspection, an annual load test with the safe working load must be performed on the ERGOLIFT-WL as required for CE MARK MAINTENANCE.

After annual inspection, have the log book signed by the certified technician.

MAINTENANCE INSPECTION CHECKLIST

Maintenance Inspection Checklist

TO BE INSPECTED BY USER

ITEM	INITIALLY	BEFORE EVERY USE	EVERY 2 MONTHS	EVERY 4 MONTHS	EVERY YEAR
------	-----------	------------------	----------------	----------------	------------

LIFT DEVICE

Inspect for missing hardware or broken pieces.	X	X			X
Overall inspection by authorized personnel.					X

SLINGS AND HARDWARE

Check all sling attachments for sign of wear.		X			
Inspect sling material for wear or deterioration.		X			
Inspect sling straps for wear.		X			
Inspect for any defect or loose threads in the "stitched areas".		X			
Cleaning sling as indicated on the tag.	<i>When Necessary</i>				

THE MAST

Mast MUST be securely assembled to the boom.	X	X			
Inspect for cracks or deflections	X	X			

THE BOOM

Check all hardware and swivel bar supports.	X		X		
Inspect for cracks or deflections.	X		X		
Inspect bolted joints of boom for wear.	X		X		

THE SWIVEL BAR

Check the bolt for wear or damage	X		X		
-----------------------------------	---	--	---	--	--

ELECTRIC ACTUATOR ASSEMBLY

Inspect hardware on mast and boom	X		X		
Check for wear or deterioration. (IF DAMAGED, RETURN TO FACTORY)	X		X		
Cycle to ensure smooth quiet operation.	X		X		
A complete inspection of the actuator must be done by a certified technician					X

CLEANING

Cleaning of the lift	X		X		
----------------------	---	--	---	--	--



For individual home use, a full inspection is required prior to each new user.

Regular cleaning will reveal loose or worn parts, enhance smooth operation and extend the life expectancy of the lift.

If applicable, do an annual load test (maximum load) of Safe Working Load.

Load is required for CE Mark Maintenance.



Take note of inspection results in the log book at the end of this manual.

MAINTENANCE INSPECTION CHECKLIST

MINOR SERVICE

ITEM	INITIAL Y	BEFORE EVERY USE	EVERY 2 MONTH S	EVERY 6 MONTH S	EVERY YEAR
General inspection of lift			X		
Inspect surfaces for scatches/chips			X		
Clean surfaces with mild soap and water and remove any adhesive tape marks with WD40 or other degreasing agent.			X		
Arrange repair/replacement of any faulty parts				X	
Check for signs or fatigue or cracks on the wall lift (especially joints and stress points)			X		
Retard rusting by applying with spray paint (BHM touch-Up Paint Product reference #P6111)				X	
Check boom/carry bar (hanger)				X	
Keep a record of servicing along with signature of authorized service agent.	<i>Always</i>				
Check all electrical components.				X	

MAJOR SERVICE (to be check by a certified technician, plus inspection of all of the above)

Inspect the welding aspect on the mast and the boom to detect cracks.					X
Inspect connecting joints for proper attachment.					X
Load test with the SWL (maximum working capacity).					X
Service motor					X



A major service undertaken by an authorized service agent every 12 months is a minimum requirement.



Maintenance inspection points are suggested by the manufacturer and are a minimum requirement. By continuing to use the lift without replacing the listed parts in this maintenance inspection checklist, caregiver and patient safety is greatly compromised.

TROUBLESHOOTING



Only a certified technician is authorized to open the ERGOLIFT-WL.

Alterations made to the ERGOLIFT-WL by someone other than a certified technician may cause serious injury.

PROBLEMS	TO CHECK
The lift does not work when you press the "up" or "down" buttons on the handset.	<ul style="list-style-type: none"> • Make sure the lift is plugged into an electrical outlet. • Make sure the handset is plugged correctly into the unit. • If there is still a problem, change the handset.
The unit starts and stops repetitively	<ul style="list-style-type: none"> • If the load is more than the safe working load, the unit will not work due to an overload protection on the motor.
Patient lift feels loose.	<ul style="list-style-type: none"> • Check to ensure the locking clip is on. • Check to ensure all split rings are completely inserted. • Check if the mast is still affixed to the pivot of the wall plate.
Unusual noise from actuator (Actuator is worn or damaged or sprindle is bent	<ul style="list-style-type: none"> • Refer to "BOOM ACTUATOR REPLACEMENT" in the "MAINTENANCE" section of this manual.



If problems are not resolved by the suggested means, please contact your dealer or BHM Medical Technical Service department.

ACCESSORIES

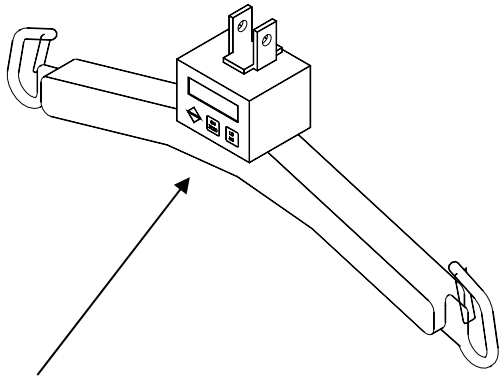

ERGOSCALE
PRODUCT # ERGOSCALE-T2

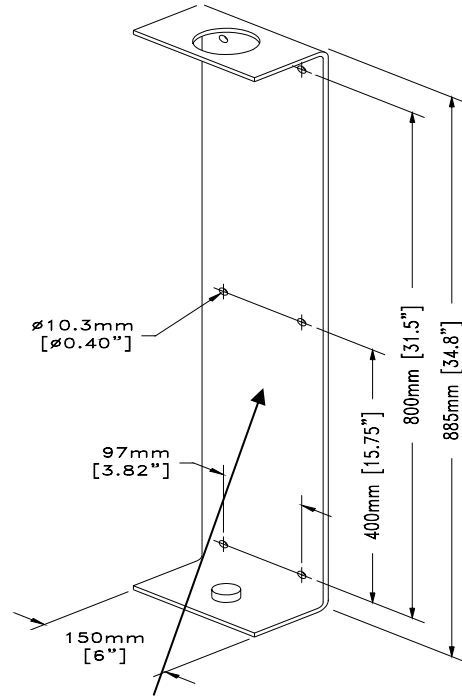

FIXATION PLATE
PRODUCT #A4560

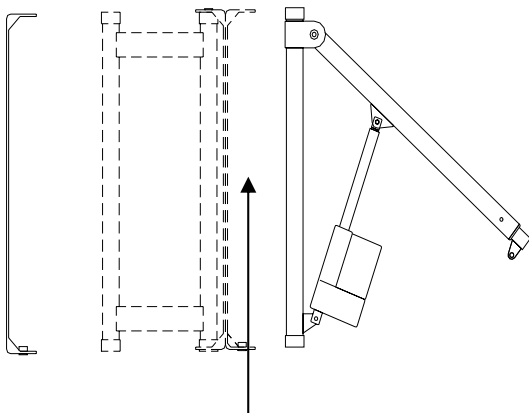
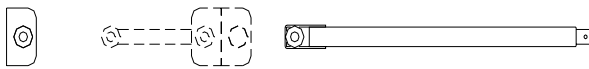

PIVOTING EXTENSION
PRODUCT # A4580

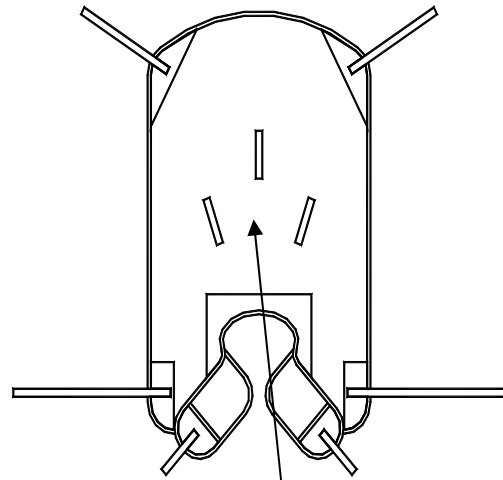

SLINGS

Service Type <input type="checkbox"/> Pre-delivery <input type="checkbox"/> Periodic inspection <input type="checkbox"/> Minor <input type="checkbox"/> Major	
Condition report : _____	
Action taken : _____	
Date : _____	Inspected by: _____ Printed _____ Signature

Service Type <input type="checkbox"/> Pre-delivery <input type="checkbox"/> Periodic inspection <input type="checkbox"/> Minor <input type="checkbox"/> Major	
Condition report : _____	
Action taken : _____	
Date : _____	Inspected by: _____ Printed _____ Signature

Service Type <input type="checkbox"/> Pre-delivery <input type="checkbox"/> Periodic inspection <input type="checkbox"/> Minor <input type="checkbox"/> Major	
Condition report : _____	
Action taken : _____	
Date : _____	Inspected by: _____ Printed _____ Signature

Service Type <input type="checkbox"/> Pre-delivery <input type="checkbox"/> Periodic inspection <input type="checkbox"/> Minor <input type="checkbox"/> Major	
Condition report : _____	
Action taken : _____	
Date : _____	Inspected by: _____ Printed _____ Signature

WARRANTY

This warranty is extended only to the original purchaser/user of BHM products.

BHM Medical Inc. warrants its products to be free from defects in material under normal use and service, within the periods stated below from the date of purchase. If within such warranty period any such product shall be proven to be defective, such product shall be repaired or replaced at BHM Medical option. This warranty does not include any labour or shipping charges incurred in replacement part installation or repair of any such product. BHM Medical sole obligation and your exclusive remedy under this warranty shall be limited to such repair and/or replacement.

Patient Lifter	1 year
Tracks and installation	Life time warranty*
Weighing Devices	1 year
Accessories on Lifter	1 year
Slings	1 year
Batteries - Voyager Portable	3 months
Batteries - All other lifts	1 year
Easytrack System	1 year

For warranty service, please contact the dealer from whom you purchased the BHM Medical product. [In the event that you do not receive satisfactory warranty service, please contact BHM Medical (see contact information in Table of Contents).]

Do not return products to our factory without prior authorisation. BHM Medical will issue a Return Merchandise Authorisation (RMA) Number. C.O.D. shipments will be refused; all shipments to BHM Medical must be prepaid. For this warranty to be valid, the purchaser must present its original proof of purchase at the moment of the claim. The defective unit, assembly or part must be returned to BHM Medical for inspection. The part or components repaired or replaced are guaranteed for the remaining period of the initial warranty.

Limitations and Exclusions:

The warranty above does not apply to serial numbered products if the serial number has been removed or defaced.

No warranty claim shall apply where the product or any other part thereof has been altered, varied, modified, or damaged; either accidentally or through improper or negligent use and storage. Warranty does not apply to products modified without BHM Medical express written consent, (including but not limited to products modified with unauthorised parts or attachments); products damaged by reason of repairs made to any component without the specific consent of BHM Medical, or to products damaged by circumstances beyond BHM Medical control. BHM Medical will solely determine evaluation of warranty claim. The warranty does not apply to problems arising from normal wear or failure to adhere to the instructions in this manual. BHM Medical Inc. slings are void of warranty if not laundered as per instructions on the Sling Label.

BHM Medical Inc. shall not be liable for damages losses or inconveniences caused by a carrier.

This warranty replaces any other warranty expressed or implicit and constitutes BHM Medical Inc. only obligation towards the purchaser. BHM Medical shall not be liable for any consequential or incidental damages whatsoever.

* Valid only if BHM Medical did the original installation. Warranty will be void if tracks or/and installation have been modified.