



User Manual

Read and understand this manual before using machine.

MINI DUST COLLECTOR



**Model Number
65115**





THANK YOU for purchasing your new Steel City Mini Dust Collector. This mini dust collector has been designed, tested, and inspected with you, the customer, in mind. When properly assembled, used and maintained, your mini dust collector will provide you with years of trouble free service, which is why it is backed by one of the longest machinery warranties in the business.

This mini dust collector is just one of many products in the Steel City's family of woodworking machinery and is proof of our commitment to total customer satisfaction.

At Steel City we continue to strive for excellence each and every day and value the opinion of you, our customer. For comments about your mini dust collector or Steel City Tool Works, please visit our web site at **www.steelcitytoolworks.com**.

TABLE OF CONTENTS

INTRODUCTION

SECTION 1	Warranty	4
SECTION 2	Product Specifications	7
SECTION 3	Definition of Terms	7
SECTION 4	Feature Identification	8
SECTION 5	General Safety	9
SECTION 6	Product Safety	11
SECTION 7	Electrical Requirements	12
SECTION 8	Grounding Instructions	13
SECTION 9	Unpacking and Inventory	15
SECTION 10	Assembly	16
SECTION 11	Maintenance	17
SECTION 12	Parts List	18

INTRODUCTION

This user manual is intended for use by anyone working with this machine. It should be kept available for immediate reference so that all operations can be performed with maximum efficiency and safety. Do not attempt to perform maintenance or operate this machine until you have read and understand the information contained in this manual.

This Dust Collector is intended for use of wood dust removal only. Any other use is forbidden. This machine is not to be modified for any reasons.

The drawings, illustrations, photographs, and specifications in this user manual represent your machine at time of print. However, changes may be made to your machine or this manual at any time with no obligation to Steel City Tool Works.

WARRANTY

STEEL CITY TOOL WORKS 1 YEAR LIMITED WARRANTY

Steel City Tool Works, LLC (“SCTW”) warrants all “STEEL CITY TOOL WORKS” machinery to be free of defects in workmanship and materials for a period of 1 year from the date of the original retail purchase by the original owner. SCTW will repair or replace, at its expense and at its option, any SCTW machine, machine part, or machine accessory which in normal use has proven to be defective, provided that the customer returns the product, shipping prepaid, to an authorized service center with proof of purchase and provides SCTW with a reasonable opportunity to verify the alleged defect by inspection. This warranty does not apply to defects due directly or indirectly to misuse, abuse, negligence, accidents, or lack of maintenance, or to repairs or alterations made or specifically authorized by anyone other than SCTW. Normal wear components are also excluded under this coverage. Every effort has been made to ensure that all SCTW machinery meets the highest quality and durability standards. We reserve the right to change specifications at any time due to our commitment to continuous improvement of the quality of our products.

EXCEPT AS SET FORTH ABOVE, SCTW MAKES NO EXPRESS OR IMPLIED REPRESENTATIONS OR WARRANTIES WITH RESPECT TO ITS MACHINERY, OR ITS CONDITION, MERCHANTABILITY, OR FITNESS FOR ANY PARTICULAR PURPOSE OR USE. SCTW FURNISHES THE ABOVE WARRANTIES IN LIEU OF ALL OTHER WARRANTIES, EXPRESS OR IMPLIED, INCLUDING THE WARRANTIES OF MERCHANTABILITY AND FITNESS FOR A PARTICULAR PURPOSE, WHICH ARE HEREBY SPECIFICALLY DISCLAIMED.

SCTW SHALL NOT BE LIABLE FOR ANY (A) SPECIAL, INDIRECT, INCIDENTAL, PUNITIVE OR CONSEQUENTIAL DAMAGES, INCLUDING WITHOUT LIMITATION LOSS OF PROFITS, ARISING FROM OR RELATED TO THIS WARRANTY, THE BREACH OF ANY AGREEMENT OR WARRANTY, OR THE OPERATION OR USE OF ITS MACHINERY, INCLUDING WITHOUT LIMITATION DAMAGES ARISING FROM DAMAGE TO FIXTURES, TOOLS, EQUIPMENT, PARTS OR MATERIALS, DIRECT OR INDIRECT LOSS CAUSED BY ANY OTHER PARTY, LOSS OF REVENUE OR PROFITS, FINANCING OR INTEREST CHARGES, AND CLAIMS BY ANY THIRD PERSON, WHETHER OR NOT NOTICE OF SUCH POSSIBLE DAMAGES HAS BEEN GIVEN TO SCTW; (B) DAMAGES OF ANY KIND FOR ANY DELAY BY OR FAILURE OF SCTW TO PERFORM ITS OBLIGATIONS UNDER THIS AGREEMENT; OR (C) CLAIMS MADE A SUBJECT OF A LEGAL PROCEEDING AGAINST SCTW MORE THAN ONE (1) YEAR AFTER SUCH CAUSE OF ACTION FIRST AROSE.

The validity, construction and performance of this Warranty and any sale of machinery by SCTW shall be governed by the laws of the Commonwealth of Pennsylvania, without regard to conflicts of laws provisions of any jurisdiction. Any action related in any way to any alleged or actual offer, acceptance or sale by SCTW, or any claim related to the performance of any agreement including without limitation this Warranty, shall take place in the federal or state courts in Allegheny County, Pennsylvania.

STEEL CITY TOOL WORKS

WARRANTY CARD

Name _____
 Street _____
 Apt. No. _____
 City _____ State _____ Zip _____
 Phone Number _____
 E-Mail _____

Product Description: _____
 Model No.: _____
 Serial No. _____

***The following information is given on a voluntary basis
 and is strictly confidential.***

1. Where did you purchase your STEEL CITY machine?
 Store: _____
 City: _____

2. How did you first learn of Steel City Tool Works?
 _____ Advertisement _____ Mail Order Catalog
 _____ Web Site _____ Friend
 _____ Local Store _____ Other _____

3. Which of the following magazines do you subscribe to?
 _____ American Woodworker _____ American How-To
 _____ Cabinetmaker _____ Family Handyman
 _____ Fine Homebuilding _____ Fine Woodworking
 _____ Journal of Light Construction _____ Old House Journal
 _____ Popular Mechanics _____ Popular Science
 _____ Popular Woodworking _____ Today's Homeowner
 _____ WOOD _____ Woodcraft
 _____ WOODEN Boat _____ Woodshop News
 _____ Woodsmith _____ Woodwork
 _____ Woodworker _____ Woodworker's Journal
 _____ Workbench _____ Other _____

4. Which of the following woodworking / remodeling shows do
 you watch?
 _____ Backyard America _____ The American Woodworker
 _____ Home Time _____ The New Yankee Workshop
 _____ This Old House _____ Woodwright's Shop
 Other _____

5. What is your annual household income?
 _____ \$20,000 to \$29,999 _____ \$30,000 to \$39,999
 _____ \$40,000 to \$49,999 _____ \$50,000 to \$59,999
 _____ \$60,000 to \$69,999 _____ 70,000 to \$79,999
 _____ \$80,000 to \$89,999 _____ \$90,000 +

6. What is your age group?
 _____ 20 to 29 years _____ 30 to 39 years
 _____ 40 to 49 years _____ 50 to 59 years
 _____ 60 to 69 years _____ 70 + years

7. How long have you been a woodworker?
 _____ 0 to 2 years _____ 2 to 8 years
 _____ 8 to 20 years _____ over 20 years

8. How would you rank your woodworking skills?
 _____ Simple _____ Intermediate
 _____ Advance _____ Master Craftsman

9. How many Steel City machines do you own? _____

10. What stationary woodworking tools do you own?
Check all that apply.
 _____ Air Compressor _____ Band Saw
 _____ Drill Press _____ Drum Sander
 _____ Dust Collection _____ Horizontal Boring Machine
 _____ Jointer _____ Lathe
 _____ Mortiser _____ Panel Saw
 _____ Planer _____ Power Feeder
 _____ Radial Arm Saw _____ Shaper
 _____ Spindle Sander _____ Table Saw
 _____ Vacuum Veneer Press _____ Wide Belt Sander
 Other _____

11. Which benchtop tools do you own? *Check all that apply.*
 _____ Belt Sander _____ Belt / Disc Sander
 _____ Drill Press _____ Band Saw
 _____ Grinder _____ Mini Jointer
 _____ Mini Lathe _____ Scroll Saw
 _____ Spindle / Belt Sander _____ Other _____

12. Which portable / hand held power tools do you own?
Check all that apply.
 _____ Belt Sander _____ Biscuit Jointer
 _____ Dust Collector _____ Circular Saw
 _____ Detail Sander _____ Drill / Driver
 _____ Miter Saw _____ Orbital Sander
 _____ Palm Sander _____ Portable Thickness Planer
 _____ Saber Saw _____ Reciprocating Saw
 _____ Router _____ Other _____

13. What machines / accessories would you like to see added to the
 STEEL CITY line?

14. What new accessories would you like to see added?

15. Do you think your purchase represents good value?
 _____ Yes _____ No

16. Would you recommend STEEL CITY products to a friend?
 _____ Yes _____ No

17. Comments:

FOLD ON DOTTED LINE

PLACE
STAMP
HERE

Steel City Tool Works
P.O. Box 10529
Murfreesboro, TN 37129

FOLD ON DOTTED LINE

PRODUCT SPECIFICATIONS

MOTOR SPECIFICATIONS:

Type	Universal
Amps	2.6
Voltage	120
Phase	Single
Hertz	60
RPM	10,500

PRODUCT SPECIFICATIONS

Noise Level (Decibel)	95 db
Number of Ports	1
Port Diameter	4 inch
Dust Collection Bag Micron	30
Dust Collection Bag Capacity	3 Cu. Ft.

DEFINITION OF TERMS

Below are some terms that will help you to understand and setup your Dust Collector and design your own Dust Collection System.

Dust Collector – A machine used to collect fine wood dust and chips.

One Micron – One micron is equal to one millionth of a meter.

C.F.M. = Cubic Feet/Minute – A measurement of the amount of air volume that can move through a dust collector in one minute.

FEATURE IDENTIFICATION

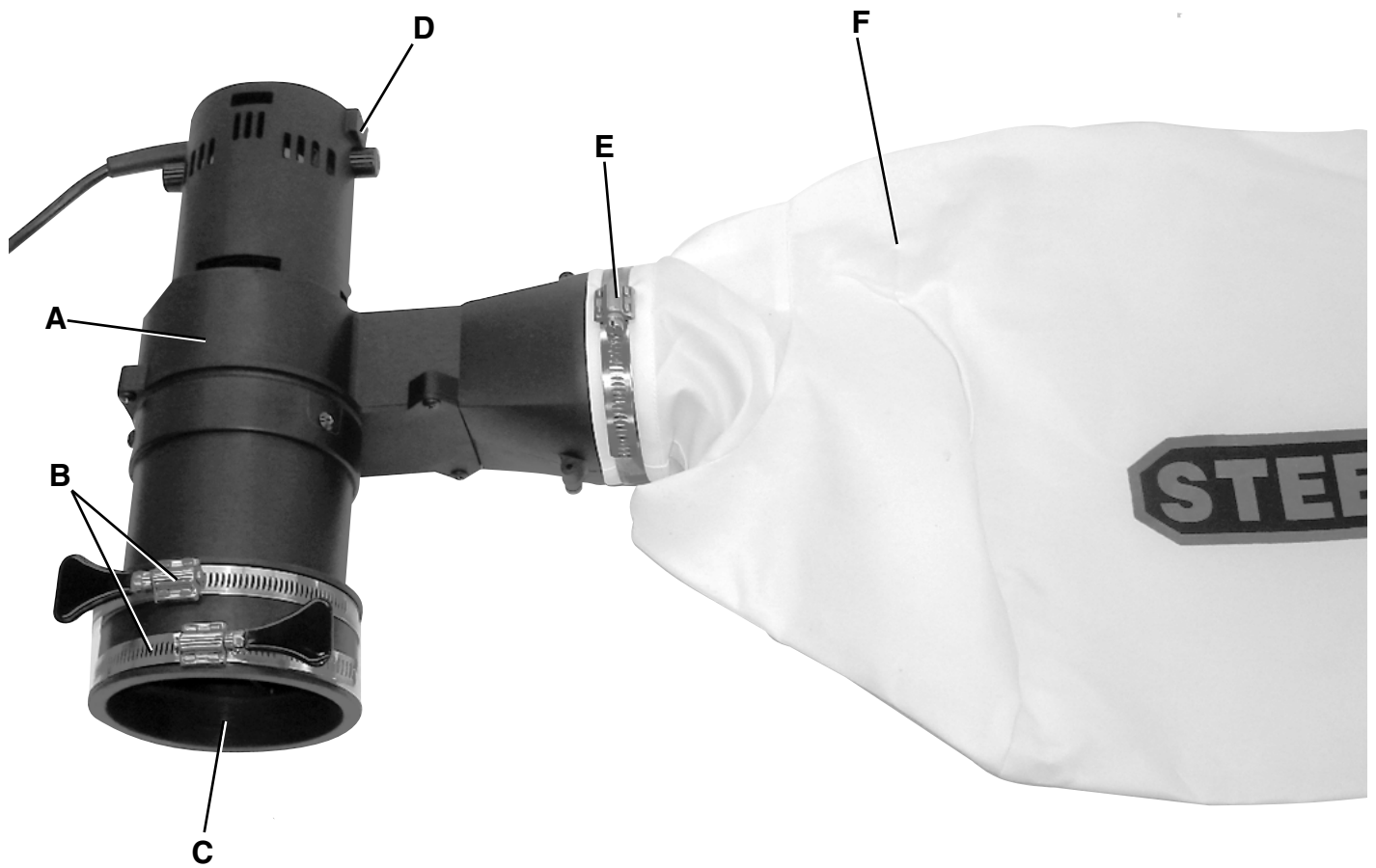

- A) Mini Dust Collector
- B) Hose Clamp 4.5" (2)
- C) Rubber Coupling
- D) On/Off Switch
- E) Hose Clamp 4"
- F) Dust Collection Bag

GENERAL SAFETY

WARNING

TO AVOID serious injury and damage to the machine, read and follow all Safety and Operating Instructions before assembling and operating this machine.

This manual is not totally comprehensive. It does not and can not convey every possible safety and operational problem which may arise while using this machine. The manual will cover many of the basic and specific safety procedures needed in an industrial environment.

All federal and state laws and any regulations having jurisdiction covering the safety requirements for use of this machine take precedence over the statements in this manual. Users of this machine must adhere to all such regulations.

Below is a list of symbols that are used to attract your attention to possible dangerous conditions.



This is the international safety alert symbol. It is used to alert you to potential personal injury hazards. Obey all safety messages that follow this symbol to avoid possible injury or death.

DANGER

Indicates an imminently hazardous situation which, if not avoided, **WILL** result in death or serious injury.

WARNING

Indicates a potentially hazardous situation which, if not avoided, **COULD** result in death or serious injury.

CAUTION

Indicates a potentially hazardous situation, if not avoided, **MAY** result in minor or moderate injury. It may also be used to alert against unsafe practices.

CAUTION

CAUTION used without the safety alert symbol indicates a potentially hazardous situation which, if not avoided, may result in property damage.

NOTICE

This symbol is used to alert the user to useful information about proper operation of the machine.

WARNING

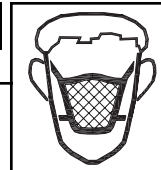

Exposure to the dust created by power sanding, sawing, grinding, drilling and other construction activities may cause serious and permanent respiratory or other injury, including silicosis (a serious lung disease), cancer, and death. Avoid breathing the dust, and avoid prolonged contact with dust. The dust may contain chemicals known to the State of California to cause cancer, birth defects or other reproductive harm.

Some examples of these chemicals are:

- Lead from lead-based paints.
- Crystalline silica from bricks, cement and other masonry products.
- Arsenic and chromium from chemically-treated lumber.

Always operate tool in well ventilated area and provide for proper dust removal. Use a dust collection system along with an air filtration system whenever possible. Always use properly fitting NIOSH/OSHA approved respiratory protection appropriate for the dust exposure, and wash exposed areas with soap and water.

1. To avoid serious injury and damage to the machine, read the entire Instruction Manual before assembly and operation of this machine.

WARNING

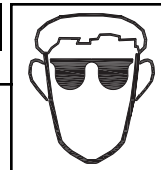

2. **ALWAYS** wear eye protection. Any machine can throw debris into the eyes during operations, which could cause severe and permanent eye damage. Everyday eyeglasses are **NOT** safety glasses. **ALWAYS** wear Safety Goggles (that comply with ANSI standard Z87.1) when operating power tools.

⚠ WARNING

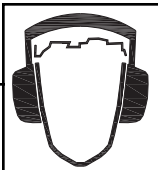

3. **ALWAYS** wear hearing protection. Plain cotton is not an acceptable protective device. Hearing equipment should comply with ANSI S3.19 Standards.

⚠ WARNING

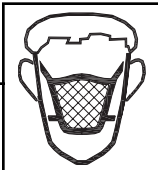

4. **ALWAYS** wear a NIOSH/OSHA approved dust mask to prevent inhaling dangerous dust or airborne particles.
5. **ALWAYS** keep the work area clean, well lit, and organized. **DO NOT** work in an area that have slippery floor surfaces from debris, grease, and wax.
6. **ALWAYS** unplug the machine from the electrical receptacle before making adjustments, changing parts or performing any maintenance.
7. **AVOID ACCIDENTAL STARTING.** Make sure that the power switch is in the "OFF" position before plugging in the power cord to the electrical receptacle.

⚠ WARNING

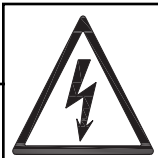

8. **AVOID** a dangerous working environment. **DO NOT** use electrical tools in a damp environment or expose them to rain.

⚠ WARNING



9. **CHILDPROOF THE WORKSHOP AREA** by removing switch keys, unplugging tools from the electrical receptacles, and using padlocks.

10. **DO NOT** use electrical tools in the presence of flammable liquids or gasses.
11. **DO NOT FORCE** the machine to perform an operation for which it was not designed. It will do a safer and higher quality job by only performing operations for which the machine was intended.
12. **DO NOT** stand on a machine. Serious injury could result if it tips over or you accidentally contact any moving part.
13. **DO NOT** store anything above or near the machine.
14. **DO NOT** operate any machine or tool if under the influence of drugs or alcohol.
15. **EACH AND EVERY** time, check for damaged parts prior to using any machine. Carefully check all guards to see that they operate properly, are not damaged, and perform their intended functions. Check for alignment, binding or breakage of all moving parts. Any guard or other part that is damaged should be immediately repaired or replaced.
16. Ground all machines. If any machine is supplied with a 3-prong plug, it must be plugged into a 3-contact electrical receptacle. The third prong is used to ground the tool and provide protection against accidental electric shock. **DO NOT** remove the third prong.
17. Keep visitors and children away from any machine. **DO NOT** permit people to be in the immediate work area, especially when the machine is operating.
18. **KEEP** protective guards in place and in working order.
19. **MAINTAIN** your balance. **DO NOT** extend yourself over the tool. Wear oil resistant rubber soled shoes. Keep floor clear of debris, grease, and wax.
20. **MAINTAIN** all machines with care. **ALWAYS KEEP** machine clean and in good working order. **KEEP** all blades and tool bits sharp.
21. **NEVER** leave a machine running, unattended. Turn the power switch to the OFF position. **DO NOT** leave the machine until it has come to a complete stop.
22. **REMOVE ALL MAINTENANCE TOOLS** from the immediate area prior to turning the machine ON.
23. **SECURE** all work. When it is possible, use clamps or jigs to secure the workpiece. This is safer than attempting to hold the workpiece with your hands.

24. **STAY ALERT**, watch what you are doing, and use common sense when operating any machine. **DO NOT** operate any machine tool while tired or under the influence of drugs, alcohol, or medication. A moment of inattention while operating power tools may result in serious personal injury.
25. **USE ONLY** recommended accessories. Use of incorrect or improper accessories could cause serious injury to the operator and cause damage to the machine. If in doubt, **DO NOT** use it.
26. **ONLY** use a proper extension cord in good condition. When using an extension cord, be sure to use one heavy enough to carry the current your machine will draw.
27. Wear proper clothing, **DO NOT** wear loose clothing, gloves, neckties, or jewelry. These items can get caught in the machine during operations and pull the operator into the moving parts. Users must wear a protective cover on their hair, if the hair is long, to prevent it from contacting any moving parts.
28. **SAVE** these instructions and refer to them frequently and use them to instruct other users.
29. Information regarding the safe and proper operation of this tool is also available from the following sources:

Power Tool Institute
1300 Summer Avenue
Cleveland, OH 44115-2851
www.powertoolinstitute.org

National Safety Council
1121 Spring Lake Drive
Itasca, IL 60143-3201

American National Standards Institute
25 West 43rd. St, 4th Floor
New York, NY. 10036
ANSI Z39.1 Safety Requirements
For Woodworking Machines
WWW.ANSI.ORG

U.S. Department of Labor Regulations
OSHA 1910.213 Regulations
WWW.OSHA.GOV

PRODUCT SAFETY

1. Serious personal injury may occur if normal safety precautions are overlooked or ignored. Accidents are frequently caused by lack of familiarity or failure to pay attention. Obtain advice from supervisor, instructor, or another qualified individual who is familiar with this machine and its operations.
2. Every work area is different. Always consider safety first, as it applies to your work area. Use this machine with respect and caution. Failure to do so could result in serious personal injury and damage to the machine.
3. Prevent electrical shock. Follow all electrical and safety codes, including the National Electrical Code (NEC) and the Occupational Safety and Health Regulations (OSHA). All electrical connections and wiring should be made by qualified personnel only.
4. **TO REDUCE** the risk of electrical shock. **DO NOT** use this machine outdoors. **DO NOT** expose to rain. Store indoors in a dry area.
5. **STOP** using this machine, if at any time you experience difficulties in performing any operation. Contact your supervisor, instructor or machine service center immediately.
6. Safety decals are on this machine to warn and direct you to how to protect yourself or visitors from personal injury. These decals **MUST** be maintained so that they are legible. **REPLACE** decals that are not legible.
7. **DO NOT** leave the dust collector plugged into the electrical outlet. Unplug dust collector from the outlet when not in use and before servicing, changing bags, unclogging and cleaning.
8. **ALWAYS** turn the power switch "OFF" before unplugging the dust collector.
9. **DO NOT** handle the plug or dust collector with wet hands.
10. **DO NOT** use the dust collector to pick up flammable or combustible liquids, such as gasoline. **NEVER** use the dust collector near any flammable or combustible liquids.
11. **USE** the dust collector to pick up wood materials only. **DO NOT** use the dust collector to pick up metal shavings, metal dust, or parts.

⚠ WARNING

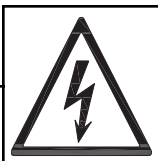

⚠ WARNING

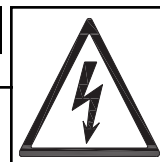

12. **NEVER** use the dust collector to dissipate fumes or smoke. **NEVER** pick up anything that is burning or smoking, such as cigarettes, matches or hot ashes.
13. **USE** only as described in this manual. **USE** accessories only recommended by Steel City.
14. **DO NOT** pull the dust collector by the power cord. **NEVER** allow the power cord to come in contact with sharp edges, hot surfaces, oil or grease.
15. **DO NOT** unplug the dust collector by pulling on the power cord. **ALWAYS** grasp the plug, not the cord.
16. **REPLACE** a damaged cord immediately. **DO NOT** use a damaged cord or plug. If the dust collector is not operating properly, or has been damaged, left outdoors or has been in contact with water.
17. **DO NOT** use the dust collector as a toy. **DO NOT** use near or around children.

⚠ WARNING

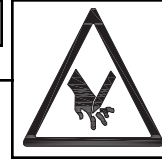

18. **DO NOT** insert fingers or foreign objects into the dust intake port. Keep hair, loose clothing, fingers, and all body parts away from openings and moving parts of the dust collector.
19. **DO NOT** use the dust collector without the dust collection bag in place and properly secured.
20. **ALWAYS** use safety gates or caps to cover dust ports when the dust collector is not in use or mounted to a supporting surface for storage.
21. **PERIODICALLY INSPECT** dust bag for any cuts, rips or tears. **NEVER** operate the dust collector with a damaged bag.
22. The dust collector is designed for home use **ONLY**.
23. **CONNECT** dust collector to a properly grounded outlet only. See grounding instructions.

ELECTRICAL REQUIREMENTS

⚠ WARNING

TO PREVENT electrical shock, follow all electrical and safety codes, including the National Electrical Code (NEC) and the Occupational Safety and Health Regulations (OSHA). All electrical connections and wiring should be made by qualified personnel only.

TO REDUCE the risk of electrical shock, **DO NOT** use machine outdoors. **DO NOT** expose to rain. Store indoors in a dry area.

DO NOT connect the machine to the power source before you have completed the set up process. **DO NOT** connect the machine to the power source until instructed to do so.

GROUNDING INSTRUCTIONS

⚠ WARNING



This machine **MUST BE GROUNDED** while in use to protect the operator from electric shock.

In the event of a malfunction or breakdown, **GROUNDING** provides the path of least resistance for electric current and reduces the risk of electric shock. This machine is equipped with an electric cord that has an equipment-grounding conductor and a grounding plug. The plug **MUST** be plugged into a matching electrical receptacle that is properly installed and grounded in accordance with **ALL** local codes and ordinances.

If a plug is provided with your machine **DO NOT** modify the plug. If it will not fit your electrical receptacle, have a qualified electrician install the proper connections to meet all electrical codes local and state. All connections must also adhere to all of OSHA mandates.

IMPROPER ELECTRICAL CONNECTION of the equipment-grounding conductor can result in risk of electric shock. The conductor with the green insulation (with or without yellow stripes) is the equipment-grounding conductor. **DO NOT** connect the equipment-grounding conductor to a live terminal.

Check with a qualified electrician or service personnel if you do not completely understand the grounding instructions, or if you are not sure the tool is properly grounded.

PLUGS/RECEPTACLES

⚠ WARNING



- Electrocution or fire could result if this machine is not grounded properly or if the electrical configuration does not comply with local and state electrical codes.
- **MAKE CERTAIN** the machine is disconnected from power source before starting any electrical work.
- **MAKE SURE** the circuit breaker does not exceed the rating of the plug and receptacle.

The motor supplied with your machine is a 120 volt, alternating current, 60 hertz, single phase motor. It is shipped wired for 120 volt application. Never connect the green or ground wire to a live terminal.

This tool is intended for use on a circuit that has an electrical receptacle as shown in Figure 1-1. Figure 1-1 shows a NEMA approved 3-wire, 15 amp electrical plug and receptacle that have a grounding conductor. If a properly grounded electrical receptacle is not available, an adapter as shown in Figure 1-2 can be used to temporarily connect this plug to a 2-contact ungrounded receptacle. The adapter has a rigid lug extending from it that **MUST** be connected to a permanent earth ground, such as a properly grounded receptacle box. **THIS ADAPTER IS PROHIBITED IN CANADA.**

Fig. 1-1

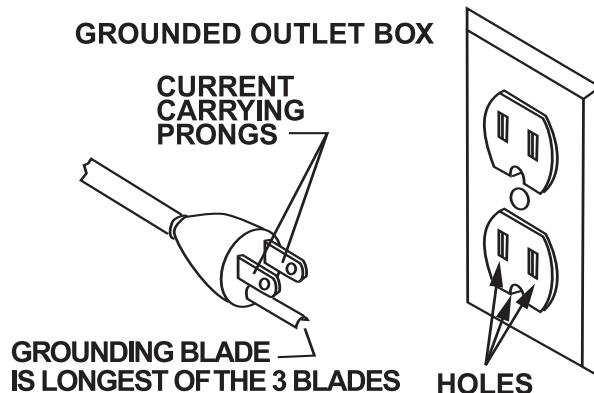
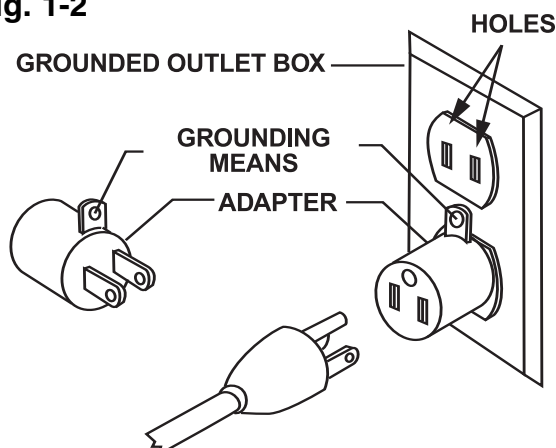

Fig. 1-2



EXTENSION CORDS

WARNING



To reduce the risk of fire or electrical shock, use the proper gauge of extension cord. When using an extension cord, be sure to use one heavy enough to carry the current your machine will draw.

The smaller the gauge-number, the larger the diameter of the extension cord is. If in doubt of the proper size of an extension cord, use a shorter and thicker cord. An undersized cord will cause a drop in line voltage resulting in a loss of power and overheating.

CAUTION

USE ONLY a 3-wire extension cord that has a 3-prong grounding plug and a 3-pole receptacle that accepts the machine's plug.

If you are using an extension cord outdoors, be sure it is marked with the suffix "W-A" ("W" in Canada) to indicate that it is acceptable for outdoor use.

Make certain the extension cord is properly sized, and in good electrical condition. Always replace a worn or damaged extension cord immediately or have it repaired by a qualified person before using it.

Protect your extension cords from sharp objects, excessive heat, and damp or wet areas.

MINIMUM RECOMMENDED GAUGE FOR EXTENSION CORDS (AWG)

120 VOLT OPERATION ONLY			
	25' LONG	50' LONG	100' LONG
0 to 6 Amps	18 AWG	16 AWG	16 AWG
6 to 10 Amps	18 AWG	16 AWG	16 AWG
10 to 12 Amps	16 AWG	16 AWG	14 AWG

UNPACKING & INVENTORY

Check shipping carton and machine for damage before unpacking. Carefully remove packaging materials, parts and machine from shipping carton. Always check for and remove protective shipping materials around motors and moving parts. Lay out all parts on a clean work surface.

Compare the items to inventory figures; verify that all items are accounted for before discarding the shipping box.

⚠ WARNING

If any parts are missing, do not attempt to plug in the power cord and turn "ON" the machine. The machine should only be turned "ON" after all the parts have been obtained and installed correctly. For missing parts, contact Steel City at 1-877-SC4-TOOL.



- A) Mini Dust Collector
- B) Hose clamps 4.5" (2)
- C) Rubber Coupling
- D) Hose Clamp 4"
- E) Dust Collection Bag (Not Shown)

ASSEMBLY and OPERATIONS

⚠ WARNING

1. **DO NOT** assemble the Dust Collector until you are sure the tool **IS NOT** plugged in.
2. **DO NOT** assemble the Dust Collector until you are sure the power switch is in the "OFF" position.
3. For your own safety, **DO NOT** connect the machine to the power source until the machine is completely assembled and you read and understand the entire Owner's Manual.
4. The Mini Dust Collector should **ONLY** be connected to one machine at a time.

⚠ WARNING

MAKE CERTAIN THE DUST COLLECTOR IS DISCONNECTED FROM THE POWER SOURCE.

1. Attach the dust collection bag (A) over the exhaust port (C) of the dust collector and secure with the 4" hose clamp (B). **SEE FIG. 1.**
2. Slide the rubber coupler (F) half way over the intake port (D) of the dust collector and secure it with one of the 4.5" hose clamps (E).
3. Slide the other half of the rubber coupler (F) over the 4" dust port opening of the machine (NOT SHOWN) you are using the dust collector on.
4. Using the second 4.5" hose clamp (E), secure the rubber coupler (F) to the dust port opening.
5. To operate the dust collector, once the dust collector is attached to the machine you are using, turn on the dust collector first and then turn on the machine it is connected to.
6. When you are finished, turn off the machine you are using first, and then turn off the dust collector.

Fig. 1

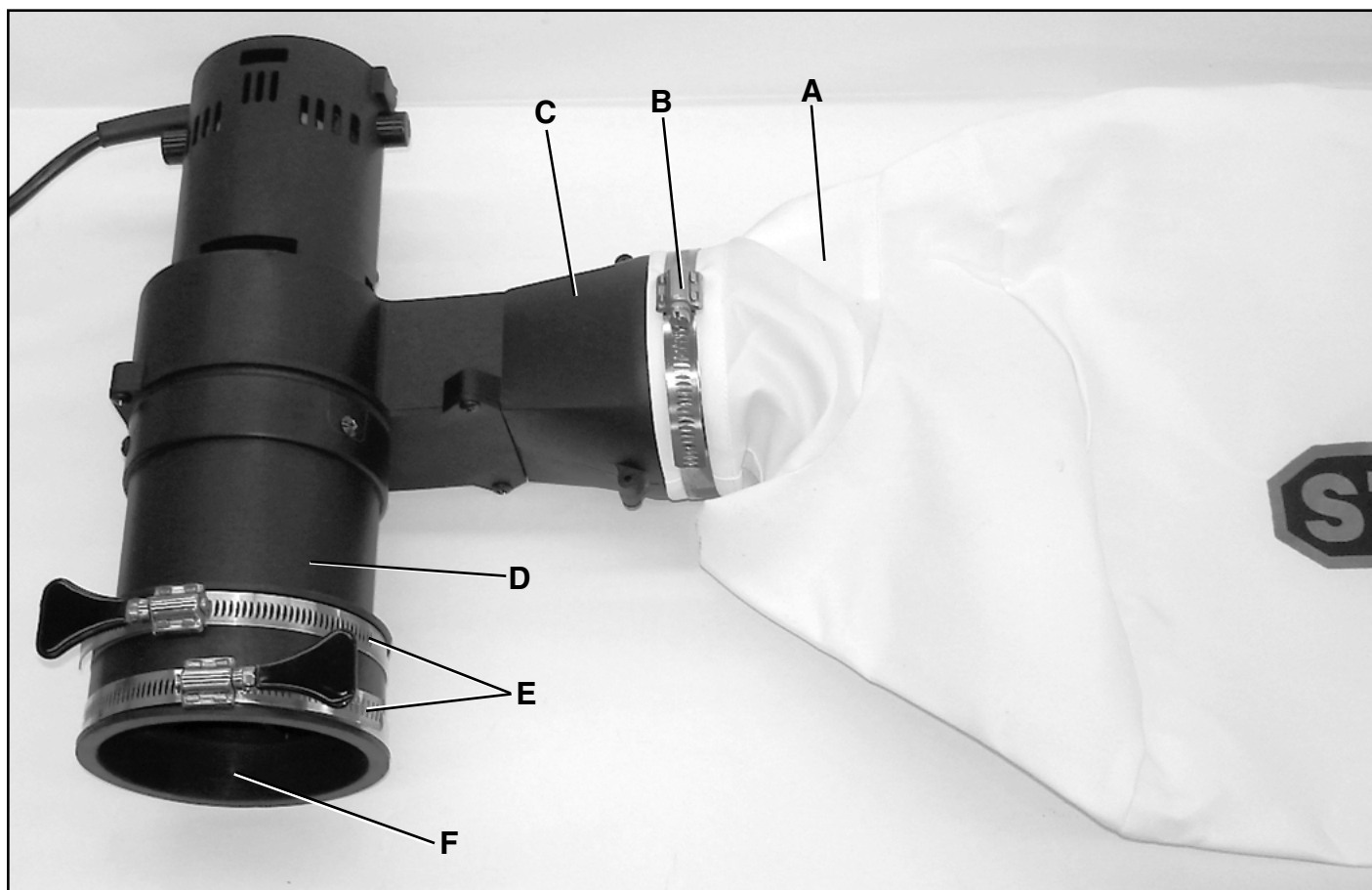

MAINTENANCE

⚠ WARNING

MAKE CERTAIN THE DUST COLLECTOR IS DISCONNECTED FROM THE POWER SOURCE.

REPLACING THE BRUSHES

1. Unscrew the brush cap (D) from the dust collector (A). **SEE FIG. 2.**

Fig. 2

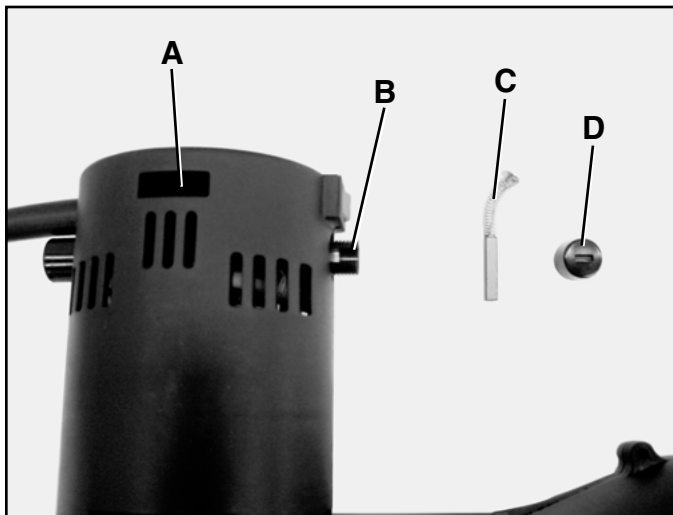

2. Remove the brush (C) from the brush housing (B).
3. Install the new brush into the brush housing.
4. Use a small flat blade screw driver (NOT INCLUDED) (E) to push and hold down on the top of the brush (F). **SEE FIG. 3.**

Fig. 3

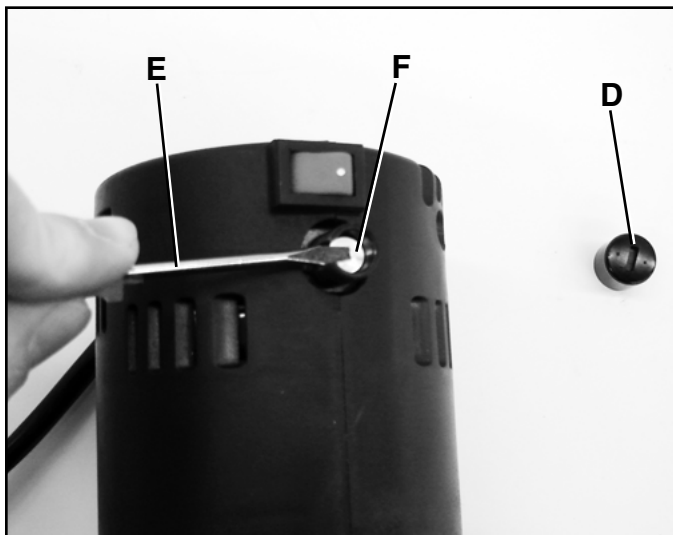

5. While holding down on the top of the brush (F), screw the brush cap (D) down onto the brush housing as far as you can. Then remove the screw driver (E) and finish tightening the brush cap.

6. Repeat steps 1 thru 5 for the other brush.

CLEANING

⚠ WARNING

MAKE CERTAIN THE DUST COLLECTOR IS DISCONNECTED FROM THE POWER SOURCE.

⚠ WARNING

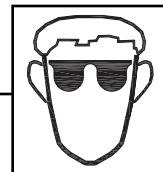
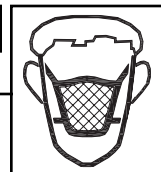

With the machine unplugged, blow off motor with low pressure air to remove dust or dirt. Air pressure above 50 P. S. I. should not be used as high-pressure air may damage insulation. The operator should always wear a respirator and eye protection when using compressed air.

Do not allow chips and dust to accumulate under dust collector. Keep area clean and in safe order.

LUBRICATION

The Dust Collector has sealed lubricated bearings in the motor housing that does not require any additional lubrication from the operator.

⚠ WARNING

Repairs to the Dust Collector should be performed by trained personnel only. Contact your nearest Steel City Dealer for authorized service. Unauthorized repairs or replacement with non-factory parts could cause serious injury to the operator and damage to the Dust Collector.

PARTS

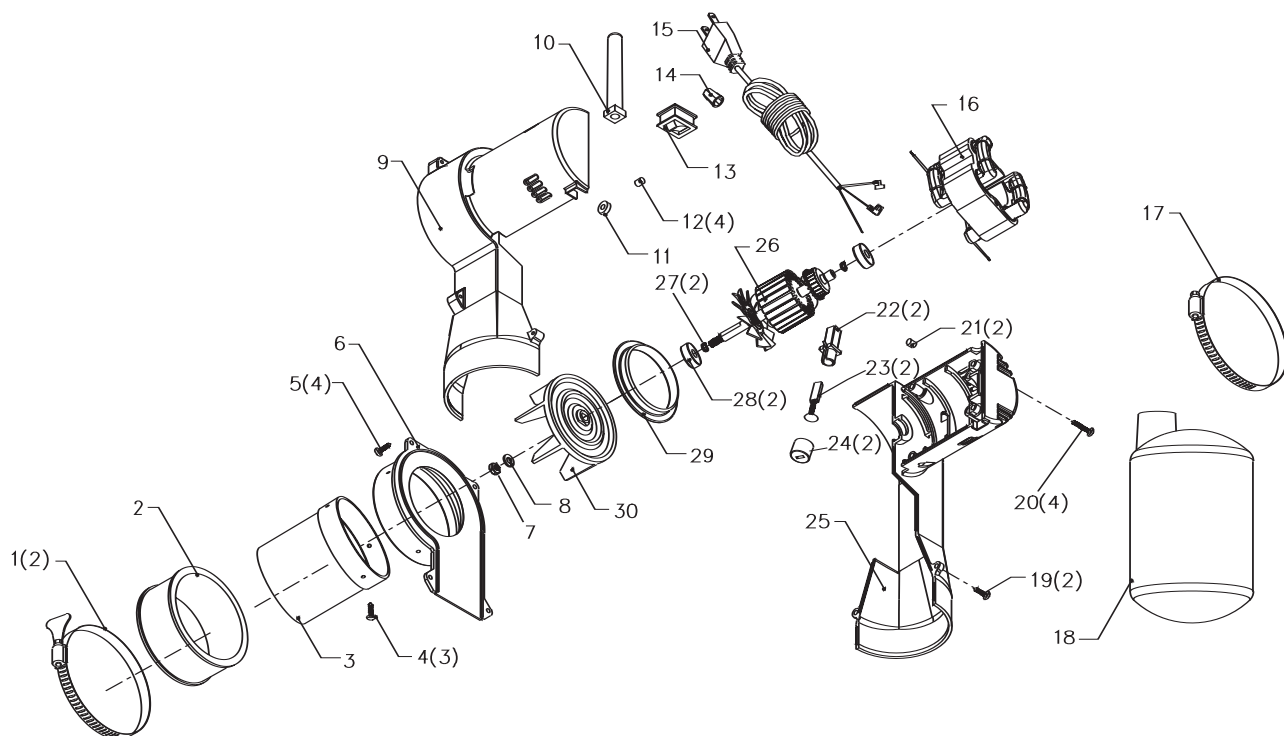

PARTS

KEY NO.	PART NO.	DESCRIPTION	QTY.	KEY NO.	PART NO.	DESCRIPTION	QTY.
1	OR73989	HOSE CLAMP 4-1/2"	2	18	OR74009	DUST COLLECTION BAG	1
2	OR73990	RUBBER COUPLER	1	19	OR95031	SCR SELF TAPPING M4.2 X 14mm	2
3	OR74010	ADAPTOR TUBE	1	20	OR95051	SCR SELF TAPPING M4.2 X 25mm	4
4	OR95050	SCR SELF TAPPING M4.2 X 12mm	3	21	OR74005	BEARING RETAINER	2
5	OR95050	SCR SELF TAPPING M4.2 X 12mm	4	22	OR74004	BRUSH HOLDER	2
6	OR73991	INTAKE COVER PLATE	1	23	OR74006	CARBON BRUSH	2
7	OR93370	NUT NYLOK M6	1	24	OR74007	BRUSH HOLDER CAP	2
8	OR90059	WASHER FLAT M6	1	25	OR74008	UPPER MOTOR HOUSING	1
9	OR73992	LOWER MOTOR HOUSING	1	26	OR74002	ARMATURE	1
10	OR73993	CORD PROTECTOR	1	27	OR95032	SNAP RING M8	2
11	OR73998	STATOR RETAINER	1	28	OR74001	BEARING 608	2
12	OR73997	BEARING RETAINER	4	29	OR74000	FAN SHROUD	1
13	OR73996	SWITCH	1	30	OR73999	IMPELLER	1
14	OR73995	WIRE NUT	1	31	OR74016	OWNERS MANUAL, ENGLISH	1
15	OR73994	POWER CORD	1	32	OR74017	OWNERS MANUAL, SPANISH	1
16	OR74003	STATOR	1	33	OR74018	OWNERS MANUAL, FRENCH	1
17	OR74011	HOSE CLAMP 4"	1	NA	OR74012	ARMATURE ASSEMBLY (CONSISTS OF REF #'S 26, 27, 28)	



STEEL CITY TOOL WORKS

www.steelcitytoolworks.com

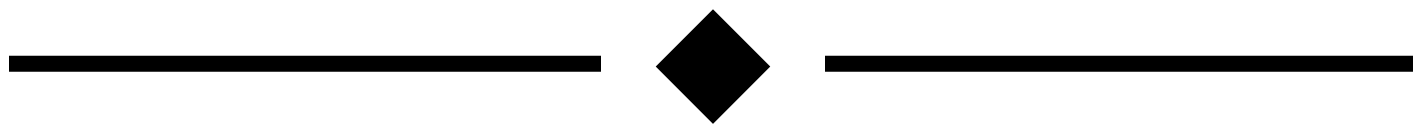

1 Year Warranty

