



Tandem
Arm™



SlimLine

Installation and User Manual

Table of Contents

Box Contents	4
Hardware Kits	5
Parts	6
Tandem Arm Installation	7
Wall Track	7
Tandem Arm Assembly	8
Optional Rotational Stops	10
Workstation	11
Slim Line Installation	14
Workstation	14
Integration	17
Weight Guidelines	17
Tandem Arm Technology Schematic	18
Slim Line Technology Schematic	19
Specifications	20
Monitor	21
Technology Box	22
External CPU Holder	23
Keyboard	24
Mouse Holder	24
Tandem Arm Cable Schematic	26
Slim Line Cable Schematic	27
Cable Management	28
Maintenance	31
Service	33
Warranty	33

REVISION HISTORY

Revision	Date	Description of Changes
A	09/2010	Initial Release
B	06/2012	Replace stops with machine screw p10.
C	2/2013	Change logos and references from RMS to Rubbermaid Healthcare

Warnings



IMPORTANT – Indicates a situation that does not present any hazard but is very important in maintaining a well functioning workstation.



ATTENTION – Consult manual to avoid a potentially hazardous situation which may result in minor or moderate injury.

- o Contact the facility Engineer of Record for direction on mounting locations and methods prior to installing any wall tracks or equipment.
- o The shipping weight of this unit is 86 lbs (39.0 kg). Use proper lifting techniques to prevent injury.



ELECTRICAL – Indicates an impending electrical hazard which, if not avoided, may result in personal injury, fire and/or death.

- o The supplied power cord is rated for medical use. Connecting the cord to an outlet that is not medical grade (indicated with a green dot) will not ensure grounding protection.
- o Power cord, USB extension, and workstation are for INDOOR use only. **DO NOT OPERATE OUTDOORS.**
- o Keep power cord away from water. **DO NOT PLUG CORD INTO OUTLET IF WET.**
- o **DO NOT OPERATE PRODUCT IF WET.** If the WORKSTATION becomes wet, unplug it immediately, wipe off any excess liquid, and allow it to dry before using again.
- o Inspect power cord before integration. **DO NOT USE POWER CORD IF DAMAGED.**
- o Fully insert power cord plug into outlet. **DO NOT** unplug by pulling on cord. **DO NOT** remove, bend or modify any metal prongs or pins of power cord.
- o **DO NOT** use excessive force to make mechanical or electrical connections.
- o **DO NOT** use an electrical extension cord with your workstation.
- o **DO NOT** use a flammable cleaner on the station as it can result in fire or explosion.

Tandem Arm Disposal

Dispose of this product according to local guidelines.

Transport/Storage

Care should be taken to transport and store this system within a temperature range of 32°F to 90°F (0°C to 32°C); Humidity 20% RH to 95% RH non-condensing.

Box Contents

Upon receipt, the packaging will contain three internal boxes and the workstation.

WORKSTATION

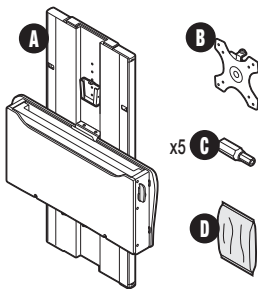

- A** Workstation
- B** Monitor Bracket
- C** Security Bit Driver Kit
- D** Slim Line Hardware Kit

Box 1

WALL TRACK

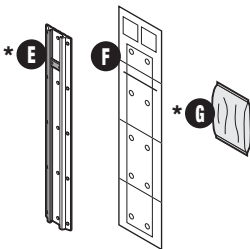

- * E** Wall Track
- F** Template
- * G** Wall Track Hardware Kit/

Box 2

ARM ASSEMBLY

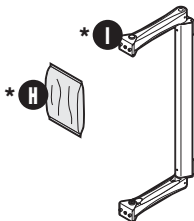

- * H** Tandem Arm Hardware Kit
- * I** Tandem Arm Assembly

Box 3



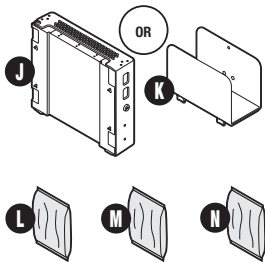







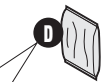



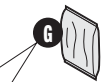



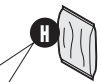

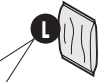

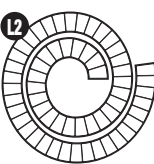
TECHNOLOGY BOX

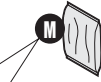

- J** Technology Box
- K** External CPU Holder
- L** Integration Hardware Kit
- M** Additional External CPU Holder Hardware Kit
- N** Mouse Holder Kit

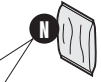
***Note:** Components for Tandem Arm **ONLY**.

Hardware Kits

<div>SLIM LINE</div> <div></div> <div><div><div><div>D1</div><div>x4</div></div><div><div>D2</div><div>x4</div></div><div><div>D3</div><div>x4</div></div></div><div><div><div>D1</div><div>#14 x 3" Wood Screw</div></div><div><div>D2</div><div>1/4 – 20 x 2.00 Phillips Head Screw</div></div><div><div>D3</div><div>Wall Anchor</div></div></div></div>	<div><div>Box 1</div><div>WALL TRACK</div></div> <div></div> <div><div><div><div>G1</div><div>x10</div></div><div><div>G2</div><div>x10</div></div><div><div>G3</div><div>x10</div></div></div><div><div><div>G1</div><div>Wood Screw</div></div><div><div>G2</div><div>1/4 – 20 x 2.00 Phillips Head Screw</div></div><div><div>G3</div><div>Wall Anchor</div></div></div></div>	<div><div>Box 2</div><div>ARM ASSEMBLY</div></div> <div></div> <div><div><div><div>H1</div><div>x4</div></div></div><div><div><div>H1</div><div>M6 x 12 Cap Head Socket Screw</div></div></div></div>
<div><div>Box 3</div><div>TECHNOLOGY BOX</div></div> <div></div> <div><div><div><div><div>L1</div><div>x4</div></div><div><div>L2</div><div>x2</div></div><div><div>L3</div><div>x2</div></div><div><div>L4</div><div>x4</div></div></div><div><div><div>L1</div><div>M4 x 10 Button Head Socket Screw</div></div><div><div>L2</div><div>24" Cable Wrap</div></div><div><div>L3</div><div>Cable Tie Mount</div></div><div><div>L4</div><div>4" Cable Tie</div></div></div></div></div>	<div></div> <div><div><div><div><div>M1</div><div>x2</div></div><div><div>M2</div><div>x2</div></div><div><div>M3</div><div>x2</div></div></div><div><div><div>M1</div><div>#14 x 3" Wood Screw</div></div><div><div>M2</div><div>1/4 – 20 x 2.00 Phillips Head Screw</div></div><div><div>M3</div><div>Wall Anchor</div></div></div></div></div>	<div></div> <div><div><div><div><div>N1</div><div>x2</div></div><div><div>N2</div><div>x2</div></div><div><div>N3</div><div>x2</div></div><div><div>N4</div><div>x2</div></div></div><div><div><div>N1</div><div>Mouse Holder</div></div><div><div>N2</div><div>M4 x 12 Button Head Socket Screw</div></div><div><div>N3</div><div>M4 Flat Washer</div></div><div><div>N4</div><div>M4 x 0.7 Nylon Nut</div></div></div></div></div>

Parts

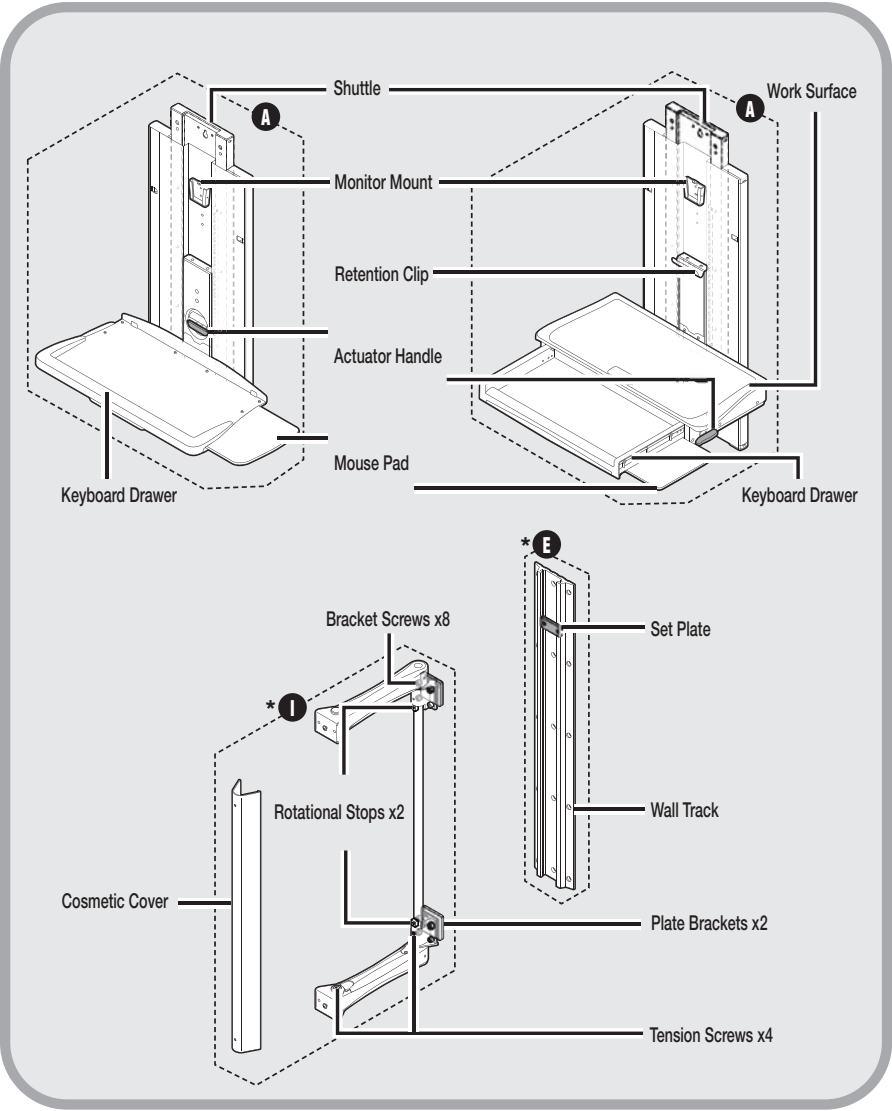

***Note:** Components for Tandem Arm **ONLY**.

Tandem Arm Installation

WALL TRACK

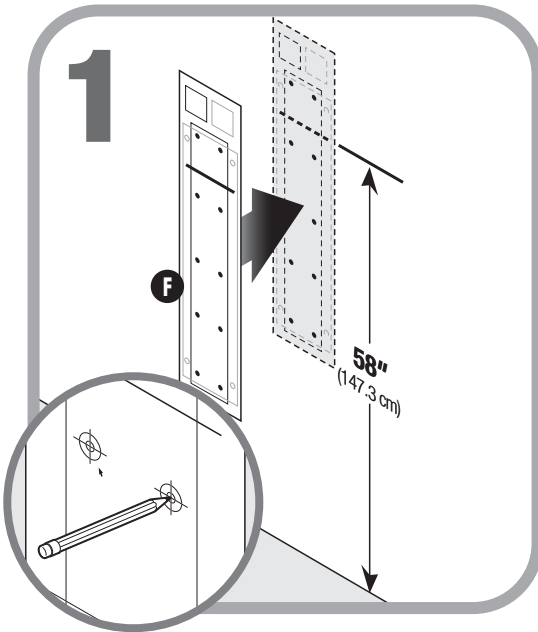

⚠ Note: Consult the Engineer of Record regarding structural codes and utilities.

Use the wall track template (F) to determine drill hole locations. Set line should be 58" (147.3 cm) from floor. Mark and drill holes labeled for Tandem Arm only.

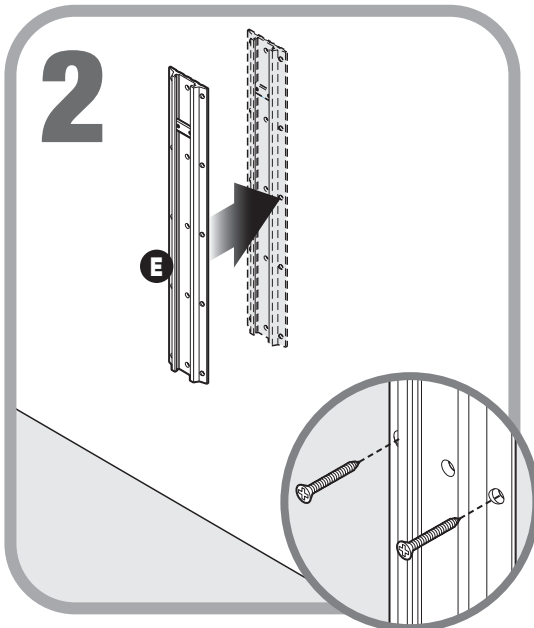

⚠ Note: Install wall track (E) using hardware provided.

Note: Use part wall anchor (G3) and machine screws (G2) for steel stud installation. Use wood screws (G1) for wood studs.

Tandem Arm Installation

TANDEM ARM ASSEMBLY

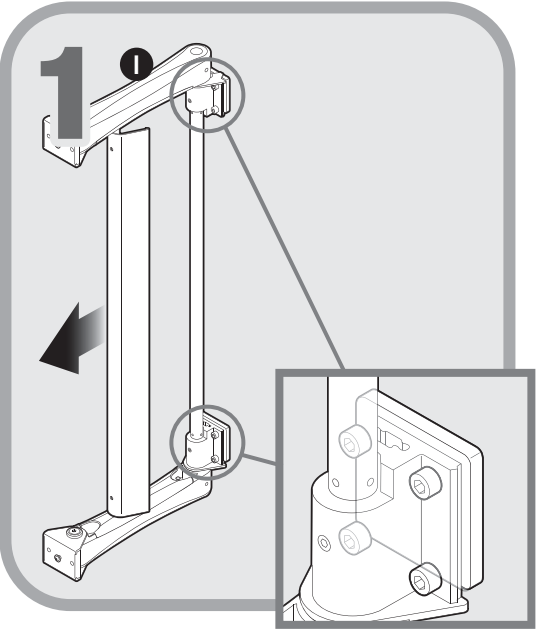

- o To reveal eight bracket screws, pull the cosmetic cover and remove it from the tandem arm assembly (I).

Note: Make sure the eight bracket screws are loose (DO NOT REMOVE).

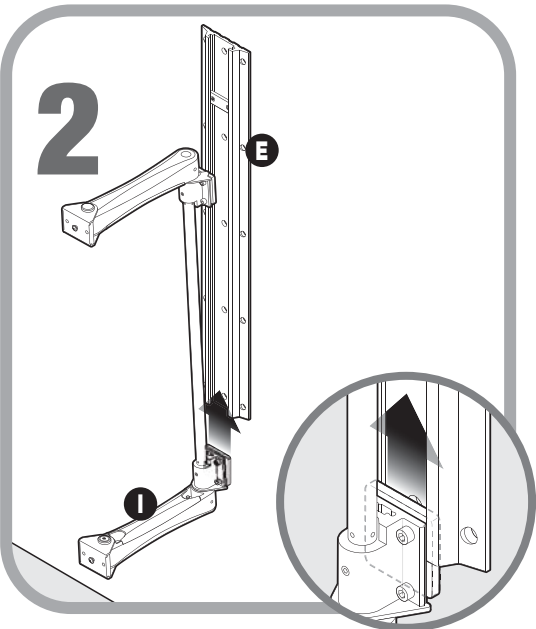

- o Slide the bottom plate bracket into the wall track (E).

Note: Step 2 continues into Step 3 and the two steps should be done in one continuous motion.

Tandem Arm Installation

TANDEM ARM ASSEMBLY

3

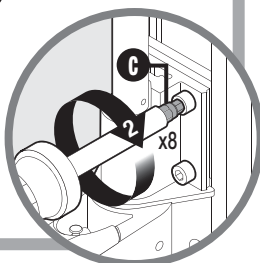
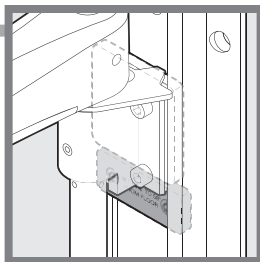
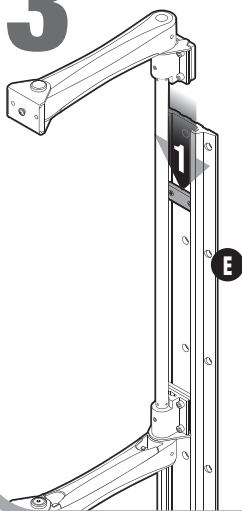

-  (1) Lower the top plate bracket into the wall track **(E)** until it rests on the set plate. (2) Using provided 5 mm hex bit **(C)**, tighten eight bracket screws on the top and bottom plate brackets to 100 in/lb (115.2 kg/cm).

4

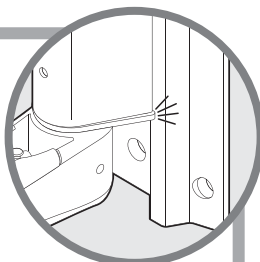
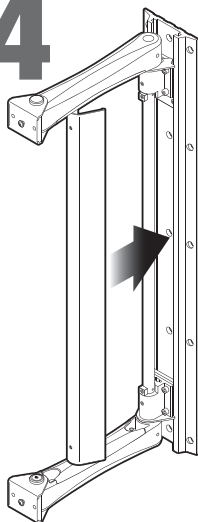

- o Snap the cosmetic cover onto the tandem arm assembly.

Note: The tension screws allow you to increase or decrease the force required to rotate the arm.

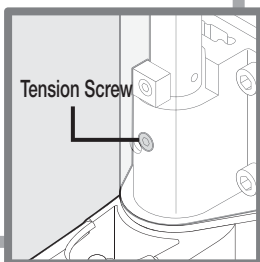

Tandem Arm Installation

OPTIONAL ROTATIONAL STOPS

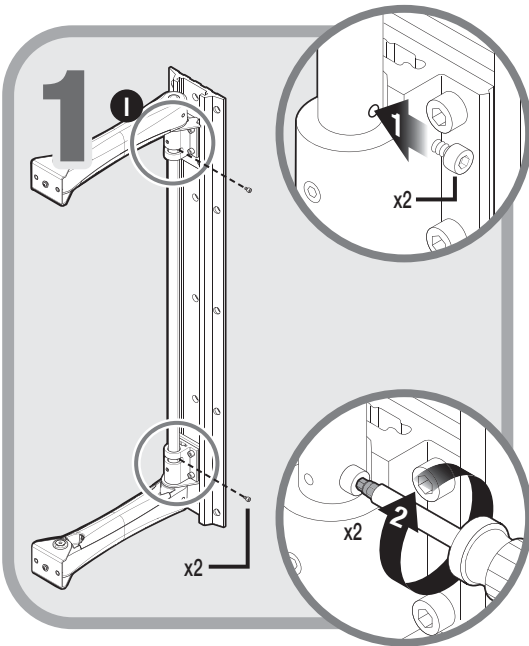
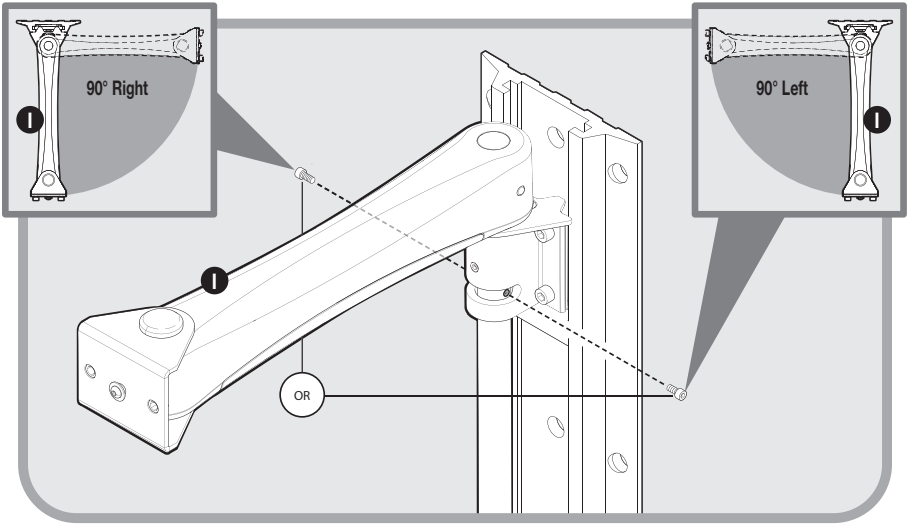

o To change the direction of the 90° arm rotation, or to change to 180° rotation, remove the cosmetic cover.

1. Remove 2 rotational stops (1)
2. insert 2 rotational stops (2) on the tandem arm (1) in desired position.

Note: For 180° travel, remove and discard both stops.

3. Replace the cosmetic cover.

Tandem Arm Installation

WORKSTATION

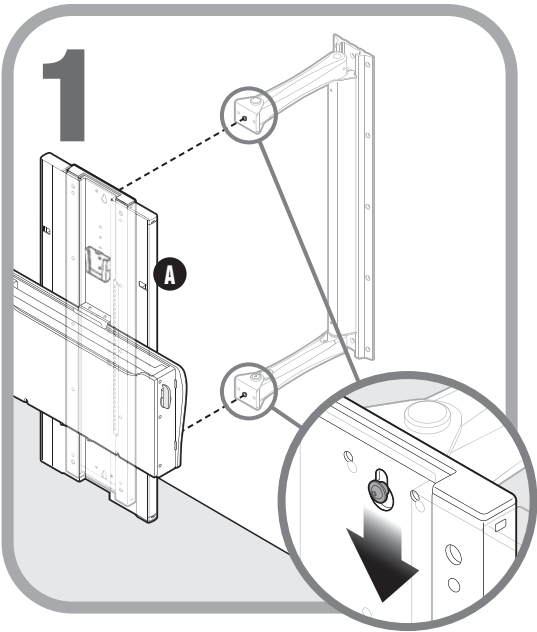

- o On the back of the workstation **(A)**, line up keyholes on the shuttle with the studs on the upper and lower tandem arms and hang work station.

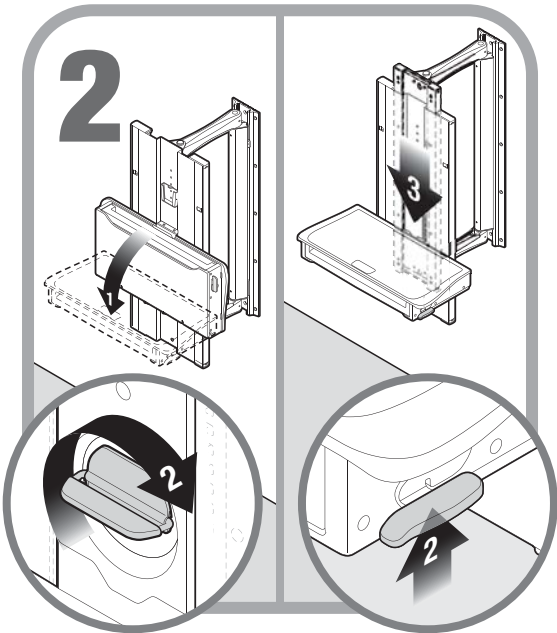

- o (1) Fold down work surface on workstation.
(2) Engage actuator handle and (3) lower the shuttle to access mounting holes. Fold the work surface closed.

Tandem Arm Installation

WORKSTATION

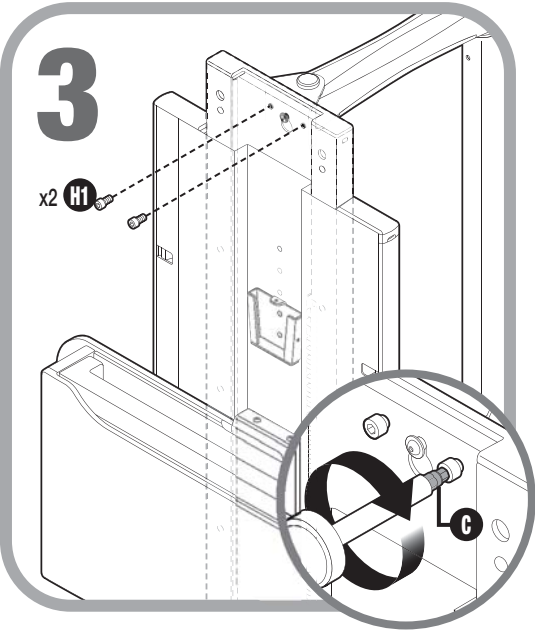

- ⚠ Insert two hex screws (**H1**) into the holes to the right and left of the top keyhole to secure the shuttle. Using provided 5 mm hex bit (**C**), tighten the two hex screws provided to 100 in/lb (115.2 kg/cm).

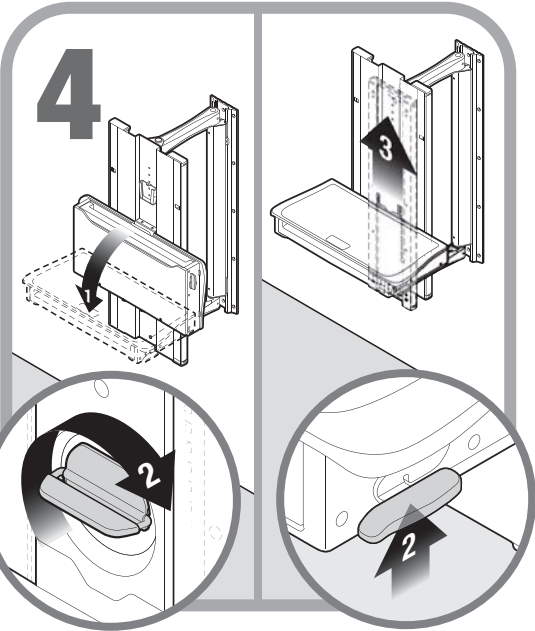

- (1) Fold down work surface on workstation. (2) Engage actuator handle and (3) raise the shuttle. Fold the work surface closed to access mounting holes.

Tandem Arm Installation

WORKSTATION

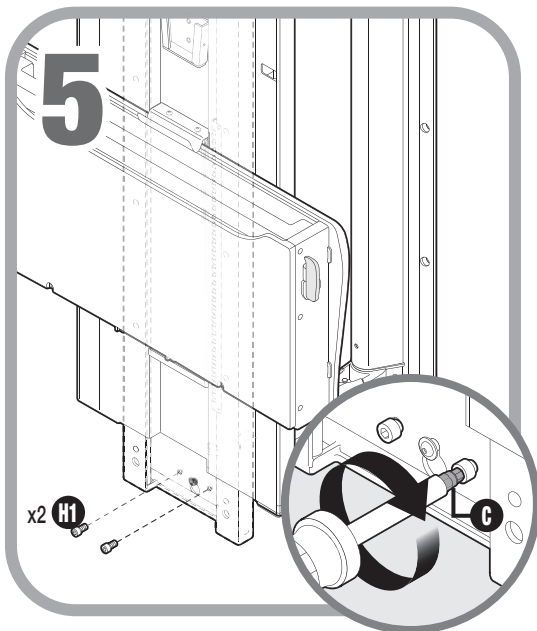

- ⚠ Insert two hex screws (**H1**) into the holes to the right and left of the bottom keyhole to secure the shuttle. Using provided 5 mm hex bit (**C**), tighten the two provided hex screws to 100 in/lb (115.2 kg/cm).

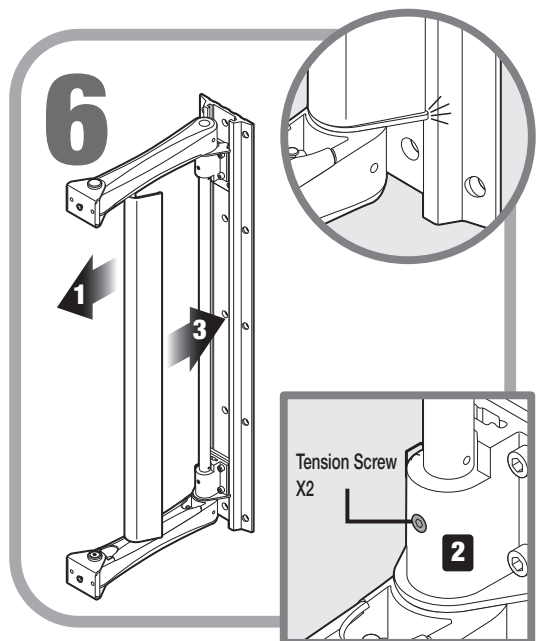

Adjust the Arm Tension (optional)

If the arm rotation of the Tandem Arm Workstation is either stiff or too loose, adjust the arm tension as follows:

- o (1) Remove the cosmetic cover.
- (2) Adjust the tension screws until the arm moves as desired.

Note: adjust the tension screws so both arms are tensioned equally.

- (3) Install the cosmetic cover.

Slim Line Installation

WORKSTATION

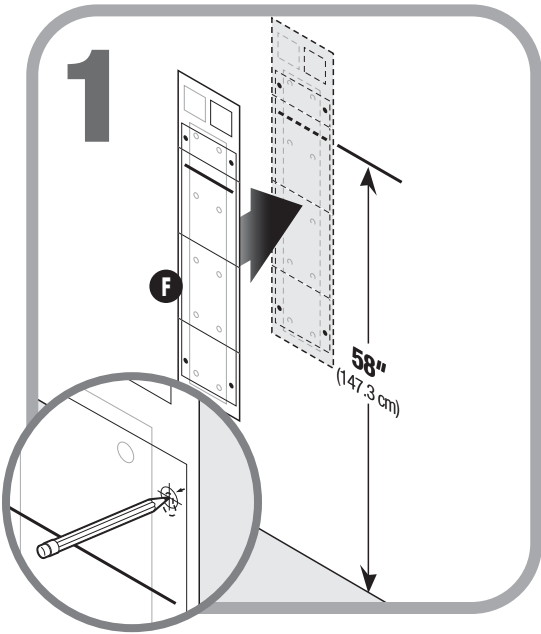

⚠ ^o **Note:** Consult the Engineer of Record regarding structural codes and utilities.

Use the wall track template (F) to determine drill hole locations. Mark and drill holes labeled for Slim Line only.

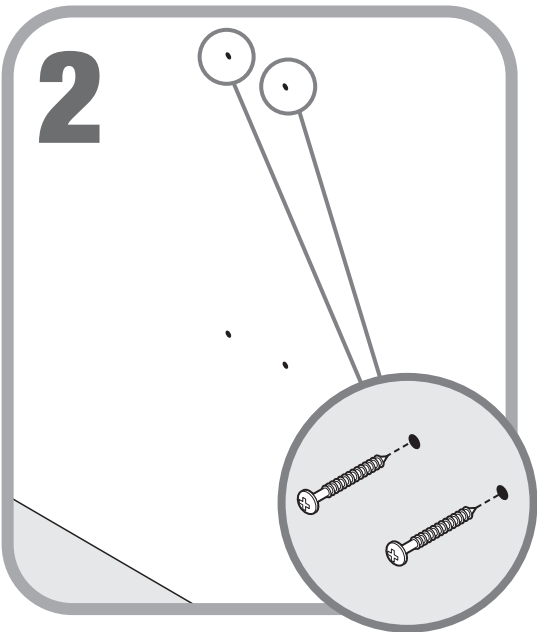

⚠ ^o Insert screws in top locations only.
Note: Use wall anchor (D3) and machine screws (D2) for steel stud installation. Use wood screws (D1) for wood studs.

Note: For steel stud installation, all wall anchors (D3) must be installed before proceeding.

Slim Line Installation

WORKSTATION

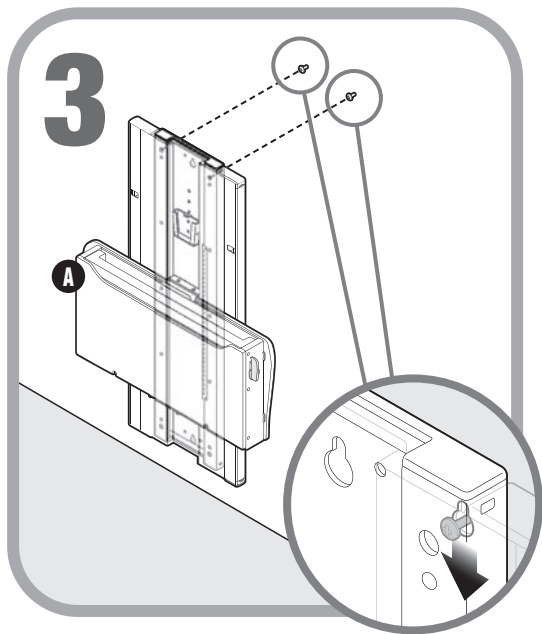

- o On the back of the workstation (**A**), line up two keyholes on the top of the shuttle with the previously installed screws.

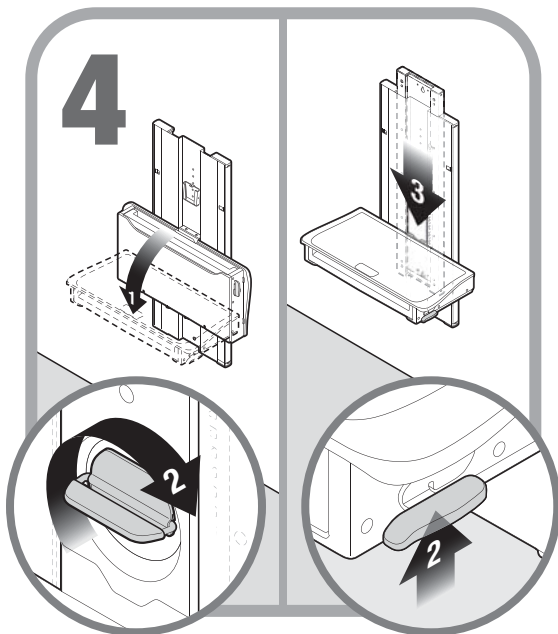

- o (1) Fold down work surface on workstation.
- o (2) Engage actuator handle and (3) lower the shuttle to access mounting holes. Fold the work surface closed.

Slim Line Installation

WORKSTATION

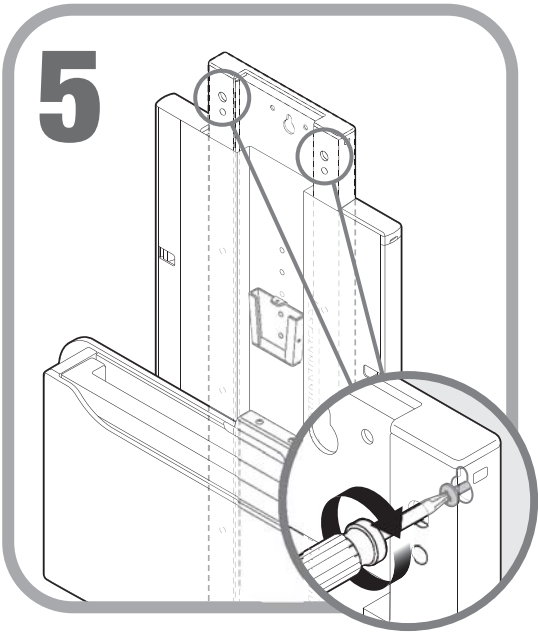

o Tighten two top screws to secure the shuttle.

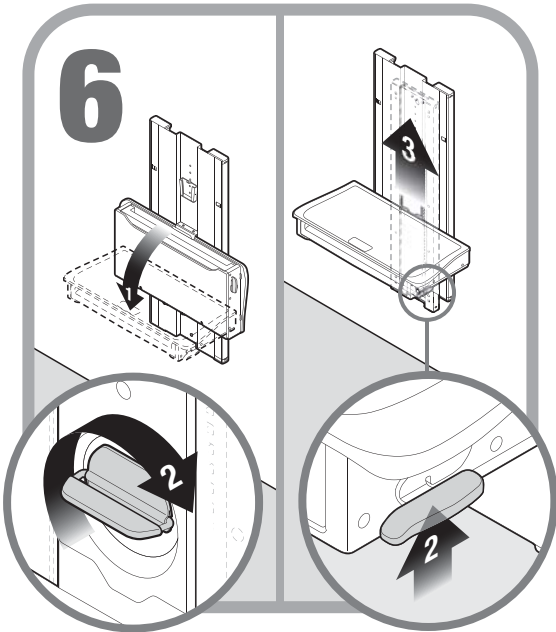

o (1) Fold down work surface on workstation.
(2) Engage actuator handle and (3) raise the shuttle. Fold the work surface closed to access mounting holes.

Slim Line Installation

WORKSTATION

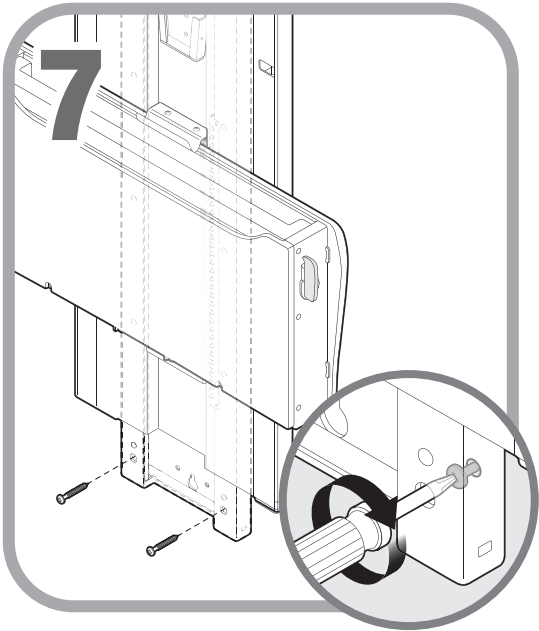

 Insert two screws in lower locations to secure the shuttle.

Note: Use machine screws **(D2)** for steel stud installation. Use wood screws **(D1)** for wood studs.

Integration

WEIGHT GUIDELINES

SKU Number*	Recommended Technology Weight**
FG9A36-TD-PTB	26 lbs (11.8 kg)
FG9A36-TD-STB	21 lbs (9.5 kg)
FG9A36-TD-PEC	16 lbs (7.3 kg)
FG9A36-TD-SEC	21 lbs (9.5 kg)
FG9A36-00-PTB	16 lbs (7.3 kg)
FG9A36-00-STB	21 lbs (9.5 kg)
FG9A36-00-PEC	16 lbs (7.3 kg)
FG9A36-00-SEC	21 lbs (9.5 kg)

* SKU number may be found by lowering the workstation to reveal the manufacturer label.

** Recommended weight only includes the technology mounted to the moving workstation. CPU's secured to the external CPU holder should not be considered for weight.

Integration

TANDEM ARM TECHNOLOGY SCHEMATIC

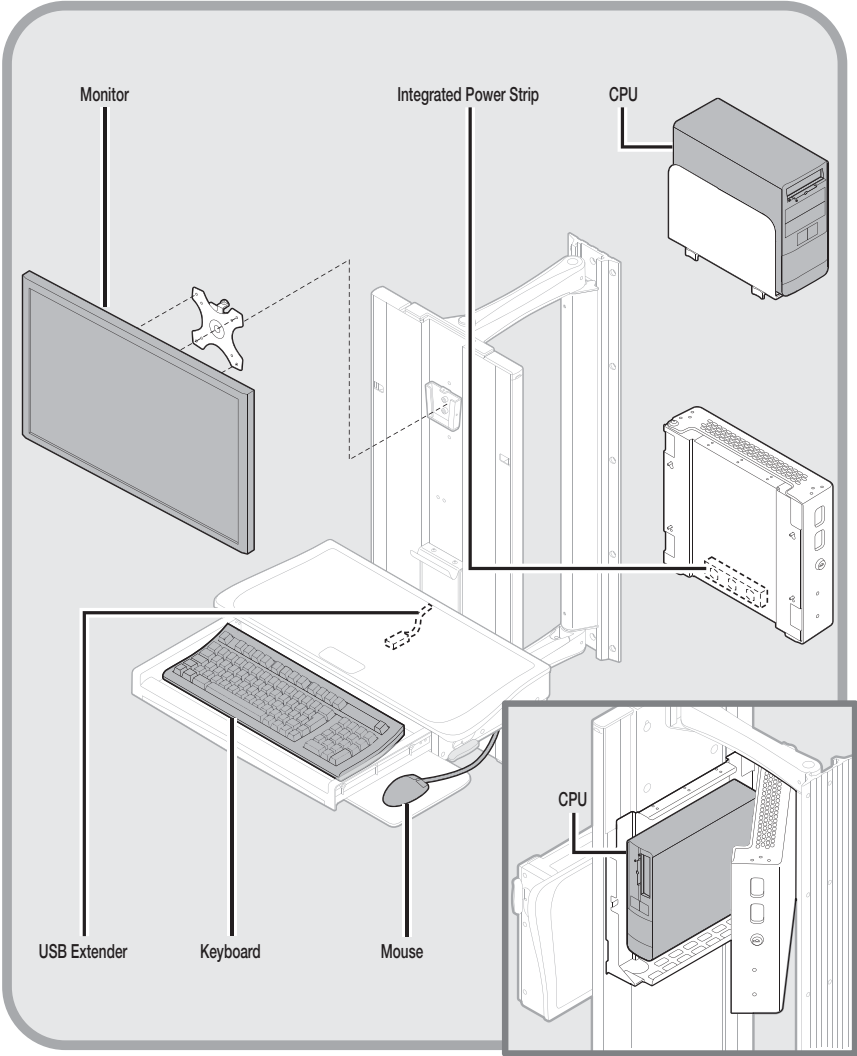

Integration

SLIM LINE TECHNOLOGY SCHEMATIC

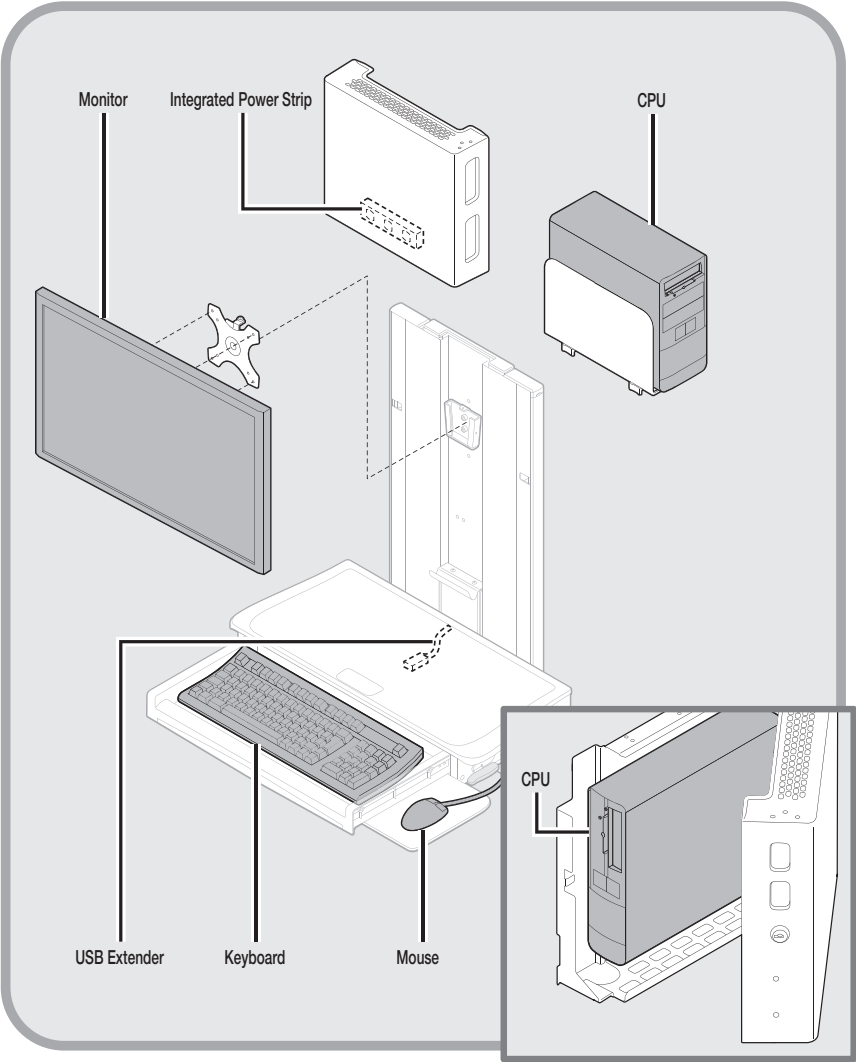

Integration

SPECIFICATIONS

Power Cord	5' (152.4 cm) length, Medical Grade NEMA Plug, 3x NEMA Receptacles, 125V 50/60Hz 250W max
USB Cables	2' x 6' (61.0 x 182.9 cm) length USB 2.0 Type A Male to Type A Female Extension Cables
Height Adjustment Range	15" (38.1 cm)
Monitor Bracket	25 lbs (11.3 kg) max ; VESA 75 mm & 100 mm
Keyboard Tray	Accommodates 2.25" H x 18" W x 7" D (5.7 cm x 45.7 cm x 17.8 cm); USB keyboard
Premium Work Surface	21.5"W x 11"D (54.6 cm x 27.9 cm)
Mouse Pad	Premium: 9.5"W x 8.25"D (24.1 cm x 21.0 cm); Standard: 8.5"W x 8.25"D (21.6 cm x 21.0 cm); USB Mouse
Rotation	180° rear pivot rotation; 180° front pivot rotation
Technology Box	Accommodates CPU size up to 2.6" H x 9.9" H x 10" D (6.6 cm x 25.1 cm x 25.4 cm); 7.5 lbs (3.4 kg); mechanical key lock
External CPU Holder	Accommodates CPU widths 2.5" – 8" (6.4 cm – 20.3 cm)

Integration

MONITOR

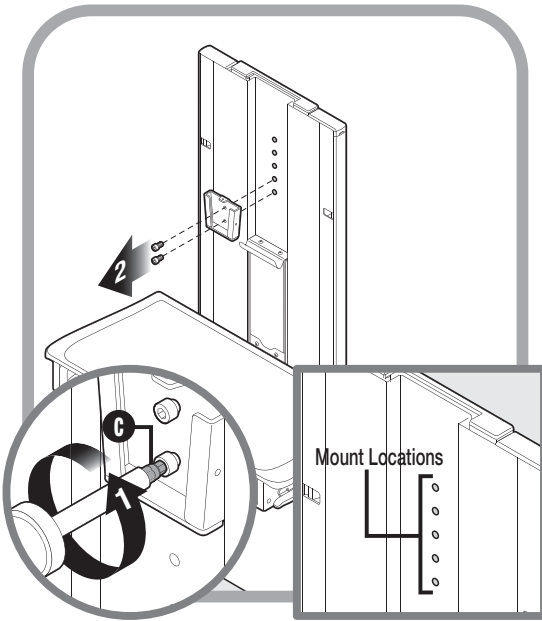

- o Monitor mount comes attached in the lowest position which is recommended for the broadest ergonomic range. Using the provided 3 mm hex bit (C), the mount can be removed and adjusted as needed.

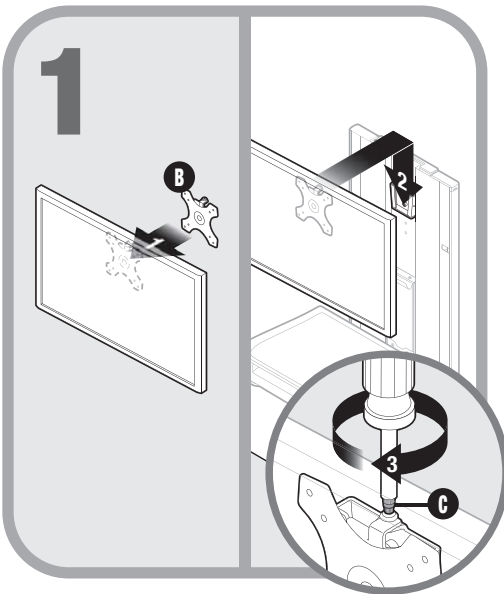

- o (1) Attach monitor bracket (B) to monitor then (2) insert into the monitor mount on workstation. (3) Tighten top bracket screw using provided 5 mm hex bit (C).

Integration

TECHNOLOGY BOX

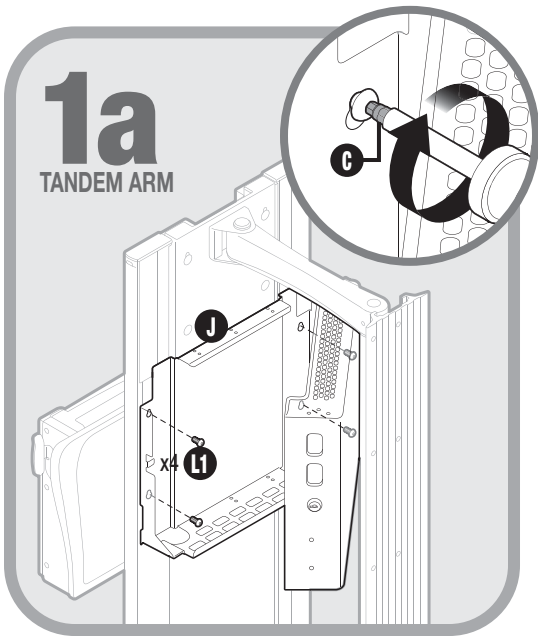

- o Open the technology box (J). Using screws (L1), mount to rear of workstation. Using provided 3 mm hex bit (C), tighten screws.
Note: Larger CPU's must use the external CPU holder (K).

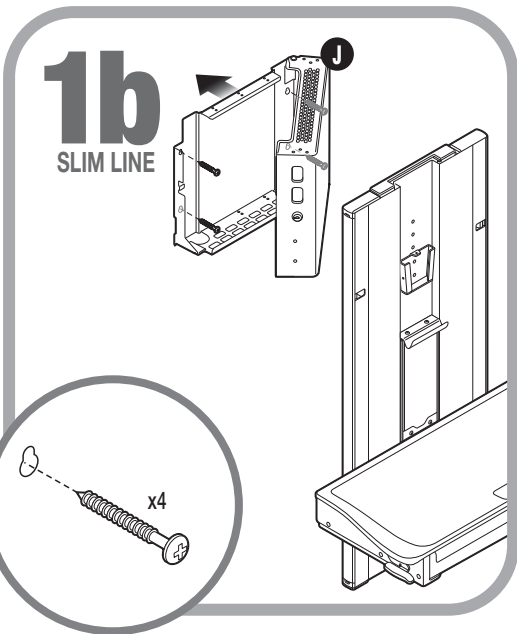

- ⚠ Mount the technology box (J) to the wall above the workstation using hardware provided.
Note: Use part wall anchor (M3) and machine screws (M2) for steel stud installation. Use wood screws (M1) for wood studs.
Note: Larger CPU's must use the external CPU holder (K).

Integration

OPTIONAL EXTERNAL CPU HOLDER

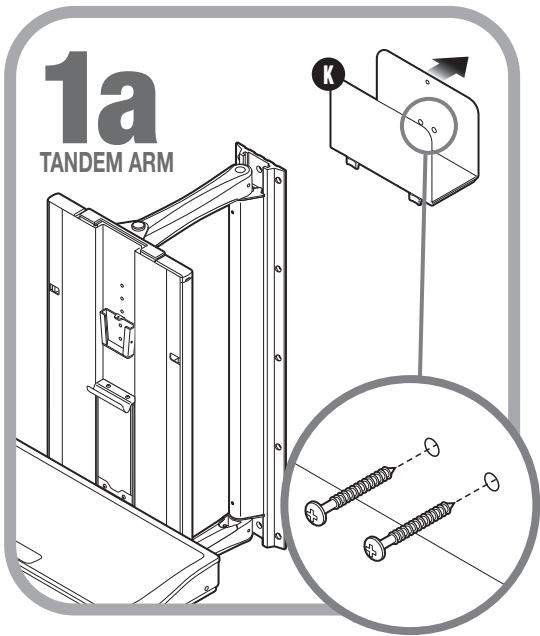

- ⚠ Mount the external CPU holder (K) to the wall above the workstation using hardware provided.
- Note:** Use part wall anchor (M3) and machine screws (M2) for steel stud installation. Use wood screws (M1) for wood studs.
- Note:** Larger CPU's must use the external CPU holder.

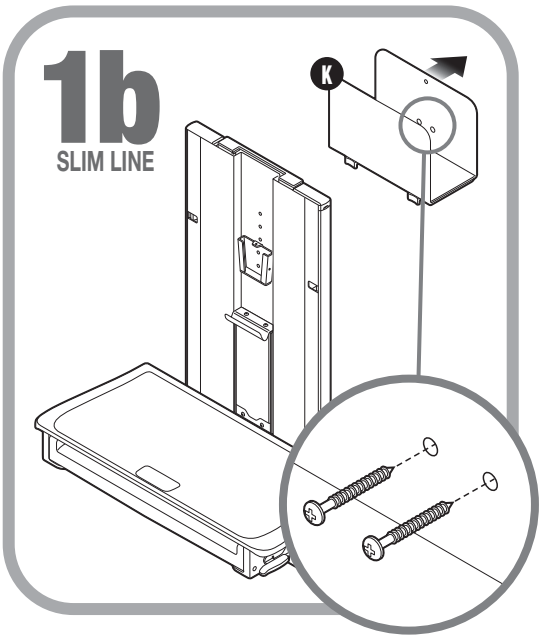

- ⚠ Mount the external CPU holder (K) to the wall above the workstation using hardware provided.
- Note:** Use part wall anchor (M3) and machine screws (M2) for steel stud installation. Use wood screws (M1) for wood studs.
- Note:** Larger CPU's must use the external CPU holder.

Integration

KEYBOARD

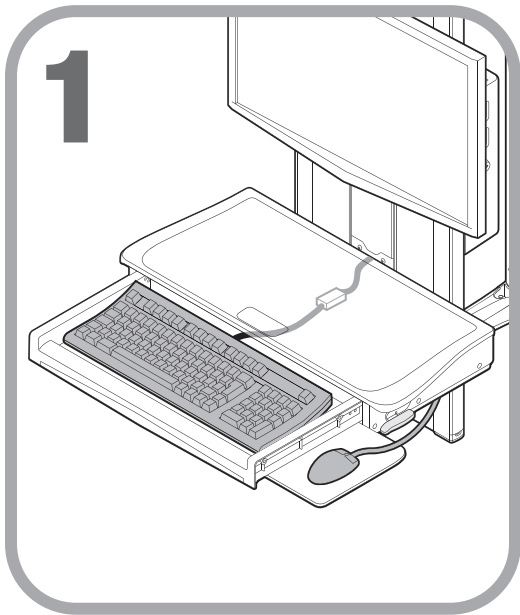

- o Place keyboard into keyboard drawer. Plug the USB connector into the pre-wired USB extender.

Note: Secure keyboard to drawer with velcro to avoid slipping.

MOUSE HOLDER

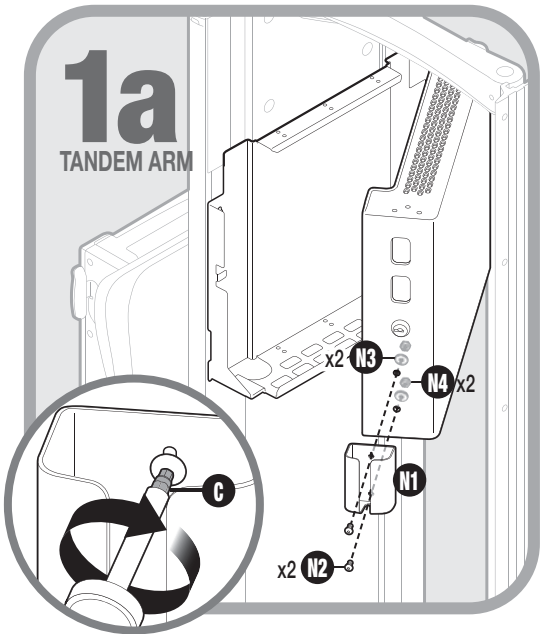

- o Open the technology box. Using screws , washers , and nuts , mount the mouse holder to the technology box. Using provided 3 mm hex bit , tighten screws.

Integration

MOUSE HOLDER

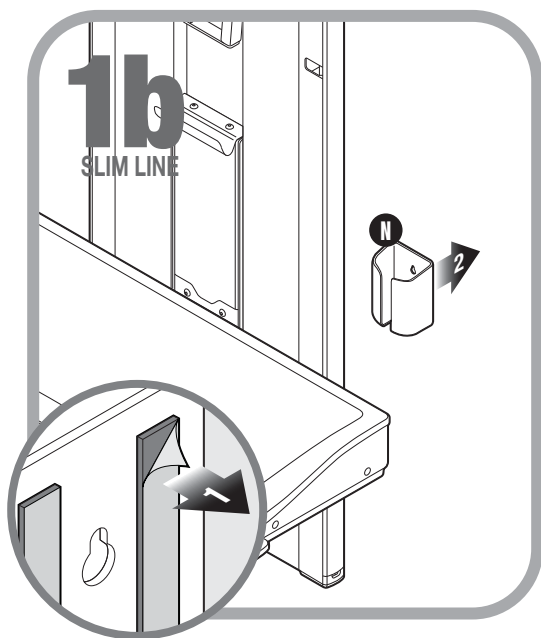

- o (1) Peel backing from adhesive and (2) mount mouse holder **(N1)** on the wall at desired location.

Integration

TANDEM ARM CABLE SCHEMATIC

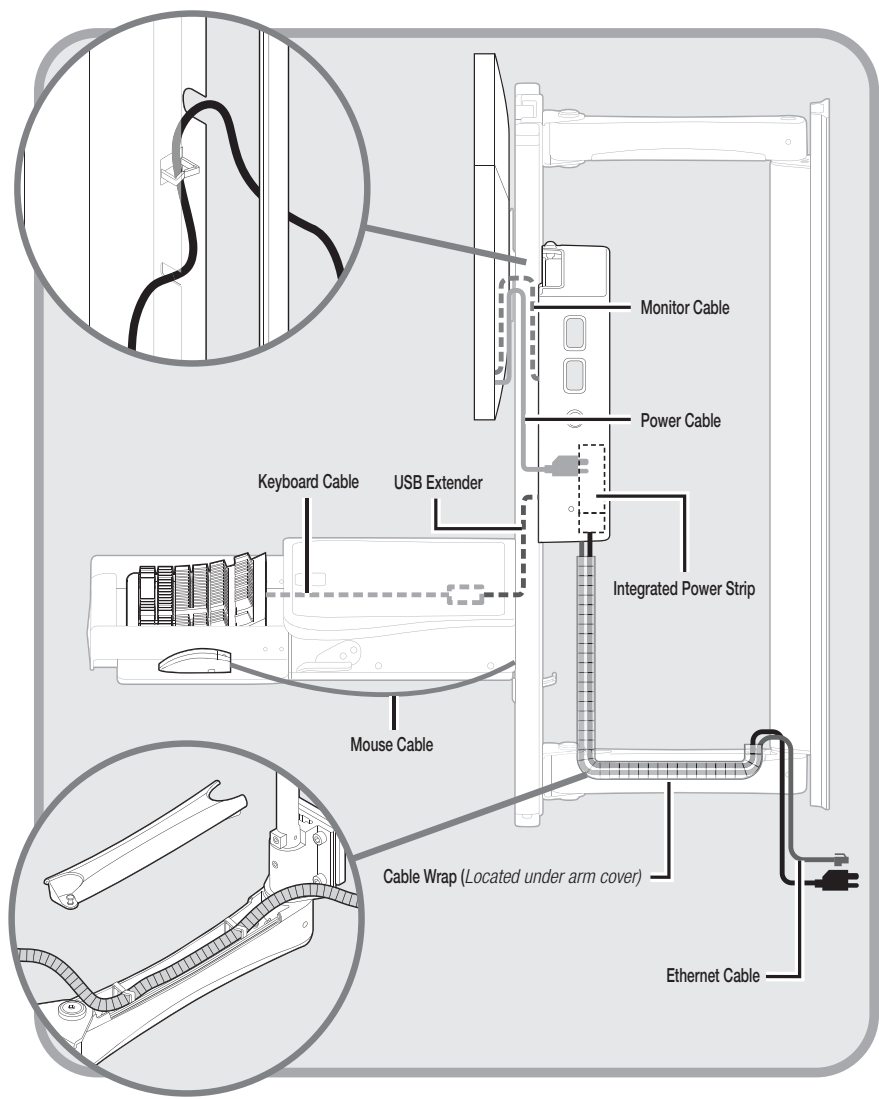

Integration

SLIM LINE CABLE SCHEMATIC

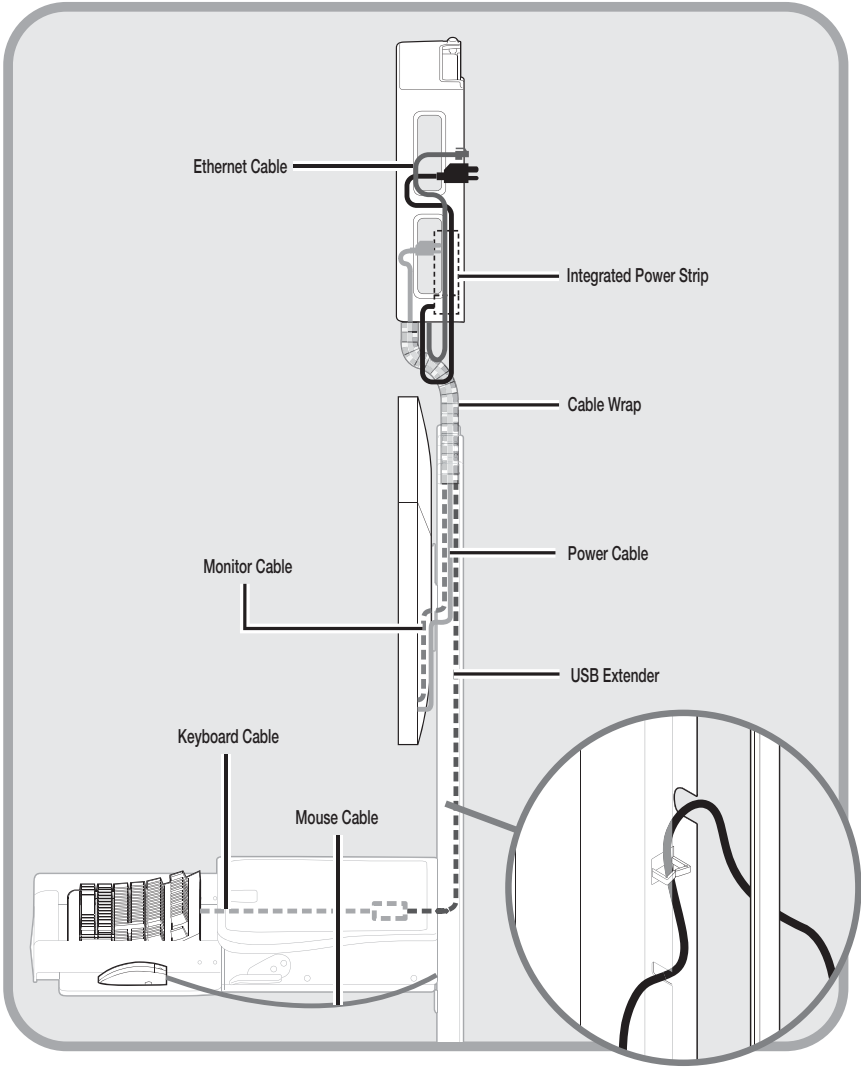

Integration

CABLE MANAGEMENT

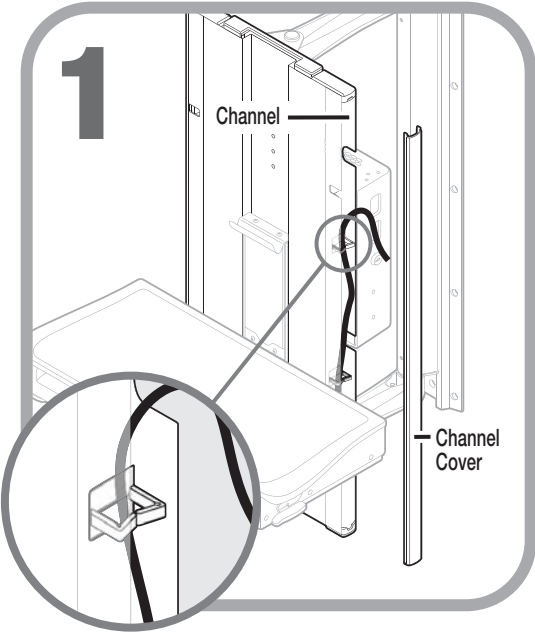

- o Remove plastic shrouds to access cable channels and cable management clips.

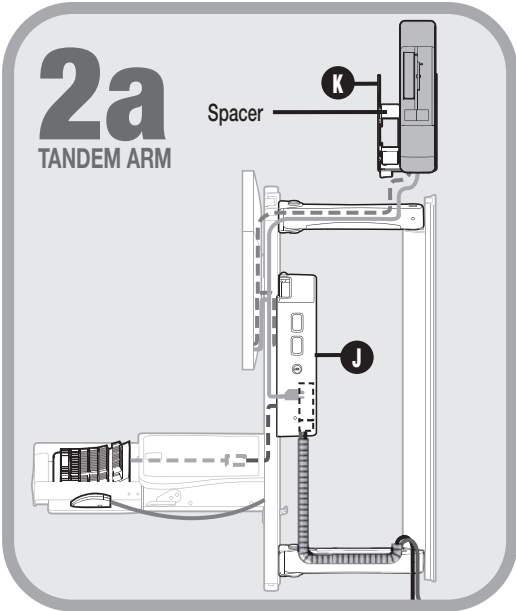

- o Cables may be routed through the technology box (J) or through the tandem arms to the wall for an external CPU holder (K).

Integration

CABLE MANAGEMENT

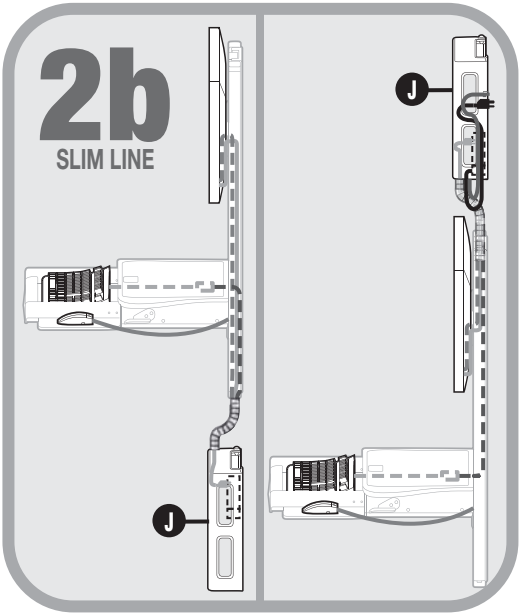

- o Cables may be routed to the technology box (K) or the external CPU holder (L) through the top or bottom of the workstation.

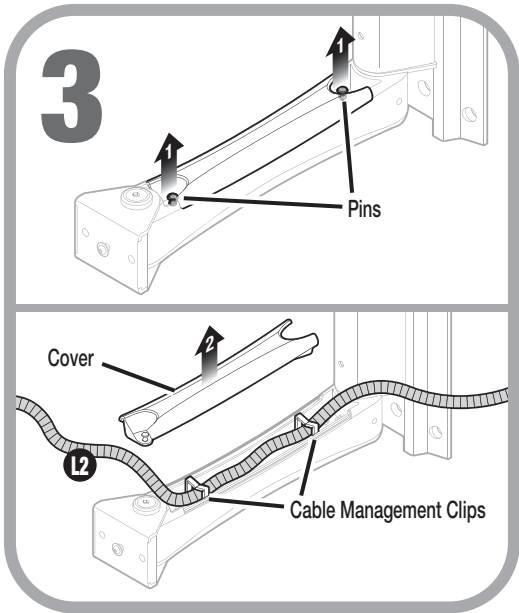

- o (1) Pull pins to (2) release the covers on the tandem arms and reveal cable management clips.



Note: Ensure cord wrap (L2) is used to prevent cords/cables from being severed from the pivot arms.

Integration

CABLE MANAGEMENT

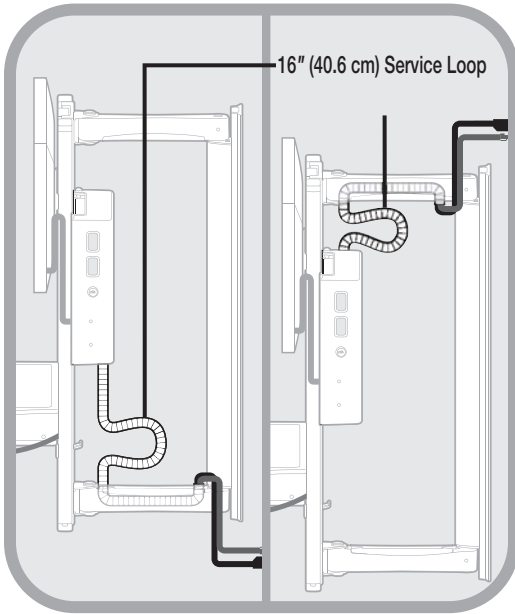

Service Loop – Leave 16" (40.6 cm) of cable exposed to allow for the height adjustment of the shuttle. If routing cables through the top, lower the workstation to its lowest position to ensure your service loop is adequate. If routing cables through the bottom, raise the workstation to its highest position to ensure your service loop is adequate.

Note: *Tandem Arm shown for reference. Service Loop applies to both Tandem Arm and Slim Line installations.*

Maintenance

DO NOT use the workstation if pieces are missing or



the unit is damaged. In these cases, immediately

contact **Rubbermaid Customer Service** for more information:
1-888-859-8294.

Cables: Always keep the cables neatly organized and be sure to route cables away from moving components with wire ties or cable clips.

Power Cord: Periodically inspect power cord and plug to ensure plug is not bent and cable is not frayed.

CLEANING

CAUTION: Because of the close proximity of electrical



power and equipment, flammable cleaners should never be used on the workstation.

- Verify that your workstation is unplugged from the wall outlet before cleaning.
- Allow your workstation to dry completely before plugging the power cord into a wall outlet.
- When cleaning the workstation, wipe surface with a damp cloth and thoroughly dry.
- **NEVER** cover the workstation or its components with liquid or allow liquids to flow into the workstation.
- **NEVER** use steel wool or other abrasive material as these could damage the surface finish.
- Before using any cleaner on the workstation, first test on a small area to ensure that the surface is not harmed.
- These guidelines cannot guarantee infection control. The hospital's Infection Control Administrator should be consulted

regarding cleaning procedures and schedules.

- Clean plastic components with diluted, non-abrasive solutions. Suggested cleaners are water, soap, diluted bleach and alcohol solutions.
- Remove pen and dry erase marker stains with a soft cloth and 91% isopropyl alcohol.
- Remove iodine stains with a soft cloth and any cleaners suggested above.



DO NOT use the following chemicals to clean your

workstation: acetone, mineral spirits, abrasive cleansers, paint thinner or any other harsh or toxic chemicals.

TROUBLESHOOTING

Problem	Solution
The lift is too hard to push down or does not rise.	Compare the total weight of the technology versus the weight guidelines in the integration section of this manual. Mounting excessive weight on the workstation will prevent the unit from rising. Placing minimal weight on the workstation will increase the pressure required to lower the unit. Refer to page 18.
The workstation is too difficult or easy to rotate right and left at the end of the arms.	Using a 5 mm hex bit, adjust the bolts on the front pivot of the upper and lower tandem arms to the desired tension. See detail on page 6.
The tandem arms are too difficult or too easy to rotate right or left at the wall pivot point	Adjust the tension on the rear pivot bar. Locate the 2 holes in the front of the cosmetic cover. Use a 3 mm hex bit to adjust. Refer to page 10.
The workstation will not raise or lower all the way.	Check the cable management from the rear of the workstation or technology box to the wall. There should be at least a 16" (40.6 cm) service loop in the cables to enable full range of motion. Refer to page 31.
The workstation is hitting an object mounted on the wall to either the right or left.	Use the rotational stops to prevent the workstation from rotating left or right. Refer to the installation instructions in the "Optional Rotational Stops" section on page 11 of this document.

Service

SERVICE REQUEST

Please visit our website at: www.rubbermaidhealthcare.com/support_service to file a request for parts.

SERVICE LEVEL COMMITMENT

Rubbermaid Healthcare is committed to providing best-in-class service. This document details our standard warranty and instructions on how to request service using our customer support system.

Warranty

LIMITED WARRANTY FOR WALL MOUNTED WORKSTATIONS

Rubbermaid Healthcare is pleased to offer a five-year warranty on durable components and a two-year warranty on electronic components.

If during the warranty period this Rubbermaid Healthcare product proves defective in materials or workmanship under normal use by the original purchaser, please contact Rubbermaid Healthcare technical support at www.rubbermaidhealthcare.com/service (please be sure to complete all information, including product serial number, description of the issue, and full contact information). Rubbermaid Healthcare will determine, at its sole discretion, how to best address your warranty issue, which may include sending you a replacement part covered under warranty or for sale. Rubbermaid Healthcare reserves the right to require proof-of-purchase prior to honoring any warranty request. This warranty does not cover product abuse, modification, failure to adhere to product instructions, or improper operation/misuse. Rubbermaid Healthcare SHALL NOT BE LIABLE FOR ANY CONSEQUENTIAL OR INCIDENTAL DAMAGES WHATSOEVER. Some states do not allow the exclusion or limitation of incidental or consequential damages, so the above limitation or exclusion may not apply to you. This warranty gives you specific legal rights and you may also have other rights which vary from state to state or country to country.

Service Details

Consumable components are not covered under warranty and include:

- Mouse/Scanner Holder
- Arm Covers
- Mouse Pad
- Cable Management Clips
- Channel Covers

All other standard components will be replaced under the applicable warranty following a filed service request. If the service request is received prior to 10 am EST, replacement parts will ship next business day. Requests filed after 10 am EST will be fulfilled with parts shipped in 2 business days. All replacement parts will ship via ground carrier.



1-888-859-8294
www.RubbermaidHealthcare.com

02/2013 Part #1779223 Rev C
© Rubbermaid Healthcare
Huntersville, NC 28078
A **Newell Rubbermaid** Company