

5.2 Silent Covert Pocket Vibration Mode: You can place this small gem in your pocket and when it detects eavesdropping it will alert you by silently vibrating. You will know in an instant if it detects an RF bug, cell phone bug or sends a GPS transmission. (The RF detector must be on)

6. Operation

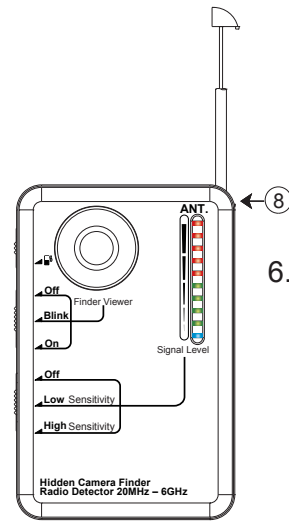

6.1 Pull up the antenna and switch ③ to High Sensitivity. At the time the device is on ten colored LED lights blink and it leaves 1-3 LED lighting in the detection mode.

(4)

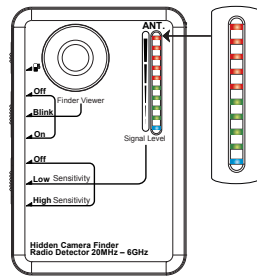

6.2 If ten colored LED still keep lighting it means the surrounding signal is very strong. ※When the detection activity is proceeded at the high floor the signal is stronger than usual.)

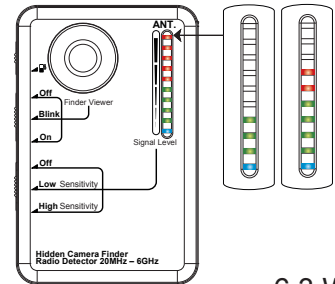

6.3 When the surrounding signal is too strong it may influence the real target finding. In this situation switch the sensitivity adjustment to Low and pull back the antenna. (WiFi is also a RF signal)

(5)

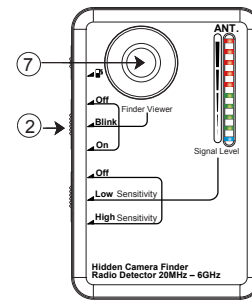

6.4 RF sensitivity adjustment can be used for a confirmation of irregular signal finding. Switch the sensitivity to low and approach to the suspected target. If the signal strength is still strong the view finder can be turned on for the final check.

6.5 Switch View Finder ② to On or Blink to find the hidden camera lens.

6.6 Look through the view finder from the obverse side of the device.

6.7 The hidden lens will flash when the laser LED light spot it as shown in the illustrations below.

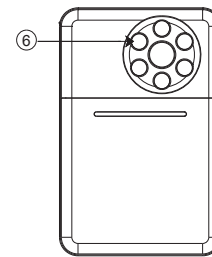

(6)

(7)

**RD-10
RF Detector
Hidden Camera Detector
Quick Guide**

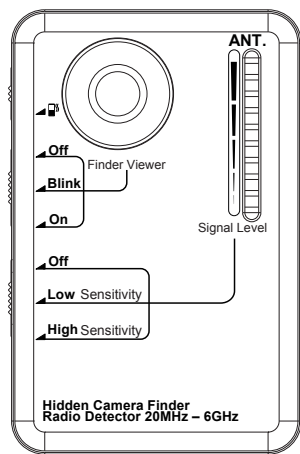

Law Enforcement Products Manufacturer
LawMate

1. Name and parts

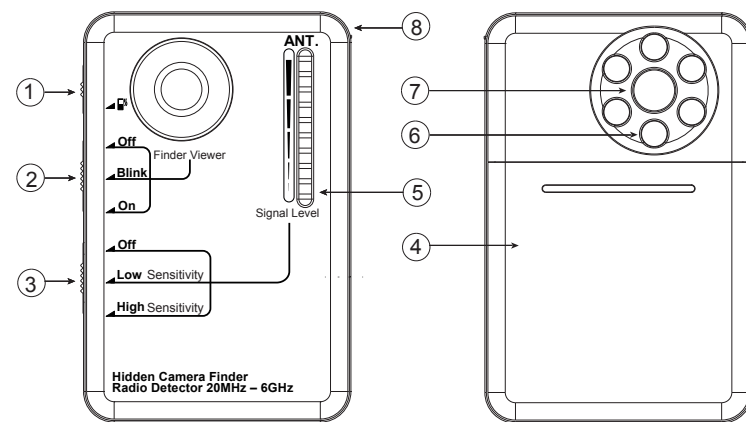

- 1. Vibration switch
- 2. Hidden camera scan Blink/On/Off
- 3. Sensitivity adjustment
- 4. Back cover

- 5. RF signal strength colored light array
- 6. Laser LED lights
- 7. Hidden camera view finder
- 8. Telescoping antenna

(1)

2. Package content

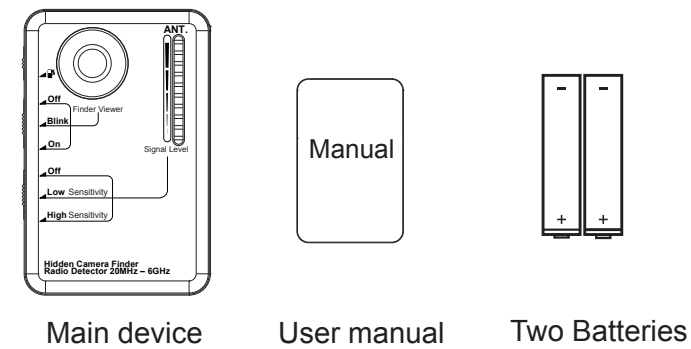

3. Power supply

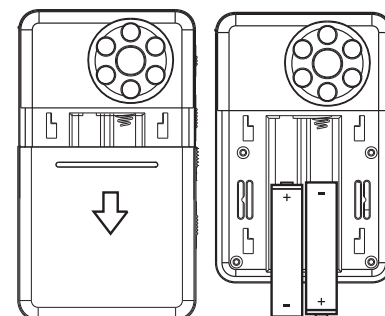

- 3.1 To open the back cover slide it towards the bottom of the device.
- 3.2 Insert the batteries as shown in the illustration.
- 3.3 Close the back cover by sliding it towards the top of the device.

(2)

5. RF signal strength colored light array / Silent vibration alert mode

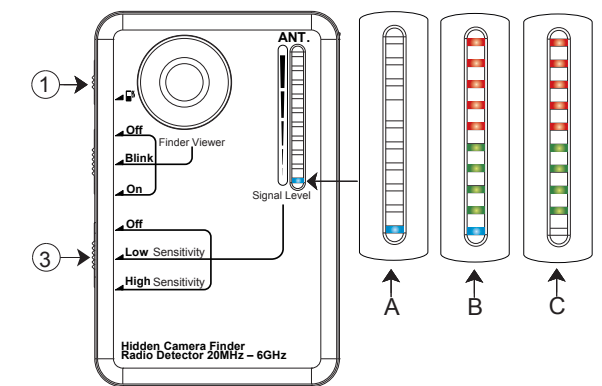

- 5.1 RF signal strength meter ten colored light array
- 5.1.1 Slide ③ to High/Low Sensitivity. The blue LED at the bottom of the bar lights up as shown in the illustration A. The device is on and stays at the detection mode.
- 5.1.2 Ten colored light array shows the output power of the target. (as shown in the illustration B)
- 5.1.3 When the device is low battery the blue LED turns off.

(3)