

# SETUP

---

This chapter provides instructions on how to:

- Install the air filters
- Position the device
- Connect the breathing circuit

## INSTALLING THE AIR FILTERS

---

**CAUTION:** *A properly installed, undamaged foam filter is required for proper operation.*

The device uses a gray foam filter that is washable and reusable, and an optional white, ultra-fine filter that is disposable. Two reusable gray foam filters and one disposable ultra-fine filter are supplied with the device.

If your home care provider did not install the inlet air filters, you must install at least the gray foam filter before using the device.

1. Place the gray foam filter on top of the white ultra-fine filter (if using the white ultra-fine filter).
2. Slide the filters into the air inlet at the rear of the device, and push them down into the recess as shown in Figure 1.

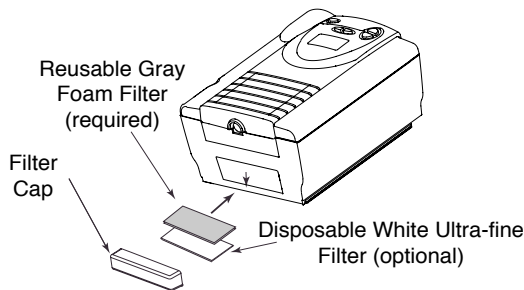
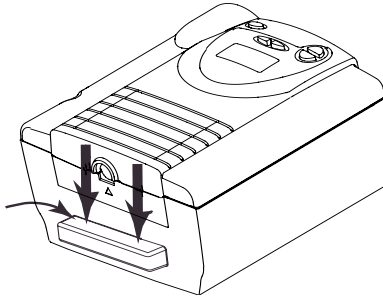

FIGURE 1 INSTALLING THE FILTERS

3. Attach the filter cap as shown in Figure 2. Position the cap so that the small opening on the cap is facing down. Insert the caps bottom tabs into the openings below the filter area. Snap the cap into place.



**FIGURE 2 ATTACHING THE FILTER CAP**

*NOTE:* The filter cap should be installed with the air inlet opening at the bottom.

See Chapter 9 to clean or replace the filters.

## WHERE TO PLACE THE DEVICE

---

Place the device on its base somewhere within easy reach of where you will use it. Make sure that the air inlet on the rear of the unit is not blocked. Place the unit on a hard, flat surface. If you block the air flow around the device, it may not work properly.

**WARNING:** *If using an external humidifier, position the humidifier so the water level is lower than you, and the humidifier is on the same level or lower than the device. See the humidifier instructions for complete setup information.*

## CONNECTING THE BREATHING CIRCUIT

---

To connect your breathing circuit to the device, complete the following steps:

1. Connect one end of the circuit tubing to the outlet of the bacteria filter (if using one) and connect the inlet of the bacteria filter to the large connector on the device as shown in Figure 3.

If you are not using a bacteria filter, connect the end of the circuit tubing directly to the outlet connector on the device.

*NOTE: Follow the recommendations of your home care provider for using the optional bacteria filter.*

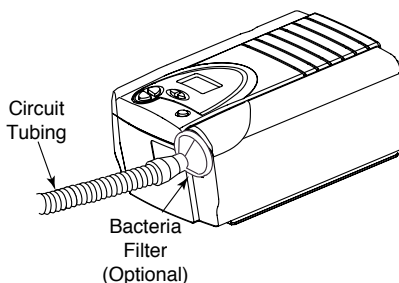

**FIGURE 3** CONNECTING THE TUBING TO THE OUTLET

2. Connect the tubing to the mask:
  - A. If you are using a mask with a built-in exhalation port, connect the mask's connector to the circuit tubing, as shown in Figure 4.

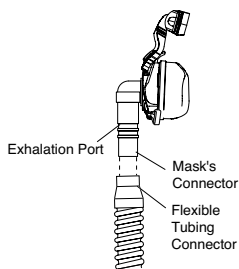

**FIGURE 4** CONNECTING A MASK WITH A BUILT-IN EXHALATION PORT

- B. If you are using a mask with a separate exhalation device, connect the open end of the circuit tubing to the exhalation device as shown in Figure 5. Position the exhalation device so that the vented air is blowing away from your face.

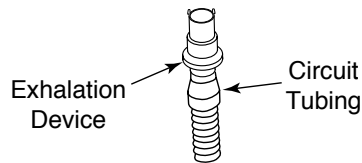

**FIGURE 5 CONNECTING AN EXHALATION DEVICE**

Connect the mask's connector to the exhalation device, as shown in Figure 6. See the mask instructions for complete setup information.

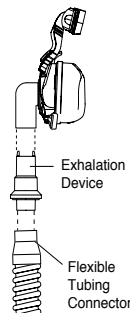

**FIGURE 6 CONNECTING THE MASK**

**WARNING:**     *The exhalation device is designed to exhaust CO<sub>2</sub> from the patient circuit. Do not block or seal the ports on the exhalation device.*

3. Attach the headgear to the mask. See the instructions that came with your headgear.

## COMPLETE SETUP

---

Figure 7 shows the completed breathing circuit setup for the device.

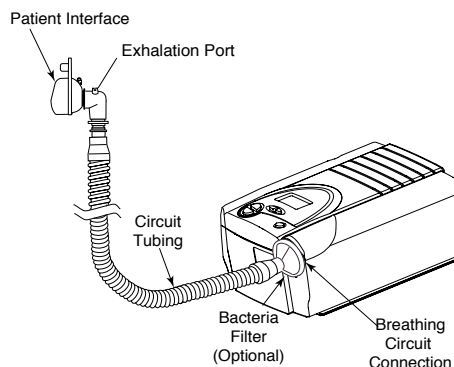

**FIGURE 7 COMPLETE BREATHING CIRCUIT**