

- Use** - This appliance is intended to be used in household and similar applications such as
- staff kitchen areas in shops, offices and other working environments
 - farm houses
 - by clients in hotels, motels and other residential type environments
 - bed and breakfast type environments.

Service

Refer all servicing to qualified personal.

Specifications

220-240V~ AC 50Hz 125 Watts

Warranty

This product is covered by a 12 month repair or replacement warranty with proof of purchase. Return any faulty appliance to the retailer. If for any reason the appliance does not function correctly or shows signs of damage please return it immediately to the retailer or contact the help line.

New Zealand call toll free 0508 ASIAPAC (274 2722)

Australia call +64 9 974 9206

Distributed by

Asia Pacific Brands Limited

PO Box 113001 Broadway

Newmarket, 1149

Auckland, New Zealand

Micasa



STAINLESS RANGE HOOD

Model: MA0035RH

READ AND FOLLOW THESE INSTRUCTIONS. RETAIN FOR FUTURE REFERENCE

Features

Stainless steel

Three baffle grill filters

AC centrifugal fan

760m³/h air flow

125 watt power

Charcoal filters

Internal plastic oil cup

Front LED lamps – 2 x 2 watt

Operation Guide

Power Connection

Connect the supply plug to an earthed 220-240V ~ 50Hz socket outlet.

Operation Guide

Once connected and installed correctly simply select the desired air extraction speed (Low – Medium – High) and light if required. The exhaust fan will drag the cooking fumes and remove via the air vents leaving your kitchen odour free. Always disconnect from the power supply if not using for any length of time.

Parts Details

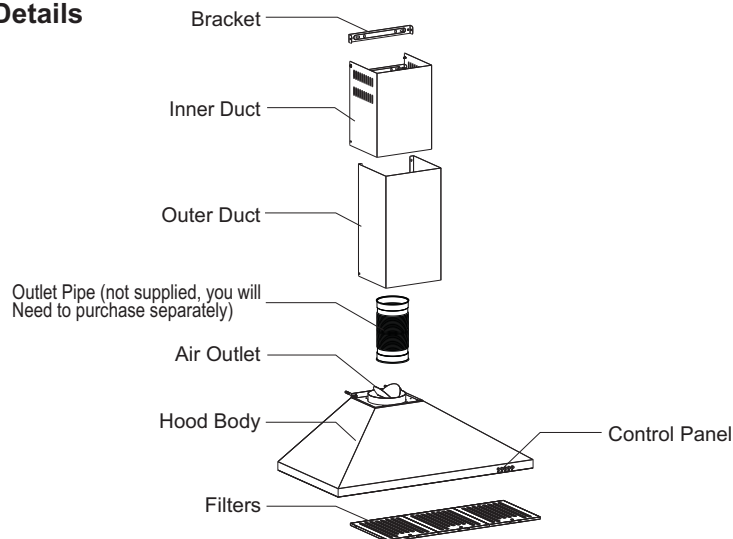

Warning! Gas Flame - Ensure there are pots or pans on the gas cooker elements when turned on so that any naked flame does not present a hazard when the range hood is on.

Warning! Do not leave unattended pots or pans when frying. Oil may overheat and ignite causing serious fire hazard. Re used oil creates a greater risk of fire.

Warning! Never flame - cook food under this range hood.

Warning! Do not let grease build up on the appliance or filters as there may be a risk of fire.

Warning! Ensure adequate ventilation.

Warning! Ensure the wall the appliance is fitted to can sustain the weight of the range hood.

Warning! Do not use the top of the hood to store items.

Warning! Children

This appliance is not intended for use by persons (including, children) with reduced physical, sensory or mental capabilities, or lack of knowledge, unless they have been given supervision or instruction concerning safe use of the appliance by a person responsible for their safety. Young children must be supervised to ensure that they do not play with the appliance. Safely dispose of any plastic bags or other packaging that may present a hazard to young children of suffocation or choke hazard.

Safety

For household indoor use only, do not use outdoors. Not for commercial use.

Always allow a gap around the appliance and do not cover the appliance.

Warning! Moisture

Do not immerse this appliance in any liquid. Do not splash the appliance with water.

Power Cord

Do not abuse or damage the supply cord. If for any reason the cord is damaged, it must be replaced by the manufacturer, its service agent or a similarly qualified person in order to avoid a hazard. A replaceable cord must be replaced with an authorised replacement from an authorized service agent.

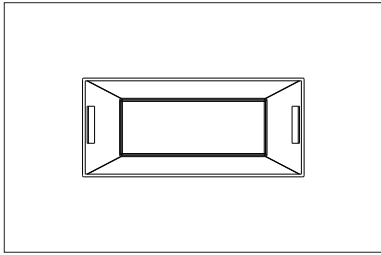

The stainless range hood is attached with charcoal filters, on the sides of the motor as below. To replace the charcoal filters please see instructions below. Replacement charcoal filters can be purchased from the retailer.

Charcoal filter *(where applicable)*

- The charcoal filters should be replaced when it is noticeably dirty or discolored, usually after 6 to 12 months depending on the conditions of use.
- These filters are not washable and cannot be restored. To ensure that this appliance functions effectively, regular maintenance is necessary as clogged filters restrict airflow and may cause the motor to overheat.
- Removing and inserting the charcoal filter:
 - Remove the grease filters
 - Remove the saturated charcoal filters from the blower as shown (see A)
 - Fit in the new charcoal filters (see B)
 - Replace the grease filters

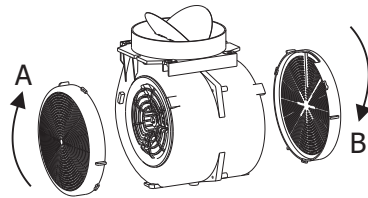

⚠ Important Safety Instructions

Before using this appliance please read and fully understand the safety directions in this manual. Ensure that you know how to operate the appliance. All electrical equipment presents a risk to the end user. We ask that you use this appliance in a sensible safe manner in accordance with the instructions supplied for your own safety. If for any reason the appliance does not function correctly or shows signs of damage please return it immediately to the retailer or contact the **help line**.

New Zealand call toll free 0508 ASIAPAC (274 2722)
Australia call +64 9 974 9206

Installation (Note: Outlet Pipe is not supplied, you will need to purchase separately)

Warning ! The hood should be installed by a suitably qualified person.

All fixing screws, nuts and bolts required are supplied.

Note. The flexible Outlet Pipe is not supplied with this rangehood unit BUT must be included in installation, please purchase from the retailer.

Height Recommendations

Gas Cooker - The unit should be fitted so that the lower edge of the hood is approximately 75cm above the cooking plate surface minimum.

Electric Cooker - The unit should be fitted so that the lower edge of the hood is approximately 65cm above the cooking plate surface minimum. The hood should not be more than 80cm above the cooker surface to maintain efficiency.

Step 1. Fix the outlet pipe to the hood as shown (ST 3.9 x 10 screw)

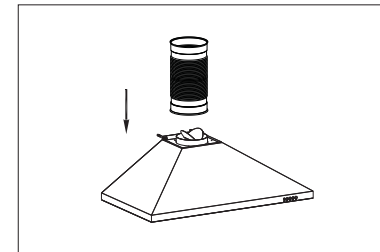

Step 2. Note. The unit is supplied with a wall bracket and a bracket that attaches to the Inner Duct. The wall bracket is secured to the wall and the hood then simply hooks onto the wall bracket when assembled.

To fit the hood bracket to the inner duct align the inner duct holes to the wall bracket holes and secure together (M4 Screw)

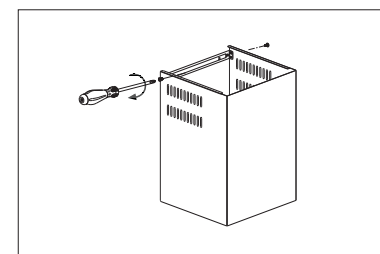

Step 3. Insert the inner duct cover into the outer duct cover

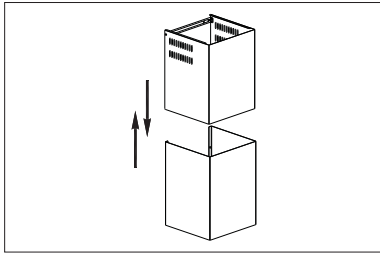

Step 4. Fit the duct cover to the hood body (M4 Screws)

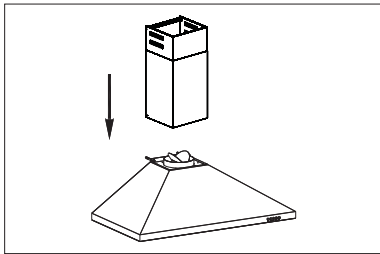

Step 5. Attach the wall bracket to the wall

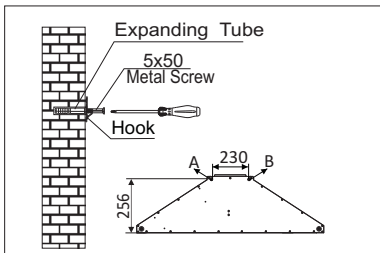

Step 6. Hang the complete range hood on the wall bracket. Ensure it is level.

Raise the outer duct cover and mark the position of the exit duct.
Remove the hood and complete the exit duct venting hole.

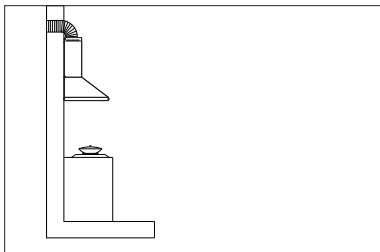

Step 7. Re-install the hood. Ensure the hood is level and at the desired height. Raise the outer duct cover, fit the exit duct into place, lower the outer duct cover.

Cleaning

Always disconnect the Range Hood from the power supply when cleaning.

Do not use harsh abrasives, solvents or scouring material as they may damage the metal or plastics. **Warning!** Do not allow water to enter the range hood.

Casing

Wipe the outer surface with a damp cloth and dry with a dry cloth.

Filters

Warning! Do not wash the charcoal filters. Replace with authorised replacements periodically. Replacement charcoal filters are sold in stores.

Clean the outer filters once a week to maintain the efficiency of the hood.

Remove the filters by pressing the release button. Wash in hot water with a mild detergent and rinse clean. **Warning!** Allow to completely dry before re-installing into the hood.

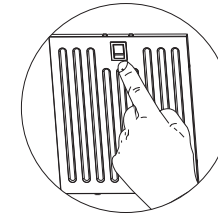

Internal Plastic Oil Cup

The stainless range hood has an internal plastic oil cup attached onto the motor housing. This is clipped onto the motor housing by clicking in the ends of the plastic oil cup onto the motor. From time to time the internal plastic oil cup should be cleaned as there will be a build up of oil into the plastic oil cup. To remove the internal plastic oil cup, simply remove the baffle grill filters by pressing the release button. Unclick the plastic oil cup from the motor housing by pulling off the 2 ends which are clicked onto the motor housing. Wash in hot water with a mild detergent and rinse clean. **Warning!** Allow to completely dry before re-installing back onto the motor housing. To re-install simply click back the plastic oil cup onto the motor housing. Re-insert the baffle grill filters.