

SUPPORT

If you are experiencing problems with this product, please contact customer support before contacting your retailer.

Just call 888-571-0866

or email: dgsupport@digitalgadgets.com



This device complies with Part 15 of the FCC Rules. Operation is subject to the following two conditions:
 1. This device may not cause harmful interference, and
 2. This device must accept any interference received, including interference that may cause undesired operation.

WHAT COMES IN THE BOX

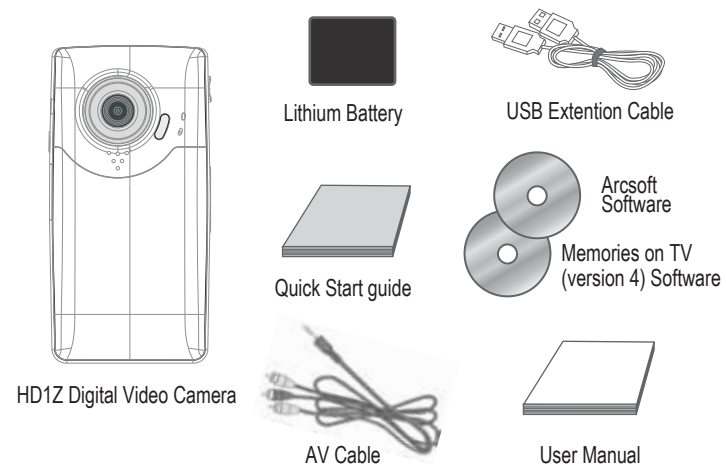

GETTING READY TO USE

Installing Battery

Press / slide down the battery cover and insert the included lithium battery. Align with correct polarity (+, -) of battery terminals. Close the battery cover.

2. Charging the battery

1. Power off the camera.
2. Connect the camera to the computer USB port or to a power adapter with the USB cable to charge the battery.
3. During charging, the busy red light will be on. The busy light is located on the top of the digital video camera to the left of the lens. The light will turn off when the battery is fully charged.
4. Charge the camera for about 3 hours to get maximum battery power. Battery lasts as long as 2 hours under normal usage.

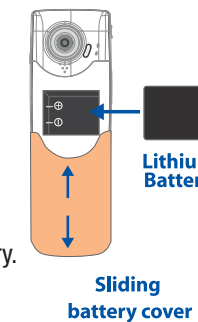

Inserting a SD Card

Turn your camcorder OFF before inserting / removing a SD Card. Insert SD card into the SD/SDHC card slot. Push it down until the card stays latched. Do not force – check card's position according to the position mark on the camera. To remove card, push card inward and it will pop out automatically.

* Note that the SD Card has a tiny LOCK switch on the side. Set the switch to the un-LOCK position to store recorded videos and still pictures.

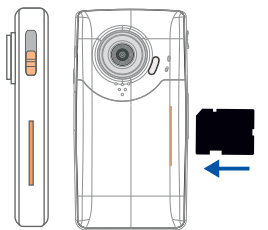

Inside Back of the Front

Page 1

Page 2

Page 3

BASIC FUNCTIONS

After pressing the power-on button, your camera will always enter video record mode. Press the mode key to change between video record, **Still photo and playback.**

Record video
 Make sure the camera is in video record mode. If it isn't, press the mode key to switch to video record mode. In video record mode, press the shutter key to start video recording. While recording, press the shutter key again to stop recording.

Take a picture
 Make sure that the camera is in still photo mode. If it is not, press the mode key to switch to still photo mode. In still photo mode, press shutter key to take a picture.

Playback videos and photos
 Make sure the camera is in playback mode. If it isn't, press the mode key to switch to playback mode. In playback mode, press the left or right key to select a file. Press the shutter key to begin/stop playing video. Press the mode key to exit playback mode
 For more detailed instructions on the operation of the HD1Z, please refer to the User Manual included in your box.

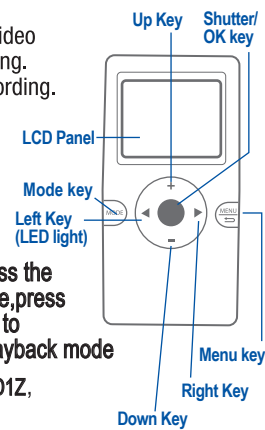

LOADING YOUR FILES ONTO A COMPUTER

Your HD1Z is equipped with a built-in folding USB connector. To open the USB, slide down the switch on the side of the camera and the USB dongle will automatically pop out. Simply plug the camera's USB into the USB port of your computer or use the USB extension cable. Follow the directions on your screen to transfer the files.

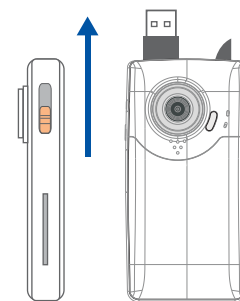

VIEWING VIDEOS ON A TELEVISION

1. Plug in the included AV cable into the AV port of the camera.
2. Locate the correct RCA inputs on your television.
3. Plug in the yellow RCA cable (video) into the yellow RCA connection (video) on your television.
4. Plug in the red and/or white RCA cable(audio) into the red and/or white RCA port (audio) on your television.
5. Turn on the camera to view content on your television.

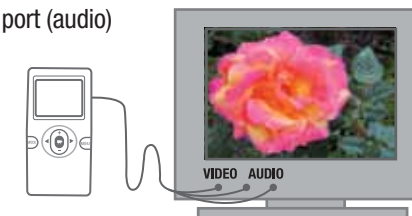

SYLVANIA is a registered trademark of Osram Sylvania Inc, used under license. Manufactured and distributed by Digital Gadgets Inc. **DIGITAL GADGETS** 21 Englehard Dr. Monroe Twp, NJ 08831 Customer Service: (888) 571-0866

SYLVANIA

Digital Video Camera Quick-Start Guide



Outside Page 4

Page 5

Page 6

Front