



***MobileLite Wireless G2
5-in-1 Mobile Companion
User Manual***



Table of Contents

INTRODUCTION	4
INCLUDED	4
GETTING TO KNOW MOBILELITE WIRELESS G2	5
REQUIREMENTS	6
SUPPORTED FILE TYPES (NON-DRM)	6
CHARGING THE MOBILELITE WIRELESS	6
BATTERY LED	6
INSTALLING THE KINGSTON MOBILELITE APPLICATION	7
CONNECTING TO MOBILELITE WIRELESS G2 OVER WIRELESS	8
UPDATING THE FIRMWARE ON THE MLWG2	9
INITIAL SETUP	10
GETTING TO KNOW THE KINGSTON MOBILELITE APP	12
EXTEND THE STORAGE OF YOUR MOBILE DEVICE	13
CHARGE YOUR SMARTPHONE	15
CONNECTING MOBILELITE WIRELESS G2 AS A LOCAL SD CARD/USB READER	15
PHOTOS	16
EXPORT PHOTOS	17
FILE MANAGEMENT	18



STREAMING VIDEO	19
UNSUPPORTED FILE FORMATS	20
STREAMING MUSIC	21
ACCESSING THE INTERNET VIA THE ETHERNET PORT (ACCESS POINT)	22
SETTINGS AND CONFIGURING THE MOBILELITE WIRELESS G2	23
ACCESSING THE INTERNET VIA WI-FI (BRIDGE MODE)	24
ACCESSING THE CONTENTS USING AN INTERNET BROWSER	25

Introduction

MobileLite Wireless G2 (MLWG2) is a portable media reader that allows you to wirelessly stream digital media content (music, photos, videos, documents, etc.) from a memory card or USB flash drive connected to the MLWG2 device to your iOS-based iPad®, iPhone®, or iPod touch® device. Serving as its own mobile wireless network, the MobileLite Wireless G2 lithium-ion battery gives you up to thirteen hours of Wi-Fi access to your digital library (within a 30-foot range) anywhere you go. MobileLite Wireless G2 is the perfect solution for expanding your on-the-go media library with devices that have no way of adding to, or expanding, their storage capacity.

What will this device do for you?

• Extend your mobile storage

Simply plug your existing USB Flash drive or SD card to add capacity.

• Smartphone charger

Charge your phone up to 2x with a fully charged MobileLite Wireless.*

• Media Storage device

This is great for movies, photos, music, documents. This is not great for applications, see next section.

• SD Card/USB Reader

Read USB Flash drives, USB external hard drives, SD cards or microSD cards from your mobile device.

• Wi-Fi Access Point

Plug in an Ethernet cable from an existing network to create your own Wi-Fi network.

What won't this device do?

• Application Storage

Most mobile operating systems will not allow you to run apps from external storage.

• iPad charger

While it will provide a charge to your iPad we feel it is too slow of a process to recommend this function.

• Standalone Wi-Fi Hotspot

There is no Internet connection built into the device. You will need to join the MobileLite Wireless to an existing network in order to use the Internet.

** Based on internal testing of iPhone 5 using a fully charged MLWG2. Actual results may vary. Battery life varies depending upon the usage and user application functions. Battery is not replaceable.*

Included:



1 - MobileLite Wireless G2



1 - USB Cable (1.5ft. A to Micro-B)

(For charging the MLWG2 and connecting to PC as a local reader)



1 - MicroSD Adapter

(Allows you to plug a MicroSD card into the MobileLite Wireless G2)

Getting to Know MobileLite Wireless G2

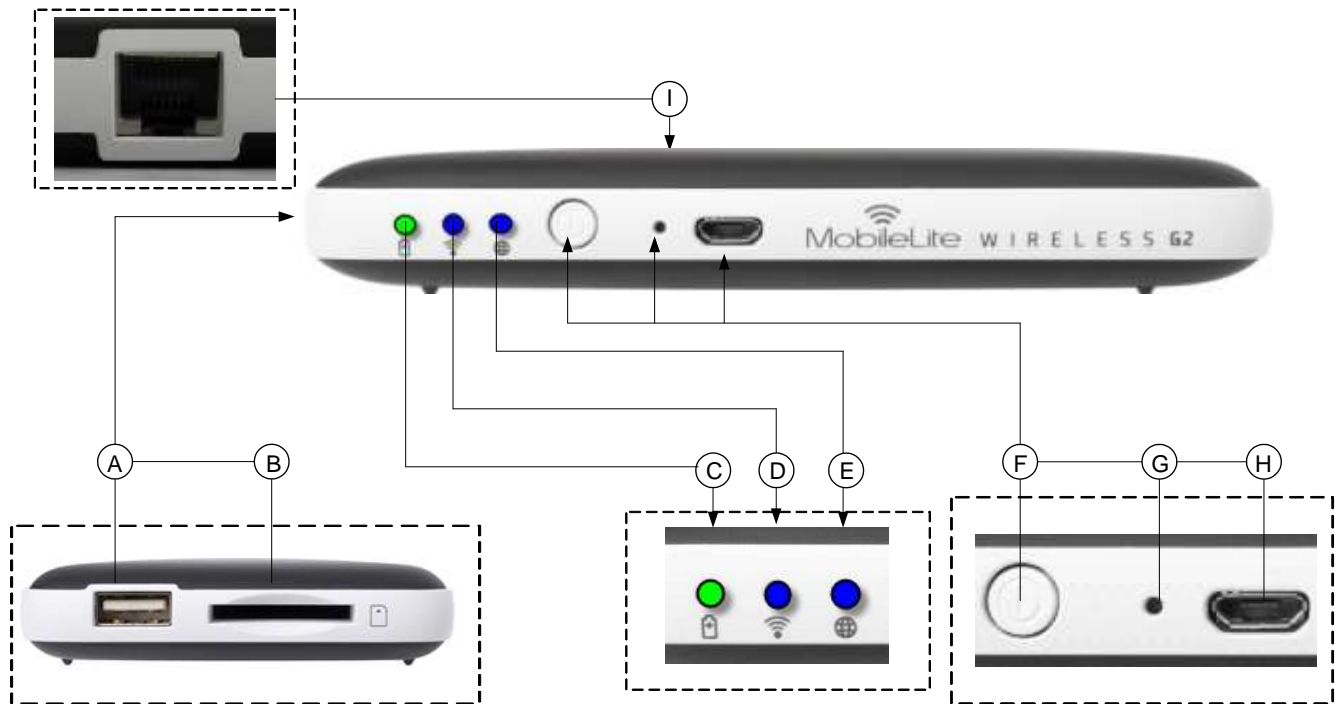

A. USB 2.0 Port - Allows you to connect an external USB Storage Device to MobileLite Wireless G2. It also allows you to charge your mobile device.

B. SD Slot - Allows you to connect a memory card (SD/SDHC/SDXC or any microSD w/ adapter) to MobileLite Wireless G2.

C. Battery LED/Power* - Indicates current battery status and current power state.

D. Wi-Fi LED - Indicates current status of Wi-Fi broadcast.

E. Bridged LED - Indicates whether or not MobileLite Wireless G2 is bridged to an Internet gateway via Wi-Fi or Ethernet.

F. Power Button - Powers on or powers off the MobileLite Wireless G2 device. Short press (1 Second): Power Bank Mode/Long press (3 seconds): Wi-Fi Mode.

G. Reset Button - Allows you to reset the MobileLite Wireless G2 device back to its original (default) configuration. Hold button down for more than 10 seconds.

H. Micro-B USB Port - Allows you to charge MobileLite Wireless G2 or connect it to a standard USB port on your computer for fast, easy data transfer. Each media expansion port will require its own drive letter if media is inserted.

I. Ethernet port – Allows you to connect an Ethernet cable to create a hotspot for wireless Internet access. Wi-Fi mode will temporarily disable while connected to Ethernet.

* The battery LED also indicates how much battery time is left while the MobileLite Wireless G2 is powered on. Green indicates 51% - 100% battery charge remaining; orange indicates 25% - 50% battery charge remaining; and red indicates less than 25% battery charge remaining.



Requirements:

- (As a local Card Reader) Computer running Windows® 8.1, Windows® 8, Windows® 7, Windows Vista® (SP2), Mac OS X (10.7.x+), Linux (v.2.6+ kernel) operating system
- iOS Mobile devices running iOS 7 and 8
- iOS Mobile devices with Internet access to the App Store (required to install the Kingston MobileLite App)

Supported File Types (Non-DRM):

- Audio: aac, mp3, wav
- Video: m4v, mp4, mov
- Image: bmp, jpeg, jpg, png
- Docs: pdf, doc, docx, ppt, pptx, txt, rtf, xls, xlsx



Charging the MobileLite Wireless

We urge you to fully charge the MLWG2 before you begin to use it. This can take up to three hours. The MLWG2 can be charged with a computer's USB port, or a USB power adapter (minimum 1.2A), using the included Micro-B USB Cable

Battery LED

The battery indicator light on the front of the MLWG2 indicates the current battery strength and tells you whether the MLWG2 is charging when it's connected to a computer or outlet. The battery indicator's LED blinks when it is charging and has a solid green LED when it is finished.

The battery LED also indicates how much battery time is left while the MobileLite Wireless G2 is powered on. Green indicates 51% - 100% battery charge remaining; orange indicates 25% - 50% battery charge remaining; and red indicates less than 25% battery charge remaining.

Less than 25% battery charge remaining



25%-50% battery charge remaining



51%-100% battery remaining



Installing the Kingston MobileLite Application

To configure the MobileLite Wireless G2, you must first install the Kingston MobileLite App to your iOS device from the on-line App Store (Internet access required). The Kingston MobileLite App is free and allows you to customize the wireless network settings and wirelessly access the content you've uploaded to your SD/USB device connected to MobileLite Wireless G2. To install the App, please follow these steps:

1. Open the App Store from your iPad, iPhone, or iPod touch device and search for "Kingston MobileLite." See **Figure 7.1** below. The App Store may return multiple results to your search, be sure to select Kingston MobileLite.



Figure 7.1 – App Store Search

2. After locating the Kingston MobileLite App that corresponds to your device, i.e. Kingston MobileLite App for iPad, for iPhone, iPod touch, etc. by **Kingston Digital, Inc.**, tap the 'FREE' button link. See **Figure 7.2**.



Figure 7.2 – Kingston MobileLite App by Kingston Digital, 'FREE'

3. After selecting 'FREE,' the grey button will turn green and change to 'INSTALL APP.' Select this button to complete the installation of the Kingston MobileLite App to your device. See **Figure 7.3**.



Figure 7.3 – Kingston MobileLite App by Kingston Digital, 'INSTALL APP'

Once the App has been installed, you may exit the App Store and proceed to the next section of this manual.



Connecting to MobileLite Wireless G2 over Wireless

MobileLite Wireless is its own independent wireless network. When browsing for Wi-Fi networks from your iPad or iPhone, you will see 'MLWG2-XXXX' in the list of available networks to join.

Settings App --> Wi-Fi option --> Choose a Network-> **MLWG2-XXXX** by default (XXXX indicates the last four characters of the device's unique MAC address. The MAC address of your device could be found on the bottom of the MobileLite Wireless G2)

By default, there is no password and when you connect to MobileLite Wireless G2 from your iOS device, you are establishing a dedicated link to MobileLite Wireless G2 over that wireless signal. Once you connect to MobileLite Wireless G2, you will substitute your iPad/iPhone's Internet connection with MobileLite Wireless's wireless connection. This means you will no longer have access to the Internet. However, MobileLite Wireless G2 does provide a bridging function that allows you to maintain access to MobileLite Wireless's content while connecting to a Wi-Fi Internet connection. **See Page 23.**

Updating the Firmware on the MLWG2

The MobileLite Wireless Application will check for firmware updates automatically. Firmware updates to the MLWG2 will add features along with fix any issues encountered after release of the hardware. It is always recommended to update the firmware to make sure to get the best experience out of the MLWG2.

1. The following will appear once the app is refreshed and if a new firmware is available.



Figure 9.1 – Firmware Update

2. If 'Update Now' is selected, then the firmware will upload to the USB or SD connected to the MLWG2.

Note: Once the firmware update is complete, the file will be deleted from the USB/SD.

3. Once the firmware is uploaded to the USB or SD, the firmware update will begin. The update takes 3-5 minutes, during which you cannot access the content on the MLWG2.

When the update is complete, the MLWG2 will restart, and the user has to reconnect to the MLWG2.

To check the firmware version, connect to the MLWG2, open the MLW app and select settings.

The firmware update can also be done manually using the Kingston support site to download the file and for instructions.

http://www.kingston.com/us/support/technical/downloads?product=mlwg2&filename=mlwG2_v2

Initial Setup

Once you're connected to the MobileLite Wireless G2 network, you can begin to configure your device by launching the Kingston MobileLite application. There are 3 quick simple steps that require your attention before you begin to access your MobileLite Wireless G2. Please see below.

Note: The initial setup will only be present the first time you launch the Kingston MobileLite app. For any future changes, you will be required to navigate to the device settings in the MobileLite app. See page 19.

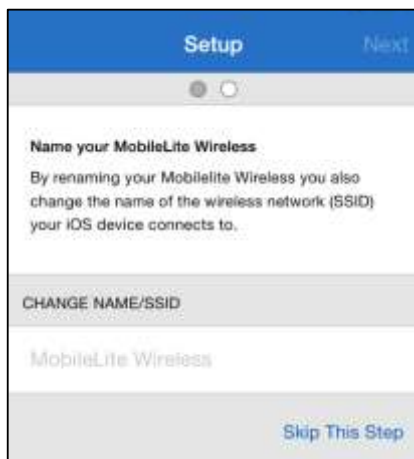

Figure 10.1: Name/SSID Change

The first step provides the option to change the name / SSID (Default MLWG2-XXXX). The last four characters of the unit's unique MAC address will be in place of the "XXXX". This will prevent any confusion when multiple devices exist within close proximity. Please see **Figure 10.1**.

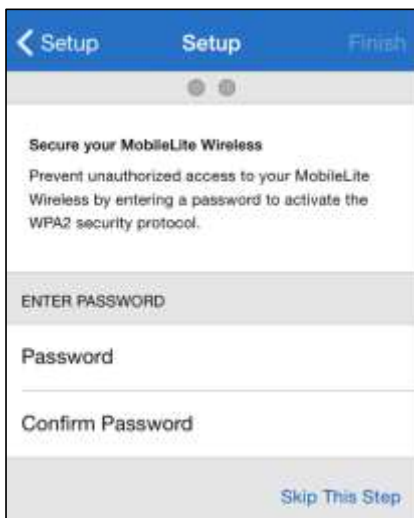

Figure 10.2: Set Password

In **Figure 10.2**, you will notice the option to password protect your device from unauthorized users. With the WPA2 security protocol in affect, only users who are given the password will have access to the device. The password must contain a minimum of 8 characters.

... Continued

If any changes were made during the setup process, the device will begin to update. See **Figure 11.2**. Alternatively, if no changes were made, you will be taken to the home screen and you move ahead for further instructions.

Once the update process is complete the next screen will prompt the user to connect to the MobileLite Wireless G2 using the Wi-Fi setting on the iOS device. See **Figure 11.2**.

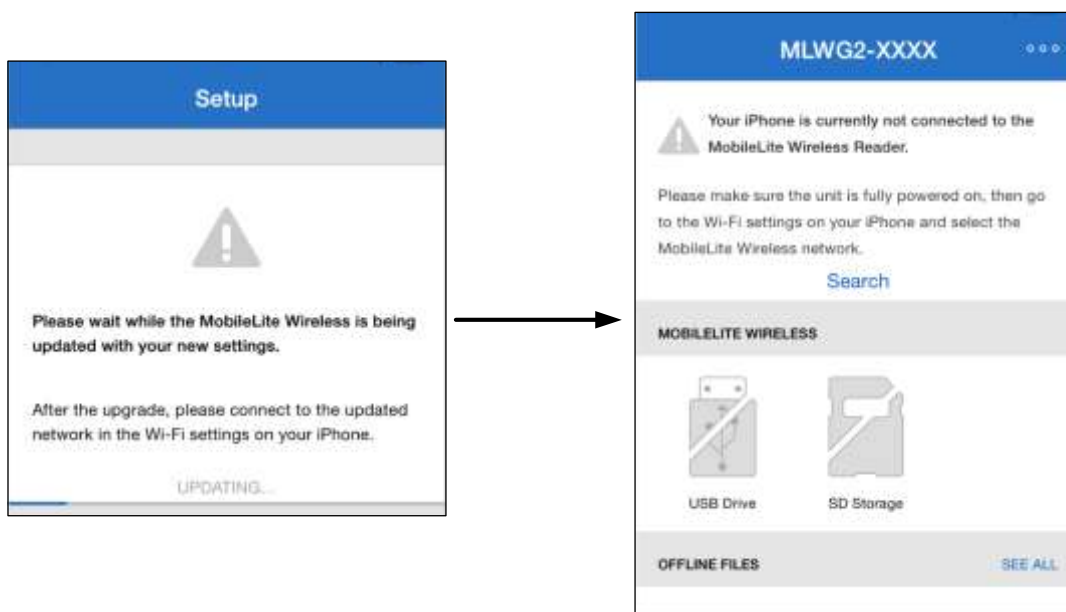

Figure 11.2: Update Process

Getting to know the Kingston MobileLite App

You can now access content connected to your MobileLite Wireless G2 from your iPad, iPhone, or iPod touch. The home screen is the foundation of the Kingston MobileLite App and contains information such as connection status of iOS device connection status, USB/SD Card connectivity, and a quick glance of your content. Please see **Figure 12.1**.

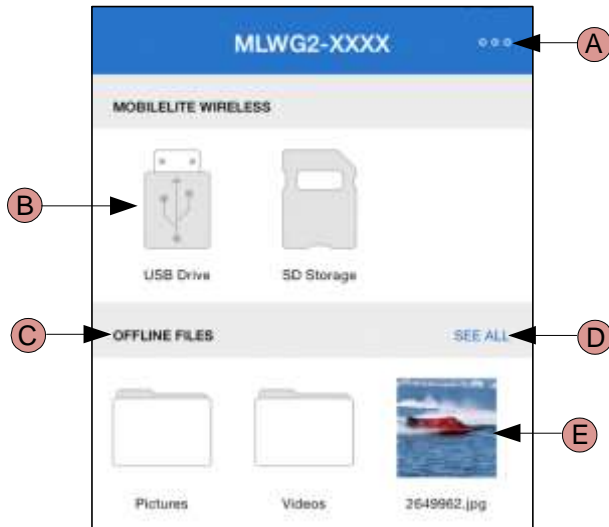

Figure 12.1: Home screen

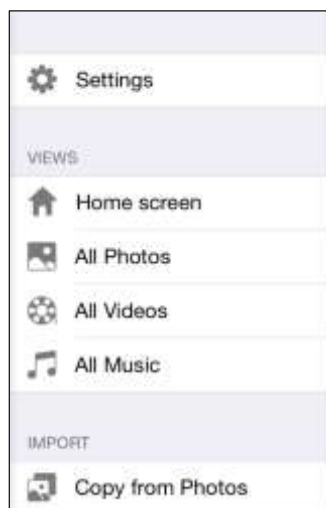

Figure 12.2: Menu



Figure 12.3: No media

A. The 'Menu' button opens a side panel with the following options: **See Figure 11.2.**

- **Settings:** Will navigate to the device settings page
- **Home screen:** Returns the user to the home screen
- **All Photos:** Filters all photos files only, regardless of location
- **All Videos:** Filters all videos files only, regardless of location
- **All Music:** Filters all music files only, regardless of location
- **Copy from Photos:** Allows the user to import pictures from the iOS Camera Roll to any USB/ SD Card.

B. The devices connected to the MLWG2. If no devices are connected, then the media will not be accessible. **See Figure 11.3.**

C. The 'Offline Files' section uses the iOS device's storage to store data that can only be accessed through the Kingston MobileLite app.

D. 'See all' will allow you to view all the files/folders stored in the Offline Files.

E. Thumbnail preview of files stored on the device. If multiple files exist, the user can scroll for a quick glance of files stored.

NOTE: Multiple partitions are supported. If a USB device with multiple partitions is connected, it will be displayed as USB Drive #1, USB Drive # 2, and so on. The same principle is applied to SD cards. If an SD card with multiple partitions is inserted then it will be displayed as SD_Card1, SD_Card2, and so on.

Extend the storage of your mobile device

The Kingston MobileLite App allows users to import photos and video from their iOS Camera Roll to a USB or SD/SDC card connected to the MobileLite Wireless G2.

Please follow the steps below to import a single or multiple files from the iOS camera roll to the MLWG2.

Step 1: Begin by selecting 'Menu', then select 'Copy from Photos'. See **Figure 13.2**

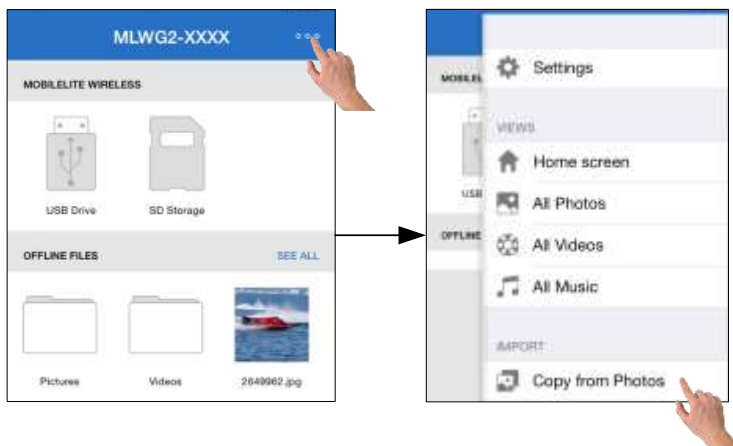

Figure 13.1 – Import from iOS Device

Step 2: Choose the album of the desired photo(s) and select a single file to import or tap the check mark to select multiple files. In multiple file selection mode, continue by selecting the Copy/Move option. See **Figure 13.2**

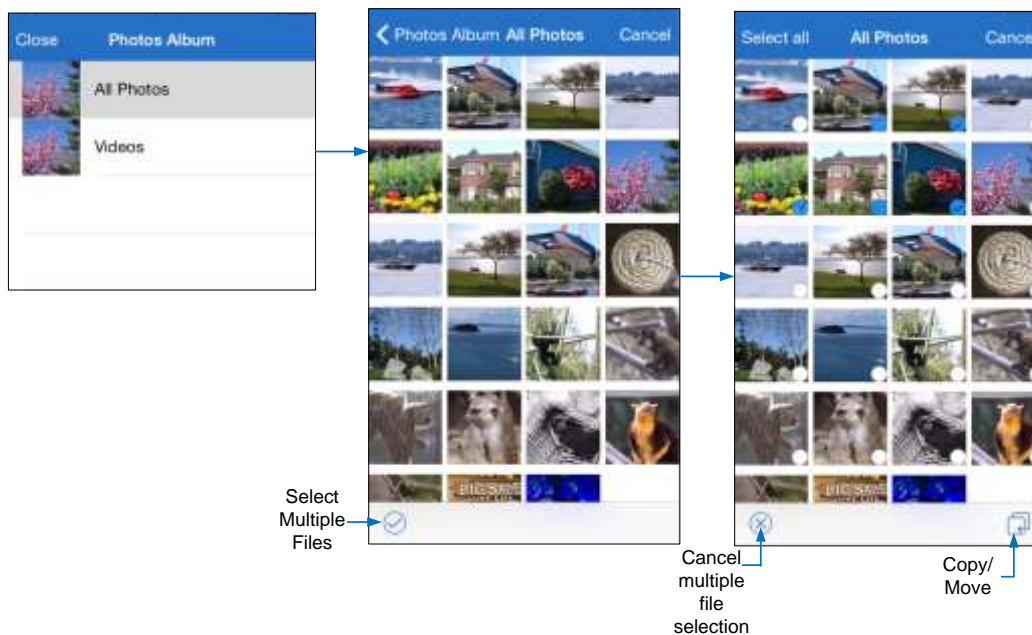

Figure 13.2: Selection of photo(s)

... Continued

Step 3: Choose the destination and complete the process by selecting 'Copy'. See **Figure 14.1**. Alternatively, a new folder could be added to keep the pictures organized. A new folder could be created using the create folder (+) icon. After naming the folder and selecting 'Save', the new folder will appear as a destination option.

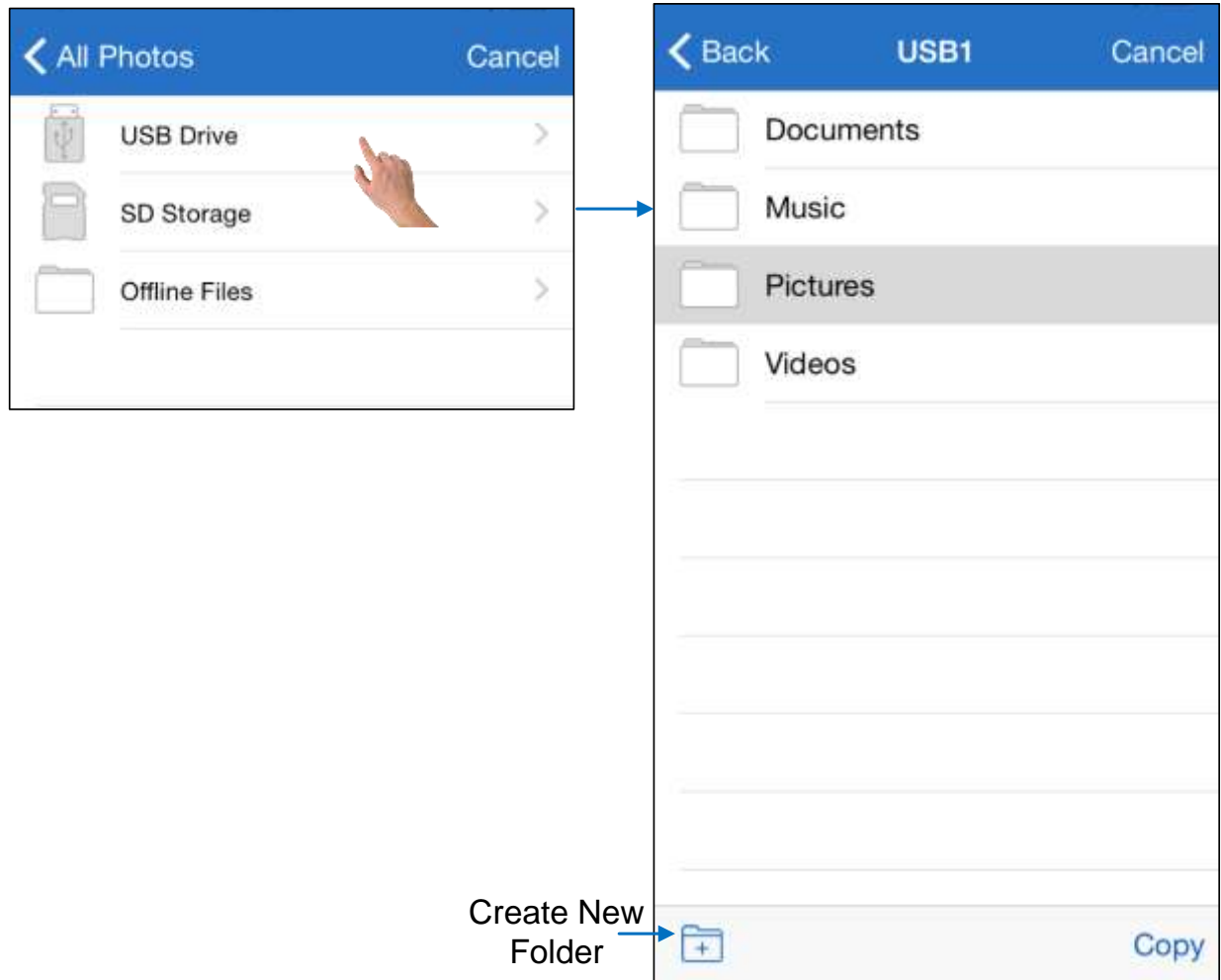

Figure 14.1: Destination selection

Charge Your Smartphone

Battery Backup

In addition to being its own Wi-Fi network, MobileLite Wireless can also be used as a battery backup.

This feature allows you to charge an iOS device using the built-in USB port.

To use this function, follow these steps:

- If the device is powered on, press and hold the power button for three seconds or until power LED turns off.
- Attach your mobile device to the USB port on the MobileLite Wireless G2
(Using the iOS device's own USB power cable).
- With MobileLite Wireless G2 powered off, press the power button for 1 second and release; do NOT press and hold the power button, as this will turn the wireless broadcast function on.

Once the power LED begins to flash, the unit is ready and the mobile device should be charging.

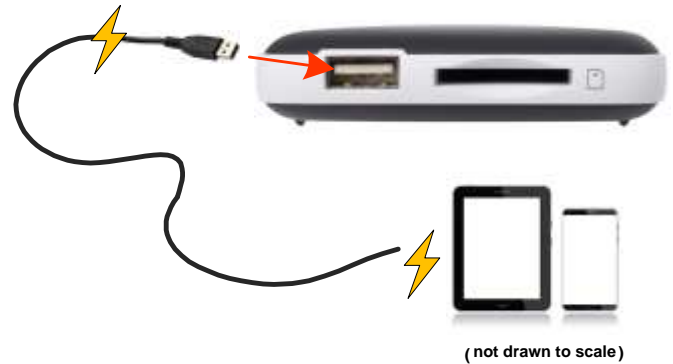

Connecting MobileLite Wireless G2 as a Local SD Card/USB Reader

To add content to the MLWG2, you can connect it to a computer using the USB cable that came with the device (with a card or USB device connected to the MLWG2) or you can copy content directly to a USB, SD, or MicroSD (using the accompanied adapter) and inserting the media into the appropriate slot on the MLWG2.

When connected to a computer, MLWG2 has to be powered off, so it can behave like any standard media reader device, creating a data volume on your PC or Mac for any media type you have inserted on the MLWG2 (i.e. USB, SD, MicroSD). You can populate each volume with digital content that you can later share or access wirelessly via the Kingston MobileLite Application.

When copying content to the media, it is highly recommended that you create folders on each volume to help you organize and quickly locate files each time you update and/or change the content of MLWG2 (as opposed to dumping all of your files onto the root volume or into a single folder). For example, you may want to store all of your music files in a folder called "My Music", or keep all of your photos in a separate folder called "My Pictures", and so on.

When you are finished loading content, please safely disconnect the MLWG2 from your computer. This will keep the power of the device off. To turn it back on, press and hold the power button for 3 seconds.



Photos

The MLWG2 device makes it simple for users to share pictures of memorable events, whether it is on social media, in a slide show, or email. Selecting the image file will open the photo. The photo can be viewed in full screen by selecting the photo once more. There are also file management options available to the user. Please see **Figure 16.1**.

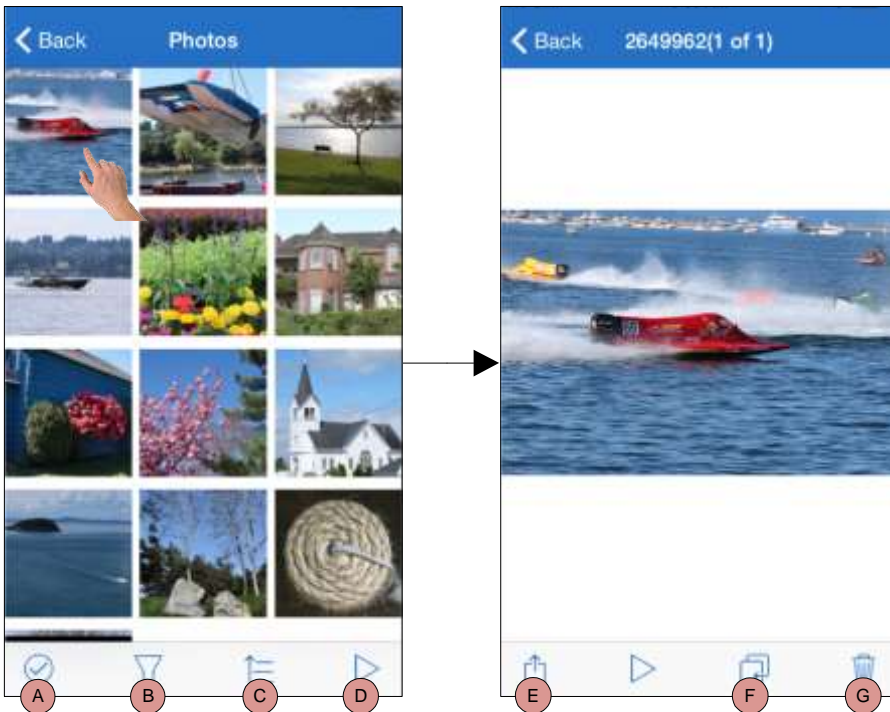

Figure 14.1 - Photos

- A. Select:** Allows user to select multiple files/folders. **See Figure 16.2**
- B. Filter:** This option is available when all photos are selected and it allows the user to filter the search for photos in the USB Drive, SD Storage and/or Offline Files. **See Figure 16.3**
- C. Sort:** Sorts the files/folders using Name, Size, Date, or Type. **See Figure 16.4**
- D. Slideshow:** Plays all the photos located in the opened folder.
- E. Share:** with Facebook, Twitter, Email, Camera Roll, or Open in. **See Figure 16.5**
- F. Copy/Move:** Will copy or move the file to the target location. **See Figure 16.6.**
- G. Delete:** Permanently deletes the current file

A. Select



Figure 16.2

B. Filter



Figure 16.3

C. Sort



Figure 16.4

E. Share



Figure 16.5

F. Copy/Move:



Figure 16.6

Export Photos

Export a photo from a USB or card to the iOS Camera Roll or Email is another available option in the Kingston MobileLite app. This task can be completed in a few simple steps.

Step 1: Select the image(s) to export. See **Figure 17.1**.

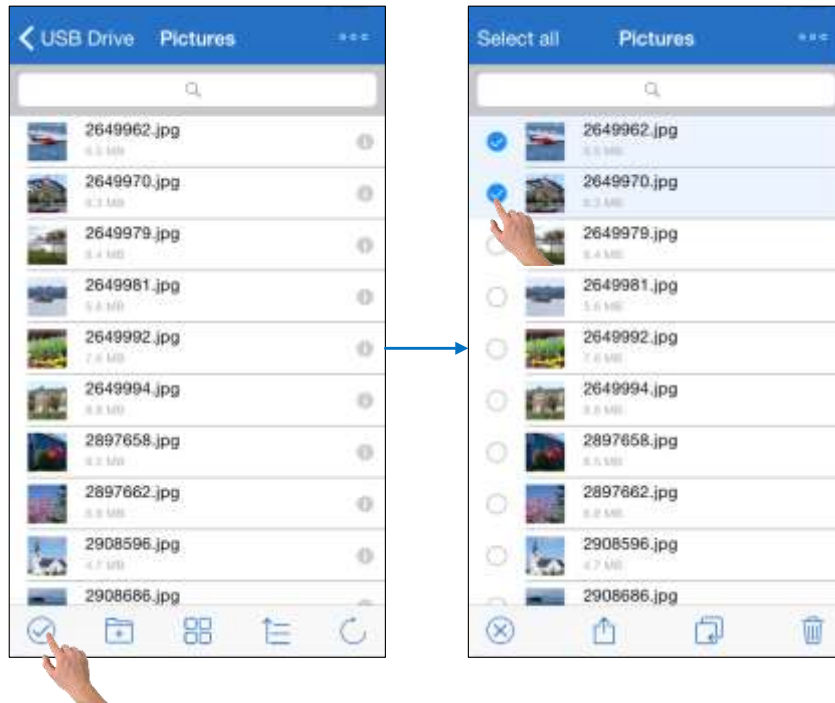



Figure 17.1: File to be exported

Step 2: Select the share icon () to bring up the 'share to' box. Select email or camera roll to export the file(s) selected.

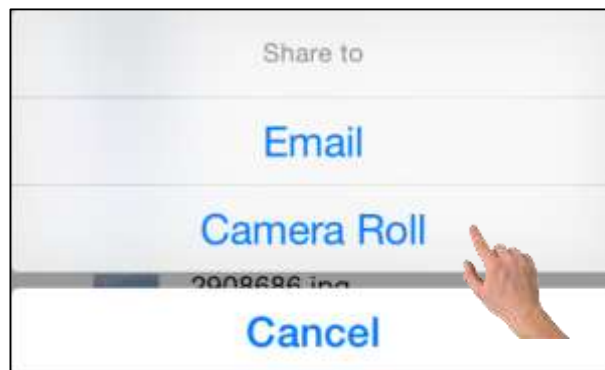
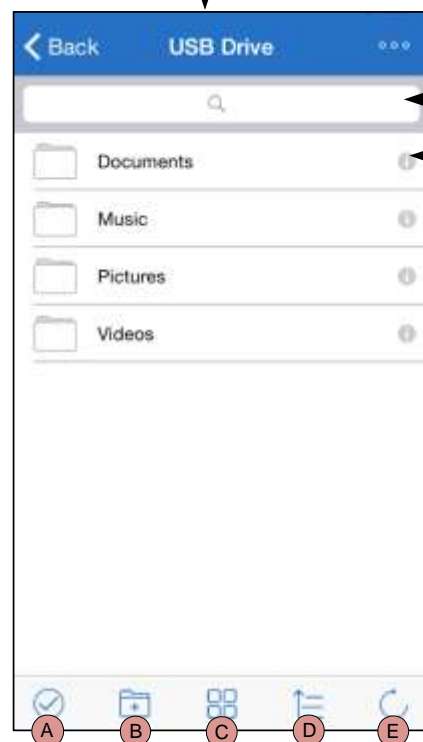

Figure 17.2: Share to Camera Roll or Email





File Management

One of the features of the MobileLite Wireless App is that it allows the user to manage the files/folders stored on their storage devices in a seamless manner. This includes creating a new folder, deleting items, or renaming content. To get started, simply tap on 'See All'; doing so will enable various options to get you started. See **Figure 18.1**.



Options once a media device (USB/SD) is selected

A. Select: This option allows the user to select file(s) and will also enable the following options below:

-  - Cancel selection
-  - Enables share options
-  - Copy/Move file/folder(s) to another location
-  - Delete the selected file(s)

B. New Folder: Allows the user to create new folders to organize files

C. View: Will switch from list view to thumbnail view

D. Sort: Will allow the user to sort the photos based on Name, size, date or file type

E. Refresh: Reloads the user's page in case any changes that were made are not reflected

F. Search: By default, the search bar is not visible. The user can display the search bar by dragging the page down

G. Info: Displays file properties and Metadata. This is also where the user can change the file/folder name

Note: Attempting to open unsupported file types will direct the user to the file's Info page. If the file is tagged with Metadata, the information such as file name, type, size, date created, date modified, and storage location will be available to the user. See page 20 for more options with unsupported video files

Figure 18.1 – File Management options

Streaming Video

The Kingston MobileLite App allows users to view their videos regardless of whether they are in a plane heading to a business trip or a good old fashion road trip. Simply begin by tapping on a video file. Upon getting to the next screen, the user will notice a few options available to them. If the desired task is to watch the video, then simply selecting the play icon will commence video playback. If the user would rather manage the video file, there are options available within this screen. See **Figure 19.1**.

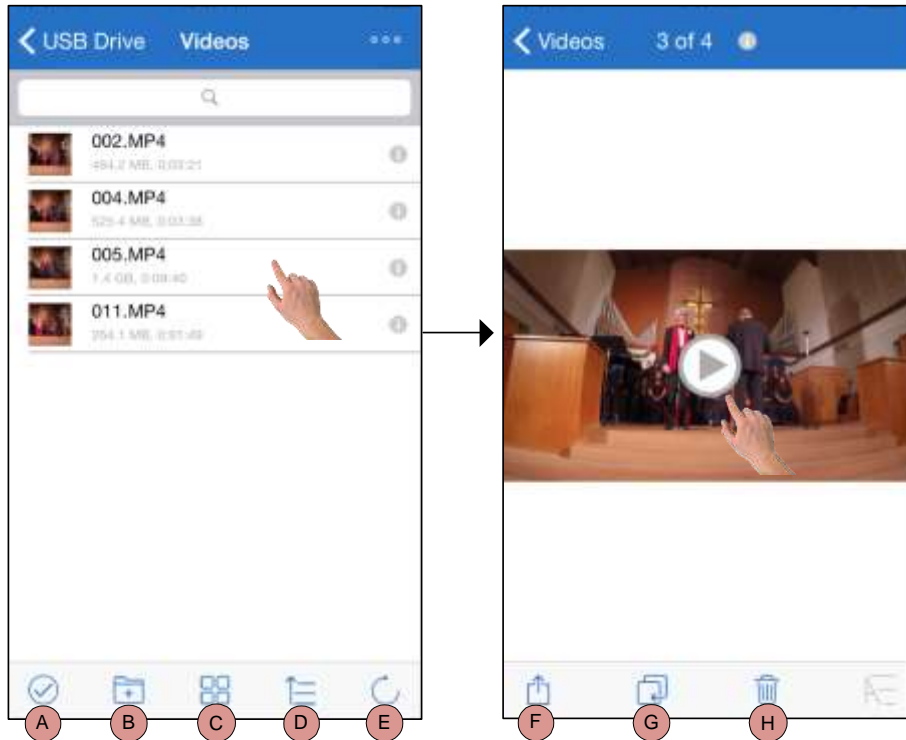

Figure 19.1: Videos

- A. Select:** Allows user to select multiple files/folders.
- B. New Folder:** Allows the user to create new folders to organize files
- C. View:** Changes the current view to list or thumbnail.
- D. Sort:** Sorts the files/folders using Name, Size, Date, or Type.
- E. Refresh:** Reloads the current location.
- F. Share:** Has the option to 'Open in', 'Email', 'Copy URL', 'Play in VLC', and 'Camera Roll'.
- G. Copy/Move:** Will copy or move the file to the target location
- H. Delete:** Permanently deletes the current file.

Note: Digital rights management (DRM) content is not supported by the Kingston MobileLite App. Apple has removed the option to play DRM content in the Safari browser with the update to iOS 8. Apple's iOS 7 and iOS 6 still have the option to play DRM content and the MobileLite App will play the files in the Safari browser.

Unsupported File Formats

The MobileLite app's default video player can open all file formats supported by your mobile device. If you try to open an unsupported format, follow the additional instructions on how to access different file formats using 3rd party apps.

Select a video and tap on the 'share to' icon. This will open the following options. **See Figure 20.1:**

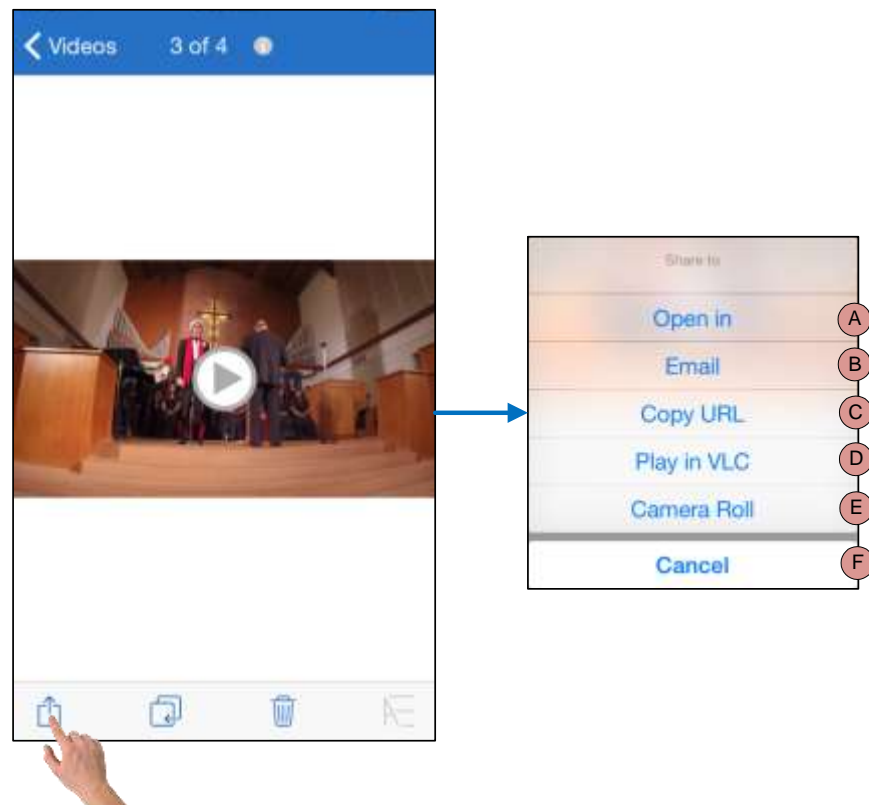

- A. Open in:** The video will be downloaded to the iOS device and a third party app could be used to play.
- B. Email:** A video could be shared by email. (10MB max)
- C. Copy URL:** A copy of the videos URL will be copied and could be pasted to a compatible third party app.
- D. Play in VLC:** If the VLC video player app is installed the selected video will play in the VLC app. If the app is not installed the link will open the app store to download the VLC app. Downloading the app is optional.
- E. Camera Roll:** The video could be exported to the iOS device.
- F. Cancel:** Cancels the 'share to' option.

Figure 20.1 – Unsupported File Format Options

Streaming Music

The MobileLite Wireless app has a built in media player that enables users to listen to music. The audio player will continue to run in the background in the case that the user decides to view a slide show, browse the web, or work on a project.

Below, are the available commands for the audio player, see **Figure 21.1**.

If the user navigates to a different location within the app during audio playback, an audio player icon () will appear next to the menu icon. Selecting this icon will either bring the user back to the audio player or open a mini audio player regardless of their current location on the app.

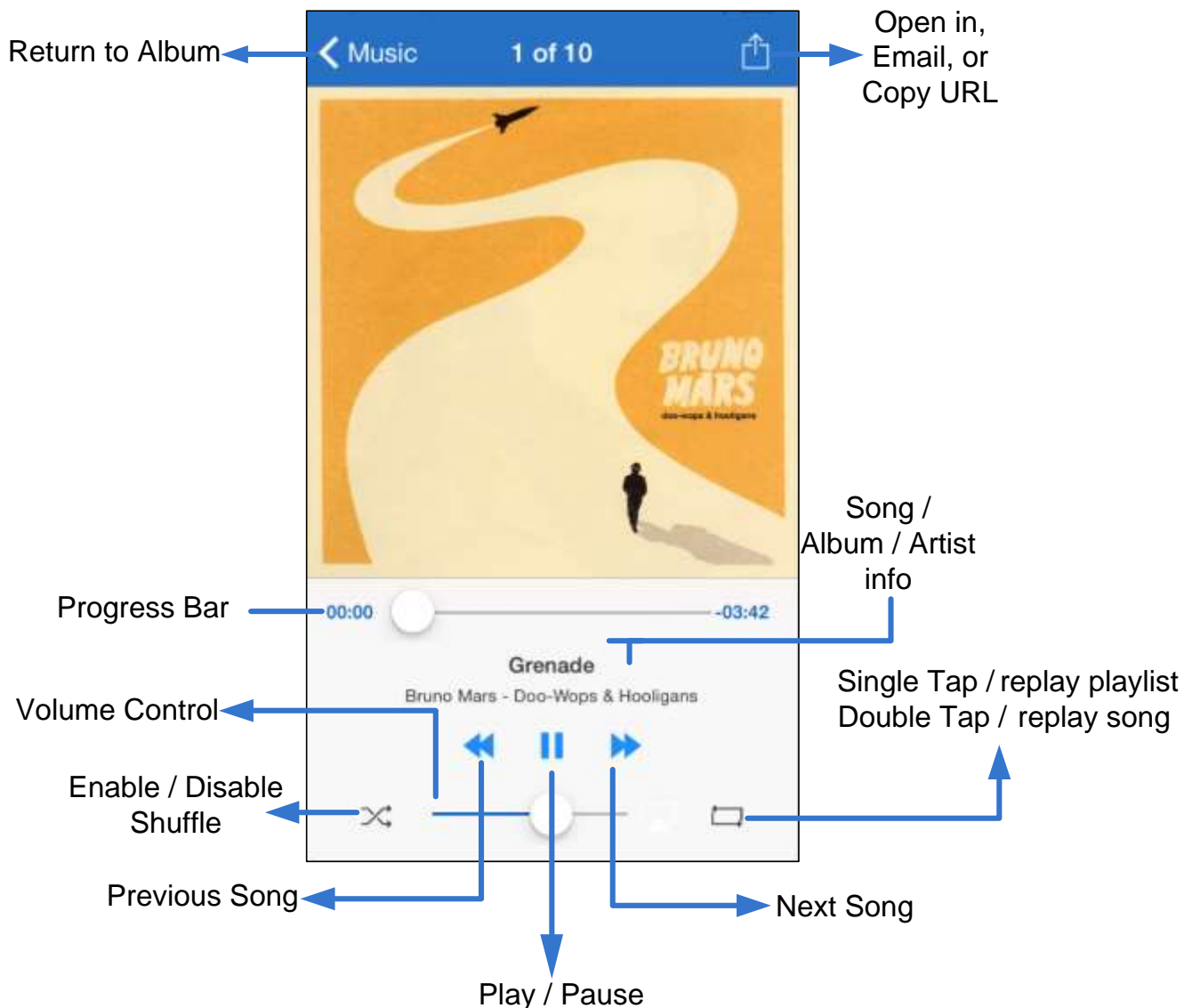

Figure 21.1: Audio Playback



Accessing the Internet via the Ethernet Port (Access Point)

If you have a wired internet connection, you can plug an Ethernet cable to the Ethernet port on the Kingston MobileLite Wireless G2. This would allow you to create a hotspot for wireless internet access. While connected to the Ethernet bridge mode the Wi-Fi bridge mode will be disabled temporarily until the Ethernet cable is removed.

NOTE: Only compatible with DHCP.

Simply connect an Ethernet cable to the Ethernet port. Check that bridge LED is ON to verify that you have a successful connection to the router. See **Figure 22.1**.

If you haven't already, make sure to connect to the MLWG2 in your iOS device's Wi-Fi settings.

Settings App --> Wi-Fi option --> Choose a Network --> Select MLWG2-XXXX

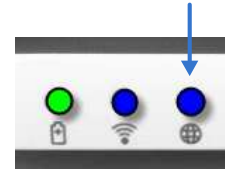

Figure 22.1 – bridge LED



Settings and Configuring the MobileLite Wireless G2

Using the Kingston MobileLite App, you can customize the wireless network settings for MobileLite Wireless G2. The default settings, if nothing was changed during the initial setup, are: **Name:** *MLWG2-XXXX*, **Auto Shutdown:** *Off*, **Visibility Status:** *ON*, **Wireless Channel:** *11*, and **Security (WPA2):** *Off*.

To access the MobileLite Wireless G2 Network Settings, please follow these steps:

1. From the 'Home screen', select 'Menu'
2. Select 'Settings'

Name – commonly referred to as an **SSID**, or **Service Set Identifier**, this field allows users to specify a device name (between 1 and 32 characters) that will broadcast in the list of available wireless networks on your iPad, iPhone, or iPod touch device. The default name is *MLWG2-XXXX* as seen in **Figure 23.1**

Battery Life - indicates amount of charge left in battery

Auto Shutdown – if enabled, the *MLWG2* will automatically shutdown at the selected time given. (30 Minutes – 300 min)

Firmware – *MLWG2* device firmware

Visibility – this gives you the option to hide or unhide the SSID specified in the 'Name' field. By default, the visibility status is turned 'ON'. If you wish to turn this feature 'OFF', the device name will NOT be broadcasted¹ in the list of available wireless networks on your iPad, iPhone, or iPod touch device; however, you can still join the Wi-Fi network by entering the device name manually using the menu option, 'Other...'

Wireless Channel – this setting allows you to select a specific frequency channel used to communicate with other devices on your wireless network. The default setting is Channel 11 (2.462 GHz.)

Security (WPA2) – this option helps prevent unauthorized access to your *MobileLite Wireless G2* device by prompting users for a password. Simply enter a password in the 'Password' field and confirm it by re-typing it in the 'Confirm Password' field and tap the 'Done' button to save the MobileLite Wireless G2 settings.



Figure 23.1 – MobileLite G2 Wireless Network Settings

¹If the visibility status has been turned off, you can still join the MobileLite Wireless G2 network by entering the SSID manually on your iPad, iPhone, or iPod touch, as long as you know the 'Name' (SSID). Please note that a password will be required if the security option is enabled.



Accessing the Internet via Wi-Fi (Bridge Mode)

Traditionally, the Wi-Fi antenna on your iPad or iPod touch device is used to access the Internet. The MobileLite Wireless, however, uses the Wi-Fi antenna on your Apple device to stream content, which effectively disconnects your iOS device from the Internet. Fortunately, MobileLite Wireless's Wi-Fi antenna supports bi-directional traffic and can be used for implementing a feature called Bridge Mode. This mode allows you to be connected to MobileLite Wireless G2 while it is connected to a Wi-Fi network (as a host client) that has access to the Internet.

To set up this feature and see a list of available wireless networks in your range, open the Kingston MobileLite App and navigate to settings. Under the '*Network Connection*' tap on the Wi-Fi network you want to connect to. After making your selection, MobileLite Wireless will prompt you for the Wi-Fi password (if security is enabled) and reboot. If there is no password, the device will automatically reboot.

Once MobileLite Wireless G2 has rebooted, you will be prompted to select a wireless network. You **MUST** select your MobileLite Wireless G2 network in order to maintain access to its contents. Since you've already connected to the network via MobileLite Wireless's App, there is no need to select it from the list again. If you do select it, you will be disconnected from MobileLite Wireless G2.

To verify that you have successfully enabled Bridge Mode:

1. From the 'Home screen', select the menu icon
2. Select Settings

When the list of wireless networks appears, you will notice a 'check mark' symbol located to the left of the network you selected in the Kingston MobileLite App. See **Figure 24.1**. This indicates that the bridge function is working properly and you are connected to MobileLite Wireless G2 and the Internet at the same time.

So if you're streaming content from the MobileLite Wireless to your Apple device and need to quickly look something up on-line, just open your internet browser and away you go.

When you want the device to forget a wireless network, click on the  icon next to the Wi-Fi icon. See **Figure 24.1**. Select Forget network on the next pop up and the device will reboot with the bridge LED off. Once it is rebooted reconnect to the MobileLite Wireless G2 network in the iOS device Wi-Fi settings. Now the blue 'check mark' symbol will no longer appear next to the network. This indicates that the bridge function is disabled. (MLW will remember multiple networks).



Figure 24.1 – Bridged MobileLite Wireless G2



Accessing the Contents Using an Internet Browser

The MobileLite Wireless Reader has the option to view the contents on the USB/SD device from a computer wirelessly using the computer's Wi-Fi.

1. On your computer's network settings, connect to the MLWG2
2. Open a supported web browsers (Chrome, Firefox, Internet Explorer, Safari)
3. In the address bar type in 192.168.201.254
4. You can now access your content to and from your MLWG2. **See Figure 25.1**

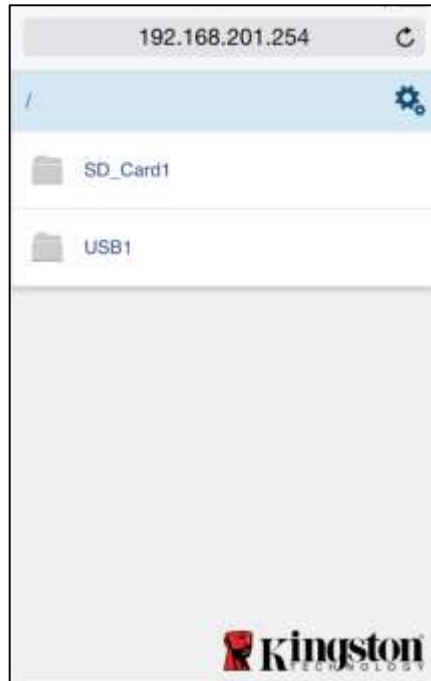

Figure 25.1 – Internet browser